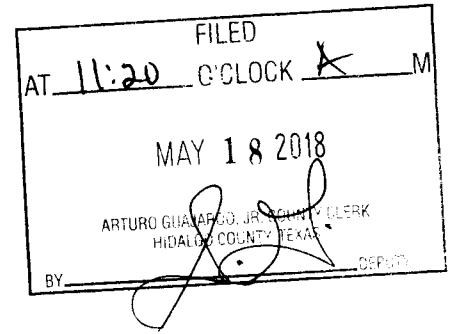

**EXHIBIT E**  
-Work Authorization

**HIDALGO COUNTY**  
Professional Engineering Services  
Contract # **C-18-130-04-03**  
Work Authorization Form



**WORK AUTHORIZATION NO.   1**

**THIS WORK AUTHORIZATION** is made pursuant to the terms and conditions of Section I.A. of the Agreement made by and between **HIDALGO COUNTY**, action herein by and through the **Commissioner's Court**, hereinafter called the "**Owner**," and, Half Associates, Inc., professional engineers of McAllen, Texas, hereinafter called "**Engineer**".

**PART 1. SCOPE OF WORK**

The purpose of this Work Authorization is for the **Engineer** to provide  
The scope of this project includes the design of drainage / park improvements for Memorial Park. Additional information regarding the scope can be found in Exhibit B.

The scope of services to be provided by the **Owner** is identified in **EXHIBIT "A" – Scope of Services to be provided by the Owner** attached hereto.

The scope of services to be provided by the **Engineer** is identified in **EXHIBIT "B" – Scope of Services to be provided by the Engineer** attached hereto.

**PART 2. ESTIMATED COST**

The estimated cost for services under this Work Authorization is \$ 732,321.00. This amount is based upon the costs outlined in the Estimated **Cost Proposal** attached hereto as **EXHIBIT "D"**.

**PART 3. PAYMENT**

Compensation and payment to the Engineer for the services established under this Work Authorization shall be made in accordance with **Article/Part/Section** 6 of the Agreement.

**PART 4. FUNDING**

This Work Authorization No. 1 shall be funded through funding source:

Account No. 8-1351-452-00-124-122-0-740

Requisition Number \_\_\_\_\_ (**MUST BE INCLUDED AFTER CC APPROVAL**)

**PART 5. PERIOD OF SERVICE**

This Work Authorization shall become effective on the date of final acceptance of the parties hereto, and terminate upon completion of scopes of the work authorization.

**PART 6. RESPONSIBILITIES AND OBLIGATIONS**

This Authorization does not waive the parties' responsibilities and obligations provided under the **Agreement.**

**PART 7. ACKNOWLEDGEMENT AND CONFIRMATION**

Acknowledgement and confirmation by **Hidalgo County Precinct #4**, as to content and detail of this **Work Authorization No. 1.**

**HIDALGO COUNTY PRECINCT No. 4**

BY: Joseph Palacios  
Joseph Palacios, Commissioner

**PART 8. ACCEPTANCE AND APPROVAL**

This Work Authorization is hereby accepted, approved by Hidalgo County Commissioners' Court on 5/8/18 as indicated below and effective as of 8<sup>th</sup> day of May, **2018.**

**THE ENGINEER:  
HALFF ASSOCIATES, INC.**

**THE OWNER:  
HIDALGO COUNTY**

By: \_\_\_\_\_

By: Ramon Garcia  
Ramon Garcia, County Judge

**ATTEST:**

By: Arturo Guajardo, Jr.  
Arturo Guajardo, Jr., County Clerk

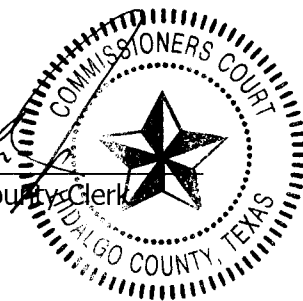

APPROVED BY  
COMMISSIONERS' COURT  
ON: 5/8/18

**LIST OF ATTACHMENTS**

- Location Map
- ATTACHMENT "A" - Service to be provided by the Owner
- ATTACHMENT "B" - Services to be provided by the Engineer
- ATTACHMENT "C" - Work Schedule
- ATTACHMENT "D" - Cost Proposal

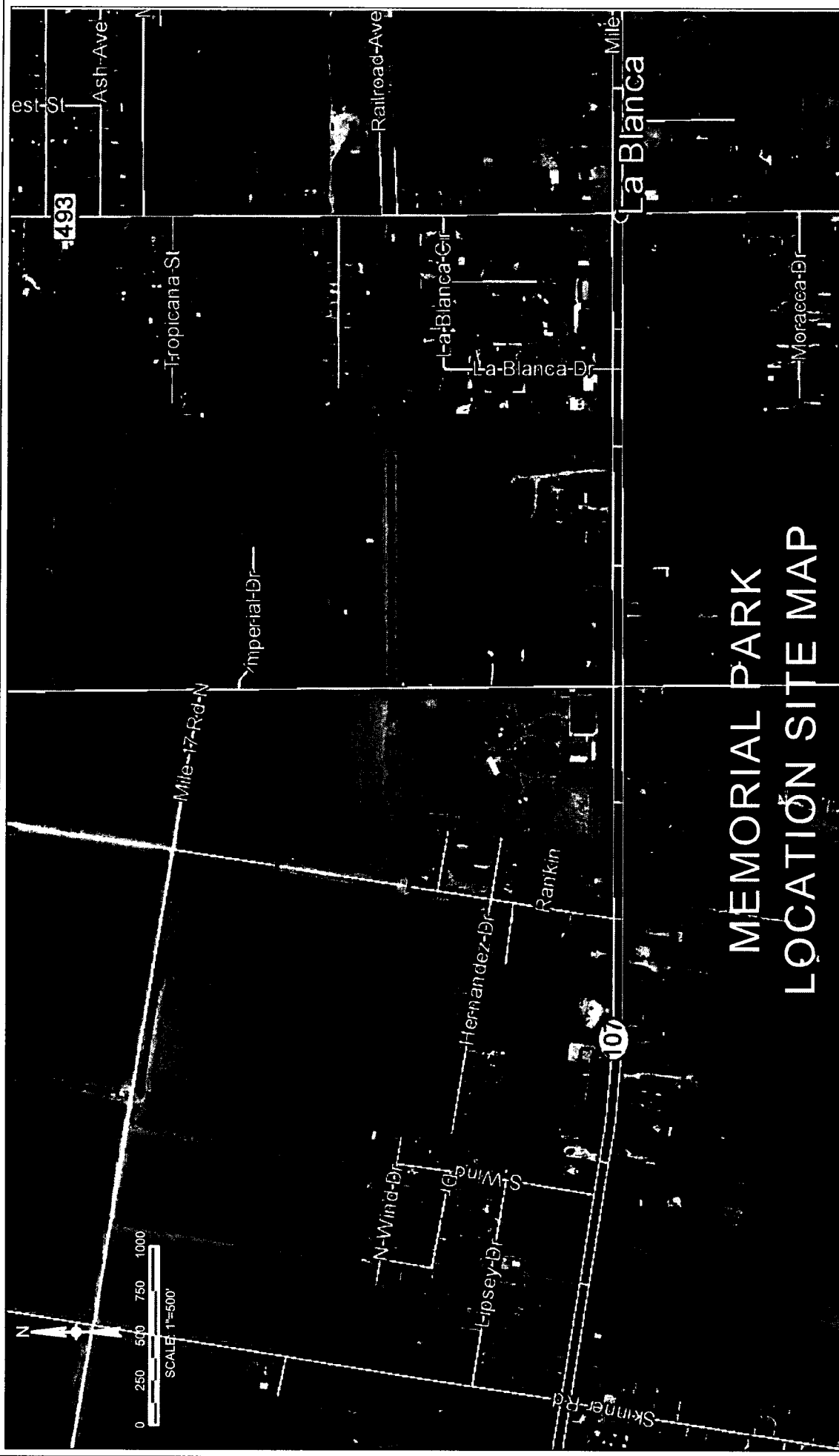

# MEMORIAL PARK LOCATION SITE MAP

**HALFF**  
 5000 WEST MILITARY, SUITE 140  
 DENVER, CO 80231  
 TEL: (303) 754-0296  
 FAX: (303) 754-0296

# ATTACHMENT A

## -Scope of Services to be provided by the Owner

The following provides an outline of the services to be provided by the **OWNER** in the development of the Project.

The **OWNER** will provide to the **ENGINEER** the following:

- (1) Authorization to the **ENGINEER** to begin work in accordance with Section 3 of this Agreement.
- (2) Payment for work performed by the **ENGINEER** and accepted by the **OWNER** in accordance with Section 6 of the Agreement.
- (3) Assistance to the **ENGINEER**, as necessary, to obtain the required data and information from other local, regional, State and Federal agencies that the **ENGINEER** cannot easily obtain.
- (4) Provide any available relevant data the **OWNER** may have on file concerning the project.
- (5) Provide timely review and decisions in response to the **ENGINEER'S** request for information and/or required submittals and deliverables, in order for the **ENGINEER** to maintain the agreed-upon work schedule prepared in accordance with Attachment "C" of this Agreement.
- (6) Attend and participate in progress meetings as required and as coordinated and conducted by the **ENGINEER**.
- (7) Assist the **ENGINEER** in the preparation of the project mailing list; provide representation, a site and stenographer for all public meetings; additionally:

### *Public Meetings*

- (a) Approve agenda and all exhibits prior to public meeting.
  - (b) Approve date and location of the meeting.
  - (c) Review/approve Public Meeting Report.
- (8) Attend the Preliminary Concept Conference coordinated and conducted by the **ENGINEER** and more particularly identified in Attachment "B" of the Agreement.
  - (9) Assist the **ENGINEER** as required in the coordination with the USACE and the Federal Emergency Management Agency (FEMA) and any other coordinating agency or entity.
  - (10) Review and approve the Project design criteria.
  - (11) Review and approve change orders as required and prepared by the **ENGINEER**.

# ATTACHMENT B

## -Scope of Services to be provided by the Engineer

Through project award via Work Authorization, Engineer shall provide Professional Services required to design and specify Building Repair and Renovation Projects. Type of services that may be included as dictated by the individual project requirements consist of: **1) Surveying, 2) Civil Engineering, 3) Mechanical/ Plumbing Engineering, 4) Electrical Engineering, 5) Structural Engineering.** Upon Identification by the Owner of specific projects that require the professional services of the Engineer, a detailed scope of work and identification of professional service disciplines required shall be established.

**Halff Associates, Inc. is please to submit this Work Authorization proposal under our existing Professional Service Agreement (C18-130-04-03) with Hidalgo County to provide:**

### DESIGN SERVICES

- Project Management
- Site Investigation and Base Map Preparation
  - Topographic Survey of Proposed Memorial Park Expansion
  - Develop Boundary Survey
  - Develop Base File
- Hydrologic and Hydraulic Analysis
  - Data Collection for Hydrology/Hydraulic Tasks
  - Hydrology and Hydraulic Modeling
- Civil Infrastructure Design
  - Offsite Drainage Design
  - Civil Infrastructure Design for Park
- Landscape Architecture and Irrigation
  - Park Infrastructure Design
  - Landscape and Irrigation Design
- Storm Water Lift Station
  - Lift Station Design

### BID PHASE SERVICES

- Pre Bid Conference
- Obtain Bids and Review
- Answer Questions Regarding Bid Document
- Provide Recommendations for Award
- Bid Phase Administrative Support
- Attendance at Commissioners Court Meeting (1)

### CONSTRUCTION PHASE SERVICES

- Pre-construction meeting (1 Visit)
- Response to RFI's
- Review Submittals
- Review Payment Applications
- CA Phase Administrative Support
- Field Observations

- Punch List and final observation
- Project Close-out

## **Proposal to Design Drainage / Park Improvements for Memorial Park**

Halff Associates' team of landscape architects, architects, and engineers will provide professional services needed to develop plans and specifications for improvements to the proposed park. The park will be delivered in a ready for construction as well as ready for bidding state by Hidalgo County Precinct 4.

The Scope of Services is as follows:

### **PHASE I – DESIGN SERVICES**

#### **Project Management**

Halff Associates, Inc. (Halff) will be the liaison and coordinate with Hidalgo County Precinct 4 and various agencies to develop construction documents for the proposed improvements. Halff will coordinate meetings and correspondence between the different disciplines of work, as well as the various agencies, to ensure uniformity and inclusion of Hidalgo County Precinct 4 requirements.

#### **Site Investigation and Base Map Preparation**

This task includes field site investigation and field surveying to obtain ties to surface improvements located onsite and offsite within limited areas of the watershed. We will establish horizontal and vertical control for the project to be utilized by the design team, contractor, and obtaining supplemental site topography required for the design. This does **not** include survey of any subsurface facilities other than wastewater and storm sewer. Existing underground structures or utilities not accessible will be obtained from record drawings and utility locating services.

Halff will perform a Boundary Survey in accordance with the “Manual of Practice for Land Surveying in Texas”. County to provide title commitment and warranty deed if necessary.

A base file will be developed from information gathered in the field to document the existing conditions and current state of the project site. We will utilize this base file to prepare our model and construction documents for the various disciplines needed for the park improvements.

#### **Hydrologic and Hydraulic Analysis**

##### **Data Collection for Hydrology/Hydraulic Tasks:**

Data collection and model inventory tasks will generally include gathering, organizing, and reviewing of all data provided, both hard copy and digital format. Data shall be provided by the County, as well as from other sources such as Hidalgo County Drainage District No. 1, Texas Department of Transportation, Franchise Utility Companies, FEMA, the U.S. Army Corps of Engineers (USACE), and other consultants, if necessary. Data review tasks will generally include comprehensive analysis of all models, studies, reports, record drawings, and GIS information to determine the accuracy and validity of each. Halff will also review the current drainage criteria and work with the County to recommend any potential changes or clarifications that may be needed.

## **Hydrology and Hydraulic Modeling**

Halff will study the contributing watershed and utilize existing H&H models developed for the County as the basis for building a combined 1D hydrologic and hydraulic model using InfoWorks ICM. Halff will modify basins as needed for proposed facilities, develop improvements that will help facilitate the storage and conveyance of storm water runoff. Halff will perform other updates that may include modification of development levels, updated terrain information, etc.

Proposed hydrologic and hydraulic facilities will be designed per the current County development guidelines and criteria. The results of the H&H modeling will be used to develop the construction documents. Modifications to the drainage design arising from the detailed design process will be documented in the overall model to reflect the completed design conditions and delivered to the County with the construction documents submittal.

## **Civil Infrastructure Design**

### **Offsite Drainage Design**

Halff will analyze the data obtained from the Hydrologic and Hydraulic Analysis and will design a detention/retention pond accordingly. This pond will be designed so that during non-storm events the pond can be used for other park amenities, including sports fields. Design of the storm sewer lift station to outfall the pond facility is included in this scope and detailed in a section below.

Design of offsite storm sewer facilities connecting potential subdivisions to the proposed detention pond is also included in this scope/fee.

### **Civil Infrastructure Design for Park**

Grading plans will be developed to provide positive drainage and meet trail and ADA criteria for longitudinal and cross slopes. Grades will be established for swales, drainage features and outfalls. Earthwork volumes will be developed to determine cut and fill volumes and to verify detention volumes are meeting hydrology and hydraulic requirements.

The drainage plan includes determination of site drainage basins, calculation of runoff volumes, layout and sizing of on-site drainage collection system and details required for construction. Storm sewer plan showing elevations and hydraulic flows and capacities will be prepared.

Coordinate geometry and layout dimensions will be shown to allow for construction of the drainage facilities. Detention/Retention calculations and design as required by the County are included in this scope/fee. Coordination with County, Hidalgo County Drainage District No. 1, and franchise utilities are included in this scope/fee.

Geometric dimensional control for the park improvements and trail paving details will be provided. Dimensional control will provide coordinate geometry, road widths and radii. **The trail surface paving section to be utilized will follow the recommendations of the project geotechnical consultant.** The details will include sections, valley gutters, and subgrade preparation.

Halff will prepare a Storm Water Pollution Prevention Plan (SWP3) that will comply with TCEQ requirements. The plan will address suggested interim erosion control measures the contractor may utilize during construction. **The maintenance of this plan, including the site inspections is not included in this fee, however these services may be made available on an hourly basis, if requested.**

Halff will provide a fencing plan with details and gates to secure the park during non-operational hours.

Halff will provide an opinion of probable construction cost with the final plans.

## **Landscape Architecture and Irrigation**

### **Park Infrastructure Design**

1. Receive survey data and build a site plan in CAD format
2. Meet with Hidalgo County Precinct 4 staff to discuss the project and gather information and understand the preferences for the development of the park and drainage features.
3. Prepare once conceptual site plan incorporating clients input.
4. Site the approved plan features on the site base plan
5. Collaborate and coordinate the siting of proposed site features with all design disciplines
6. Prepare construction documents for Landscape Architecture Improvements:
  - a. Athletic fields
    - i. Baseball fields
      1. Grading plan
      2. Detail skinned area and warning track
      3. Detail fencing, backstops, foul poles, windscreens
      4. Detail dugouts
      5. Detail area and location of premanufactured bleachers
      6. Coordinate with field lighting manufacturer for locations and necessary photometrics
      7. Scoreboard location
      8. Horizontal and vertical control of flatwork around concession and common areas
      9. Horizontal and vertical control of flatwork connection from looping trail, parking, and/or other athletic fields
    - ii. Softball Field
      1. Grading plan
      2. Detailed skinned area and warning track
      3. Detail fencing, backstops, foul poles, windscreens
      4. Detail dugouts
      5. Detail area and location of premanufactured bleachers
      6. Coordinate with field lighting manufacturer for locations and necessary photometrics
      7. Scoreboard location
      8. Horizontal and vertical control of flatwork around concession and common areas
      9. Horizontal and vertical control of flatwork connection from looping trail, parking, and/or other athletic fields
    - iii. Soccer field
      1. Grading plan
      2. Detail player bench areas
      3. Detail area and location of premanufactured bleachers

4. Coordinate with field lighting manufacturer for locations and necessary photometrics
  5. Horizontal and vertical control of flatwork around concession and common areas
  6. Horizontal and vertical control of flatwork connection from looping trail, parking, and/or other athletic fields
- b. Prepare construction details for scope-related work
  - c. Prepare technical specifications for scope-related work

### **Landscape and Irrigation Design**

1. Prepare construction documents for:
  - a. Irrigation plan
    - i. Reuse water as an irrigation water source
    - ii. Pump station
    - iii. Alternative water source (potable)
    - iv. Irrigation design of entire park
  - b. Planting plan
  - c. Athletic field
    - i. Baseball field
      1. Irrigation plan
      2. Turf plan (natural grass) – infield, outfield, and foul territory areas
    - ii. Softball field
      1. Irrigation plan
      2. Turf plan (natural grass) – outfield and foul territory areas
    - iii. Soccer Field
      1. Irrigation plan
      2. Turf plan (natural grass)

### **Storm Water Lift Station**

#### **Lift Station Design**

Develop hydraulic calculation to size a pumping station and force main needed to route water from the detention/retention pond to the Hidalgo County Drainage District No. 1 outfall ditch located on the north side of the project. The design will include all civil, electrical, mechanical and structural elements needed to design an operational and functional storm water pump station. The design will include a transfer switch and generator system that will operate during storm events in the event of a power outage. Coordination with the Drainage District will be ongoing during the design process and to conform to their mode of operation.

### **PHASE II – BID PHASE SERVICES**

This scope includes preparation of quantities and bid proposal form, coordination with contractors to invite them to bid, preparation of clarifications/addendums, collecting and evaluating bids, and preparation of bid tabulation with recommendation.

### **PHASE III – CONSTRUCTION PHASE SERVICES**

This scope includes review of the contractors submittals, review and response to contractor's requests for information (RFI's), review of contractors payment applications, conducting full time construction observation during construction (assumed 6 months construction time), preparation of one (1) punch list, and conducting one (1) final walk through. Additional punch lists or final walk throughs after the first punch list and first final walk through are **not** included in this scope of work but can be provided as additional services if requested.

Hidalgo County Precinct 4 will be self-performing much of the construction for this work authorization, therefore, Construction Phase Services will begin as soon as construction documents are provided to Hidalgo County Precinct 4 and pre-construction meetings have taken place. Multiple construction documents for multiple phases of construction are included in this scope.

# ATTACHMENT C

## -Work Schedule

A detailed work schedule for each **Work Authorization**, identified and more particularly described in **Article 7** of this Agreement, shall be prepared by the **Engineer** to be submitted and approved by the Owner in writing for each **Work Authorization**. The work schedule will provide specific work sequence and definite review times by the **Owner** and the **Engineer** of the work performed.

The **Engineer** will diligently pursue the completion of each **Work Authorization** as defined by the milestones and deliverable due dates outlined in each **Work Authorization**'s associated work schedule.

The **Engineer** will inform the **Owner** (in reasonable advance of the delay) should the **Engineer** encounter delays that would prevent the performance of all work in accordance with the established work schedule.

# ATTACHMENT D

## Cost Proposal

Provide Design Drainage / Park Improvements for Memorial Park:

• DESIGN SERVICES	\$526,340.00
• BID PHASE SERVICES	\$32,645.00
• CONSTRUCTION PHASE SERVICES	\$104,436.00
• REIMBURSABLE EXPENSES	\$68,900.00

**TOTAL:** \$ 732,321.00



**EXHIBIT D - COST PROPOSAL**

Half Associates, Inc.

Fee Schedule - Drainage / Park Improvements for Memorial Park

Contracted Rate:	Principal	Project Manager	Quality Manager	Project Engineer	EIT	Senior CADD Operator	CADD Operator	Survey Manager (RPLS)	Two Person Survey Crew	Admin Clerical	Project Inspector	Sub-Consultant	TOTAL (HOURS)	TOTAL (\$)
	\$247	\$235	\$263	\$185	\$108	\$99	\$83	\$154	\$201	\$62	\$86			
<b>PHASE I - DESIGN SERVICES</b>														
<b>Project Management</b>														
Project Management	40	160											240	\$ 49,960.00
Project Management Sub-Total (Hours)	40	160	0	0	0	0	0	0	0	40	0		240	\$ 49,960.00
Project Management Sub-Total (\$)	\$9,880	\$37,600	\$0	\$0	\$0	\$0	\$0	\$0	\$0	\$2,480	\$0	\$0		\$ 49,960.00
<b>Site Investigation and Base Map Preparation</b>														
Topographic Survey of Proposed Memorial Park Expansion				8			60	16	140				224	\$ 37,064.00
Develop Boundary Survey				8			40	24	40				112	\$ 16,536.00
Develop Base File				8			40	4					52	\$ 5,416.00
Site Investigation and Base Map Preparation Sub-Total (Hours)	0	0	0	24	0	0	140	44	180	0	0		388	
Site Investigation and Base Map Preparation Sub-Total (\$)	\$0	\$0	\$0	\$4,440	\$0	\$0	\$11,620	\$6,776	\$36,180	\$0	\$0	\$0		\$ 59,016.00
<b>Hydrologic and Hydraulic Analysis</b>														
Data Collection for Hydrology / Hydraulic Tasks			8	20	40	80							140	\$ 15,940.00
Hydrology and Hydraulic Modeling			8	80	120	160							368	\$ 45,704.00
Hydrologic and Hydraulic Analysis Sub-Total (Hours)			8	100	160	240	0	0	0	0	0		508	
Hydrologic and Hydraulic Analysis Sub-Total (\$)	\$0	\$0	\$2,104	\$18,500	\$17,280	\$23,760	\$0	\$0	\$0	\$0	\$0	\$0		\$ 61,644.00
<b>Civil Infrastructure Design</b>														
Offsite Drainage Design			16	80	120	80	160			8			464	\$ 53,664.00
Civil Infrastructure Design for Park			40	160	480	160	120			36			996	\$ 119,992.00
Civil Infrastructure Design Sub-Total (Hours)	0	0	56	240	600	240	280	0	0	44	0		1460	
Civil Infrastructure Design Sub-Total (\$)	\$0	\$0	\$14,728	\$44,400	\$64,800	\$23,760	\$23,240	\$0	\$0	\$2,728	\$0	\$0		\$ 173,656.00
<b>Landscape Architecture and Irrigation</b>														
Park Infrastructure Design			8	80	200	360				40			688	\$ 76,624.00
Landscape and Irrigation Design			8	48	96	200				32				\$ 43,136.00
Landscape Architecture and Irrigation Sub-Total (Hours)	0	0	16	128	296	560	0	0	0	72	0		688	
Landscape Architecture and Irrigation Sub-Total (\$)	\$0	\$0	\$4,208	\$23,680	\$31,968	\$55,440	\$0	\$0	\$0	\$4,464	\$0	\$0		\$ 119,760.00
<b>Storm Water Lift Station</b>														
Lift Station Design			8	80	120	160	200						568	\$ 62,304.00
Lift Station Sub-Total (Hours)	0	0	8	80	120	160	200	0	0	0	0		568	
Lift Station Sub-Total (\$)	\$0	\$0	\$2,104	\$14,800	\$12,960	\$15,840	\$16,600	\$0	\$0	\$0	\$0	\$0		\$ 62,304.00
<b>PHASE I - DESIGN SUB-TOTAL (HOURS)</b>														
<b>PHASE I - DESIGN SUB-TOTAL (\$)</b>														
<b>PHASE II - BID PHASE SERVICES</b>														
Pre Bid Conference	1	2		16						40			59	\$ 6,157.00
Obtain Bids and Review	1	2		16						40			59	\$ 6,157.00
Answer Questions Regarding Bid Document	1	2		16	24					40			83	\$ 8,749.00
Provide Recommendations for Award	1	2		16						40			59	\$ 6,157.00
Bid Phase Administrative Support										40			40	\$ 2,780.00
Attendance at Commissioners Court Meeting (1)	1	2		4						24			31	\$ 2,945.00
PHASE II - BID PHASE SERVICES SUB-TOTAL (HOURS)	5	10	0	68	24	0	0	0	0	224	0		331	
PHASE II - BID PHASE SERVICES SUB-TOTAL (\$)	\$1,235	\$2,350	\$0	\$12,580	\$2,592	\$0	\$0	\$0	\$0	\$13,888	\$0	\$0		\$ 32,645.00
<b>PHASE III - CONSTRUCTION PHASE SERVICES</b>														
Pre Construction Meeting (1 Visit)				1	2		4			4			11	\$ 981.00
Response to RFIs				2	4		8			8			22	\$ 1,962.00



May 8, 2018

- 2. **AI-64761** Approval of the following items for RG Enterprises LLC dba G&G Contractors for the Pct. 4 San Carlos Community Resource Center Landscape/ Retaining Wall/ Irrigation project P.O. 748664, as submitted and recommended by project architect, Mata-Garcia Architects LLC for contract # C-16-145A-04-13 including, but not limited to:

- A. Application for Payment 3 in the amount of \$55,394.50;
- B. Application for Payment 4 Release of Retainage in the the amount of \$13,852.87.

On motion by COMMISSIONER PCT. 4, JOSEPH PALACIOS, seconded by COMMISSIONER PCT. 1, DAVID FUENTES, the Court made a UNANIMOUS vote of approval on A and B.

**Vote:** 4 - 0 - Unanimously

- 3. **AI-64738** Authority and approval to enter into an Interlocal Agreement between Hidalgo County and **Texas A & M University** to extend the original facilitation, recruitment, outreach and resource development agreement established in 1999, amended and renewed in 2014 for the **Hidalgo County San Carlos Endowment Center** (Sunflower Road).

On motion by COMMISSIONER PCT. 4, JOSEPH PALACIOS, seconded by COMMISSIONER PCT. 1, DAVID FUENTES, the Court made a UNANIMOUS vote of approval.

**Vote:** 4 - 0 - Unanimously

**E. ~~XXXXXXXX~~ PRECINCT 4**

- 1. **AI-64785** Acceptance and approval of *Work Authorization No. 1* with estimated cost (\$ 732,321.00), as submitted HALFF ASSOCIATES, INC. (project engineer) in connection to (ON CALL) agreement # C-18-130-04-03 for: "Road and Bridge, C.I.P. and Other Projects in General" located within Hidalgo County Precinct Number 4, *Project Specific: Design of Drainage/Park Improvements for Memorial Park" located in Hidalgo County Precinct 4.*

**APPROVED**

On motion by COMMISSIONER PCT. 4, JOSEPH PALACIOS, seconded by COMMISSIONER PCT. 1, DAVID FUENTES, the Court made a UNANIMOUS vote of approval.

**Vote:** 4 - 0 - Unanimously

**20. Open Forum**

- Fern McClagherty claimed that the public is upset at the court members over the construction of the courthouse and other projects.

**21. Closed Session:**

Commissioners' Court may go into Closed Session pursuant to Chapter 551, Texas Government Code, Sections 551.071, 551.072 & 551.074 to discuss the following:

On motion by COMMISSIONER PCT. 4, JOSEPH PALACIOS, seconded by COMMISSIONER PCT. 1, DAVID FUENTES, the Court made a UNANIMOUS vote of approval.

**Vote:** 4 - 0 - Unanimously

**A. Real Estate Acquisition**

No action taken on this item.

**SPECIAL MEETING - May 8, 2018**

**BE IT REMEMBERED**, that on this 8th day of May A.D., 2018, there was begun and held a **SPECIAL MEETING** of the Honorable Commissioners' Court of Hidalgo County, Texas, wherein the following members thereof were present, to-wit:

HONORABLE RAMON GARCIA

HIDALGO COUNTY JUDGE

HONORABLE DAVID FUENTES

COMMISSIONER, PRECINCT NO. 1

HONORABLE EDUARDO "EDDIE" CANTU

COMMISSIONER, PRECINCT NO. 2

HONORABLE JOE M. FLORES

COMMISSIONER, PRECINCT NO. 3

HONORABLE JOSEPH PALACIOS

COMMISSIONER, PRECINCT NO. 4

and **ARTURO GUAJARDO, JR.**, COUNTY CLERK & EX-OFFICIO CLERK OF THE COMMISSIONERS' COURT of Hidalgo County, Texas, wherein the following proceedings were had, to-wit:

May 8, 2018



**AGENDA  
CC REGULAR  
HIDALGO COUNTY  
COMMISSIONERS COURT MEETING  
May 8, 2018  
9:30 A.M.**

NOTICE is hereby given in accordance with Chapter 551, Texas Government Code, that a SPECIAL MEETING of the Commissioners' Court will be held at the Edinburg Council Chambers 415 W. University Drive, Edinburg, Hidalgo County, Texas. Discussion and possible action relating to the following business will be transacted:

**1. Roll Call**

All members of the court were present during the meeting.

**2. Pledge of Allegiance**

Judge Garcia led the courtroom in reciting the Pledge of Allegiance.

**3. Prayer**

Opening prayer offered by Julia Sullivan.

**4. Approval of Consent Agenda**

The court moved to approve the consent agenda with the exception of Items. 9.A. and 10.I. to be pulled for discussion.

**5. County Judge's Office:**

- A. AI-64591** Consideration and approval of a Proclamation Declaring May 2018 as Elder Abuse Prevention Month.

On motion by COMMISSIONER PCT. 3, JOE M. FLORES, seconded by COMMISSIONER PCT. 4, JOSEPH PALACIOS, the Court made a UNANIMOUS vote of approval.

**Vote:** 5 - 0 - Unanimously

Ann Cortez, District Director for Adult Protective Services, informed that this past year they had over 3,000 neglect, abuse and exploitation cases in Hidalgo County, 1,500 cases were validated.

*Court proceeded to Item. 10.B.*

**6. District Attorney's Office:**

- A. AI-64710** 1. Requesting consideration and approval of the Interlocal Agreement between the Department of Public Safety (DPS) and the County of Hidalgo, Texas by and through the Hidalgo County Criminal District Attorney.

On motion by COMMISSIONER PCT. 3, JOE M. FLORES, seconded by COMMISSIONER PCT. 2, EDUARDO "EDDIE" CANTU, the Court made a UNANIMOUS vote of approval.

**Vote:** 4 - 0 - Unanimously

2. Requesting consideration, approval and authorization for Ricardo Rodriguez, Jr., Criminal

May 8, 2018

- B. **AI-64743** Approval of 2017 appropriations of funds from the Pct. 3 R&B Unreserved Fund Balance for various Pct. 3 Rd. Maint. accounts in the amount of \$778,000.00 to fund operating expenditures.

On motion by COMMISSIONER PCT. 1, DAVID FUENTES, seconded by COMMISSIONER PCT. 4, JOSEPH PALACIOS, the Court made a UNANIMOUS vote of approval.

**Vote:** 4 - 0 – Unanimously

19.

**Purchasing Department - Notes:**

A. FOR ANY CONTRACT(S) AWARDED AND APPROVED UNDER THIS AGENDA, EXECUTED COPIES OF THE CONTRACT(S) WILL BE AVAILABLE ON THE COUNTY INTRA-NET WEBSITE AND WILL BE FORWARDED VIA E-MAIL, FAX OR HAND DELIVERED TO HIDALGO COUNTY AUDITOR'S OFFICE.

B. ANY AND ALL REQUESTS FOR PAYMENT(S) APPROVED WILL BE SUBJECT TO COUNTY AUDITORS PROCESSING PROCEDURES INCLUDING AUTHORITY FOR COUNTY TREASURER TO ISSUE PAYMENT(S)/CHECK(S).

A. **Hidalgo County**

1. **AI-64699** Requesting action to clarify (R-AI #64478 CC of 04/17/2018) for the "Demolition Services of HC Structures" to reflect the advertisement of only one (1) project [former DPS office on frontage road] as the other structure [Pct. #2 Palmer Pavilion] commenced under Purchase Order No. 764996 in 2017 but as yet has not been completed thus statutory bid limit applicable to all other demolition projects hereafter for this fiscal year.

Martha Salazar informed they'll advertise for only one.

On motion by COMMISSIONER PCT. 1, DAVID FUENTES, seconded by COMMISSIONER PCT. 4, JOSEPH PALACIOS, the Court made a UNANIMOUS vote of approval.

**Vote:** 4 - 0 – Unanimously

B. **Executive Office**

1. **AI-64791** Acceptance and approval of Work Authorization No. 2, estimated cost of \$ 26,250.00 as submitted by Halff Associates, Inc. (project engineer) for (*Project Specific*): "Demolition of all Site Structures and Improvements at Old County Jail Site (located at 207 East Loeb Street, Edinburg, Texas) through on-cal) agreement #C-17-142-05-16 for: Buildings Repairs, Renovations, Alterations, Additions and/or Other Related Services to County Owned Buildings located in Precinct 4.

On motion by COMMISSIONER PCT. 1, DAVID FUENTES, seconded by COMMISSIONER PCT. 4, JOSEPH PALACIOS, the Court made a UNANIMOUS vote of approval.

**Vote:** 4 - 0 – Unanimously

C. **Pct. 3**

1. **AI-64748** Acceptance and approval of Work Authorization No. 4 (with an estimated cost of \$625,000.00) as submitted by project engineer, L&G Consulting Engineers, to provide Engineering Services required for the preparation of the Right-of-Way Acquisition for an estimated amount of 32 parcels and Compensable Utility Management and Construction Management, for the Shary Road (FM 494) project from FM 676 (Mile 5) to to SH 107 through contract #C-13-133-12-03.

On motion by COMMISSIONER PCT. 4, JOSEPH PALACIOS, seconded by COMMISSIONER PCT. 1, DAVID FUENTES, the Court made a UNANIMOUS vote of approval.

**Vote:** 4 - 0 - Unanimously

D. **Pct. 4**