

Key Plan

Hopkins Real Estate Group
17461 Derian Ave.
Suite 106
Irvine, CA 92614
T: 949-270-2400
F: 949-644-8631

No.	Date	Revision Description
11/07/06		1ST CITY SUBMITTAL
12/08/06		OWNER COORDINATION
12/21/06		PLAN CHECK CORR.
01/30/07		VALUE ENGINEER/PLAN OR CORR. #2.2
02/02/07		FIRE DEPARTMENT CORRECTIONS
03/14/07		CONSTRUCTION SET
03/07/07		FIRE DEPT. CORR. #2

Imperial Promenade
1000 W. Imperial Hwy.
La Habra, CA
(PADS & SHOPS BLDG.)

SITE PLAN

Project: 0519114.01 Drawing Number:
Date: November 1, 2006
Drawn by: STAFF
Checked by: L6/M6

SITE PLAN GENERAL NOTES

- REFER TO CIVIL, PLUMBING & ELECTRICAL DRAWINGS FOR UTILITIES AND UTILITIES LOCATIONS. FIELD VERIFY ALL UTILITIES AND THEIR LOCATIONS AND COORDINATE WITH CIVIL DRAWINGS BEFORE START OF WORK. K.K.E. ASSUMES NO LIABILITY FOR WORK REGARDING UTILITIES.
- FOR GRADE ELEVATIONS-SEE CIVIL DWGS.
- FOR RAMP ELEVATIONS SEE CIVIL DRAWINGS. ALL RAMP SHALL HAVE A NON-SLIP FINISH.
- PUBLIC FIRE HYDRANTS AT THIS LOCATION SHALL HAVE A FIRE FLOW OF 2000 GALLONS PER MINUTE AT 20 PSI FOR A DURATION OF 2 HOURS COVER AND ABOVE MAXIMUM DAILY DEMAND.
- ALL HYDRANTS SHALL MEASURE 6"x4"x2" BRASS OR BRONZE, CONFORMING TO CURRENT NFPA STANDARD CE05 OR APPROVED EQUAL. HYDRANTS SHALL BE INSTALLED PER CALIFORNIA FIRE CODE AS APPLICABLE TO THE LOCALITY. REFER TO ORDINANCE NO 1984, (TITLE 20) UTILITY MANUAL, SECTION 4.0 TO 4.6.
- ALL REQUIRED PUBLIC FIRE HYDRANTS SHALL BE INSTALLED, TESTED AND ACCEPTED PRIOR TO CONSTRUCTION.
- TEMPORARY PEDESTRIAN PROTECTION SHALL BE PROVIDED AS REQUIRED BY THE LA HABRA CITY BUILDING CODE.
- VEHICULAR ACCESS MUST BE PROVIDED AND MAINTAINED SERVICEABLE THROUGHOUT B.T.I. CONSTRUCTION.
- FIELD INSPECTOR SHALL DETERMINE FIRE EXTINGUISHER REQUIREMENTS.
- BUILDING ADDRESS NUMBERS TO BE PROVIDED ON THE FRONT OF ALL BUILDINGS AND SHALL BE VISIBLE AND LEGIBLE FROM STREET FRONTING PROPERTY. SAID NUMBERS SHALL CONTRAST WITH THEIR BACKGROUND.
- COMMERCIAL DUMPSTERS OR CONTAINERS WITH AN INDIVIDUAL CAPACITY OF 15 CUBIC YARDS OR GREATER SHALL NOT BE STORED OR PLACED WITHIN FIVE FEET OF COMBUSTIBLE WALLS, OPENINGS OR COMBUSTIBLE ROOF EAVE LINES UNLESS AREAS CONTAINING DUMPSTERS ARE PROTECTED BY AN APPROVED SPRINKLER SYSTEM.
- REFER TO CIVIL PLANS FOR ALL PARKING, STRIPING, DIRECTIONAL ARROW, STOP SIGN, ETC.
- PROVIDE SURVEY STAKES PRIOR TO FOUNDATION INSPECTION TO VERIFY LOT LINES.

FIRE DEPARTMENT NOTES

- THE REQUIRED FIRE FLOW IS BASED ON THE FOLLOWING CALCULATION:
FIRE FACS 1 AND 2: 2-RISK FIRE FLOW: 3000 GPM
INCREASE 500 GPM FOR EACH STORY ABOVE GROUND FLOOR: 500 GPM
INCREASE 500 GPM FOR A SINGLE EXPOSURE WITHIN 50 FEET: 500 GPM
INCREASE FOR HAZARDOUS OCCUPANCY: 500 GPM
REDUCTION FOR FIRE SPRINKLERS AND/OR CONSTRUCTING TYPE: 2250 GPM
- THE INSPECTION, HYDRAULIC TEST AND FLUSHING OF THE UNDERGROUND FIRE PROTECTION PIPING SHALL BE WITNESSED BY AN AUTHORIZED FIRE DEPARTMENT REPRESENTATIVE AND NO UNDERGROUND PIPING OR THRUST BLOCKS SHALL BE COVERED OR HIDDEN FROM VIEW UNTIL THE FIRE DEPARTMENT REPRESENTATIVE HAS BEEN NOTIFIED AND GIVEN NOT LESS THAN 48 HOURS IN WHICH TO INSPECT SUCH INSTALLATIONS. FIRE CODE 1003.4.
- GENERAL CONTRACTOR TO PROVIDE AN APPROVED AUTOMATIC FIRE SPRINKLER SYSTEM PLANS SHALL BE SUBMITTED TO THE SPRINKLER PLAN CHECK UNIT FOR REVIEW AND APPROVAL PRIOR TO INSTALLATION. FIRE CODE 1003.3.
- THE MEANS OF EGRESS TRAVEL SHALL BE ILLUMINATED AT ANY TIME THE BUILDING IS OCCUPIED IN A LIGHT INTENSITY OF NOT LESS THAN 1 FOOT-CANDLE AT THE FLOOR LEVEL. BUILDING CODE 1003.2.1.1.
- SHOPS BUILDING EXTERIOR WALL ADJACENT TO EXISTING BUILDING ARE TO BE 1-HR FIRE RATED. SEE WALL SECTIONS SHEET AS.402 AND AS.403.
- The power supply for the means of egress exit illumination shall be supplied from separate source in accordance with the Building Code 1003.2.4.2. Provide note on site plan and indicate the light fixtures with emergency power on reflected ceiling plan.
- Illuminated exit signs shall be located as necessary to clearly indicate the direction of egress travel. Additional exit signs may be required at time of field inspection. Building Code 1003.2.3.2. Indicate exit sign locations on floor plan.
- Building address numbers shall be provided and maintained so as to be plainly visible and legible from the street fronting the property. The numbers shall be a minimum 3 inches high, 1 inch wide with a 3/8 inch stroke. For buildings set back more than 150 feet from the street, the numbers shall be a minimum 5 inches high, 2 inches wide with a 3/8 inch stroke. Fire Code 901.4.4.
- Exit doors shall be capable of opening without the use of a key or any special knowledge or effort. Building Code 1003.3.1.6.
- The means of egress travel shall be illuminated at any time the building is occupied with a light intensity of not less than 1 foot-candle at the floor level. Building Code 1003.2.4.1.
- Pasadena Fire Extinguisher requirements shall be determined by Fire Department Field Inspector in accordance with Fire Code 1003.3.
- Provide Building Code occupancy classification(s) for all separate and distinct uses of the building(s) in accordance with the Building Code Section 301 and Table 3-A.
- Provide an approved automatic fire sprinkler system. Plans shall be submitted to the Sprinkler Plan Check Unit for review and approval prior to installation. Fire Code 1003.3.1.1. Area of Protection - Building Code 805.
- The inspection, hydrostatic test and flushing of the underground fire protection piping shall be witnessed by an authorized Fire Department representative and no underground piping or thrust blocks shall be covered with earth or hidden from view until the Fire Department representative has been notified and given not less than 48 hours in which to inspect such installations. Fire Code 1003.4.

SITE PLAN SYMBOLS

- BUILDING DESCRIPTION:
BUILDING OCCUPANCY CLASSIFICATION: MIB-MERCANTILE/BUSINESS (TABLE 3A)
CONSTRUCTION TYPE: TYPE V-N
- SITE PLAN SYMBOLS
- ACCESSIBLE PATH OF TRAVEL
 - LIGHT STANDARD-SEE ELECTRICAL DWGS.
 - LINE OF LIMIT OF WORK
 - - - NOT IN CONTRACT

SITE PLAN KEY NOTES

- GENERAL
- LINE OF LIMIT OF WORK
 - PARCEL LINE
 - PATH OF TRAVEL
 - TRASH ENCLOSURE AND CONCRETE APRON PER CITY STANDARDS
 - CONG. CURB AT LANDSCAPE - REFER TO CIVIL DWGS. - SEE DETAIL 1A023
 - CONG. CURB AT SIDEWALK - REFER TO CIVIL DWGS. - SEE DETAIL 2A023
 - CONG. SIDEWALK WITH MEDIUM BRUSH FINISH - PROVIDE CONTROL JOINTS AS SHOWN ON PLAN - SEE DETAIL 2A023
 - A.G. PAVING OVER AGGREGATE BASE - REFER TO CIVIL DWGS.
 - DETECTABLE WARNING TRUNCATED DOMES IS REQUIRED AT THE WALKWAY CROSSES OR ADJOINING A VEHICULAR WAY PER SECTION 1098B.5
 - PLANTER TYP. - SEE DETAIL
 - ACCESSIBLE RAMP - SEE DETAIL 1A023
 - PIPE BOLLARD - SEE DETAIL 1A023
 - STEEL TREE GRATE - SEE LANDSCAPE PLANTING PLAN FOR SPECIFICATION
 - LOCATION OF FIRE LANES TO COMPLY WITH FIRE DEPT. REQUIREMENTS
 - PROPOSED TRANSFORMER-PAD MOUNTED. SEE CIVIL & ELECTRICAL DWGS.
 - MAIN ELECTRICAL SWITCHGEAR SERVICE PANEL - SEE CIVIL & ELECTRICAL DWGS.
 - ASSUMED VAULT LOCATION - COORDINATE WITH UTILITY COMPANY
 - LIGHT STANDARD AS REQ'D. SEE ELECTRICAL DWGS. SEE DETAIL 1A023
 - WATER METER TO BUILDING - SEE CIVIL DWGS.
 - AUTOMATIC SPRINKLER RISER LOCATION - SEE PLUMBING & CIVIL DWGS.
 - STORM DRAIN TO FACE OF CURB-SEE PLUMBING DWGS. COORDINATE LOCATION OF STORM DRAIN OUTLETS WITH BUILDING PAD DWGS. BEFORE START OF WORK.
 - 6AS METERS - SEE CIVIL DWGS.
 - CATCH BASIN - SEE CIVIL DWGS.
 - CART STORAGE WITH 6" THICK 6M WALL
 - CART STORAGE METAL.

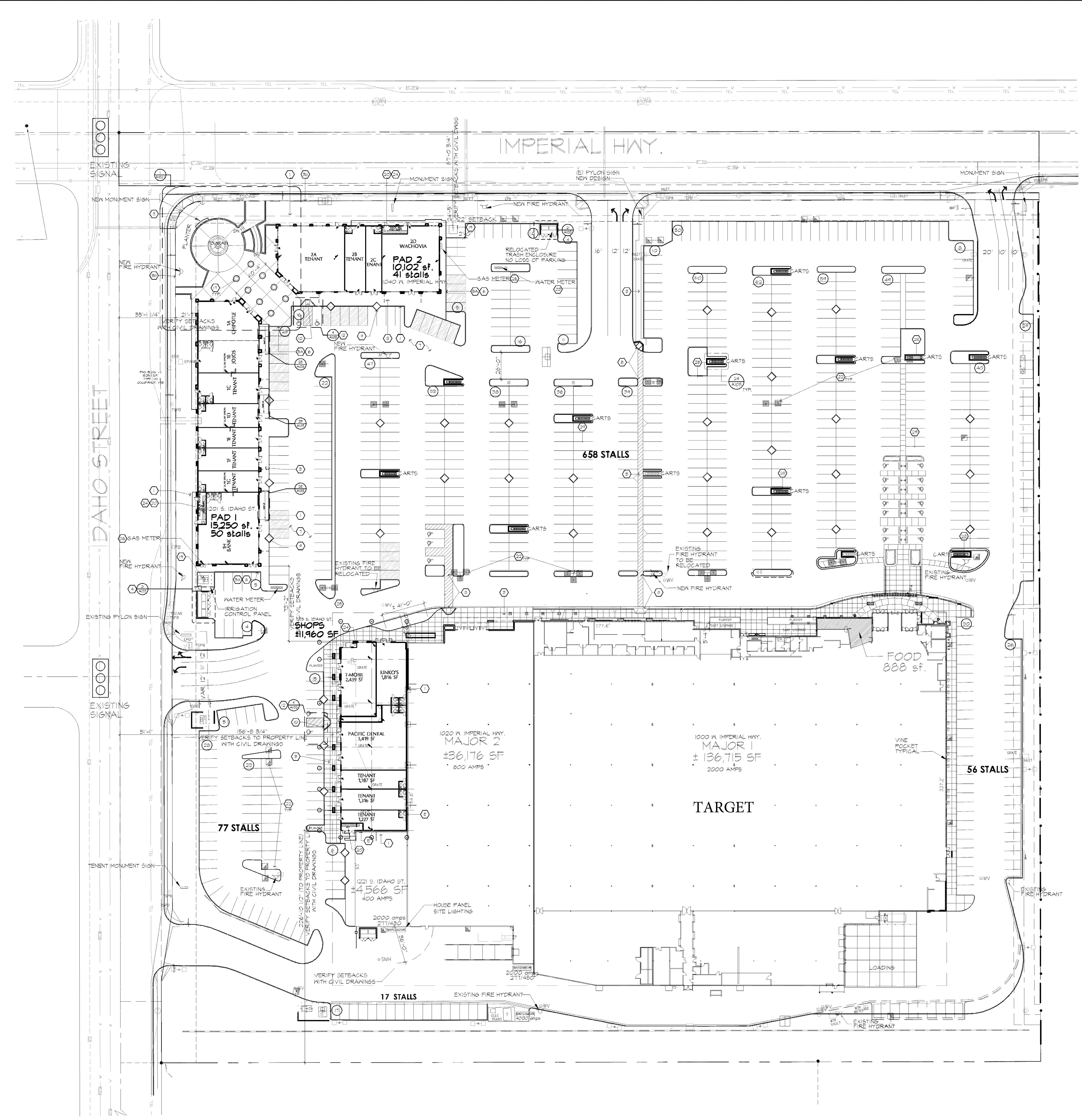

REFERENCE SITE PLAN
SCALE: 1" = 40'-0"

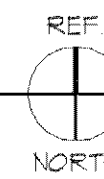

NOTICE
-VERIFY ALL DIMENSIONS AND CONDITIONS
-NOTIFY THIS OFFICE OF ANY VARIATIONS
-ALTERNATE USE OF THIS DRAWING MUST
BE APPROVED BY THIS OFFICE

*This document is the exclusive property
of the Target Corporation and contains
proprietary information of Target Corp.
The possession of this document does
not convey any rights to reproduce,
disclose its contents or to produce, use
or sell anything it may describe.
Reproduction, disclosure or use without
specific prior written authorization from
Target Corporation is strictly forbidden.

CEILING HEIGHT

A & A: 14'-0"
Hardlines: 14'-0"
Stockroom: 18'-6"
*USE HEIGHT TO BOTTOM OF STRUCTURE

Seismic: Yes

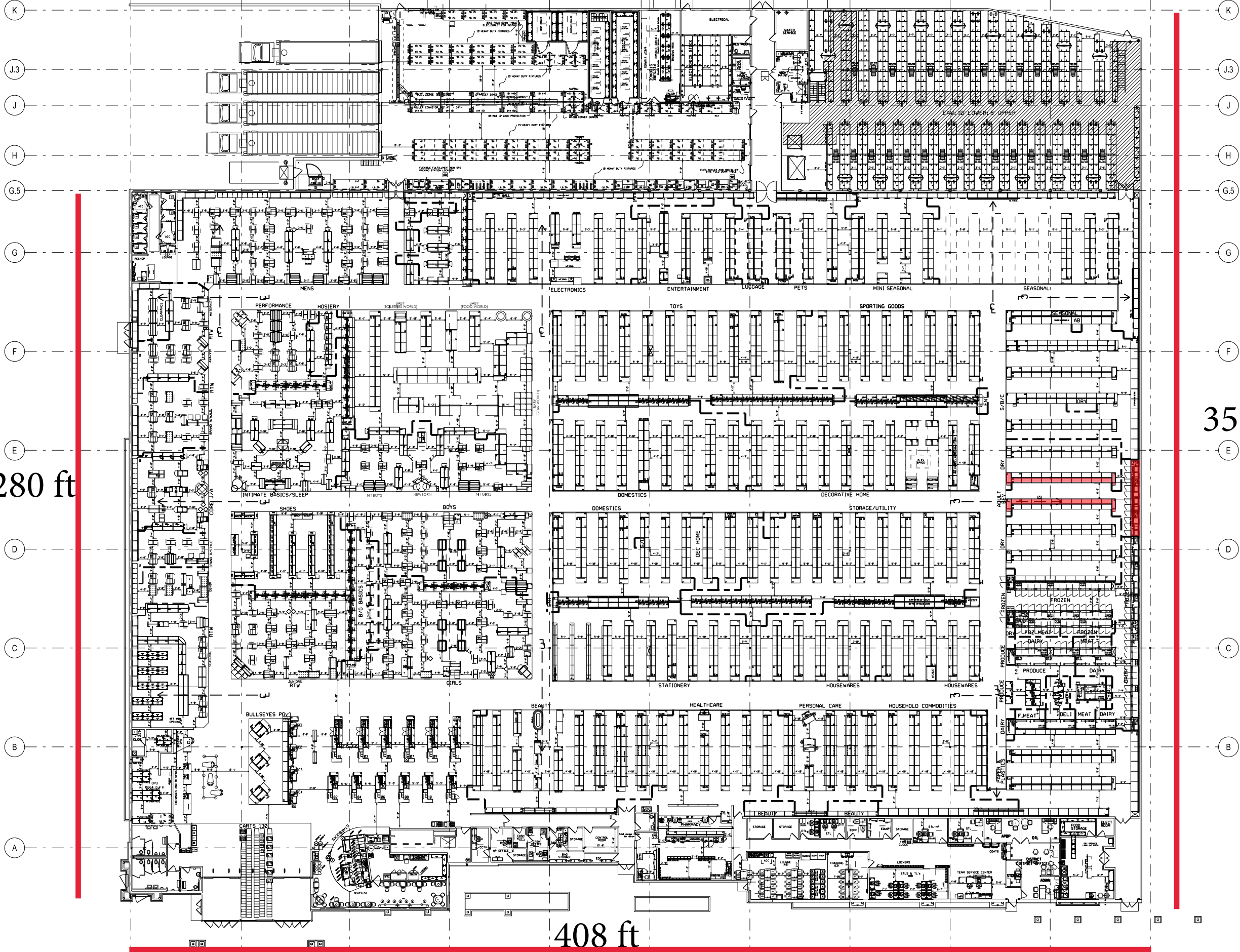

280 ft

355 ft

408 ft

EXISTING



ISSUE DATE:
PLOT DATE: 19-OCT-2021 04:29
PLANNER:
SCALE: 1/40"=1'-0"
PROJECT

NAME: Lo Hobra
Lo Hobra, CA
STORE NO.: T-2397
TITLE: FIXTURE PLAN

PLAN TYPE: SHEET NO.:
P04.383 FZ1
P19