

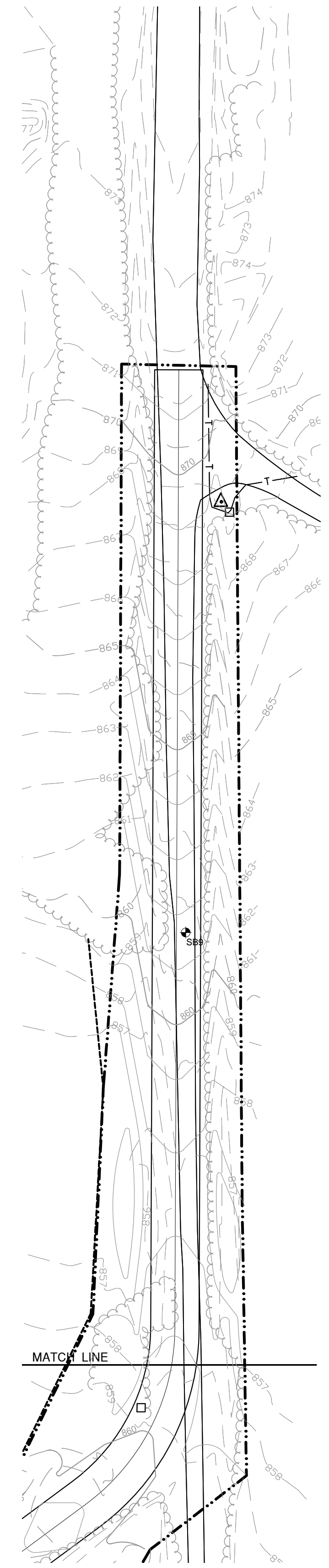

DIMENSION PLAN
0 40 80



SITE PLAN
0 40 80



Call 48 Hours prior to digging.
Gopher State One Call
 Twin Cities Area: 651-454-8388
 Toll-Free: 1-800-252-1166

GENERAL PLAN NOTES:

CONTRACTOR IS ADVISED THAT ALL EXISTING SITE DATA, UTILITIES, TOPOGRAPHY, SPOT ELEVATIONS, VEGETATION, ETC., HAS BEEN PROVIDED BY THE ANOKA COUNTY SURVEYORS OFFICE AND ARE SHOWN IN THEIR APPROXIMATE LOCATIONS. CONTRACTOR SHALL VERIFY ALL UTILITY LOCATIONS AND TOPOGRAPHIC CONDITIONS PRIOR TO COMMENCEMENT OF CONSTRUCTION. ANY DISCREPANCIES SHALL IMMEDIATELY BE BROUGHT TO THE ATTENTION OF THE OWNER/LANDSCAPE ARCHITECT.

ALL SITE FEATURES NOT NOTED FOR REMOVAL SHALL BE PROTECTED BY THE CONTRACTOR. ANY DAMAGE WILL BE AT THE CONTRACTORS EXPENSE.

CONTRACTOR SHALL CONTACT GOPHER STATE FOR ALL UTILITY LOCATIONS 48 HRS. PRIOR TO EXCAVATION-CONSTRUCTION.

REFER TO EXISTING CONDITIONS AND GRADING PLAN FOR ALL EXISTING AND PROPOSED GRADES.

CONTRACTOR SHALL BE RESPONSIBLE FOR PROTECTING EXISTING SITE AMENITIES, TREES, UTILITIES, ETC. FROM DAMAGE DURING CONSTRUCTION. CONTRACTOR SHALL BE RESPONSIBLE FOR CORRECTING ANY DAMAGE THAT OCCURS FROM CONSTRUCTION TO AREAS BOTH INSIDE AND OUTSIDE OF CONSTRUCTION LIMITS, AND ADDITIONAL AREAS DESIGNATED BY OWNER FOR PROTECTION (AT CONTRACTORS EXPENSE).

CONTRACTOR SHALL BE RESPONSIBLE FOR PROTECTING INDICATED TREES TO REMAIN FROM DAMAGE; TO THE TREE ITSELF AS WELL AS THE ROOT SYSTEM TO THE DRIP LINE. SOME TREES MAY NOT BE ABLE TO BE PROTECTED TO THE DRIP LINE DUE TO EXISTING LOCATION. CONTRACTOR TO REVIEW TREE PROTECTION FENCE LOCATIONS WITH LANDSCAPE ARCHITECT PRIOR TO CONSTRUCTION.

CONTRACTOR SHALL STAY WITHIN CONSTRUCTION LIMITS UNLESS APPROVED OTHERWISE BY OWNER/LANDSCAPE ARCHITECT. MOVEMENT AND PARKING OF EQUIPMENT SHALL STAY WITHIN LIMITS OF CONSTRUCTION UNLESS OTHERWISE NOTED.

CONTRACTOR SHALL BE RESPONSIBLE FOR INSTALLING ALL TRAFFIC CONTROL DEVICES AND SIGNS AS REQUIRED AND INDICATED PER PLAN, DETAILS, AND SPECIFICATIONS.

ALL PAVEMENT MARKING/STRIPING INDICATED TO BE 4" WIDE AND INSTALLED PER PLAN, DETAILS, AND SPECIFICATIONS AND IN ACCORDANCE WITH MNDOT STANDARDS.

EXISTING CONCRETE, BITUMINOUS, AGRAGATE AND COMPACTED SOILS TO BE COMPLETELY REMOVED WHERE PLANTING BEDS AND INFILTRATION BASINS ARE PROPOSED.

INFILTRATION BASINS AND PLANTERS TO BE OVER EXCAVATED A MINIMUM OF 3 FEET IN DEPTH AND INSPECTED BY LANDSCAPE ARCHITECT PRIOR TO BACKFILLING WITH SOIL APPROVED BY LANDSCAPE ARCHITECT.



**ANOKA COUNTY
PARKS AND RECREATION**
 550 BUNKER LAKE BOULEVARD NW
 ANDOVER, MN 55304
 TEL (763) 757.3920
 FAX (763) 755.0230

CONTACT INFORMATION:

Danielle Sanborn, Landscape Architect
 550 Bunker Lake Blvd NW
 Andover, MN 55304
 danielle_sanborn@co.anoka.mn.us
 763.757.2864

I hereby certify that this plan, specification or report was prepared by me or under my direct supervision and that I am a duly Licensed Landscape Architect under the laws of the State of Minnesota.

Registration: Landscape Architect
 State: Minnesota
 Number:
 Signature: Danielle Sanborn

| NO. | DATE | DESCRIPTION |
|-----|------|-------------|
| | | |
| | | |
| | | |
| | | |
| | | |
| | | |
| | | |
| | | |
| | | |
| | | |

DESIGN PHASE:

DESIGN PLAN

BOAT LAUNCH CONSTRUCTION
 ANOKA COUNTY PARKS AND RECREATION
 MISSISSIPPI WEST REGIONAL PARK
 7560 139TH LANE NW, RAMSEY, MINNESOTA 55303

DATE: JUNE 22ND, 2011

DESIGNED BY: DDS
 DRAWN BY: DDS
 CHECKED BY: DDS

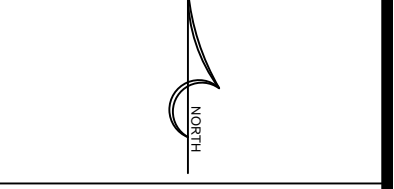

TITLE

**OVERALL DIMENSION
PLAN**