



engineering surveying planning energy

14800 28th Ave. N, Ste 140  
Plymouth, Minnesota 55447  
(763) 476.6010 telephone  
(763) 476.8532 facsimile  
www.mfra.com

Client  
**SOPHIA-  
RAMSEY LLC**

Project  
**RIGHT-IN  
ACCESS LANE**

Location  
**RAMSEY, MN**

### Certification

I hereby certify that this plan, specification or report was prepared by me or under my direct supervision and that I am a duly licensed professional ENGINEER under the laws of the state of Minnesota.

PAUL W. PEARSON  
Registration No. 12795 Date: 11/03/2011  
If applicable, contact us for a wet signed copy of this plan which is available upon request at MFRA, Inc., Plymouth, MN office.

### Summary

Approved: PWP Drawn: DJD

### Revision History

No. Date By Submittal / Rev.

Sheet Title  
**PRELIMINARY  
PLAN**

Sheet No. Revision  
**1/1**

Project No. SOL18892

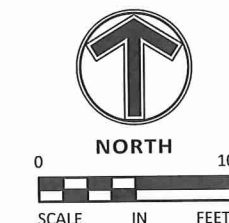
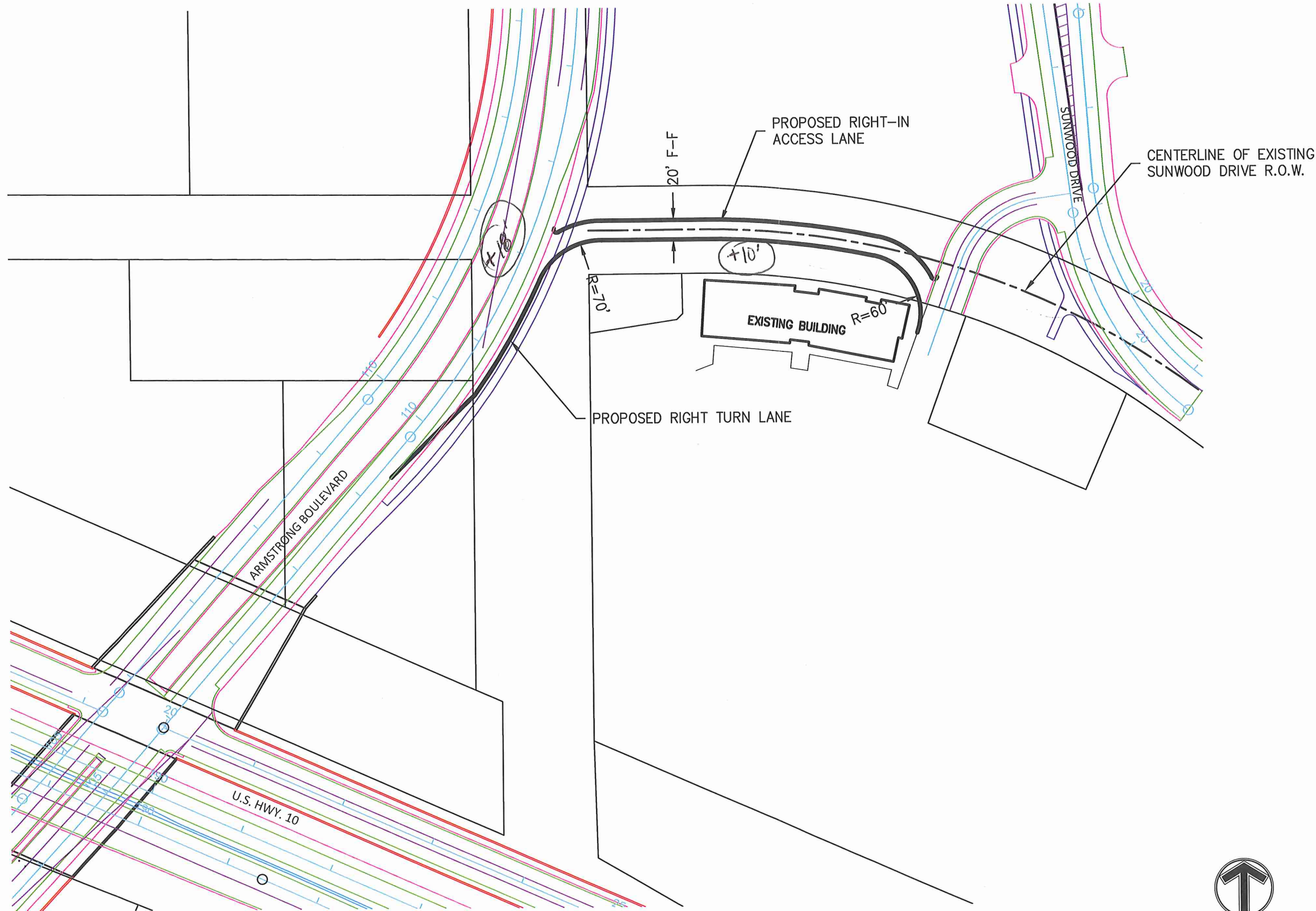

Nov 03, 2011 - 1:30pm - User:225.L:\PROJECTS\SOL18892.dwg\Civil\18892-SKETCH.dwg