

CITY OF RAMSEY

CONSTRUCTION PLANS FOR 2012 CULVERT REPLACEMENT AND CATCH BASIN REPAIR  
RAMSEY CITY PROJECT NO. 12-24

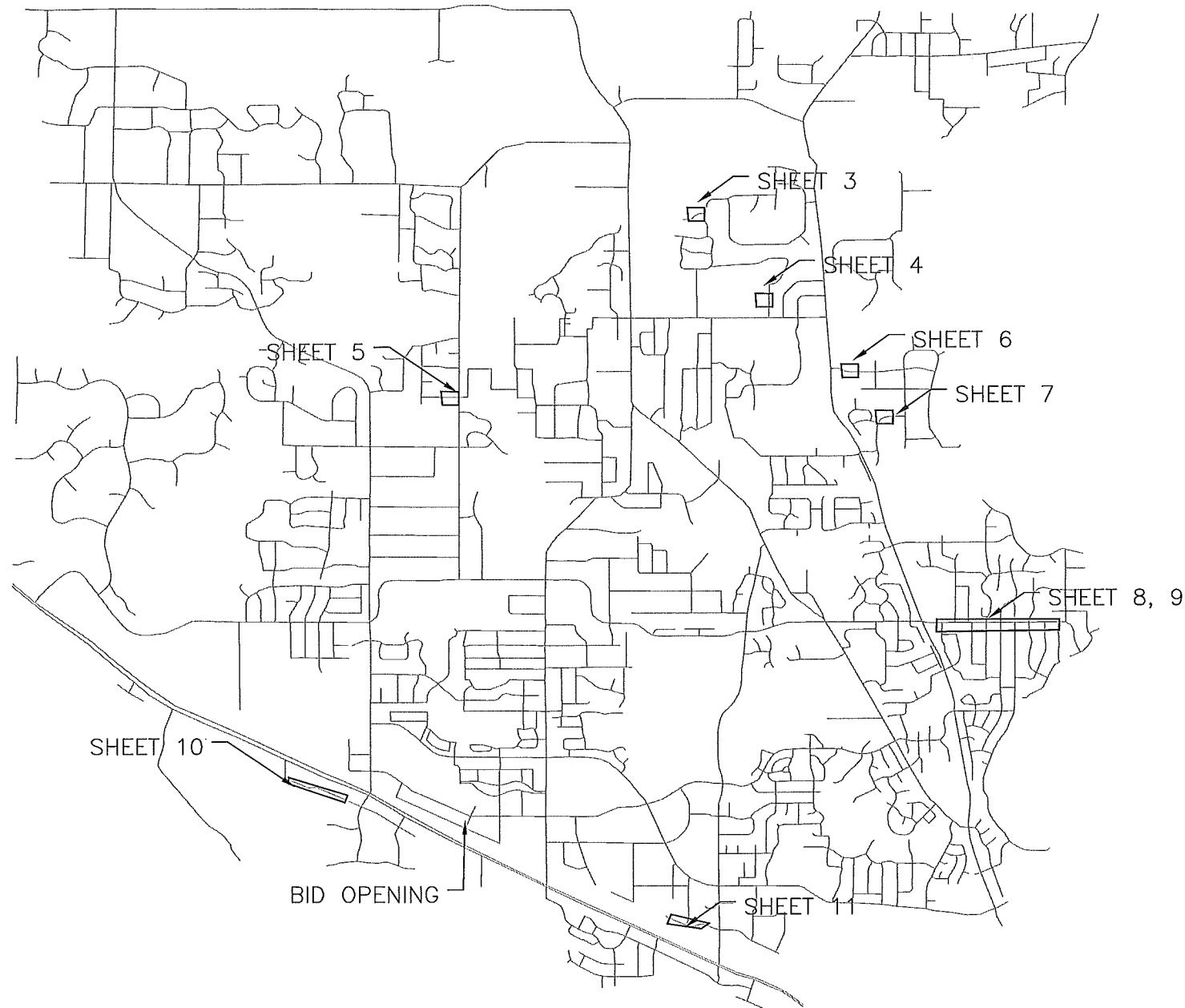

**GOVERNING SPECIFICATIONS**  
THE 2005 EDITION OF THE MINNESOTA DEPARTMENT OF TRANSPORTATION "STANDARD SPECIFICATIONS FOR CONSTRUCTION" SHALL APPLY.

ALL FEDERAL, STATE AND LOCAL LAWS, REGULATIONS AND ORDINANCES SHALL BE COMPLIED WITH IN THE CONSTRUCTION OF THIS PROJECT.

ALL TRAFFIC CONTROL DEVICES AND SIGNING SHALL CONFORM TO THE MINNESOTA MANUAL ON UNIFORM TRAFFIC CONTROL DEVICES, INCLUDING THE FIELD MANUAL FOR TEMPORARY TRAFFIC CONTROL ZONE LAYOUTS.

Sheet List Table

Sheet Number	Sheet Title
1	CULVERT REPLACEMENT PROJECT
2	DETAILS
3	6453 171ST LANE
4	16756 SODIUM STREET
5	7600 163RD LANE
6	5810 164th Lane
7	5604 162ND LANE
8	ALPINE DRIVE CATCH BASINS
9	ALPINE DRIVE CATCHBASINS
10	RIVERDALE DRIVE CATCH BASIN REPAIR
11	MCKINLEY STREET CATCH BASIN REPAIR



Call before you dig  
811  
651 454-0002 Metro  
800 252-1166 Outstate  
www.gopherstateonecall.org



**CITY OF RAMSEY**  
7550 SUNWOOD DRIVE  
RAMSEY, MN 55303  
(763) 427-1410 FAX (763) 433-9898

I hereby certify that this plan, specification, or report was prepared by me or under my direct supervision and that I am a duly Licensed Professional Engineer under the laws of the State of Minnesota.  
*Leonard E. Einton*  
LEONARD E. EINTON Lic. No. 21112

Date 5/7/12