

# City of Ramsey North Commons Park

Proposal # 100-72756-3  
December 28, 2012

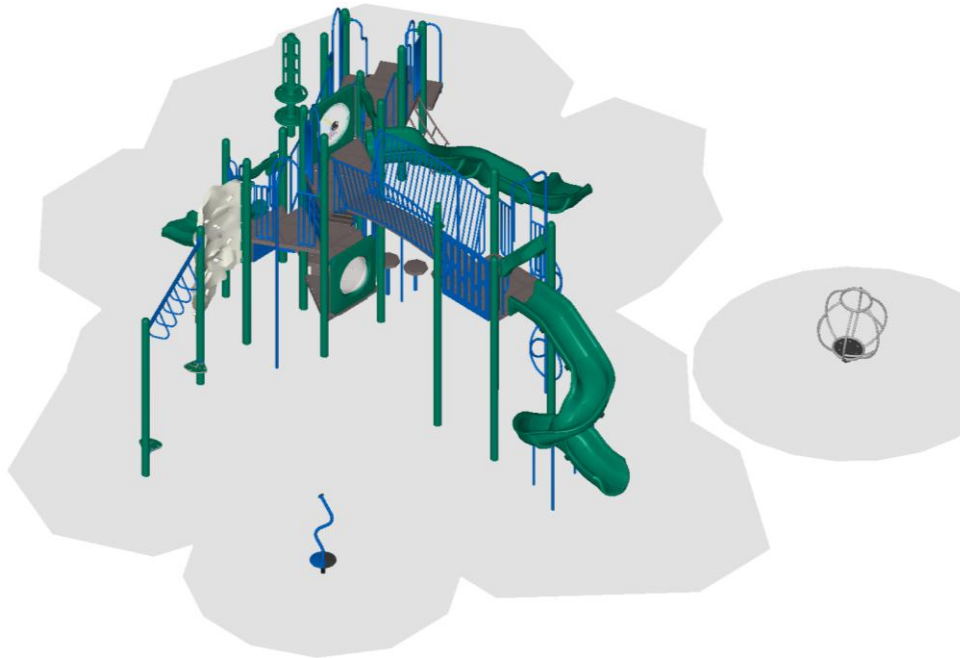

Presented by  
**St. Croix Recreation Company, Inc.**  
and





December 28, 2012

Mark Riverblood  
City of Ramsey  
14100 Jasper Street NW  
Ramsey, MN 55303

Dear Mark Riverblood:

St. Croix Recreation Company, Inc. is delighted to provide City of Ramsey with this playground equipment proposal.

This design was developed with your specific needs in mind, and we look forward to discussing this project further with you to ensure your complete satisfaction. St. Croix Recreation Company, Inc. is confident that this proposal will satisfy City of Ramsey's functional, environmental, and safety requirements -- and most importantly -- bring joy and excitement to the children and families directly benefiting from your new playground.

You have our personal commitment to support this project and your organization in every manner possible, and we look forward to continue developing a long-standing relationship with City of Ramsey. We appreciate your consideration and value this opportunity to earn your business.

Sincerely,

Mike Basich  
St. Croix Recreation Company, Inc.  
225 N. Second Street  
Stillwater, MN 55082

## **Design Summary**

St. Croix Recreation Company, Inc. is very pleased to present this Proposal for consideration for the North Commons Park located in Ramsey. BCI Burke Company, LLC has been providing recreational playground equipment for over 90 years and has developed the right mix of world-class capabilities to meet the initial and continuing needs of City of Ramsey. We believe our proposal will meet or exceed your project's requirements and will deliver the greatest value to you.

The following is a summary of some of the key elements of our Proposal:

- Project Name: North Commons Park
- Project Number: 100-72756-3
- User Capacity: 90
- Age Groups: Ages 5-12 years
- Dimensions: 48' 4" x 46' 6"
- Designer Name: Kari Champeau

St. Croix Recreation Company, Inc. has developed a custom playground configuration based on the requirements as they have been presented for the North Commons Park playground project. Our custom design will provide a safe and affordable playground environment that is aesthetically pleasing, full of fun for all users and uniquely satisfies your specific requirements. In addition, proposal # 100-72756-3 has been designed with a focus on safety, and is fully compliant with ASTM F1487 and CPSC playground safety standards.

We invite you to review this proposal for the North Commons Park playground project and to contact us with any questions that you may have.

Thank you in advance for giving us the opportunity to make this project a success.

INFORMATION  
MINIMUM FALL ZONE  
SURFACED WITH  
RESILIENT MATERIAL  
AREA

1625 SQ.FT.  
PERIMETER  
218 FT.

STRUCTURE SIZE  
48' 4" x 46' 6"

STRUCTURE IS DESIGNED  
FOR CHILDREN AGES:

- 6-23 MONTH OLDS
- 2-5 YEAR OLDS
- 5-12 YEAR OLDS
- 13 + YEAR OLDS



To verify product certification,  
visit [www.ipema.org](http://www.ipema.org)

The play components identified  
in this plan are IPEMA  
certified. The use and layout of  
these components conform to the  
requirements of ASTM F1487.  
To verify product certification,  
visit [www.ipema.org](http://www.ipema.org)

The space requirements shown  
here are to ASTM standards.  
Requirements for other standards  
may be different.

The use and layout of play  
components identified in this plan  
conform to the CPSC guidelines.

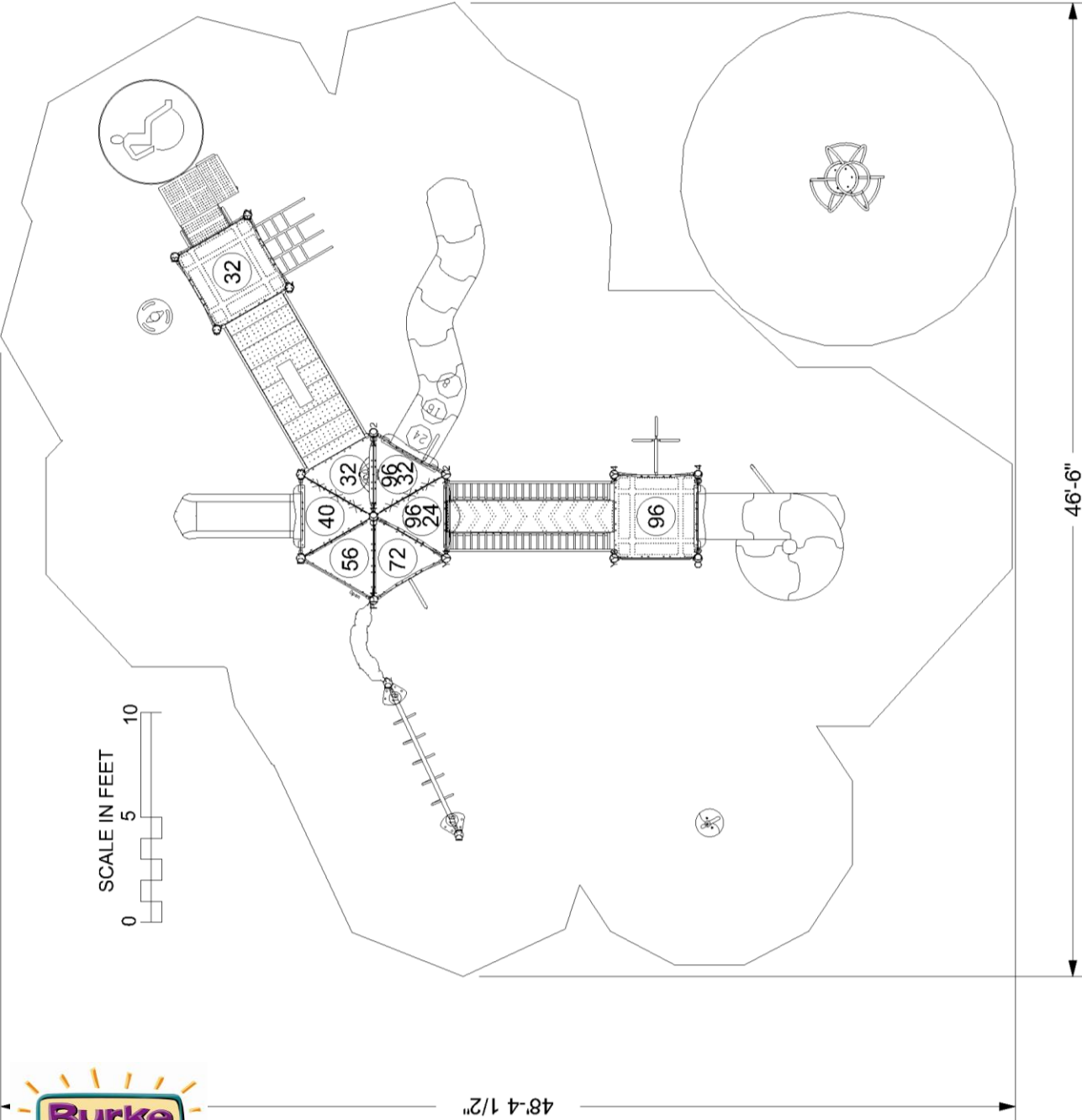

**WARNING!**

ACCESSIBLE SAFETY SURFACING MATERIAL IS REQUIRED BENEATH  
AND AROUND THIS EQUIPMENT.  
FOR SLIDE FALL ZONE SURFACING AREA SEE CPSC's Handbook for  
Public Playground Safety.  
PLATFORM HEIGHTS ARE IN INCHES ABOVE RESILIENT MATERIAL.

**ADA ACCESSIBILITY GUIDELINE (ADAAG CONFORMANCE)**

NUMBER OF PLAY EVENTS:	18	RECD:	0
NUMBER OF ELEVATED PLAY EVENTS:	11	PROVIDED:	0
NUMBER OF ELEVATED PLAY EVENTS ACCESSIBLE BY RAMP:	4	PROVIDED:	4
NUMBER OF ELEVATED PLAY EVENTS ACCESSIBLE BY TRANSFER SYSTEM:	4	PROVIDED:	6
NUMBER OF ELEVATED PLAY EVENTS ACCESSIBLE BY RAMP OR TRANSFER SYSTEM:	7	PROVIDED:	4
NUMBER OF GROUND LEVEL PLAY EVENTS:	5	RECD:	3
NUMBER OF TYPES OF GROUND LEVEL PLAY EVENTS:	5	PROVIDED:	3



SERIES: Basics, Intensity, Nucleus  
SITE PLAN  
DRAWN BY: Kari Champeau

North Commons Park  
7695 147th Lane NW  
Ramsey, MN 55303

St. Croix Recreation Company, Inc.  
100-72756-3

ITEM	COMP.	DESCRIPTION
1	270-0001	OFFSET ENCLOSURE
2	270-0050	8" CLOSURE PLATE
3	270-0109	PLATFORM LADDER 24"
4	270-0129	TRIANGLE PLATFORM
5	270-0130	SQUARE PLATFORM
6	270-0185	PLATFORM LADDER 16"
7	270-0188	LONG BUCKLE BRIDGE W/GUJAR
8	270-0219	ARCHED CATWALK BRIDGE 96"
9	370-0027	LAUNCH PAD
10	370-0154	SLIDING POLE 56"-72"
11	370-0229	CARGO NET 32"-40"
12	370-0270	POD WALK 32"
13	370-0300	TREE CLIMBER 32"
14	370-0557	LINKING RING CLIMBER 80" 96"
15	370-0710	TRIANGLE TRAVERSE
16	370-0718	TRANSFER STATION, HANDRAIL
17	470-0507	ROCK'N ROLL SLIDE, 40" - 48"
18	470-0552	VIPER S 96
19	470-0557	VIPER SPIRAL 96
20	560-0457	SWIFT TWIST SPINNER
21	560-0542	ROCKIT CURVED PANEL
22	560-2571	COMET II
23	570-1550	BARRIER PANEL
24	570-1566	PADDLE BALL PANEL
25	570-1602	BUBBLE WINDOW PANEL
26	660-0137	ROCKIT ATTACHMENT POST 55

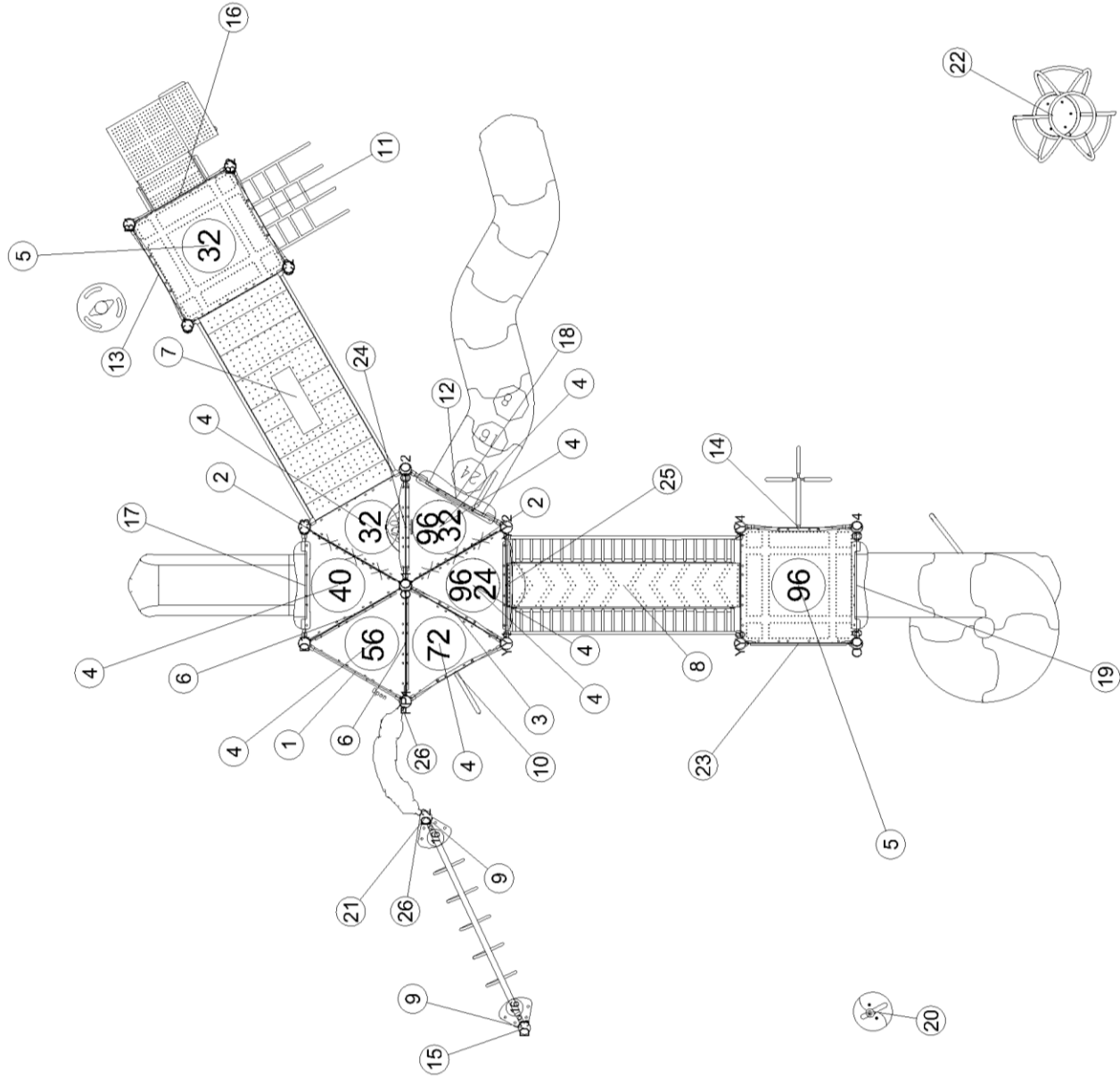

December 28, 2012

SERIES: Basics, Intensity, Nucleus  
 COMPONENT PLAN  
 DRAWN BY: Kari Champeau

North Commons Park  
 7695 147th Lane NW  
 Ramsey, MN 55303

St. Croix Recreation Company, Inc.  
 100-72756-3

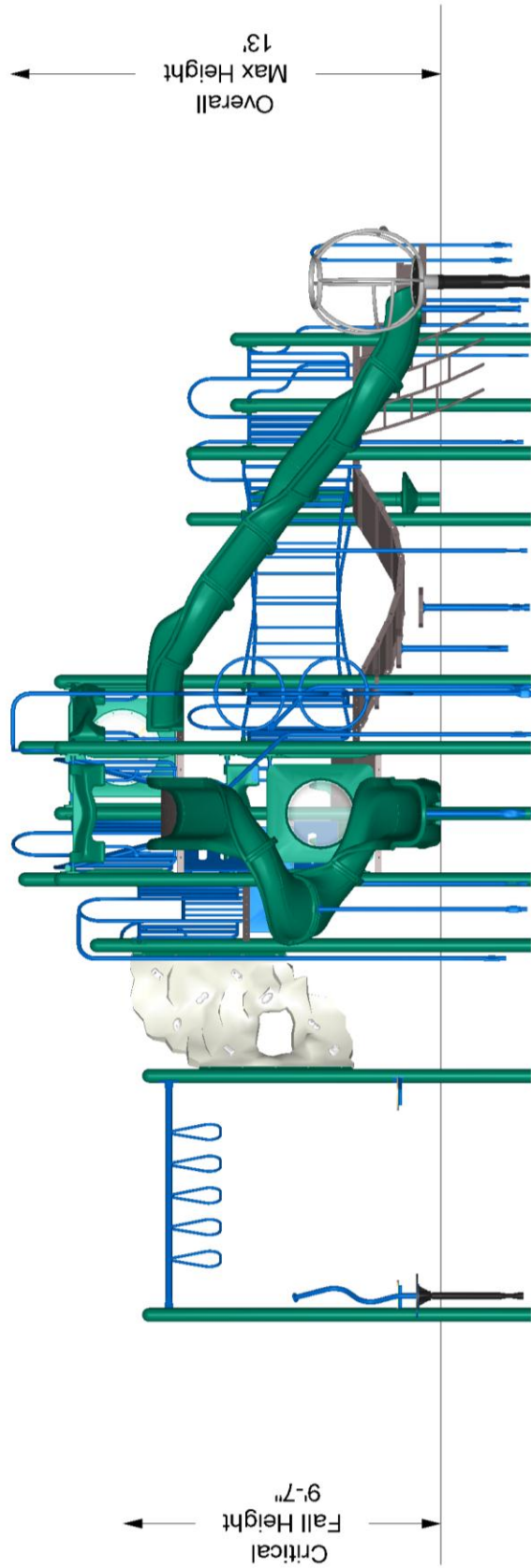

The protective surfacing for this design must accommodate the critical fall height.



December 28, 2012

SERIES: Basics, Intensity, Nucleus  
 ELEVATION PLAN  
 DRAWN BY: Kari Champeau

North Commons Park  
 7695 147th Lane NW  
 Ramsey, MN 55303

St. Croix Recreation Company, Inc.  
 100-72756-3

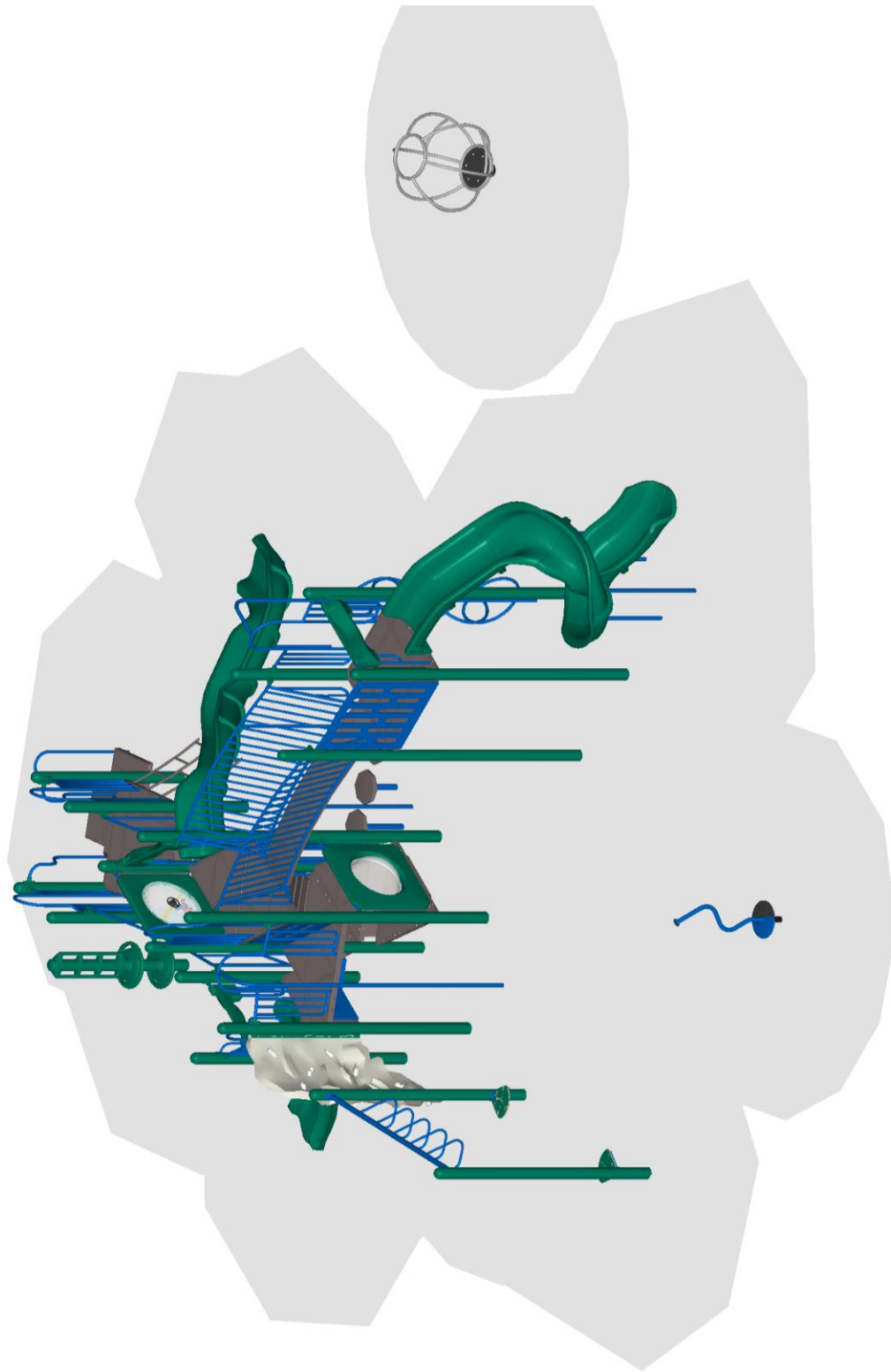

December 28, 2012

SERIES: Basics, Intensity, Nucleus

North Commons Park

St. Croix Recreation Company, Inc.

ISOMETRIC PLAN

7695 147th Lane NW

100-72756-3

DRAWN BY: Kari Champeau

Ramsey, MN 55303

BCI Burke Company, LLC PO Box 549 Fond du Lac, Wisconsin 54936-0549 Telephone 920-921-9220



# Proposal # 100-72756-3

December 28, 2012  
2013 Pricing

**Proposal Prepared for:**

Mark Riverblood  
Inc.  
City of Ramsey  
14100 Jasper Street NW  
Ramsey, MN 55303  
Phone: 763-238-1733

**Project Location:**

North Commons Park  
  
7695 147th Lane NW  
Ramsey, MN 55303

**Proposal Prepared by:**

St. Croix Recreation Company,  
  
225 N. Second Street  
Stillwater, MN 55082  
Phone: 651-430-1247  
Fax: 651-430-9231  
jj@stcroixrec.com

Mike Basich  
Phone: 651-430-1247  
Fax: 651-430-9231  
mb@stcroixrec.com

Component No.	Description	Qty.	User Cap.	Ext. User Cap.	Weight	Ext. Weight
Burke Basics						
560-0457	SWIFT TWIST SPINNER	1	1	1	52	52
560-2571	COMET II	1	6	6	149	149
Intensity						
370-0027	LAUNCH PAD	2	1	2	9	18
370-0710	TRIANGLE TRAVERSE	1	2	2	40	40
Nucleus						
270-0001	OFFSET ENCLOSURE	1	1	1	30	30
270-0050	8" CLOSURE PLATE	2	0	0	9	18
270-0109	PLATFORM LADDER 24"	1	1	1	65	65
270-0129	TRIANGLE PLATFORM	8	2	16	47	376
270-0130	SQUARE PLATFORM	2	6	12	105	210
270-0185	PLATFORM LADDER 16"	2	1	2	10	20
270-0188	LONG BUCKLE BRIDGE W/GUARDRAIL...	1	10	10	316	316
270-0219	ARCHED CATWALK BRIDGE 96"	1	6	6	368	368
370-0154	SLIDING POLE 56"-72"	1	1	1	59	59
370-0229	CARGO NET 32"-40"	1	2	2	60	60
370-0270	POD WALK 32"	1	3	3	124	124
370-0300	TREE CLIMBER 32"	1	2	2	105	105
370-0557	LINKING RING CLIMBER 80"-96"	1	4	4	100	100
370-0718	TRANSFER STATION, HANDRAIL 32"	1	4	4	162	162
470-0507	ROCK'N ROLL SLIDE, 40" - 48"	1	1	1	107	107
470-0552	VIPER S 96	1	4	4	248	248
470-0557	VIPER SPIRAL 96	1	4	4	301	301
570-1550	BARRIER PANEL	1	0	0	30	30
570-1566	PADDLE BALL PANEL	1	1	1	47	47
570-1602	BUBBLE WINDOW PANEL	1	1	1	40	40
600-0104	NPPS SUPERVISION SAFETY KIT	1	0	0	3	3
670-0002	POST ASSEMBLY 5" OD X 107"	2	0	0	58	116
670-0098	MODULAR HARDWARE, NUCLEUS	1	0	0	5	5
670-0099	INSTALLATION KIT, INTENSITY	1	0	0	2	2
670-0103	MAINTENANCE KIT, INTENSITY	1	0	0	0	0
670-0158	POST ASSEMBLY 5" OD X 184"	4	0	0	97	388
670-0165	POST ASSEMBLY 5" OD X 123"	3	0	0	66	198
670-0166	POST ASSEMBLY 5" OD X 139"	3	0	0	74	222



# Proposal # 100-72756-3

December 28, 2012

2013 Pricing

670-0168	POST ASSEMBLY 5" OD X 158"	1	0	0	84	84
670-0169	POST ASSEMBLY 5" OD X 171"	4	0	0	91	364
<b>RockIt</b>						
560-0542	ROCKIT CURVED PANEL	1	4	4	79	79
660-0137	ROCKIT ATTACHMENT POST 55 1/2"	2	0	0	13	26
<b>Swings</b>						
550-0093/0094	SINGLE POST SWING W/SEATS	1	4	4	382	382

Total User Capacity: 94  
 Total Weight: 4,532 lbs.  
 Total Price: \$29,950.00

Information is relative to the Dec 28 2012 4:35AM database.

### Special Notes:

Prices do not include freight, unloading, material storage, site excavation/preparation, removal of existing equipment, removal of excess soil from footing holes, site security, safety surfacing, installation, or sales tax (if applicable). Prices are based on standard colors per CURRENT YEAR BCI Burke Catalog. Custom colors, where available, would be an extra charge. **Pricing is valid for 45 days from the date of this proposal.**

## BCI Burke Generations Warranty™

### The Longest and Strongest warranty in the industry

BCI Burke Company, LLC ("Burke") warrants that all standard products are warranted to be free from defects in materials and workmanship, under normal use and service, for a period of one (1) year from the date of invoice.

### We stand behind our products.

In addition, the following products are warranted, under normal use and service from the date of invoice as follows:

- One Hundred (100) Year Limited Warranty on aluminum and steel upright posts (including Intensity®, Voltage™, Nucleus™ and Little Buddies®) against structural failure due to corrosion, deterioration or workmanship.
- One Hundred (100) Year Limited Warranty on KoreConnect® clamps against structural failure due to corrosion, deterioration or workmanship.
- One Hundred (100) Year Limited Warranty on Hardware (nuts, bolts, washers)
- One Hundred (100) Year Limited Warranty on bolt-through fastening and clamp systems (Voltage™, Intensity® and Nucleus™).
- Twenty-Five (25) Year Limited Warranty on spring assemblies and aluminum cast animals.
- Fifteen (15) Year Limited Warranty on main structure platforms and decks, metal roofs, table tops, bench tops, railings, loops and rungs.
- Fifteen (15) Year Limited Warranty on all plastic components including StoneBorders against structural failure due to materials or workmanship.
- Ten (10) Year Limited Warranty on ShadePlay Canopies fabric, threads, and cables against degradation, cracking or material breakdown resulting from ultra-violet exposure, natural deterioration or manufacturing defects. This warranty is limited to the design loads as stated in the specifications.
- Ten (10) Year Limited Warranty on NaturePlay® Boulders against structural failure due to natural deterioration or workmanship.
- Five (5) Year Limited Warranty on Intensity® cables against premature wear due to natural deterioration or manufacturing defects.
- Five (5) Year Limited Warranty on swing seats and hangers; Kid Koaster® Trolleys and moving parts against structural failure due to materials or workmanship.

The warranty stated above is valid only if the equipment is erected in conformity with the layout plan and/or installation instructions furnished by BCI Burke Company, LLC using approved parts; have been maintained and inspected in accordance with BCI Burke Company, LLC instructions. Burke's liability and your exclusive remedy hereunder will be limited to repair or replacement of those parts found in Burke's reasonable judgment to be defective. Any claim made within the above stated warranty periods must be made promptly after discovery of the defect. A part is covered only for the original warranty period of the applicable part. Replacement parts carry the applicable warranty from the date of shipment of the replacement from Burke. After the expiration of the warranty period, you must pay for all parts, transportation and service charges.

Burke reserves the right to accept or reject any claim in whole or in part. Burke will not accept the return of any product without its prior written approval. Burke will assume transportation charges for shipment of the returned product if it is returned in strict compliance with Burke's written instructions.

**THE FOREGOING WARRANTIES ARE EXCLUSIVE AND IN LIEU OF ANY OTHER WARRANTY, EXPRESS OR IMPLIED, INCLUDING BUT NOT LIMITED TO ANY IMPLIED WARRANTY OR MERCHANTABILITY OR FITNESS FOR A PARTICULAR PURPOSE. IF THE FOREGOING DISCLAIMER OF ADDITIONAL WARRANTIES IS NOT GIVEN FULL FORCE AND EFFECT, ANY RESULTING ADDITIONAL WARRANTY SHALL BE LIMITED IN DURATION TO THE EXPRESS WARRANTIES AND BE OTHERWISE SUBJECT TO AND LIMITED BY THE TERMS OF BURKE'S PRODUCT WARRANTY. SOME STATES DO NOT ALLOW THE EXCLUSION OF CERTAIN IMPLIED WARRANTIES, SO THE ABOVE LIMITATION MAY NOT APPLY TO YOU.**

**Warranty Exclusions:** The above stated warranties do not cover: "cosmetic" defects, such as scratches, dents, marring, or fading; damage due to incorrect installation, vandalism, misuse, accident, wear and tear from normal use, exposure to extreme weather; immersion in salt or chlorine water, unauthorized repair or modification, abnormal use, lack of maintenance, or other cause not within Burke's control; and

**Limitation of Remedies:** Burke is not liable for consequential or incidental damages, including but not limited to labor costs or lost profits resulting from the use of or inability to use the products or from the products being incorporated in or becoming a component of any other product. If, after a reasonable number of repeated efforts, Burke is unable to repair or replace a defective or nonconforming product, Burke shall have the option to accept return of the product, or part thereof, if such does not substantially impair its value, and return the purchase price as the buyer's entire and exclusive remedy. Without limiting the generality of the foregoing, Burke will not be responsible for labor costs involved in the removal of products or the installation of replacement products. Some states do not allow the exclusion of incidental damages, so the above exclusion may not apply to you.

For more information regarding the warranty, call Customer Service at 920-921-9220 or 1-800-356-2070.