

SITE PLAN

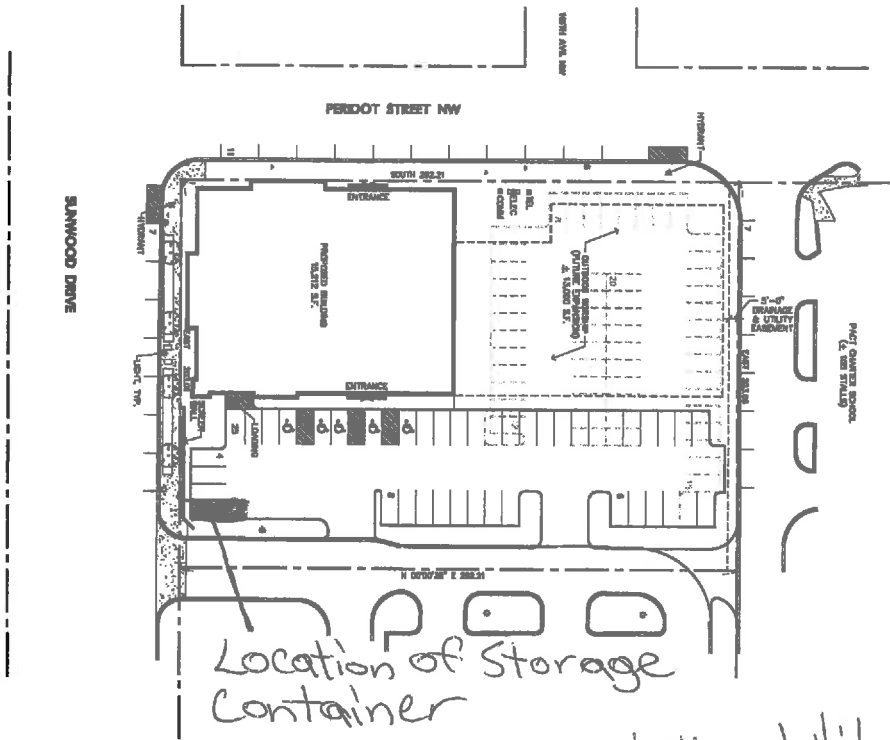

We request the ability to have a Storage Container on Northgate Church property. To alleviate congestion in the Storage rooms of the Church. This will happen from May 22, 2015 to June 15, 2015 for the production of Peter Pan.

NO.	DESCRIPTION	DATE	BY
1	ISSUED FOR PERMITS	4/20/15	W. SKAFF
2	ISSUED FOR PERMITS	4/20/15	W. SKAFF
3	ISSUED FOR PERMITS	4/20/15	W. SKAFF
4	ISSUED FOR PERMITS	4/20/15	W. SKAFF
5	ISSUED FOR PERMITS	4/20/15	W. SKAFF
6	ISSUED FOR PERMITS	4/20/15	W. SKAFF
7	ISSUED FOR PERMITS	4/20/15	W. SKAFF
8	ISSUED FOR PERMITS	4/20/15	W. SKAFF
9	ISSUED FOR PERMITS	4/20/15	W. SKAFF
10	ISSUED FOR PERMITS	4/20/15	W. SKAFF
11	ISSUED FOR PERMITS	4/20/15	W. SKAFF
12	ISSUED FOR PERMITS	4/20/15	W. SKAFF
13	ISSUED FOR PERMITS	4/20/15	W. SKAFF
14	ISSUED FOR PERMITS	4/20/15	W. SKAFF
15	ISSUED FOR PERMITS	4/20/15	W. SKAFF
16	ISSUED FOR PERMITS	4/20/15	W. SKAFF
17	ISSUED FOR PERMITS	4/20/15	W. SKAFF
18	ISSUED FOR PERMITS	4/20/15	W. SKAFF
19	ISSUED FOR PERMITS	4/20/15	W. SKAFF
20	ISSUED FOR PERMITS	4/20/15	W. SKAFF
21	ISSUED FOR PERMITS	4/20/15	W. SKAFF
22	ISSUED FOR PERMITS	4/20/15	W. SKAFF
23	ISSUED FOR PERMITS	4/20/15	W. SKAFF
24	ISSUED FOR PERMITS	4/20/15	W. SKAFF
25	ISSUED FOR PERMITS	4/20/15	W. SKAFF
26	ISSUED FOR PERMITS	4/20/15	W. SKAFF
27	ISSUED FOR PERMITS	4/20/15	W. SKAFF
28	ISSUED FOR PERMITS	4/20/15	W. SKAFF
29	ISSUED FOR PERMITS	4/20/15	W. SKAFF
30	ISSUED FOR PERMITS	4/20/15	W. SKAFF
31	ISSUED FOR PERMITS	4/20/15	W. SKAFF
32	ISSUED FOR PERMITS	4/20/15	W. SKAFF
33	ISSUED FOR PERMITS	4/20/15	W. SKAFF
34	ISSUED FOR PERMITS	4/20/15	W. SKAFF
35	ISSUED FOR PERMITS	4/20/15	W. SKAFF
36	ISSUED FOR PERMITS	4/20/15	W. SKAFF
37	ISSUED FOR PERMITS	4/20/15	W. SKAFF
38	ISSUED FOR PERMITS	4/20/15	W. SKAFF
39	ISSUED FOR PERMITS	4/20/15	W. SKAFF
40	ISSUED FOR PERMITS	4/20/15	W. SKAFF
41	ISSUED FOR PERMITS	4/20/15	W. SKAFF
42	ISSUED FOR PERMITS	4/20/15	W. SKAFF
43	ISSUED FOR PERMITS	4/20/15	W. SKAFF
44	ISSUED FOR PERMITS	4/20/15	W. SKAFF
45	ISSUED FOR PERMITS	4/20/15	W. SKAFF
46	ISSUED FOR PERMITS	4/20/15	W. SKAFF
47	ISSUED FOR PERMITS	4/20/15	W. SKAFF
48	ISSUED FOR PERMITS	4/20/15	W. SKAFF
49	ISSUED FOR PERMITS	4/20/15	W. SKAFF
50	ISSUED FOR PERMITS	4/20/15	W. SKAFF

Wayne Skaff
 WAYNE SKAFF
 EXEC. PASTOR
 NORTHGATE CHURCH
 4/20/15

Brian Aldinger
 Board member
 Northern Starz
 Children's theatre