



From: **Chris Barta** Chris@franklinoutdoor.com
Subject: **Digital Specs**
Date: **April 30, 2015 at 9:19 AM**
To: **countrysideservices@yahoo.com**

Description

- **Display Specifications:**

Cabinet Size - 1'-10.125" H x 13'-11" W x 7" D

Display Size - 1'-6.875" H x 13'-7.75" W

Pixel Pitch - 20

Pixel Type - ~~Red~~ Monochromatic, Grey Scale *Full Color*

Physical Pixel Matrix - 24H x 208W

Physical Pixel Count - 4992

Physical Pixels/Sq Ft - 232.3

LEDs/Sq Ft - 929

Colors Per Pixel - 4-R

Number of Colors - 256

Brightness - 9000 NITS

Viewing Angles - 160° H & 60° V

Character Height - 5.75 ins., 41 Characters/Line, 3 Lines

Viewing Distance - 287.5 ft.

- **Cabinet Specifications:**

1 Primary Sign(s) and 1 Secondary Sign(s)

Front Service w/ Hinged Door

Cabinet Type - Aluminum

Standard Mounting

Cabinet Color - Black

Approximate Weight - 216 lbs. **(per face)**

- **Electrical Specifications: (per face)**

Max. Total Watts - 998 W, Max. Watts/Pixel - 0.2 W, Max. Total Amps - 8.32 A

Avg. Total Watts - 329 W, Avg. Watts/Pixel - 0.07 W, Avg. Total Amps - 2.75 A

* Power to each sign face must meet NEC requirements.

- **Included Options:**

Prime Vue Control Operating System

Phone Support

64-bit Processing

1 Wireless RF Bridge Set(s)

Parts Warranty - 5 Years

Labor Warranty - 5 Years

Temperature Probe

Photocell

- **Comments:**

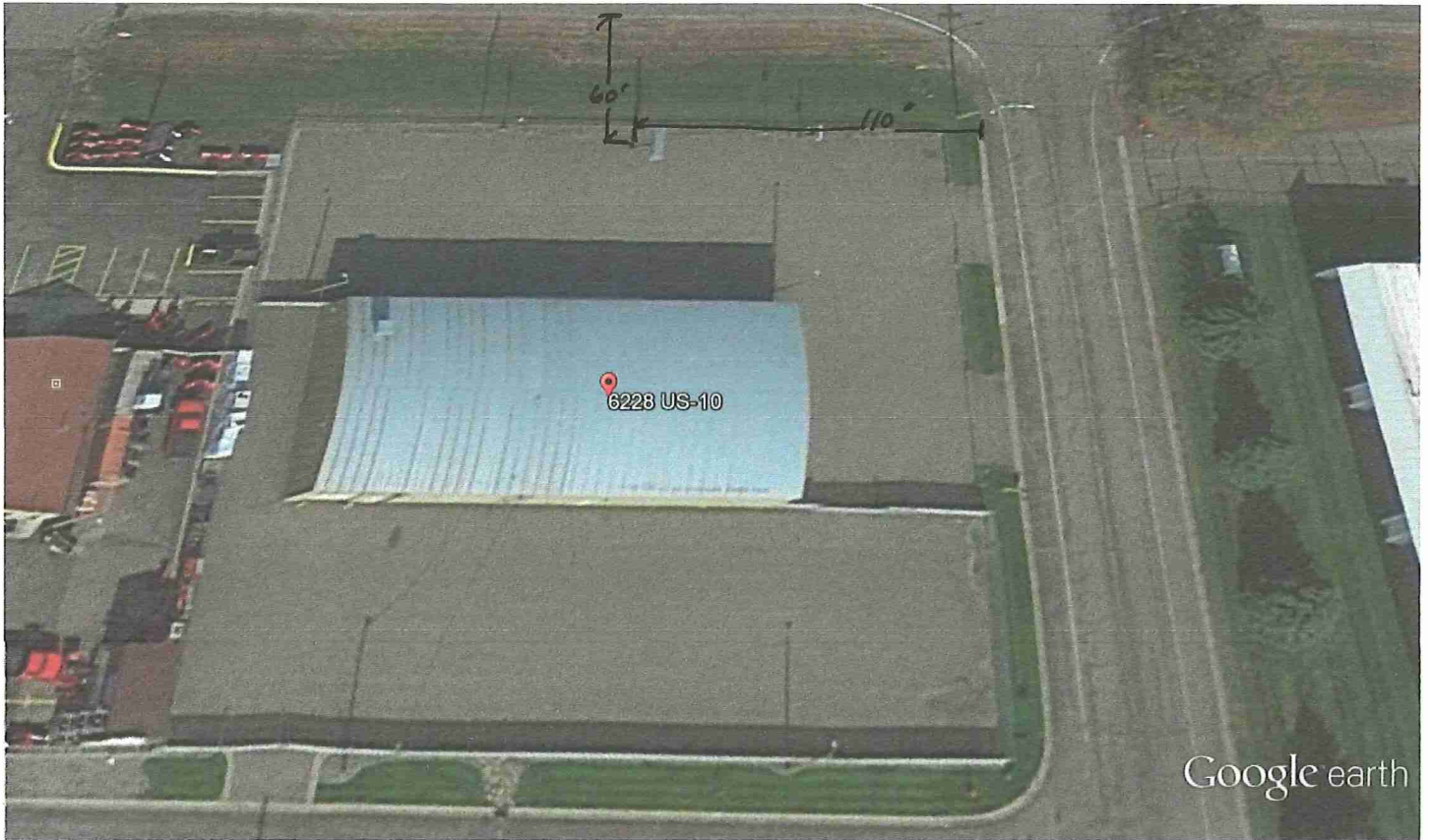

Google earth

feet
meters

100

50

