

Critical Physical Adjacencies:

- Staff break room

Finishes:

- Painted Gyp Bd wall finish
- Acoustic ceiling tile

Other Requirements:

- Room identification signage
- Windows preferred

In-contract Systems and Equipment:

- Operable partition wall

Separate-contract Systems and Equipment:

-

Owner-supplied Systems and Equipment:

- TV display monitor
- White Board

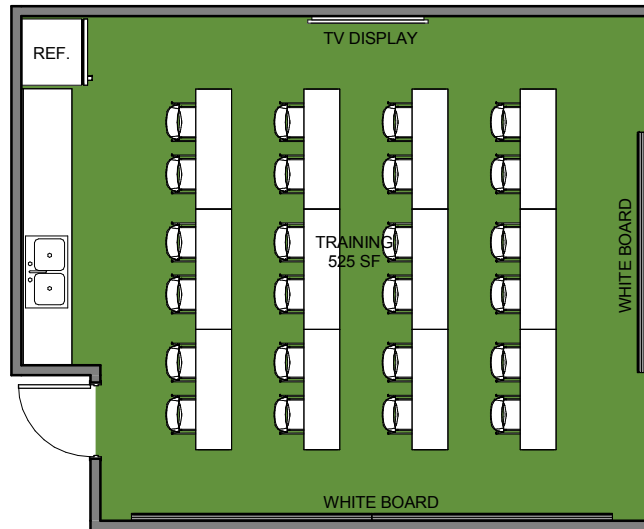

Critical Physical Adjacencies:

-

Finishes:

- Suspended acoustical tile ceiling
- Textured and painted gypsum board walls
- No chair rail required
- Rubber wall base
- Vinyl tile floor

Other Requirements:

- Room identification signage
- Windows preferred, not operable
- Acoustic separation, STC 65

In-contract Systems and Equipment:

- Data and power at walls
- Public address speaker at ceiling
- Direct/indirect lighting with occupancy sensor and override
- Dedicated VAV with CO2 sensor demand ventilation

Separate-contract Systems and Equipment:

- Tables
- Task chairs, rolling
- 3 Markerboards (120"x48")

Owner-supplied Systems and Equipment:

- CPU, mouse, keyboard, webcam, 60" monitor
- Conference phone
- Trash and recycle bins

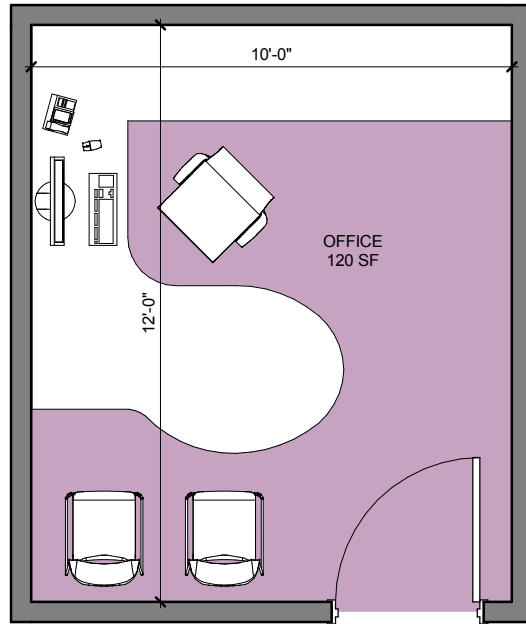

Critical Physical Adjacencies:

- Reception

Finishes:

- Suspended acoustical tile ceiling
- Textured and painted gypsum board walls
- No chair rail required
- Rubber wall base
- Carpet tile floor

Other Requirements:

- Room identification signage
- Windows preferred, not operable
- Acoustic separation, STC 65

In-contract Systems and Equipment:

- Data and power at walls
- Public address speaker at ceiling
- Direct/indirect lighting with occupancy sensor and override
- Dedicated VAV with CO2 sensor demand ventilation

Separate-contract Systems and Equipment:

- Workstation
- 1 work chair, 2 side chairs

Owner-supplied Systems and Equipment:

- CPU, mouse, keyboard, webcam, 60" monitor
- Workstation phone
- Trash and recycle bins

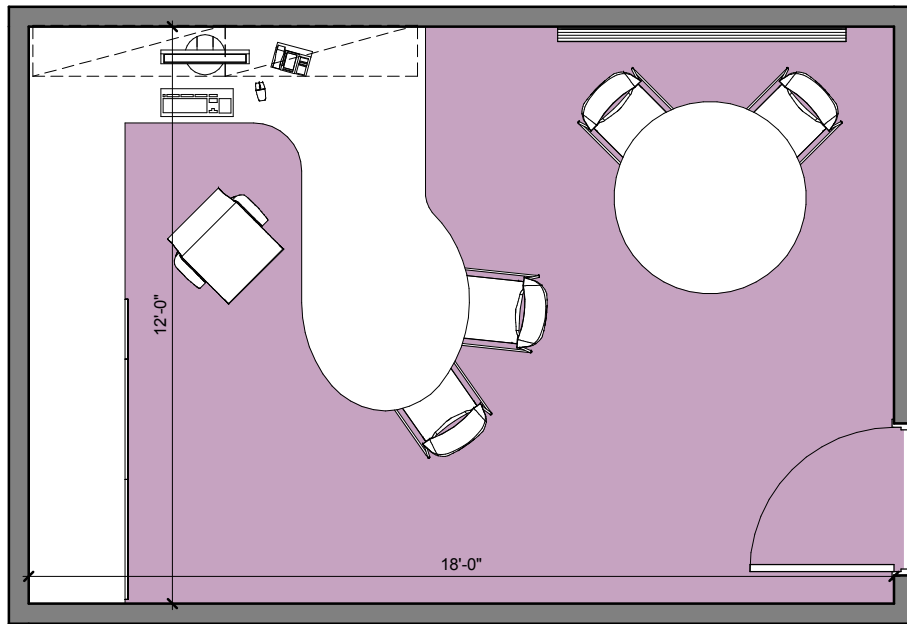

Critical Physical Adjacencies:

- Reception
- Copy Room

Finishes:

- Suspended acoustical tile ceiling
- Textured and painted gypsum board walls
- No chair rail required
- Rubber wall base
- Carpet tile floor

Other Requirements:

- Room identification signage
- Windows preferred, not operable
- Acoustic separation, STC 65

In-contract Systems and Equipment:

- Data and power at walls and table center
- Public address speaker at ceiling
- Direct/indirect lighting with occupancy sensor and override
- Dedicated VAV with CO2 sensor demand ventilation

Separate-contract Systems and Equipment:

- Workstation
- 1 work chair, 4 side chairs
- 1 round conference table

Owner-supplied Systems and Equipment:

- CPU, mouse, keyboard, webcam, monitor
- Workstation phone
- Trash and recycle bins

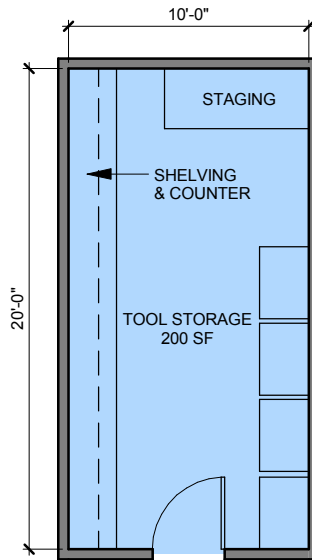

Critical Physical Adjacencies:

- Adjacent to shops area

Finishes:

- Durable wall and floor finishes
- Sealed concrete floor
- Painted CMU/Masonry wall finishes
- Exposed ceiling structure

Other Requirements:

- Room identification signage

In-contract Systems and Equipment:

- Power at walls and work tables

Separate-contract Systems and Equipment:

- Compressed air supply

Owner-supplied Systems and Equipment:

- Shelving
- Work tables

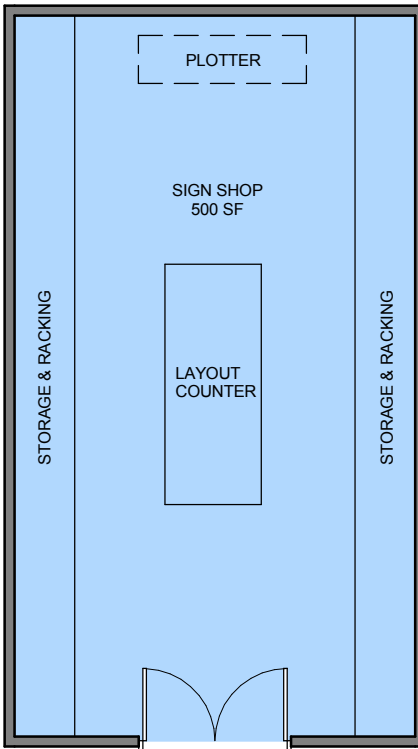

Critical Physical Adjacencies:

- Access to exterior for loading/unloading materials
- Clean environment

Finishes:

- Durable wall and floor finishes
- Sealed concrete floor
- Painted CMU/Masonry wall finishes
- Exposed ceiling structure

Other Requirements:

- Room identification signage
- Windows preferred, not operable
- 6ft wide min. access door

In-contract Systems and Equipment:

- Power at walls and work tables

Separate-contract Systems and Equipment:

-

Owner-supplied Systems and Equipment:

- Shelving
- Layout Counter
- Plotter

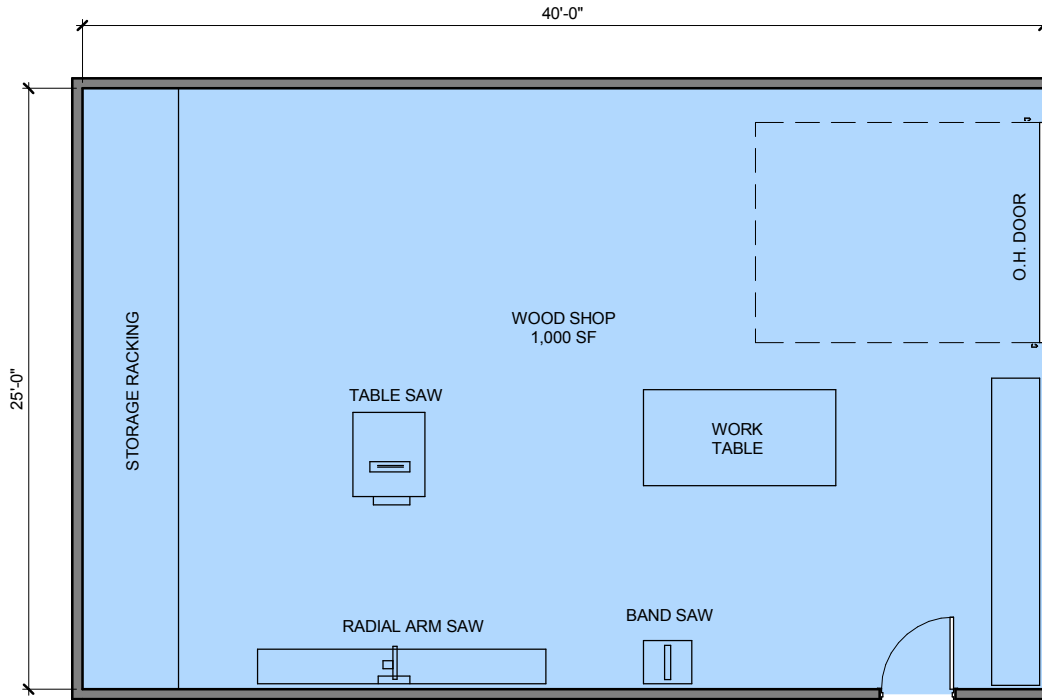

Critical Physical Adjacencies:

- Access to exterior for loading/unloading materials

Finishes:

- Durable wall and floor finishes
- Sealed concrete floor
- Painted CMU/Masonry wall finishes

Other Requirements:

- Room identification signage
- Windows preferred, not operable
- 8ft high min. overhead door for forklift access, preferred

In-contract Systems and Equipment:

- Power at walls and work tables

Separate-contract Systems and Equipment:

- Compressed air supply

Owner-supplied Systems and Equipment:

- Shelving and work tables
- Woodworking equipment
- Dust collection system

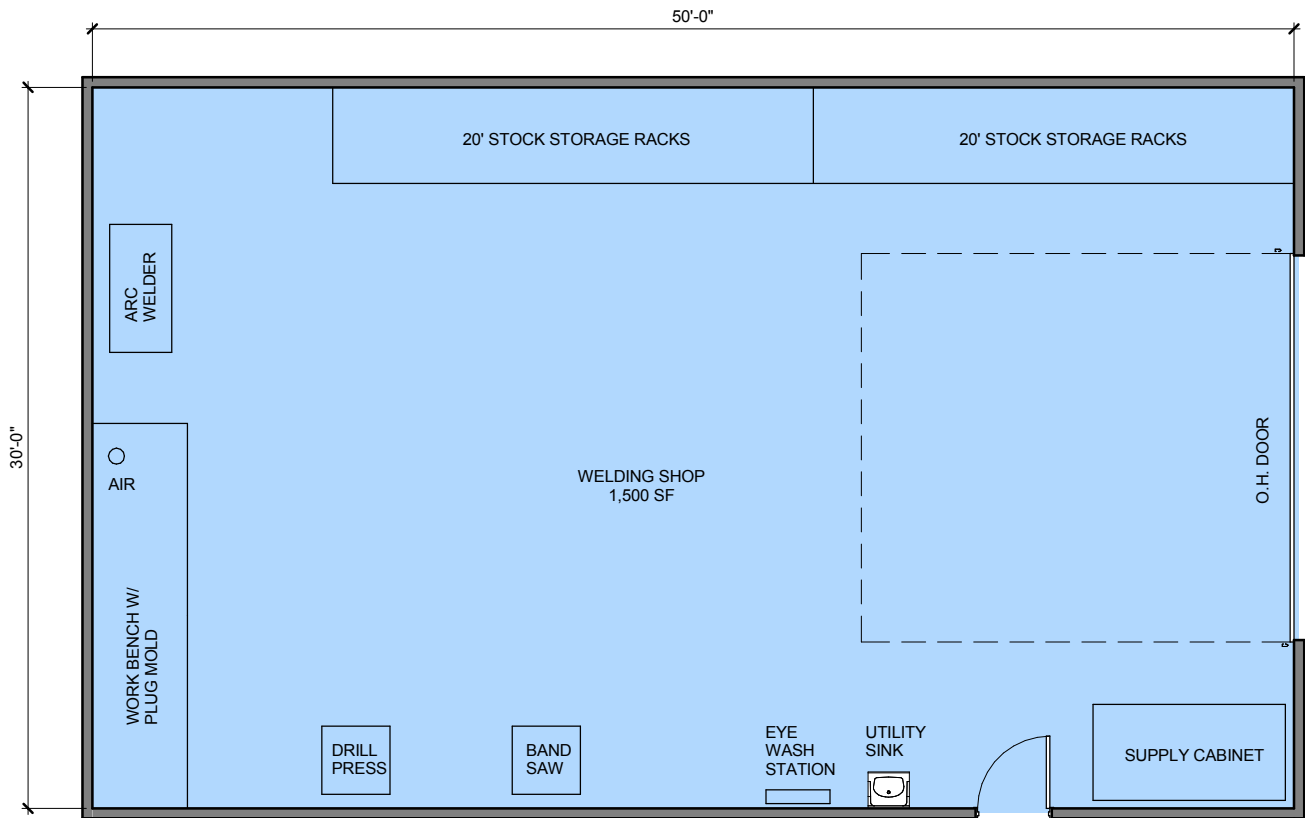

Critical Physical Adjacencies:

- Access to exterior for loading/unloading materials
- Near fleet maintenance bays

Finishes:

- Durable wall and floor finishes
- Sealed concrete floor
- Painted CMU/Masonry wall finishes
- Exposed ceiling structure

Other Requirements:

- Room identification signage
- Windows preferred, not operable
- Overhead door for forklift access, preferred

In-contract Systems and Equipment:

- Power at walls and work tables
- Utility hand sink

Separate-contract Systems and Equipment:

- Compressed air supply
- Eye wash station

Owner-supplied Systems and Equipment:

- Shelving
- Work tables
- Welding equipment (Arc Welder, Band Saw, Drill Press)

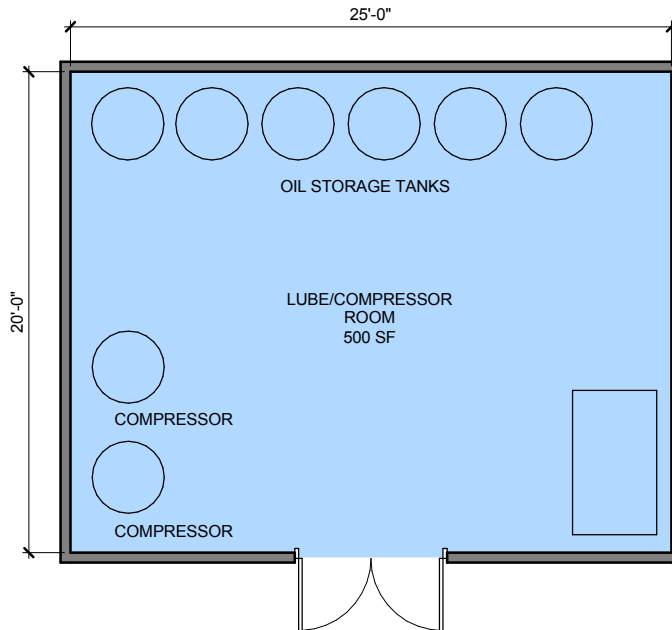

Critical Physical Adjacencies:

- Access to exterior for loading/unloading materials
- Near fleet maintenance bays

Finishes:

- Durable wall and floor finishes
- Sealed concrete floor
- Painted CMU/Masonry wall finishes
- Exposed ceiling structure

Other Requirements:

- Room identification signage
- 6ft wide min. access door, preferred

In-contract Systems and Equipment:

- Power

Separate-contract Systems and Equipment:

- Compressed air supply
- Lube storage system

Owner-supplied Systems and Equipment:

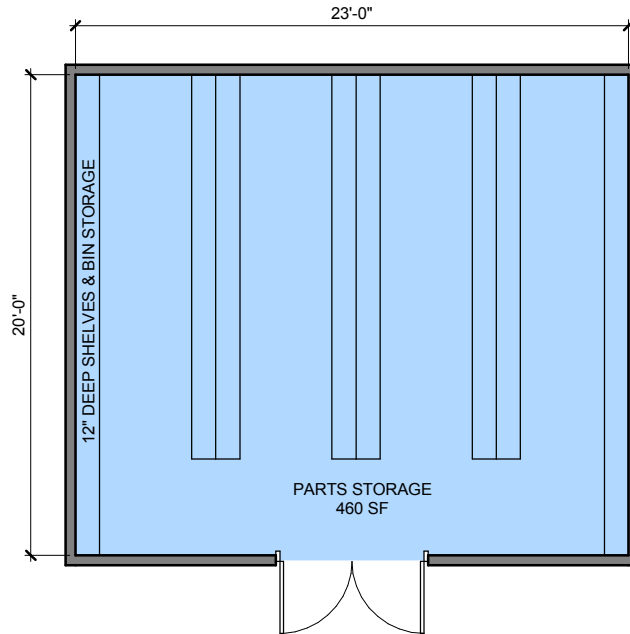

Critical Physical Adjacencies:

- Access to fleet maintenance area

Finishes:

- Durable wall and floor finishes
- Sealed concrete floor
- Painted CMU/Masonry wall finishes
- Exposed ceiling structure

Other Requirements:

- Room identification signage

In-contract Systems and Equipment:

-

Separate-contract Systems and Equipment:

-

Owner-supplied Systems and Equipment:

- Shelving

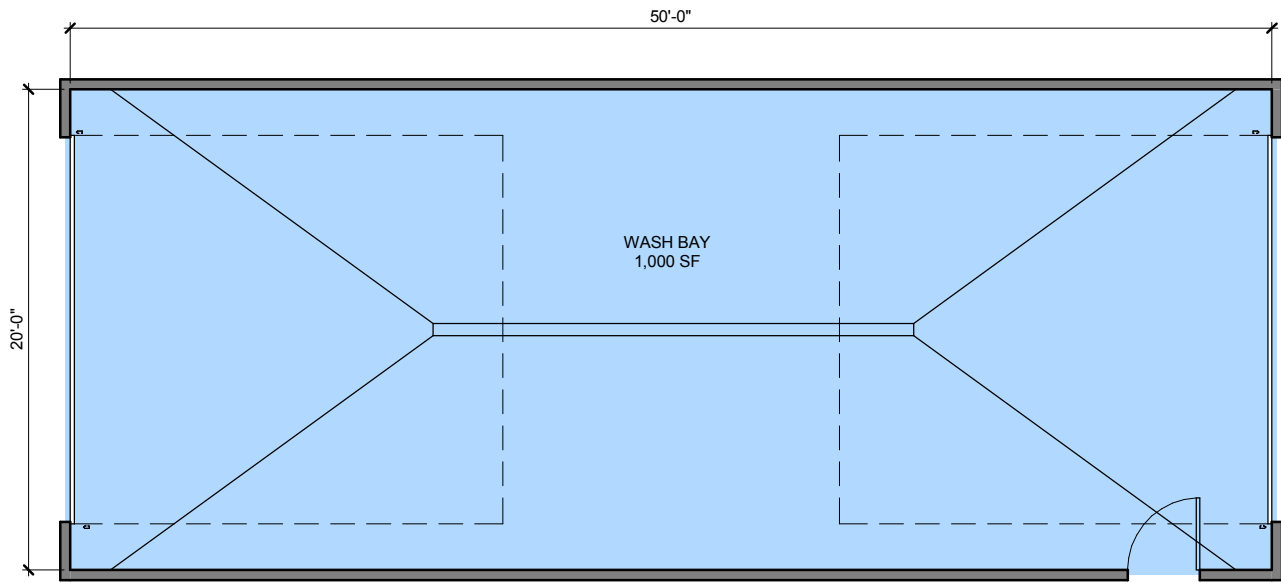

Critical Physical Adjacencies:

- Exterior access door
- Exit into fleet storage

Finishes:

- Durable wall and floor finishes
- Sealed concrete floor
- Painted CMU/Masonry wall finishes
- Exposed ceiling structure

Other Requirements:

- Room identification signage
- Water-proof light fixtures as required
- Floor drain
- (2) Two weatherproof power receptacles

In-contract Systems and Equipment:

-

Separate-contract Systems and Equipment:

- Compressed air supply at two locations

Owner-supplied Systems and Equipment:

- Wash equipment
- Work tables

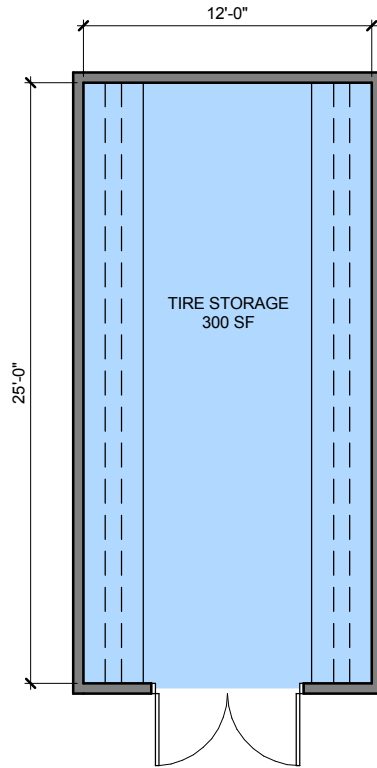

Critical Physical Adjacencies:

- Fleet maintenance bay

Finishes:

- Durable wall and floor finishes
- Sealed concrete floor
- Painted CMU/Masonry wall finishes
- Exposed ceiling structure

Other Requirements:

- Room identification signage
- 6ft wide door for moving carts and materials

In-contract Systems and Equipment:

-

Separate-contract Systems and Equipment:

-

Owner-supplied Systems and Equipment:

- Shelving

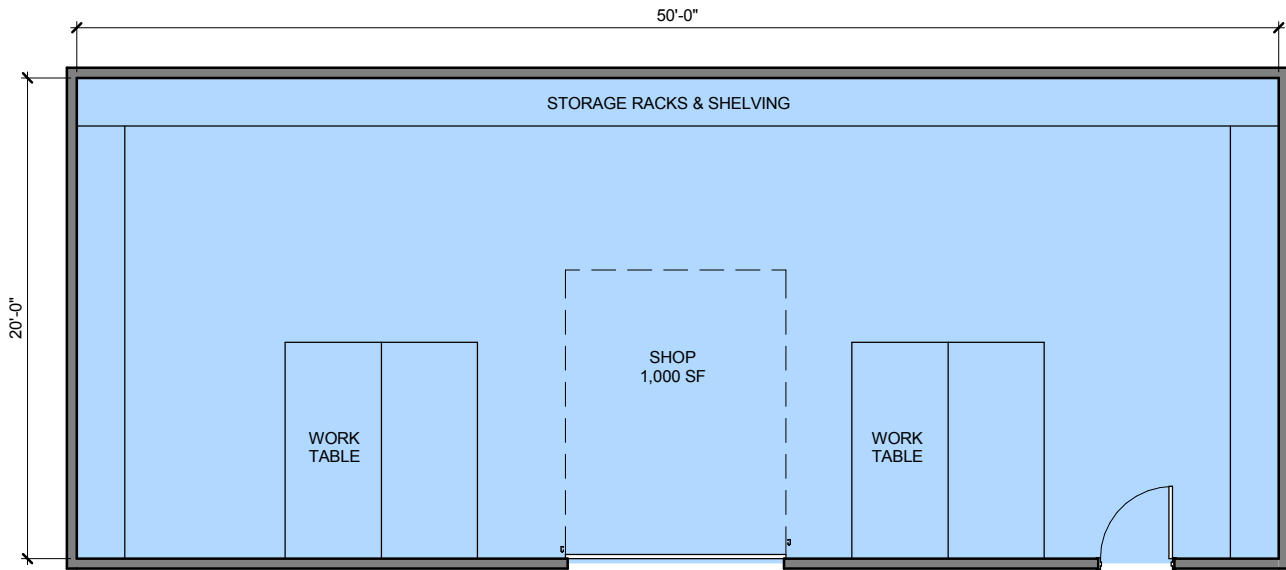

Critical Physical Adjacencies:

- Access to exterior for loading/unloading materials

Finishes:

- Durable wall and floor finishes
- Sealed concrete floor
- Painted CMU/Masonry wall finishes
- Exposed ceiling structure

Other Requirements:

- Room identification signage
- Windows preferred, not operable
- 8ft high min. overhead door for forklift access, preferred

In-contract Systems and Equipment:

- Power at walls and work tables

Separate-contract Systems and Equipment:

- Compressed air supply

Owner-supplied Systems and Equipment:

- Shelving
- Work tables

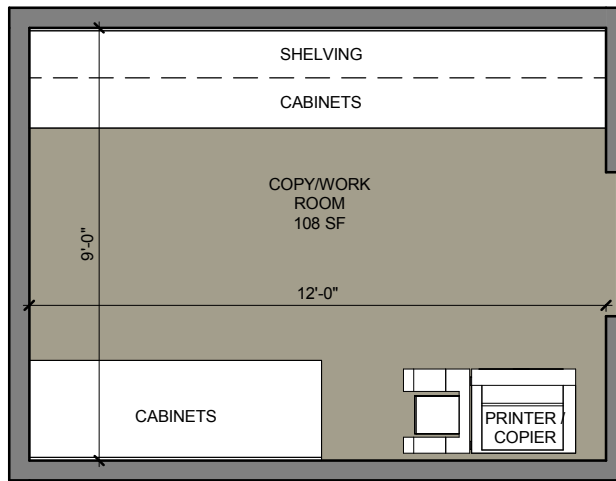

Critical Physical Adjacencies:

- Reception
- Manager's Office

Finishes:

- Suspended acoustical tile ceiling
- Textured and painted gypsum board walls
- No chair rail required
- Rubber wall base
- Carpet tile floor

Other Requirements:

- Room identification signage
- Windows preferred, not operable
- Acoustic separation, STC 65

In-contract Systems and Equipment:

- Data and power at walls and table center
- Public address speaker at ceiling
- Direct/indirect lighting with occupancy sensor and override
- Dedicated VAV with CO2 sensor demand ventilation

Separate-contract Systems and Equipment:

- Cabinets
- Copier / printer

Owner-supplied Systems and Equipment:

- CPU, mouse, keyboard, webcam, 60" monitor
- Conference phone
- Trash and recycle bins