



ELMCREST PARK PLAYGROUND



Elmcrest Park Playground

Request for Proposals- Design Narrative

Responding to RFP Section: "Design Intent for the Playground Equipment and Submittal"

Project Details and Clarification:

Project Timing

- Playground equipment manufacturing lead time is 6 weeks
- Construction will take approx. 3-4 weeks from mobilization to closeout
- Project schedule and completion date will depend on date of order

Site Details and Layout

- We are proposing moving the asphalt path as advised in the RFP (new path location is noted on the drawing)
- Proposed curbing is an 8"x12" concrete curb
- The concrete pad off the building shown in 2-D is not included in pricing but presented as an option to provide a good viewing/picnic area. Pricing can be provided upon request.

Playground equipment

- All posts are 5" diameter. All climbers, posts and metal components are powder coated.
- All decks are vinyl coated
- Design complies to ADA, ASTM and CPSC standards
- Stand-alone safety sign provided as part of the proposal

Design Intent and Explanation:

Using the design intent description from the RFP, visits to the site and an analysis of the surrounding landscape we have put together a play space design that complements the existing park features while adding interest, aesthetics and play to Elmcrest Park.

Our design plays off of the 'subtle farm theme' described in the RFP and attempts to carry similar features such as the building roof into the playground.

We incorporated playground components for the 5-12 age group that offers movement, challenge and dynamic play. A good example of this is the 34' ZipKrooz zipline, climbing walls and 96" slide. For the 2-5 group we included components like themed spring riders and crop climbers to promote imaginative play while at the same time providing movement and challenge.

The barn structure also includes "periscopes" off of the higher decks where kids can look out over the soccer fields for their siblings playing a game or look for their parents in the shelter.

If you would like to see more explanations of our design and process please look to the design diagrams page enclosed in the RFP and the 2-D with specific component call outs.

Thanks for considering our proposal and please let us know if you have any questions!

ELMCREST PARK PLAYGROUND

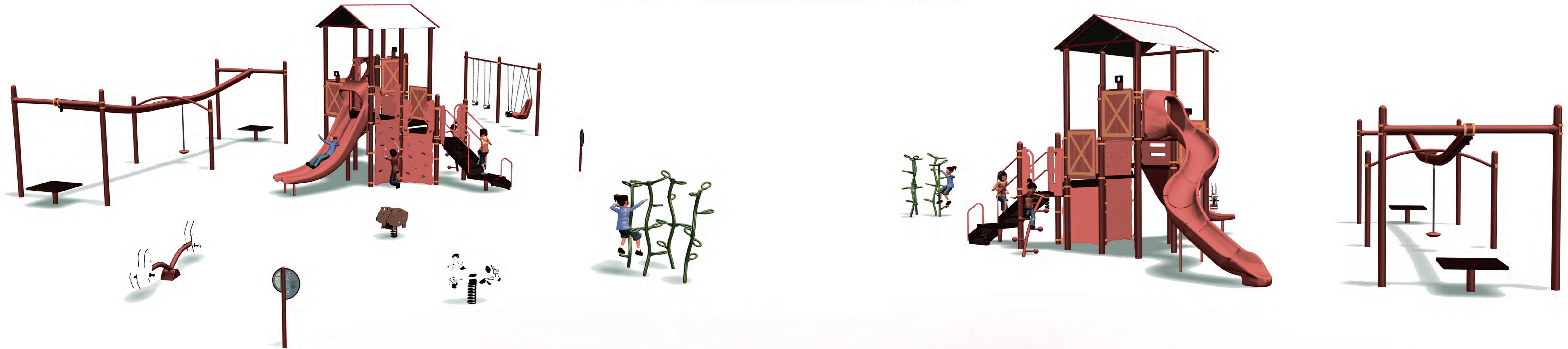
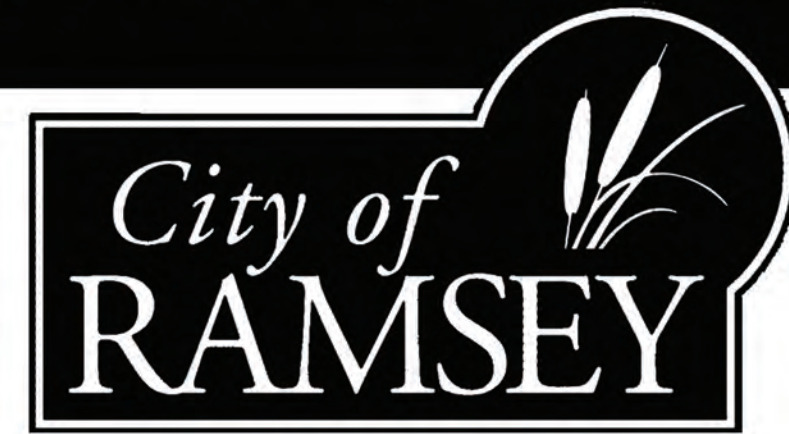

Elmcrest Park

Ramsey, MN May 1, 2015 83936-1-1



Custom products shown are conceptual only. Estimated manufacturing time: 6 weeks from the time of LSI order acceptance.



**Better playgrounds.
Better world.®**

playlsi.com

Proudly presented by:



Elmcrest Park

Ramsey, MN May 1, 2015 83936-1-1R



Custom products shown are conceptual only. Estimated manufacturing time: 6 weeks from the time of LSI order acceptance.



**Better playgrounds.
Better world.®**

playlsi.com

Proudly presented by:





connecting visual elements

elevated track promotes continuous movement

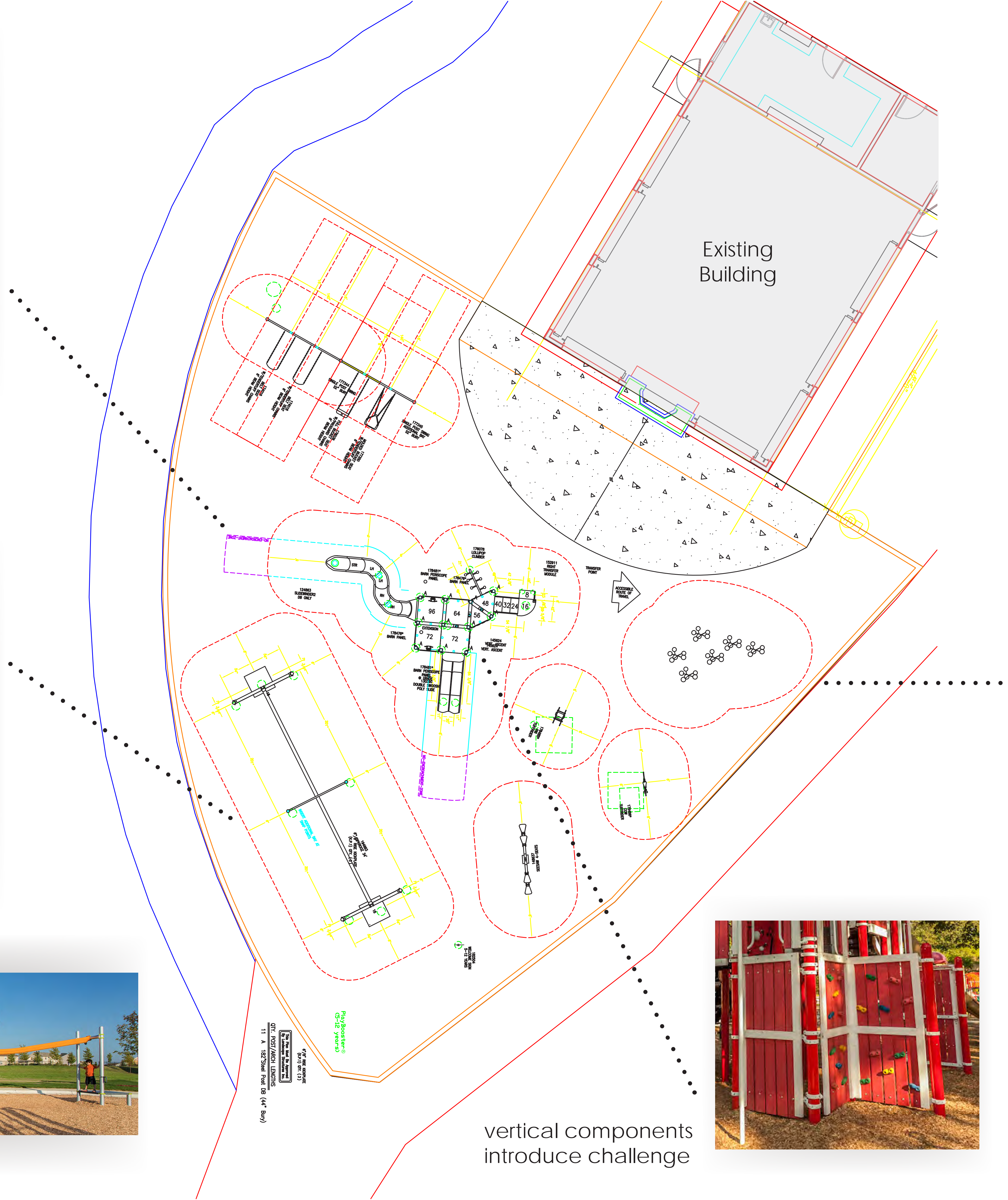

vertical components introduce challenge



introducing local environment

Schematic Design elements of theme



EXISTING CONDITION + COMMUNITY INVOLVEMENT + VISION + PLAN + MODEL =

FUTURE DESIGN



Diagrams

Playground Sections

[aerial view]

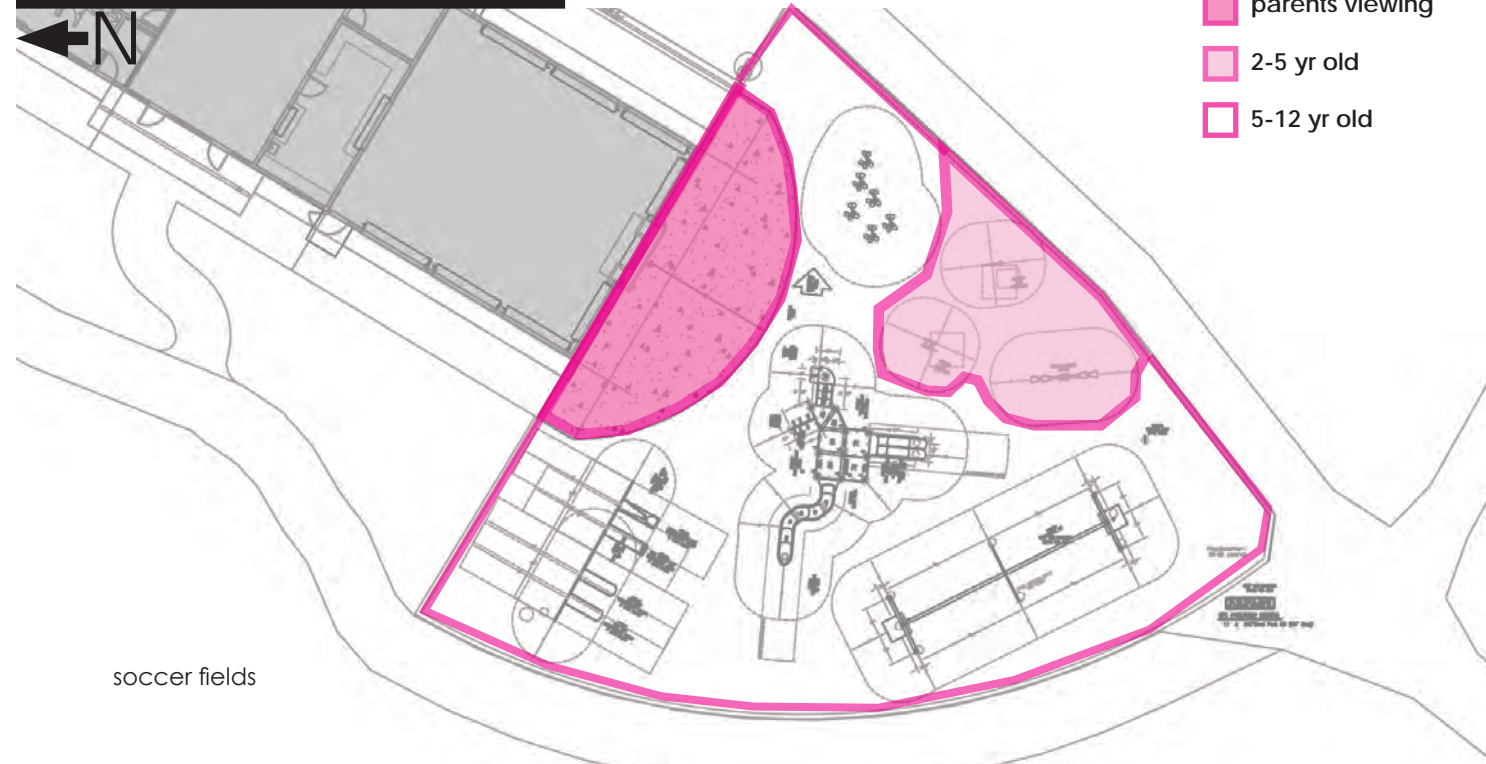

Path Circulation

[aerial view]

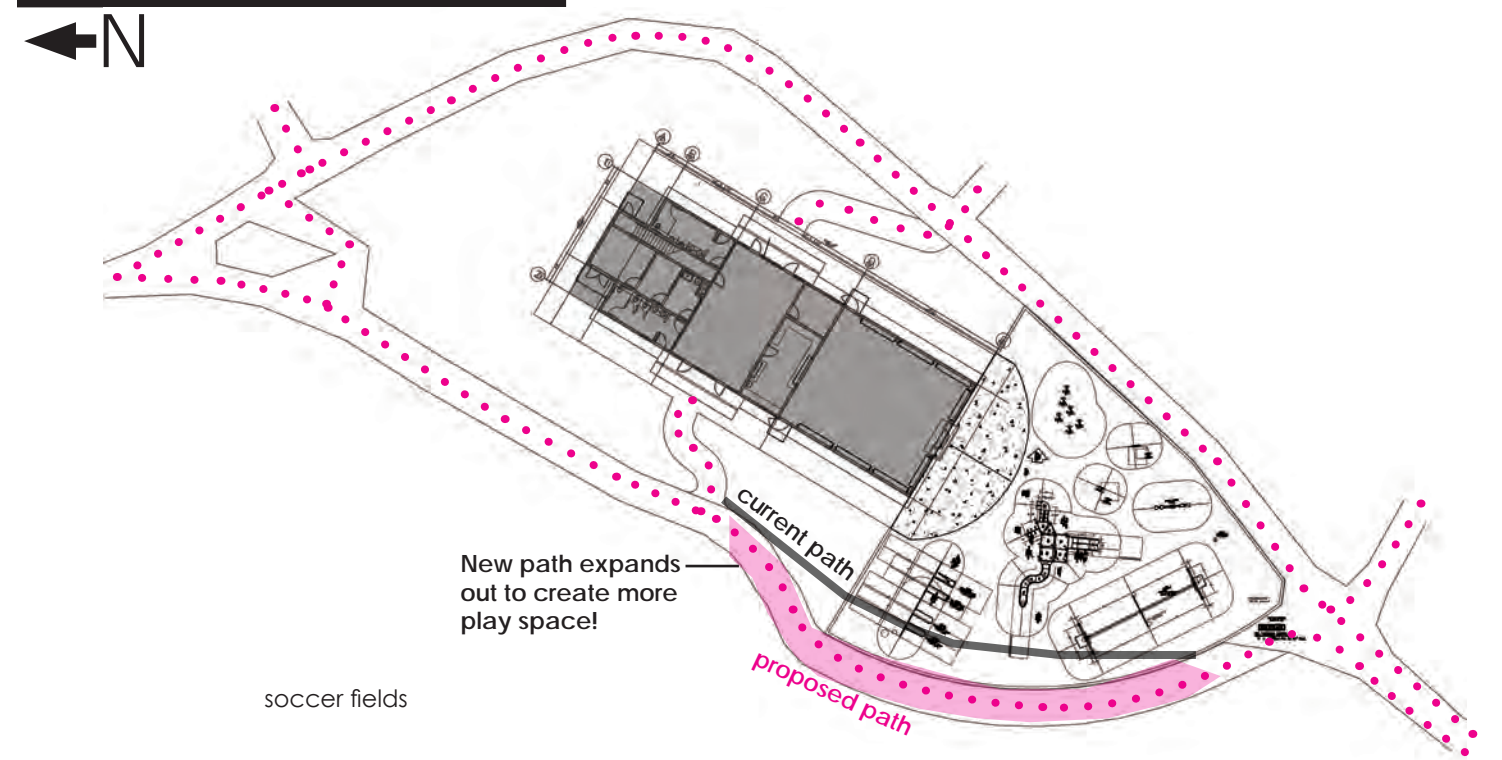

Playground Circulation

[aerial view]



Aesthetic Relationships

[eye-level view]

- mimicking the farm/rural elements of the community building in the playground design
 - roof (A1 & A2)
 - barn door design (B1 & B2)

A1 & A2

B1 & B2

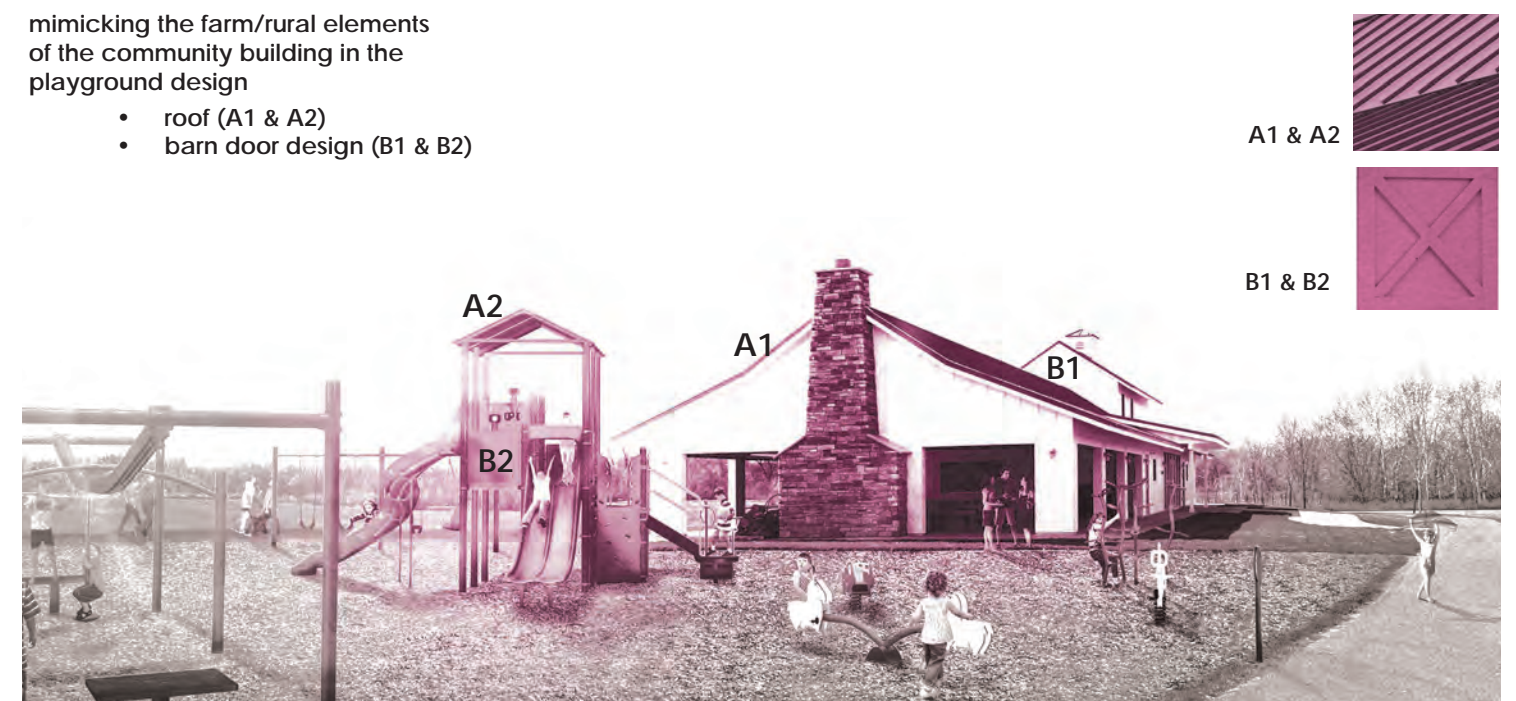



QUOTE

CONTACT: Mark Riverblood
PHONE:
EMAIL: mrivblood@ci.ramsey.mn.us

Please make PO's & contracts out to:
 Landscape Structures, Inc.
 601 7th Street South
 Delano, MN 55328

SHIP TO:

Please remit payment to:
 Landscape Structures, Inc.
 PO Box 86 SDS 12-0395
 Minneapolis, MN 55486-0395

BILL TO:

Date: May 5th, 2015

Project Name: Elmcrest Park

We are pleased to submit this proposal to supply the following items:

QTY	ITEM NO.	DESCRIPTION	UNIT PRICE	EXTENDED AMT
		Playground Equipment		
		Barn Structure	\$33,912.00	
		TuffRider Cow with Spring Coil	\$1,105.00	
		TuffRider Pig with Spring Coil	\$1,180.00	
		Sheep Seesaw	\$3,465.00	
		ZipKrooz	\$9,400.00	
		Double Bay Swings	\$2,880.00	
		Crop Climbers	\$6,060.00	
		Welcome Sign	\$270.00	
		State Contract Discount	(\$5,827.20)	
		Additional Discount	(\$4,061.08)	
		Playground Equipment Total		\$48,383.72
		Engineered Wood Fiber, Drainage Aggregate, and Fabric		\$6,719.70
		Site Prep, Excavation, and Hauling		\$7,282.50
		Concrete Curb		\$7,560.00
		Freight		\$0.00
		Subtotal		\$69,945.92
		Applicable Tax		Included Above
		TOTAL		\$69,945.92

SIGNATURE BELOW ACCEPTING THIS PROPOSAL WILL CONSTITUTE A PURCHASE ORDER ONLY UPON APPROVAL BY LANDCAPE STRUCTURES INC. CUSTOMER RECEIPT OF AN ORDER ACKNOWLEDGEMENT CONSTITUTES SUCH APPROVAL.

ACCEPTED BY CUSTOMER _____ Title _____ Date _____

PROPOSED BY: _____

**Terms – Net 30 days
 1.5% finance charge on
 remaining balance.**

This proposal is presented by



4940 WEST 35TH ST
 ST LOUIS PARK MN 55416
 763 550 7860 763 550 7864

PROPOSAL

DATE: May 6th, 2015



PROJECT: Elmcrest Park - Ramsey, MN

Please make PO's & Contracts out to:

Flagship Recreation, LLC
4940 West 35th Street
St. Louis Park MN 55416
763.550.7860 - Office
763.550.7864 - Fax

Please remit payment to:

Flagship Recreation, LLC
4940 West 35th Street
St. Louis Park MN 55416

We are pleased to submit this proposal to supply the following items:

QTY	ITEM NO.	DESCRIPTION	UNIT PRICE	EXTENDED AMT
		Playground Installation		\$10,249.08
		Engineered Wood Fiber Installation		\$9,805.00

SIGNATURE BELOW ACCEPTING THIS PROPOSAL WILL CONSTITUTE A PURCHASE ORDER ONLY UPON APPROVAL BY FLAGSHIP RECREATION, LLC CUSTOMER RECEIPT OF AN ORDER ACKNOWLEDGEMENT CONSTITUTES SUCH APPROVAL.

Freight	N/A
Subtotal	\$20,054.08
Applicable Tax	Included Above
TOTAL	\$20,054.08

ACCEPTED BY CUSTOMER

DATE



KIM AVELDSON

PROPOSED BY:



January 30, 2015

To Whom It May Concern:

Landscape Structures Inc. has been actively involved with the ASTM (American Society for Testing and Materials) in the development and on-going updates to the F1487 Safety Standard (Consumer Safety Performance Specification for Playground Equipment for Public Use) for the design, manufacture, installation and maintenance of public playground equipment. We are also a charter member of the International Play Equipment Manufactures Association (IPEMA).

All products covered under the scope of the Standard in our 2014-2015 Playground Components Book and 2015 Playground Components Supplement have been tested and certified to be in compliance with the requirements of the ASTM F1487 Safety Standard, except where noted. Our facilities, procedures and test results have been validated by an independent testing laboratory according to procedures set forth by the IPEMA. To verify compliance of all our play components, visit the IPEMA website at www.ipema.org.

It is our opinion we also conform to the U.S. Consumer Products Safety Commission's (CPSC) Handbook for Public Playground Safety published in 2010. Our playstructures are also designed to be in compliance with the 2010 ADA Standard for Accessible Design.

The company has had continuous certification to the quality standard, ISO 9001, since 1996 and to the environmental standard, ISO 14001, since 1998. The pursuit of ISO certification helped Landscape Structures establish its quality management systems and establish the infrastructure for continued growth.

If you have any questions, please contact the undersigned.

Sincerely,

Tom Fitzpatrick, P.E.
Product Compliance Engineer

Subscribed and sworn before me on this 30th day of January, 2015.

Joan C. Mochinski
Notary Public

1-31-17
Expiration Date

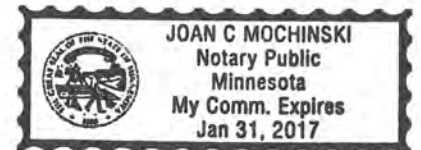

(Notary Stamp)

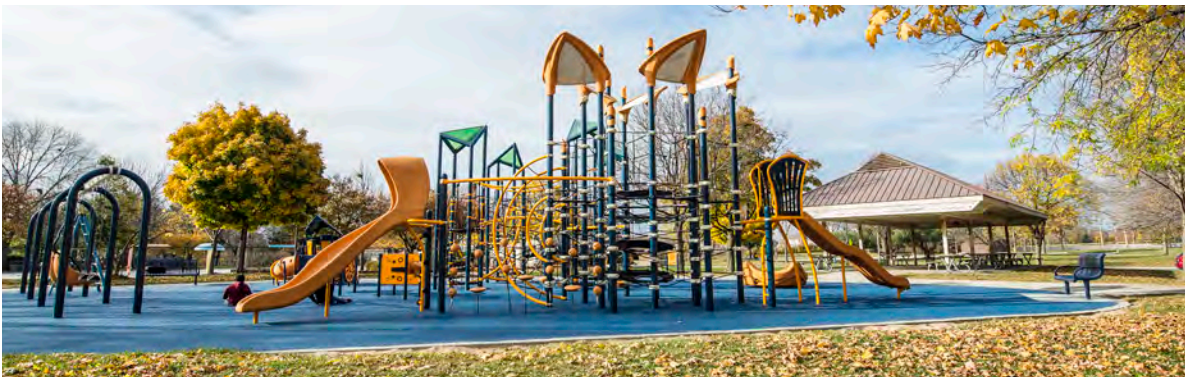

100-Year Limited Warranty On all PlayBooster®, PlayShaper® and PlaySense® aluminum posts, stainless steel fasteners, clamps, beams and caps against structural failure due to corrosion/natural deterioration or manufacturing defects, and on PlayBooster, Evos® and Weevos® steel posts and arches against structural failure due to material or manufacturing defects.

15-Year Limited Warranty On all plastic components (including TuffTimbers™ edging), all steel components (except 100-year steel posts), Mobius® climbers, decks and TenderTuff™ coatings (except Wiggle Ladders, Chain Ladders and Swing Chain) against structural failure due to material or manufacturing defects. TuffTurf® tiles against material or manufacturing defects.

10-Year Limited Warranty On concrete products against structural failure due to natural deterioration or manufacturing defects. Does not cover minor chips, hairline cracks or efflorescence.

8-Year Limited Warranty On Aeronet® climbers and climbing cables against defects in materials or manufacturing defects. On CoolToppers® fabric against failure from significant fading, deterioration, breakdown, mildew, outdoor heat, cold or discoloration. This warranty is limited to the design loads as stated in the specifications found in the technical information.

5-Year Limited Warranty On PebbleFlex® surfacing system against failure due to delamination, manufacturing defects, installation services provided by Landscape Structures Inc. and impact attenuation.

3-Year Limited Warranty On all other parts, i.e.: Pulse™ products, CableCore® products, all swing seats and hangers, Mobius climber handholds, Wiggle Ladders, Chain Ladders and ProGuard™ Swing Chain, Track Ride trolleys and bumpers, all rocking equipment including Sway Fun® gliders, PVC belting material, HealthBeat® resistance mechanism, Seesaws, Wiggle Ring Bridge, etc., against failure due to corrosion/natural deterioration or manufacturing defects.

This warranty does not include any cosmetic issues or wear and tear from normal use. It is valid only if the playstructures and/or equipment are erected to conform with Landscape Structures' installation instructions and maintained according to the maintenance procedures furnished by Landscape Structures Inc.



2015 Play Equipment Warranty

You have our word.

Landscape Structures Inc. warrants that all playstructures and/or equipment sold will conform in kind and in quality to the specifications manual for the products identified in the Acknowledgment of Order and will be free of defects in manufacturing and material. Seller further warrants:

All the warranties commence on date of Seller's invoice. Should any failure to conform to the above express warranties appear within the applicable warranty period, Seller shall, upon being notified in writing promptly after discovery of the defect and within the applicable warranty period, correct such nonconformity either by repairing any defective part or parts, or by making available a replacement part within 60 days of written notification. Seller shall deliver the repaired or replacement part or parts to the site free of charge, but will not be responsible for providing labor or the cost of labor for the removal of the defective part or parts and the installation of any replacement part or parts. Replacement parts will be warranted for the balance of the original warranty.

THIS WARRANTY IS EXCLUSIVE AND IN LIEU OF ALL OTHER WARRANTIES, WHETHER EXPRESSED OR IMPLIED, INCLUDING BUT NOT LIMITED TO ANY WARRANTY OF MERCHANTABILITY OR OF FITNESS FOR A PARTICULAR PURPOSE.

The remedies hereby provided shall be the exclusive and sole remedies of the purchaser. Seller shall not be liable for any direct, indirect, special, incidental or consequential damages.

Seller neither assumes nor authorizes any employee, representative or any other person to assume for Seller any other liability in connection with the sale or use of the structures sold, and there are no oral agreements or warranties collateral to or affecting this agreement. The warranty stated above is valid only if the structures and/or equipment are erected in conformance with Landscape Structures' installation instructions and maintained according to the maintenance procedures furnished by Landscape Structures Inc.; have been subjected to normal use for the purpose for which the goods were designed; have not been subject to misuse, negligence, vandalism, or accident; have not been subjected to addition or substitution of parts; and have not been modified, altered, or repaired by persons other than Seller or Seller's designees in any respect which, in the judgement of Seller, affects the condition or operation of the structures. To make a claim, send your written statement of claim, along with the original job number or invoice number to: Landscape Structures Inc. 601 7th Street South, Delano, Minnesota, 55328-8605.

Signed:

Chairman

Date: 01/01/2015



Terms of Sale

PRICING: Landscape Structures' list prices do not include delivery and handling charges. Prices are subject to change without notice.

TERMS: To tax-supported institutions and those with established credit: net 30 days from the date of the invoice. 1.5% per month thereafter; freight charges are prepaid and applied to the invoice.

TAXES: Landscape Structures' list prices do not include applicable taxes, if any.

WEIGHTS: Weights are approximate and may vary.

DELIVERY: If delivery of the equipment is by common carrier, and there is damage or a shortage, notify the carrier at once and sign delivery documents provided by the carrier noting the damage or shortage. Most products are delivered on large pallets and will require a forklift or similar equipment to unload as a unit on the site.

INSTALLATION: All playstructures and/or equipment are delivered unassembled and packaged with recyclable materials. For a list of factory-certified installers in your area, please contact your Landscape Structures playground consultant.

SERVICE: We have knowledgeable, qualified playground consultants throughout the world who are available to help you before, during and after the sale. Landscape Structures has exclusive design software that features all of our parts and pieces in pull-down menus. With this software, your playground consultant can design a playground layout that meets not only your needs, but ASTM and CPSC standards as well. In addition, we have a full staff of NPSI-certified designers, along with 2-D and 3-D drawing capabilities and custom capabilities to assist you with your playground plans.

RETURN POLICY: As an indication of our commitment to our customers, Landscape Structures will accept returns of new structures and/or new equipment purchased within 60 days of the original invoice date. Advance notification is necessary to ensure proper credit. Parts not included in this return policy are custom parts (including PlayShaper® posts), as well as used or damaged parts. A 20% restock fee plus all return freight charges will apply to all product returns. NOTE: All parts are subject to inspection upon return. Parts returned damaged may not receive a full credit. For this reason, it is important that all returned parts are properly packaged to prevent damage while in transit.

PRODUCT CHANGES: Because of our commitment to safety, innovation, and value, we reserve the right to change specifications at any time.

PLEASE CONTACT US AT:

Landscape Structures Inc.
601 7th St. South
Delano, MN 55328-8605
888.438.6574 (*inside the U.S.A.*)
763.972.5200 (*outside the U.S.A.*)
playlsi.com

