

# Mississippi Skyway: Regional Multiuse Trail Connection

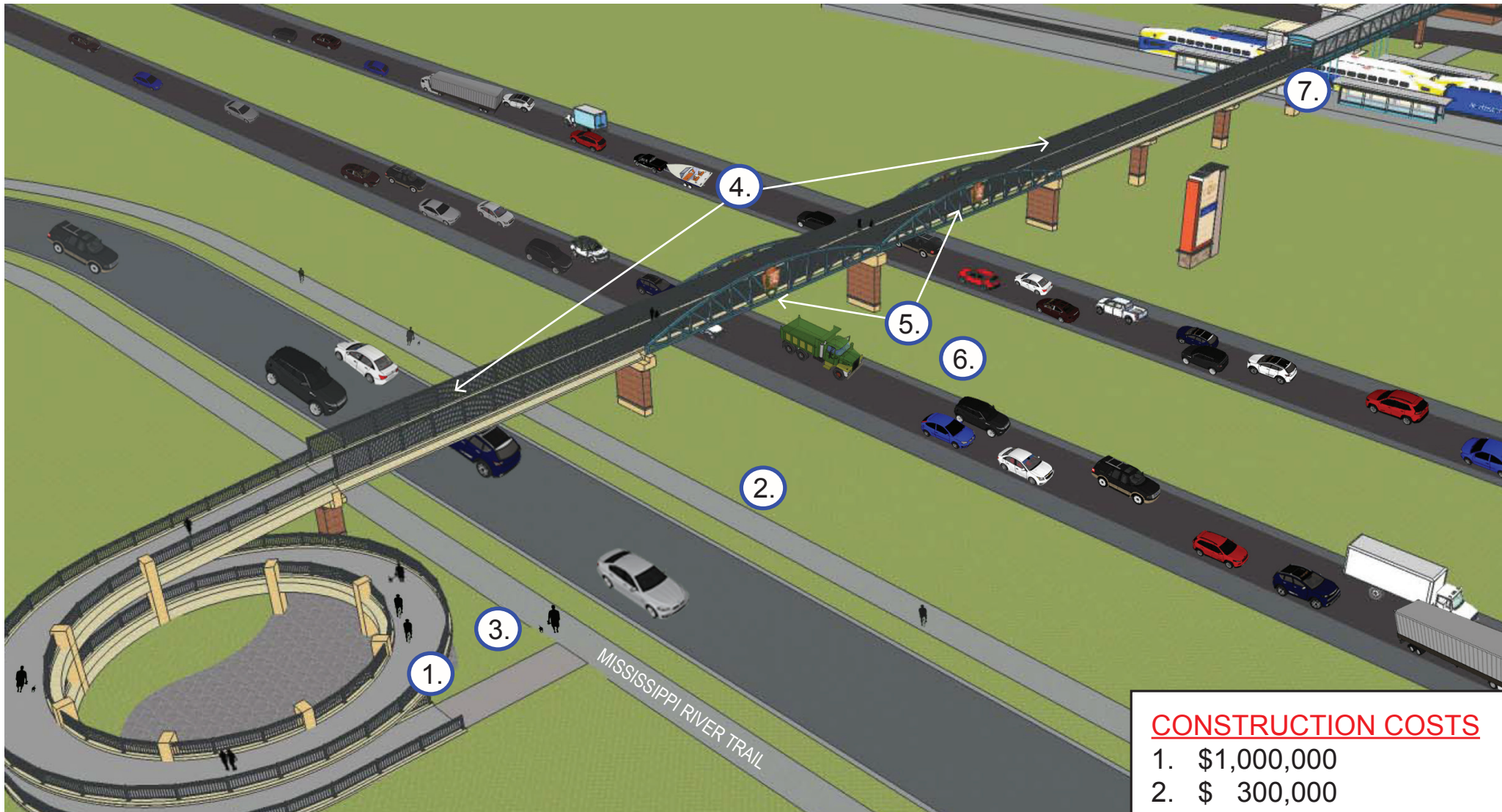

1. Helix Ramp = **\$1,000,000**
2. Utility Relocation to Allow for Construction = **\$300,000**
3. Grading, Landscaping, Connection to Existing Trail Retaining Walls, etc. = **\$500,000**
4. 364 feet of Prestressed Beams - 14.5 feet wide - 5.278 sq feet x \$175/sq foot = **\$923,650**
5. 210 feet of Bowstring Pre-Fabricated Trusses - 15.5 feet wide - 3,225 sq feet x \$310/sq foot = **\$1,009,050**
6. Special Staging and Traffic Control in this area for work near Highway 10 = **\$300,000**
7. Grading and Connection to Existing Skyway = **\$500,000**

<b>CONSTRUCTION COSTS</b>	
1.	\$1,000,000
2.	\$ 300,000
3.	\$ 500,000
4.	\$ 923,650
5.	\$1,009,050
6.	\$ 300,000
7.	\$ 500,000
<hr/>	
<b>Total</b>	<b>= \$4,532,700</b>