

CITY OF RAMSEY

SUNWOOD DRIVE STRIPING IMPROVEMENTS

CITY IMPROVEMENT PROJECT NO. 17-04

GOVERNING SPECIFICATIONS

THE 2016 EDITION OF THE MINNESOTA DEPARTMENT OF TRANSPORTATION "STANDARD SPECIFICATIONS FOR CONSTRUCTION" SHALL GOVERN.

ALL FEDERAL, STATE AND LOCAL LAWS, REGULATIONS AND ORDINANCES SHALL BE COMPLIED WITH IN THE CONSTRUCTION OF THIS PROJECT.

ALL TRAFFIC CONTROL DEVICES AND SIGNING SHALL CONFORM TO THE MINNESOTA MANUAL ON UNIFORM TRAFFIC CONTROL DEVICES, INCLUDING THE FIELD MANUAL FOR TEMPORARY TRAFFIC CONTROL ZONE LAYOUTS.

SHEET INDEX

THIS PLAN CONTAINS 10 SHEETS

SHEET No.	DESCRIPTION
1	TITLE SHEET
2	STATEMENT OF ESTIMATED QUANTITIES
3-6	REMOVALS
7-10	STRIPING PLAN

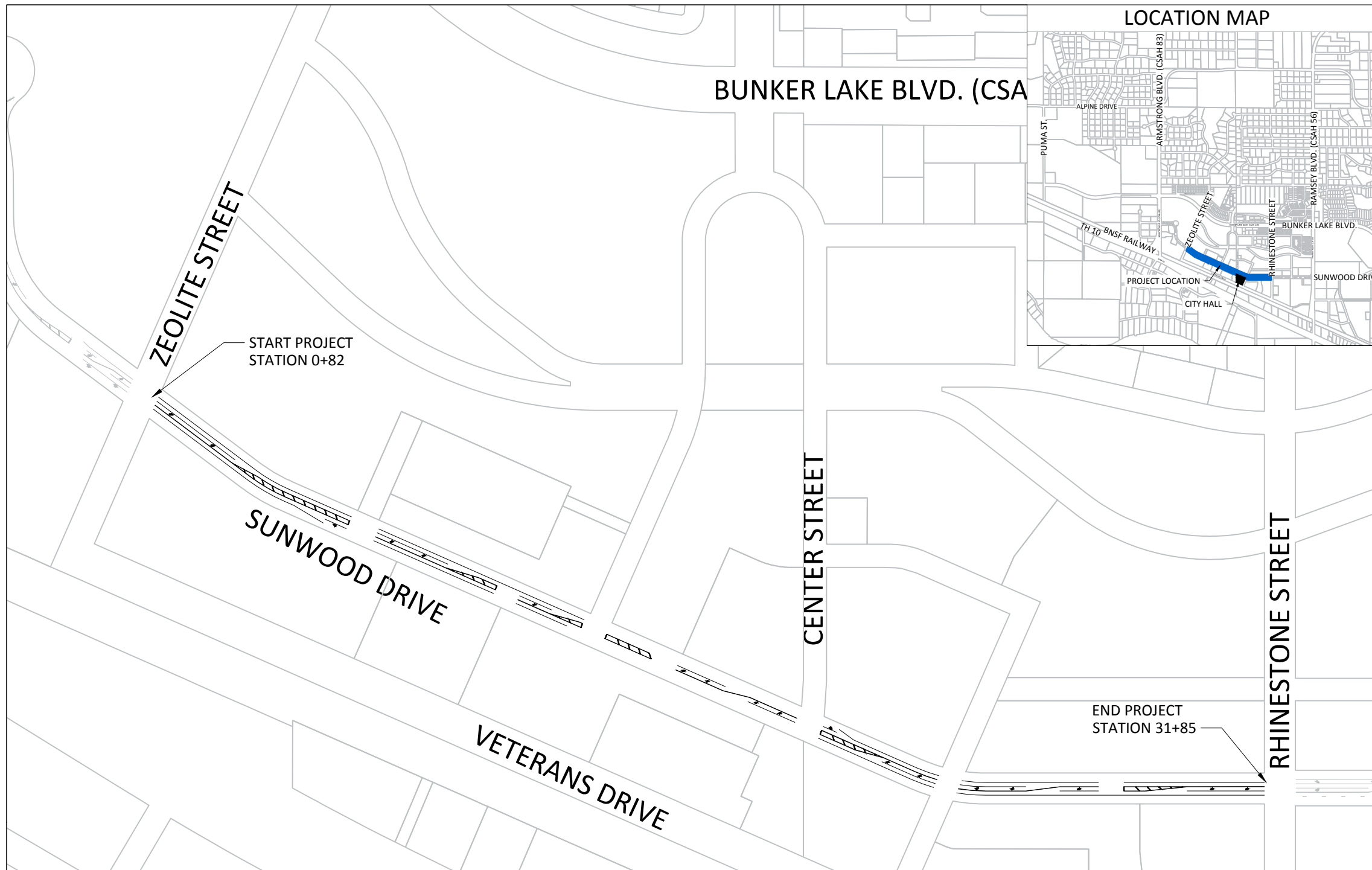

LOCATION MAP

BUNKER LAKE BLVD. (CSA)

ZEOLITE STREET

START PROJECT STATION 0+82

SUNWOOD DRIVE

VETERANS DRIVE

CENTER STREET

RHINESTONE STREET

END PROJECT STATION 31+85

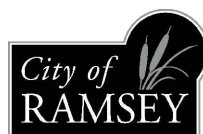
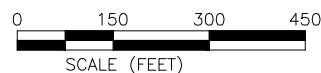

CITY OF RAMSEY
7550 SUNWOOD DRIVE
RAMSEY, MN 55303
(763) 427-1410 FAX (763) 433-9898

NOTE: EXISTING UTILITY INFORMATION SHOWN ON THIS PLAN HAS BEEN PROVIDED BY THE UTILITY OWNER. THE CONTRACTOR SHALL FIELD VERIFY EXACT LOCATIONS PRIOR TO COMMENCING CONSTRUCTION AS REQUIRED BY STATE LAW. NOTIFY GOPHER STATE ONE CALL 1-800-252-1166 OR 651-454-0002



Call before you dig
811
651 454-0002 Metro
800 252-1166 Outstate
www.gopherstateonecall.org

I hereby certify that this plan, specification, or report was prepared by me or under my direct supervision and that I am a duly Licensed Professional Engineer under the laws of the State of Minnesota.

BRUCE R WESTBY, P.E.
RAMSEY CITY ENGINEER

40116 DATE
LIC. NO.

DATE	REVISION

17-04 SUNWOOD DRIVE STRIPING - ESTIMATED QUANTITIES

PAGE NO.	NOTE	ITEM NO.	ITEM	UNIT	ESTIMATED QUANTITY
		2021.501	MOBILIZATION	LS	1
3 - 4, 6	1	2102.501	PAVEMENT MARKING REMOVAL	SF	480
3 - 6	1, 2	2102.502	PAVEMENT MARKING REMOVAL	LF	2104
		2563.601	TRAFFIC CONTROL	LS	1
7 - 10		2582.501	PAVT MSSG (LT ARROW) - EPOXY	EA	16
7, 9		2582.501	PAVT MSSG (RT ARROW) - EPOXY	EA	2
7 - 10	3	2582.502	4" DOUBLE SOLID LINE YELLOW - EPOXY	LF	3652
7 - 10		2582.502	4" SOLID LINE WHITE - EPOXY	LF	5895
7 - 10		2582.502	24" SOLID LINE YELLOW - EPOXY	LF	427

NOTES:

1. REMOVALS SHALL BE MARKED IN THE FIELD BY CITY STAFF.
2. REMOVAL OF DOUBLE SOLID LINE IS PAID BY LINEAR FOOT FOR EACH SOLID LINE. EXAMPLE: 50 LF OF DOUBLE SOLID LINE REMOVAL EQUALS 100 LF OF PAVEMENT MARKING REMOVAL.
3. 4" DOUBLE SOLID LINE SHALL BE SPACED 4" APART AS MEASURED AT THE INSIDE EDGES OF THE LINES.

17-04 SUNWOOD DRIVE STRIPING SUMMARY

LINE	SEGMENT NO.	START STATION	TAPER STATION	END STATION	LENGTH (FEET)	KEY
EB FOG LINE	EB FL 1	0+85		6+12	531	4SW
	EB FL 2	7+50		10+89	339	4SW
	EB FL 3	11+53		13+31	178	4SW
	EB FL 4	20+09		23+31	324	4SW
	EB FL 5	23+90		31+85	797	4SW
EB TURN LANE	EB TL 1	6+12		6+72	60	4SW
	EB TL 2	18+04		19+37	133	4SW
	EB TL 3	21+84		23+33	149	4SW
	EB TL 4	26+56		27+56	100	4SW
	EB TL 5	29+85		31+85	200	4SW
CENTERLINE	CL 1	0+83		6+72	590	4DY
	CL 1A	3+33	4+07	6+72	338	4DY
	CL 1D	3+33		6+72	154	24SY
	CL 2	7+50		10+89	339	4DY
	CL 2A	9+50	10+37	10+89	139	4DY
	CL 2D	9+50		10+89	48	24SY
	CL 3	11+53		13+31	178	4DY
	CL 3A	12+43	13+21	13+31	89	4DY
	CL 3D	12+43		13+31	26	24SY
	CL 4	14+00		15+30	130	4DY
	CL 4A	14+00		15+20	120	4DY
	CL 4D	14+00		15+30	74	24SY
	CL 5	16+00		19+37	338	4DY
	CL 6	20+09		23+34	324	4DY
	CL 6A	20+09	21+09	21+84	176	4DY
	CL 6D	20+09		21+84	70	24SY
CL 7	23+93		27+56	364	4DY	
CL 8	28+22		31+85	363	4DY	
CL 8A	28+22	28+76	29+85	164	4DY	
CL 8D	28+22		29+85	55	24SY	
WB FOG LINE	WB FL 1	31+85		28+22	363	4SW
	WB FL 2	27+56		23+99	354	4SW
	WB FL 3	23+36		20+49	285	4SW
	WB FL 4	13+31		7+50	581	4SW
	WB FL 5	6+72		0+78	590	4SW
WB TURN LANE	WB TL 1	25+68		23+96	171	4SW
	WB TL 2	20+46		20+09	37	4SW
	WB TL 3	17+35		16+00	135	4SW
	WB TL 4	12+43		11+53	90	4SW
	WB TL 5	9+49		7+50	200	4SW
	WB TL 6	2+80		0+80	200	4SW

STRIPING KEY & LEGEND

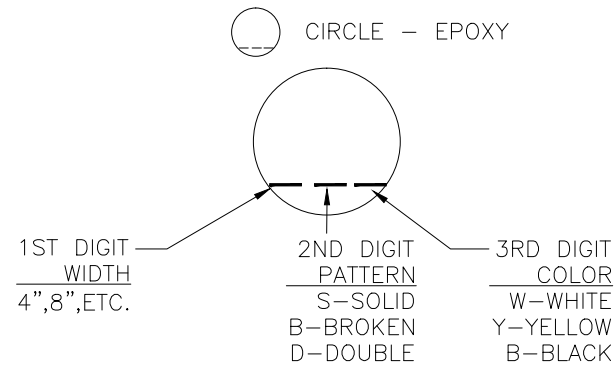

EXAMPLE: **4SW** = 4" SOLID WHITE - EPOXY

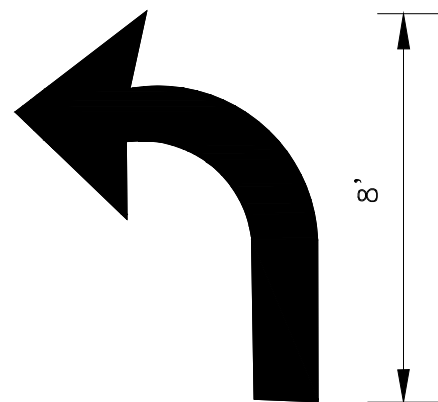

PAVEMENT ARROW MARKINGS

PERMANENT PAVEMENT MARKING GENERAL NOTES AND GUIDELINES:

1. THE ENGINEER'S INVOLVEMENT IN THE APPLICATION OF THE MATERIAL SHALL BE LIMITED TO FIELD CONSULTATION AND INSPECTION. THE CONTRACTOR WILL PLACE NECESSARY "SPOTTING" AT APPROPRIATE POINTS TO PROVIDE HORIZONTAL CONTROL FOR STRIPING TO DETERMINE NECESSARY STARTING AND CUTOFF POINTS. LONGITUDINAL JOINTS, PAVEMENT EDGES AND EXISTING MARKINGS MAY SERVE AS HORIZONTAL CONTROL WHEN SO DIRECTED.
2. EDGE LINES AND LANE LINES ARE TO BE BROKEN ONLY AT INTERSECTIONS WITH PUBLIC ROADS AND AT PRIVATE ENTRANCES IF THEY ARE CONTROLLED BY A YIELD SIGN, STOP SIGN OR TRAFFIC SIGNAL. THE BREAK POINT IS TO BE AT THE START OF THE RADIUS FOR THE INTERSECTION OR AT MARKED STOP LINES OR CROSSWALKS.
3. TOLERANCE OF 1/4 INCH UNDER OR 1/4 OVER THE SPECIFIED WIDTH WILL BE ALLOWED FOR STRIPING PROVIDED THE VARIATION IS GRADUAL AND DOES NOT DETRACT FROM THE GENERAL APPEARANCE. BROKEN LINE SEGMENTS MAY VARY UP TO 1/2 FOOT FROM THE SPECIFIED LENGTHS PROVIDED THE OVER AND UNDER VARIATIONS ARE REASONABLY COMPENSATORY. ALIGNMENT DEVIATIONS FROM THE CONTROL GUIDE SHALL NOT EXCEED 1 INCH. MATERIAL SHALL NOT BE APPLIED OVER LONGITUDINAL JOINTS. ESTABLISHMENT OF APPLICATION TOLERANCES SHALL NOT RELIEVE THE CONTRACTOR OF THEIR RESPONSIBILITY TO COMPLY AS CLOSELY AS PRACTICABLE WITH THE PLANNED DIMENSIONS.
4. THE ROAD SURFACE SHALL BE CLEANED AT THE DIRECTION OF THE ENGINEER JUST PRIOR TO APPLICATION. PAVEMENT CLEANING SHALL CONSIST OF AT LEAST BRUSHING WITH A ROTARY BROOM (NON-METALLIC) OR AS RECOMMENDED BY THE MATERIAL MANUFACTURER AND ACCEPTABLE TO THE ENGINEER. THIS WORK SHALL BE INCIDENTAL TO PAVEMENT MARKING.
5. THE EPOXY MARKING APPLICATION SHALL IMMEDIATELY FOLLOW THE PAVEMENT CLEANING. GLASS BEADS SHALL BE APPLIED IMMEDIATELY AFTER APPLICATION OF THE EPOXY RESIN LINE TO PROVIDE AN IMMEDIATE NO-TRACK SYSTEM.
6. FOR 15 MIL APPLICATIONS, GLASS BEADS SHALL BE APPLIED AT A RATE OF AT LEAST 25 LB/GAL. THE "NO-TRACKING" CONDITION SHALL BE DETERMINED ON AN APPLICATION OF SPECIFIED THICKNESS TO THE PAVEMENT AND COVERED WITH GLASS BEADS AT THE RATE OF AT LEAST 25 LB/GAL.
7. OPERATIONS SHALL BE CONDUCTED ONLY WHEN THE ROAD PAVEMENT SURFACE TEMPERATURES ARE 50 DEGREES °F OR GREATER.
8. PERMANENT PAVEMENT MARKINGS SHALL NOT BE PLACED OVER TEMPORARY TAPE MARKINGS.

DATE	REVISION
Jun 07, 2017 - 9:35am	
G:\Engineering\AutoCad Dwg\Projects N-2\Sunwood Drive Striping - 17-04\Plan Drawings\Location Map.dwg	

I hereby certify that this plan, specification, or report was prepared by me or under my direct supervision and that I am a duly Licensed Professional Engineer under the laws of the State of Minnesota

BRUCE WESTBY
Date 6/7/17 Lic. No. 40116

DESIGNED BY: J JF	DATE: 6/7/17
DRAWN BY: J JF	FILE No. 17-04
CHECKED BY: BRW	

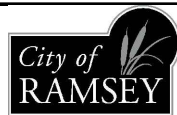

CITY OF RAMSEY
7550 SUNWOOD DRIVE
RAMSEY, MN 55303
(763) 427-1410 FAX (763) 433-9898

SEQ & NOTES

SUNWOOD DRIVE STRIPING IMPROVEMENTS
CITY PROJECT NO. 17-04
CITY OF RAMSEY, MINNESOTA

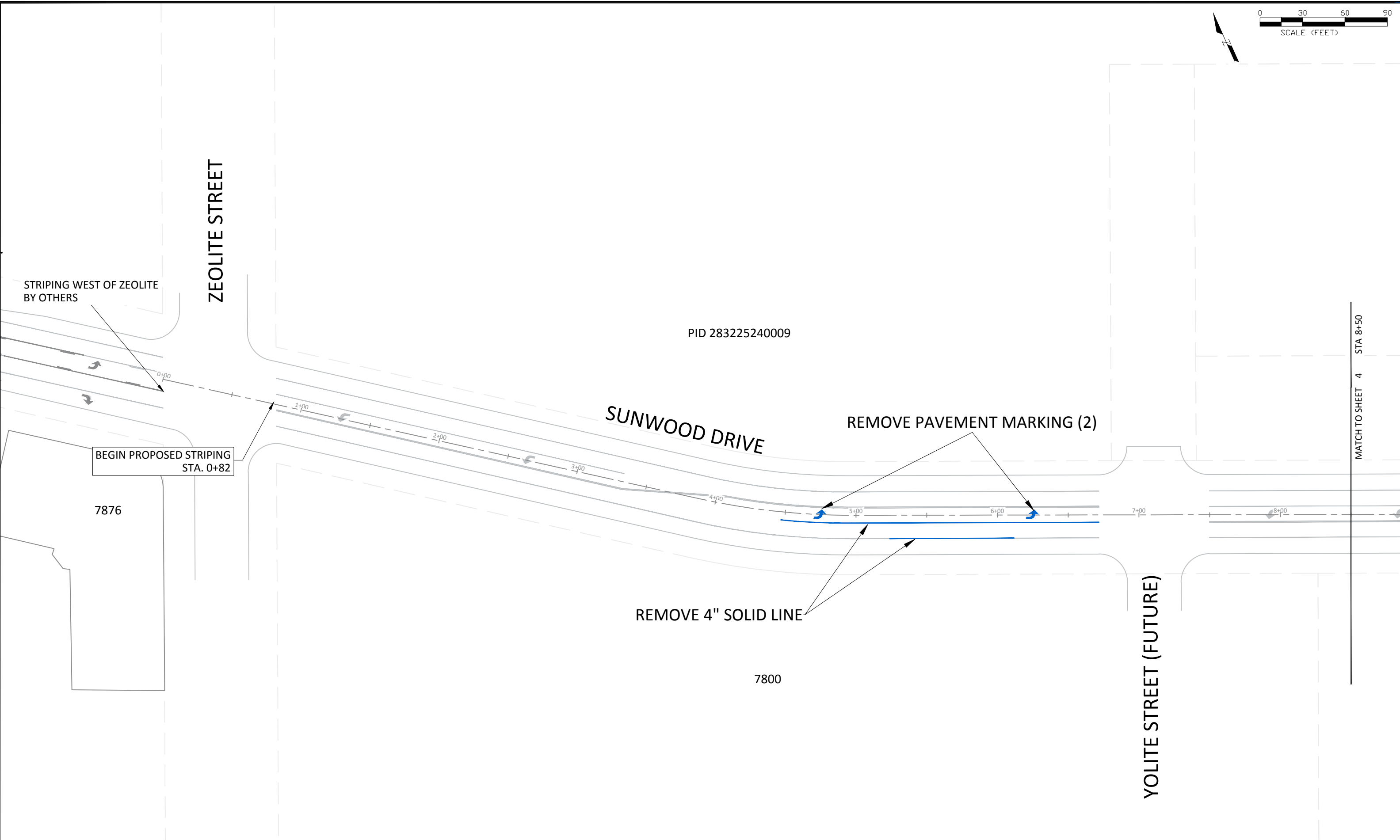

DATE	REVISION

I hereby certify that this plan, specification, or report was prepared by me or under my direct supervision and that I am a duly Licensed Professional Engineer under the laws of the State of Minnesota

BRUCE WESTBY
Date 6/7/17 Lic. No. 40116

DESIGNED BY: JJJ
DRAWN BY: JJJ
CHECKED BY: BRW

DATE: 6/7/17
FILE No. 17-04

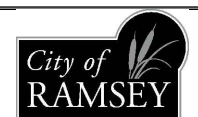

CITY OF RAMSEY
7550 SUNWOOD DRIVE
RAMSEY, MN 55303
(763) 427-1410 FAX (763) 433-9898

REMOVALS STA. 0+00 TO 8+50

SUNWOOD DRIVE STRIPING IMPROVEMENTS
CITY PROJECT NO. 17-04
CITY OF RAMSEY, MINNESOTA

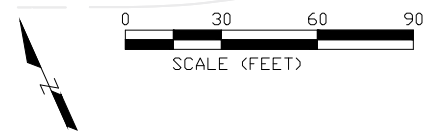

MATCH TO SHEET 3 STA 8+50

MATCH TO SHEET 5 STA 17+50

PID 283225240013

PID 283225240008

PID 283225310009

REMOVE 4" DOUBLE SOLID LINE

REMOVE PAVEMENT MARKING (2)

REMOVE 4" SOLID LINE

REMOVE 4" SOLID LINE

SUNWOOD DRIVE



7750

7700

7650

DATE	REVISION

I hereby certify that this plan, specification, or report was prepared by me or under my direct supervision and that I am a duly Licensed Professional Engineer under the laws of the State of Minnesota

BRUCE WESTBY
Date 6/7/17 Lic. No. 40116

DESIGNED BY: JJJ
DRAWN BY: JJJ
CHECKED BY: BRW

DATE: 6/7/17
FILE No. 17-04

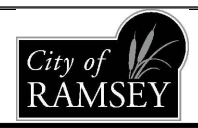

CITY OF RAMSEY
7550 SUNWOOD DRIVE
RAMSEY, MN 55303
(763) 427-1410 FAX (763) 433-9898

REMOVALS STA. 8+50 TO 17+50

SUNWOOD DRIVE STRIPING IMPROVEMENTS
CITY PROJECT NO. 17-04
CITY OF RAMSEY, MINNESOTA

SHEET 4 OF 10 SHEETS

Jun 07, 2017 - 9:36am
G:\Engineering\AutoCad Dwg\Projects N-2\Sunwood Drive Striping - 17-04\Plan Drawings\Removals.dwg

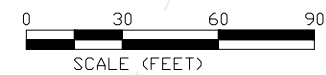

PID 28322531009

MATCH TO SHEET 4
STA 17+50

CENTER STREET

PID 283225420018

REMOVE 4" SOLID LINE

SUNWOOD DRIVE

SAPPHIRE STREET

7533

7550

MATCH TO SHEET 6
STA 26+00

PID 283225420022

DATE	REVISION
Jun 07, 2017 - 9:36am	
G:\Engineering\AutoCad Dwg\Projects N-2\Sunwood Drive Striping - 17-04\Plan Drawings\Removals.dwg	

I hereby certify that this plan, specification, or report was prepared by me or under my direct supervision and that I am a duly Licensed Professional Engineer under the laws of the State of Minnesota

BRUCE WESTBY
Date 6/7/17 Lic. No. 40116

DESIGNED BY: JJF
DRAWN BY: JJF
CHECKED BY: BRW

DATE: 6/7/17
FILE No. 17-04



CITY OF RAMSEY
7550 SUNWOOD DRIVE
RAMSEY, MN 55303
(763) 427-1410 FAX (763) 433-9898

REMOVALS STA. 17+50 TO 26+00

SUNWOOD DRIVE STRIPING IMPROVEMENTS
CITY PROJECT NO. 17-04
CITY OF RAMSEY, MINNESOTA

SHEET 5 OF 10 SHEETS

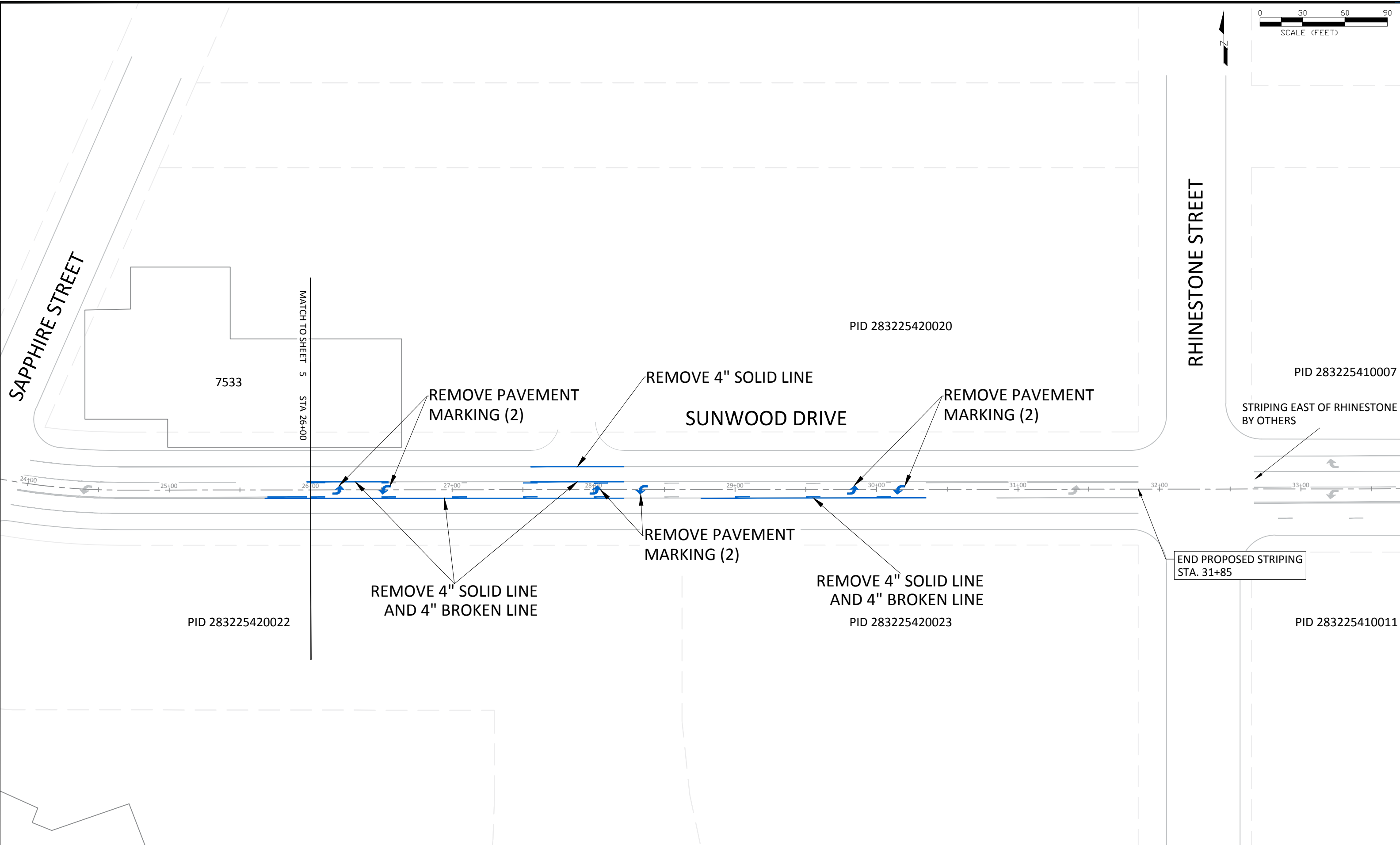
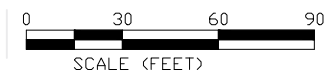

DATE	REVISION

I hereby certify that this plan, specification, or report was prepared by me or under my direct supervision and that I am a duly Licensed Professional Engineer under the laws of the State of Minnesota

BRUCE WESTBY
 Date 6/7/17 Lic. No. 40116

DESIGNED BY: JJJ
 DRAWN BY: JJJ
 CHECKED BY: BRW

DATE: 6/7/17
 FILE No. 17-04

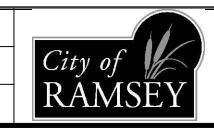

CITY OF RAMSEY
 7550 SUNWOOD DRIVE
 RAMSEY, MN 55303
 (763) 427-1410 FAX (763) 433-9898

REMOVALS STA. 26+00 TO 31+85

SUNWOOD DRIVE STRIPING IMPROVEMENTS
 CITY PROJECT NO. 17-04
 CITY OF RAMSEY, MINNESOTA

SHEET 6 OF 10 SHEETS

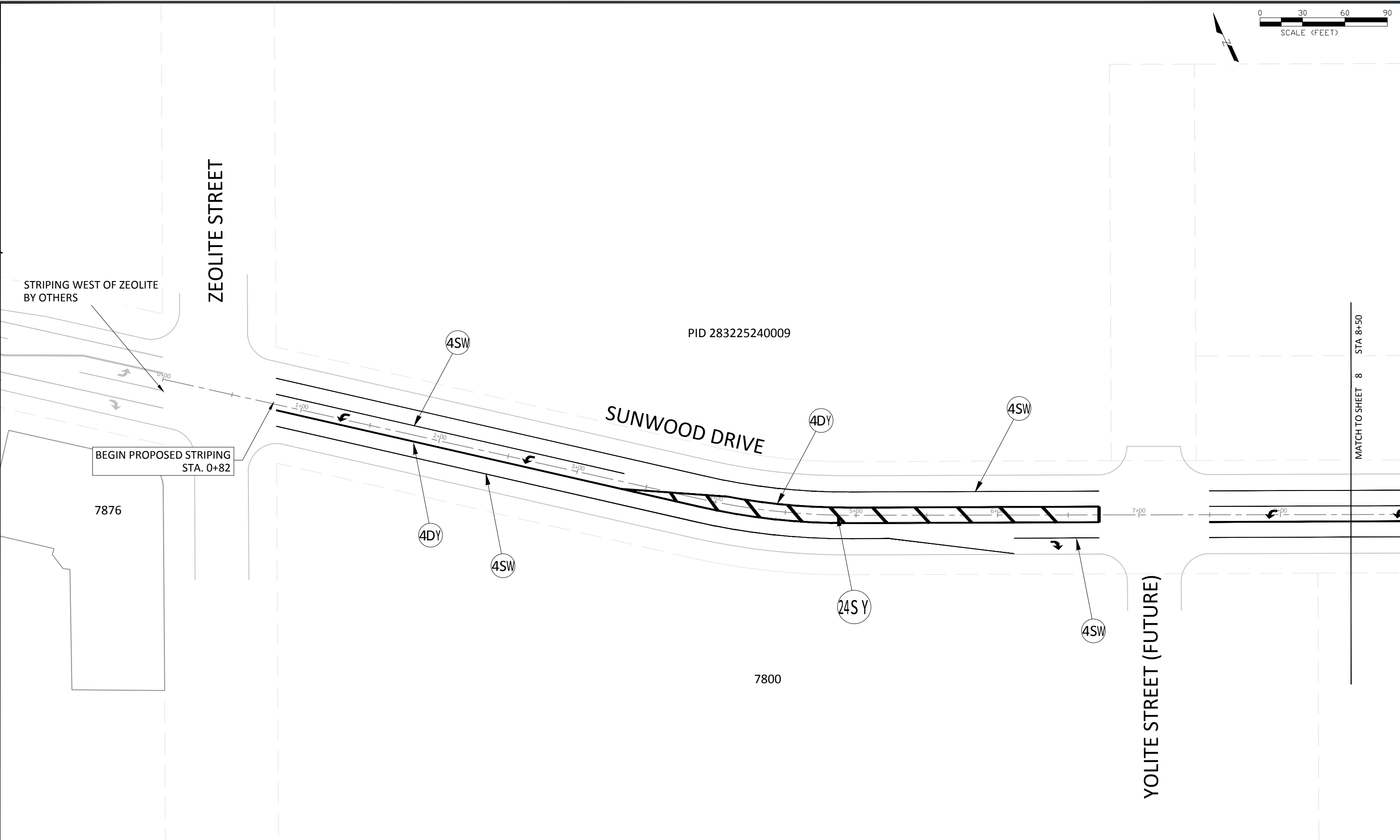

DATE	REVISION

I hereby certify that this plan, specification, or report was prepared by me or under my direct supervision and that I am a duly Licensed Professional Engineer under the laws of the State of Minnesota

BRUCE WESTBY
Date 6/7/17 Lic. No. 40116

DESIGNED BY: JJJ
DRAWN BY: JJJ
CHECKED BY: BRW

DATE: 6/7/17
FILE No. 17-04

CITY OF RAMSEY
7550 SUNWOOD DRIVE
RAMSEY, MN 55303
(763) 427-1410 FAX (763) 433-9898

STRIPING PLAN STA. 0+00 TO 8+50

SUNWOOD DRIVE STRIPING IMPROVEMENTS
CITY PROJECT NO. 17-04
CITY OF RAMSEY, MINNESOTA

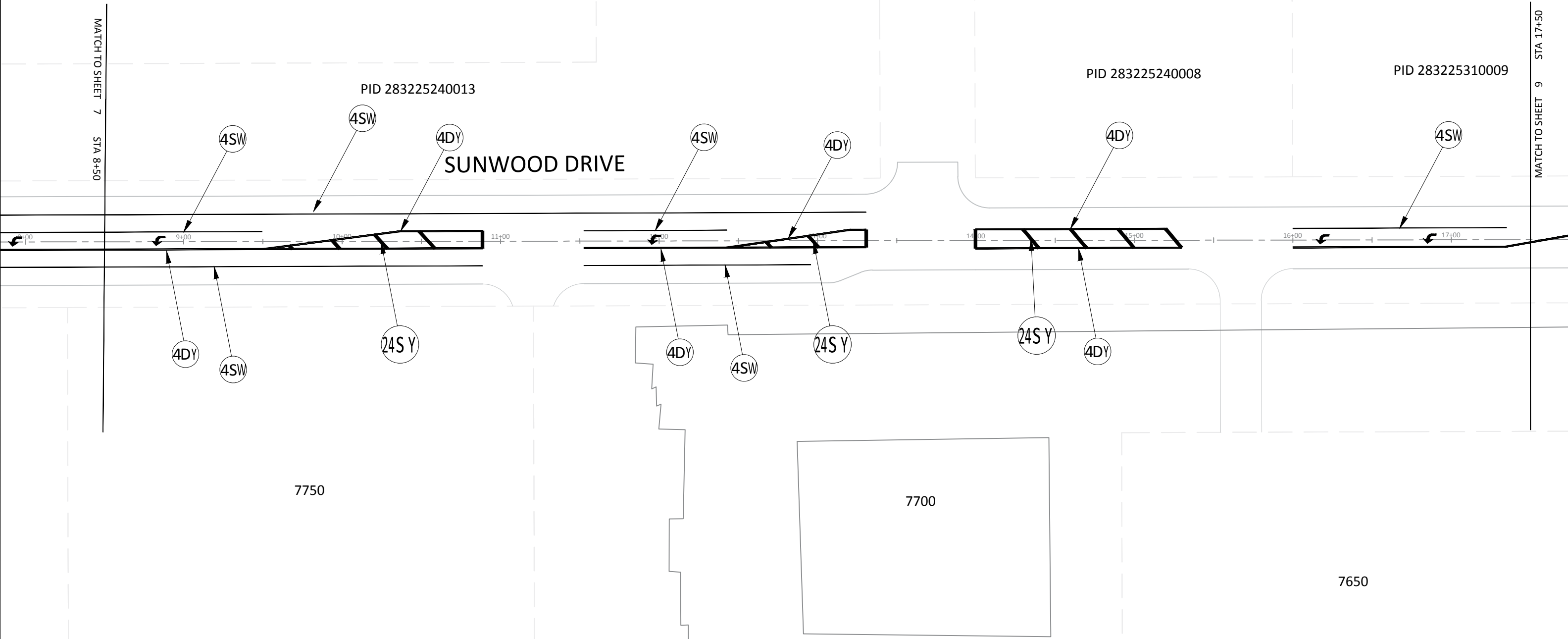
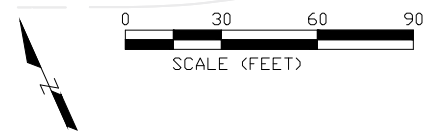

DATE	REVISION

I hereby certify that this plan, specification, or report was prepared by me or under my direct supervision and that I am a duly Licensed Professional Engineer under the laws of the State of Minnesota

BRUCE WESTBY
 Date 6/7/17 Lic. No. 40116

DESIGNED BY: JJJ
 DRAWN BY: JJJ
 CHECKED BY: BRW

DATE: 6/7/17
 FILE No. 17-04

CITY OF RAMSEY
 7550 SUNWOOD DRIVE
 RAMSEY, MN 55303
 (763) 427-1410 FAX (763) 433-9898

STRIPING PLAN STA. 8+50 TO 17+50

SUNWOOD DRIVE STRIPING IMPROVEMENTS
 CITY PROJECT NO. 17-04
 CITY OF RAMSEY, MINNESOTA

SHEET 8 OF 10 SHEETS

Jun 07, 2017 - 9:37am
 G:\Engineering\AutoCad Dwg\Projects N-2\Sunwood Drive Striping - 17-04\Plan Drawings\Sunwood Drive Striping - 2017.dwg

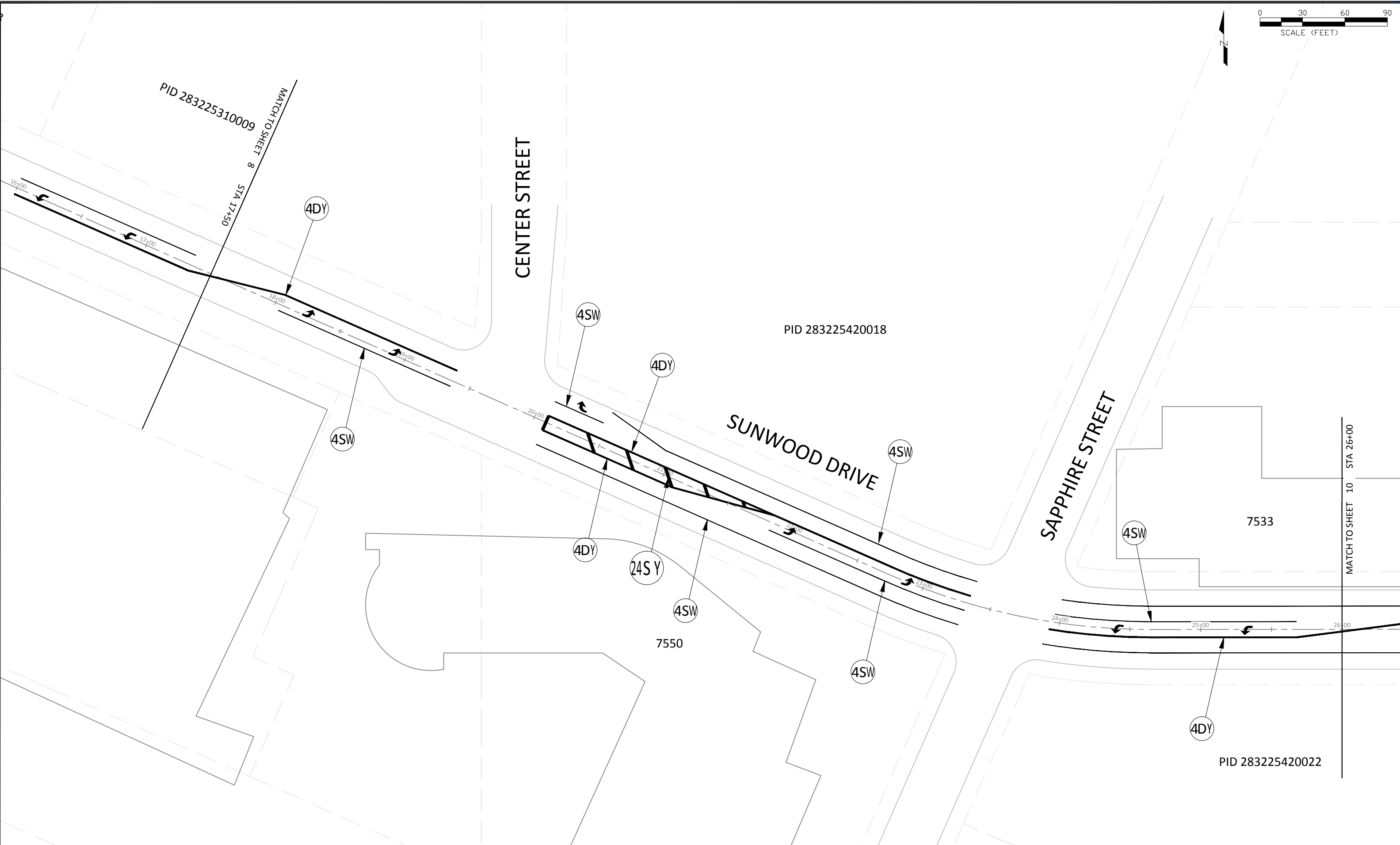
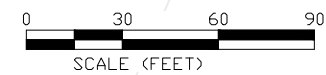

DATE	REVISION

I hereby certify that this plan, specification, or report was prepared by me or under my direct supervision and that I am a duly Licensed Professional Engineer under the laws of the State of Minnesota

BRUCE WESTBY
 Date 6/7/17 Lic. No. 40116

DESIGNED BY: JJJ
 DRAWN BY: JJJ
 CHECKED BY: BRW

DATE: 6/7/17
 FILE No. 17-04

CITY OF RAMSEY
 7550 SUNWOOD DRIVE
 RAMSEY, MN 55303
 (763) 427-1410 FAX (763) 433-9898

STRIPING PLAN STA. 17+50 TO 26+00

SUNWOOD DRIVE STRIPING IMPROVEMENTS
 CITY PROJECT NO. 17-04
 CITY OF RAMSEY, MINNESOTA

SHEET 9 OF 10 SHEETS

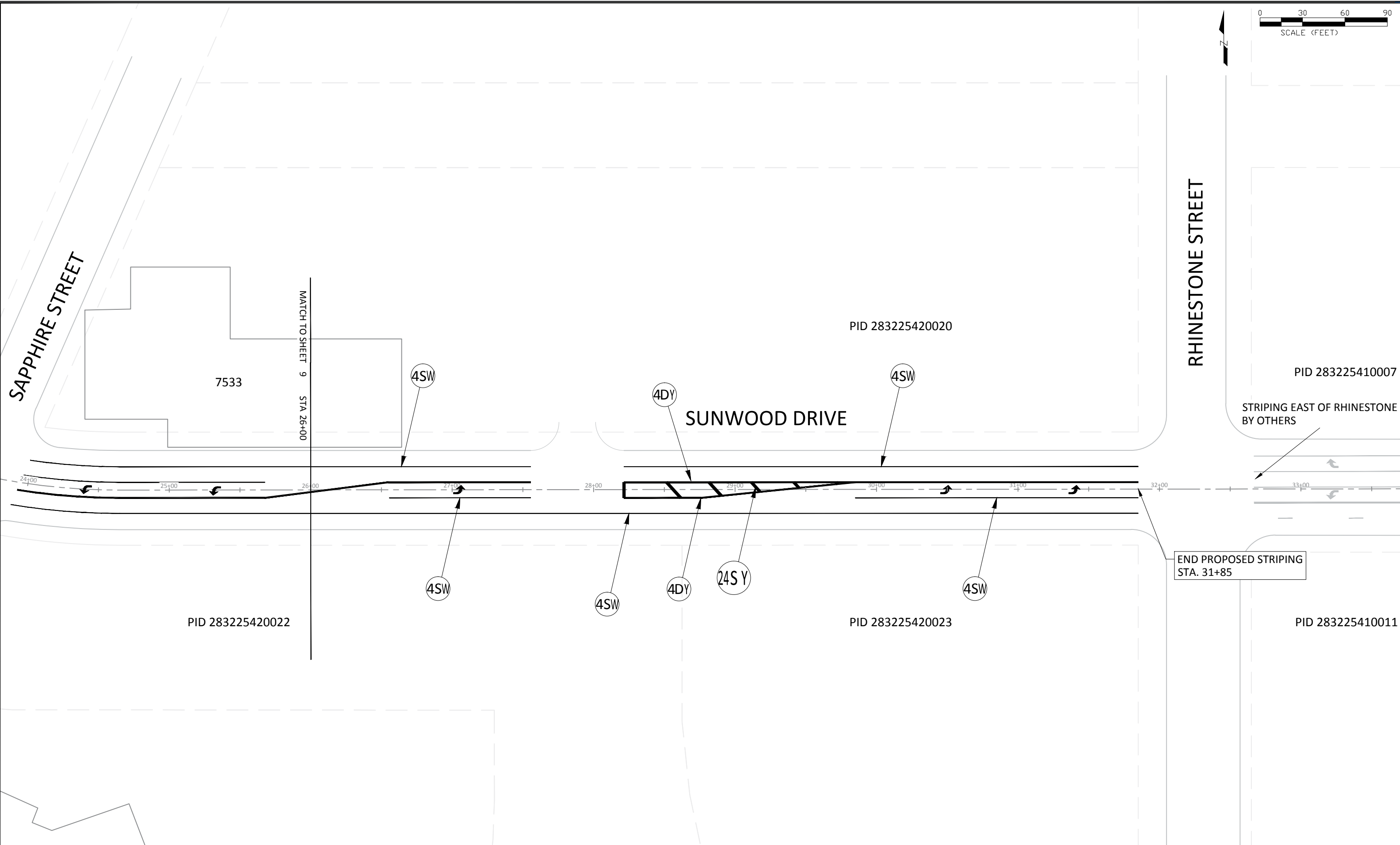
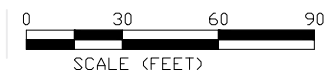

DATE	REVISION

I hereby certify that this plan, specification, or report was prepared by me or under my direct supervision and that I am a duly Licensed Professional Engineer under the laws of the State of Minnesota

BRUCE WESTBY
 Date 6/7/17 Lic. No. 40116

DESIGNED BY: JJJ
 DRAWN BY: JJJ
 CHECKED BY: BRW

DATE: 6/7/17
 FILE No. 17-04

CITY OF RAMSEY
 7550 SUNWOOD DRIVE
 RAMSEY, MN 55303
 (763) 427-1410 FAX (763) 433-9898

STRIPING PLAN STA. 26+00 TO 31+85

SUNWOOD DRIVE STRIPING IMPROVEMENTS
 CITY PROJECT NO. 17-04
 CITY OF RAMSEY, MINNESOTA

SHEET 10 OF 10 SHEETS