

CITY OF RAMSEY

RIVERS BEND STREET RECONSTRUCTIONS

147TH LANE, 148TH AVENUE, YAKIMA STREET, XKIMO STREET

CITY IMPROVEMENT PROJECT NO. 17-02

GOVERNING SPECIFICATIONS
 THE 2018 EDITION OF THE MINNESOTA DEPARTMENT OF TRANSPORTATION "STANDARD SPECIFICATIONS FOR CONSTRUCTION" SHALL GOVERN.

ALL FEDERAL, STATE AND LOCAL LAWS, REGULATIONS AND ORDINANCES SHALL BE COMPLIED WITH IN THE CONSTRUCTION OF THIS PROJECT.

ALL TRAFFIC CONTROL DEVICES AND SIGNING SHALL CONFORM TO THE MINNESOTA MANUAL ON UNIFORM TRAFFIC CONTROL DEVICES. INCLUDING THE FIELD MANUAL FOR TEMPORARY TRAFFIC CONTROL ZONE LAYOUTS.

SHEET INDEX

SHEET NO.	DESCRIPTION
1	TITLE SHEET
2	STATEMENT OF ESTIMATED QUANTITIES
3	TYPICAL SECTION
4	DETAILS
5 - 6	EXISTING CONDITIONS AND REMOVALS
7	EROSION CONTROL AND RESTORATION
8 - 9	STREET CONSTRUCTION

I hereby certify that this plan, specification, or report was prepared by me or under my direct supervision and that I am a duly Licensed Professional Engineer under the laws of the State of Minnesota.

Bruce Westby
BRUCE WESTBY, P.E.
 RAMSEY CITY ENGINEER

Lic. No. 40116

Date 2/14/18

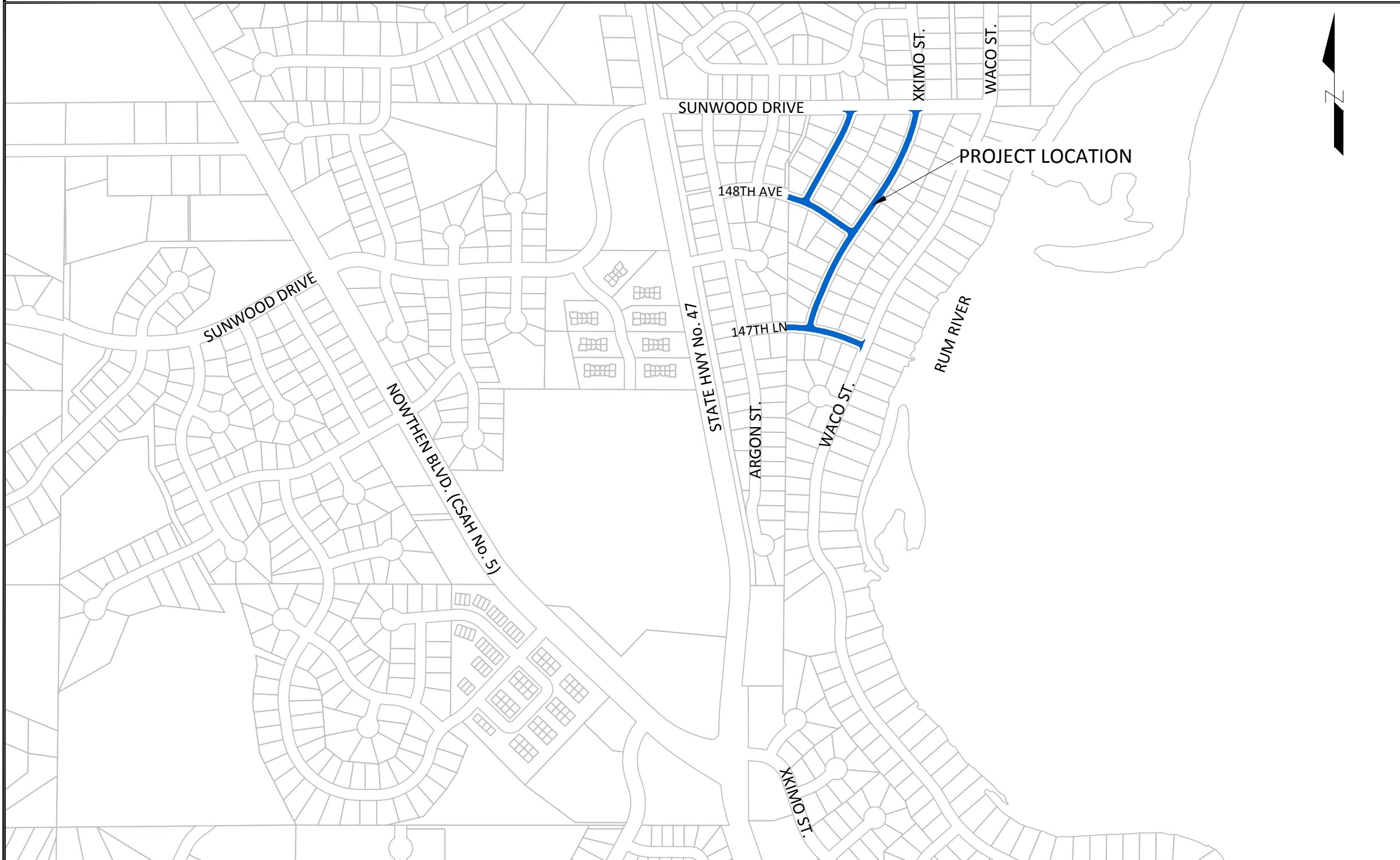

CITY OF RAMSEY
 7550 SUNWOOD DRIVE
 RAMSEY, MN 55303
 (763) 427-1410 FAX (763) 433-9898

NOTE: EXISTING UTILITY INFORMATION SHOWN ON THIS PLAN HAS BEEN PROVIDED BY THE UTILITY OWNER. THE CONTRACTOR SHALL FIELD VERIFY EXACT LOCATIONS PRIOR TO COMMENCING CONSTRUCTION AS REQUIRED BY STATE LAW. NOTIFY GOPHER STATE ONE CALL 1-800-252-1166 OR 651-454-0002



STATEMENT OF ESTIMATED QUANTITIES
17-02 RIVERS BEND STREET RECONSTRUCTIONS

PAGE NO.	NOTE	MNDOT NO.	ITEM DESCRIPTION	UNIT	ESTIMATED QUANTITY
		2021.501	MOBILIZATION	LS	1
5 - 6	1	2104.501	REMOVE CONCRETE CURB AND GUTTER	LF	1,105
5 - 6	1	2104.503	REMOVE CONCRETE PAVEMENT	SF	180
5 - 6	1	2104.505	REMOVE BITUMINOUS PAVEMENT	SY	32
5	1	2104.505	REMOVE CONCRETE VALLEY GUTTER	SY	70
5 - 6	1	2104.511	SAWING CONCRETE PAVEMENT - FULL DEPTH	LF	450
5 - 6	1	2104.513	SAWING BITUMINOUS PAVEMENT - FULL DEPTH	LF	300
7	2	2105.201	COMMON EXCAVATION (EV)	CY	26
5 - 6		2112.501	SUBGRADE PREPARATION	RDST	28
5 - 6		2130.501	WATER	MGAL	50
5 - 6	5	2215.501	BITUMINOUS PAVEMENT RECLAMATION (FULL-DEPTH)	SY	7,898
5 - 6	1	2232.501	MILL BITUMINOUS PAVEMENT (2' WIDTH X 1.5" DEPTH)	SY	48
8 - 9	7	2301.603	CURING COMPOUND FOR EXISTING CONCRETE CURB AND GUTTER	LF	4,253
3, 5 - 6	2, 5	2331.607	HAUL AND DISPOSE BIT PAVEMENT RECLAMATION (LV)	CY	921
8 - 9	3	2357.502	BITUMINOUS MATERIAL FOR TACK COAT	GAL	556
8 - 9	4	2360.501	TYPE SP 9.5 WEARING COURSE MIXTURE (SPWEA340C) (1.5")	TON	656
8 - 9	4	2360.502	TYPE SP 12.5 NON-WEARING COURSE MIXTURE (SPNWB330C) (2.0")	TON	869
8 - 9	4	2360.505	TYPE SP 9.5 WEARING COURSE MIXTURE (SPWEA340C) DRIVEWAYS (2.0")	TON	4
5 - 6		2504.602	ADJUST VALVE BOX	EA	9
5 - 6		2506.522	ADJUST FRAME AND RING CASTING	EA	14
9		2506.602	GROUT CATCH BASIN	EA	4
8 - 9		2531.501	CONCRETE CURB & GUTTER DESIGN SURMOUNTABLE	LF	875
8 - 9		2531.501	CONCRETE CURB & GUTTER DESIGN B618	LF	230
8 - 9		2531.507	6" CONCRETE DRIVEWAY PAVEMENT	SY	20
8		2531.604	7" CONCRETE VALLEY GUTTER	SY	68
7		2540.601	LANDSCAPE RESTORATION	LS	1
5 - 6	6	2563.601	TRAFFIC CONTROL	LS	1
7		2573.530	STORM DRAIN INLET PROTECTION	EA	8
7		2573.535	STABILIZED CONSTRUCTION EXIT	LS	2
7	2	2574.525	COMMON TOPSOIL BORROW (LV)	CY	31
7		2575.505	SODDING TYPE LAWN	SY	235

PAY ITEM NOTES:

- REMOVAL LIMITS SHALL BE MARKED IN THE FIELD BY CITY STAFF.
- EV TO CV CONVERSION FACTOR = 1.2.
- ESTIMATED QUANTITY BASED ON APPLICATION RATE OF 0.07 GAL/SY.
- ESTIMATED QUANTITY BASED ON APPLICATION RATE OF 110 LB/SY-IN.
- STOCKPILING OF BITUMINOUS PAVEMENT RECLAMATION IS INCIDENTAL TO THE HAUL BIT PAVEMENT RECLAMATION PAY ITEM. THERE ARE NO STOCKPILE OR STAGING AREAS AVAILABLE ON-SITE FOR STOCKPILING OF BITUMINOUS PAVEMENT RECLAMATION.
- LUMP SUM QUANTITY SHALL INCLUDE ALL COST REQUIRED FOR MAINTAINING ALL FLAGGING OPERATIONS AS NECESSARY, MAINTAINING PEDESTRIAN ACCESS ROUTES, ANY SIGNAGE AND BARRICADES AS NECESSARY.
- EXISTING CONCRETE CURB AND GUTTER SHALL BE COVERED WITH WHITE CURE. CONTRACTOR SHALL SWEEP CLEAN THE CONCRETE CURB AND GUTTER PRIOR TO PLACEMENT OF CURE.

GENERAL NOTES:

- THE LOCATIONS OF EXISTING UNDERGROUND UTILITIES ARE SHOWN IN AN APPROXIMATE WAY ONLY. IT IS NOT GUARANTEED ANY OR ALL EXISTING UTILITIES ARE SHOWN. THE CONTRACTOR SHALL DETERMINE THE EXACT LOCATION OF ALL EXISTING UTILITIES BEFORE COMMENCING WORK. HE AGREES TO BE FULLY RESPONSIBLE FOR ANY AND ALL DAMAGES WHICH MIGHT BE OCCASIONED BY HIS FAILURE TO EXACTLY LOCATE AND PRESERVE ANY AND ALL UNDERGROUND UTILITIES.
- THE CONTRACTOR SHALL DETERMINE THE EXACT LOCATION OF ALL EXISTING IRRIGATION SYSTEMS WITHIN THE PROJECT CONSTRUCTION LIMITS BEFORE COMMENCING WORK. THE CONTRACTOR IS RESPONSIBLE FOR AVOIDING DAMAGE TO IRRIGATION SYSTEMS WHERE POSSIBLE.

DATE	REVISION

I hereby certify that this plan, specification, or report was prepared by me or under my direct supervision and that I am a duly Licensed Professional Engineer under the laws of the State of Minnesota

Bruce Westby
BRUCE WESTBY
 Date 2/14/18 Lic. No. 40116

DESIGNED BY: JJJ
 DRAWN BY: JJJ
 CHECKED BY: BRW
 DATE: 2/14/18
 FILE No. 17-01

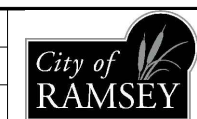

CITY OF RAMSEY
 7550 SUNWOOD DRIVE
 RAMSEY, MN 55303
 (763) 427-1410 FAX (763) 433-9898

STATEMENT OF ESTIMATED QUANTITIES

RIVERS BEND STREET RECONSTRUCTIONS
CITY PROJECT NO. 17-02
 CITY OF RAMSEY, MINNESOTA

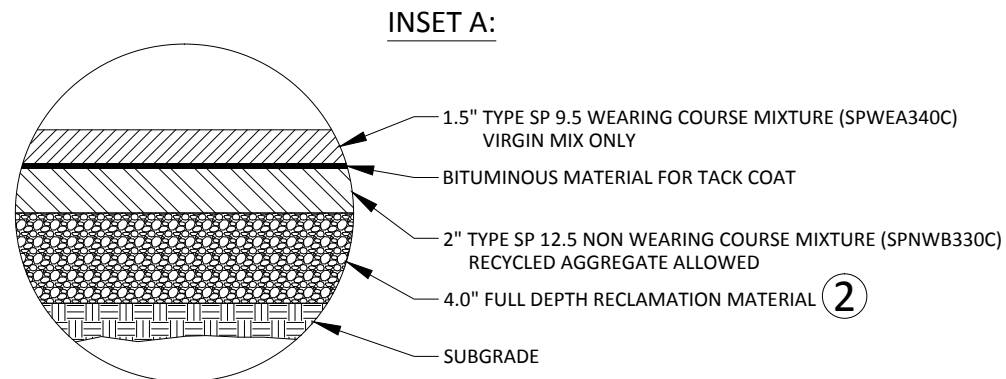
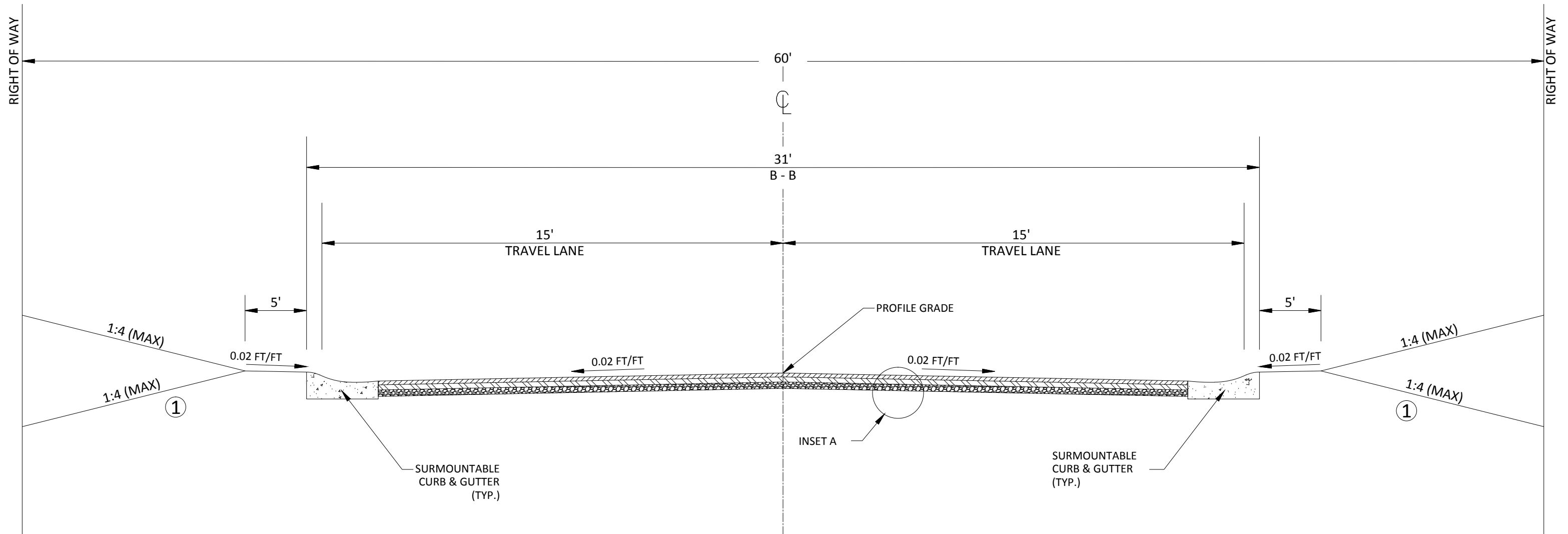

REFERENCE NOTES:

- ① GRADE TO MATCH EXISTING GROUND. ESTABLISH TURF USING A MINIMUM OF 4" COMMON TOPSOIL BORROW AND SODDING TYPE LAWN. SEE CITY PLATE NO. ERO-6 FOR COMMON TOPSOIL BORROW.
- ② FULL DEPTH RECLAMATION MUST PASS CITY OF RAMSEY MODIFIED CLASS 5 AGGREGATE BASE GRADATION. SEE CITY PLATE NO. STR-26. MATERIAL SHALL BE SHAPED AND COMPACTED ACCORDING TO THE SPECIFIED DENSITY METHOD.

DATE	REVISION

I hereby certify that this plan, specification, or report was prepared by me or under my direct supervision and that I am a duly Licensed Professional Engineer under the laws of the State of Minnesota.

Bruce Westby
 BRUCE WESTBY
 Date: 2/14/18 Lic. No. 40116

DESIGNED BY: JJF
 DRAWN BY: JJF
 CHECKED BY: BRW
 DATE: 2/14/18
 FILE No. 17-01

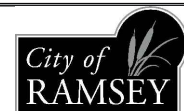

CITY OF RAMSEY
 7550 SUNWOOD DRIVE
 RAMSEY, MN 55303
 (763) 427-1410 FAX (763) 433-9898

TYPICAL SECTION

RIVERS BEND STREET RECONSTRUCTIONS
 CITY PROJECT NO. 17-02
 CITY OF RAMSEY, MINNESOTA

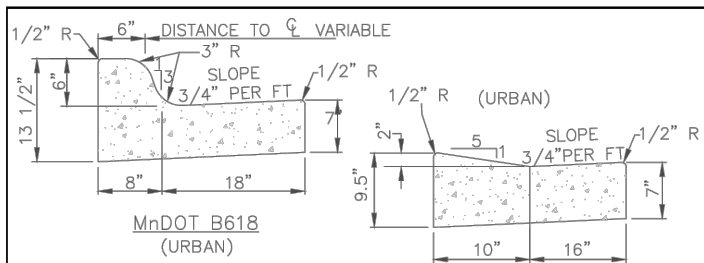

DRIVEWAY FOR B618

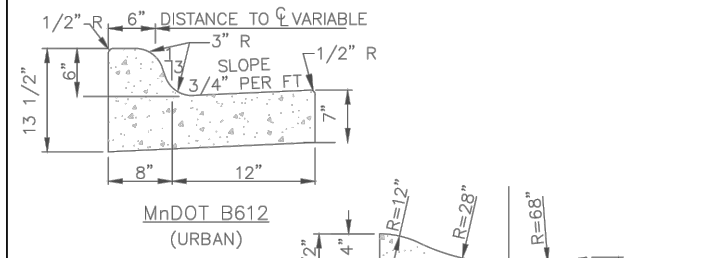

SURMOUNTABLE

- NOTES:
- ON WEAR COURSE MILL THE EXISTING BITUMINOUS 1.5" BY 24" IN FRONT OF THE REPLACEMENT CURB.
 - ON BASE COURSE SAW CUT AND REMOVE EXISTING BITUMINOUS 18" IN FRONT OF THE REPLACEMENT CURB.

APPROVED:
1 - 2016



STANDARD DETAILS:
CURB AND GUTTER

CITY PLATE No.
STR-1

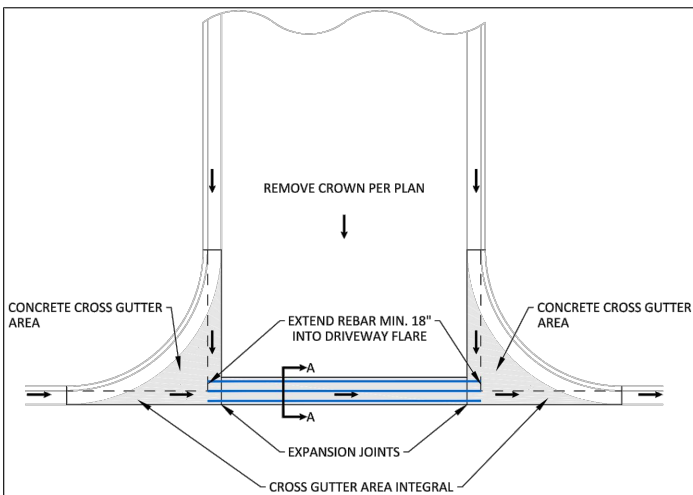

PLAN

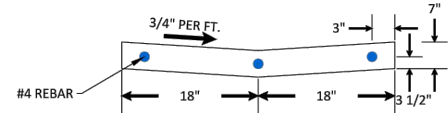

SECTION A-A

NOTE: NOT TO SCALE

- NOTES:
- WITH REMOVAL OF EXISTING CURB AT A STREET, MILL BITUMINOUS TO A DEPTH OF 1.5" AND A WIDTH OF 18" IN EXISTING STREET.
 - TO BE USED WHENEVER CROSS DRAINAGE IS < 2%.
 - CONCRETE CURB AND GUTTER SHALL BE CAST INTEGRAL WITH CONCRETE CROSS GUTTER AREA.
 - CONCRETE CURB AND GUTTER SHALL BE PAID SEPARATELY FROM CONCRETE CROSS GUTTER AREA.

APPROVED:
3 - 2017



STANDARD DETAILS:
CROSS GUTTER

CITY PLATE No.
STR-2

TABLE A MODIFIED CLASS 5 SPECIFICATIONS

% PASSING

1"	100
3/4"	90 - 100
3/8"	50 - 80
No.4	35 - 70
No.10	20 - 60
No.40	10 - 35
No.200	5 - 10

- NOTES:
- THE AGGREGATE BASE CONSTRUCTION WILL BE ACCEPTED FOR PAYMENT IN ACCORDANCE WITH THE PROVISIONS IN TABLE A.
 - IF THE AGGREGATE BASE FAILS TO MEET THE REQUIREMENTS OF TABLE A THE MATERIAL CAN BE CORRECTED IN PLACE OR REMOVED AND REPLACED WITH MATERIAL THAT MEET THE REQUIREMENTS OF TABLE A.
 - IN THE EVENT THAT RECYCLED MATERIAL IS USE IT MUST MEET MNDOT REQUIREMENTS FOR RECYCLED BASE.

APPROVED:
2 - 2003



STANDARD DETAILS:
MODIFIED CLASS 5
SPECIFICATIONS

CITY PLATE No.
STR-26

- NOTES:
- BITUMINOUS SHALL BE SAWCUT AND REMOVED
 - CLASS 5 AND BITUMINOUS COURSES SHALL BE MECHANICALLY COMPACTED.
 - SEE CITY PLATE STR-26 FOR MODIFIED CLASS 5 SPECIFICATIONS.

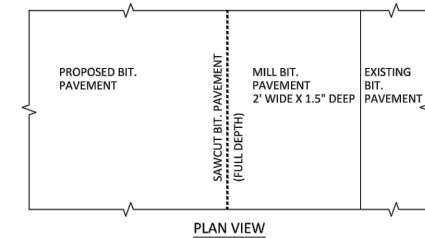

PLAN VIEW

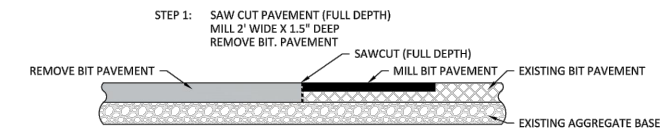

SECTION VIEW

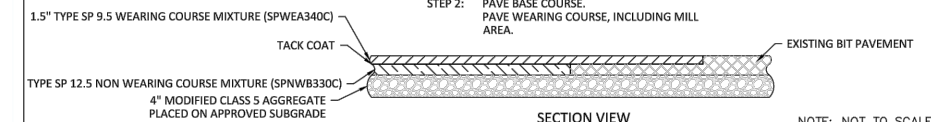

NOTE: NOT TO SCALE.

APPROVED:
3 - 2017



CITY PLATE No.
STR-31

STANDARD DETAILS:
STREET TIE-IN

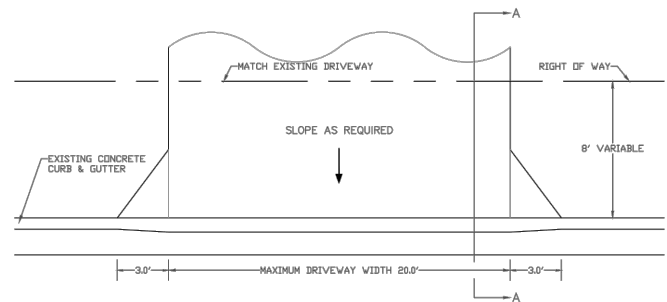

SECTION A-A

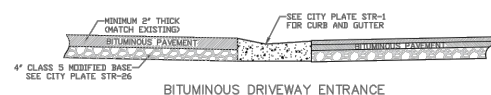
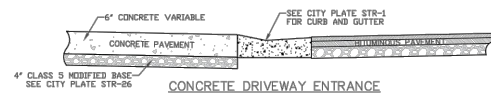

- NOTES:
- PANEL WIDTH SHALL NOT EXCEED 10 FT. WITHOUT A CENTERLINE CONSTRUCTION JOINT.
 - CONCRETE DRIVEWAY TO BE ONE COURSE CONCRETE PAVEMENT. (SEE SPECIAL PROVISIONS FOR CLASS OF CONCRETE.)
 - CONCRETE DRIVEWAYS TO BE 6" THICK.
 - 1/2" EXPANSION JOINT, 1/2" PREFORMED JOINT FILLER MATERIAL, AASHTO M 213 (REQUIRED WHEN 2 CONCRETE AREAS ARE POURED SEPARATELY.)
 - BITUMINOUS DRIVEWAYS MINIMUM 2" THICK, MATCH EXISTING BITUMINOUS PAVEMENT THICKNESS.

APPROVED:
1 - 2016



STANDARD DETAILS:
RESIDENTIAL DRIVEWAY -
NO SIDEWALK

CITY PLATE No.
STR-30

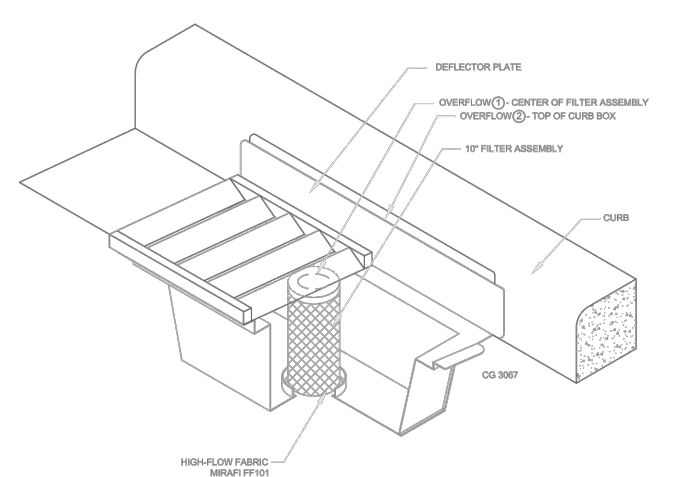

INLET PROTECTION - WIMCO OR EQUAL

N.T.S.

- NOTE:
- THIS INLET PROTECTION SHALL BE USED IMMEDIATELY FOLLOWING CURB & GUTTER CONSTRUCTION. INLET PROTECTION SHALL REMAIN INSTALLED AND MAINTAINED UNTIL ALL HOME CONSTRUCTION IS COMPLETE.

APPROVED:
1 - 2016



STANDARD DETAILS:
INLET PROTECTION

CITY PLATE No.
ERO-2

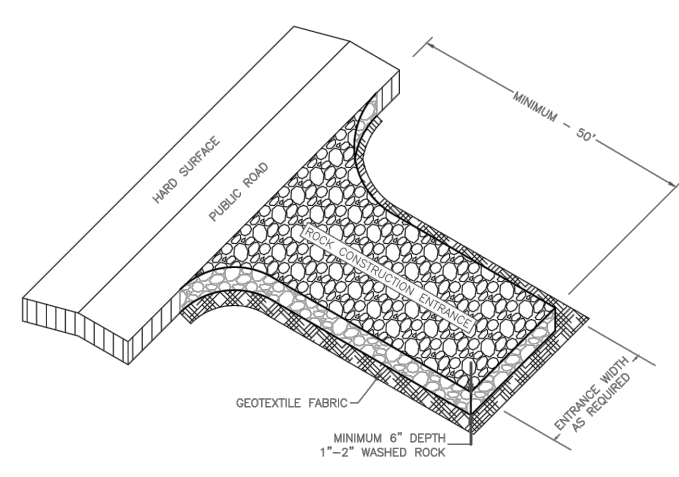

NOT TO SCALE

- NOTE:
- MINIMUM CONSTRUCTION ENTRANCE WIDTH EQUAL TO PROPOSED ROADWAY WIDTH.
 - WIDTH OF RADIUS AS REQUIRED TO ENSURE VEHICLES DO NOT TRACK ONTO PUBLIC ROAD.
 - MAINTENANCE AS REQUIRED TO PREVENT TRACKING ONTO PUBLIC ROADS. THIS MAY REQUIRE TOP DRESSING WITH ADDITIONAL ROCK OR REMOVAL AND REINSTALLATION OF THE ENTRANCE AS NEEDED.

APPROVED:
1 - 2016



STANDARD DETAILS:
ROCK CONSTRUCTION ENTRANCE

CITY PLATE No.
ERO-5

MNDOT 2016 SPEC

MNDOT 2016 SPEC TABLE 3877-1 COMMON TOPSOIL BORROW REQUIREMENT		
REQUIREMENT	RANGE	TEST METHOD
MATERIAL PASSING THE 3/4 IN [19MM]	100%	ASTM D 422
MATERIAL PASSING NO. 4 [4.75MM]	>85%	-
CLAY	5% - 35%	ASTM D 422
SILT	5% - 70%	ASTM D 422
SAND	10% - 75%	ASTM D 422
ORGANIC MATTER	3% - 15%	ASTM D 2974
pH	6.1-7.8	ASTM G 51

- NOTE:
- INSTALLATION OF 4" OF TOPSOIL MEETING MNDOT SPECIFICATION 3877A COMMON TOPSOIL BORROW, MAY BE REQUIRED ACROSS ALL DISTURBED AREAS.
 - A SOIL CERTIFICATION FROM A GEOTECHNICAL FIRM MUST BE PROVIDED VERIFYING THE TOPSOIL MEETS SPECIFICATION ALONG WITH LOAD TICKETS TO VERIFY THE SOURCE OF MATERIAL AND QUANTITY.
 - TOPSOIL MUST COME FROM A CITY APPROVED SOURCE.

APPROVED:
1 - 2016



CITY PLATE No.
ERO-6

STANDARD DETAILS:
TOPSOIL REQUIREMENTS

DATE	REVISION

I hereby certify that this plan, specification, or report was prepared by me or under my direct supervision and that I am a duly Licensed Professional Engineer under the laws of the State of Minnesota

Bruce Westby
BRUCE WESTBY
Date: 2/14/18 Lic. No. 40116

DESIGNED BY:
JJF
DRAWN BY:
JJF
CHECKED BY:
BRW

DATE:
2/14/18
FILE No.
17-01

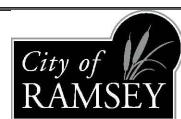

CITY OF RAMSEY
7550 SUNWOOD DRIVE
RAMSEY, MN 55303
(763) 427-1410 FAX (763) 433-9898

DETAILS

RIVERS BEND STREET RECONSTRUCTIONS
CITY PROJECT NO. 17-02
CITY OF RAMSEY, MINNESOTA

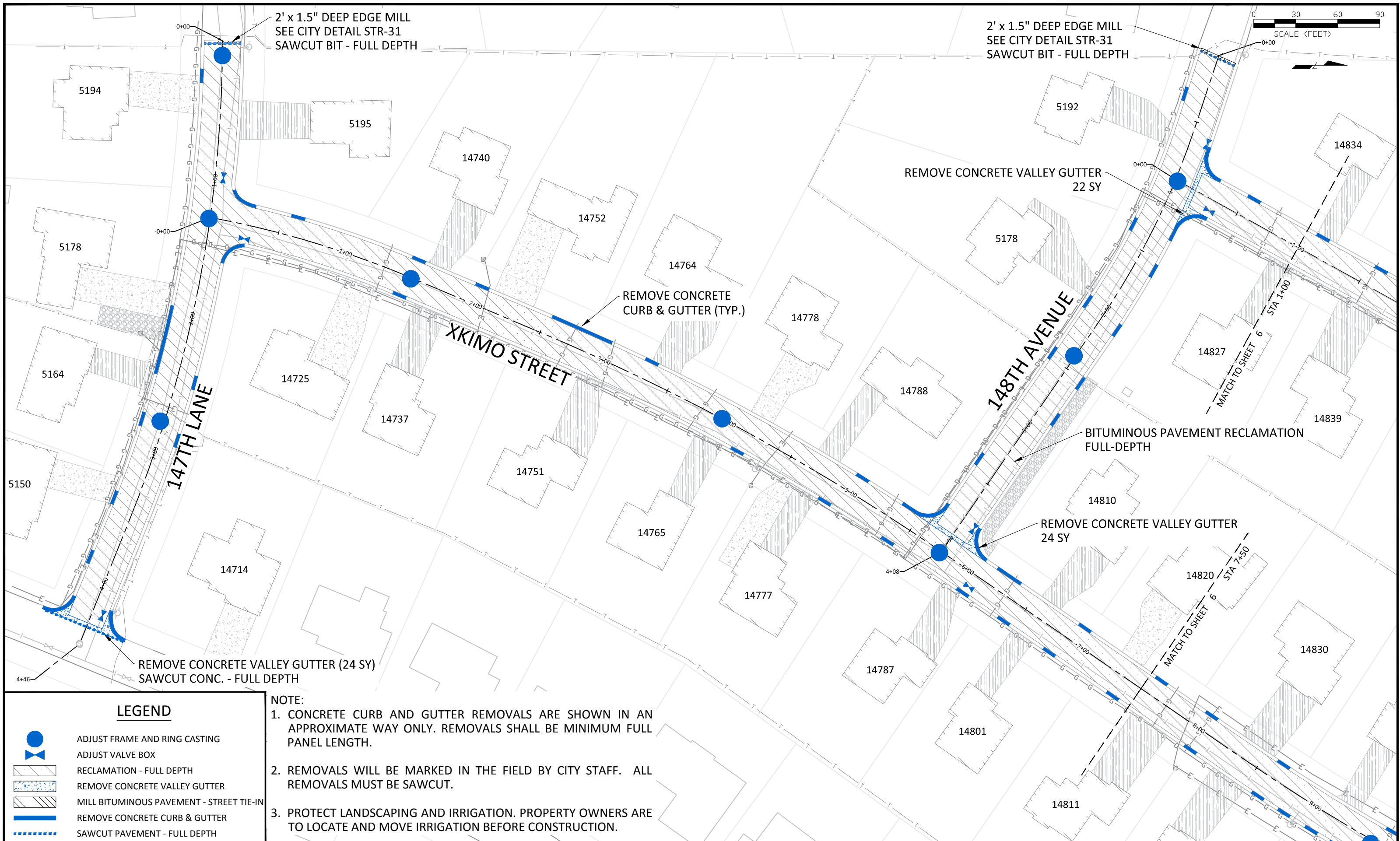

LEGEND

- ADJUST FRAME AND RING CASTING
- ADJUST VALVE BOX
- RECLAMATION - FULL DEPTH
- REMOVE CONCRETE VALLEY GUTTER
- MILL BITUMINOUS PAVEMENT - STREET TIE-IN
- REMOVE CONCRETE CURB & GUTTER
- SAWCUT PAVEMENT - FULL DEPTH

NOTE:

1. CONCRETE CURB AND GUTTER REMOVALS ARE SHOWN IN AN APPROXIMATE WAY ONLY. REMOVALS SHALL BE MINIMUM FULL PANEL LENGTH.
2. REMOVALS WILL BE MARKED IN THE FIELD BY CITY STAFF. ALL REMOVALS MUST BE SAWCUT.
3. PROTECT LANDSCAPING AND IRRIGATION. PROPERTY OWNERS ARE TO LOCATE AND MOVE IRRIGATION BEFORE CONSTRUCTION.

DATE	REVISION

I hereby certify that this plan, specification, or report was prepared by me or under my direct supervision and that I am a duly Licensed Professional Engineer under the laws of the State of Minnesota

Bruce Westby
BRUCE WESTBY
Date: 2/14/18 Lic. No. 40116

DESIGNED BY: JJF
DRAWN BY: JJF
CHECKED BY: BRW

DATE: 2/14/18
FILE No. 17-01

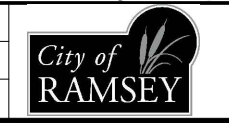

CITY OF RAMSEY
7550 SUNWOOD DRIVE
RAMSEY, MN 55303
(763) 427-1410 FAX (763) 433-9898

EXISTING CONDITIONS AND REMOVALS

RIVERS BEND STREET RECONSTRUCTIONS
CITY PROJECT NO. 17-02
CITY OF RAMSEY, MINNESOTA

2' x 1.5" DEEP EDGE MILL
SEE CITY DETAIL STR-31
SAWCUT BIT - FULL DEPTH

SUNWOOD DRIVE

2' x 1.5" DEEP EDGE MILL
SEE CITY DETAIL STR-31
SAWCUT BIT - FULL DEPTH

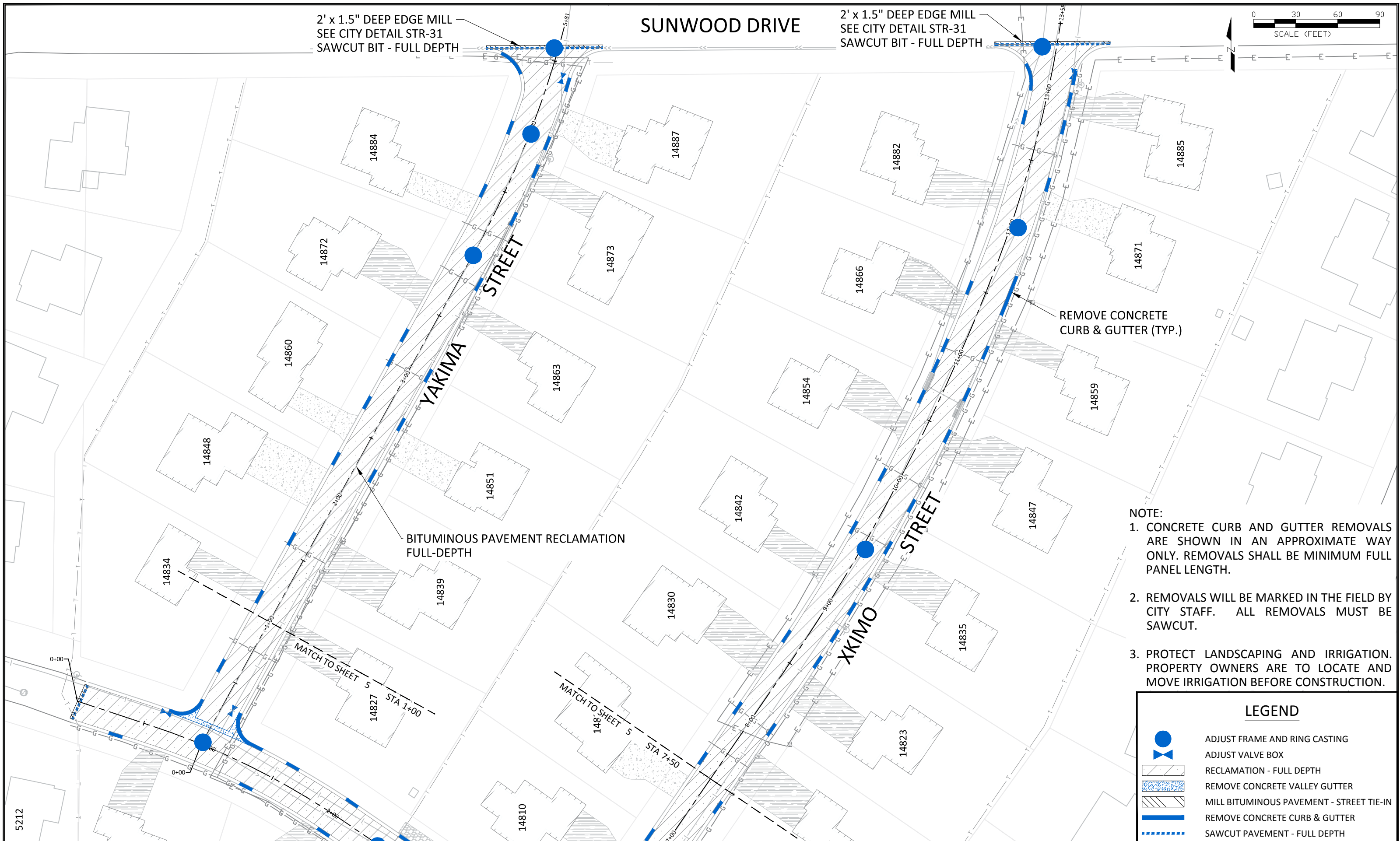

REMOVE CONCRETE CURB & GUTTER (TYP.)

BITUMINOUS PAVEMENT RECLAMATION FULL-DEPTH

- NOTE:**
1. CONCRETE CURB AND GUTTER REMOVALS ARE SHOWN IN AN APPROXIMATE WAY ONLY. REMOVALS SHALL BE MINIMUM FULL PANEL LENGTH.
 2. REMOVALS WILL BE MARKED IN THE FIELD BY CITY STAFF. ALL REMOVALS MUST BE SAWCUT.
 3. PROTECT LANDSCAPING AND IRRIGATION. PROPERTY OWNERS ARE TO LOCATE AND MOVE IRRIGATION BEFORE CONSTRUCTION.

LEGEND

- ADJUST FRAME AND RING CASTING
- ADJUST VALVE BOX
- RECLAMATION - FULL DEPTH
- REMOVE CONCRETE VALLEY GUTTER
- MILL BITUMINOUS PAVEMENT - STREET TIE-IN
- REMOVE CONCRETE CURB & GUTTER
- SAWCUT PAVEMENT - FULL DEPTH

5212

DATE	REVISION

I hereby certify that this plan, specification, or report was prepared by me or under my direct supervision and that I am a duly Licensed Professional Engineer under the laws of the State of Minnesota

Bruce Westby
BRUCE WESTBY
Date: 2/14/18 Lic. No. 40116

DESIGNED BY: JJF
DRAWN BY: JJF
CHECKED BY: BRW

DATE: 2/14/18
FILE No. 17-01

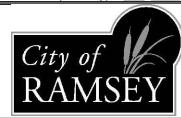

CITY OF RAMSEY
7550 SUNWOOD DRIVE
RAMSEY, MN 55303
(763) 427-1410 FAX (763) 433-9898

EXISTING CONDITIONS AND REMOVALS

RIVERS BEND STREET RECONSTRUCTIONS
CITY PROJECT NO. 17-02
CITY OF RAMSEY, MINNESOTA

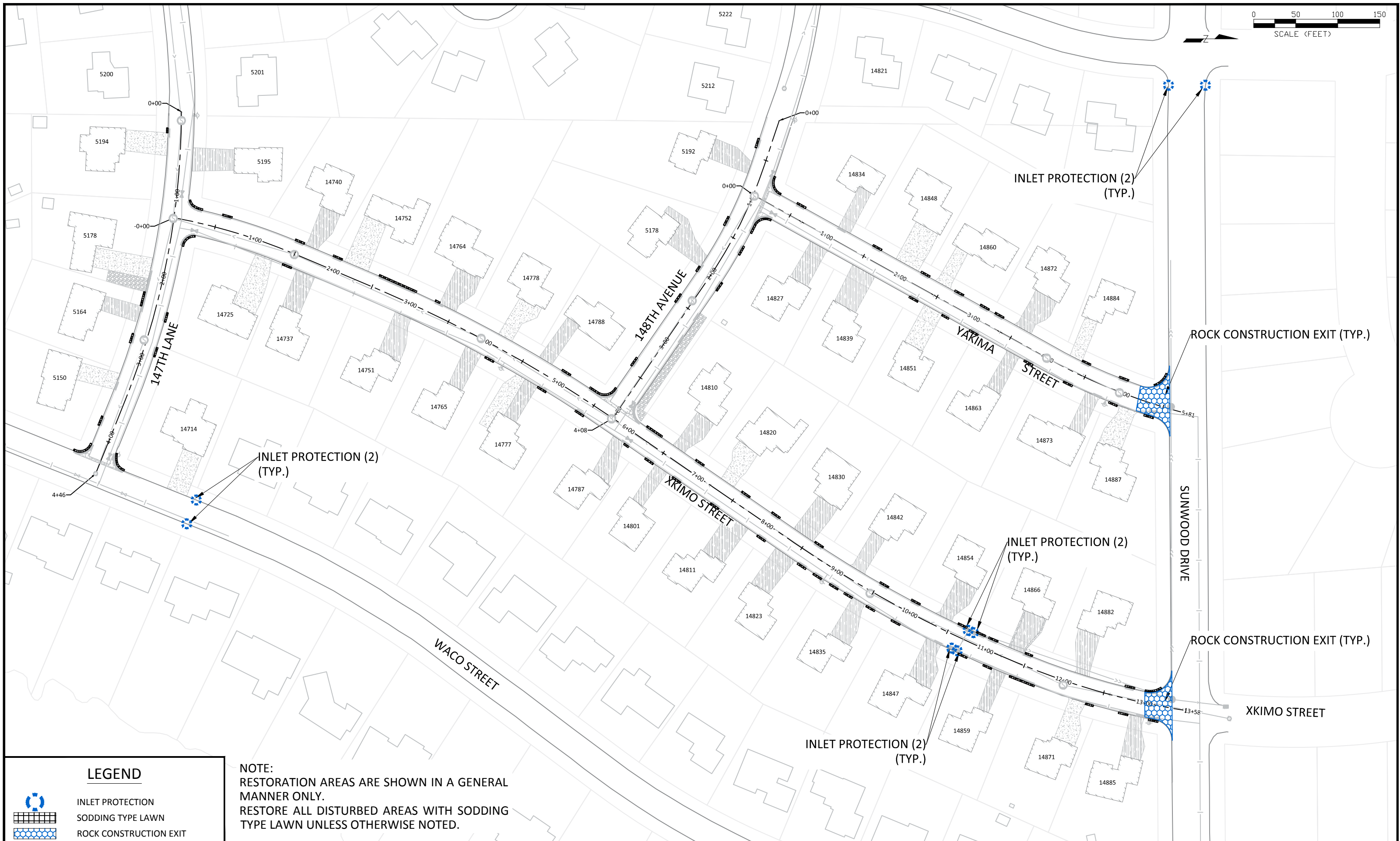

LEGEND

	INLET PROTECTION
	SODDING TYPE LAWN
	ROCK CONSTRUCTION EXIT

NOTE:
RESTORATION AREAS ARE SHOWN IN A GENERAL MANNER ONLY.
RESTORE ALL DISTURBED AREAS WITH SODDING TYPE LAWN UNLESS OTHERWISE NOTED.

DATE	REVISION

I hereby certify that this plan, specification, or report was prepared by me or under my direct supervision and that I am a duly Licensed Professional Engineer under the laws of the State of Minnesota

Bruce Westby
BRUCE WESTBY
Date: 2/14/18 Lic. No. 40116

DESIGNED BY: JJF
DRAWN BY: JJF
CHECKED BY: BRW

DATE: 2/14/18
FILE No. 17-01

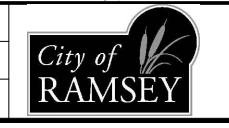

CITY OF RAMSEY
7550 SUNWOOD DRIVE
RAMSEY, MN 55303
(763) 427-1410 FAX (763) 433-9898

EROSION CONTROL AND RESTORATION

RIVERS BEND STREET RECONSTRUCTIONS
CITY PROJECT NO. 17-02
CITY OF RAMSEY, MINNESOTA

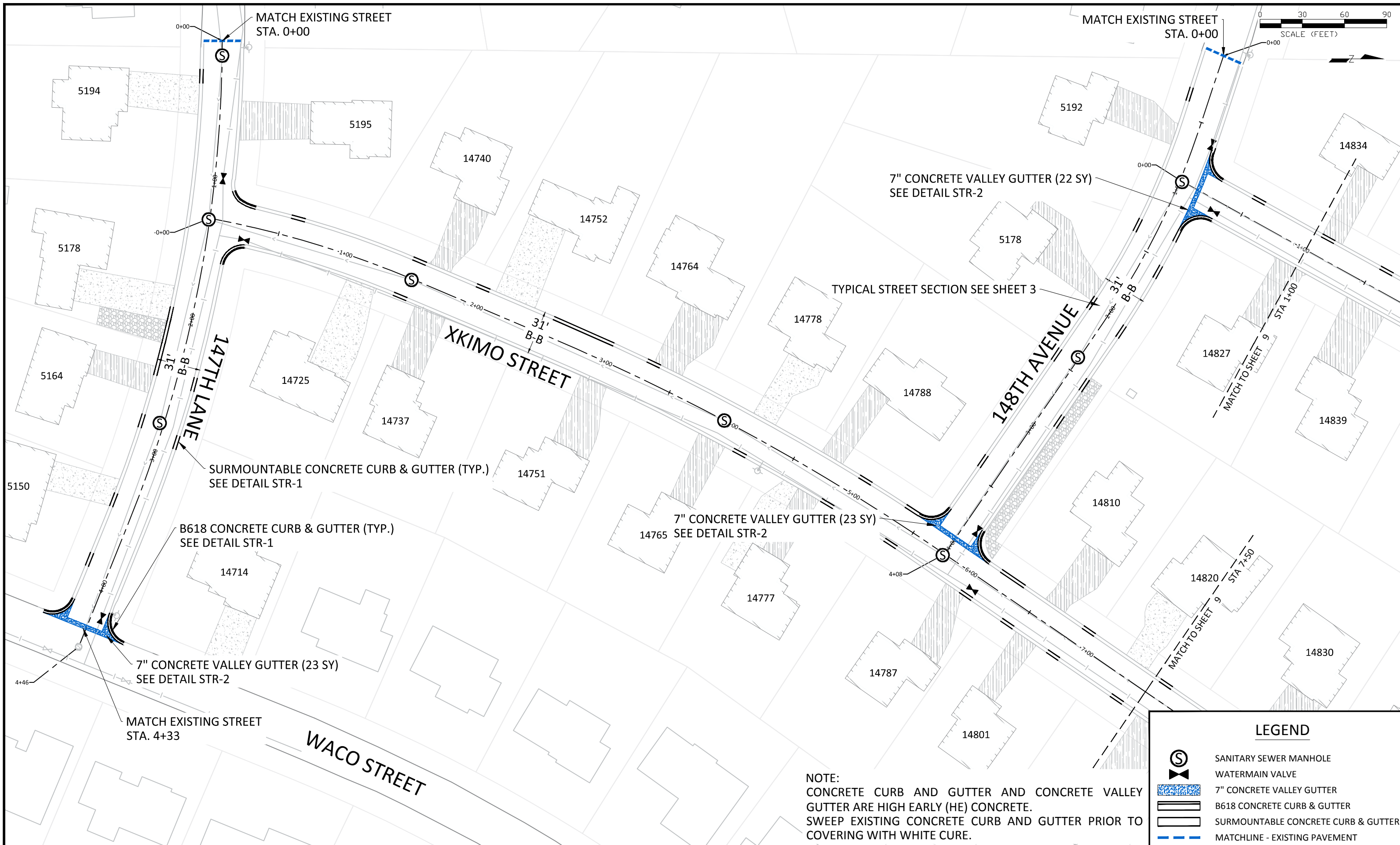

LEGEND	
	SANITARY SEWER MANHOLE
	WATERMAIN VALVE
	7" CONCRETE VALLEY GUTTER
	B618 CONCRETE CURB & GUTTER
	SURMOUNTABLE CONCRETE CURB & GUTTER
	MATCHLINE - EXISTING PAVEMENT

NOTE:
 CONCRETE CURB AND GUTTER AND CONCRETE VALLEY GUTTER ARE HIGH EARLY (HE) CONCRETE.
 SWEEP EXISTING CONCRETE CURB AND GUTTER PRIOR TO COVERING WITH WHITE CURE.

DATE	REVISION

I hereby certify that this plan, specification, or report was prepared by me or under my direct supervision and that I am a duly Licensed Professional Engineer under the laws of the State of Minnesota.
 BRUCE WESTBY
 Date: 2/14/18 Lic. No. 40116

DESIGNED BY: JJF
 DRAWN BY: JJF
 CHECKED BY: BRW
 DATE: 2/14/18
 FILE NO.: 17-01

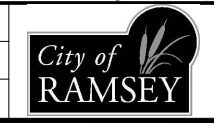

CITY OF RAMSEY
 7550 SUNWOOD DRIVE
 RAMSEY, MN 55303
 (763) 427-1410 FAX (763) 433-9898

STREET CONSTRUCTION

RIVERS BEND STREET RECONSTRUCTIONS
 CITY PROJECT NO. 17-02
 CITY OF RAMSEY, MINNESOTA

MATCH EXISTING STREET
STA. 5+62

SUNWOOD DRIVE

MATCH EXISTING STREET
STA. 13+37









B618 CONCRETE CURB & GUTTER (TYP.)
SEE DETAIL STR-1

SURMOUNTABLE CONCRETE CURB & GUTTER (TYP.)
SEE DETAIL STR-1

GROUT CATCH BASIN (4)

NOTE:
CONCRETE CURB AND GUTTER AND CONCRETE VALLEY
GUTTER ARE HIGH EARLY (HE) CONCRETE.
SWEEP EXISTING CONCRETE CURB AND GUTTER PRIOR TO
COVERING WITH WHITE CURE.

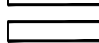
LEGEND

-  GROUT CATCH BASIN
-  SANITARY SEWER MANHOLE
-  WATERMAIN VALVE
-  STORM SEWER MANHOLE
-  7" CONCRETE VALLEY GUTTER
-  B618 CONCRETE CURB & GUTTER
-  SURMOUNTABLE CONCRETE CURB & GUTTER
-  MATCHLINE - EXISTING PAVEMENT

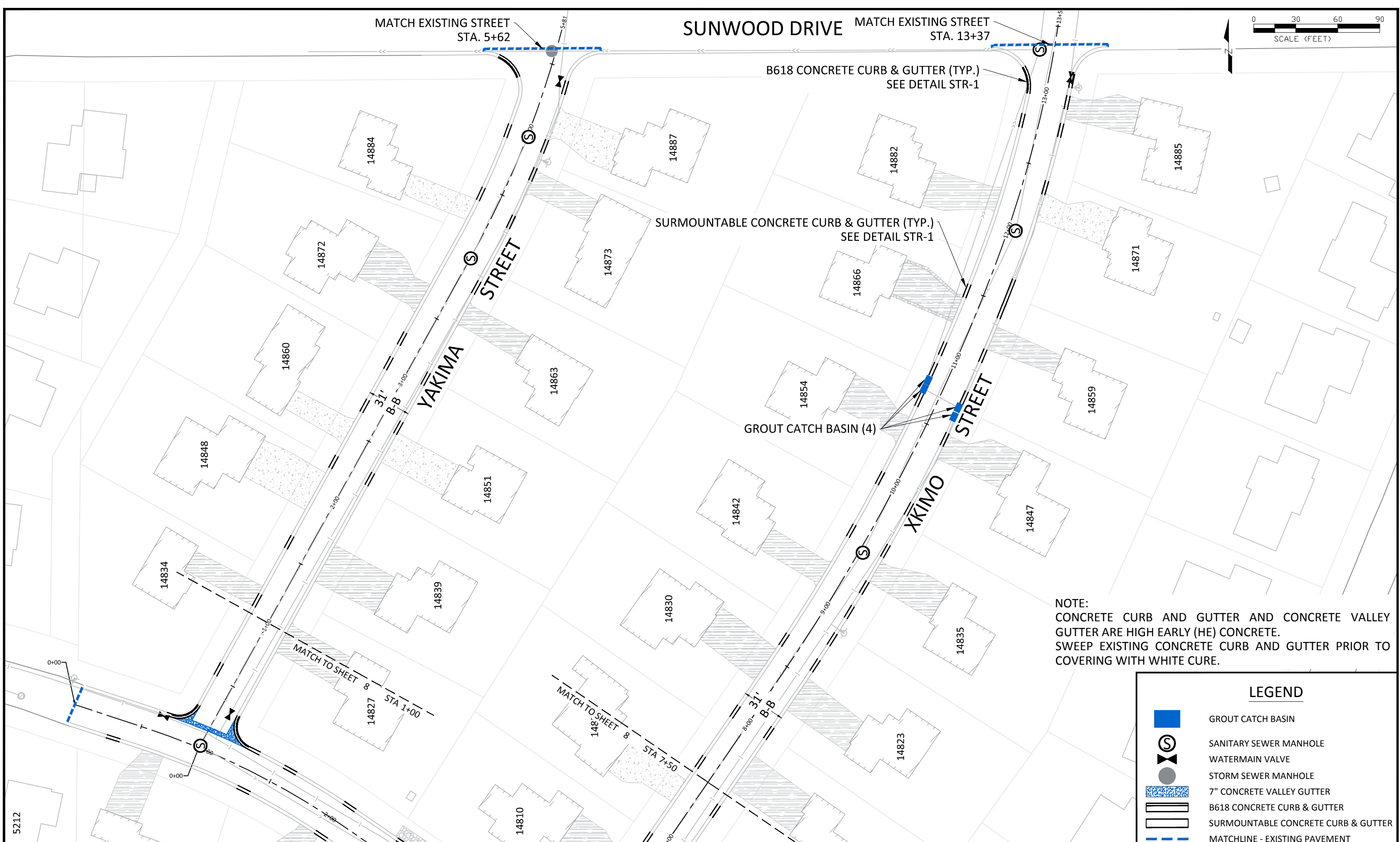

5212

DATE	REVISION

I hereby certify that this plan, specification, or report was prepared by me or under my direct supervision and that I am a duly Licensed Professional Engineer under the laws of the State of Minnesota

Bruce Westby
BRUCE WESTBY
Date: 2/14/18 Lic. No. 40116

DESIGNED BY: JJJ
DRAWN BY: JJJ
CHECKED BY: BRW

DATE: 2/14/18
FILE No. 17-01

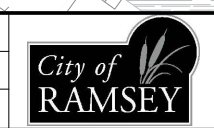

CITY OF RAMSEY
7550 SUNWOOD DRIVE
RAMSEY, MN 55303
(763) 427-1410 FAX (763) 433-9898

STREET CONSTRUCTION

RIVERS BEND STREET RECONSTRUCTIONS
CITY PROJECT NO. 17-02
CITY OF RAMSEY, MINNESOTA