

QTY.	KEY	COMMON NAME	BOTANICAL NAME	SIZE	MTHD	REMARKS
6	AB	AUTUMN BLAZE MAPLE	ACER SACCHARUM	2.5" CAL.	BB	
5	HL	IMPERIAL HONEYLOCUST	GLEDITSIA TRICANTHOS	2.5" CAL.	BB	
3	BH	BLACK HILLS SPRING SNOW CRAB	PICEA GLAUCA DENSAATA	6' TALL	BB	
2	SS	SPRING SNOW CRAB	MALUS SPRING SNOW	1.5" CAL.	BB	
2	KL	DWARF KOREAN LILAC	SYRINGA VILLOSA	1" CAL.	BB	
6	FI	FALSE INDIGO	AMORPHA FRUITICOSA	2.4" TALL	CONT.	
20	GS	GLOBE GOLDMOUND SPIREA	SPIREA X BURKALDA 'GOLDMOUND'	2.4" TALL	CONT.	
4	GA	GLOBE ARBOREVIATAE	THUJA OCCIDENTALIS	2.4" TALL	CONT.	

- LANDSCAPE NOTES:**
1. SEED/SOD AREAS AS SHOWN ON THE PLAN.
 2. SEE PLAN FOR PLANTINGS LOCATED IN ROCK MULCH BED. ROCK MULCH BEDS SEPARATED FROM SOD BY BLACK VINYL EDGER. OTHER PLANTINGS TO HAVE WOOD MULCH RING TO PREVENT WEED GROWTH AND CONSERVE WATER.
 3. UNDERGROUND IRRIGATION SYSTEM TO BE PROVIDED FOR ALL FOUNDATION PLANTINGS AND TURF AREAS. PROVIDE MOISTURE SENSOR IRRIGATION DESIGN BY CONTRACTOR.
 4. SEE PLAN FOR EXISTING TREES TO BE SAVED OR REMOVED.

LANDSCAPING REQUIREMENTS

TREES:
81'4" Lot Perimeter @ 1/50 = 16 Trees Required
16 Trees Provided

SHRUBS:
9,728 Building s.f. @ 1/300 = 32 Shrubs Required
32 Shrubs Provided

TREE INVENTORY	TAG	SPECIES NAME	CALIPPER	SAVED	REMOVED
	3	NORTHERN RED OAK	13	-	13
	4	NORTHERN RED OAK	8	-	8
	5	BUR OAK	19	-	19
	6	BUR OAK	5	-	5
	7	BUR OAK	6	-	6
	8	BUR OAK	16	-	16
	10	SIBERIAN ELM	5	-	5
	11	NORTHERN RED OAK	20	-	20
	12	BUR OAK	5	-	5
	13	BUR OAK	6	-	6
	14	BUR OAK	6	-	6
	15	BUR OAK	4	-	4
	16	BUR OAK	9	-	9
	17	BUR OAK	5	-	5
	18	SIBERIAN OAK	12	-	12
	19	BUR OAK	6	-	6
	20	BUR OAK	10	-	10
	21	BUR OAK	5	-	5
	22	BUR OAK	5	-	5
	23	BUR OAK	7	-	7
	24	BUR OAK	6	-	6
	26	BUR OAK	5	-	5
	27	BUR OAK	7	-	7
	28	BUR OAK	6	-	6
	30	BUR OAK	18	-	18
	31	NORTHERN RED OAK	18	-	18
	34	COTTONWOOD	19	-	19
	35	COTTONWOOD	17	-	17
	36	NORTHERN RED OAK	7	-	7
	37	NORTHERN RED OAK	8	-	8
	38	NORTHERN RED OAK	6	-	6
	39	NORTHERN RED OAK	15	-	15
	40	NORTHERN RED OAK	14	-	14
	41	NORTHERN RED OAK	5	-	5
	43	NORTHERN RED OAK	7	-	7
	45	SIBERIAN ELM	13	-	13
	46	SIBERIAN ELM	5	-	5
	47	BIGTOOTH ASPFEN	8	-	8
	48	COTTONWOOD	19	-	19
	49	COTTONWOOD	22	-	22
	53	BUR OAK	26	-	26
	56	SIBERIAN ELM	11	-	11
	58	SIBERIAN ELM	4	-	4
	59	SIBERIAN ELM	4	-	4
	62	SIBERIAN ELM	3	-	3
	63	SIBERIAN ELM	4	-	4
	92	COTTONWOOD	24	-	24
	98	BUR OAK	24	-	24
	117	BUR OAK	6	-	6
	123	BUR OAK	17	-	17
	124	BUR OAK	17	-	17
	244	BUR OAK	19	-	19
	245	BUR OAK	7	-	7
	246	SIBERIAN ELM	6	-	6
	247	NORTHERN RED OAK	14	-	14
	253	BLACK CHERRY	14	-	14
	TOTAL CALIPPER			597	
	TOTAL CALIPPER SAVED			85	
	TOTAL CALIPPER REMOVED				512
	PERCENTAGE CALIPPER SAVED/REMOVED			20.43%	79.56%

TREE REPLACEMENT
Minimum Caliper To Be Saved = 30%
Actual Caliper To Be Saved = 14.24%
15.76% OF 597" CALIPPER = 94.1"
94.1" X 1.25 = 118" TO BE REPLACED
Verify Replacement Method With City Of Ramsey.

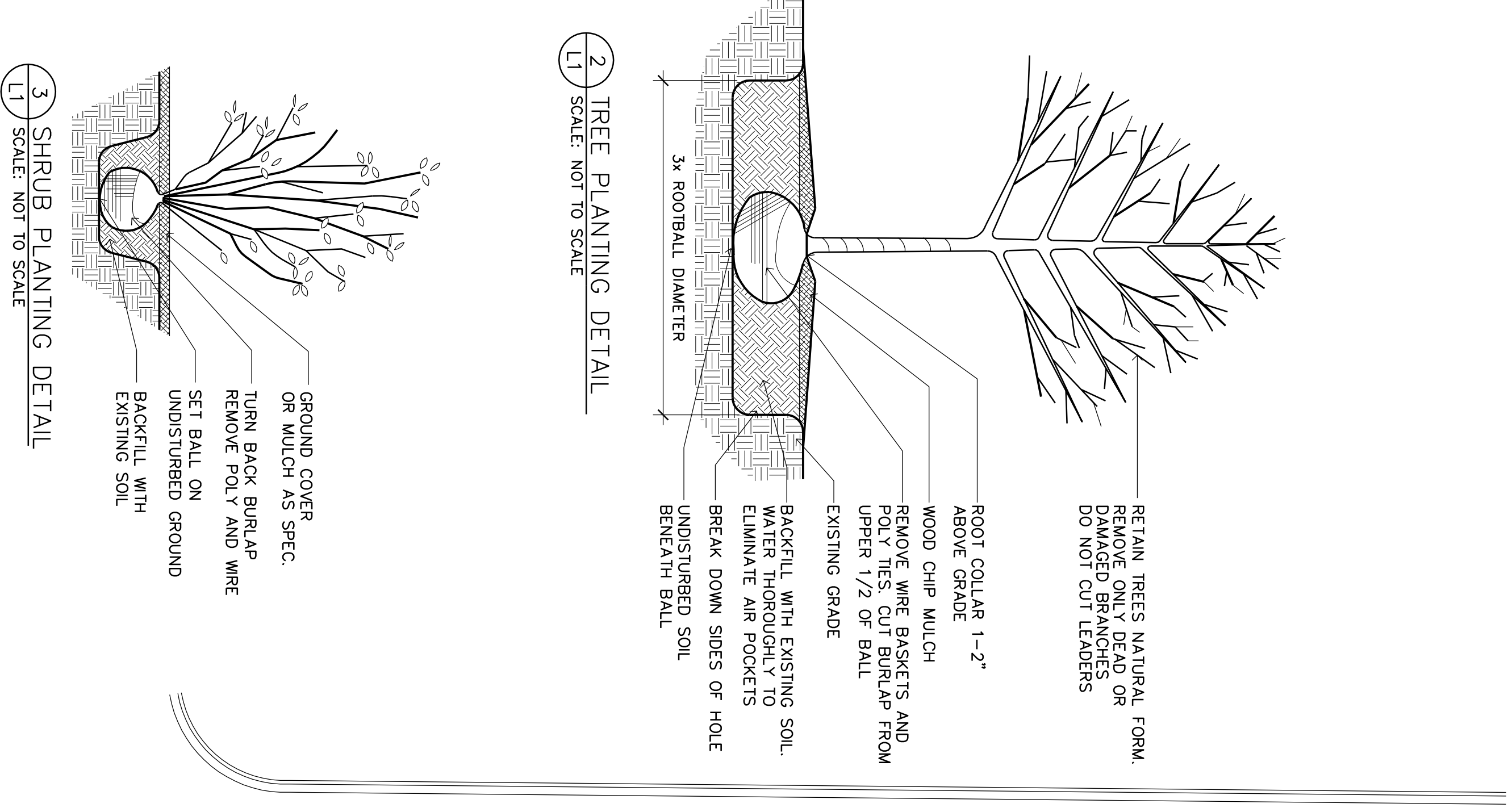

BASALT STREET N.W.

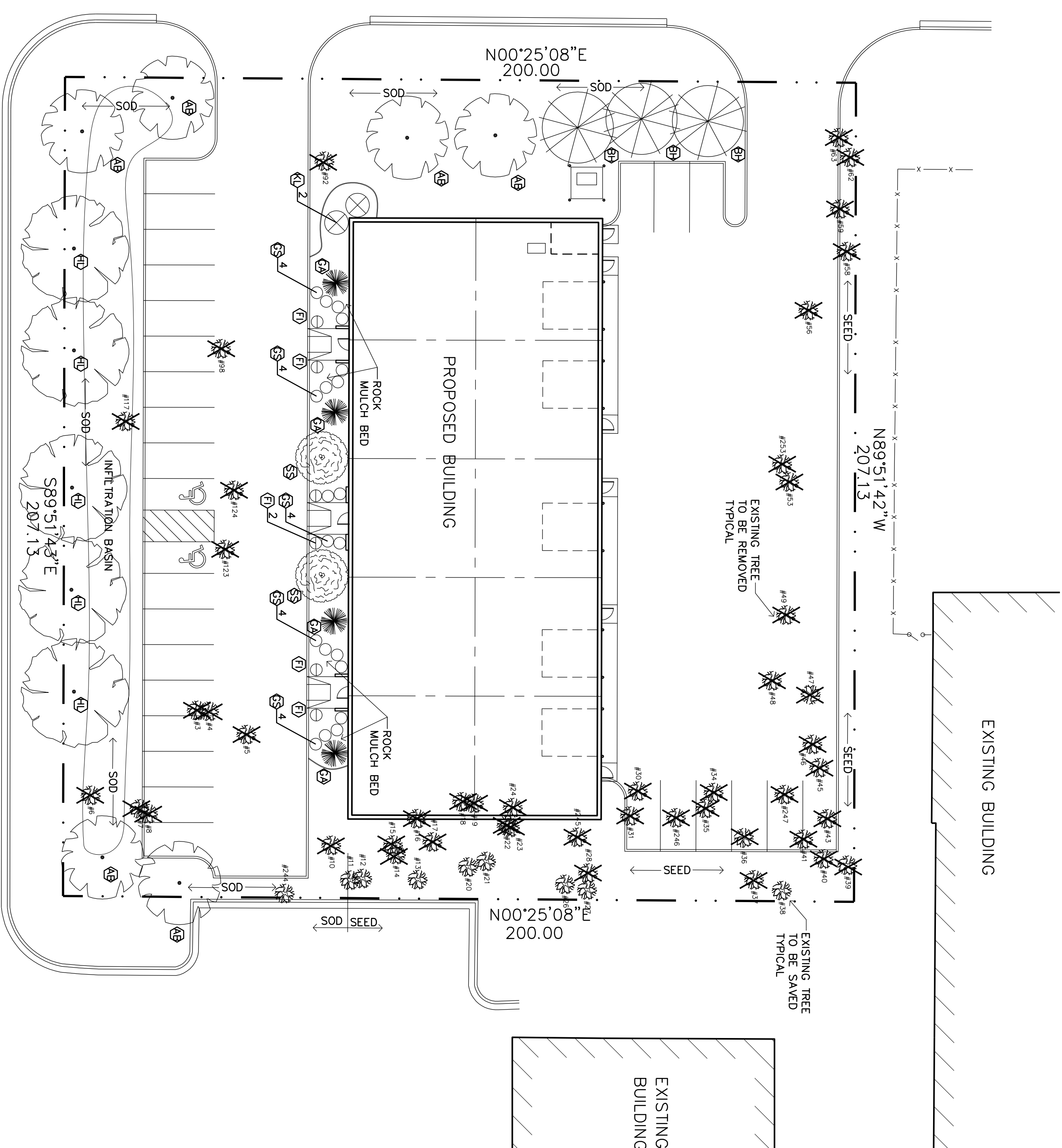

141st AVENUE N.W.

1 LANDSCAPE PLAN
SCALE: 1" = 20'-0"



**PRELIMINARY
CONSTRUCTION**

Shorp & Associates, LLC

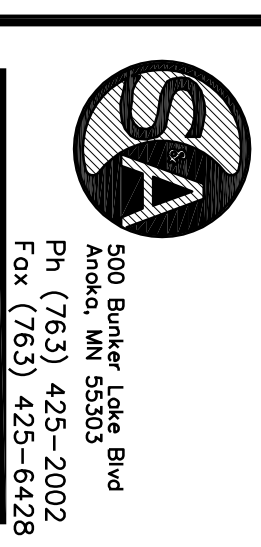

500 Butler Lane Blvd
Arden, WI 53503
Ph: (763) 425-2002
Fax: (763) 425-6428

BASALT INDUSTRIAL

Ramsy, Minnesota

Drawn By:	JRB
Checked By:	LL
Revisions:	
2/22/18	PRELIMINARY

LANDSCAPE PLAN

Sheet Number

L1

Project No. 180212-1