

THIS IS MORE ABOUT TERRACES... SUBTLE
LEVEL CHANGES TO HIGHLIGHT/SEPARATE
USE AREAS - STORMWATER DIRECTED
TO PLANTED BEDS OR TO UNDERGROUND
VAULTS FOR STORAGE/REUSE.

AREA DRAINS...
FRENCH/TRENCH DRAINS...
CATCH BASINS/INLETS...
WHAT ELSE DO WE
NEED TO DIRECT
WATER OVER THE
MANY PAVEMENT
SURFACES ???

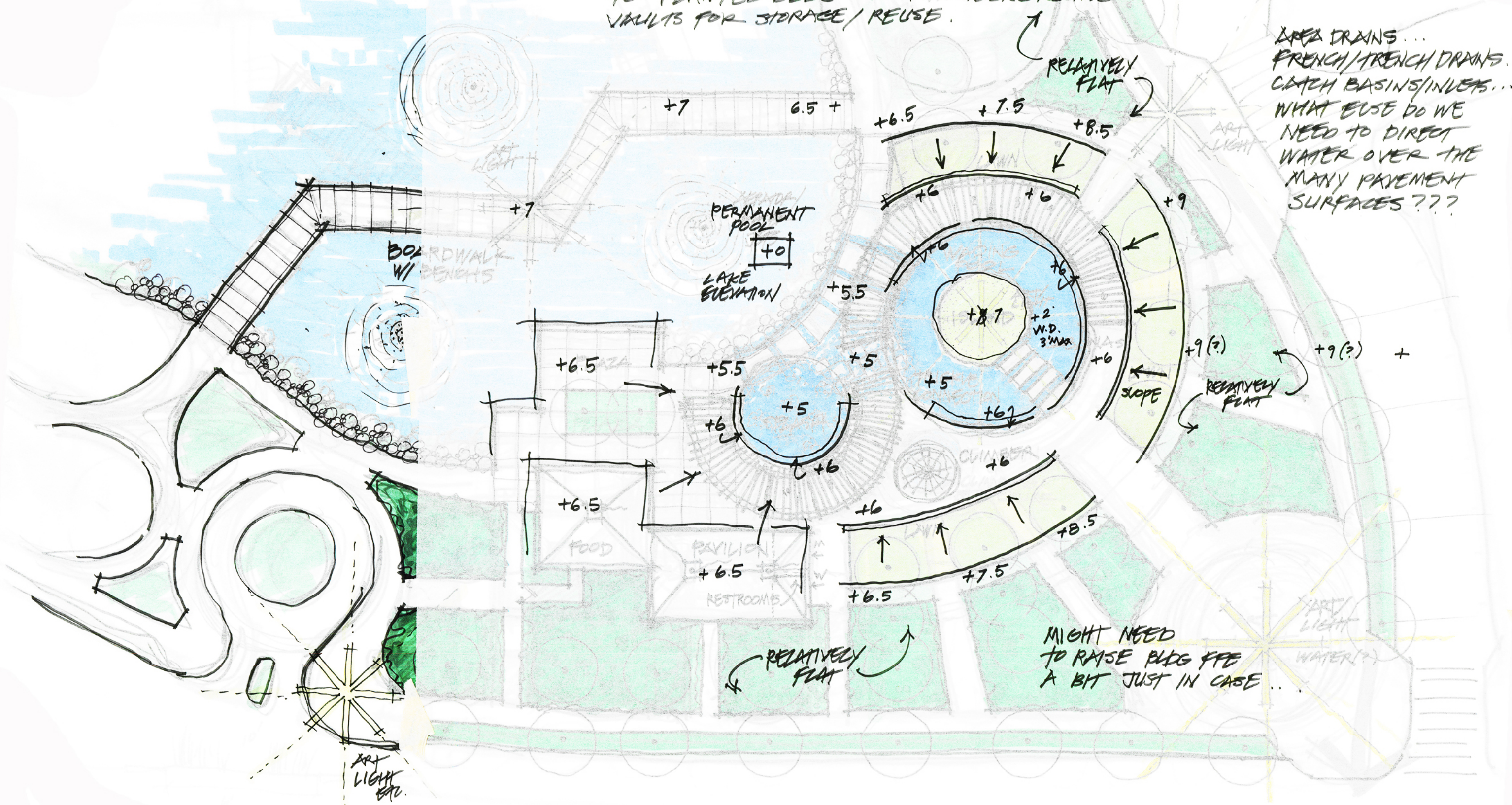

MIGHT NEED
TO RAISE PLUG FFE
A BIT JUST IN CASE...

ART
LIGHT
Etc.

ART
LIGHT
WATER(?)