

SUNFISH LAKE BOULEVARD OVERPASS WITH RIGHT-IN/RIGHT-OUT

EXAMPLE: ST. LOUIS PARK



OVERALL
BENEFITS SCORE
OPTION A | OPTION B
81 | 81



TOP MEASURES

OPTION A		OPTION B
	PEDESTRIAN EASE	
	BUSINESS EASE	
	PROPERTY IMPACTS	
	COST	
	RR GRADE SEPARATION	



COLOR CODE BREAKDOWN

OPTION A, \$61-68M



OPTION B, \$54-60M

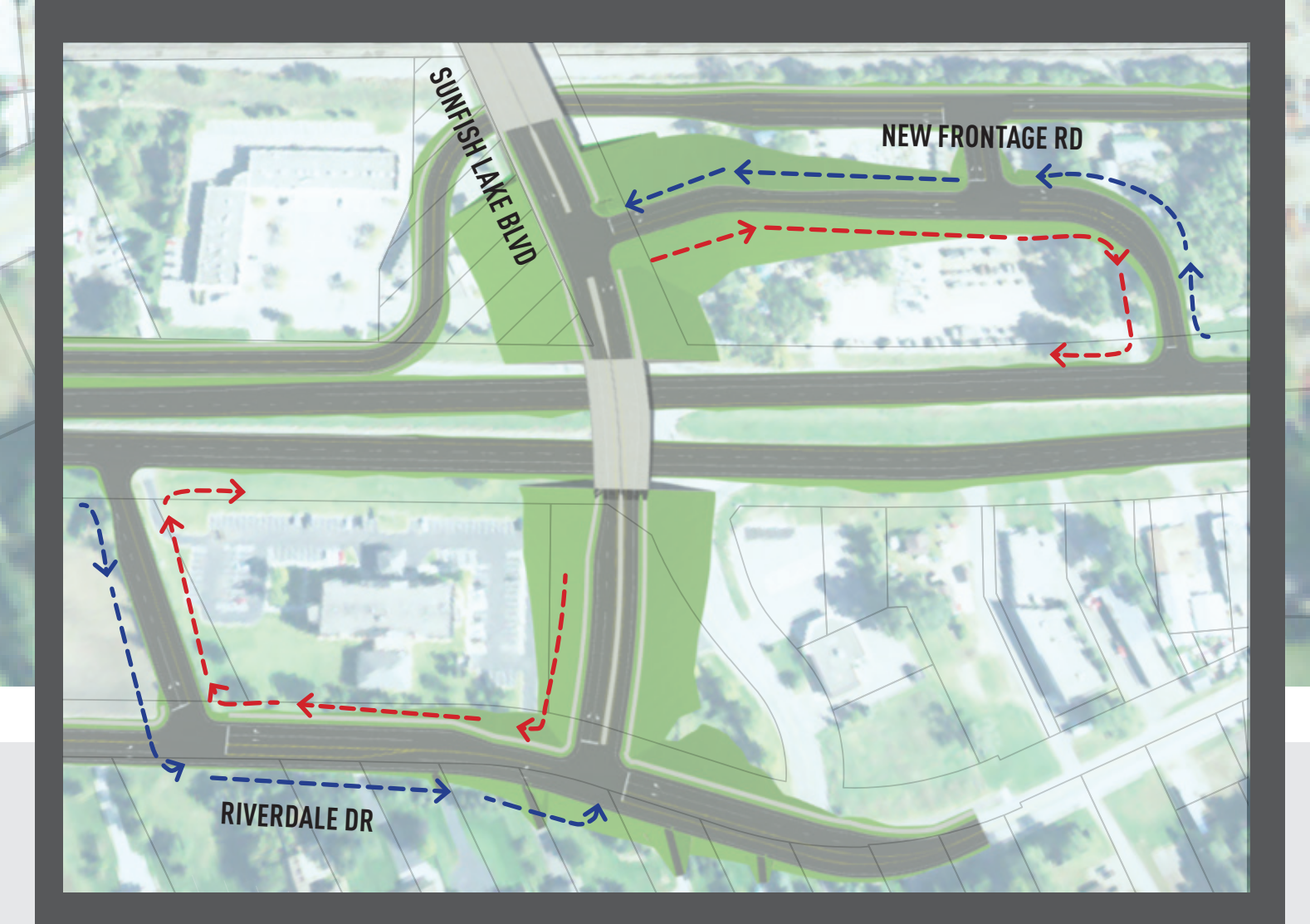

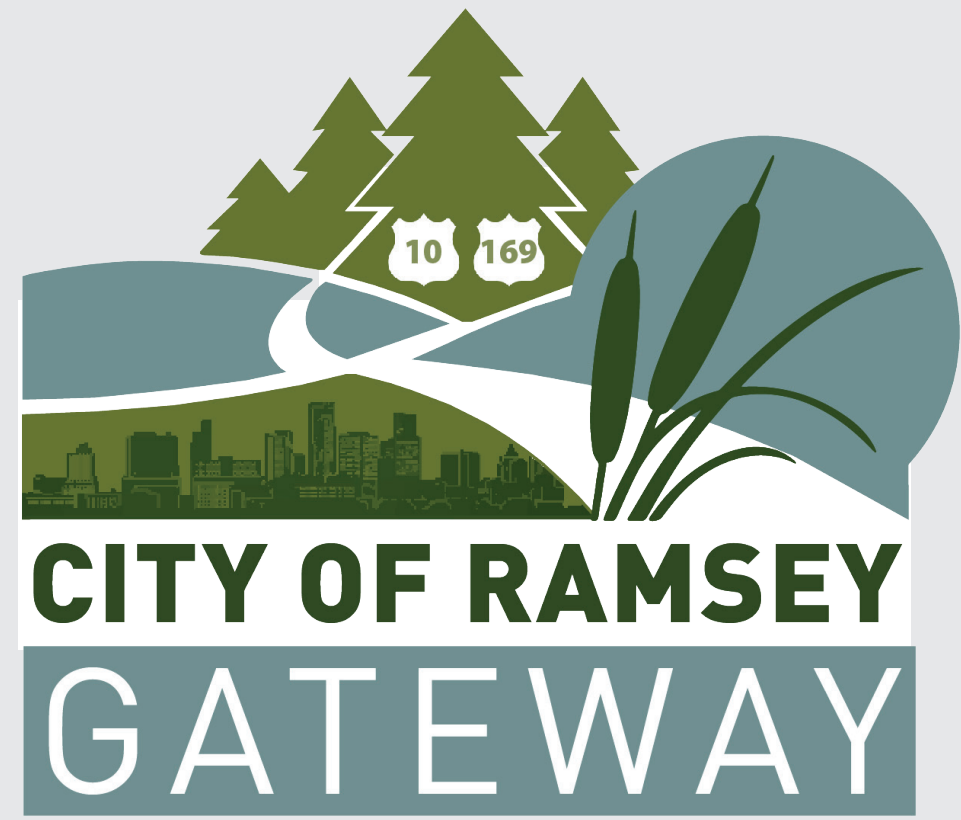

SUNFISH LAKE BOULEVARD

GRADE-SEPARATED ROUNDABOUT

OVERALL
BENEFITS SCORE
72



TOP MEASURES

-  PEDESTRIAN EASE
-  BUSINESS EASE
-  PROPERTY IMPACTS
-  COST
-  RR GRADE SEPARATION

1 - POOR **2 - FAIR** **3 - GOOD**

COLOR CODE BREAKDOWN

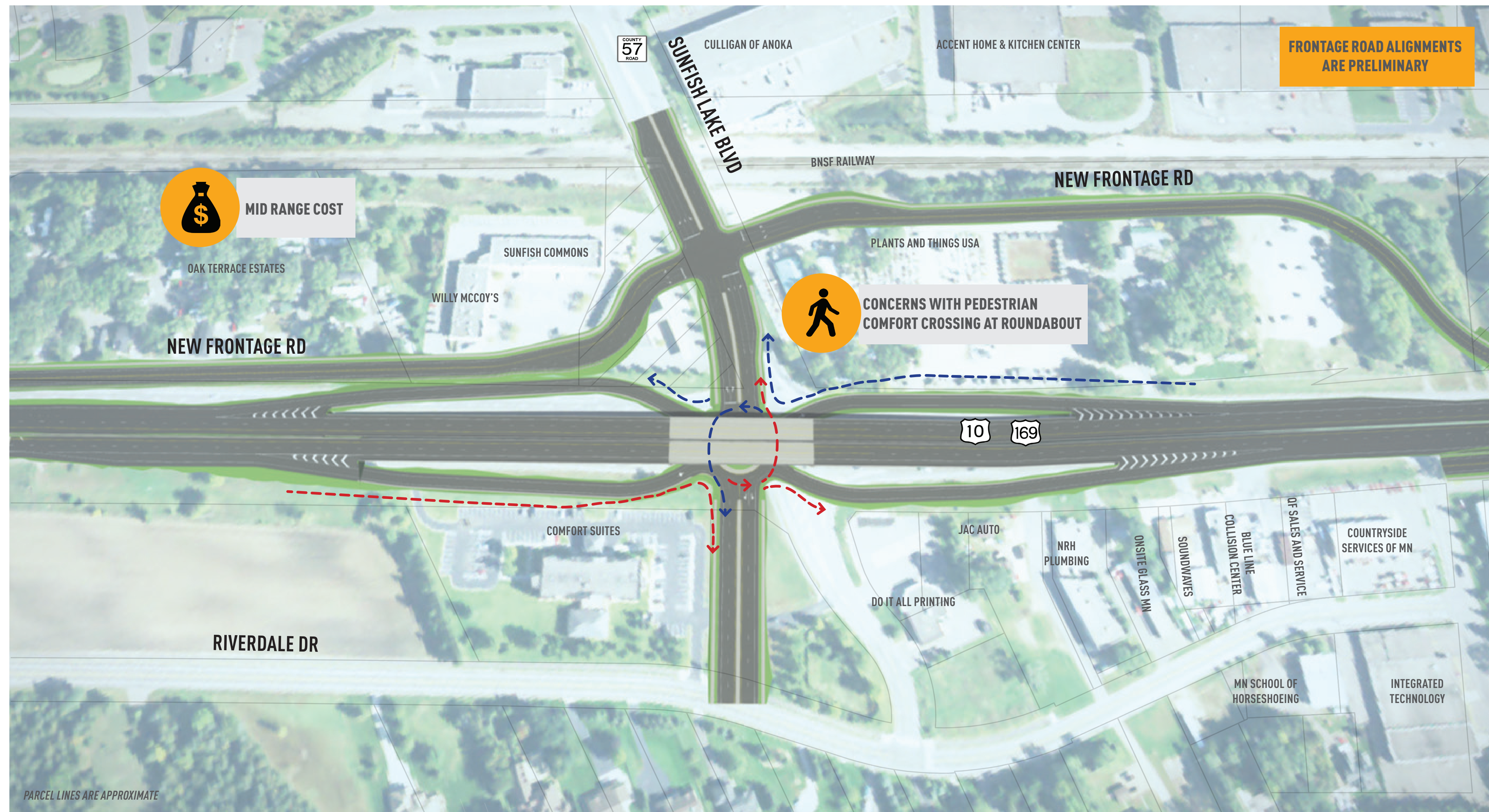

GREEN SHADING DENOTES POTENTIAL GRADING AREAS

\$51-56M

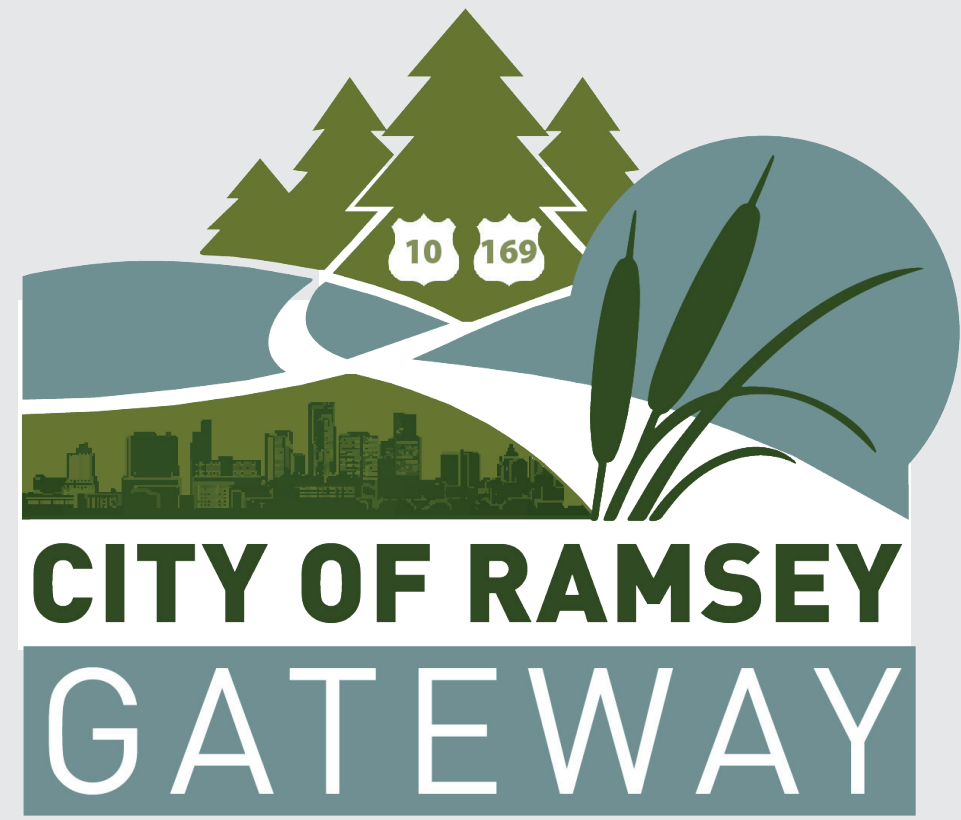

SUNFISH LAKE BOULEVARD CENTER TURN OVERPASS

OVERALL
BENEFITS SCORE
72



TOP MEASURES

-  PEDESTRIAN EASE
-  BUSINESS EASE
-  PROPERTY IMPACTS
-  COST
-  RR GRADE SEPARATION

1 - POOR **2 - FAIR** **3 - GOOD**

COLOR CODE BREAKDOWN

EXAMPLE: CHICAGO, IL

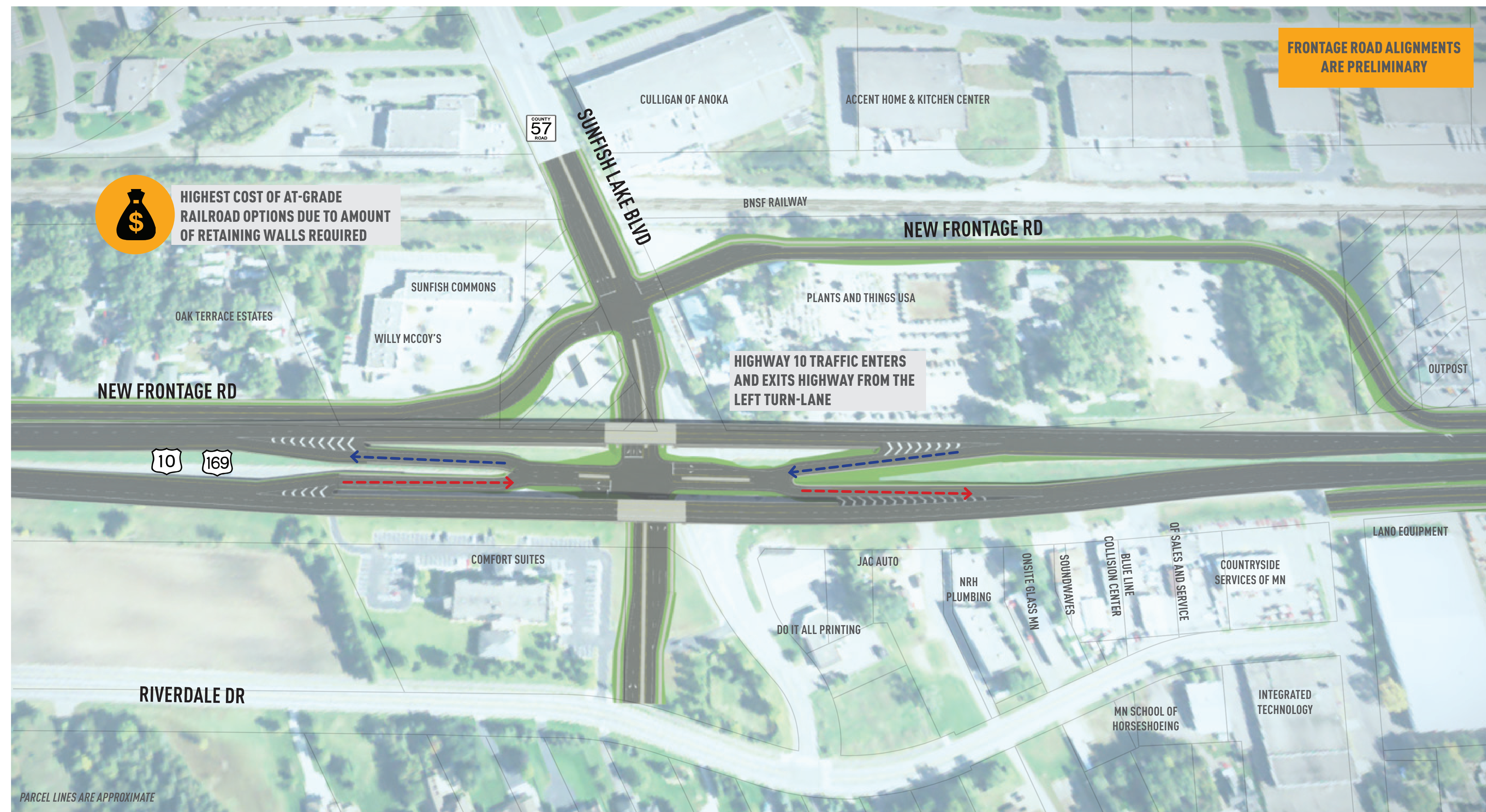

\$59-65M

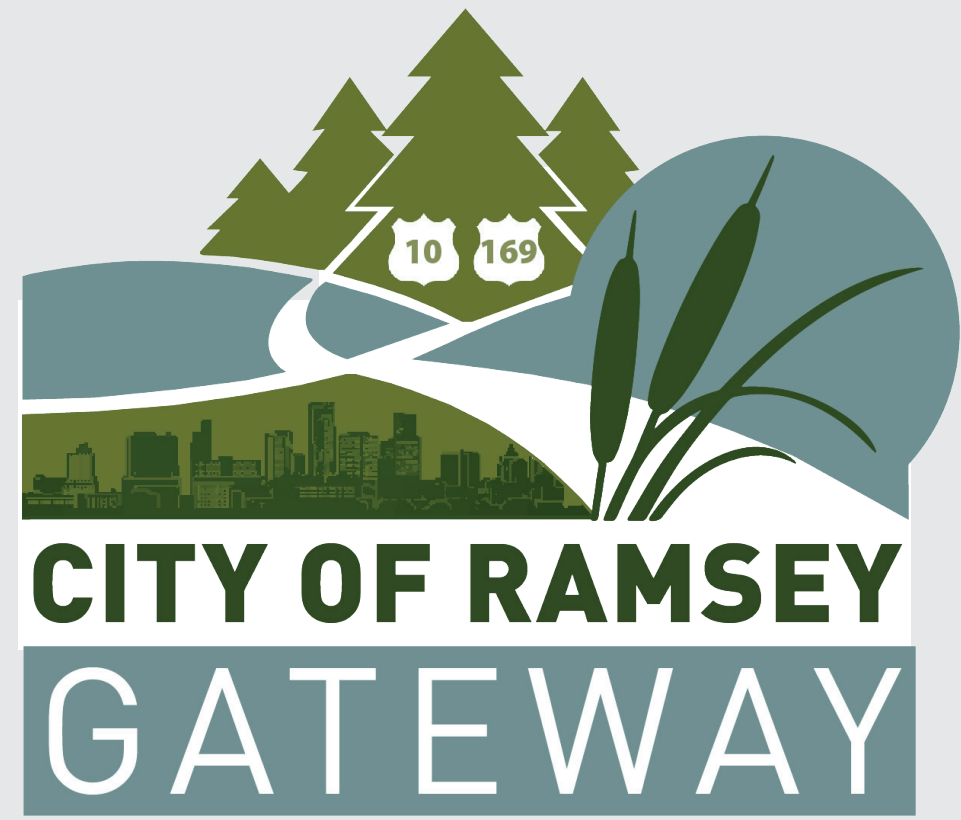

SUNFISH LAKE BOULEVARD

RIGHT-IN/RIGHT-OUT WITH ROUNDABOUT

REDUCED ACCESS

OVERALL
BENEFITS SCORE

66

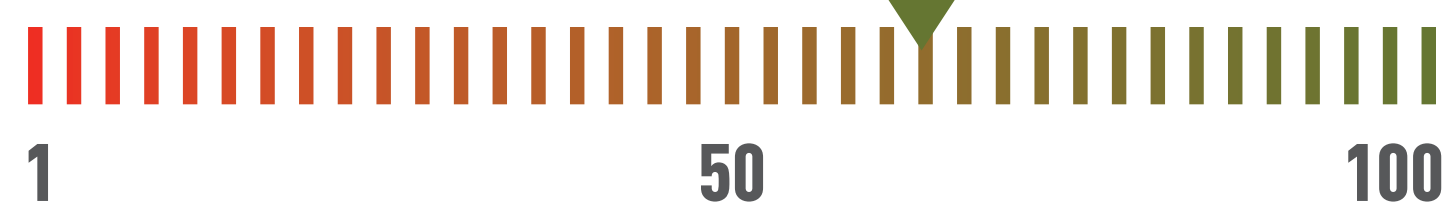

TOP MEASURES

-  PEDESTRIAN EASE
-  BUSINESS EASE
-  PROPERTY IMPACTS
-  COST
-  RR GRADE SEPARATION



COLOR CODE BREAKDOWN

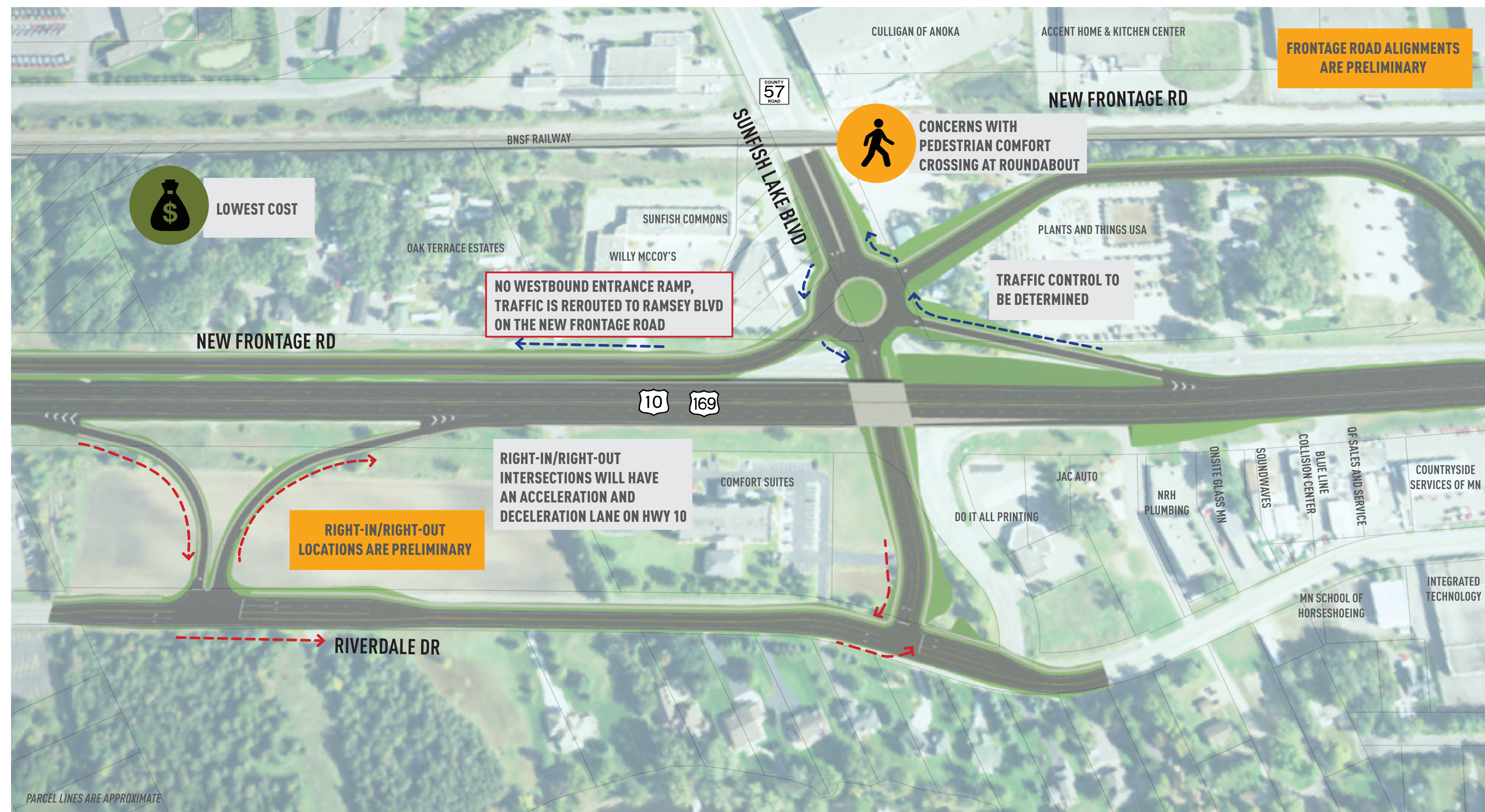

GREEN SHADING DENOTES POTENTIAL GRADING AREAS

\$34-38M

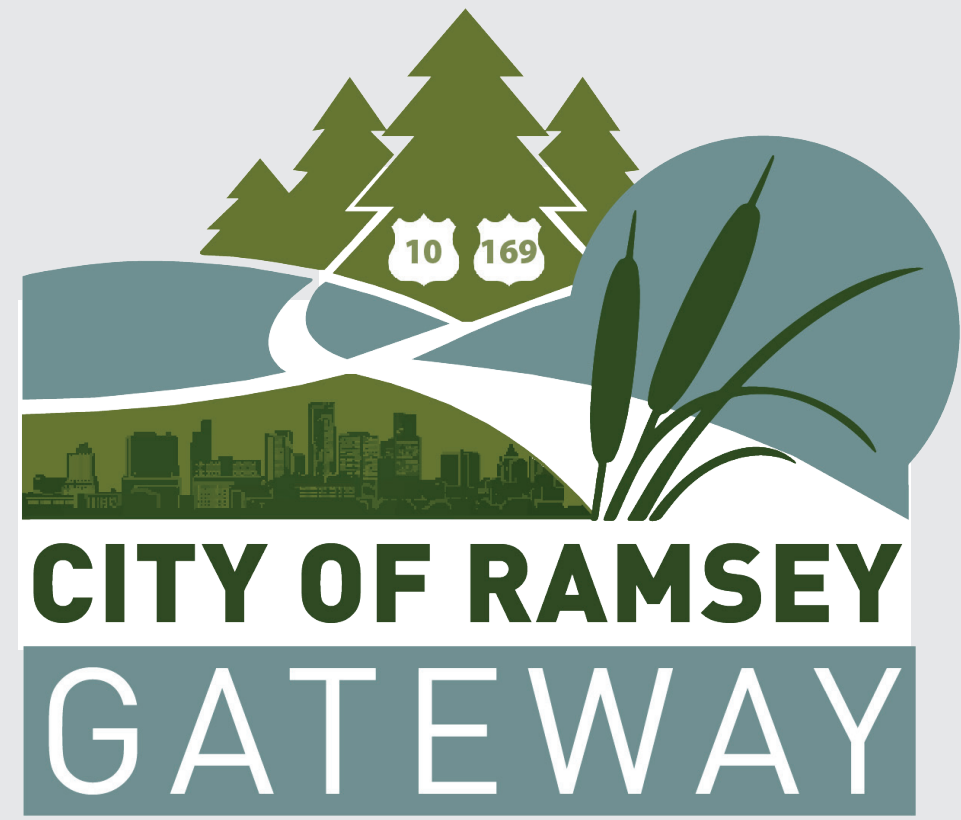

SUNFISH LAKE BOULEVARD

RIGHT-IN/RIGHT-OUT WITH ROUNDABOUT

FULL ACCESS

OVERALL
BENEFITS SCORE
70

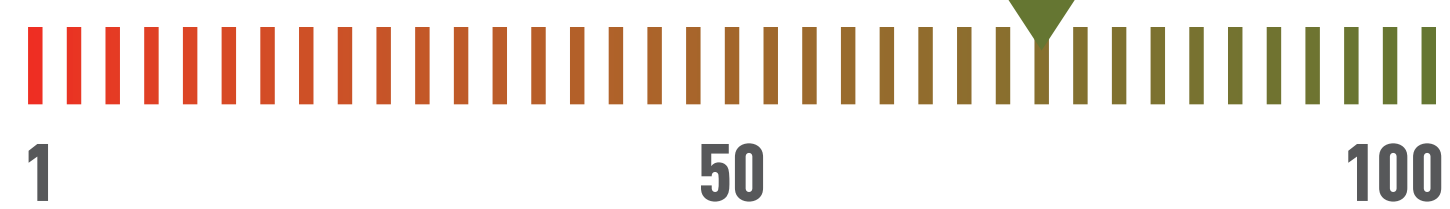

TOP MEASURES

-  PEDESTRIAN EASE
-  BUSINESS EASE
-  PROPERTY IMPACTS
-  COST
-  RR GRADE SEPARATION

1 - POOR **2 - FAIR** **3 - GOOD**

COLOR CODE BREAKDOWN

EXAMPLE: **BROOKLYN CENTER**

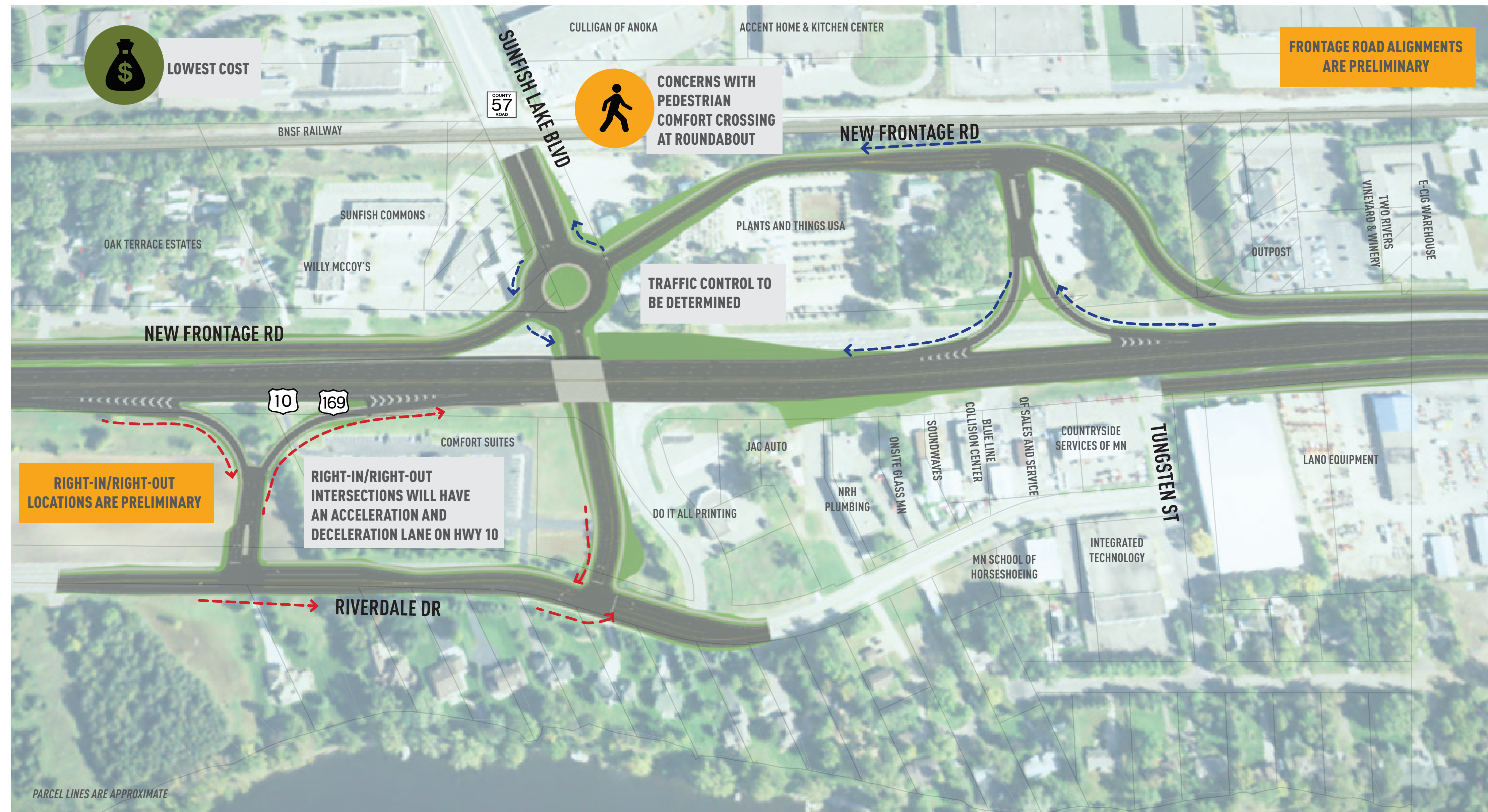

GREEN SHADING DENOTES POTENTIAL GRADING AREAS

\$34-38M

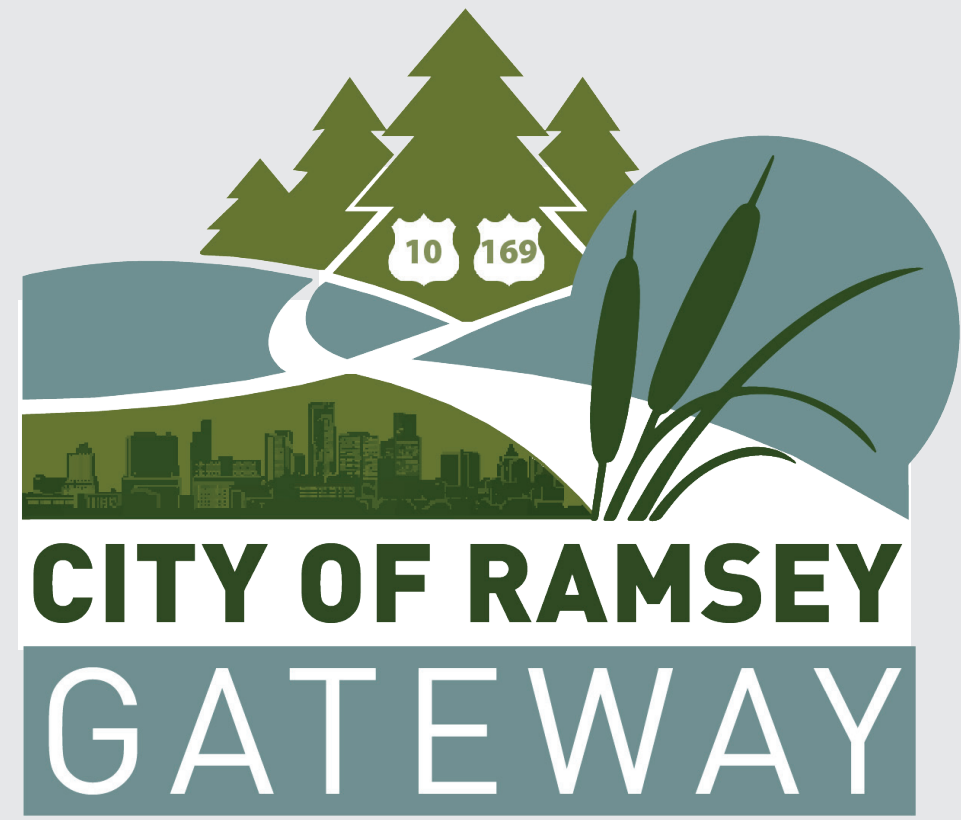

SUNFISH LAKE BOULEVARD OPTIONS: COST-BENEFIT

