

5 CURB + GUTTER SECTION
1-1/2"=1'-0"

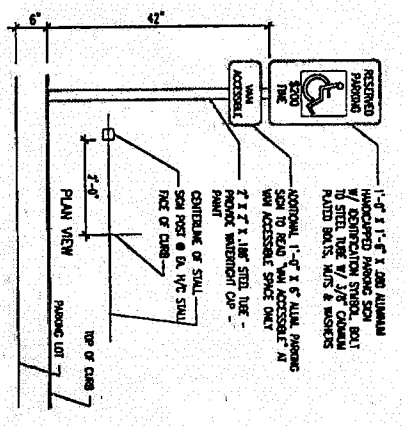

4 HANDICAP SIGN
N.T.S.

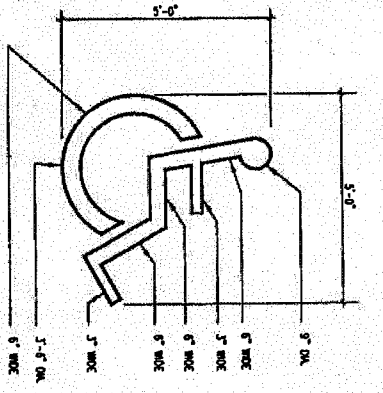

3 HANDICAP SYMBOL
N.T.S.

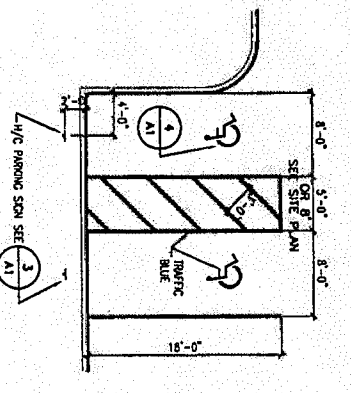

2 HANDICAP PARKING
1/8"=1'-0"

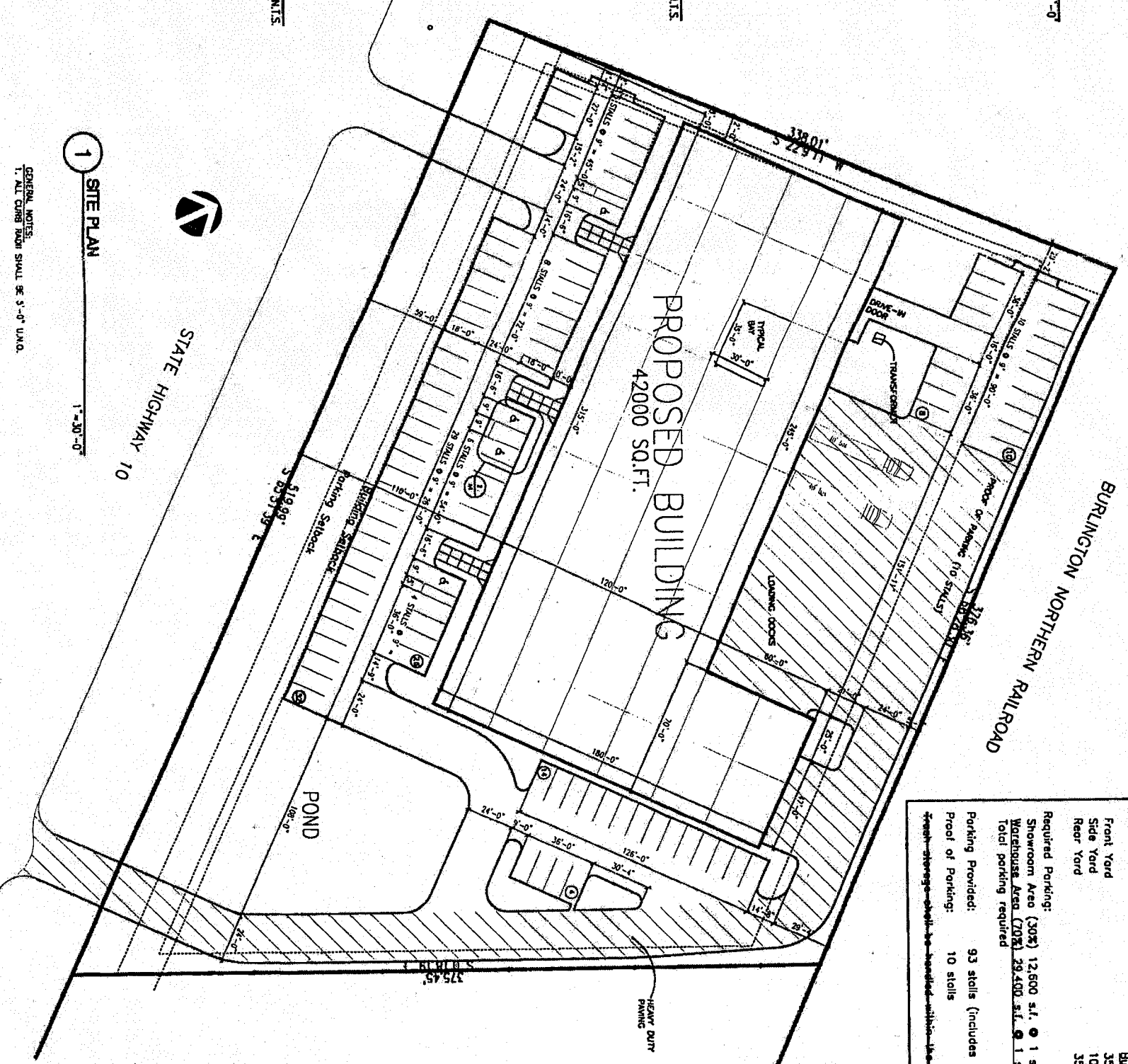

1 SITE PLAN
1"=30'-0"

GENERAL NOTES:
1. ALL CURB RAMP SHALL BE 3'-0" W.A.O.

PROJECT DATA	
Zoning Classification:	B3 - Highway Business
Site Area:	159,576 s.f. (3.7 Acres)
Maximum allowable building coverage:	55,850 s.f. (35%)
Proposed Building Area:	42,000 s.f. (26%)
Total Paved Area:	62,500 s.f. (39%)
Required Setbacks:	
Front Yard	Building 35', Parking 20'
Side Yard	10', 0'
Rear Yard	35', 0'
Required Parking:	
Showroom Area (30%)	12,600 s.f. @ 1 stall/200 s.f. = 63 stalls
Warehouse Area (70%)	29,400 s.f. @ 1 stall/1000 s.f. = 30 stalls
Total parking required	93 stalls
Parking Provided:	93 stalls (includes 4 accessible stalls) ✓
Proof of Parking:	10 stalls

<p>Design/Construction Construction Management 200 W. Hwy. 13 S1317 Brynner, Minnesota 55317 Phone 612-890-1211 Fax 612-890-0894</p>	<p>REVISIONS</p> <table border="1"> <tr><td>1</td><td></td></tr> <tr><td>2</td><td></td></tr> <tr><td>3</td><td></td></tr> <tr><td>4</td><td></td></tr> <tr><td>5</td><td></td></tr> <tr><td>6</td><td></td></tr> <tr><td>7</td><td></td></tr> <tr><td>8</td><td></td></tr> <tr><td>9</td><td></td></tr> <tr><td>10</td><td></td></tr> </table>	1		2		3		4		5		6		7		8		9		10	
	1																				
2																					
3																					
4																					
5																					
6																					
7																					
8																					
9																					
10																					
<p>© 1998 AMCON CONSULT. CO. All rights reserved. THIS DOCUMENT IS THE PROPERTY OF AMCON CONSULT. CO. AND IS NOT TO BE REPRODUCED OR TRANSMITTED IN ANY FORM OR BY ANY MEANS, ELECTRONIC OR MECHANICAL, INCLUDING PHOTOCOPYING, RECORDING, OR BY ANY INFORMATION STORAGE AND RETRIEVAL SYSTEM.</p>	<p>PROPOSED NEW BUILDING FOR: B + B CARPETS / RETAIL RAMSEY, MINNESOTA</p>																				
<p>CERTIFICATION I, AMCON CONSULT. CO., hereby certify that the above information was prepared by me or under my direct supervision and that I am a duly Licensed Professional Engineer in the State of Minnesota.</p> <p>_____ Date: _____ Title: _____</p>	<p>DATE: 12/13/99 SITE PLAN PROJECT NO. 99804 A1</p>																				