

TREE PROTECTION FENCE

PLAN

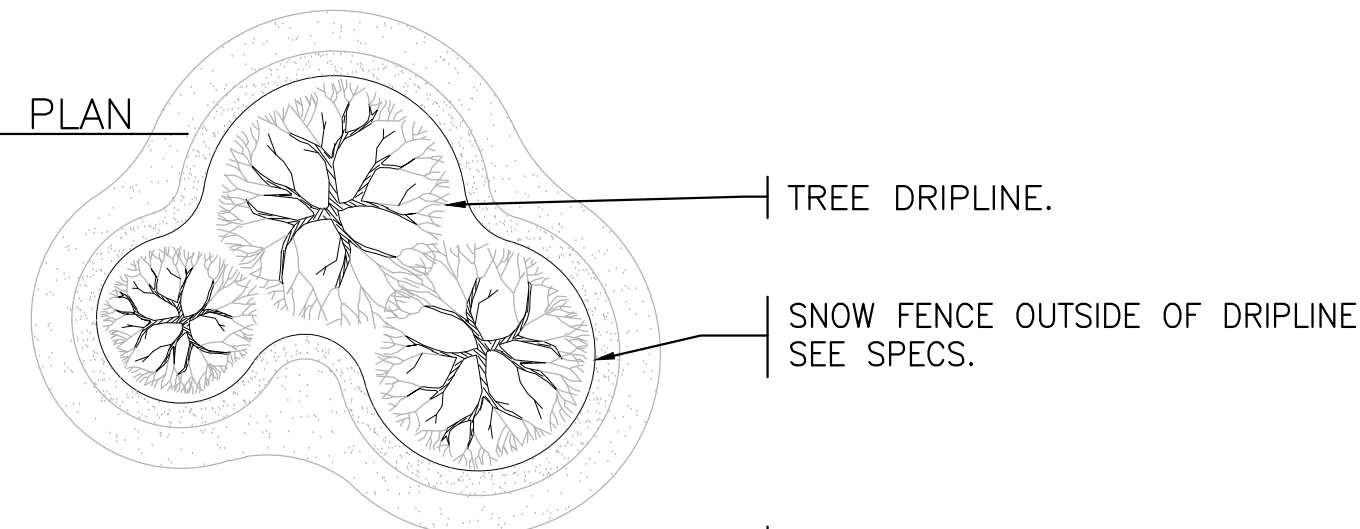

ELEVATION

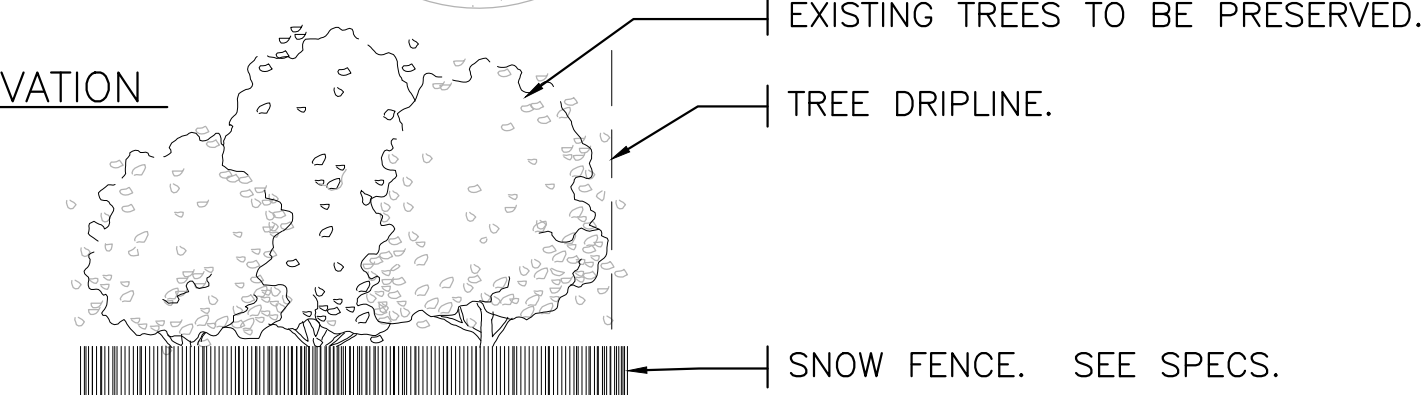

ERECT PROTECTIVE SNOW FENCE PRIOR TO ANY CONSTRUCTION ACTIVITY.
DO NOT STORE ANY EQUIPMENT OR MATERIALS WITHIN PROTECTIVE AREA.
REMOVE THE PROTECTIVE SNOW FENCE ONLY AFTER CONSTRUCTION OPERATIONS ARE COMPLETED.

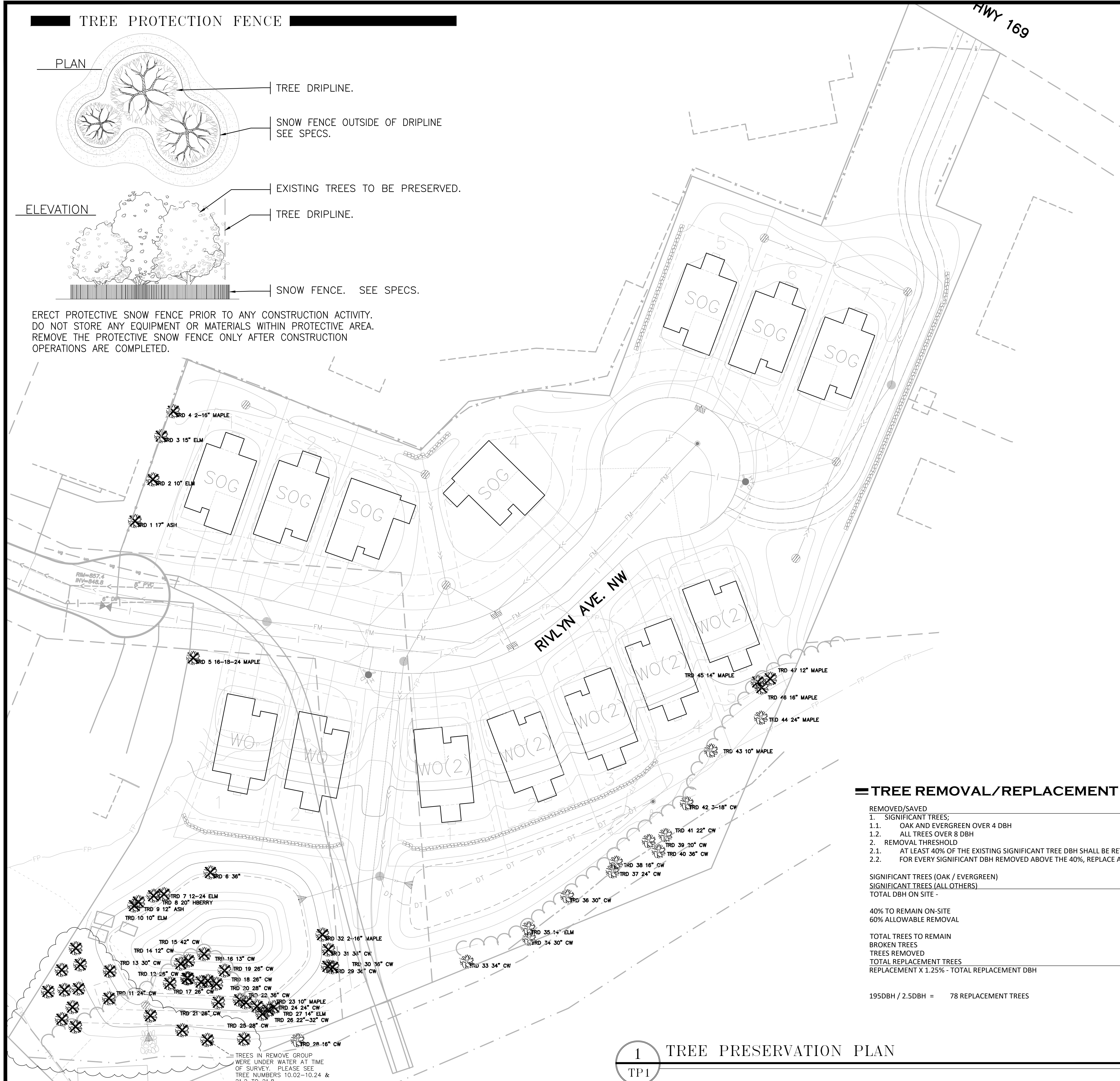

TREE REMOVAL/REPLACEMENT SUMMARY

REMOVED/SAVED	REPLACEMENT/CREDIT
1. SIGNIFICANT TREES;	
1.1. OAK AND EVERGREEN OVER 4 DBH	
1.2. ALL TREES OVER 8 DBH	
2. REMOVAL THRESHOLD	
2.1. AT LEAST 40% OF THE EXISTING SIGNIFICANT TREE DBH SHALL BE RETAINED ON-SITE	
2.2. FOR EVERY SIGNIFICANT DBH REMOVED ABOVE THE 40%, REPLACE AT 1.25%	
SIGNIFICANT TREES (OAK / EVERGREEN)	0 dbh
SIGNIFICANT TREES (ALL OTHERS)	1,829 dbh
TOTAL DBH ON SITE -	1,829 dbh
40% TO REMAIN ON-SITE	733 dbh
60% ALLOWABLE REMOVAL	1,096 dbh
TOTAL TREES TO REMAIN	430 dbh
BROKEN TREES	147 dbh
TREES REMOVED	-1252 dbh
TOTAL REPLACEMENT TREES	156 dbh
REPLACEMENT X 1.25% - TOTAL REPLACEMENT DBH	195 dbh
195DBH / 2.5DBH =	78 REPLACEMENT TREES

Tree Tag	DBH	Tree Type	Significant	Dead/Broken	Remove
1	17	Ash	Y	N	Y
2	10	Boxelder	Y	Broken	Y
3	15	Elm	Y	N	Y
4.1	16	Boxelder	Y	N	Y
4.2	16	Boxelder	Y	N	Y
5.1	16	Silver Maple	Y	N	Y
5.2	18	Silver Maple	Y	N	Y
5.3	24	Silver Maple	Y	N	Y
6	36	Silver Maple	Y	N	Y
7.1	11	Elm	Y	N	Y
7.2	24	Elm	Y	N	Y
8	20	Hackberry	Y	N	Y
9	12	Ash	Y	N	Y
10.1	11	Elm	Y	Broken	Y
10.2	12	Cottonwood	Y	N	Y
10.3	10	Cottonwood	Y	N	Y
10.4	12	Cottonwood	Y	N	Y
10.5	12	Cottonwood	Y	N	Y
10.6	10	Cottonwood	Y	N	Y
10.7	12	Cottonwood	Y	N	Y
10.8	12	Cottonwood	Y	N	Y
10.9	12	Cottonwood	Y	N	Y
10.10	10	Cottonwood	Y	N	Y
10.11	12	Cottonwood	Y	N	Y
10.12	12	Cottonwood	Y	N	Y
10.13	12	Cottonwood	Y	N	Y
10.14	18	Cottonwood	Y	N	Y
10.15	20	Cottonwood	Y	N	Y
10.16	18	Cottonwood	Y	N	Y
10.17	18	Cottonwood	Y	Broken	Y
10.18	20	Cottonwood	Y	N	Y
10.19	18	Cottonwood	Y	N	Y
10.20	20	Cottonwood	Y	N	Y
10.21	20	Cottonwood	Y	N	Y
10.22	18	Cottonwood	Y	Broken	Y
10.23	20	Cottonwood	Y	Broken	Y
10.24	20	Cottonwood	Y	Broken	Y
11	24	Cottonwood	Y	N	Y
12	26	Cottonwood	Y	N	Y
13	30	Cottonwood	Y	N	Y
14	12	Cottonwood	Y	N	Y
15	42	Cottonwood	Y	N	Y
16	13	Cottonwood	Y	N	Y
17	26	Cottonwood	Y	N	Y
18.1	30	Cottonwood	Y	N	Y
18.2	26	Cottonwood	Y	Broken	Y
18.3	18	Cottonwood	Y	N	Y
18.4	12	Cottonwood	Y	N	Y
10.5	10	Cottonwood	Y	N	Y
18.6	22	Cottonwood	Y	N	Y
18.7	24	Cottonwood	Y	Broken	Y
18.8	30	Cottonwood	Y	N	Y
19	26	Cottonwood	Y	N	Y
20	28	Cottonwood	Y	N	Y
21.1	26	Cottonwood	Y	N	Y
21.2	20	Cottonwood	Y	N	Y
21.3	18	Cottonwood	Y	N	N
21.4	12	Cottonwood	Y	N	N
21.5	10	Cottonwood	Y	N	N
21.6	22	Cottonwood	Y	N	N
21.7	24	Cottonwood	Y	N	N
21.8	30	Cottonwood	Y	N	N
22	36	Cottonwood	Y	N	Y
23	10	Silver Maple	Y	N	Y
24	22	Cottonwood	Y	N	Y
25	28	Cottonwood	Y	N	Y
26.1	32	Cottonwood	Y	N	Y
26.2	22	Cottonwood	Y	N	Y
27	14	Elm	Y	N	Y
28	16	Cottonwood	Y	N	Y
29	36	Cottonwood	Y	N	Y
30.1	36	Cottonwood	Y	N	Y
30.2	8	Elm	Y	N	Y
30.3	8	Elm	Y	N	Y
31	36	Cottonwood	Y	N	Y
32	16	Boxelder	Y	N	Y
33	34	Cottonwood	Y	N	N
34	30	Cottonwood	Y	N	N
35	14	Elm	Y	N	N
36	30	Cottonwood	Y	N	N
37	24	Cottonwood	Y	N	N
38	16	Cottonwood	Y	N	N
39	20	Cottonwood	Y	N	N
40	36	Cottonwood	Y	N	N
41	22	Cottonwood	Y	N	N
42.1	18	Cottonwood	Y	N	N
42.2	18	Cottonwood	Y	N	N
42.3	18	Cottonwood	Y	N	N
43	10	Boxelder	Y	N	N
44	24	Silver Maple	Y	N	N
45	14	Silver Maple	Y	N	Y
46	14	Silver Maple	Y	N	Y
47	12	Silver Maple	Y	N	Y

1 TREE PRESERVATION PLAN
TP1

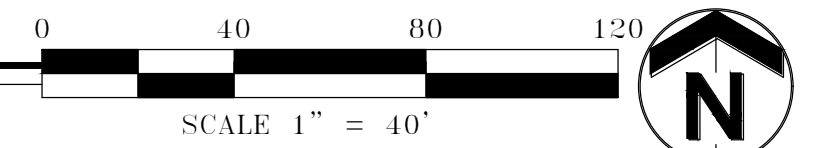

3890 Pheasant Ridge Drive NE, Suite 100
Blaine, MN 55449
Phone: (763) 489-7900
Fax: (763) 489-7959
www.carlsonmccain.com

I hereby certify that this plan, specification or report was prepared by me or under my direct supervision and that I am a duly Licensed Landscape Architect under the laws of the State of Minnesota

Print Name: James A. Kalkes RLA
Signature: *James A. Kalkes*
Date: 4/4/19 License #: 45071

Drawn: JAK
Designed: JAK
Date: 4/4/19

Revisions:
1. 4/4/19 per City Comments

VILLAGE BANK
9298 Central Avenue NE
Blaine, MN 55434

RIVER WALK VILLAGE
Ramsay, Minnesota

TREE PRESERVATION PLAN

Save Date: 04/04/19 F:\p08617801 - 782017802 - Highway 10 Ramsay\cad_c3d\landscape\7802_tree preservation.dwg