

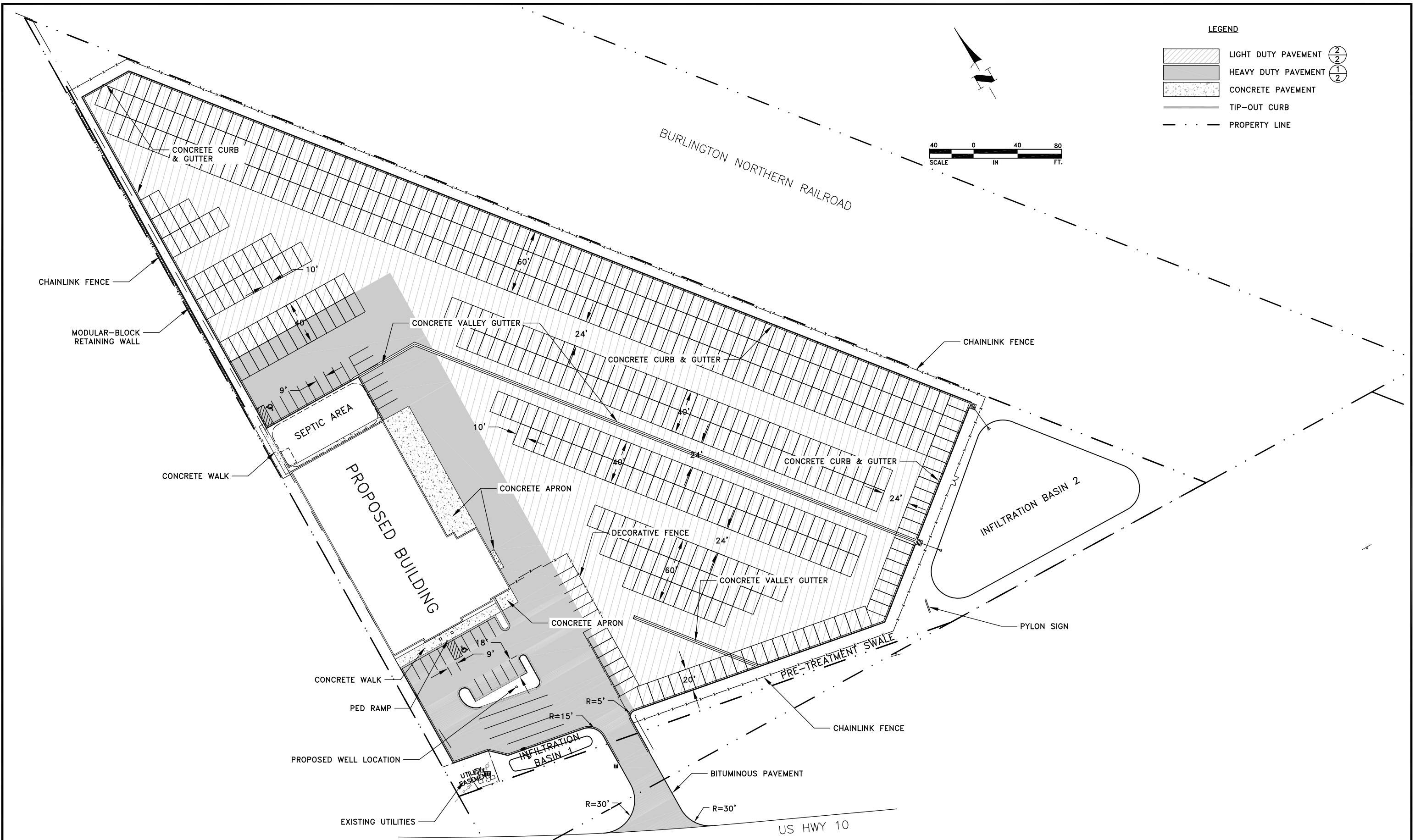



May 02, 2019 - 2:01pm
 K:\PRIVATE\3990.03\ENGINEERING\3990.03_SITE.dwg



LEGEND

	LIGHT DUTY PAVEMENT	$\frac{2}{2}$
	HEAVY DUTY PAVEMENT	$\frac{1}{2}$
	CONCRETE PAVEMENT	$\frac{1}{2}$
	TIP-OUT CURB	
	PROPERTY LINE	

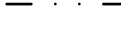
DATE	REVISION

I hereby certify that this plan, specification, or report was prepared by me or under my direct supervision and that I am a duly Licensed Professional Engineer under the laws of the State of Minnesota.

Shane M. Nelson
 SHANE M. NELSON, P.E.
 Date 4/29/19 Lic. No. 43381

DESIGNED BY:
AMT

DRAWN BY:
AMT

CHECKED BY:
SMN



Hakanson Anderson
 Civil Engineers and Land Surveyors
 3601 Thurston Ave., Anoka, Minnesota 55303
 763-427-5860 FAX 763-427-0520
 www.hakanson-anderson.com

M & G TRAILER SALES

PAVING PLAN
 RAMSEY, MINNESOTA

SHEET 5 OF 9 SHEETS