

2020 CRACK SEAL QUANTITIES		
AREA	MILES	CRACK SEAL MATERIAL
A	0.38	2,295
B	3.47	12,606
C	4.69	41,879
D	2.62	15,860
E	4.58	18,926
TOTAL	15.74	91,566

█ CRACK SEAL
█ FRONT CURB CRACK SEAL ONLY

NOTE: CRACK SEAL - INCLUDES FRONT OF CONCRETE CURB
 FRONT OF CURB IS CONSIDERED EDGE BETWEEN CONCRETE CURB AND GUTTER WITH
 EDGE OF BITUMINOUS PAVEMENT.

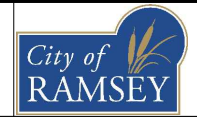

CITY OF RAMSEY
 7550 SUNWOOD DRIVE
 RAMSEY, MN 55303
 (763) 427-1410 FAX (763) 433-9898

OVERALL MAP

2020 CRACK SEAL IMPROVEMENTS
 CITY PROJECT NO. 20-00
 CITY OF RAMSEY, MINNESOTA

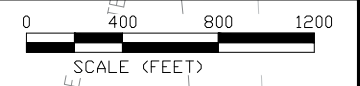

AREA A CRACK SEAL QUANTITIES			
SUBDIVISION	PROGRAM	MILES	CRACK SEAL MATERIAL
VOLTINS OAK HILL ESTATES	CS	0.03	414
WOODLANDS 3RD	CS	0.35	639
TOTALS		0.38	2,295

- CRACK SEAL
- FRONT CURB CRACK SEAL ONLY

NOTE: CRACK SEAL - INCLUDES FRONT OF CONCRETE CURB
 FRONT OF CURB IS CONSIDERED EDGE BETWEEN CONCRETE CURB AND GUTTER WITH
 EDGE OF BITUMINOUS PAVEMENT.

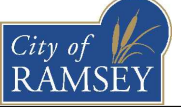

CITY OF RAMSEY
 7550 SUNWOOD DRIVE
 RAMSEY, MN 55303
 (763) 427-1410 FAX (763) 433-9898

AREA A

2020 CRACK SEAL IMPROVEMENTS
 CITY PROJECT NO. 20-00
 CITY OF RAMSEY, MINNESOTA

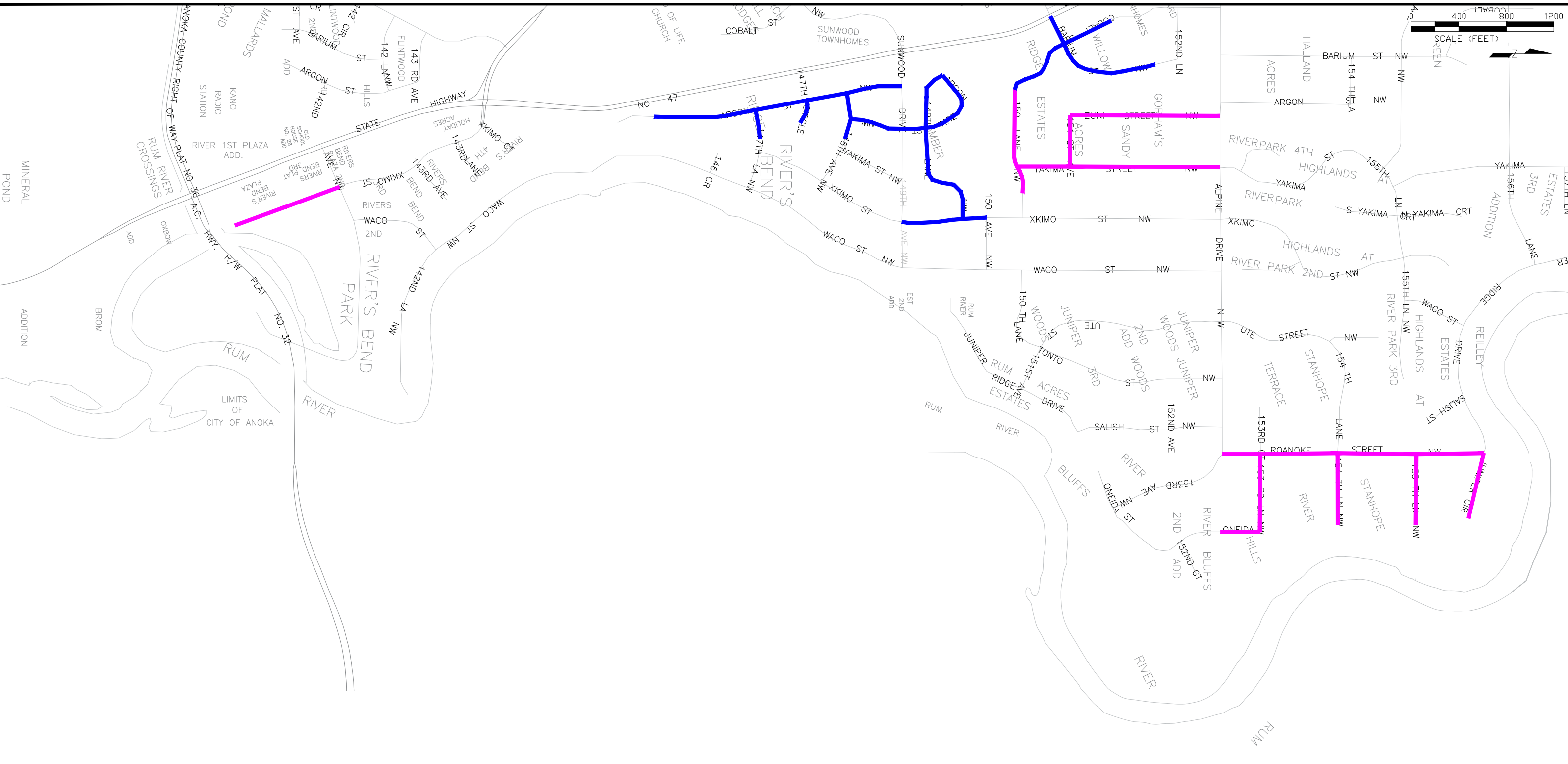

AREA B CRACK SEAL QUANTITIES			
SUBDIVISION	PROGRAM	MILES	CRACK SEAL MATERIAL
GORHAM'S SANDY ACRES ESTATES	CS	0.81	3,687
MSA - ROANOKE STREET	CS	0.42	1,390
RIVERS BEND PLAZA	CS	0.18	1,423
STANHOPE RIVER HILLS	CS	0.52	2,033
AMBER RIDGE	FCCS	1.13	2,981
WILLOW RIDGE	FCCS	0.41	1,093
TOTALS		3.47	12,606

CRACK SEAL
 FRONT CURB CRACK SEAL ONLY

NOTE: CRACK SEAL - INCLUDES FRONT OF CONCRETE CURB
 FRONT OF CURB IS CONSIDERED EDGE BETWEEN CONCRETE CURB AND GUTTER WITH
 EDGE OF BITUMINOUS PAVEMENT.

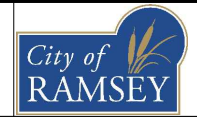



CITY OF RAMSEY
 7550 SUNWOOD DRIVE
 RAMSEY, MN 55303
 (763) 427-1410 FAX (763) 433-9898

AREA B

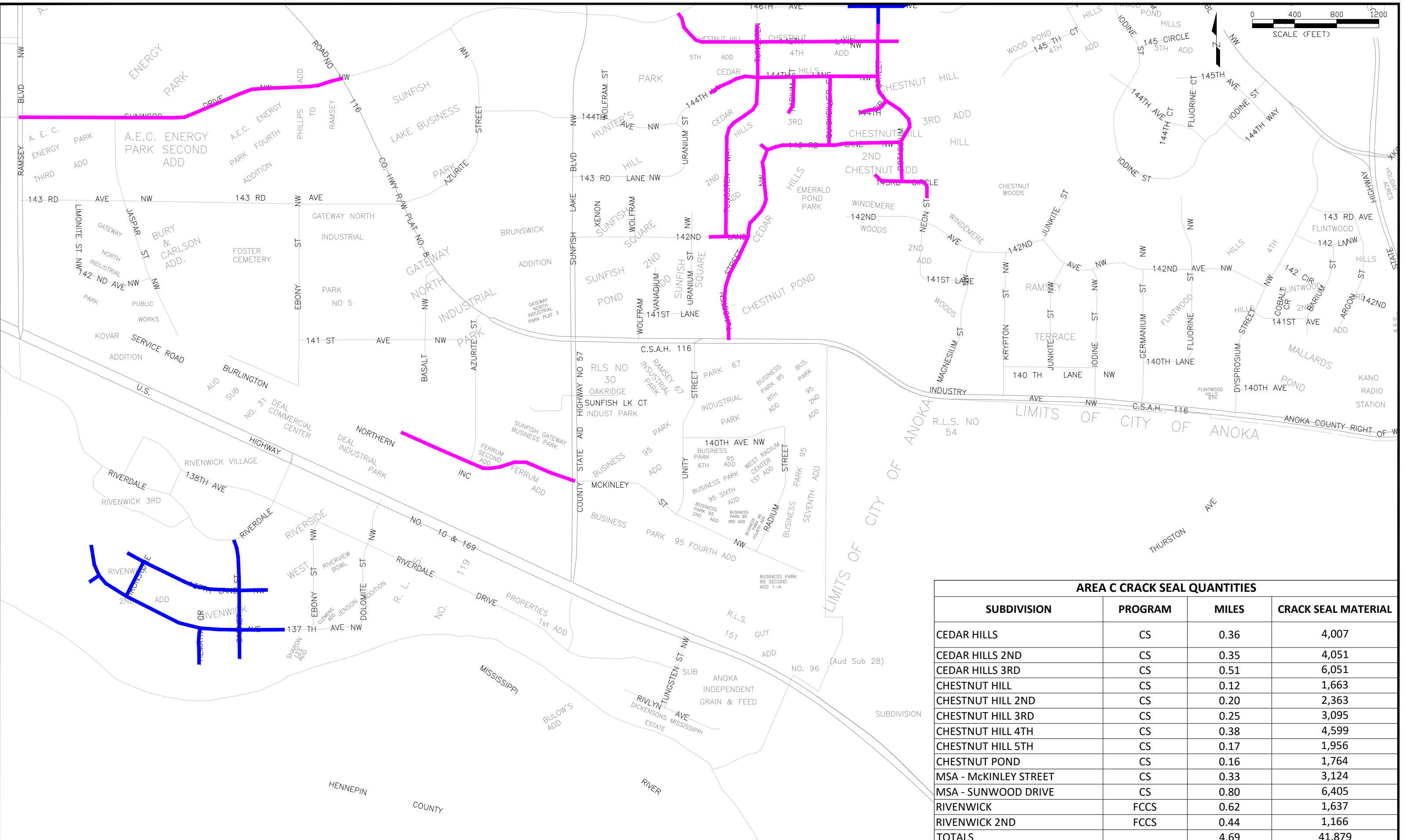
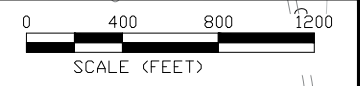
2020 CRACK SEAL IMPROVEMENTS
 CITY PROJECT NO. 20-00
 CITY OF RAMSEY, MINNESOTA



AREA C CRACK SEAL QUANTITIES			
SUBDIVISION	PROGRAM	MILES	CRACK SEAL MATERIAL
CEDAR HILLS	CS	0.36	4,007
CEDAR HILLS 2ND	CS	0.35	4,051
CEDAR HILLS 3RD	CS	0.51	6,051
CHESTNUT HILL	CS	0.12	1,663
CHESTNUT HILL 2ND	CS	0.20	2,363
CHESTNUT HILL 3RD	CS	0.25	3,095
CHESTNUT HILL 4TH	CS	0.38	4,599
CHESTNUT HILL 5TH	CS	0.17	1,956
CHESTNUT POND	CS	0.16	1,764
MSA - MCKINLEY STREET	CS	0.33	3,124
MSA - SUNWOOD DRIVE	CS	0.80	6,405
RIVENWICK	FCCS	0.62	1,637
RIVENWICK 2ND	FCCS	0.44	1,166
TOTALS		4.69	41,879

 CRACK SEAL
 FRONT CURB CRACK SEAL ONLY

NOTE: CRACK SEAL - INCLUDES FRONT OF CONCRETE CURB
 FRONT OF CURB IS CONSIDERED EDGE BETWEEN CONCRETE CURB AND GUTTER WITH
 EDGE OF BITUMINOUS PAVEMENT.

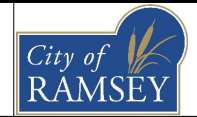

CITY OF RAMSEY
 7550 SUNWOOD DRIVE
 RAMSEY, MN 55303
 (763) 427-1410 FAX (763) 433-9898

AREA C

2020 CRACK SEAL IMPROVEMENTS
 CITY PROJECT NO. 20-00
 CITY OF RAMSEY, MINNESOTA

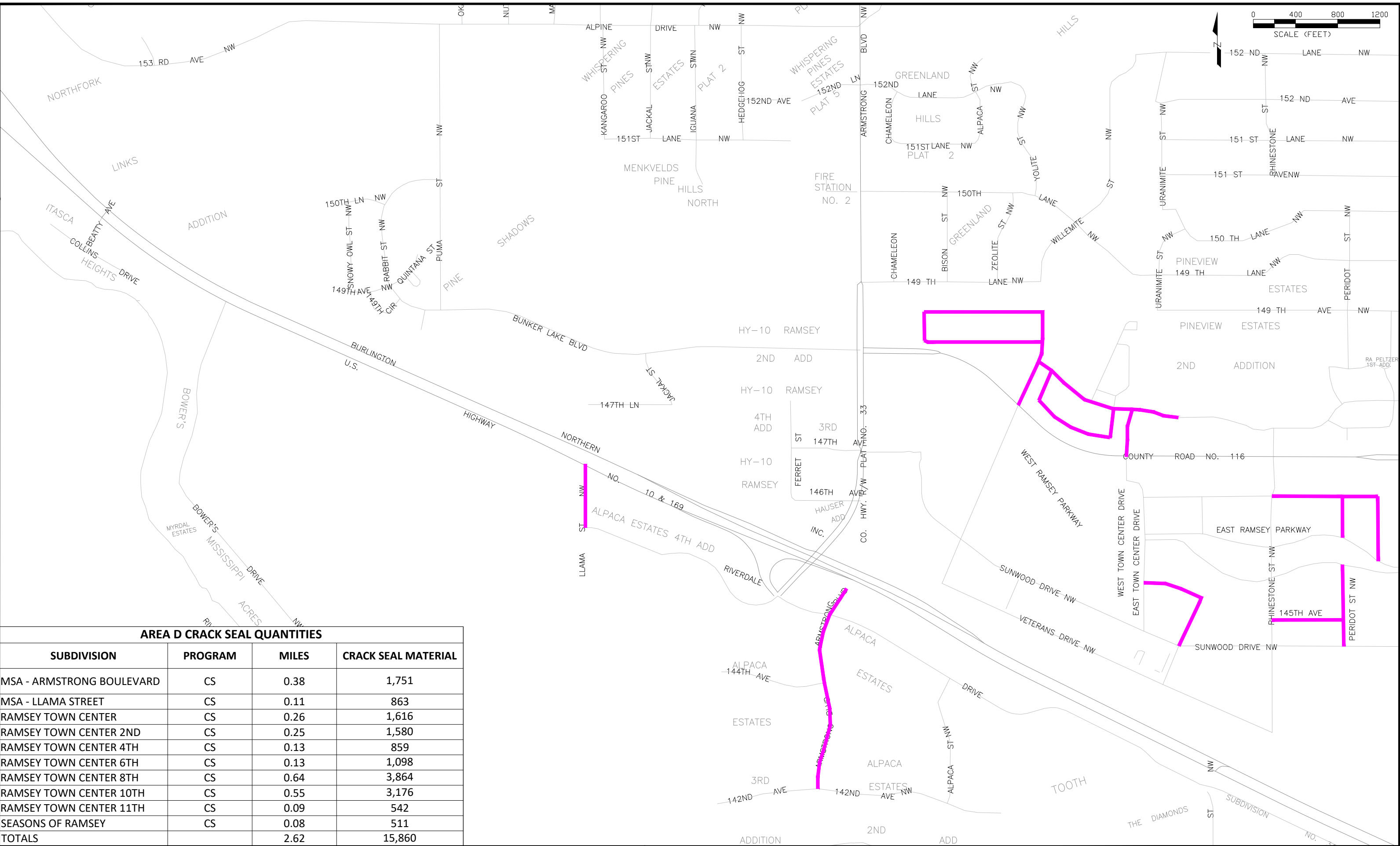
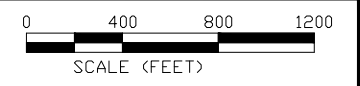

AREA D CRACK SEAL QUANTITIES

SUBDIVISION	PROGRAM	MILES	CRACK SEAL MATERIAL
MSA - ARMSTRONG BOULEVARD	CS	0.38	1,751
MSA - LLAMA STREET	CS	0.11	863
RAMSEY TOWN CENTER	CS	0.26	1,616
RAMSEY TOWN CENTER 2ND	CS	0.25	1,580
RAMSEY TOWN CENTER 4TH	CS	0.13	859
RAMSEY TOWN CENTER 6TH	CS	0.13	1,098
RAMSEY TOWN CENTER 8TH	CS	0.64	3,864
RAMSEY TOWN CENTER 10TH	CS	0.55	3,176
RAMSEY TOWN CENTER 11TH	CS	0.09	542
SEASONS OF RAMSEY	CS	0.08	511
TOTALS		2.62	15,860

NOTE: CRACK SEAL - INCLUDES FRONT OF CONCRETE CURB
 FRONT OF CURB IS CONSIDERED EDGE BETWEEN CONCRETE CURB AND GUTTER WITH
 EDGE OF BITUMINOUS PAVEMENT.

CRACK SEAL
 FRONT CURB CRACK SEAL ONLY

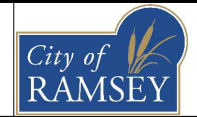

CITY OF RAMSEY
 7550 SUNWOOD DRIVE
 RAMSEY, MN 55303
 (763) 427-1410 FAX (763) 433-9898

AREA D

2020 CRACK SEAL IMPROVEMENTS
CITY PROJECT NO. 20-00
 CITY OF RAMSEY, MINNESOTA

SHEET 5 OF 6 SHEETS

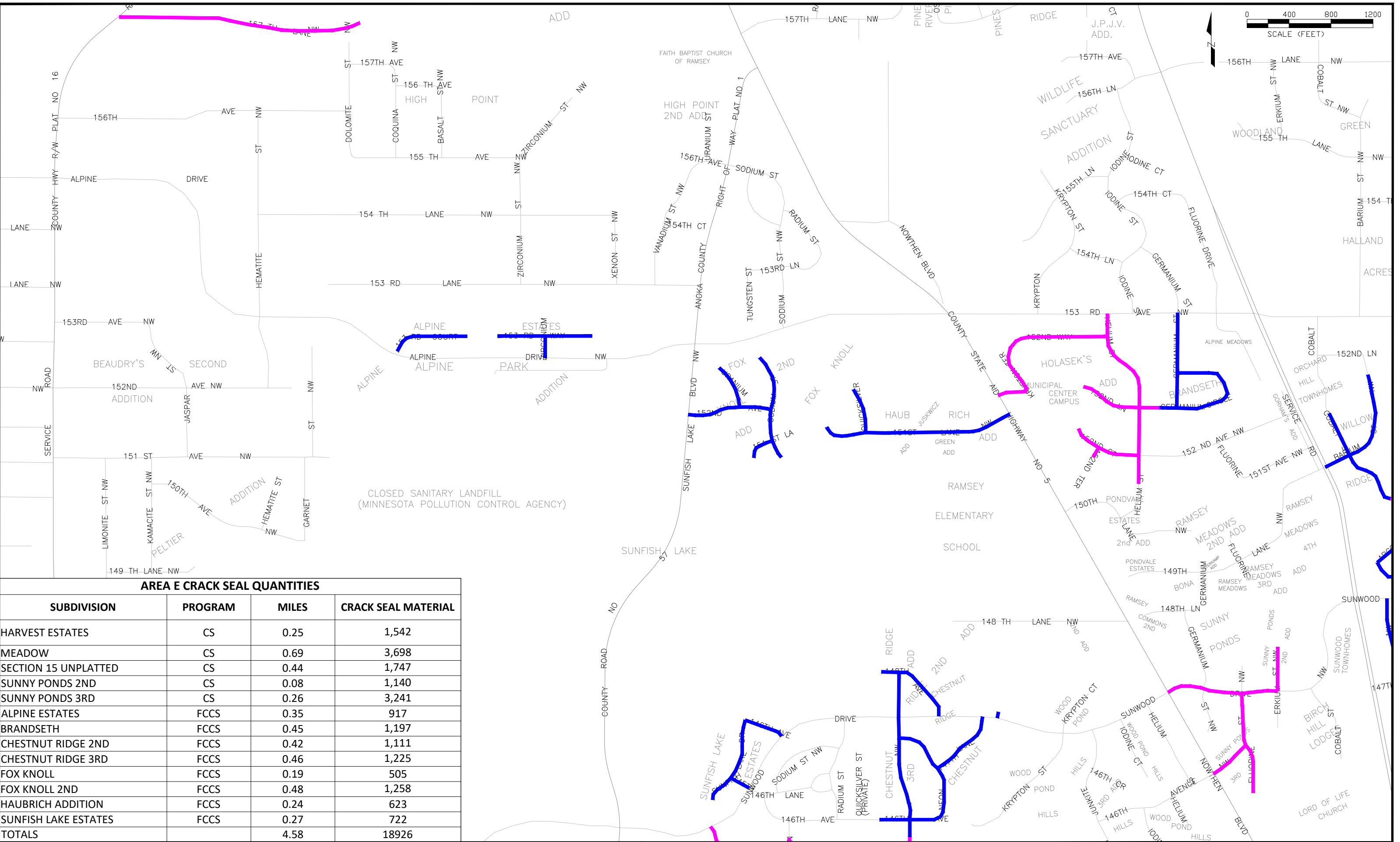
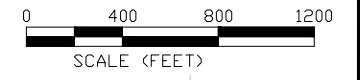

AREA E CRACK SEAL QUANTITIES

SUBDIVISION	PROGRAM	MILES	CRACK SEAL MATERIAL
HARVEST ESTATES	CS	0.25	1,542
MEADOW	CS	0.69	3,698
SECTION 15 UNPLATTED	CS	0.44	1,747
SUNNY PONDS 2ND	CS	0.08	1,140
SUNNY PONDS 3RD	CS	0.26	3,241
ALPINE ESTATES	FCCS	0.35	917
BRANDSETH	FCCS	0.45	1,197
CHESTNUT RIDGE 2ND	FCCS	0.42	1,111
CHESTNUT RIDGE 3RD	FCCS	0.46	1,225
FOX KNOLL	FCCS	0.19	505
FOX KNOLL 2ND	FCCS	0.48	1,258
HAUBRICH ADDITION	FCCS	0.24	623
SUNFISH LAKE ESTATES	FCCS	0.27	722
TOTALS		4.58	18926

CRACK SEAL

FRONT CURB CRACK SEAL ONLY

NOTE: CRACK SEAL - INCLUDES FRONT OF CONCRETE CURB
 FRONT OF CURB IS CONSIDERED EDGE BETWEEN CONCRETE CURB AND GUTTER WITH
 EDGE OF BITUMINOUS PAVEMENT.

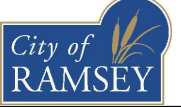

CITY OF RAMSEY
 7550 SUNWOOD DRIVE
 RAMSEY, MN 55303
 (763) 427-1410 FAX (763) 433-9898

AREA E

2020 CRACK SEAL IMPROVEMENTS
CITY PROJECT NO. 20-00
 CITY OF RAMSEY, MINNESOTA

SHEET
6
 OF
6
 SHEETS