

1 VAULTED WALL DETAIL
VIEW FROM REC. ROOM 1/4"=1'-0"

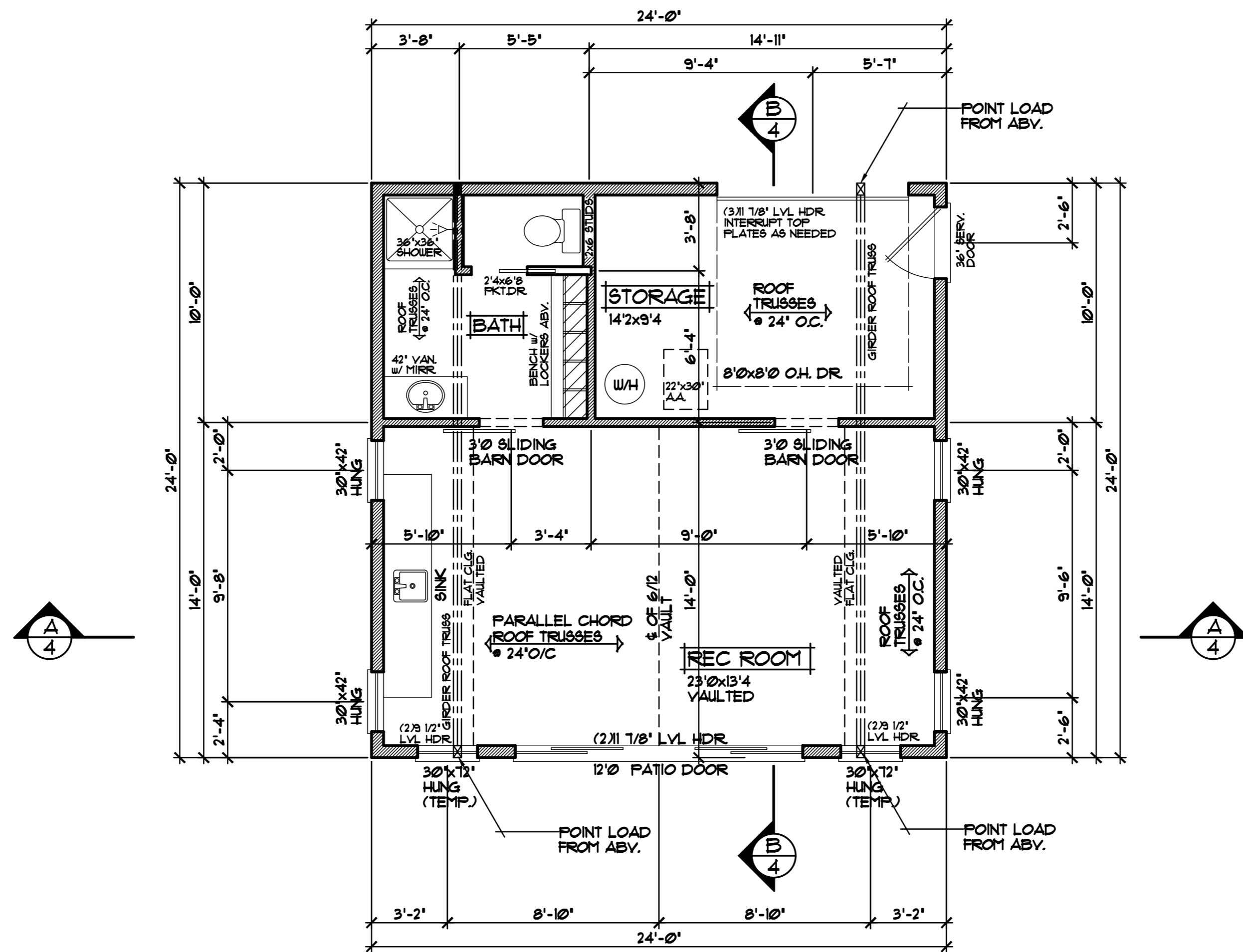

MAIN LEVEL PLAN 1/4"=1'-0"
576 SQFT. MAIN LEVEL

FRAMING NOTES

- 9'-1 1/8' PLATE HEIGHT • ENTIRE MAIN LEVEL (UNLESS NOTED OTHERWISE)
- FRAME ALL EXTERIOR STUDS w/ 2x6 STUDS @ 16' O.C. (TYP)

DOOR & WINDOW NOTES

- GENERIC WINDOWS SPECIFIED, VERIFY ROUGH OPENING SIZES FOR DOORS & WINDOWS w/ MANUFACTURER
- WINDOWS with "x" REQUIRE A SASH STOPPER (TYP)
- ALL WINDOW & DOOR OPENINGS TO HAVE (2)2x10 #2 GRADE HEADER or BETTER (UNLESS NOTED OTHERWISE)
- TOP OF RO. FOR ALL WINDOWS ON MAIN LEVEL TO BE 6'-10 1/2' FROM SUB-FLOOR (UNLESS NOTED OTHERWISE)

SPECIAL NOTICE:
CROIX DESIGN AND DRAFTING, INC. ACCEPTS NO RESPONSIBILITY FOR ERRORS AND/OR OMISSIONS. THESE DRAWINGS ARE DESIGN CONCEPT ONLY. EVERY EFFORT HAS BEEN MADE TO PREVENT ERRORS, BUT THE USER MUST CHECK ALL DIMENSIONS AND CONDITIONS BEFORE CONSTRUCTION. THE USER SHALL BE RESPONSIBLE FOR ANY CHANGES OR ADJUSTMENTS REQUIRED DURING ACTUAL CONSTRUCTION. NO REPRESENTATION IS MADE OR IMPLIED FOR ACCURACY.

OFFICE: 763.757.5997
FAX: 763.757.4383
ANDOVER, MINNESOTA
WWW.CROIXDESIGN.COM



BUILT BY: