

CITY OF RAMSEY

5751 164TH LANE DRAINAGE IMPROVEMENTS

CITY IMPROVEMENT PROJECT NO. 19-17

GOVERNING SPECIFICATIONS

THE 2018 EDITION OF THE MINNESOTA DEPARTMENT OF TRANSPORTATION "STANDARD SPECIFICATIONS FOR CONSTRUCTION" SHALL GOVERN.

ALL FEDERAL, STATE AND LOCAL LAWS, REGULATIONS AND ORDINANCES SHALL BE COMPLIED WITH IN THE CONSTRUCTION OF THIS PROJECT.

ALL TRAFFIC CONTROL DEVICES AND SIGNING SHALL CONFORM TO THE MINNESOTA MANUAL ON UNIFORM TRAFFIC CONTROL DEVICES, INCLUDING THE FIELD MANUAL FOR TEMPORARY TRAFFIC CONTROL ZONE LAYOUTS.

SHEET INDEX

THIS PLAN CONTAINS 5 SHEETS

SHEET No.	DESCRIPTION
-----------	-------------

1	TITLE SHEET
2	STATEMENT OF ESTIMATED QUANTITIES
3	EXISTING CONDITIONS & REMOVALS
4	STORM SEWER & GRADING
5	PROFILE & DETAILS



LOCATION MAP

LEGEND

	LIGHT POLE		EASEMENT
	TREE		RIGHT OF WAY
	SHRUB		ELECTRIC
	SIGN		OVERHEAD ELECTRIC
	VALVE		GAS
	UTILITY PEDESTAL		TELECOMMUNICATIONS
	HAND HOLE		STORM SEWER
	REMOVE TREE		SANITARY SEWER
	3'X2' CATCH BASIN		WATERMAIN
	MANHOLE		SAWCUT PAVEMENT
	INLET PROTECTION		TREE LINE
	HYDRANT		FENCE
	VALVE		LANDSCAPING
			RETAINING WALL
			5' CONTOUR LINE
			1' CONTOUR LINE

I hereby certify that this plan, specification, or report was prepared by me or under my direct supervision and that I am a duly Licensed Professional Engineer under the laws of the State of Minnesota.

JOE FERIANCEK, P.E.
 CITY OF RAMSEY

57095 DATE 6/20/20
 LIC. NO.

DATE	REVISION



CITY OF RAMSEY
 7550 SUNWOOD DRIVE
 RAMSEY, MN 55303
 (763) 427-1410 FAX (763) 433-9898

THE SUBSURFACE UTILITY INFORMATION IN THIS PLAN IS UTILITY QUALITY LEVEL D. THIS QUALITY LEVEL WAS DETERMINED ACCORDING TO THE GUIDELINES OF CI/ASCE 38-02, ENTITLED "STANDARD GUIDELINES FOR THE COLLECTION AND DEPICTION OF EXISTING SUBSURFACE UTILITY DATA."

NOTE: EXISTING UTILITY INFORMATION SHOWN ON THIS PLAN HAS BEEN PROVIDED BY THE UTILITY OWNER. THE CONTRACTOR SHALL FIELD VERIFY EXACT LOCATIONS PRIOR TO COMMENCING CONSTRUCTION AS REQUIRED BY STATE LAW. NOTIFY GOPHER STATE ONE CALL 1-800-252-1166 OR 651-454-0002



Call before you dig
 811
 651 454-0002 Metro
 800 252-1166 Outstate
www.gopherstateonecall.org

**19-17 5751 164th Lane Drainage Improvements
Estimated Quantities**

Notes	Item No.	MnDOT No.	Item	Unit	Estimated Quantity
	1	2021.501	Mobilization	LS	1
	2	2104.503	Remove Pipe Culvert	LF	24
1	3	2104.503	Sawing Bituminous Pavement	LF	99
1	4	2104.504	Remove Bituminous Pavement (Driveway)	SY	46
1	5	2104.504	Remove Bituminous Pavement (Street)	SY	58
2	6	2105.507	Common Excavation (EV)	CY	50
	7	2112.519	Subgrade Preparation	RDST	1
2	8	2211.507	Aggregate Base (CV); Class 5 Modified	CY	16
1	9	2232.504	Mill Bituminous Surface (2.0")	SY	18
3	10	2357.506	Bituminous Material for Tack Coat	GAL	8
4	11	2360.509	Type SP 9.5 Wearing Course Mixture (1.5")	TON	10
4	12	2360.509	Type SP 12.5 Non Wearing Course Mixture (2.0")	TON	7
	13	2501.502	15" CS Pipe Apron	EA	4
	14	2501.503	15" CS Pipe Culvert	LF	84
	15	2504.601	Irrigation System Repair	LS	1
5	16	2563.601	Traffic Control	LS	1
	17	2573.503	Silt Fence	LF	20
6	18	2574.507	Topsoil (LV)	CY	45
	19	2575.504	Sodding Type Lawn	SY	314

PAY ITEM NOTES:

1. REMOVAL LIMITS SHALL BE MARKED IN THE FIELD BY CITY STAFF.
2. EV TO CV CONVERSION FACTOR = 1.25.
3. ESTIMATED QUANTITY BASED ON APPLICATION RATE OF 0.07 GAL/SY.
4. ESTIMATED QUANTITY BASED ON APPLICATION RATE OF 110 LB/SY-IN.
5. LUMP SUM QUANTITY SHALL INCLUDE ALL COST REQUIRED FOR MAINTAINING FLAGGING OPERATIONS AS NECESSARY, MAINTAINING PEDESTRIAN ACCESS ROUTES, ANY SIGNAGE AND BARRICADES AS NECESSARY.
6. LV TO CV CONVERSION FACTOR = 1.30.

GENERAL NOTES:

1. THE LOCATION OF EXISTING UNDERGROUND UTILITIES ARE SHOWN IN AN APPROXIMATE WAY ONLY. IT IS NOT GUARANTEED ANY OR ALL EXISTING UTILITIES ARE SHOWN. THE CONTRACTOR SHALL DETERMINE THE EXACT LOCATION OF ALL EXISTING UTILITIES BEFORE COMMENCING WORK. HE AGREES TO BE FULLY RESPONSIBLE FOR ANY AND ALL DAMAGES WHICH MIGHT BE OCCASIONED BY HIS FAILURE TO EXACTLY LOCATE AND PRESERVE ANY AND ALL UNDERGROUND UTILITIES.
2. THE CONTRACTOR SHALL DETERMINE THE EXACT LOCATION OF ALL EXISTING IRRIGATION SYSTEMS WITHIN THE PROJECT CONSTRUCTION LIMITS BEFORE COMMENCING WORK. THE CONTRACTOR IS RESPONSIBLE FOR REPAIRING ANY DAMAGE TO IRRIGATION SYSTEMS.

DATE	REVISION

I hereby certify that this plan, specification, or report was prepared by me or under my direct supervision and that I am a duly Licensed Professional Engineer under the laws of the State of Minnesota

[Signature]
Engineer
Date 8/20/2020 Lic. No. 57095

DESIGNED BY:
JJF

DRAWN BY:
JJF

CHECKED BY:
JJF

DATE:
6/20/20

FILE No.
19-17

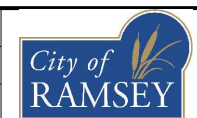

CITY OF RAMSEY
7550 SUNWOOD DRIVE
RAMSEY, MN 55303
(763) 427-1410 FAX (763) 433-9898

STATEMENT OF ESTIMATED QUANTITIES

**5751 164TH LANE DRAINAGE IMPROVEMENTS
CITY PROJECT NO. 19-17
CITY OF RAMSEY, MINNESOTA**

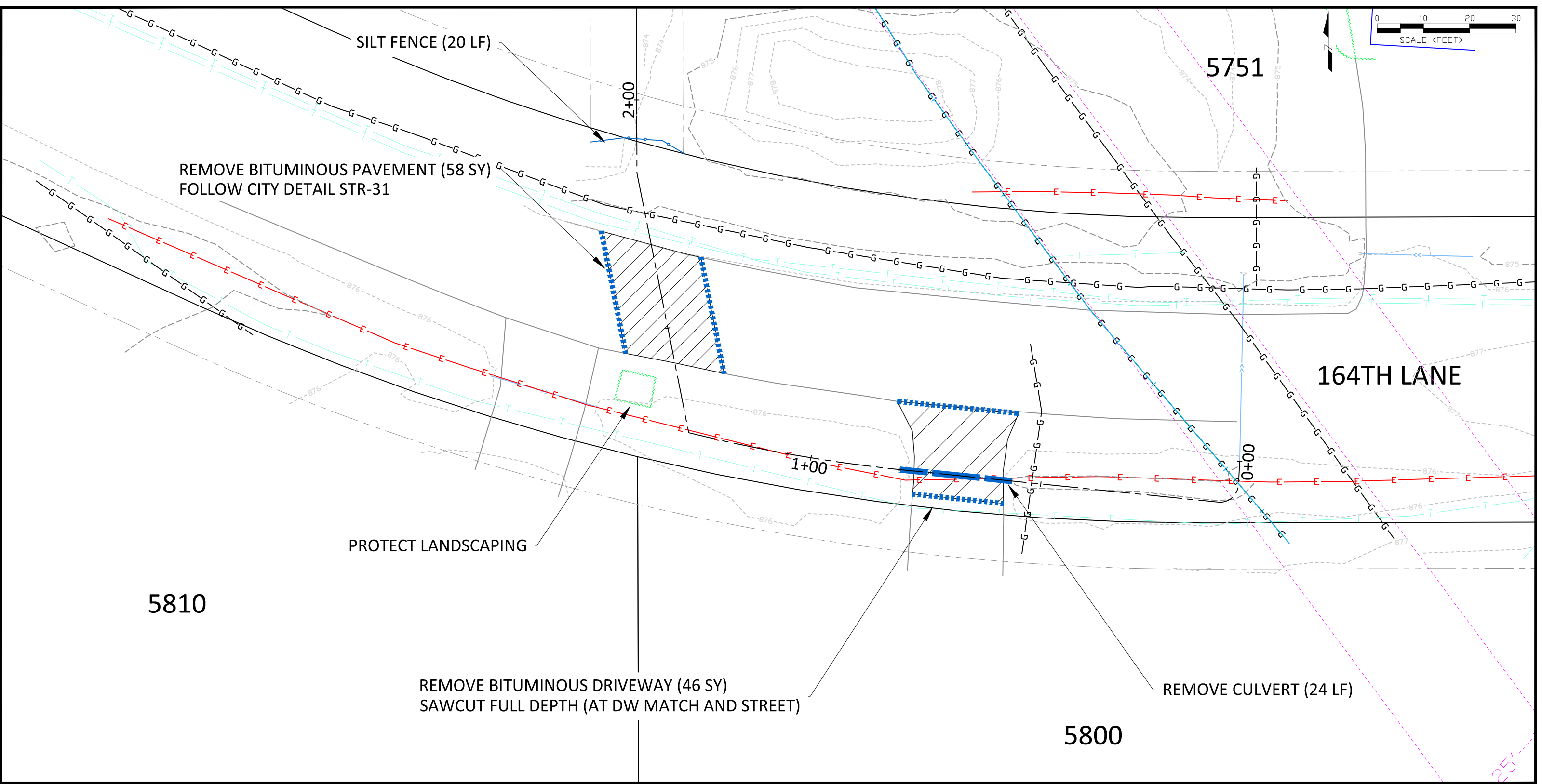
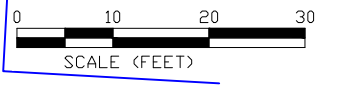

SILT FENCE (20 LF)

REMOVE BITUMINOUS PAVEMENT (58 SY)
FOLLOW CITY DETAIL STR-31

PROTECT LANDSCAPING

REMOVE BITUMINOUS DRIVEWAY (46 SY)
SAWCUT FULL DEPTH (AT DW MATCH AND STREET)

REMOVE CULVERT (24 LF)

LEGEND

- | | | | | | |
|-------------------|-------------------------------|-------|---------------------|---|-----------------------|
| --- | EX. MAJOR CONTOUR | — G — | GAS LINE | ▨ | EDGE OF PAVEMENT |
| - - - | EX. MINOR CONTOUR | — T — | COMMUNICATIONS LINE | ▨ | REMOVE BIT - STREET |
| - · - · - | D&U EASEMENT | — E — | ELECTRIC LINE | ▨ | REMOVE BIT - DRIVEWAY |
| - · - · - · - · - | NORTHERN NATURAL GAS EASEMENT | — B — | BUILDING | ▨ | REMOVE CULVERT |
| — | LOT LINE | — L — | LANDSCAPING | ▨ | SAWCUT - FULL DEPTH |

NOTE:

1. POT HOLE NORTHERN NATURAL GAS LINE BEFORE GRADING ACTIVITIES, MIN. 36" COVER REQUIRED.
2. CONTRACTOR IS RESPONSIBLE FOR FIXING ANY DAMAGE TO EXISTING IRRIGATION SYSTEMS AND LANDSCAPING.
3. THE LOCATION OF EXISTING UNDERGROUND UTILITIES ARE SHOWN IN AN APPROXIMATE WAY ONLY. IT IS NOT GUARANTEED ANY OR ALL EXISTING UTILITIES ARE SHOWN. THE CONTRACTOR SHALL DETERMINE THE EXACT LOCATION OF ALL EXISTING UTILITIES BEFORE COMMENCING WORK. HE AGREES TO BE FULLY RESPONSIBLE FOR ANY AND ALL DAMAGES WHICH MIGHT BE OCCASIONED BY HIS FAILURE TO EXACTLY LOCATE AND PRESERVE ANY AND ALL UNDERGROUND UTILITIES.

DATE	REVISION

I hereby certify that this plan, specification, or report was prepared by me or under my direct supervision and that I am a duly Licensed Professional Engineer under the laws of the State of Minnesota

Joe Feriancek
 JOE FERIANCEK
 Date 8/20/2020 Lic. No. 57095

DESIGNED BY:
JJF

DRAWN BY:
JJF

CHECKED BY:
JJF

DATE:
8/20/20

FILE No.
19-17

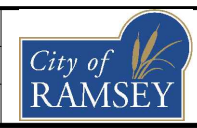

CITY OF RAMSEY
 7550 SUNWOOD DRIVE
 RAMSEY, MN 55303
 (763) 427-1410 FAX (763) 433-9898

EXISTING CONDITIONS & REMOVALS

5751 164TH LANE DRAINAGE IMPROVEMENTS
 CITY PROJECT NO. 19-17
 CITY OF RAMSEY, MINNESOTA

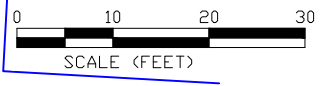

5751

NO EXCAVATION ALLOWED WITHIN 10' OF NORTHERN NATURAL GAS EASTERN PIPE. ONLY FILL ALLOWED WITHIN 10' OF PIPE.

PATCH BITUMINOUS PAVEMENT PER DETAIL (58 SY)
 1.5" WEAR COURSE
 2.0" NON WEAR COURSE
 4.0" CLASS 5 AGGREGATE BASE

164TH LANE

5810

2" BITUMINOUS PAVEMENT (46 SY)
 4" AGGREGATE BASE (46 SY)
 MATCH EXISTING

5800

FES 4
 STA 1+84.24
 INV. 874.00

2+00

54' - 15" CMP @ 0.23%

FES 3
 STA 1+29.97
 INV. 874.13

1+00

FES 2
 STA 0+83.49
 INV. 874.24

30' - 15" CMP @ 0.20%

FES 1
 STA 0+53.31
 INV. 874.30

875

875

876

875

875

875

876

876

875

875

876

875

875

876

877

876

877

876

877

876

877

876

877

876

877

876

877

876

877

876

877

876

877

876

877

876

877

876

877

876

877

876

877

876

877

876

877

876

877

876

877

876

877

876

877

876

877

876

877

876

877

876

877

876

877

876

877

876

877

876

877

876

877

876

877

876

877

876

877

876

877

876

877

876

877

876

877

876

877

876

877

876

877

876

877

876

877

876

877

876

877

876

877

876

877

876

877

876

877

876

877

876

877

876

877

876

877

876

877

876

877

876

877

876

877

876

877

876

877

876

877

876

877

876

877

876

877

876

877

876

877

876

877

876

877

876

877

876

877

876

877

876

877

876

877

876

877

876

877

876

877

876

877

876

877

876

877

876

877

876

877

876

877

876

877

876

877

876

877

876

877

876

877

876

877

876

877

876

877

876

877

876

877

876

877

876

877

876

877

876

877

876

877

876

877

876

877

876

877

876

877

876

877

876

877

876

877

876

877

876

877

876

877

876

877

876

877

876

877

876

877

876

877

876

877

876

877

876

877

876

877

876

877

876

877

876

877

876

877

876

877

876

877

876

877

876

877

876

877

876

877

876

877

876

877

876

877

876

877

876

877

876

877



Profile View of Proposed Ditch CL

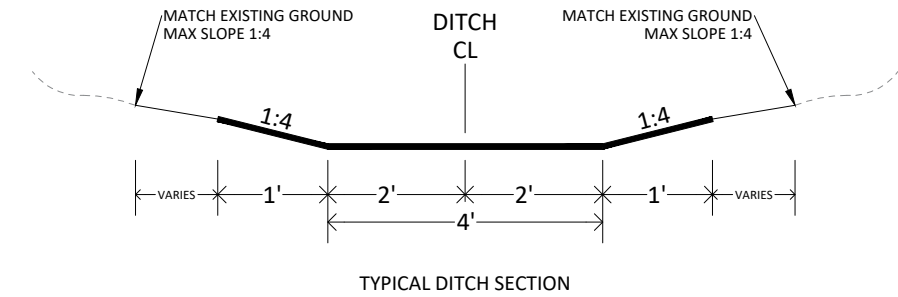
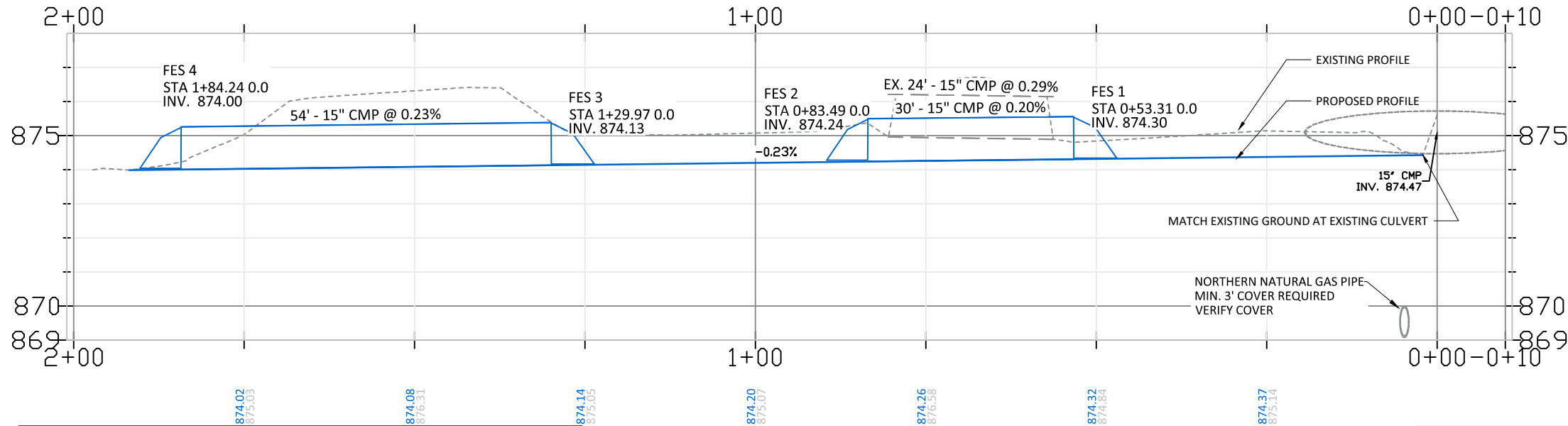

- Notes:
1. INSTALLATION OF 4" OF TOPSOIL REQUIRED ACROSS ALL DISTURBED AREAS.
 2. TOPSOIL IS DEFINED AS BLACK DIRT COMPOSED OF UNCONSOLIDATED MATERIAL, LARGELY UNDECOMPOSED ORGANIC MATTER WHICH IS SUITABLE FOUNDATION FOR VEGETATIVE GROWTH.
 3. THE COMPOSITION OF TOPSOIL SHOULD CONTAIN NO MORE THAN THIRTY-FIVE PERCENT (35%) SAND CONTENT.

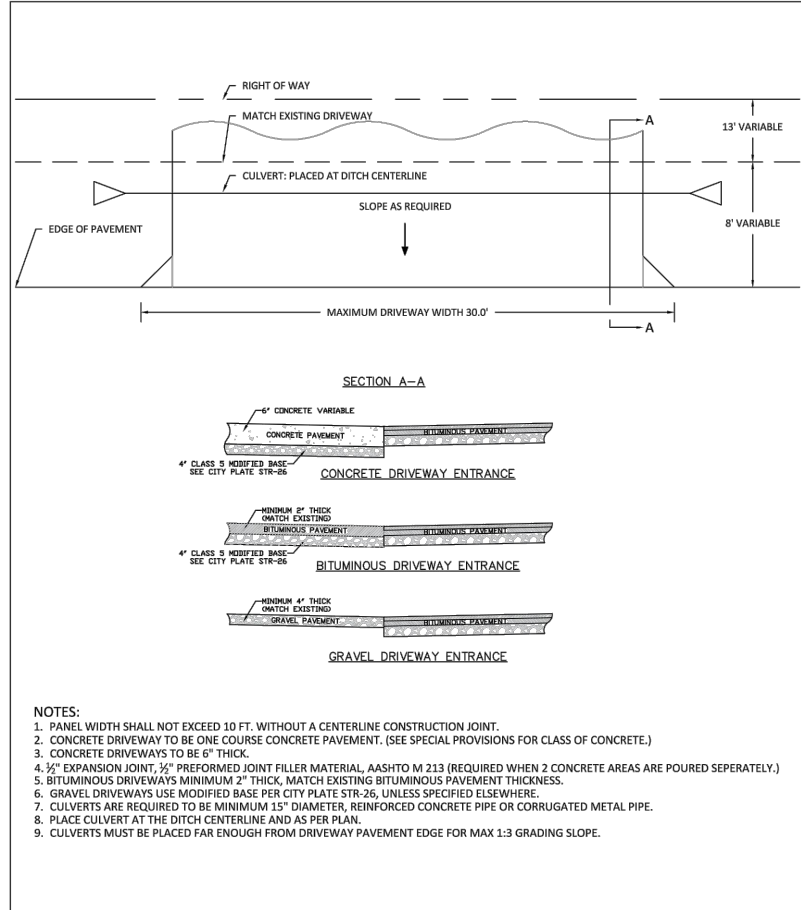
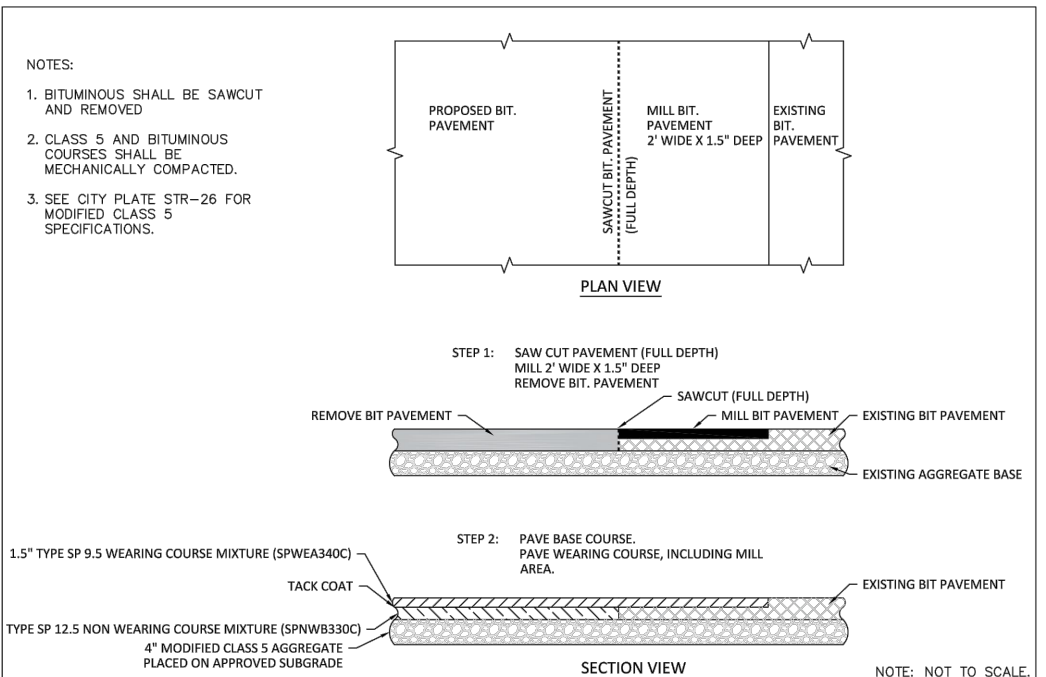

APPROVED: 7 - 2019

STANDARD DETAILS: TOPSOIL REQUIREMENTS

CITY PLATE No. ERO-6

APPROVED: 3 - 2017

CITY PLATE No. STR-31

STANDARD DETAILS: STREET TIE-IN

APPROVED: 2 - 2019

STANDARD DETAILS: RESIDENTIAL DRIVEWAY - URBAN SECTION

CITY PLATE No. STR-33

DATE	REVISION

I hereby certify that this plan, specification, or report was prepared by me or under my direct supervision and that I am a duly Licensed Professional Engineer under the laws of the State of Minnesota

Joe Feriancek
 JOE FERIANCEK
 Date 8/20/2020 Lic. No. 57095

DESIGNED BY: JJF
 DRAWN BY: JJF
 CHECKED BY: JJF

DATE: 8/20/20
 FILE No. 19-17

CITY OF RAMSEY
 7550 SUNWOOD DRIVE
 RAMSEY, MN 55303
 (763) 427-1410 FAX (763) 433-9898

PROFILE & DETAILS

5751 164TH LANE DRAINAGE IMPROVEMENTS
 CITY PROJECT NO. 19-17
 CITY OF RAMSEY, MINNESOTA