

CITY OF RAMSEY

5751 164TH LANE DRAINAGE IMPROVEMENTS

CITY IMPROVEMENT PROJECT NO. 19-17

GOVERNING SPECIFICATIONS

THE 2018 EDITION OF THE MINNESOTA DEPARTMENT OF TRANSPORTATION "STANDARD SPECIFICATIONS FOR CONSTRUCTION" SHALL GOVERN.

ALL FEDERAL, STATE AND LOCAL LAWS, REGULATIONS AND ORDINANCES SHALL BE COMPLIED WITH IN THE CONSTRUCTION OF THIS PROJECT.

ALL TRAFFIC CONTROL DEVICES AND SIGNING SHALL CONFORM TO THE MINNESOTA MANUAL ON UNIFORM TRAFFIC CONTROL DEVICES, INCLUDING THE FIELD MANUAL FOR TEMPORARY TRAFFIC CONTROL ZONE LAYOUTS.

SHEET INDEX

THIS PLAN CONTAINS 4 SHEETS

SHEET No.	DESCRIPTION
1	TITLE SHEET
2	EXISTING CONDITIONS & REMOVALS
3	STORM SEWER & GRADING
4	PROFILE & DETAILS



LOCATION MAP

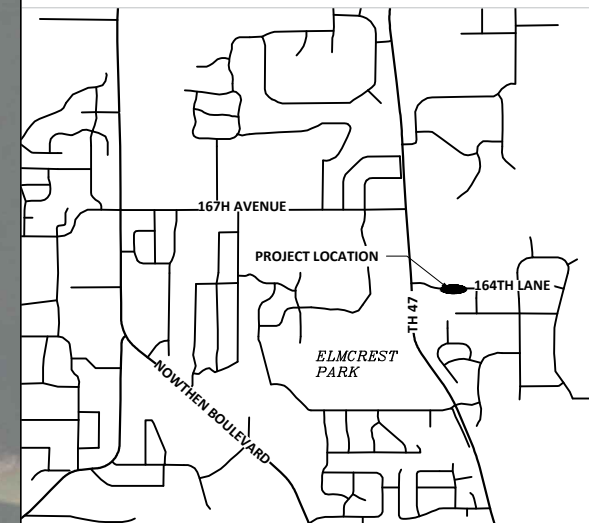

LEGEND

	LIGHT POLE		EASEMENT
	TREE		RIGHT OF WAY
	SHRUB		ELECTRIC
	SIGN		OVERHEAD ELECTRIC
	VALVE		GAS
	UTILITY PEDESTAL		TELECOMMUNICATIONS
	HAND HOLE		STORM SEWER
	REMOVE TREE		SANITARY SEWER
	3'X2' CATCH BASIN		WATERMAIN
	MANHOLE		SAWCUT PAVEMENT
	INLET PROTECTION		TREE LINE
	HYDRANT		FENCE
	VALVE		LANDSCAPING
			RETAINING WALL
			5' CONTOUR LINE
			1' CONTOUR LINE

I hereby certify that this plan, specification, or report was prepared by me or under my direct supervision and that I am a duly Licensed Professional Engineer under the laws of the State of Minnesota.

DRAFT

JOE FERIANCEK, P.E.
CITY OF RAMSEY

57095 DATE **6/19/20**
LIC. NO.

DATE	REVISION



CITY OF RAMSEY
7550 SUNWOOD DRIVE
RAMSEY, MN 55303
(763) 427-1410 FAX (763) 433-9898

THE SUBSURFACE UTILITY INFORMATION IN THIS PLAN IS UTILITY QUALITY LEVEL D. THIS QUALITY LEVEL WAS DETERMINED ACCORDING TO THE GUIDELINES OF CI/ASCE 38-02, ENTITLED "STANDARD GUIDELINES FOR THE COLLECTION AND DEPICTION OF EXISTING SUBSURFACE UTILITY DATA."

NOTE: EXISTING UTILITY INFORMATION SHOWN ON THIS PLAN HAS BEEN PROVIDED BY THE UTILITY OWNER. THE CONTRACTOR SHALL FIELD VERIFY EXACT LOCATIONS PRIOR TO COMMENCING CONSTRUCTION AS REQUIRED BY STATE LAW. NOTIFY GOPHER STATE ONE CALL 1-800-252-1166 OR 651-454-0002



Call before you dig
811
651 454-0002 Metro
800 252-1166 Outstate
www.gopherstateonecall.org

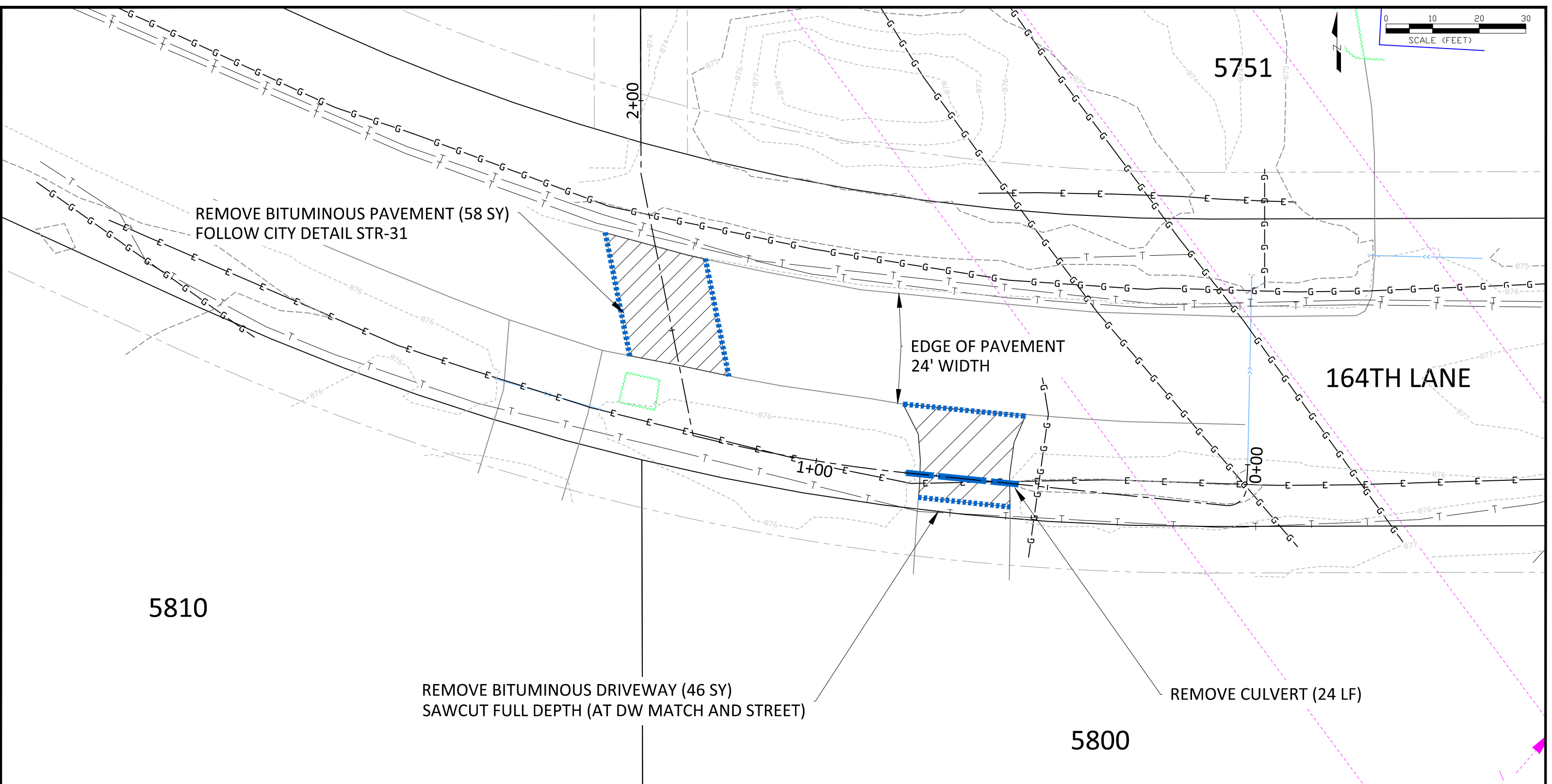
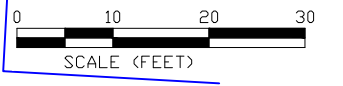

LEGEND

---	EX. MAJOR CONTOUR	— G —	GAS LINE	▨	EDGE OF PAVEMENT
- - -	EX. MINOR CONTOUR	— T —	COMMUNICATIONS LINE	▨	REMOVE BIT - STREET
- · - · -	D&U EASEMENT	— E —	ELECTRIC LINE	▨	REMOVE BIT - DRIVEWAY
---	NORTHERN NATURAL GAS EASEMENT	— [Blue] —	BUILDING	▨	REMOVE CULVERT
---	LOT LINE	— [Green] —	LANDSCAPING	▨	SAWCUT - FULL DEPTH

NOTE:

1. POT HOLE NORTHERN NATURAL GAS LINE BEFORE GRADING ACTIVITIES, MIN. 36" COVER REQUIRED.
2. CONTRACTOR IS RESPONSIBLE FOR FIXING ANY DAMAGE TO EXISTING IRRIGATION SYSTEMS AND LANDSCAPING.
3. THE LOCATION OF EXISTING UNDERGROUND UTILITIES ARE SHOWN IN AN APPROXIMATE WAY ONLY. IT IS NOT GUARANTEED ANY OR ALL EXISTING UTILITIES ARE SHOWN. THE CONTRACTOR SHALL DETERMINE THE EXACT LOCATION OF ALL EXISTING UTILITIES BEFORE COMMENCING WORK. HE AGREES TO BE FULLY RESPONSIBLE FOR ANY AND ALL DAMAGES WHICH MIGHT BE OCCASIONED BY HIS FAILURE TO EXACTLY LOCATE AND PRESERVE ANY AND ALL UNDERGROUND UTILITIES.

DATE	REVISION

I hereby certify that this plan, specification, or report was prepared by me or under my direct supervision and that I am a duly Licensed Professional Engineer under the laws of the State of Minnesota

DRAFT
Engineer
Date X/XX/XX Lic. No. XXXXX

DESIGNED BY: JJF	DATE: 6/19/20
DRAWN BY: JJF	FILE No. 19-17
CHECKED BY: JJF	

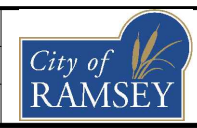

CITY OF RAMSEY
7550 SUNWOOD DRIVE
RAMSEY, MN 55303
(763) 427-1410 FAX (763) 433-9898

EXISTING CONDITIONS & REMOVALS

5751 164TH LANE DRAINAGE IMPROVEMENTS
CITY PROJECT NO. 19-17
CITY OF RAMSEY, MINNESOTA

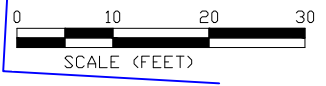

5751

PATCH BITUMINOUS PAVEMENT PER DETAIL (58 SY)
 1.5" WEAR COURSE
 2.0" NON WEAR COURSE
 4.0" CLASS 5 AGGREGATE BASE

FES 4
 STA 1+84.24
 INV. 874.00

2+00

54' - 15" CMP @ 0.23%

164TH LANE

FES 3
 STA 1+29.97
 INV. 874.13

1+00

FES 2
 STA 0+83.49
 INV. 874.24

30' - 15" CMP @ 0.20%

FES 1
 STA 0+53.31
 INV. 874.30

0+00

5810

2" BITUMINOUS PAVEMENT (46 SY)
 4" AGGREGATE BASE (46 SY)
 MATCH EXISTING

5800

LEGEND

- EX. MAJOR CONTOUR
- - - EX. MINOR CONTOUR
- - - D&U EASEMENT
- - - NORTHERN NATURAL GAS EASEMENT
- LOT LINE
- PROPOSED MAJOR CONTOUR
- PROPOSED MINOR CONTOUR
- ▨ BITUMINOUS PAVEMENT - STREET
- ▨ BITUMINOUS PAVEMENT - DRIVEWAY
- PROPOSED CULVERT

NOTE:

1. RESTORE DISTURBED AREAS WITH 4" TOPSOIL AND SODDING TYPE LAWN.
2. ESTIMATED 50 CY OF EXCAVATION REQUIRED. ON-SITE TOPSOIL MAY BE SALVAGED, NOT INCLUDED IN EXCAVATION ESTIMATE. ESTIMATED 45 CY OF TOPSOIL REQUIRED BASED ON DISTURBED AREA OF 2,826 SF AND COMPACTION FACTOR OF 1.3.
3. CONTRACTOR IS RESPONSIBLE FOR FIXING ANY DAMAGE TO EXISTING IRRIGATION SYSTEMS.
4. CONTRACTOR IS RESPONSIBLE FOR FIXING ANY DAMAGE TO EXISTING LANDSCAPING.

DATE	REVISION

I hereby certify that this plan, specification, or report was prepared by me or under my direct supervision and that I am a duly Licensed Professional Engineer under the laws of the State of Minnesota

DRAFT
 Engineer
 Date X/XX/XX Lic. No. XXXXX

DESIGNED BY:
 JJF
 DRAWN BY:
 JJF
 CHECKED BY:
 JJF

DATE:
 6/19/20
 FILE No.
 19-17

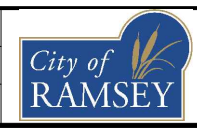

CITY OF RAMSEY
 7550 SUNWOOD DRIVE
 RAMSEY, MN 55303
 (763) 427-1410 FAX (763) 433-9898

STORM SEWER & GRADING

5751 164TH LANE DRAINAGE IMPROVEMENTS
 CITY PROJECT NO. 19-17
 CITY OF RAMSEY, MINNESOTA



Profile View of Proposed Ditch CL

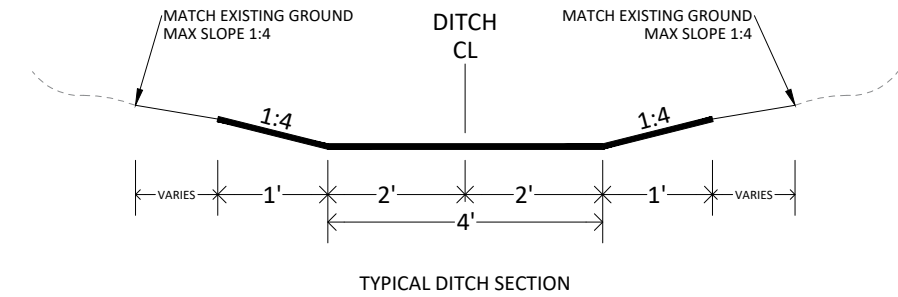
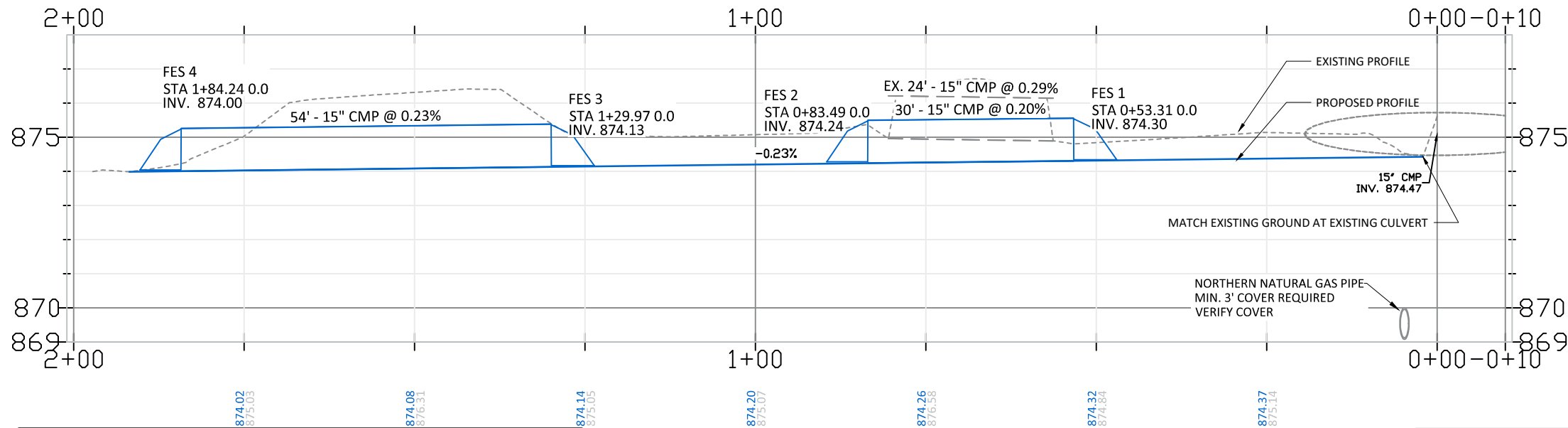

- Notes:
1. INSTALLATION OF 4" OF TOPSOIL REQUIRED ACROSS ALL DISTURBED AREAS.
 2. TOPSOIL IS DEFINED AS BLACK DIRT COMPOSED OF UNCONSOLIDATED MATERIAL, LARGELY UNDECOMPOSED ORGANIC MATTER WHICH IS SUITABLE FOUNDATION FOR VEGETATIVE GROWTH.
 3. THE COMPOSITION OF TOPSOIL SHOULD CONTAIN NO MORE THAN THIRTY-FIVE PERCENT (35%) SAND CONTENT.

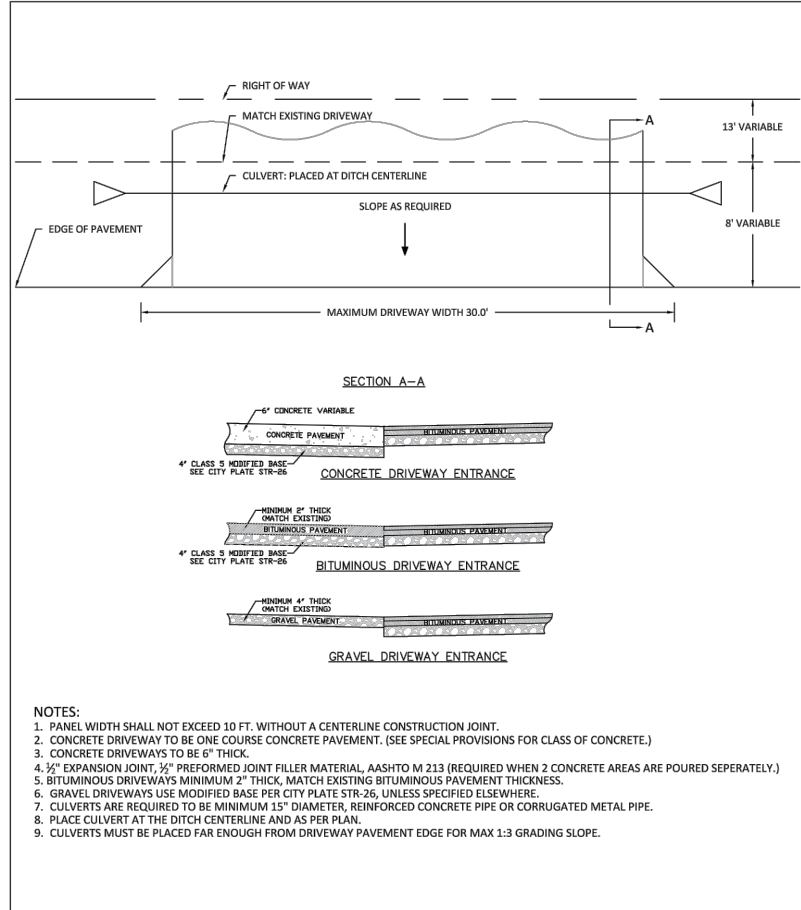
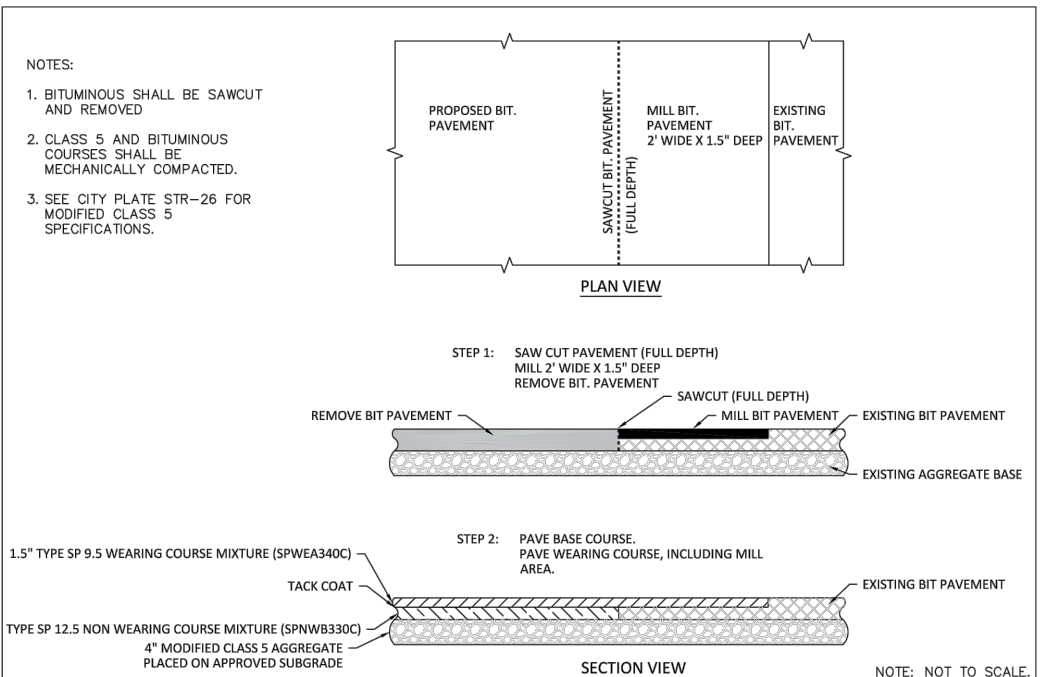

APPROVED: 7 - 2019

STANDARD DETAILS: TOPSOIL REQUIREMENTS

CITY PLATE No. ERO-6

APPROVED: 3 - 2017

CITY PLATE No. STR-31

STANDARD DETAILS: STREET TIE-IN

APPROVED: 2 - 2019

STANDARD DETAILS: RESIDENTIAL DRIVEWAY - URBAN SECTION

CITY PLATE No. STR-33

DATE	REVISION

I hereby certify that this plan, specification, or report was prepared by me or under my direct supervision and that I am a duly Licensed Professional Engineer under the laws of the State of Minnesota

DRAFT
Engineer

Date XX/XX/XX Lic. No. XXXXX

DESIGNED BY: JJF
DRAWN BY: JJF
CHECKED BY: JJF

DATE: 6/19/20
FILE No. 19-17

CITY OF RAMSEY
7550 SUNWOOD DRIVE
RAMSEY, MN 55303
(763) 427-1410 FAX (763) 433-9898

PROFILE & DETAILS

5751 164TH LANE DRAINAGE IMPROVEMENTS
CITY PROJECT NO. 19-17
CITY OF RAMSEY, MINNESOTA