

EXISTING TYPICAL SECTION

RIVERDALE DRIVE NW

NOT TO SCALE

STA 0+19 TO STA 23+70

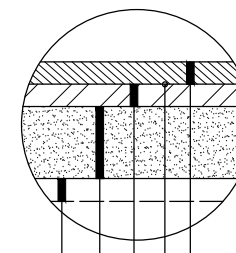
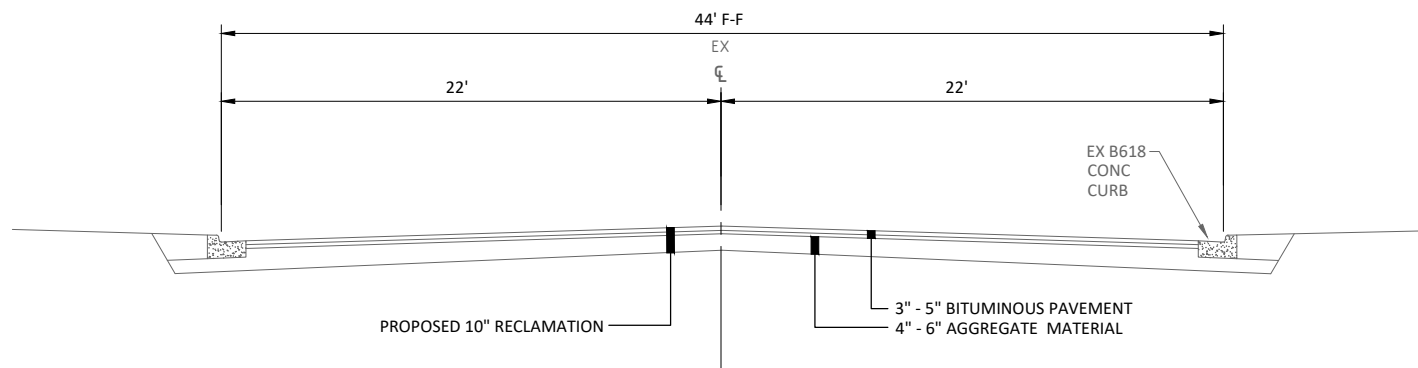

- 2" TYPE SP 9.5 WEARING COURSE (SPWEA340C) (2360)
- BITUMINOUS TACK COAT (2357) (INCIDENTAL)
- 2" TYPE SP 12.5 NON WEARING COURSE (SPNWB330C) (2360)
- 6" AGGREGATE BASE CL 5, RECYCLED RECLAIM MATERIAL (3135)
- 12" SUBGRADE PREPARATION (2112) (INCIDENTAL)

INSET A - BITUMINOUS ROADWAY

NOT TO SCALE

NOTES:

1. ANY VARIATIONS FROM THE TYPICAL SECTION DIMENSIONS ARE SHOWN ON THE PLAN DRAWINGS
2. PAVEMENT SLOPES AT INTERSECTION LOCATIONS MAY VARY FROM THOSE SHOWN ON THE TYPICAL SECTION
3. ELEVATIONS SHOWN ARE RELATIVE TO C/L AND DO NOT RELATE TO ACTUAL CONSTRUCTION GRADES
4. SUBGRADE SHALL BE TEST ROLLED PRIOR TO AGGREGATE BASE INSTALLATION AND CONFORM TO MnDOT SPEC 2111
5. TRAIL CLEAR ZONE 1:6 MAX, NO TRAFFIC SIGNS SHALL BE INSTALLED WITHIN TRAIL CLEAR ZONE

S.A.P. 199-108-004 TYPICAL SECTION

RIVERDALE DRIVE NW

NOT TO SCALE

STA 0+19.0 TO STA 13+45.0

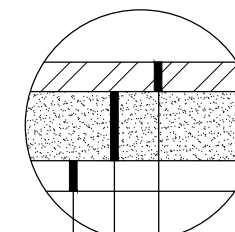
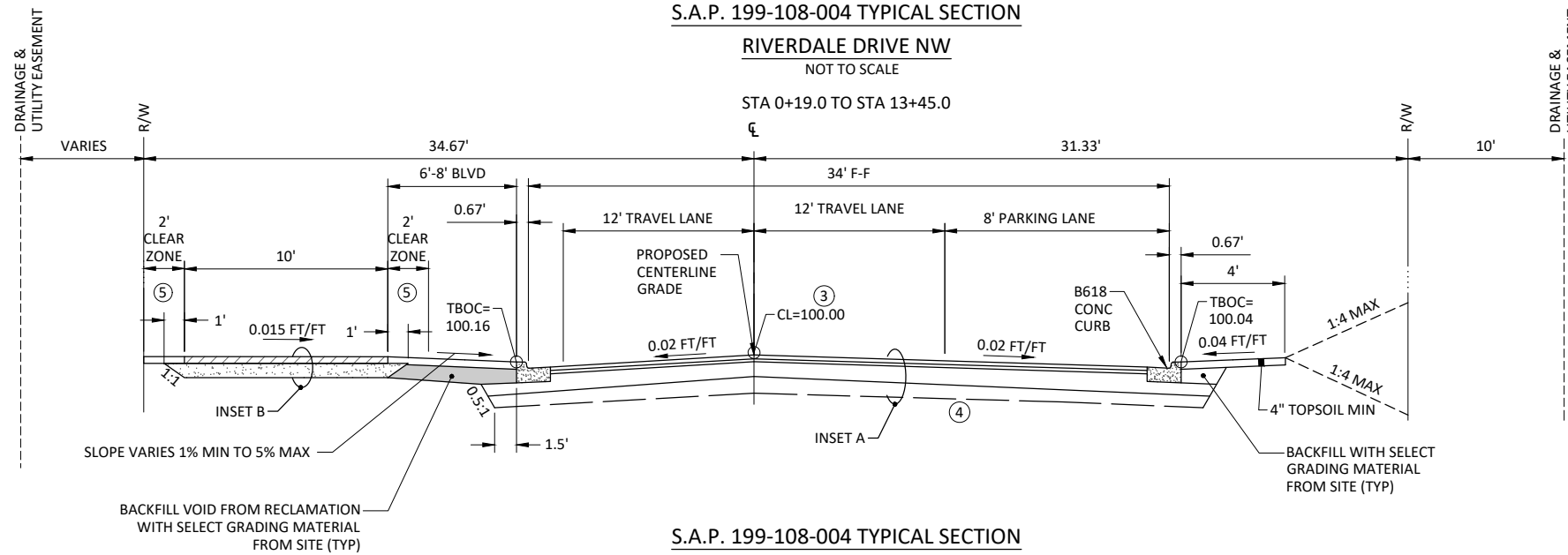

- 2.5" TYPE SP 9.5 WEARING COURSE (SPWEA340C) (2360)
- 4" AGGREGATE BASE CL 5, MOD (2211) (SEE STR-26)
- SUBGRADE PREPARATION (2112) (INCIDENTAL)

INSET B - BITUMINOUS TRAIL

NOT TO SCALE

**TABLE A
MODIFIED CLASS 5
SPECIFICATIONS**

% PASSING

1"	100
3/4"	90 - 100
3/8"	50 - 80
No.4	35 - 70
No.10	20 - 60
No.40	10 - 35
No.200	5 - 10

- NOTES:
1. THE AGGREGATE BASE CONSTRUCTION WILL BE ACCEPTED FOR PAYMENT IN ACCORDANCE WITH THE PROVISIONS IN TABLE A.
 2. IF THE AGGREGATE BASE FAILS TO MEET THE REQUIREMENTS OF TABLE A THE MATERIAL CAN BE CORRECTED IN PLACE OR REMOVED AND REPLACED WITH MATERIAL THAT MEET THE REQUIREMENTS OF TABLE A.
 3. IN THE EVENT THAT RECYCLED MATERIAL IS USE IT MUST MEET MN DOT REQUIREMENTS FOR RECYCLED BASE.

APPROVED:
2 - 2003



STANDARD DETAILS:
MODIFIED CLASS 5
SPECIFICATIONS
CITY PLATE NO. STR-26

S.A.P. 199-108-004 TYPICAL SECTION

RIVERDALE DRIVE NW

NOT TO SCALE

STA 13+45.0 TO STA 23+70.0

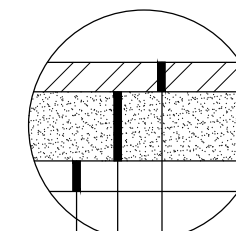
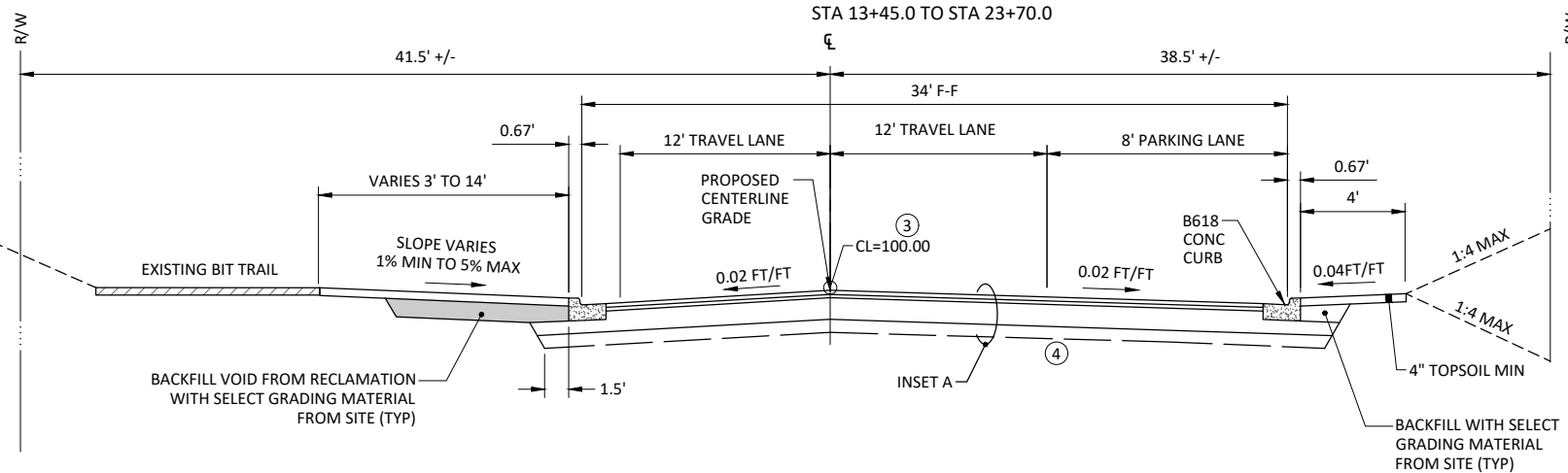

- MINIMUM 3" TYPE SP 9.5 WEARING COURSE (SPWEA340C) (2360) (MATCH EXISTING THICKNESS & LIFTS)
- 6" AGGREGATE BASE CL 5, RECYCLED RECLAIM MATERIAL (3135)
- SUBGRADE PREPARATION (2112) (INCIDENTAL)

BITUMINOUS DRIVEWAY (COMMERCIAL)

NOT TO SCALE

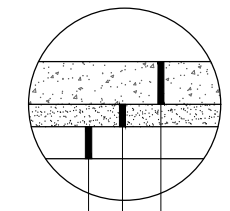

- 6" CONCRETE WALK (2521)
- 3" AGGREGATE BASE CL 5, MOD (2211) (SEE STR-26)
- SUBGRADE PREPARATION (2112) (INCIDENTAL)

CONCRETE WALK / PEDESTRIAN RAMP

NOT TO SCALE

© Bolton & Menk, Inc. 2021. All Rights Reserved. File Name: S:\11232041\CD\122021\101.RWP 1/12/2021 2:27:25 PM

I HEREBY CERTIFY THAT THIS PLAN, SPECIFICATION, OR REPORT WAS PREPARED BY ME OR UNDER MY DIRECT SUPERVISION AND THAT I AM A DULY LICENSED PROFESSIONAL ENGINEER UNDER THE LAWS OF THE STATE OF MINNESOTA.

90% PLANS

KEVIN P. KIELB
LIC. NO. 23211 DATE 1/12/2021



7533 SUNWOOD DR NW, SUITE 206
RAMSEY, MINNESOTA 55303
Phone: (763) 433-2851
Email: Ramsey@bolton-menk.com
www.bolton-menk.com



DESIGNED	NO.	ISSUED FOR	DATE
ZFL			
ZFL			
KPK			
CLIENT PROJ. NO.	21-00		

CITY OF RAMSEY, MINNESOTA
RIVERDALE DRIVE IMPROVEMENTS, S.A.P. 199-108-004

TYPICAL SECTIONS

SHEET
7
OF
37