

CITY OF RAMSEY

2021 ADDITIONAL PAVEMENT OVERLAY IMPROVEMENTS

CITY IMPROVEMENT PROJECT NO. 21-12

GOVERNING SPECIFICATIONS

THE 2018 EDITION OF THE MINNESOTA DEPARTMENT OF TRANSPORTATION "STANDARD SPECIFICATIONS FOR CONSTRUCTION" SHALL GOVERN.

ALL FEDERAL, STATE AND LOCAL LAWS, REGULATIONS AND ORDINANCES SHALL BE COMPLIED WITH IN THE CONSTRUCTION OF THIS PROJECT.

ALL TRAFFIC CONTROL DEVICES AND SIGNING SHALL CONFORM TO THE MINNESOTA MANUAL ON UNIFORM TRAFFIC CONTROL DEVICES, INCLUDING THE FIELD MANUAL FOR TEMPORARY TRAFFIC CONTROL ZONE LAYOUTS.

SHEET INDEX

THIS PLAN CONTAINS 22 SHEETS

SHEET No.	DESCRIPTION
01	TITLE SHEET
02	STATEMENT OF ESTIMATED QUANTITIES
03-04	CITY DETAILS
05-10	MNDOT PED RAMP DETAILS
11-13	BITUMINOUS MILL & OVERLAY - TRAPROCK COMMONS
14-17	BITUMINOUS MILL & OVERLAY - WILDLIFE SANCTUARY 2ND & 3RD
18-21	BITUMINOUS MILL & OVERLAY - REILLEY ESTATES 1ST, 2ND & 3RD
22	BITUMINOUS MILL & OVERLAY - SUNFISH GATEWAY BP

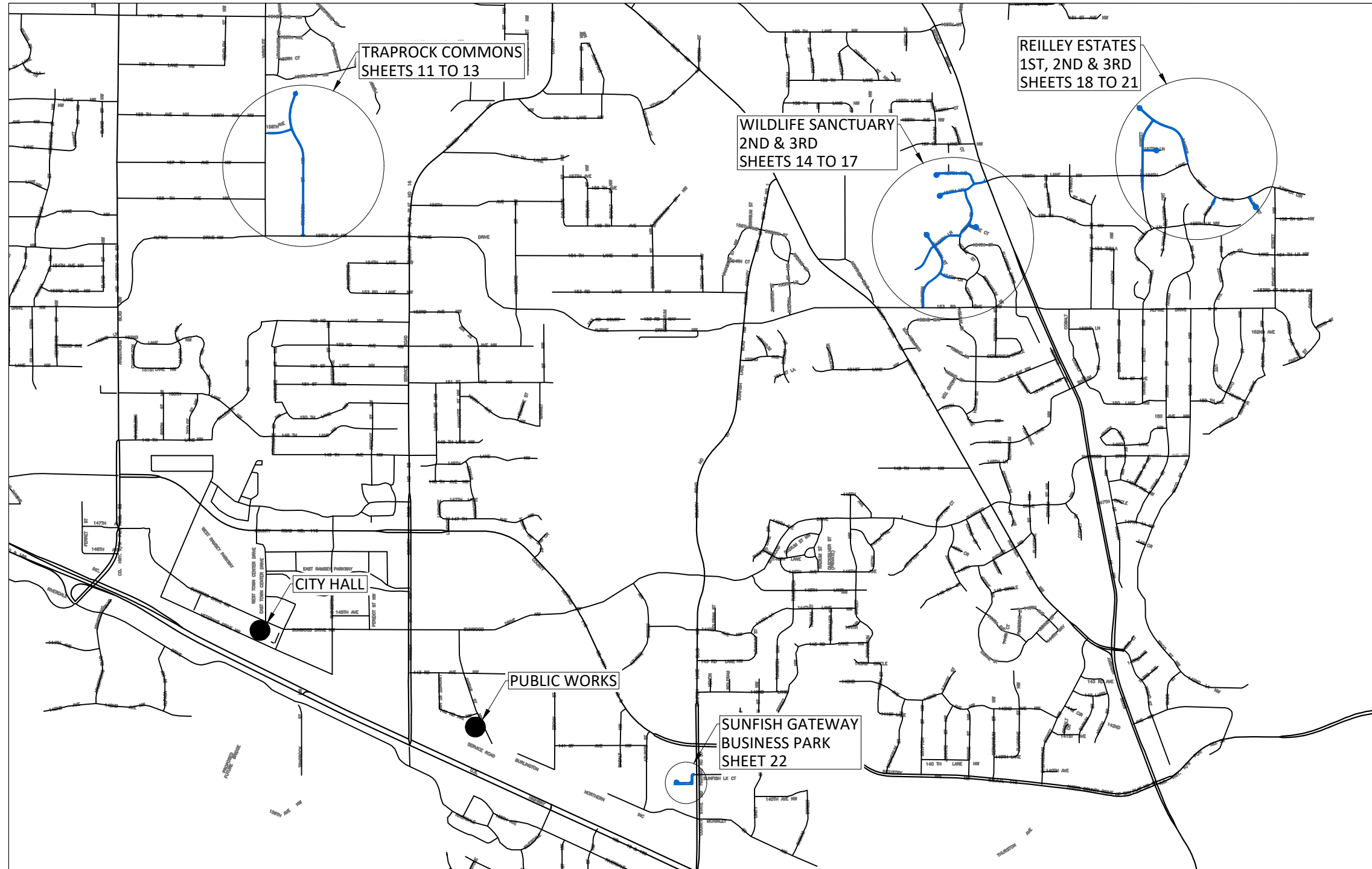

LEGEND

	LIGHT POLE		EASEMENT
	TREE		RIGHT OF WAY
	SHRUB		ELECTRIC
	SIGN		OVERHEAD ELECTRIC
	VALVE		GAS
	UTILITY PEDESTAL		TELECOMMUNICATIONS
	HAND HOLE		STORM SEWER
	REMOVE TREE		SANITARY SEWER
	3'X2' CATCH BASIN		WATERMAIN
	MANHOLE		SAWCUT PAVEMENT
	INLET PROTECTION		TREE LINE
	HYDRANT		FENCE
	VALVE		LANDSCAPING
			RETAINING WALL
			5' CONTOUR LINE
			1' CONTOUR LINE
			SILT FENCE
			REMOVE BITUMINOUS PAVEMENT
			SODDING TYPE LAWN
			CONCRETE PAVEMENT
			BITUMINOUS PAVEMENT
			GRAVEL SURFACE
			MILL BITUMINOUS PAVEMENT

I hereby certify that this plan, specification, or report was prepared by me or under my direct supervision and that I am a duly Licensed Professional Engineer under the laws of the State of Minnesota.

DRAFT

JOE FERIANCEK, P.E.
CIVIL ENGINEER II

DATE: --/--/--
LIC. NO. -----

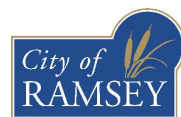
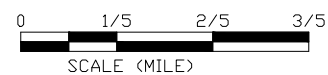

CITY OF RAMSEY
7550 SUNWOOD DRIVE
RAMSEY, MN 55303
(763) 427-1410 FAX (763) 433-9898

THE SUBSURFACE UTILITY INFORMATION IN THIS PLAN IS UTILITY QUALITY LEVEL D. THIS QUALITY LEVEL WAS DETERMINED ACCORDING TO THE GUIDELINES OF CI/ASCE 38-02, ENTITLED "STANDARD GUIDELINES FOR THE COLLECTION AND DEPICTION OF EXISTING SUBSURFACE UTILITY DATA."

NOTE: EXISTING UTILITY INFORMATION SHOWN ON THIS PLAN HAS BEEN PROVIDED BY THE UTILITY OWNER. THE CONTRACTOR SHALL FIELD VERIFY EXACT LOCATIONS PRIOR TO COMMENCING CONSTRUCTION AS REQUIRED BY STATE LAW. NOTIFY GOPHER STATE ONE CALL 1-800-252-1166 OR 651-454-0002



Call before you dig
811
651 454-0002 Metro
800 252-1166 Outstate
www.gopherstateonecall.org

DATE	REVISION