

Jul 22, 2021 - 4:50pm
 K:\PRIVATE\4443.06\Engineering\4443.06_REMOVALS_AND_EXISTING_CONDITIONS.dwg

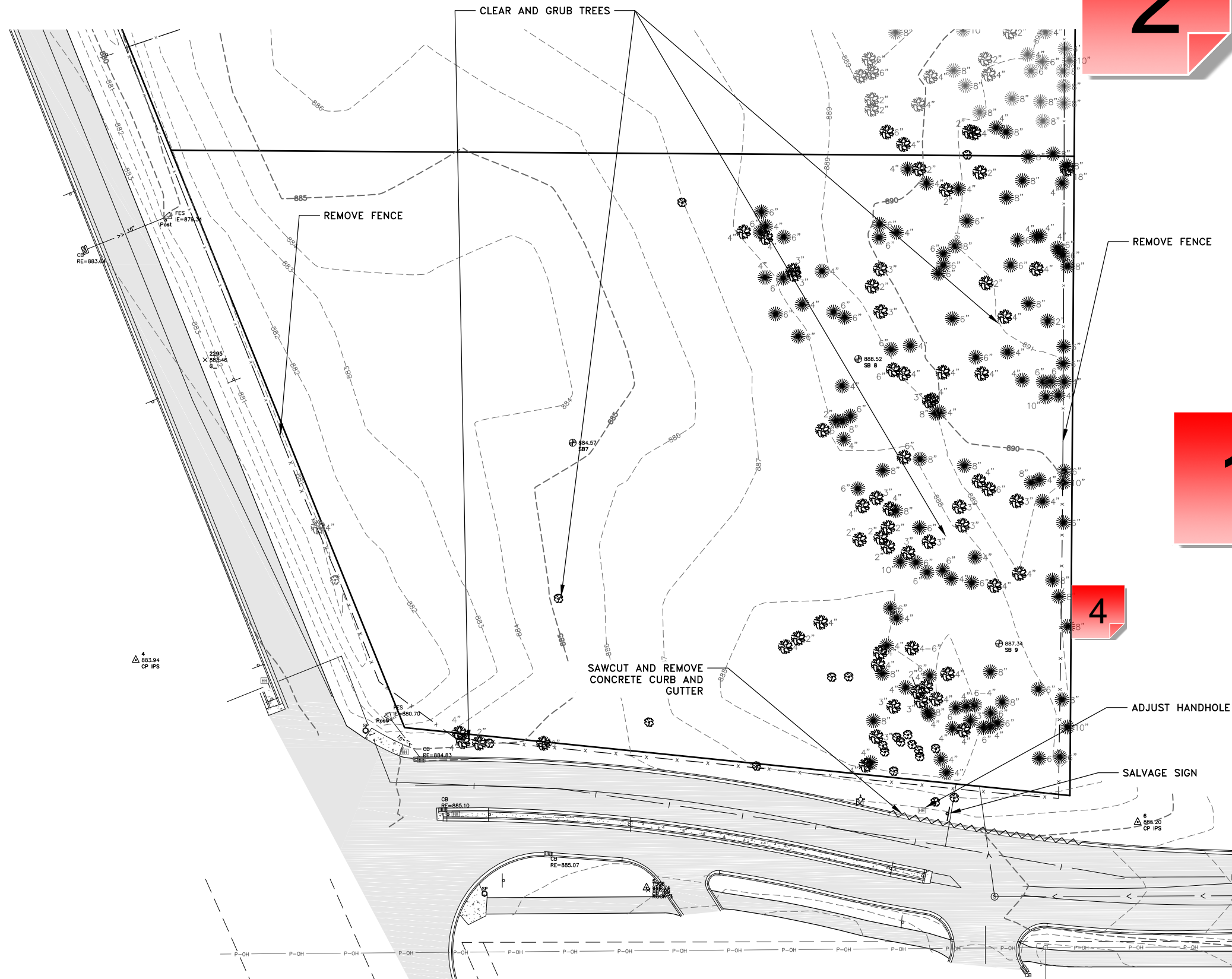

2

- GENERAL NOTES:
1. SILT FENCE SHALL BE IN PLACE PRIOR TO THE START OF ANY REMOVAL ACTIVITIES. SEE THE GRADING, DRAINAGE AND EROSION CONTROL PLAN FOR SILT FENCE LOCATIONS.
 2. CLEARING OF ANY OAK TREES SHALL NOT OCCUR PRIOR TO XXX XXTH. IF OAK TREE CLEARING IS NECESSARY PRIOR TO XXX XXTH, AN OAK WILT MANAGEMENT PLAN MUST BE PREPARED AND SUBMITTED TO THE CITY FOR REVIEW TO ENSURE ADEQUATE MEASURES ARE IMPLEMENTED TO PROTECT FROM THE INTRODUCTION OF OAK WILT.
 3. CLEAR AND GRUB BRUSH, SHRUBS AND SMALL TREES WITHIN THE CONSTRUCTION LIMITS (NOT SHOWN).

LEGEND

- PROPERTY LINE
- - - SECTION LINE
- - - EASEMENT LINE
- - - XXX EXISTING CONTOUR
- G BURIED GAS MAIN
- T-BUR BURIED TELEPHONE LINE
- U-OH OVERHEAD UTILITY LINE
- P-BUR BURIED ELECTRIC LINE
- > EXISTING SANITARY SEWER
- W EXISTING WATERMAIN/WATER SERVICE
- >> EXISTING STORM SEWER
- SF EXISTING SILT FENCE
- X — X — X EXISTING CONCRETE CURB AND GUTTER
- - - X - - - X - - - X REMOVE FENCE
- X — X — X SAWCUT AND REMOVE CONCRETE CURB AND GUTTER
- ⊙ EXISTING SANITARY MANHOLE
- ⊕ EXISTING CATCH BASIN
- △ EXISTING APRON
- ⊕ HYDRANT
- ⊕ EXISTING WATERMAIN VALVE
- SIGN
- ⊙ EXISTING DECIDUOUS TREET
- ⊙ EXISTING SHRUB
- ⊙ EXISTING CONIFEROUS TREE
- SB-X ⊕ SOIL BORING LOCATION
- ⊕ DETAIL NUMBER
- ⊕ SHEET NUMBER
- ⊕ REMOVE DECIDUOUS TREET
- ⊕ REMOVE SHRUB
- ⊕ REMOVE CONIFEROUS TREE

1

4

3

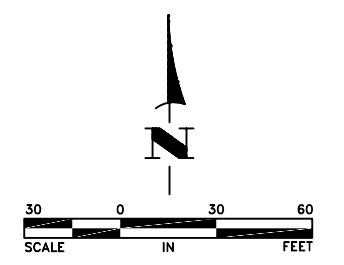

DATE	REVISION

I hereby certify that this plan, specification, or report was prepared by me or under my direct supervision and that I am a duly Licensed Professional Engineer under the laws of the State of Minnesota.

Shane Nelson
 SHANE M. NELSON, P.E., P.E.
 Date 7/20/21 Lic. No. 43381

DESIGNED BY: SMN
 DRAWN BY: SGJ
 CHECKED BY: TAE



Hakanson Anderson
 Civil Engineers and Land Surveyors
 3601 Thurston Ave., Anoka, Minnesota 55303
 763-427-5860 FAX 763-427-0520
 www.hakanson-anderson.com

G-WILLS LIQUORS STORE
 RAMSEY, MN

EXISTING CONDITIONS, TREE INVENTORY,
 AND REMOVALS PLAN
 RAMSEY, MINNESOTA

SHEET C6
 OF C12 SHEETS

1 - Inventory Data

Created by: Chris Anderson
On: 08/02/2021 04:04 PM

Need to include a table that identifies, at a minimum, species, DBH, status (preserve or remove), and if it is to be removed, a brief description of why (e.g. building pad, mass grading, stormwater pond, etc.).

Table should also include a total tabulation of all significant tree DBH inches, total DBH inches to be removed, and total DBH inches to be saved.

Note that any oak or evergreen tree with DBH of 4+ inches and all other trees with DBH of 8+ inches must be included on the Tree Inventory.

----- 0 Replies -----

2 - Clearing Within Oaks

Created by: Chris Anderson
On: 08/05/2021 03:23 PM

Any clearing activities involving oak trees shall not be conducted between April 15 and July 15 to avoid the typical high risk oak wilt season.

----- 0 Replies -----

3 - Tree Preservation Requirements

Created by: Chris Anderson
On: 08/05/2021 03:25 PM

If more than 70% of the significant tree DBH inches are removed, reforestation is required. For every 1 inch over the removal threshold, 1.25 inches shall be installed. This shall be shown in a separate Planting Schedule table on the Landscape Plan.

----- 0 Replies -----

4 - Tree Preservation

Created by: Chris Anderson
On: 08/09/2021 03:40 PM

Isn't there the ability to preserve some of the existing trees along the eastern boundary? They could count toward the bufferyard plantings and base landscape planting requirements.

Examine proposed grading to see if it could be adjusted somewhat to protect some of these existing trees.

----- 0 Replies -----