

MINNESOTA DEPARTMENT OF TRANSPORTATION
 CITY OF RAMSEY
 ANOKA COUNTY, MINNESOTA
 2022 RIVERDALE DRIVE TRUNK UTILITY IMPROVEMENTS
 CITY IMPROVEMENT PROJECT #22-05

MINN. PROJ. NO. _____ STATE FUNDS _____

--- GOVERNING SPECIFICATIONS ---
 THE 2020 EDITION OF THE MINNESOTA DEPARTMENT OF TRANSPORTATION
 "STANDARD SPECIFICATION FOR CONSTRUCTION" SHALL GOVERN.

ALL TRAFFIC CONTROL DEVICES AND SIGNING SHALL CONFORM AND BE INSTALLED IN ACCORDANCE
 WITH THE "MINNESOTA MANUAL ON UNIFORM TRAFFIC CONTROL DEVICES" (MN MUTCD) AND
 PART VI, "FIELD MANUAL" FOR TEMPORARY TRAFFIC CONTROL DEVICES.

RIVERDALE DR (S.A.P. 199-115-004)

GROSS LENGTH	4209 FEET	0.797 MILES
BRIDGE LENGTH	NA FEET	NA MILES
EXCEPTION LENGTH	NA FEET	NA MILES
NET LENGTH	4209 FEET	0.797 MILES

LENGTH AND DESCRIPTION BASED UPON
 PROPOSED RIVERDALE DR NW CENTERLINE

CONSTRUCTION PLAN FOR: _____ GRADING, LIFT STATION, SANITARY SEWER, WATERMAIN, STORM SEWER, LANDSCAPING AND RELATED APPURTENANCES

S.A.P. 199-115-004 LOCATED ON _____ RIVERDALE DR NW FROM _____ BOWERS DRIVE TO _____ 200' EAST OF LLAMA STREET

FUTURE DESIGN

DESIGNATION	RIVERDALE DR NW
STA. 0+75 TO STA. 42+84	
FUNTIONAL CLASSIFICATION	URBAN COLLECTOR
R-VALUE	TBD
ΣN-18	TBD
NO. & WIDTH OF TRAFFIC LANES	2 & 12 ft
NO. & WIDTH OF SHOULDER	2 & 8 ft
ADT (PRESENT YEAR) 2022	0
ADT (PROJECTED YEAR) 2041	TBD
HCADT (PROJECTED YEAR) 2041	3.87%
DESIGN SPEED	30 mph
DESIGN LOAD	10 ton
DESIGN SPEED FOR ROADWAY BASED ON ON STOPPING SIGHT DISTANCE:	
HEIGHT OF EYE = 3.5 FT	
HEIGHT OF OBJECT = 2.0 FT	

FUTURE DESIGN

DESIGNATION	OFF-ROAD TRAIL
STA 0+75 TO 42+84	
FUNTIONAL CLASSIFICATION	BIKE TRAIL
DESIGN SPEED	20 MPH
STOPPING SIGHT DISTANCE	
HEIGHT OF EYE = 4.5 FT	
HEIGHT OF OBJECT = 0 FT	

MAP LEGEND

- █ PROJECT LIMITS
- ★ EXCESS SUITABLE MATERIAL DISPOSAL SITE
- AGGREGATE STOCKPILE SITE: RAMSEY PUBLIC WORKS, 14199 JASPER STREET NW

NOTE: EXISTING UTILITY INFORMATION SHOWN ON THIS PLAN HAS BEEN PROVIDED BY THE UTILITY OWNER. THE CONTRACTOR SHALL FIELD VERIFY EXACT LOCATIONS PRIOR TO COMMENCING CONSTRUCTION AS REQUIRED BY STATE LAW. NOTIFY GOPHER STATE ONE CALL, 1-800-252-1166 OR 651-454-0002.

THE SUBSURFACE UTILITY INFORMATION IN THIS PLAN IS UTILITY QUALITY LEVEL D UNLESS OTHERWISE NOTED. THIS UTILITY LEVEL WAS DETERMINED ACCORDING TO THE GUIDELINES OF CI/ASCE 38-02, ENTITLED "STANDARD GUIDELINES FOR THE COLLECTION AND DEPICTION OF EXISTING SUBSURFACE UTILITY DATA."

BID LOCATION:
 ONLINE BID THROUGH QUEST CDN

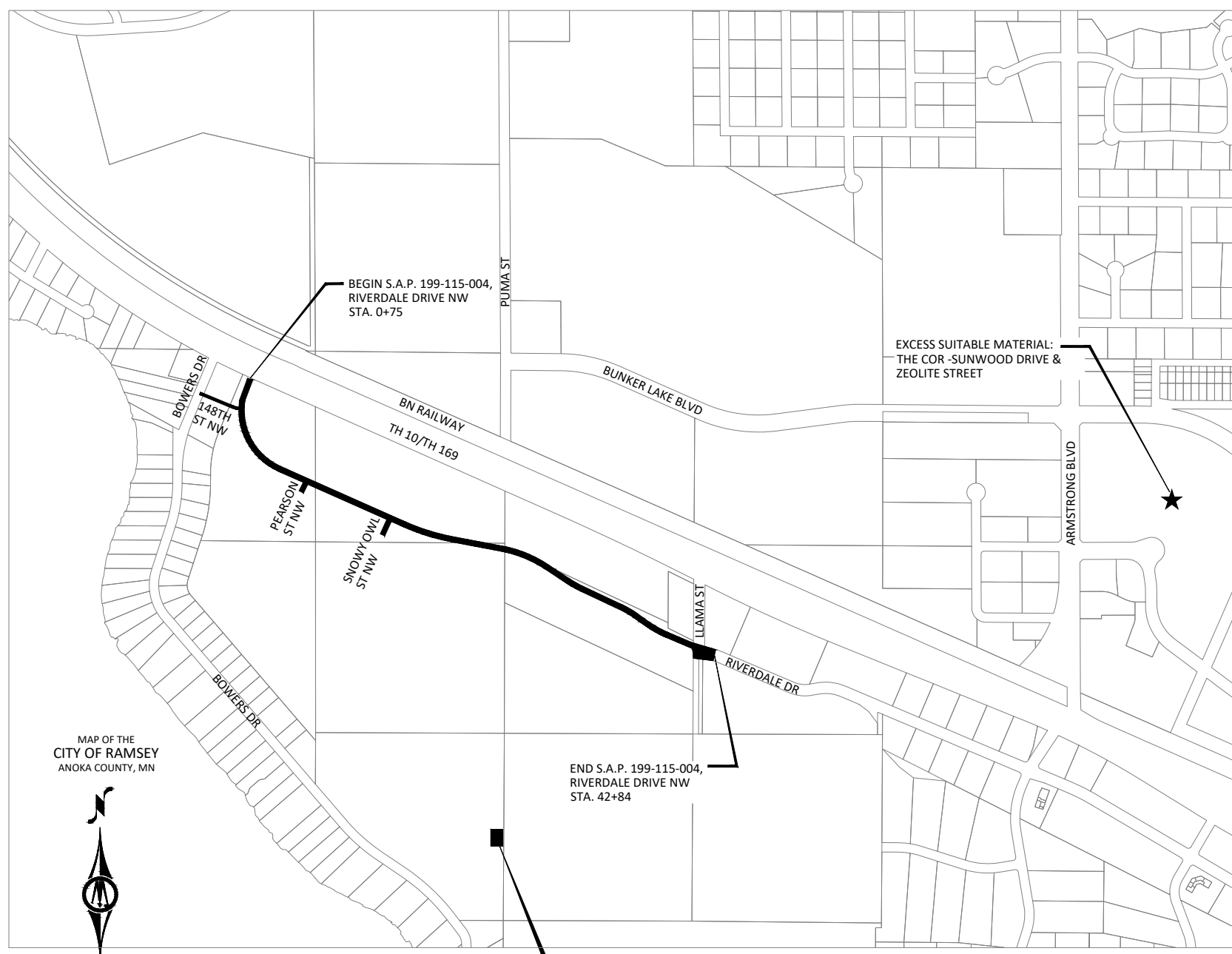

SHEET NUMBER	SHEET TITLE
GENERAL	
1	TITLE SHEET
2	STATEMENT OF ESTIMATED QUANTITIES
3	LOCATION PLAN
CIVIL	
4	TYPICAL SECTIONS
5 - 7	CONSTRUCTION DETAILS
8	ALIGNMENT TABULATION
9 - 12	EXISTING CONDITIONS, REMOVALS PLAN
13 - 15	STORM WATER POLLUTION PREVENTION PLAN
16 - 20	EROSION CONTROL & TURF ESTABLISHMENT PLAN
21 - 27	SANITARY SEWER & WATERMAIN PLAN & PROFILE
28 - 34	STORM SEWER PLAN & PROFILE
35 - 37	STORM SEWER LEAD PROFILES
38	POND GRADING PLAN
39 - 42	LIFT STATION
43 - 44	LIFT STATION ELECTRICAL PLANS
45 - 72	CROSS SECTIONS
THIS PLAN SET CONTAINS <u>72</u> SHEETS.	

Kevin P. Kielb

Kevin P. Kielb, P.E.
 Design Engineer: I hereby certify that this plan was prepared by me or under my direct supervision, and that I am a duly Licensed Professional Engineer under the laws of the State of Minnesota.

Date 02/07/2022 License Number 23211

Approved: City of RAMSEY Engineer _____ Date _____

District State Aid Engineer:
 Review for compliance with State Aid Rules/Policy _____ Date _____

Approved for State Aid Funding: State Aid Engineer _____ Date _____

BM=875.70 EX TNH @ SE CORNER LLAMA ST & RIVERDALE DR	PROJECT DATUM:	RECORD DRAWING INFORMATION OBSERVER: CONTRACTOR: DATE:
	HORIZONTAL: VERTICAL:	

CITY OF RAMSEY, MINNESOTA		SHEET 1 OF 72
2022 RIVERDALE DRIVE TRUNK UTILITY IMPROVEMENTS (S.A.P. 199-115-004)		
TITLE SHEET		

© Bolton & Menk, Inc. 2022. All Rights Reserved. File Name: 011255071-CA-0103125501001.dwg 2/8/2022 11:04:19 AM

BOLTON & MENK

7533 SUNWOOD DR NW, SUITE 206
 RAMSEY, MINNESOTA 55303
 Phone: (763) 433-2851
 Email: Ramsey@bolton-menk.com
 www.bolton-menk.com

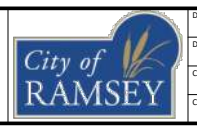

DESIGNED	NO.	ISSUED FOR	DATE
ZFL			
ZFL			
KPK			
CLIENT PROJ. NO. 22-05			