



Real People. Real Solutions.

The Ramsey Gateway Project Highway 10 – Ramsey Blvd/Sunfish Lake Blvd Council Work Session

November 7th, 2022



Anoka County
MINNESOTA



PROJECT LAYOUT | Plan Rendering



An aerial photograph showing a multi-lane highway with a bridge crossing over it. The bridge is a long, straight structure with a central section that appears to be a viaduct or a different type of bridge. The surrounding area is a mix of residential and commercial buildings, with some green spaces. The image is semi-transparent, allowing the text to be overlaid.

Aesthetic Considerations

BRIDGE OPPORTUNITIES – RAMSEY/SUNFISH



DECISIONS NEEDED | Final Bridge Aesthetics

- ❑ *Coordinate with Armstrong aesthetics*
- ❑ **Ramsey Blvd.**
 - *slightly elevated aesthetics: black railing, medallions and intermediary brick columns on bridge deck*
 - *colored concrete bands on bridge deck matching Armstrong*
 - *downlights integrated into concrete barrier*
- ❑ **Sunfish Lake**
 - *similar to Armstrong but with black railing and medallions*
 - *Colored concrete bands on bridge deck matching Armstrong*
 - *Downlights integrated into concrete barrier*
 - *Showing 'City of Ramsey' in low profile as community entrance*



SUNFISH LAKE BRIDGE | Aesthetics (car experience)

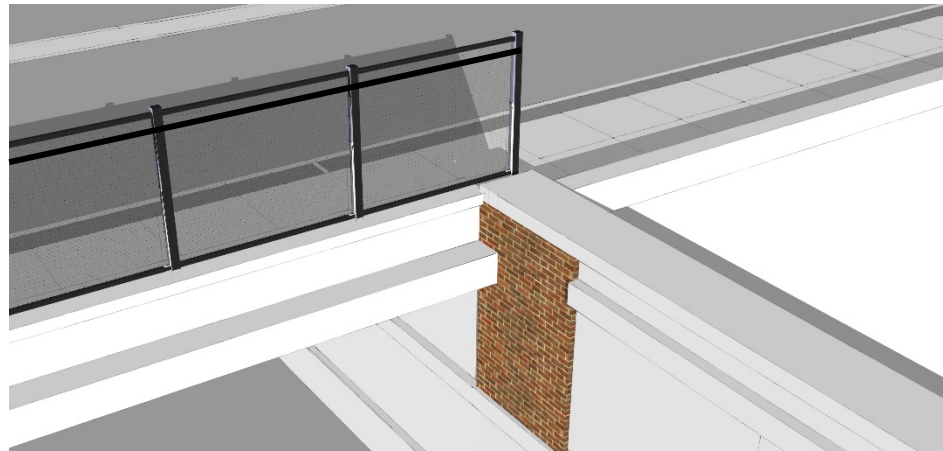
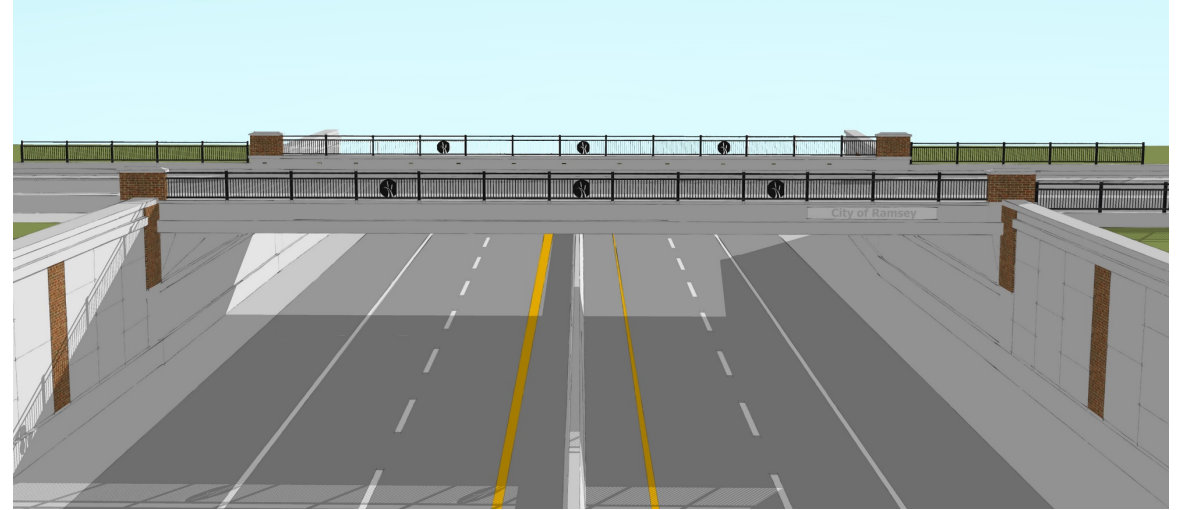
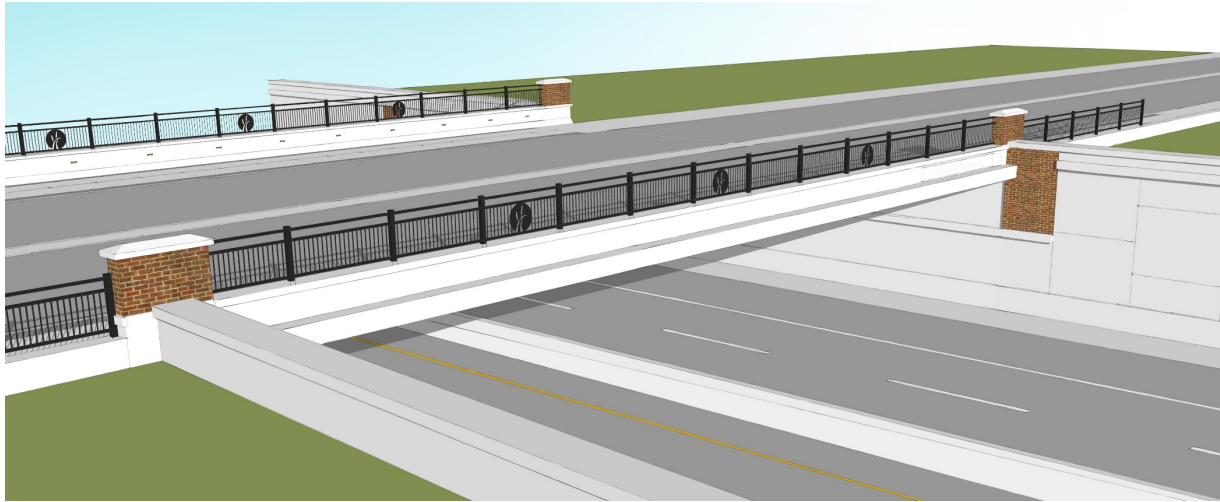

RAILROAD BRIDGE AESTHETIC

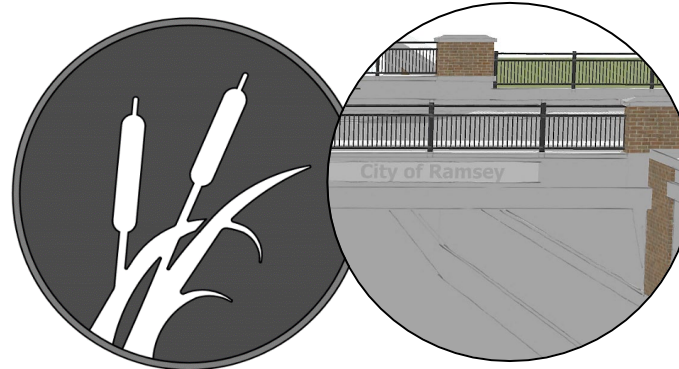

CUSTOM FENCE MEDALLION

Car Experience:

- Similar to Armstrong
- Black railing with medallions
- Brick accents
- Low profile 'City of Ramsey'



SUNFISH LAKE BRIDGE | Aesthetics (car experience)

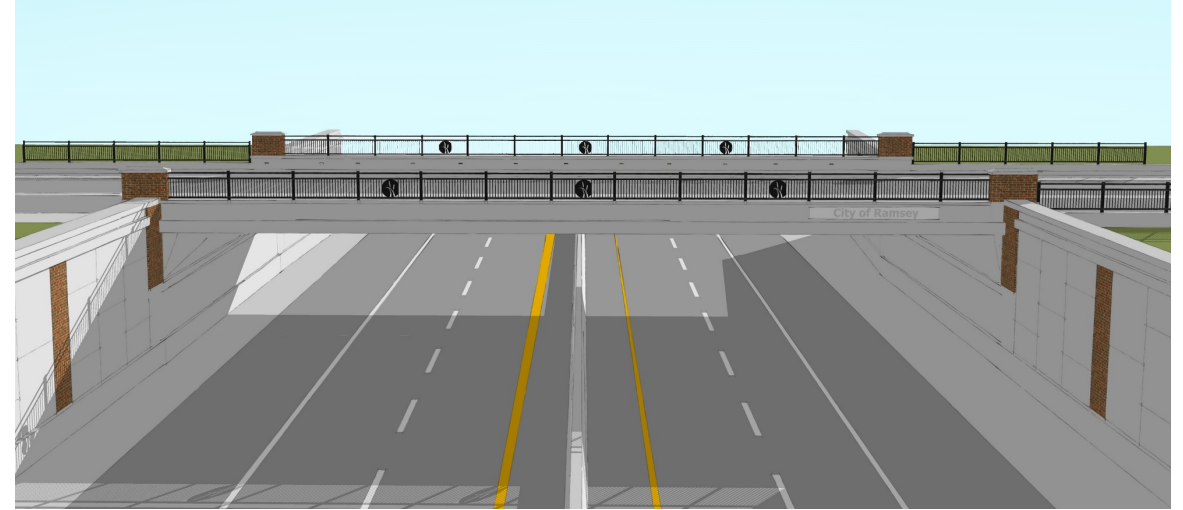
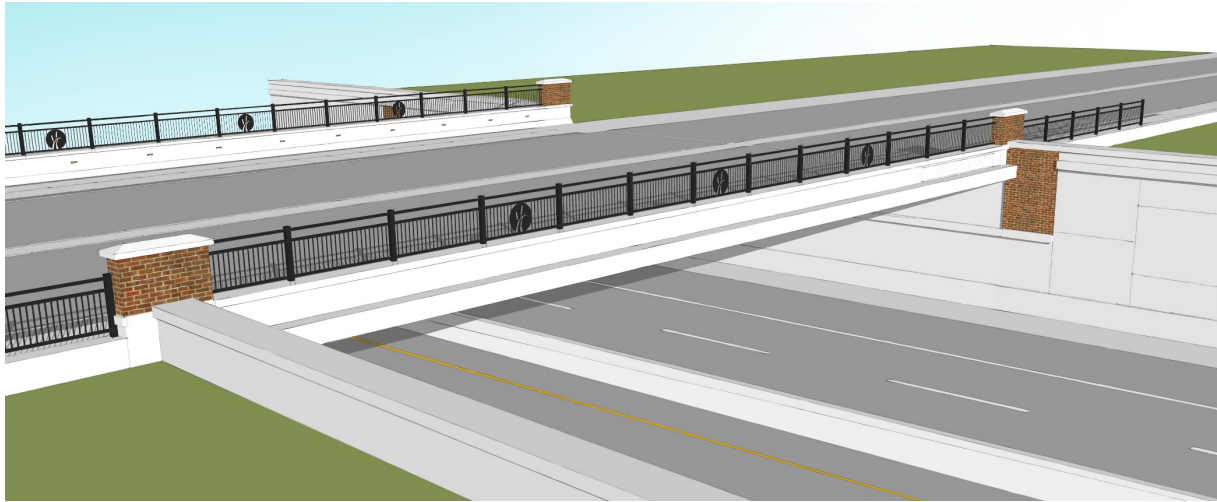

MnDOT's naming policy allows for a city to provide its name near border limits for wayfinding.

- *This can be a sign and may be part of a structure (with approval)*
- *We are showing 'City of Ramsey' on Sunfish Lake due to proximity to city limits – more likely to be approved by MnDOT over Ramsey*

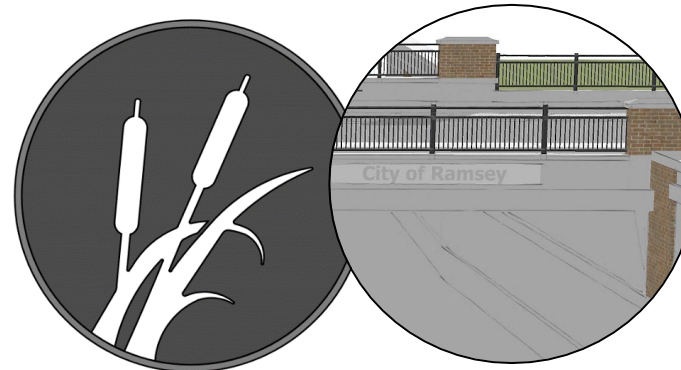

CUSTOM FENCE MEDALLION

Car Experience:

- Similar to Armstrong
- Black railing with medallions
- Brick accents
- Low profile 'City of Ramsey'



RAMSEY BLVD. BRIDGE | Aesthetics (car experience)

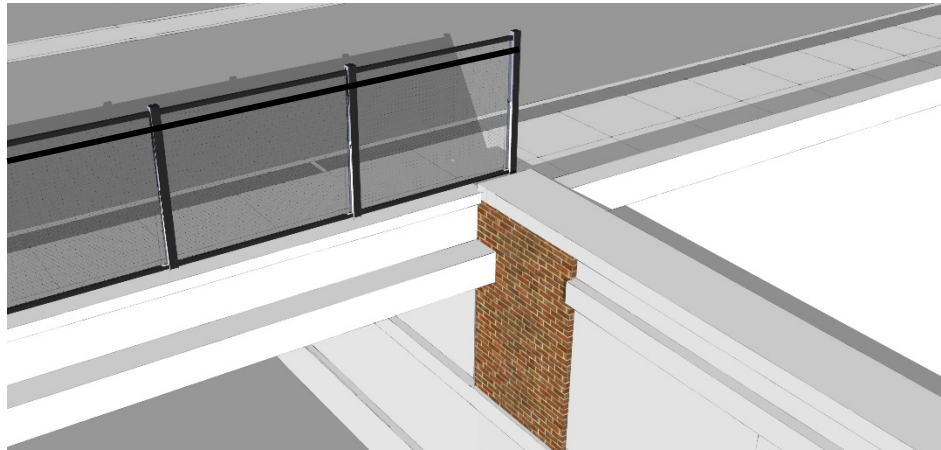
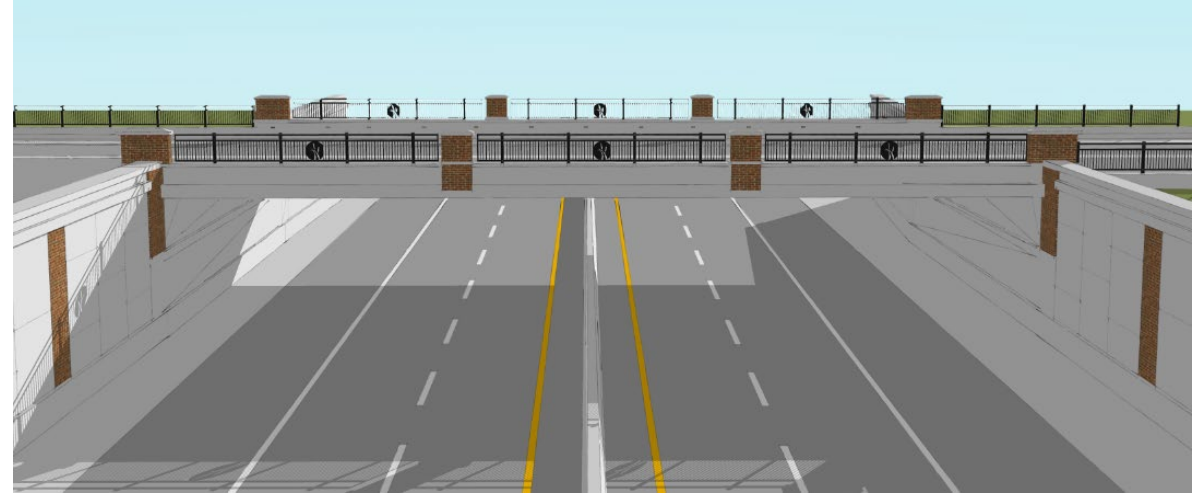

RAILROAD BRIDGE AESTHETIC



CUSTOM FENCE MEDALLION

Car Experience:

- Slightly elevated from Armstrong
- Black railing with medallions
- Interim brick columns on bridge
- Brick accents



PROPOSED RAMSEY BRIDGE | Aesthetics (Pedestrian Experience)



- Pedestrian Experience:
 - Black railing with medallions
 - Sidewalk Treatments
 - Lighting Accents



CUSTOM FENCE MEDALLION



An aerial photograph of a road corridor, likely in Ramsey/Sunfish, showing a multi-lane highway with proposed improvements. The image is semi-transparent, allowing the underlying aerial view of buildings and terrain to be seen. The proposed improvements include a central median, additional lanes, and two roundabouts on either side of the main corridor.

Aesthetic Considerations

CORRIDOR OPPORTUNITIES – RAMSEY/SUNFISH



DECISIONS NEEDED | Final Corridor Enhancements

- ❑ **Lighting:**
 - taller lights at roundabouts
 - city standard decorative lighting at other intersections
- ❑ **Noise walls:** simple, coordinate with bridge color
- ❑ **Benches:** south of Ramsey & Sunfish Lake corridors
- ❑ **Trees:** Outside of MnDOT ROW, around bench areas, where feasible
- ❑ **Roundabouts:** low maintenance, seasonal interest, screening



CORRIDOR OPPORTUNITIES | Aesthetics (lighting/noise walls)

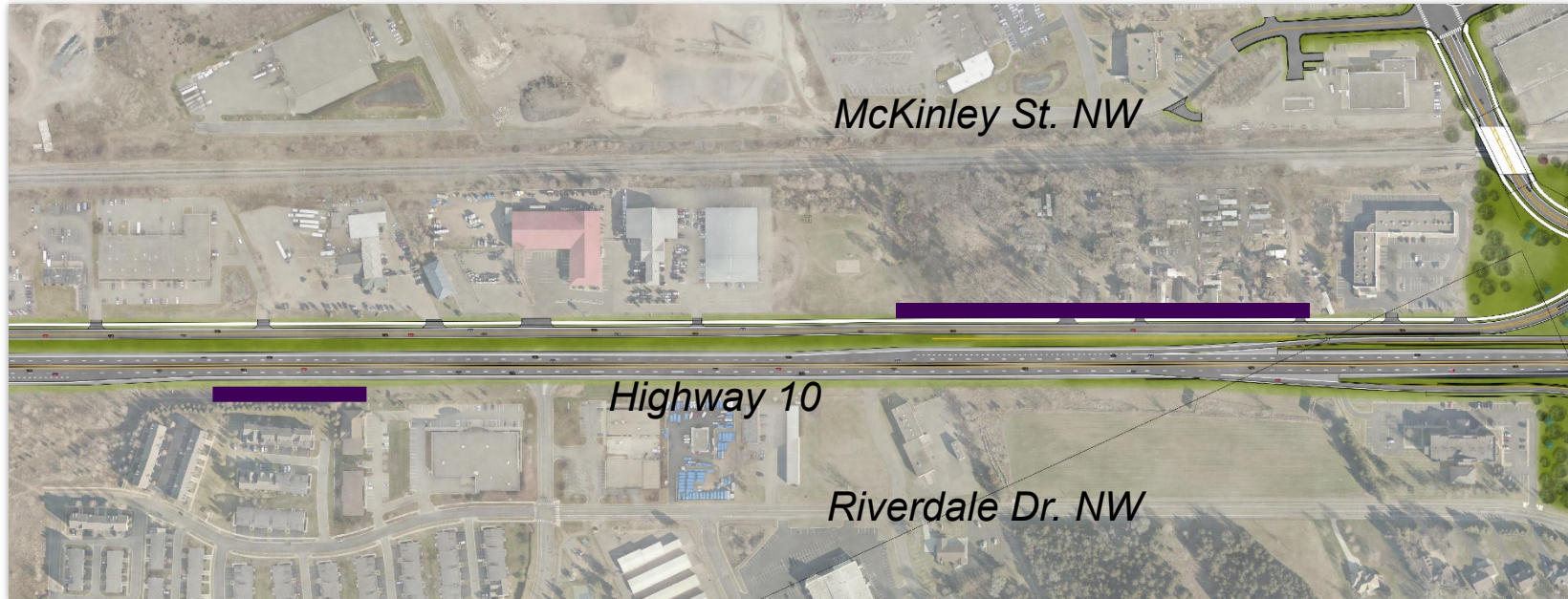

Lights at the roundabouts will match armstrong lights



Lights to be installed at the other intersections

- MnDOT does allow limited aesthetic upgrades
- Working to closely match the aesthetic at Armstrong

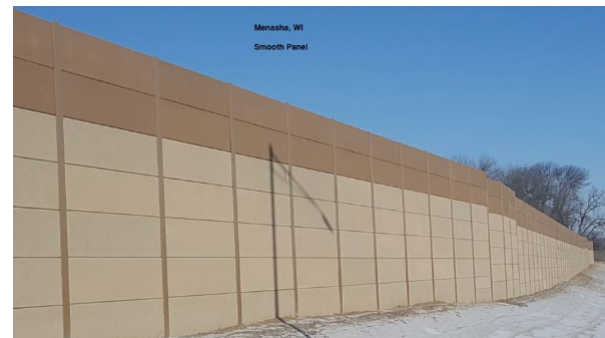

- Roundabout lights to match Armstrong lighting
- Intersection lights to match city standard



CORRIDOR OPPORTUNITIES | Aesthetics (benches/trees)



- Benches along corridor to provide rest areas
- Benches at 'trailhead' on south side of project
- Trees and tall grasses concentrated at bench nodes

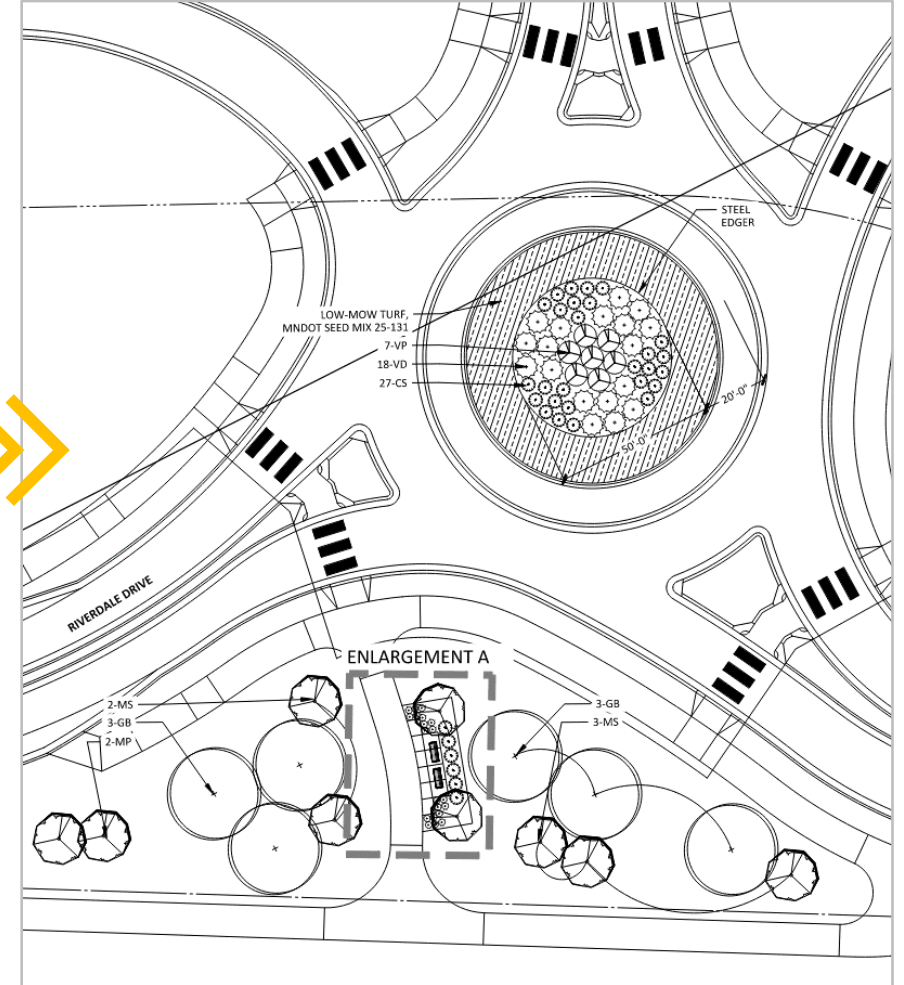

CORRIDOR OPPORTUNITIES | Aesthetics (benches/trees)



- Benches along corridor to provide rest areas
- Benches near hotel on south side of project
- Trees and tall grasses concentrated at bench nodes

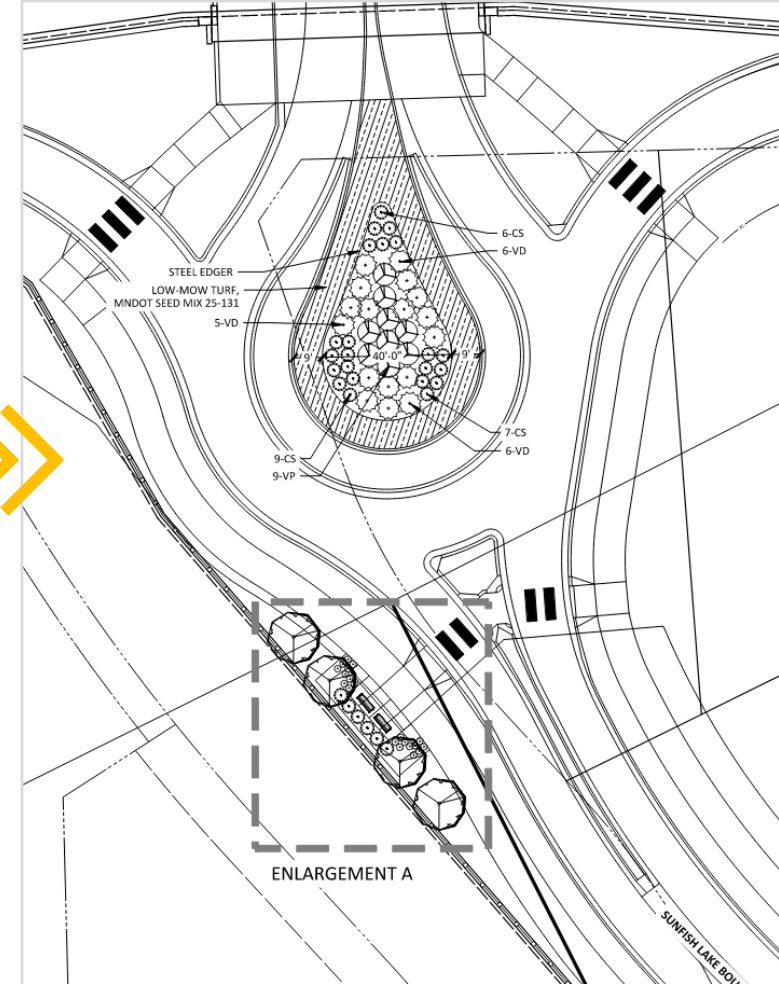
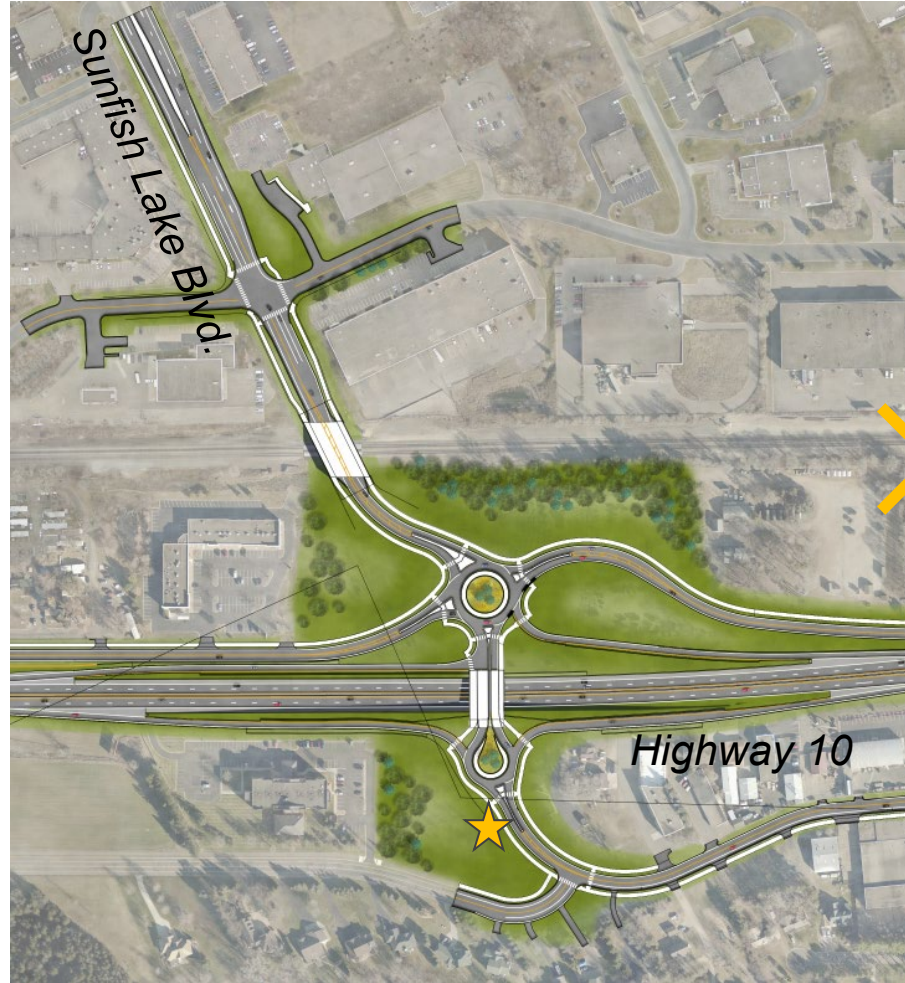

CORRIDOR OPPORTUNITIES | Aesthetics (roundabouts)

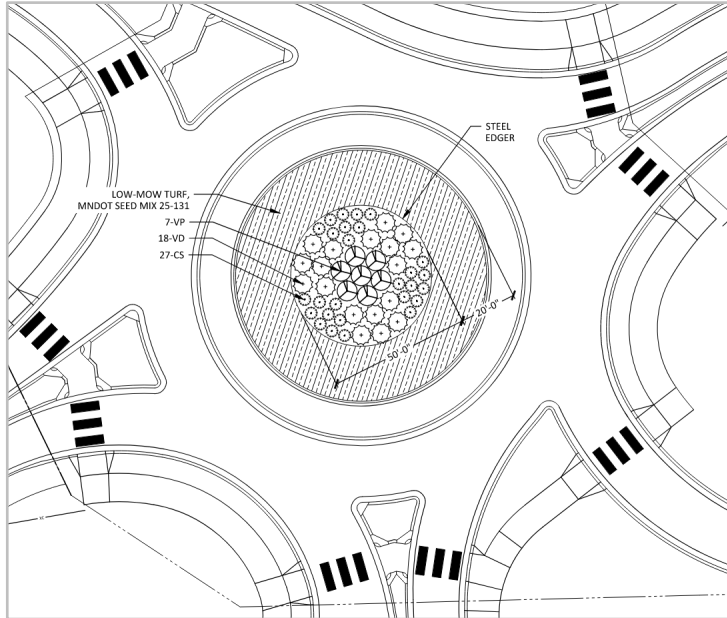

- Simple – Low Maintenance
- Screen oncoming traffic from across roundabout
- Seasonal interest

VIBURNUM



DOGWOOD



LOW-MOW TURF



PROPOSED FEATURES | Aesthetics Cost Participation (Overview)

- Cost participation for aesthetic elements are based on level of impact determined in part from a Visual Impact Assessment (VIA) and Visual Quality Manual (VQM), then confirmed by MnDOT Bridge Office.
- The chart below indicates three levels. (This project is anticipated at Level B).

Table 1: Maximum MnDOT Aesthetic Participation Factors and Limits as a Percentage of Estimated MnDOT Project Construction Costs

	Level of Impact		
	Level A	Level B	Level C
Specific Item Categories:			
*Bridges	15% not to exceed \$3,000,000 per bridge	7% not to exceed \$300,000 per bridge	5% not to exceed \$200,000 per bridge
Retaining Walls	10%	5%	1% or standard treatments
Noise Walls	7%	4%	1%



PROPOSED FEATURES | Aesthetics Cost Participation (Overview)

- **This project will likely use project dollars instead of local match**
 - Participating items would be covered by project dollars to a limit similar to MnDOT's Level B Cost Participation Policy.
 - **Costs above that limit would be the responsibility of the local agency**
 - Costs for aesthetic elements to structures currently fall within participating amounts **(Level B)**
 - Railings, columns, brick accents, medallions, accent lighting
 - Roundabout and other intersection lighting in per MnDOT and County policy (and not an aesthetic issue)



PROPOSED FEATURES | Aesthetics Cost Participation (Overview)

- Non-participating items will require a discussion between the City and County but are assumed to be local cost items
 - Trees around bench areas south of Ramsey Blvd. bridge & Sunfish Lake Blvd. bridge: **\$15,000**
 - Minor Landscaping around benches: **\$5,000**
 - Benches south of Ramsey Blvd. bridge & Sunfish Lake Blvd. bridge: **\$10,000**
 - Roundabout Landscaping for the project (shrubs/edger): **\$20,000**
- Maintenance responsibilities for aesthetics features will require discussions with Anoka County and MnDOT for a maintenance agreement.



FINAL STEPS |

<u>Action</u>	<u>Schedule 22'</u>
✓ Council Feedback	Apr
✓ Public comment on corridor options and concepts	Jun/Jul
✓ Selections and Final Direction [Council]	Sept
❑ Final plans & cost estimates	Nov





The Ramsey Gateway Project – Aesthetic Considerations

QUESTIONS?

