

CITY LANDSCAPE REQUIREMENTS

ROAD FRONTAGE REQUIREMENTS:
 FOR EVERY 35 FEET OF PUBLIC ROAD FRONTAGE, ONE OVERSTORY TREE SHALL BE PLANTED ADJACENT TO THE ROAD RIGHT-OF-WAY ON PRIVATE PROPERTY. THESE PLANTING ARE CREDITED TOWARD THE MINIMUM PLANTING REQUIREMENTS.

- 92' LF OF ROAD FRONTAGE / 35 LF = 26 TREES REQUIRED / 26 TREES PROPOSED

THE COR PARKING LOT REQUIREMENTS:

- PROVIDE LANDSCAPING TO SCREEN PARKING SPACES FROM STREET AND PROVIDING LANDSCAPED PARKING ISLANDS TO IMPROVE VIEWS FROM THE STREET.
- WHEREVER A SURFACE PARKING AREA FACES A STREET FRONTAGE, SUCH FRONTAGE SHALL BE SCREENED WITH A DECORATIVE WALL, RAILING, HEDGE, OR A COMBINATION OF THESE ELEMENTS, TO A MINIMUM HEIGHT OF (3) FEET AND A MAXIMUM OF A (4 1/2) FEET ABOVE THE LEVEL OF THE PARKING LOT, AT THE BUILDING-TO LINE REQUIRED FOR THE PROPERTY.

RESTORATION SCHEDULE

MULCH	QTY	DESCRIPTION
	5,765 SF	DOUBLE SHREDDED WOOD MULCH (NATURAL COLOR)
ROCK MULCH	QTY	DESCRIPTION
	3,025 SF	1.5" DIA RIVER ROCK MULCH AT 3" DEPTH
SEED MIX	QTY	DESCRIPTION
	7,715 SF	MNDOT SEED MIX 25-131 (TURF)
SOD	QTY	DESCRIPTION
	37,786 SF	LAWN SOD
EDGER	QTY	DESCRIPTION
	1,200 LF	PLASTIC LANDSCAPE EDGER (BLACK COLOR)

Issued:	Date:
A CITY SUBMITTAL #1	05/12/23
B CITY SUBMITTAL #2	06/06/23
C	
D	
E	

Revisions:	Date:
1	
2	
3	
4	
5	
6	
7	
8	
9	

I HEREBY CERTIFY THAT THIS PLAN, SPECIFICATION OR REPORT WAS PREPARED BY ME OR UNDER MY DIRECT SUPERVISION AND THAT I AM A DULY LICENSED PROFESSIONAL ENGINEER UNDER THE LAWS OF THE STATE OF MINNESOTA.

RYAN J. ANDERSON

Ryan Anderson

DATE 06/06/2023 LIC. NO. 55938

NOTE:
 THE CLARITY OF THESE PLANS DEPEND UPON COLOR COPIES. IF THIS TEXT DOES NOT APPEAR IN COLOR, THIS IS NOT AN ORIGINAL PLAN SET AND MAY RESULT IN MISINTERPRETATION.



MANAGING LOCATION:
 BLOOMINGTON OFFICE
 7900 INTERNATIONAL DRIVE
 SUITE 550
 MINNEAPOLIS, MN 55425
 PHONE: 952.426.0699

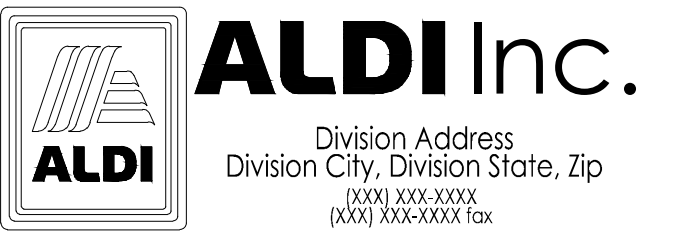

ALDI Inc. Store #: 143
 RAMSEY, MN
 7992 SUNWOOD DR NW
 RAMSEY, MN 55303
 ANOKA COUNTY
 Project Name & Location:

PLANTING AND RESTORATION PLAN

Drawing Name:	ISG Project No.
Type: V7.0 ER	23-21339
Drawn By: AE	C-510
Designed By: AE	Drawing No.
Reviewed By: MRW	

PLANT SCHEDULE

EVERGREEN TREES	CODE	QTY	BOTANICAL / COMMON NAME	SIZE	ROOT
	AB	2	ABIES BALSAMEA BALSAM FIR	6' HT MIN	B & B
OVERSTORY TREES	CODE	QTY	BOTANICAL / COMMON NAME	SIZE	ROOT
	AX	3	ACER X FREEMANII FREEMAN MAPLE	2.5' CAL	B & B
	BA	6	BETULA ALLEGANIENSIS YELLOW BIRCH	2.5' CAL	B & B
	CO	4	CELTIS OCCIDENTALIS COMMON HACKBERRY	2.5' CAL	B & B
	CC	6	CRATAEGUS CRUS-GALLI VAR. INERMIS THORNLESS COCKSPUR HAWTHORN	2.5' CAL	B & B
	GS	4	GLEDITSIA TRIACANTHOS INERMIS 'SKYLINE' SKYLINE HONEY LOCUST	2.5' CAL	B & B
	GD	3	GYMNOCLADUS DIOICA 'ESPRESSO' KENTUCKY COFFEETREE	2.5' CAL	B & B
DECIDUOUS SHRUBS	CODE	QTY	BOTANICAL / COMMON NAME	SIZE	ROOT
	AR	61	AMELANCHIER ALNIFOLIA 'REGENT' REGENT SERVICEBERRY	2' HT MIN	CONT

	AM	50	ARONIA MELANOCARPA BLACK CHOKEBERRY	2' HT MIN	CONT
	SC	28	SHEPHERDIA CANADENSIS RUSSETT BUFFALOBERRY	2' HT MIN	CONT
	VR	29	VIBURNUM RAFINESQUIANUM DOWNY ARROWWOOD	2' HT MIN	CONT
EVERGREEN SHRUBS	CODE	QTY	BOTANICAL / COMMON NAME	SIZE	ROOT
	JC2	5	JUNIPERUS CHINENSIS 'SEA GREEN' SEA GREEN JUNIPER	5 GAL	CONT
	TC2	4	TAXUS CANADENSIS CANADA YEW	5 GAL	CONT
GRASSES	CODE	QTY	BOTANICAL / COMMON NAME	SIZE	ROOT
	SL2	32	SCHIZACHYRIUM SCOPARIUM LITTLE BLUESTEM	2 GAL	CONT
	PP	16	SESLERIA AUTUMNALIS AUTUMN MOOR GRASS	2 GAL	CONT
PERENNIALS	CODE	QTY	BOTANICAL / COMMON NAME	SIZE	ROOT
	EP	18	ECHINACEA PURPUREA PURPLE CONEFLOWER	2 GAL	CONT
	HA	20	HEMEROCALLIS X 'APRICOT SPARKLES' APRICOT SPARKLES DAYLILY	2 GAL	CONT
	MD	30	MONARDA DIDYMA BEE BALM	2 GAL	CONT
	NW	28	NEPETA X FAASSENII 'WALKER'S LOW' WALKER'S LOW CATMINT	2 GAL	CONT

MARK HYDRANT = 873.47

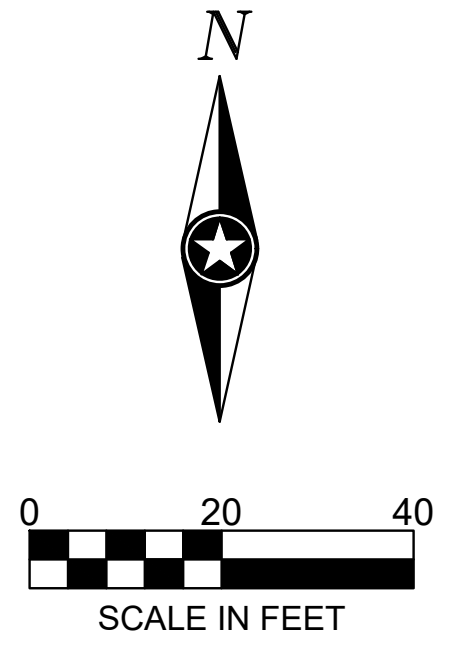

PRELIMINARY NOT FOR CONSTRUCTION

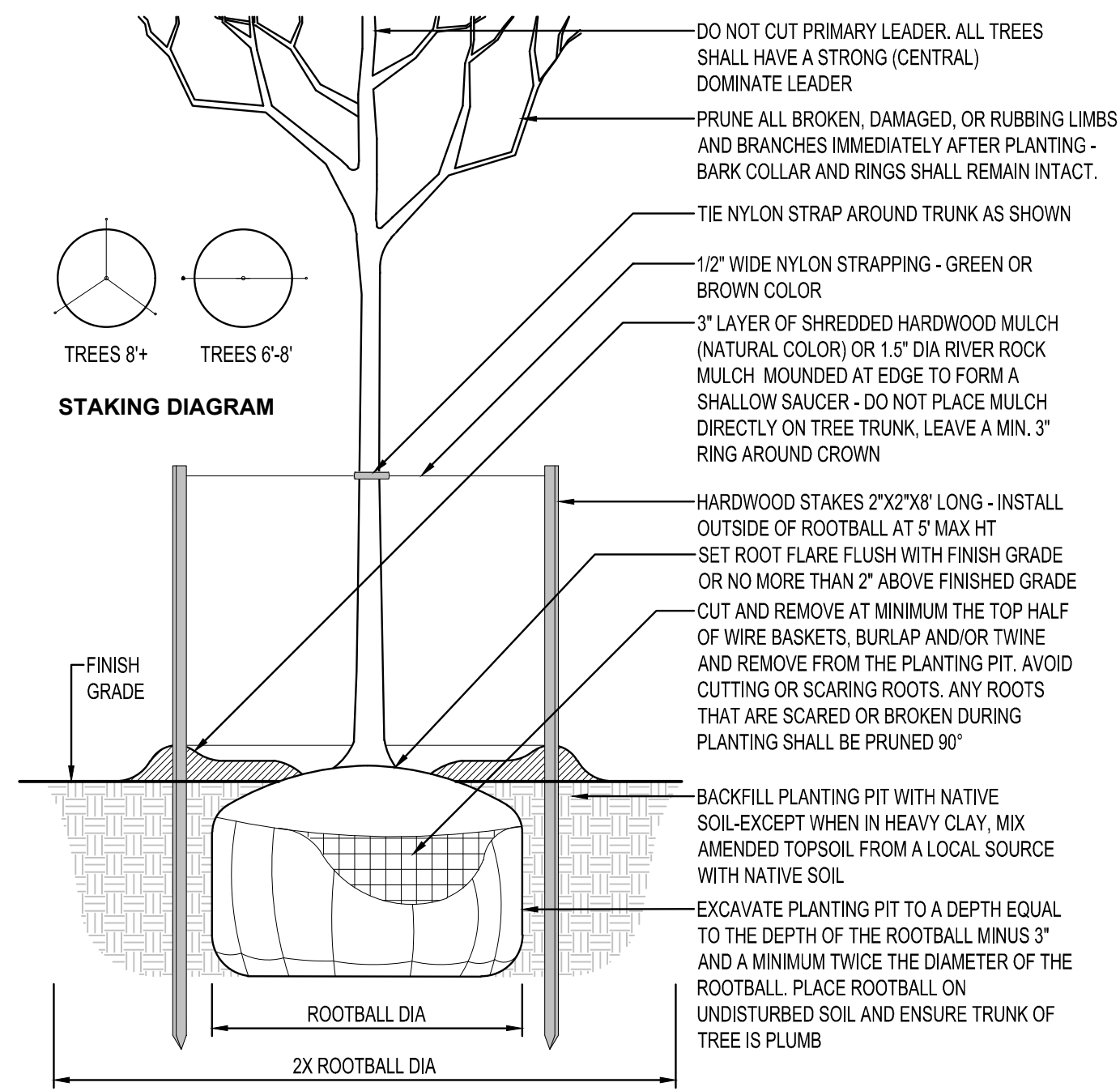

DECIDUOUS TREE PLANTING
NTS

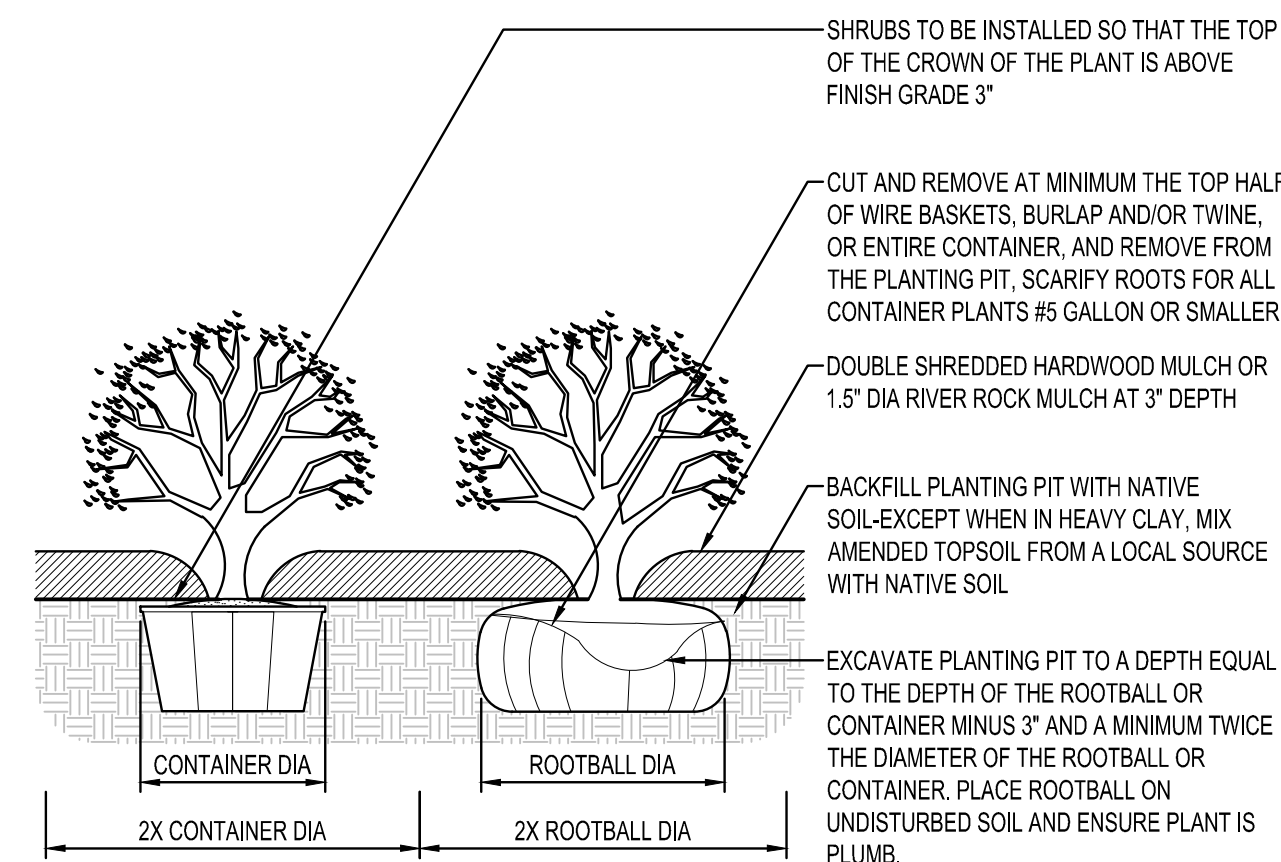

SHRUB PLANTING
NTS

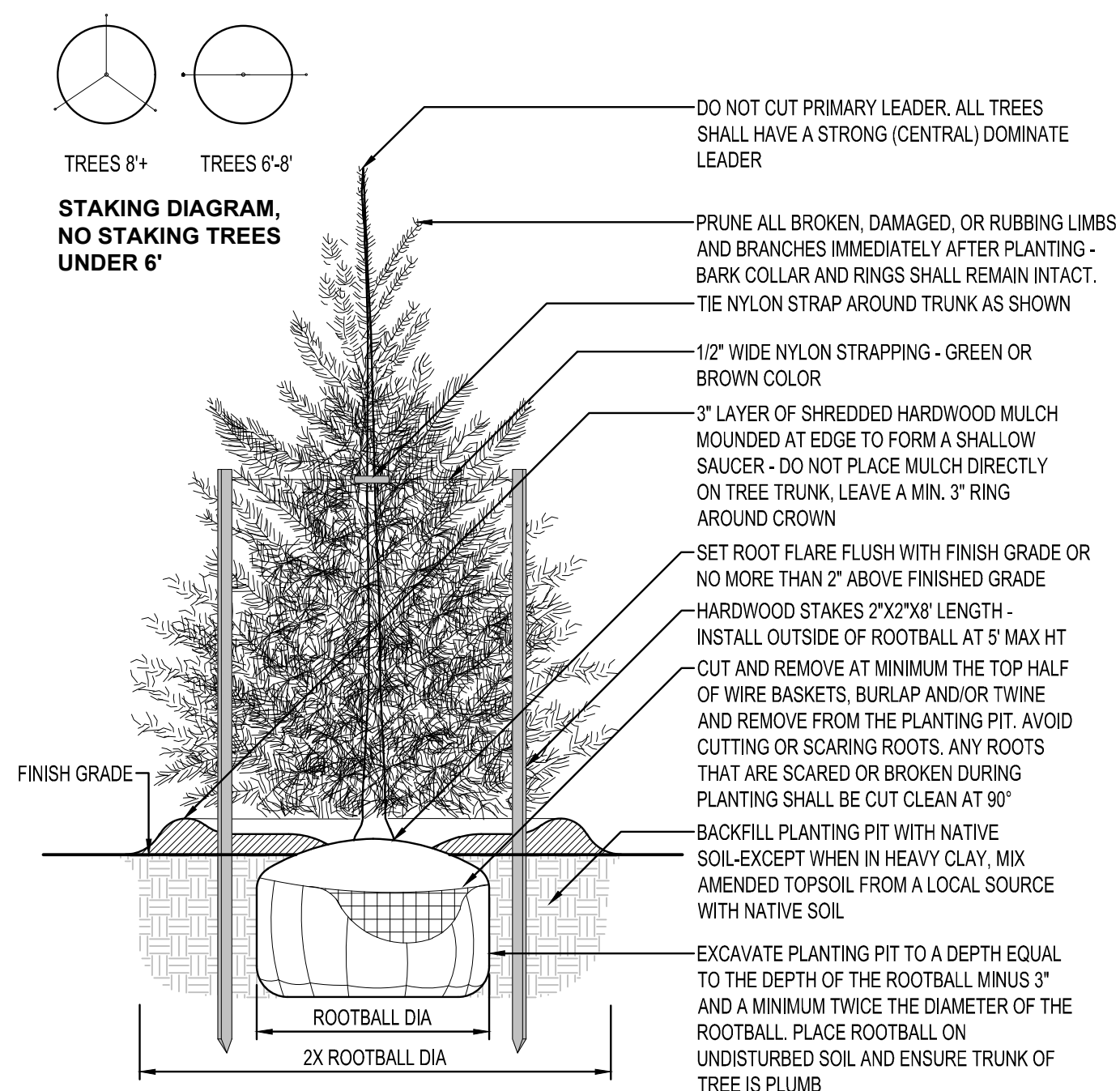

EVERGREEN TREE PLANTING
NTS

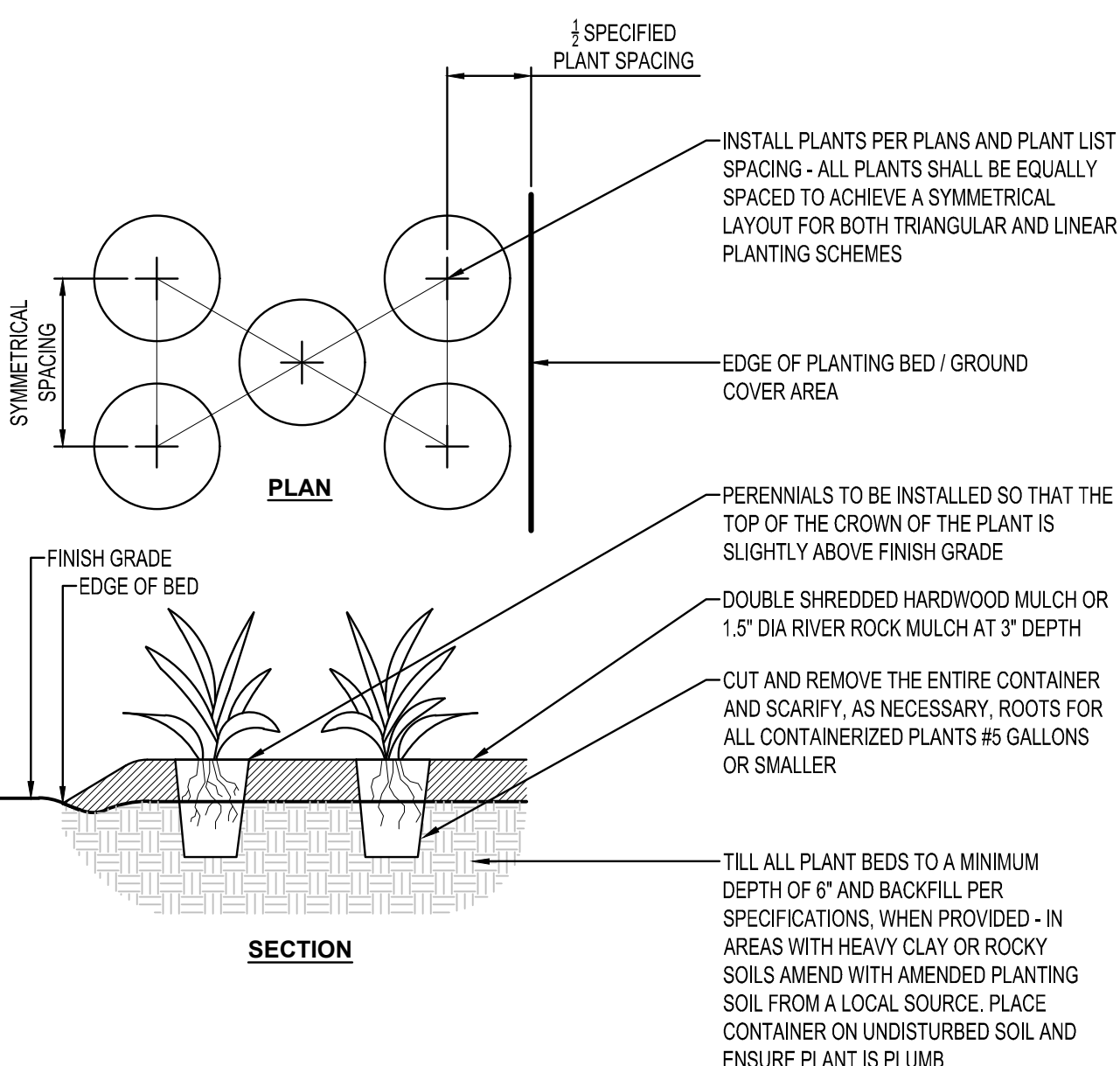

PERENNIAL PLANTING
NTS

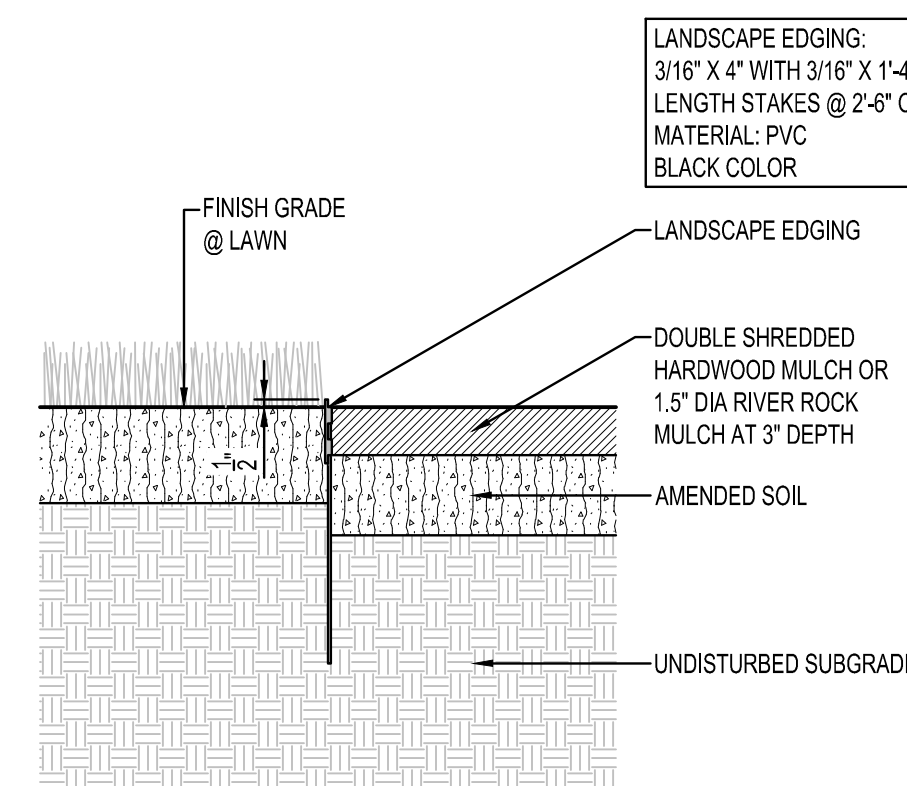

LANDSCAPE EDGING
NTS

PLANTING NOTES

- COORDINATE LOCATION OF ALL UTILITIES (LINES, DUCTS, CONDUITS, SLEEVES, FOOTINGS, ETC.) WITH LOCATIONS OF PROPOSED LANDSCAPE ELEMENTS (FENCE, FOOTINGS, TREE ROOTBALLS, ETC.). CONTRACTOR SHALL REPORT ANY DISCREPANCIES TO OWNER'S REPRESENTATIVE PRIOR TO CONTINUING WORK.
- SAVE AND PROTECT ALL EXISTING TREES NOT NOTED TO BE REMOVED.
- A TOPSOIL INSPECTION IS REQUIRED PRIOR TO INSTALLATION OF LANDSCAPING.
- A MINIMUM OF 4 INCHES OF TOPSOIL, WITH NO MORE THAN 35% SAND CONTENT IS REQUIRED OVER ALL DISTRIBUTED AREAS NOT OTHERWISE IMPROVED WITH IMPERVIOUS SURFACING.
- REMOVE ALL CONSTRUCTION DEBRIS AND MATERIALS INJURIOUS TO PLANT GROWTH FROM PLANTING PITS AND BEDS PRIOR TO BACKFILLING WITH PLANTING MIX.
- REFER TO PLANTING DETAILS FOR AMENDED SOIL DEPTH IN PLANTING BEDS AND SURROUNDING TREES.
- FIELD STAKE PLANTINGS ACCORDING TO PLAN. OWNER'S REPRESENTATIVE SHALL APPROVE ALL PLANT LOCATIONS PRIOR TO INSTALLATION. OWNER'S REPRESENTATIVE RESERVES THE RIGHT TO REVISE PLANTING LAYOUT AT TIME OF INSTALLATION.
- ALL PLANT MATERIALS SHALL BE TRUE TO THEIR SCIENTIFIC NAME AND SIZE AS INDICATED IN THE PLANT SCHEDULE.
- IF DISCREPANCIES EXIST BETWEEN THE NUMBER OF PLANTS DRAWN ON THE PLANTING PLAN AND THE NUMBER OF PLANTS IN THE SCHEDULE, THE PLANTING PLAN SHALL GOVERN.
- ANY PROPOSED SUBSTITUTIONS OF PLANT SPECIES SHALL BE MADE WITH PLANTS OF EQUIVALENT OVERALL FORM, HEIGHT, BRANCHING HABIT, FLOWER, LEAF, COLOR, FRUIT AND CULTURE, AND ONLY AFTER WRITTEN APPROVAL OF THE OWNER'S REPRESENTATIVE.
- ALL PLANT MATERIALS MUST CONFORM TO AMERICAN STANDARDS FOR NURSERY STOCK (ANSI Z60.1), LATEST EDITION PUBLISHED BY THE AMERICAN ASSOCIATION OF NURSERMEN, WASHINGTON D.C. LARGER SIZED PLANT MATERIALS OF THE SPECIES LISTED MAY BE USED IF THE STOCK CONFORMS TO ANSI Z60.1.
- ALL PLANT MATERIAL SHALL BE GUARANTEED BY THE CONTRACTOR TO BE IN A LIVE AND HEALTHY GROWING CONDITION FOR TWO FULL GROWING SEASON (TWO YEARS) AFTER FINAL PROJECT ACCEPTANCE OR SHALL BE REPLACED BY THE CONTRACTOR FREE OF CHARGE WITH THE SAME GRADE AND SPECIES.
- ALL TREES SHALL HAVE A STRONG CENTRAL LEADER. ANY TREES DEEMED NOT TO HAVE A STRONG CENTRAL LEADER SHALL BE REJECTED.
- CONTRACTOR IS RESPONSIBLE FOR ALL DAMAGE DUE TO CONSTRUCTION OPERATIONS. ANY AREAS THAT ARE DISTURBED SHALL BE RESTORED TO ITS ORIGINAL CONDITION AT NO ADDITIONAL COST TO THE OWNER.
- PROVIDE DOUBLE SHREDDED HARDWOOD MULCH (NATURAL COLOR) SURROUNDING ALL PROPOSED TREES (5' Ø) AND WITHIN PLANTING BEDS TO A 3" MINIMUM DEPTH AS SHOWN IN TREE PLANTING DETAIL. DO NOT USE AN UNDERLAYMENT SUCH AS PLASTIC SHEET OR LANDSCAPE FABRIC. APPLY PRE-EMERGENT TO ALL PLANTING BEDS PRIOR TO MULCHING. REFER TO PLANS FOR ADDITIONAL DETAILS. REFER TO STORMWATER DETAILS FOR BASIN CONSTRUCTION AND MULCH APPLICATION.
- MULCHING MATERIAL SHALL BE DOUBLE SHREDDED HARDWOOD MULCH, AND 1.5" DIA RIVER ROCK MULCH AT 3" DEPTH WITH NO INDIVIDUAL PIECES LARGER THAN 3". FREE OF GROWTH OR GERMINATION INHIBITING INGREDIENTS. 3" MINIMUM DEPTH. MINIMUM DEPTHS AT LOCATIONS INDICATED ON DRAWINGS.
- CONTRACTOR SHALL PROVIDE SAMPLE OF MULCH TO BE APPROVED BY THE LANDSCAPE ARCHITECT.
- INDICATED QUANTITIES ARE ESTIMATES AND SHALL BE CONFIRMED BY THE CONTRACTOR.
- ADJUST SPACING OF PLANT MATERIALS AROUND ADJACENT UTILITY STRUCTURES.
- PLANTINGS ARE TO BE WATERED REGULARLY UNTIL PLANTING/SOD/SEED HAS BEEN ESTABLISHED.
- ANY DEVIATIONS FROM THE APPROVED LANDSCAPE PLAN WILL REQUIRE PRIOR APPROVAL FROM THE CITY.

Issued:	Date:
A CITY SUBMITTAL #1	05/12/23
B CITY SUBMITTAL #2	06/06/23
C	
D	
E	
Revisions:	Date:
1	
2	
3	
4	
5	
6	
7	
8	
9	

I HEREBY CERTIFY THAT THIS PLAN, SPECIFICATION OR REPORT WAS PREPARED BY ME OR UNDER MY DIRECT SUPERVISION AND THAT I AM A DULY LICENSED PROFESSIONAL ENGINEER UNDER THE LAWS OF THE STATE OF MINNESOTA.

RYAN J. ANDERSON

Ryan Anderson

DATE 06/06/2023 LIC. NO. 55938

NOTE: THE CLARITY OF THESE PAGES DEPEND UPON COLOR COPIES. IF THIS TEXT DOES NOT APPEAR IN COLOR, THIS IS NOT AN ORIGINAL PLAN SET AND MAY RESULT IN MISINTERPRETATION.



MANAGING LOCATION:
BLOOMINGTON OFFICE
7900 INTERNATIONAL DRIVE
SUITE 550
MINNEAPOLIS, MN 55425
PHONE: 952.426.0699

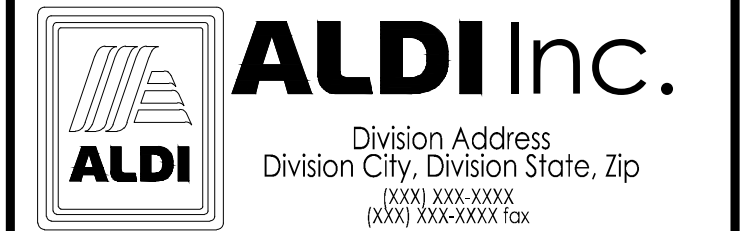

ALDI Inc. Store #: 143
RAMSEY, MN
7992 SUNWOOD DR NW
RAMSEY, MN 55303
ANOKA COUNTY
Project Name & Location:

PLANTING NOTES AND DETAILS

Drawing Name:	ISG Project No.
Type: V7.0 ER	23-21339
Drawn By: AE	
Designed By: AE	C-520
Reviewed By: MRW	Drawing No.

PRELIMINARY NOT FOR CONSTRUCTION