

CITY LANDSCAPE REQUIREMENTS

E-3 EMPLOYMENT DISTRICT LANDSCAPE REQUIREMENTS:

MINIMUM TREE CROWN COVER REQUIREMENTS:
 IMPERVIOUS AREA: 258,688 SF
 PERVIOUS AREA: 302,667 SF
 RATIO OF IMPERVIOUS AREA: 46.08% / 0.4608
 TOTAL AREA: 561,355 SF

MULTIPLY THE IMPERVIOUS AREA/SITE AREA RATIO BY THE SQUARE FOOTAGE OF PERVIOUS AREA: 0.4608 X 302,667 = 139,468 REQUIRED / 139,468 PROPOSED
 NOTE: SEE SHEET C5-20 FOR DETAILS

THE FOLLOWING FORMULA SHALL BE UTILIZED TO DETERMINE THE AVERAGE CANOPY COVER FOR ACCEPTABLE SPECIES:
 $[(\text{MINIMUM} + \text{MAXIMUM SPREAD}) \times 4] \times \pi \times (0.65 \text{ FOR PREFERRED SPECIES}) = 114,806$

ROAD FRONTAGE REQUIREMENTS:
 FOR EVERY 35 FEET OF PUBLIC ROAD FRONTAGE, ONE OVERSTORY TREE SHALL BE PLANTED ADJACENT TO THE ROAD RIGHT-OF-WAY ON PRIVATE PROPERTY. THESE PLANTING ARE CREDITED TOWARD THE MINIMUM PLANTING REQUIREMENTS.
 • 522 LF OF ROAD FRONTAGE / 35 LF = 15 TREES REQUIRED / 15 TREES PROPOSED

PARKING LOT REQUIREMENTS:
 1 TREE PER EVERY TEN PARKING SPACES.
 • 153 PARKING SPACES / 10 = 15 TREES REQUIRED / 15 TREES PROVIDED

EVERY OVERSTORY TREE PLANTED SHALL BE PROVIDED WITH A PLANTING AREA PF AT LEAST 162 SF.

BUFFERYARD REQUIREMENTS:
 E-3 BUFFERYARD WIDTH: 35 FEET
 % INCREASE IN PLANTINGS: 20%

ACCEPTABLE GROUND COVER MATERIAL INCLUDES SOD, MULCH AND OTHER NATURAL GROUND COVER. USE OF LANDSCAPE ROCK AND PLASTIC UNDERLAYMENT IS PROHIBITED.

ALL AREAS DISTURBED DURING CONSTRUCTION AND NOT OTHERWISE IMPROVED WITH IMPERVIOUS SURFACING SHALL RECEIVE A MINIMUM OF 4" OF TOPSOIL WITH NO MORE THAN 35% SAND CONTENT. TOPSOIL INSPECTION IS REQUIRED PRIOR TO INSTALLATION OF SOD/GROUND COVER.

PLANT SCHEDULE

EVERGREEN TREES	QTY	BOTANICAL / COMMON NAME	SIZE	ROOT
LL	3	LARIX LARICINA TAMARACK	6' HT MIN	B & B
PB	2	PICEA GLAUCA DENSATA BLACK HILLS SPRUCE	6' HT MIN	B & B
PS	14	PINUS STROBUS WHITE PINE	6' HT MIN	B & B
OVERSTORY TREES	QTY	BOTANICAL / COMMON NAME	SIZE	ROOT
BA	6	BETULA ALLEGHANIENSIS YELLOW BIRCH	2.5' CAL	B & B
CO	14	CELTIS OCCIDENTALIS COMMON HACKBERRY	2.5' CAL	B & B
JC	9	JUGLANS CINEREA BUTTERNUT	2.5' CAL	B & B
QA	10	QUERCUS ALBA WHITE OAK	2.5' CAL	CONT
QM	3	QUERCUS MACROCARPA BURR OAK	2.5' CAL	B & B
SD	5	SORBUS DECORA SHOWY MOUNTAIN ASH	2.5' CAL	B & B
DECIDUOUS SHRUBS	QTY	BOTANICAL / COMMON NAME	SIZE	ROOT
AR	25	AMELANCHIER ALNIFOLIA 'REGENT' REGENT SERVICEBERRY	2' HT MIN	CONT
AS	16	AMELANCHIER SANGUINEA ROUNDLEAF SERVICEBERRY	2' HT MIN	CONT
AF	109	AMORPHA FRUTICOSA FALSE INDIGO	2' HT MIN	CONT
AM	7	ARONIA MELANOCARPA BLACK CHOKEBERRY	2' HT MIN	CONT
SA	7	SHEPHERDIA ARGENTEA SILVER BUFFALO BERRY	2' HT MIN	CONT
SC	12	SHEPHERDIA CANADENSIS RUSSETT BUFFALO BERRY	2' HT MIN	CONT
VR	11	VIBURNUM RAPINESOLIANUM DOWNY ARROWWOOD	2' HT MIN	CONT
VA	13	VIBURNUM TRILOBUM AMERICAN CRANBERRYBUSH	2' HT MIN	CONT

MULCH	QTY	BOTANICAL / COMMON NAME
	9,595 SF	DOUBLE SHREDDED WOOD MULCH (NATURAL COLOR)
SEED MIX	QTY	DESCRIPTION
	25,498 SF	EAST INFILTRATION BASIN SEED MIX
	21,393 SF	WEST INFILTRATION BASIN SEED MIX
SOD	QTY	DESCRIPTION
	185,113 SF	MNDOT SOD 25-131 (TURF)
EDGER	QTY	DESCRIPTION
	40 LF	POLYVINYL EDGER (BLACK COLOR)

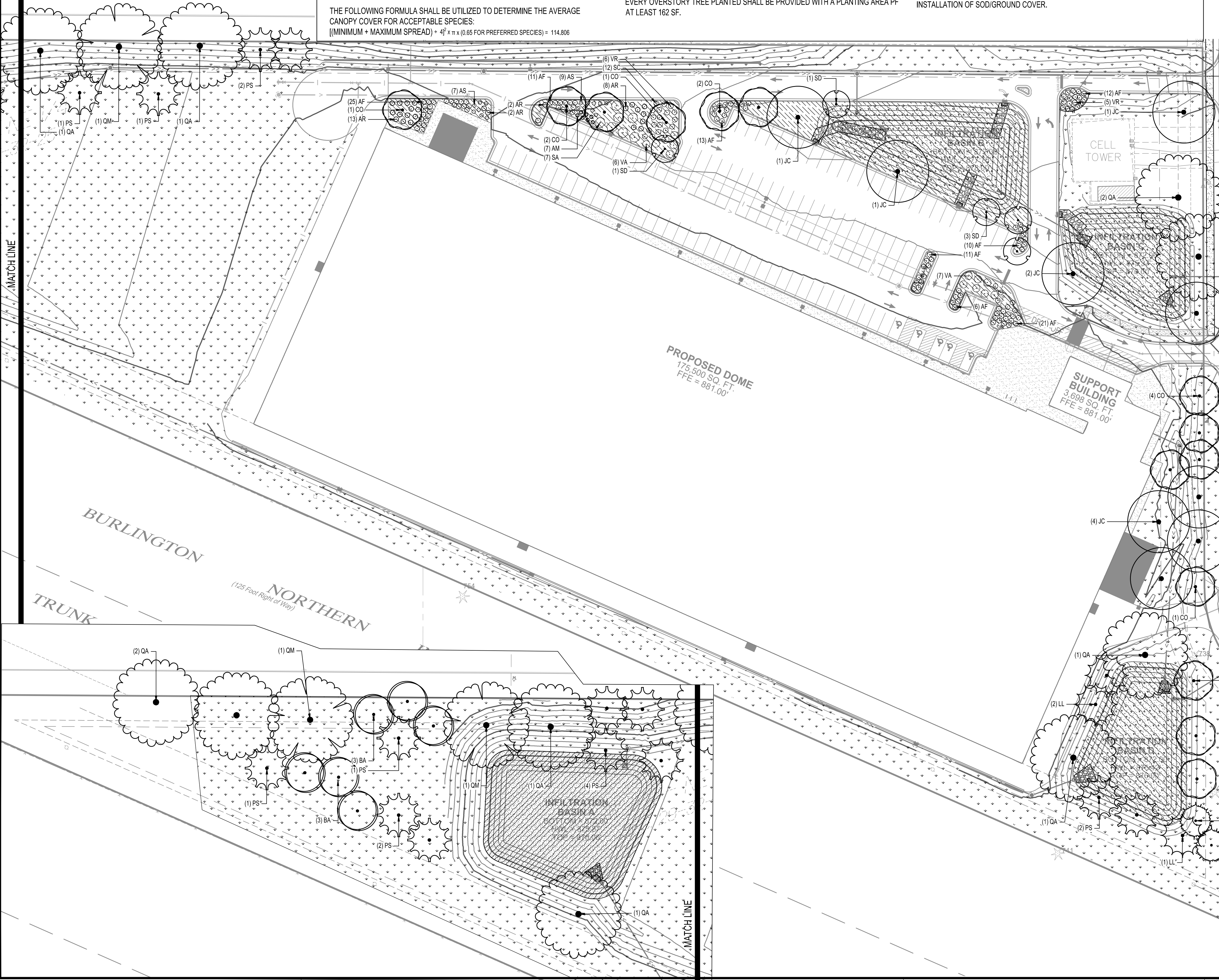

NOTE:
 THE CLARITY OF THESE PLANS DEPEND UPON COLOR COPIES. IF THIS TEXT DOES NOT APPEAR IN COLOR, THIS IS NOT AN ORIGINAL PLAN SET AND MAY RESULT IN MISINTERPRETATION.

I HEREBY CERTIFY THAT THIS PLAN, SPECIFICATION OR REPORT WAS PREPARED BY ME OR UNDER MY DIRECT SUPERVISION AND THAT I AM A DULY LICENSED PROFESSIONAL ENGINEER UNDER THE LAWS OF THE STATE OF MINNESOTA.
 REESE A. SUDTELGTE

DATE: 12/15/2022 LIC. NO. 54243

I HEREBY CERTIFY THAT THIS PLAN, SPECIFICATION OR REPORT WAS PREPARED BY ME OR UNDER MY DIRECT SUPERVISION AND THAT I AM A DULY LICENSED ARCHITECT UNDER THE LAWS OF THE STATE OF MINNESOTA.
 MITCHELL R. WORKMON

DATE: 12/15/2022 LIC. NO. 53748

THIS DOCUMENT IS THE PROPERTY OF I & S GROUP, INC. AND MAY NOT BE USED, COPIED OR DUPLICATED WITHOUT PRIOR WRITTEN CONSENT.

PROJECT
ANOKA RAMSEY ATHLETIC ASSOCIATION NEW DOME

RAMSEY MINNESOTA

REVISION SCHEDULE		
DATE	DESCRIPTION	BY

PROJECT NO.	22-26051
FILE NAME	26051 CS-LAND
DRAWN BY	AJR
DESIGNED BY	AJR
REVIEWED BY	RAS
ORIGINAL ISSUE DATE	12/16/2022
CLIENT PROJECT NO.	-

TITLE
PLANTING AND RESTORATION PLAN

SHEET
C5-10

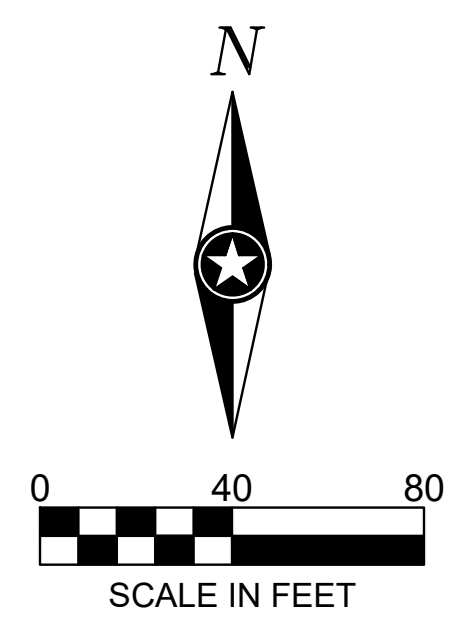

PLOT DATE: 11/02/2023 7:04 PM

PRELIMINARY NOT FOR CONSTRUCTION