

**EVERGREEN TREE PLANTING**  
NTS

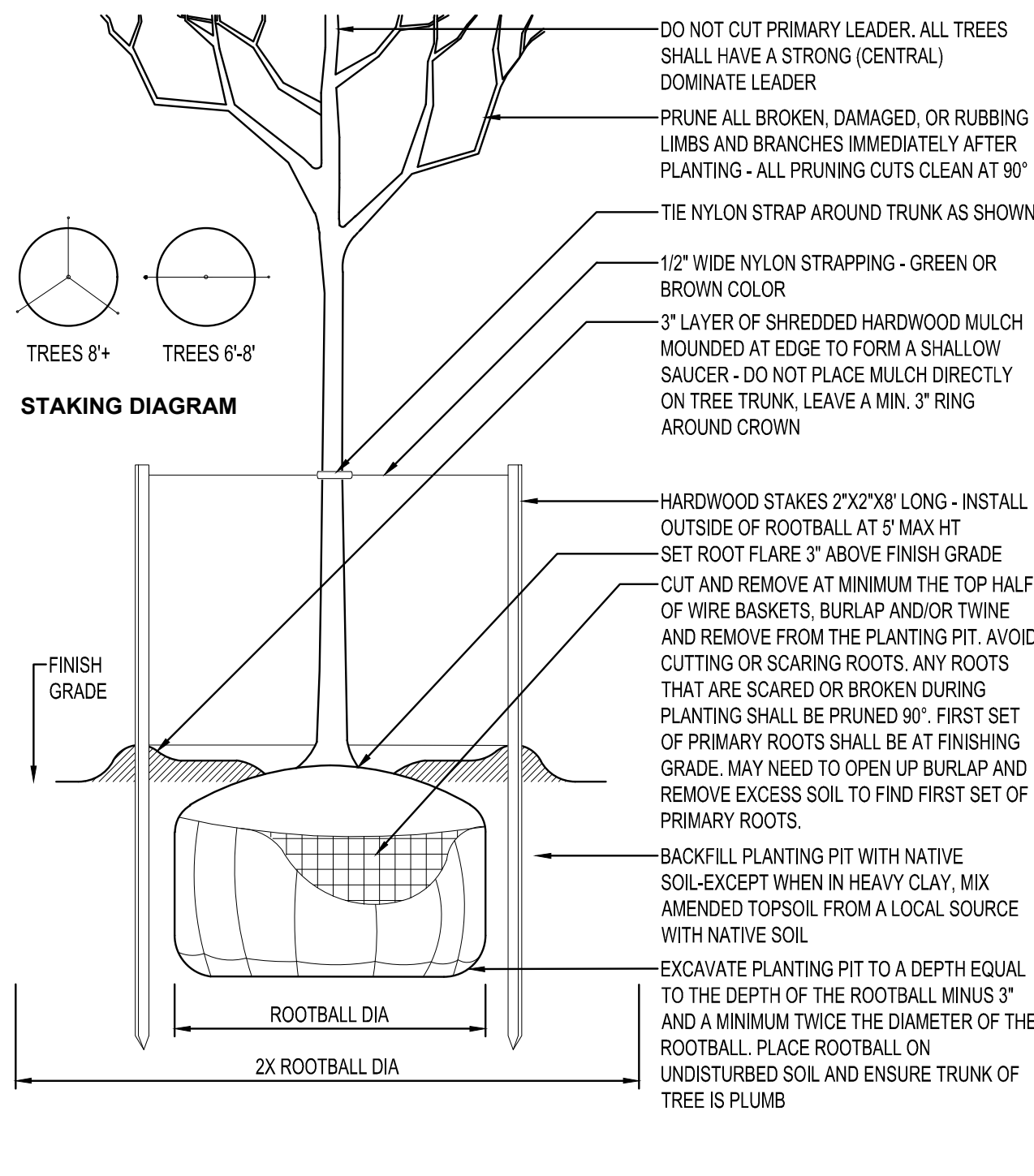

**DECIDUOUS TREE PLANTING**  
NTS

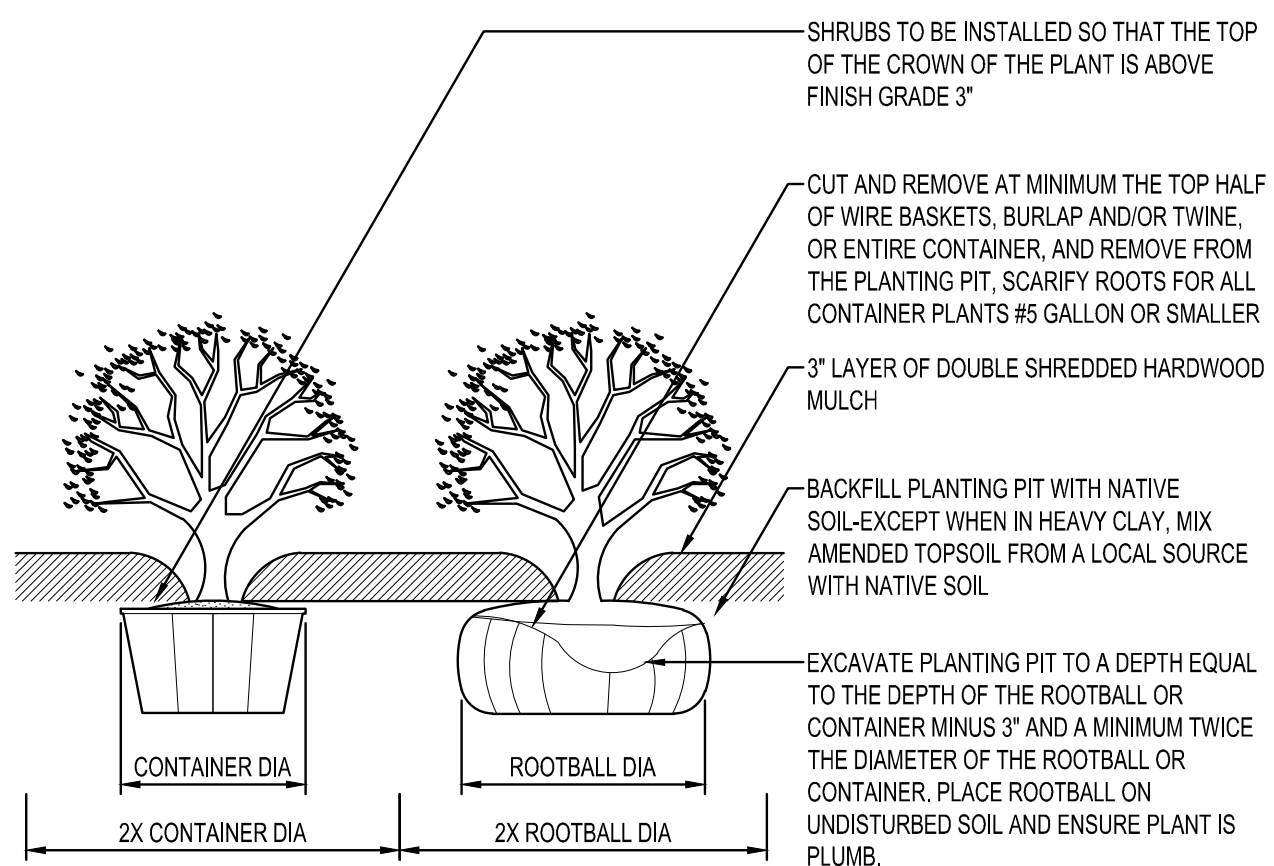

**SHRUB PLANTING**  
NTS

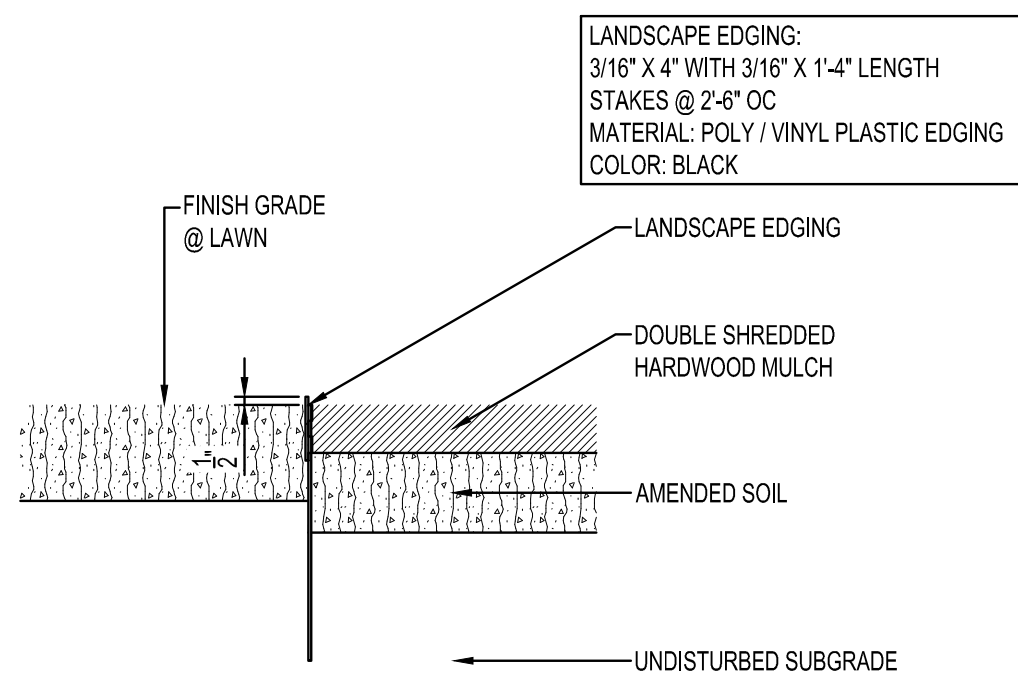

**LANDSCAPE EDGING**  
NTS

**PLANTING NOTES**

- COORDINATE LOCATION OF ALL UTILITIES (LINES, DUCTS, CONDUITS, SLEEVES, FOOTINGS, ETC.) WITH LOCATIONS OF PROPOSED LANDSCAPE ELEMENTS (FENCE, FOOTINGS, TREE ROOTBALLS, ETC.). CONTRACTOR SHALL REPORT ANY DISCREPANCIES TO OWNER'S REPRESENTATIVE PRIOR TO CONTINUING WORK.
- SAVE AND PROTECT ALL EXISTING TREES NOT NOTED TO BE REMOVED.
- REMOVE ALL CONSTRUCTION DEBRIS AND MATERIALS INJURIOUS TO PLANT GROWTH FROM PLANTING PITS AND BEDS PRIOR TO BACKFILLING WITH PLANTING MIX.
- REFER TO PLANTING DETAILS FOR AMENDED SOIL DEPTH IN PLANTING BEDS AND SURROUNDING TREES.
- FIELD STAKE PLANTINGS ACCORDING TO PLAN. OWNER'S REPRESENTATIVE SHALL APPROVE ALL PLANT LOCATIONS PRIOR TO INSTALLATION. OWNER'S REPRESENTATIVE RESERVES THE RIGHT TO REVISE PLANTING LAYOUT AT TIME OF INSTALLATION.
- ALL PLANT MATERIALS SHALL BE TRUE TO THEIR SCIENTIFIC NAME AND SIZE AS INDICATED IN THE PLANT SCHEDULE.
- IF DISCREPANCIES EXIST BETWEEN THE NUMBER OF PLANTS DRAWN ON THE PLANTING PLAN AND THE NUMBER OF PLANTS IN THE SCHEDULE, THE PLANTING PLAN SHALL GOVERN.
- ANY PLANT SUBSTITUTIONS REQUIRE PRIOR APPROVAL BY THE CITY. ANY PROPOSED SUBSTITUTIONS OF PLANT SPECIES SHALL BE MADE WITH PLANTS OF EQUIVALENT OVERALL FORM, HEIGHT, BRANCHING HABIT, FLOWER, LEAF, COLOR, FRUIT AND CULTURE, AND ONLY AFTER WRITTEN APPROVAL OF THE OWNER'S REPRESENTATIVE.
- ALL PLANT MATERIALS MUST CONFORM TO AMERICAN STANDARDS FOR NURSERY STOCK (ANSI Z60.1). LATEST EDITION PUBLISHED BY THE AMERICAN ASSOCIATION OF NURSERYMEN, WASHINGTON D.C. LARGER SIZED PLANT MATERIALS OF THE SPECIES LISTED MAY BE USED IF THE STOCK CONFORMS TO ANSI Z60.1.
- ALL PLANT MATERIAL SHALL BE GUARANTEED BY THE CONTRACTOR TO BE IN A LIVE AND HEALTHY GROWING CONDITION FOR ONE FULL GROWING SEASON (ONE YEAR) AFTER FINAL PROJECT ACCEPTANCE OR SHALL BE REPLACED BY THE CONTRACTOR FREE OF CHARGE WITH THE SAME GRADE AND SPECIES.
- ALL TREES SHALL HAVE A STRONG CENTRAL LEADER. ANY TREES DEEMED NOT TO HAVE A STRONG CENTRAL LEADER SHALL BE REJECTED.
- CONTRACTOR IS RESPONSIBLE FOR ALL DAMAGE DUE TO CONSTRUCTION OPERATIONS. ANY AREAS THAT ARE DISTURBED SHALL BE RESTORED TO ITS ORIGINAL CONDITION AT NO ADDITIONAL COST TO THE OWNER.
- PROVIDE DOUBLE SHREDDED HARDWOOD MULCH SURROUNDING ALL PROPOSED TREES (5' Ø) AND WITHIN PLANTING BEDS TO A 3" MINIMUM DEPTH AS SHOWN IN TREE PLANTING DETAIL. DO NOT USE AN UNDERLAYMENT SUCH AS PLASTIC SHEET OR LANDSCAPE FABRIC. APPLY PRE-EMERGENT TO ALL PLANTING BEDS PRIOR TO MULCHING. REFER TO PLANS FOR ADDITIONAL DETAILS. REFER TO STORMWATER DETAILS FOR BASIN CONSTRUCTION AND MULCH APPLICATION.
- MULCHING MATERIAL SHALL BE DOUBLE SHREDDED HARDWOOD MULCH, WITH NO INDIVIDUAL PIECES LARGER THAN 3". FREE OF GROWTH OR GERMINATION INHIBITING INGREDIENTS. 3" MINIMUM DEPTH. MINIMUM DEPTHS AT LOCATIONS INDICATED ON DRAWINGS.
- CONTRACTOR SHALL PROVIDE SAMPLE OF MULCH TO BE APPROVED BY THE LANDSCAPE ARCHITECT.
- INDICATED QUANTITIES ARE ESTIMATES AND SHALL BE CONFIRMED BY THE CONTRACTOR.
- ADJUST SPACING OF PLANT MATERIALS AROUND ADJACENT UTILITY STRUCTURES.
- ANY CLEARING OF OAK STANDS SHALL BE PERFORMED PRIOR TO APRIL 15TH OR AFTER JULY 15TH EACH SEASON.
- ALL PLANT MATERIAL SHALL HAVE A 2-YEAR MAINTENANCE WARRANTY FROM DATE OF CITY APPROVAL OF INSTALLED LANDSCAPING.
- ALL AREAS DISTURBED DURING CONSTRUCTION AND NOT OTHERWISE IMPROVED WITH IMPERVIOUS SURFACING SHALL RECEIVE A MINIMUM OF 4" OF TOPSOIL WITH NO MORE THAN 35% SAND CONTENT. TOPSOIL INSPECTION IS REQUIRED PRIOR TO INSTALLATION OF SOD/DIGROUND COVER.

**PROPOSED PLANT MATERIAL CROWN COVER PER RAMSEY TREE BOOK**

- EVERGREEN TREE CROWN COVER:**
- AMERICAN LARCH 718 SF (3 TREES) = 2,154 SF OF CROWN COVER
  - BLACK HILLS SPRUCE 386 (2 TREES) = 772 SF OF CROWN COVER
  - WHITE PINE 1,995 (14 TREES) = 27,930 SF

- DECIDUOUS TREE CROWN COVER:**
- YELLOW BIRCH 992 SF (6 TREES) = 5,952 SF
  - COMMON HACKBERRY 992 SF (14 TREES) = 13,888 SF
  - BUTTERNUT 1,995 (9 TREES) = 17,955 SF
  - WHITE OAK 3,910 (10 TREES) = 39,100 SF
  - BURR OAK 3,910 (3 TREES) = 11,730 SF
  - SHOWY MOUNTAIN ASH 386 (5 TREES) = 1,930 SF

- SHRUB CROWN COVER:**
- REGENT SERVICEBERRY 18 (25 SHRUBS) = 450 SF
  - ROUNDLEAF SERVICEBERRY 10 (16 SHRUBS) = 160 SF
  - FALSE INDIGO 131 (109 SHRUBS) = 14,279 SF
  - BLACK CHOKECHERRY 10 SF (7 SHRUBS) = 70 SF
  - SILVER BUFFALOBERRY 93 SF (7 SHRUBS) = 651 SF
  - RUSSET BUFFALOBERRY 41 SF (12 SHRUBS) = 492 SF
  - DOWNY ARROWWOOD 41 SF (11 SHRUBS) = 451 SF
  - AMERICAN CRANBERRYBUSH 51 SF (13 SHRUBS) = 663 SF

- EXISTING EVERGREEN TREE CROWN COVER:**
- WHITE SPRUCE 460 SF (1 TREE) = 460 SF
  - EASTERN RED CEDAR 77 SF (2 TREES) = 514 SF

**TOTAL CROWN COVER = 139,601 SF**

| WEST INFILTRATION BASIN CUSTOM SEED MIX |                         |                 |                 |                 |
|---|-------------------------|-----------------|-----------------|-----------------|
| SCIENTIFIC NAME                         | COMMON NAME             | RATE            | RATE            | % MIX BY WEIGHT |
|   |                         | (PLS OZ / ACRE) | (SEEDS / SQ.FT) |                 |
| <i>Desmodium canadense</i>              | Showy Tick Trefol       | 2               | 0.3             | 0.41            |
| <i>Echinacea purpurea</i>               | Purple Coneflower       | 8               | 1.2             | 1.65            |
| <i>Helenium autumnale</i>               | Sneezeweed              | 2               | 6.0             | 0.41            |
| <i>Monarda fistulosa</i>                | Wild Bergamot           | 2               | 3.2             | 0.41            |
| <i>Oenothera biennis</i>                | Common Evening Primrose | 1               | 0.2             | 0.21            |
| <i>Pycnanthemum virginianum</i>         | Mountain Mint           | 0.5             | 2.5             | 0.10            |
| <i>Symphoricarum laeve</i>              | Smooth Blue Aster       | 2               | 2.5             | 0.41            |
| <i>Symphoricarum lanceolatum</i>        | Panicled Aster          | 1               | 3.6             | 0.21            |
| <i>Rudbeckia hirta</i>                  | Black-eyed Susan        | 10              | 21.1            | 2.06            |
| <i>Chamaecrista fasciculata</i>         | Partridge Pea           | 16              | 1.0             | 3.29            |
| <i>Verbena hastata</i>                  | Blue Venain             | 4               | 8.5             | 0.82            |
| <i>Asclepias incarnata</i>              | Rose Milkweed           | 6               | 0.7             | 1.23            |
| <i>Symphoricarum novae-angliae</i>      | New England Aster       | 1               | 1.5             | 0.21            |
| <i>Bidens polyplepis</i>                | Bearded Beggarticks     | 1               | 0.2             | 0.21            |
| <i>Rudbeckia laciniata</i>              | Wild Golden Glow        | 1               | 0.2             | 0.21            |
| <i>Helianthus maximiliani</i>           | Maximilian's Sunflower  | 1               | 0.3             | 0.21            |
| <i>Amoglossum atriplicifolium</i>       | Pale Indian Plantain    | 1               | 0.1             | 0.21            |
| <b>TOTAL FORBS</b>                      |                         | <b>59.5</b>     | <b>53.2</b>     | <b>12.24</b>    |
| <i>Andropogon gerardii</i>              | Big Bluestem            | 32              | 7.3             | 6.58            |
| <i>Beckmannia syzigachne</i>            | American Slough Grass   | 16              | 18.4            | 3.29            |
| <i>Calamagrostis canadensis</i>         | Blue Joint Grass        | 0.5             | 3.2             | 0.10            |
| <i>Bromus ciliatus</i>                  | Fringed Brome           | 8               | 1.8             | 1.65            |
| <i>Spartina pectinata</i>               | Cord Grass              | 10              | 1.5             | 2.06            |
| <i>Sorghastrum nutans</i>               | Indian Grass            | 32              | 8.8             | 6.58            |
| <i>Panicum virgatum</i>                 | Switch Grass            | 4               | 1.3             | 0.82            |
| <i>Elymus canadensis</i>                | Canada Wild Rye         | 16              | 1.9             | 3.29            |
| <i>Elymus virginicus</i>                | Virginia Wild Rye       | 32              | 3.1             | 6.58            |
| <i>Bromus kalmii</i>                    | Prairie Brome           | 16              | 2.9             | 3.29            |
| <i>Poa palustris</i>                    | Fowl Bluegrass          | 16              | 47.8            | 3.29            |
| <i>Carex vulpinoidea</i>                | Brown Fox Sedge         | 4               | 9.2             | 0.82            |
| <b>TOTAL GRASSES &amp; SEDGES</b>       |                         | <b>186.5</b>    | <b>107.2</b>    | <b>38.37</b>    |
| <i>Avena sativa</i>                     | Oats - Cover Crop       | 240             | 4.4             | 49.38           |
| <b>TOTAL COVER CROPS</b>                |                         | <b>240</b>      | <b>4.4</b>      | <b>49.38</b>    |
| <b>TOTALS</b>                           |                         | <b>486</b>      | <b>164.8</b>    | <b>100</b>      |

| EAST INFILTRATION BASINS CUSTOM SEED MIX |                    |                 |                 |                 |
|--|--------------------|-----------------|-----------------|-----------------|
| SCIENTIFIC NAME                          | COMMON NAME        | RATE            | RATE            | % MIX BY WEIGHT |
|  |                    | (PLS OZ / ACRE) | (SEEDS / SQ.FT) |                 |
| <i>Bouteloua curtipendula</i>            | Side-oats Grama    | 16              | 2.2             | 4.09            |
| <i>Calamagrostis canadensis</i>          | Blue Joint Grass   | 1               | 6.4             | 0.26            |
| <i>Elymus canadensis</i>                 | Canada Wild Rye    | 24              | 2.9             | 6.13            |
| <i>Elymus hystrix</i>                    | Bottlebrush Grass  | 6               | 1.0             | 1.53            |
| <i>Elymus riparius</i>                   | Riverbank Wild Rye | 16              | 1.1             | 4.09            |
| <i>Elymus villosus</i>                   | Silky Wild Rye     | 4               | 0.5             | 1.02            |
| <i>Elymus virginicus</i>                 | Virginia Wild Rye  | 16              | 1.5             | 4.09            |
| <i>Glyceria striata</i>                  | Fowl Manna Grass   | 6               | 12.4            | 1.53            |
| <i>Panicum virgatum</i>                  | Switch Grass       | 2               | 0.6             | 0.51            |
| <i>Poa palustris</i>                     | Fowl Bluegrass     | 16              | 47.8            | 4.09            |
| <i>Schizachyrium scoparium</i>           | Little Bluestem    | 16              | 5.5             | 4.09            |
| <i>Spartina pectinata</i>                | Cord Grass         | 8               | 1.2             | 2.04            |
| <b>TOTAL GRASSES</b>                     |                    | <b>131</b>      | <b>83.2</b>     | <b>33.46</b>    |
| <i>Carex blanda</i>                      | Common Wood Sedge  | 2               | 0.6             | 0.51            |
| <i>Carex brevior</i>                     | Plains Oval Sedge  | 4               | 2.7             | 1.02            |
| <i>Carex crinita</i>                     | Fringed Sedge      | 1               | 0.5             | 0.26            |
| <i>Carex molesta</i>                     | Field Oval Sedge   | 1               | 0.6             | 0.26            |
| <i>Carex muskingumensis</i>              | Palm Sedge         | 1               | 0.2             | 0.26            |
| <i>Carex stipata</i>                     | Awl-fruited Sedge  | 3               | 2.3             | 0.77            |
| <i>Carex vulpinoidea</i>                 | Brown Fox Sedge    | 6               | 13.8            | 1.53            |
| <i>Juncus dudleyi</i>                    | Dudley's Rush      | 0.5             | 36.7            | 0.13            |
| <i>Juncus tenuis</i>                     | Path Rush          | 1               | 23.0            | 0.26            |
| <i>Scirpus pendulus</i>                  | Rufous Bulrush     | 1               | 7.1             | 0.26            |
| <b>TOTAL SEDGES &amp; RUSHES</b>         |                    | <b>20.5</b>     | <b>87.4</b>     | <b>5.24</b>     |
| <i>Avena sativa</i>                      | Oats - Cover Crop  | 240             | 4.4             | 61.30           |
| <b>TOTAL COVER CROPS</b>                 |                    | <b>240</b>      | <b>4.4</b>      | <b>61.30</b>    |
| <b>TOTALS</b>                            |                    | <b>391.5</b>    | <b>175.0</b>    | <b>100.00</b>   |



**NOTE:** THE CLARITY OF THESE PLANS DEPEND UPON COLOR COPIES. IF THIS TEXT DOES NOT APPEAR IN COLOR, THIS IS NOT AN ORIGINAL PLAN SET AND MAY RESULT IN MISINTERPRETATION.

I HEREBY CERTIFY THAT THIS PLAN, SPECIFICATION OR REPORT WAS PREPARED BY ME OR UNDER MY DIRECT SUPERVISION AND THAT I AM A DULY LICENSED PROFESSIONAL ENGINEER UNDER THE LAWS OF THE STATE OF MINNESOTA.  
REESE A. SUDTELGTE

DATE: 12/15/2022 LIC. NO. 54243

I HEREBY CERTIFY THAT THIS PLAN, SPECIFICATION OR REPORT WAS PREPARED BY ME OR UNDER MY DIRECT SUPERVISION AND THAT I AM A DULY LICENSED ARCHITECT UNDER THE LAWS OF THE STATE OF MINNESOTA.  
MITCHELL R. WORKMON

DATE: 12/15/2022 LIC. NO. 53748

THIS DOCUMENT IS THE PROPERTY OF I & S GROUP, INC. AND MAY NOT BE USED, COPIED OR DUPLICATED WITHOUT PRIOR WRITTEN CONSENT.

PROJECT  
**ANOKA RAMSEY ATHLETIC ASSOCIATION NEW DOME**  
RAMSEY MINNESOTA

| REVISION SCHEDULE |             |    |
|-------------------|-------------|----|
| DATE              | DESCRIPTION | BY |
|                   |             |    |
|                   |             |    |
|                   |             |    |
|                   |             |    |

PROJECT NO. 22-26051  
FILE NAME 26051 CS-LAND  
DRAWN BY AJR  
DESIGNED BY AJR  
REVIEWED BY RAS  
ORIGINAL ISSUE DATE 12/16/2022  
CLIENT PROJECT NO. -

**PLANTING NOTES AND DETAILS**

**PRELIMINARY NOT FOR CONSTRUCTION**