

LANDSCAPE LEGEND:

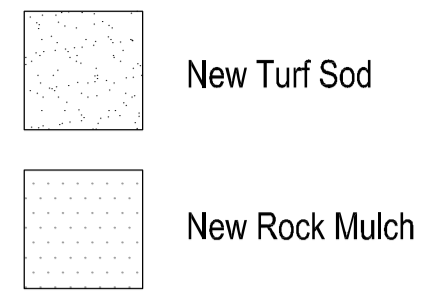

MUNICIPAL LANDSCAPE CALCULATIONS:

Minimum Planting Sizes
Coniferous Trees: 5' Hgt.
Ornamental Trees: 1.0" Cal.
Shade/Deciduous Island Trees: 1.0" Cal.
Shade/Deciduous Overstory Trees: 1.0" Cal.
Deciduous Shrubs: 24"

City of Ramsey R-1 Residential Units:
 Two (2) Overstory Trees Per Dwelling
 Dwelling Proposed in Phase I + II: 68
 Development Trees Required: 136
 Development Trees Provided: 136

GENERAL NOTES:

- Landscape contractor to provide a new irrigation layout plan for the property. See Landscape Notes.
- See Civil Engineer's plans for grading layout and requirements
- Contractor to coordinate any work in the right-of-way with City of Ramsey Public Works Department.
- Sod all disturbed areas except plant beds and areas noted to receive mulch.
- Place a minimum of 6" topsoil or slope dressing on all areas disturbed by construction, including right-of-way boulevards, unless specified otherwise.
- Refer to builder's specifications for additional requirements.
- See Sheets L1.2 + L1.3 for Landscape Details, Notes, Schedules, and Foundation Planting Enlargements.
- Landscape contractor is responsible for verification of soils and graded condition prior to mobilization and shall notify the General Contractor if earthwork is not acceptable. Landscape contractor is responsible for fine grading, or grade to within 1" of final set elevation.

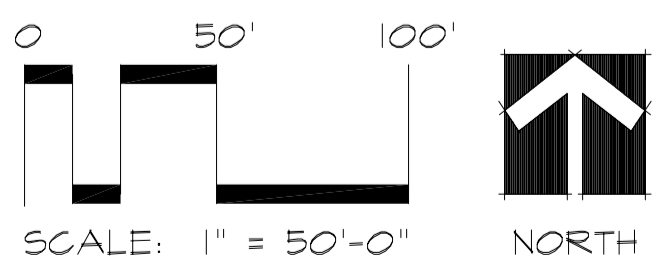
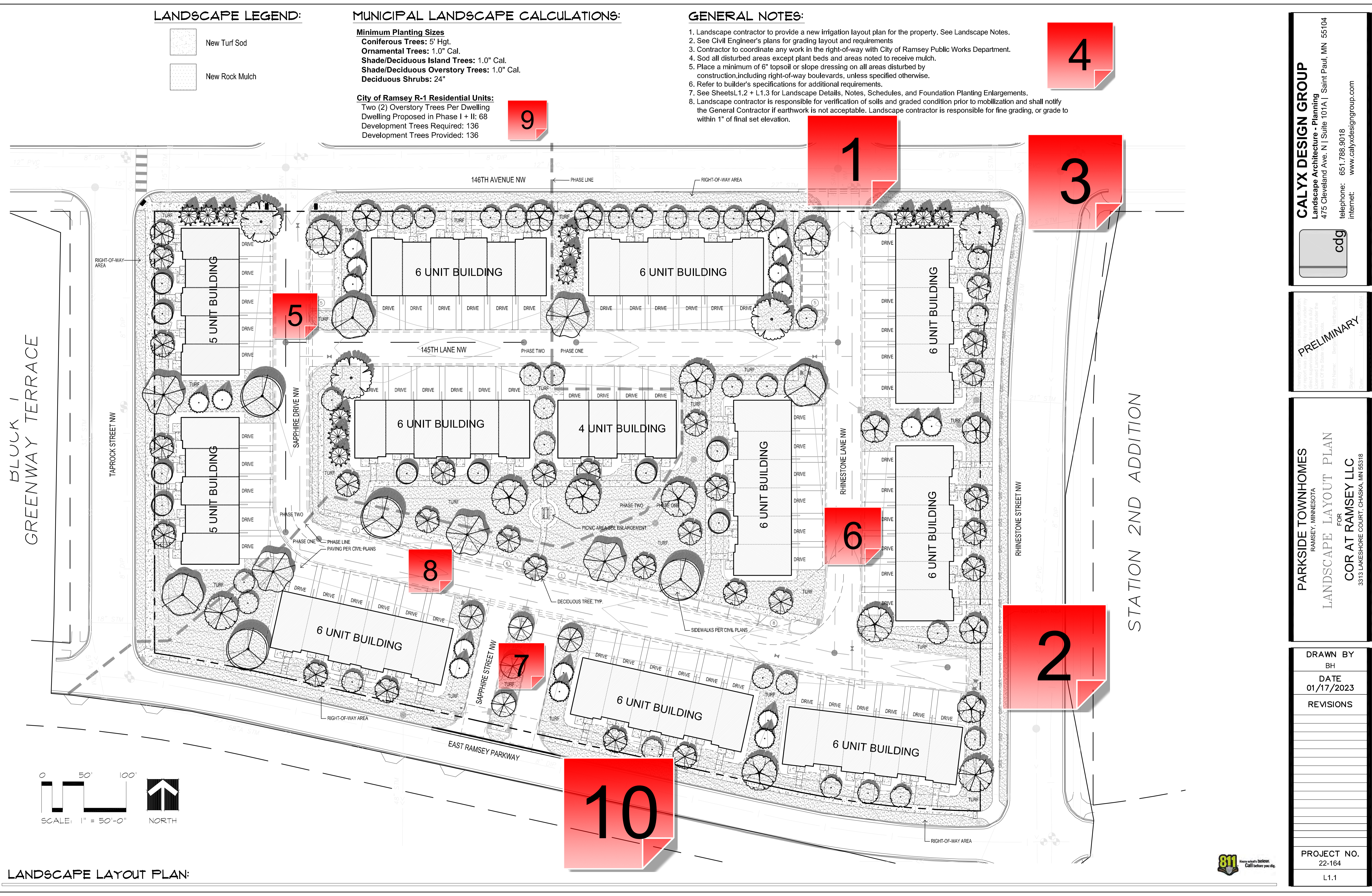

LANDSCAPE LAYOUT PLAN:

CALYX DESIGN GROUP
 Landscape Architecture - Planning
 475 Cleveland Ave. N | Suite 101A | Saint Paul, MN 55104
 telephone: 651.788.9018
 internet: www.calyxdesigngroup.com

PRELIMINARY

PARKSIDE TOWNHOMES
 RAMSEY, MINNESOTA
 LANDSCAPE LAYOUT PLAN
 FOR
COR AT RAMSEY LLC
 3313 LAKESHORE COURT, CHASKA, MN 55318

DRAWN BY	BH
DATE	01/17/2023
REVISIONS	
PROJECT NO.	22-164
	L1.1



1 - Streetscape Plantings

Status as of 01/19/2023 08:14 AM

Type: Action

State: For Discussion

Created by: Chris Anderson

On: 01/19/2023 08:14 AM

Type: Action

State: For Discussion

The COR District emphasizes an attractive streetscape, including boulevard trees and street furniture. Please review the street tree and street furniture sections of the COR Design Framework, beginning on page 83:
<https://www.ci.ramsey.mn.us/DocumentCenter/View/669/The-COR-Design-Framework-PDF?bidId=#page83>

----- 0 Replies -----

2 - Street Hierarchy and Tree Species

Created by: Chris Anderson

On: 01/19/2023 08:15 AM

Per the Street Hierarchy, Rhinestone Street is categorized as a Connector Street and Ramsey Parkway is categorized as a Parkway Street. The other 2 streets are categorized as Local Streets. This is needed to determine appropriate tree species in the boulevards.

----- 0 Replies -----

3 - Blvd Tree Spacing

Created by: Chris Anderson

On: 01/19/2023 08:23 AM

Blvd trees shall be spaced at 35 feet on center.

----- 0 Replies -----

4 - Topsoil

Created by: Chris Anderson

On: 01/19/2023 08:24 AM

Add (or modify existing) note that all disturbed areas not otherwise improved with impervious surfacing shall have four (4) inches of topsoil, with not more than 35% sand content. Topsoil inspection is required PRIOR to installing sod and trees.

----- 0 Replies -----

5 - Street Name

Created by: Chris Anderson

On: 01/19/2023 08:48 AM

Update Street name to Sapphire Way.

----- 0 Replies -----

6 - Street Name

Created by: Chris Anderson

On: 01/19/2023 08:49 AM

Update Street name to Rhinestone Terrace NW

----- 0 Replies -----

7 - Street Name

Created by: Chris Anderson

On: 01/19/2023 08:49 AM

Update Street name to Sapphire Lane NW.

----- 0 Replies -----

8 - Street Name

Created by: Chris Anderson

On: 01/19/2023 08:51 AM

Add street name of 145th Place NW.

----- 0 Replies -----

9 - Planting Requirements

Created by: Chris Anderson

On: 01/19/2023 08:52 AM

The R-1 planting standards are not applicable to this project. This project is more similar to R-3, you can refer to those standards here:

https://library.municode.com/mn/ramsey/codes/code_of_ordinances?nodeId=PTIICORR_CH117Z_OSU_ARTIIZO_DIV6PEST_SDIINGE_S117-364LA

----- 0 Replies -----

10 - Street Furniture

Created by: Chris Anderson

On: 01/19/2023 09:03 AM

Per the Design Framework, street furniture, such as bike racks, trash receptacles, and benches are required along Parkway streets. City Staff would suggest that these be installed on the south side of Ramsey Parkway, adjacent to The Draw park, rather than in front of the 3, 6-unit buildings. Please coordinate with City Staff as there are specific models of each of the furniture sites that are acceptable.

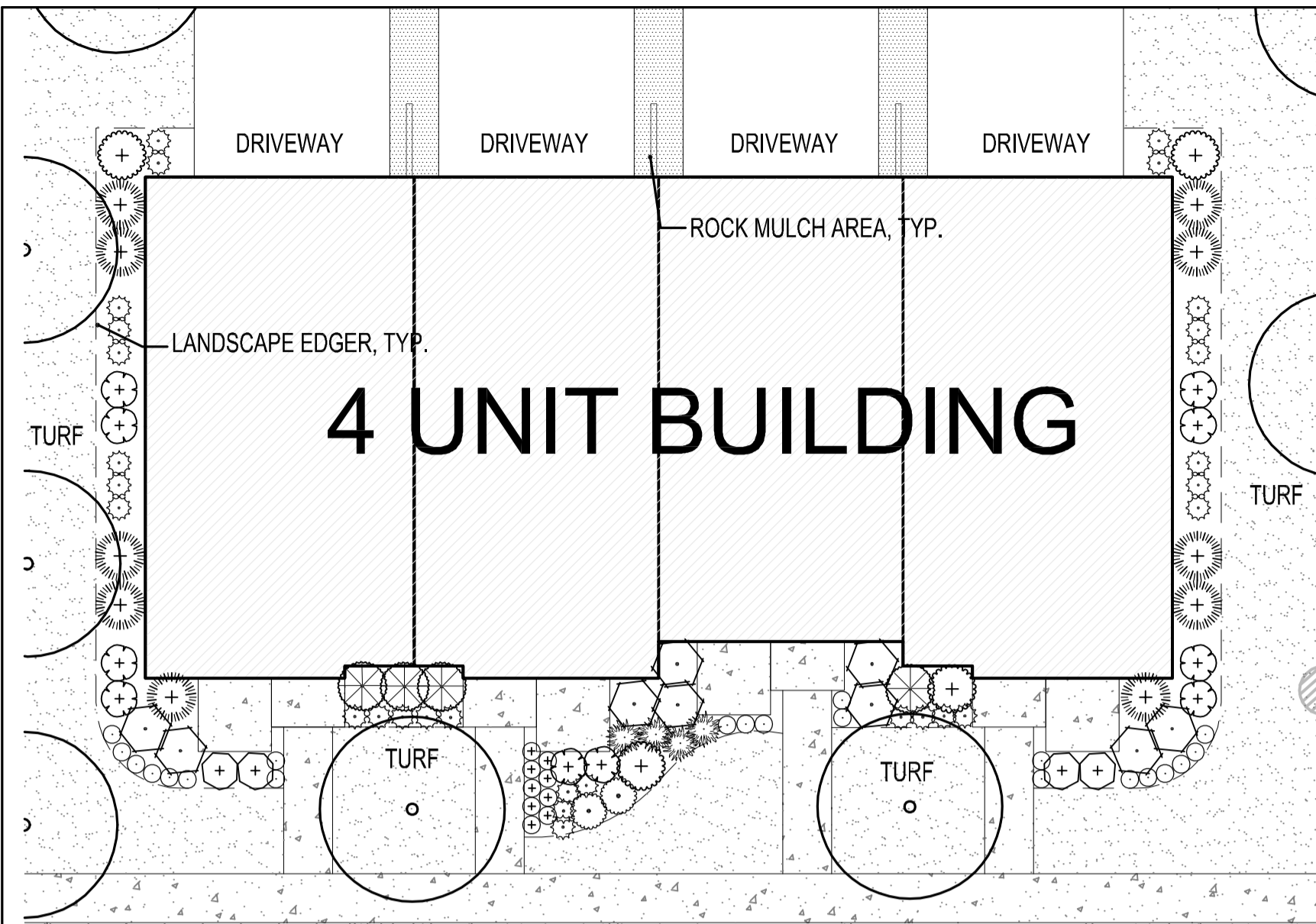

TYPICAL 4 UNIT FOUNDATION PLANTING PLAN:

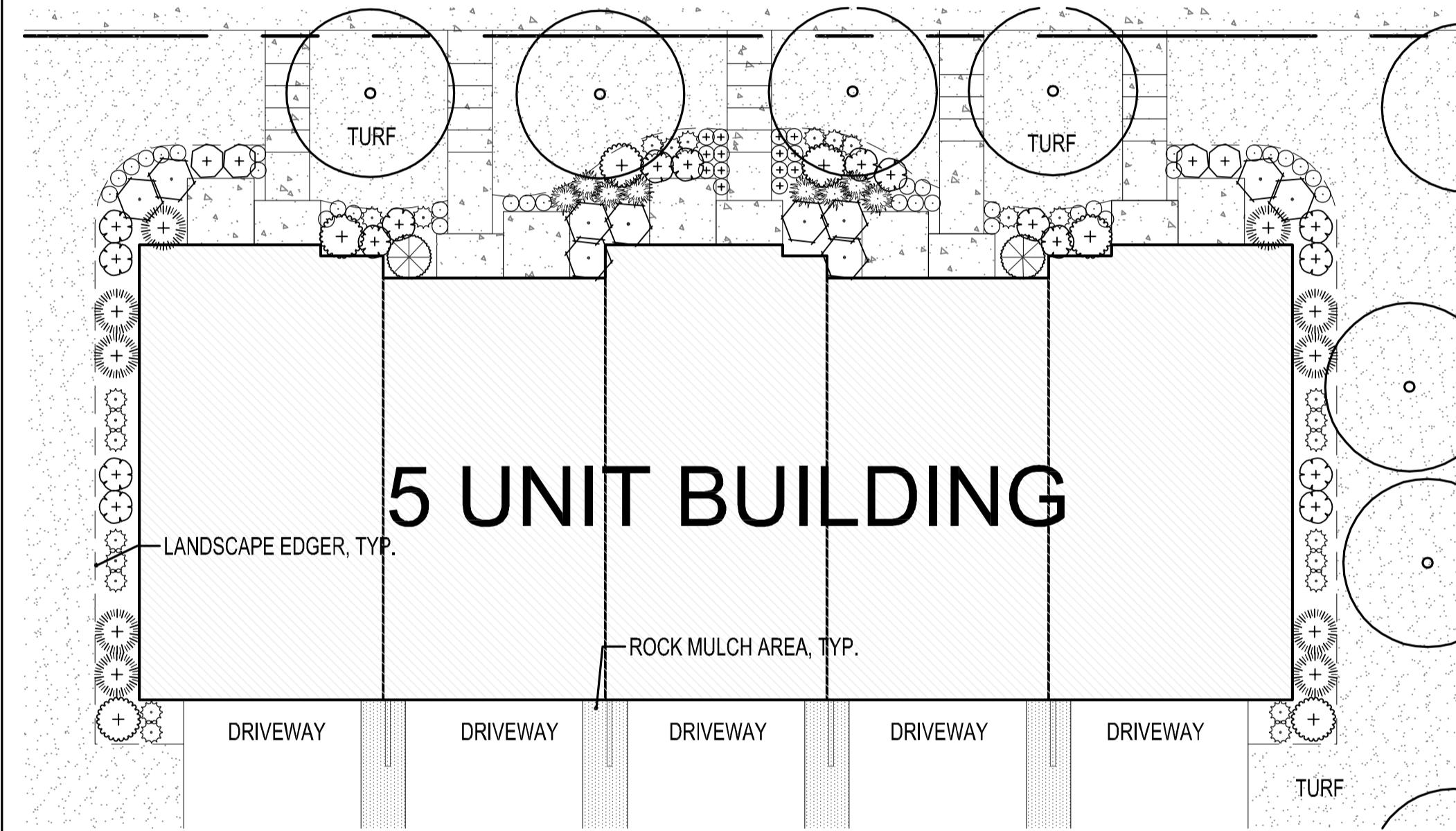

TYPICAL 5-UNIT FOUNDATION PLANTING PLAN:

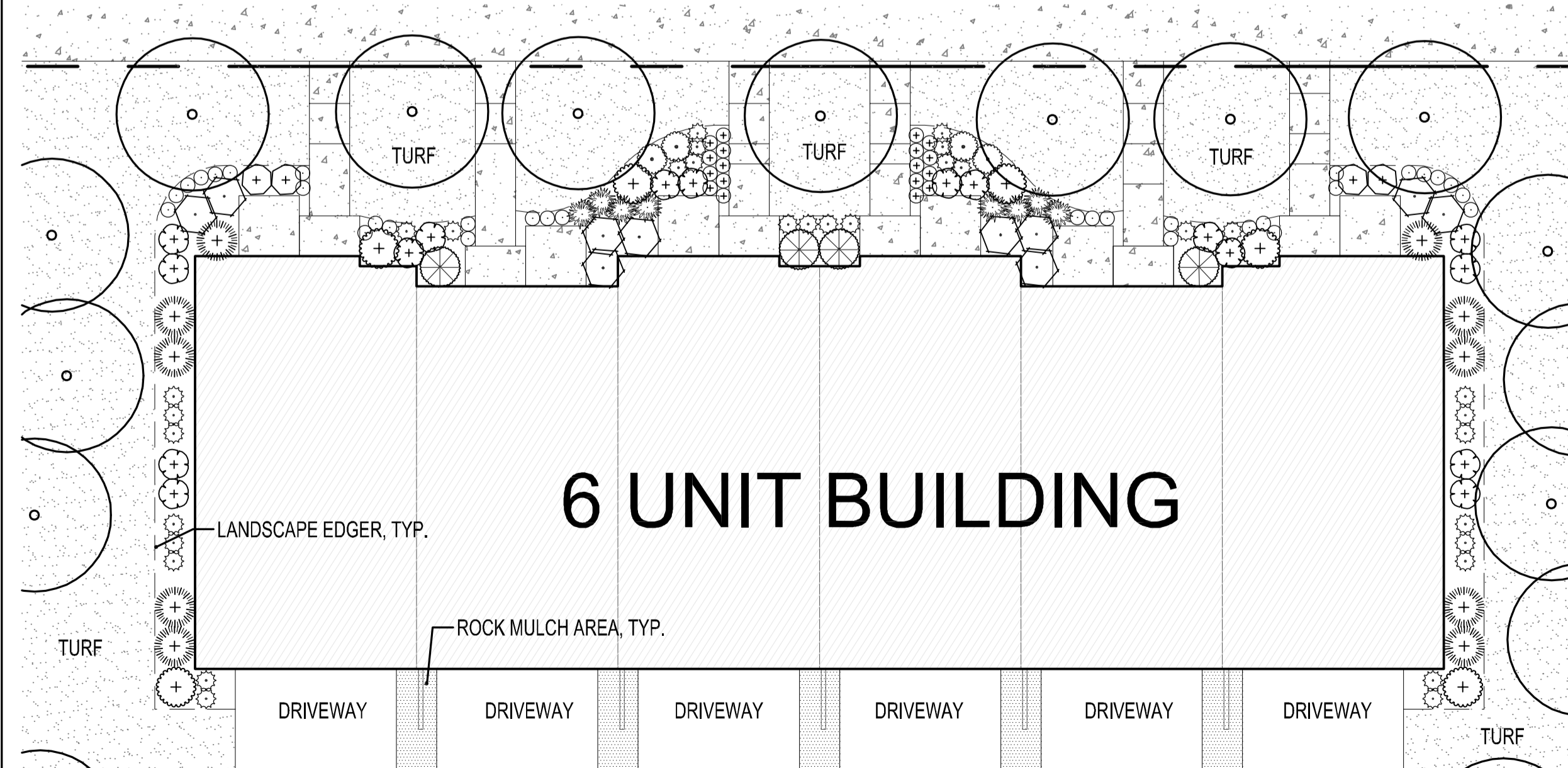

TYPICAL 6-UNIT FOUNDATION PLANTING PLAN:



GENERAL NOTES:

1. Landscape contractor to provide a new irrigation layout plan for the property. See landscape note #17.
2. See Civil Engineer's plans for grading layout and requirements
3. Contractor to coordinate any work in the right-of-way with City of Ramsey Public Works Department.
4. Sod all disturbed areas except plant beds and areas noted to receive mulch.
5. Place a minimum of 6" topsoil or slope dressing on all areas disturbed by construction, including right-of-way boulevards, unless specified otherwise.
6. Refer to builder's specifications for additional requirements.
7. See Sheet L1.1 for development landscape layout plan.
8. Landscape contractor is responsible for verification of soils and graded condition prior to mobilization and shall notify the General Contractor if earthwork is not acceptable. Landscape contractor is responsible for fine grading, or grade to within 1" of final set elevation.

REFER TO LAYOUT PLAN SHEETS FOR TREE LOCATIONS

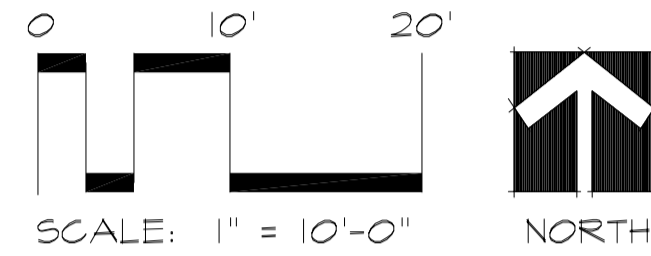

LANDSCAPE LEGEND:

- New Turf Sod
- New Rock Mulch

REFER TO LAYOUT PLAN SHEETS FOR TREE LOCATIONS

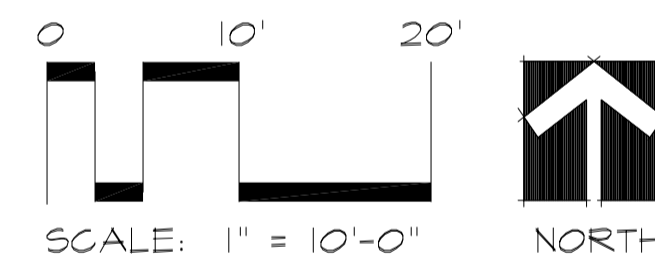

REFER TO LAYOUT PLAN SHEETS FOR TREE LOCATIONS

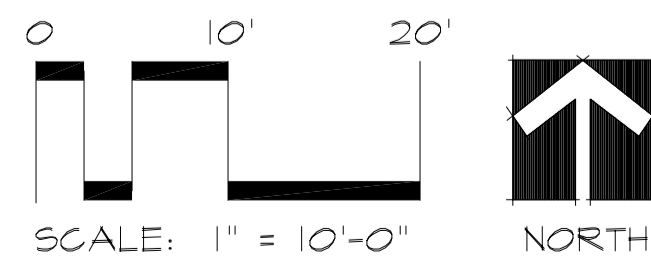

PLANT SCHEDULE

EVERGREEN TREES	CODE	BOTANICAL NAME	COMMON NAME	SIZE	CONTAINER	QTY
	PD	<i>Picea glauca</i> 'Densata'	Black Hills Spruce	5' Ht.	B&B	17
	SP	<i>Pinus sylvestris</i>	Scotch Pine	5' Ht.	B&B	12
OVERSTORY TREE	CODE	BOTANICAL NAME	COMMON NAME	SIZE	CONTAINER	QTY
	AR	<i>Acer rubrum</i>	Red Maple	2" Cal.	B&B	2
	AS	<i>Acer x freemanii</i> 'Sienna'	Sienna Glen Maple	1.5" Cal.	B&B	4
	BR	<i>Betula nigra</i>	River Birch	1.5" Cal.	B&B	3
	BF	<i>Betula platyphylla</i> 'Fargo'	Dakota Pinnacle® Asian White Birch	1.5" Cal.	B&B	9
	CO	<i>Celtis occidentalis</i>	Common Hackberry	2" Cal.	B&B	4
	GI	<i>Gleditsia triacanthos inermis</i> 'Skycole'™	Skyline Thornless Honey Locust	1.5" Cal.	B&B	8
	QE	<i>Quercus ellipsoidalis</i>	Northern Pin Oak	1.5" Cal.	B&B	8
	QC	<i>Quercus robur x alba</i> 'Crimschmidt'	Crimson Spire™ Oak	1" Cal.	B&B	17
	QR	<i>Quercus rubra</i>	Northern Red Oak	1.5" Cal.	B&B	5
ORNAMENTAL TREES	CODE	BOTANICAL NAME	COMMON NAME	SIZE	CONTAINER	QTY
	CC	<i>Crataegus laevigata</i> 'Crimson Cloud'	Crimson Cloud Hawthorn	1" Cal.	B&B	14
	MS	<i>Malus x</i> 'Spring Snow'	Spring Snow Crab Apple	1" Cal.	B&B	28
	SI	<i>Syringa reticulata</i> 'Ivory Silk'	Ivory Silk Japanese Tree Lilac	1" Cal.	B&B	5
SHRUBS	CODE	BOTANICAL NAME	COMMON NAME	SIZE	CONTAINER	QTY
	Am	<i>Aronia melanocarpa</i> 'Morton'™	Iroquois Beauty Black Chokeberry	5 gal.	Pot	70
	Cr2	<i>Clethra alnifolia</i> 'Ruby Spice'	Ruby Spice Clethra	5 gal.	Pot	186
	Cr	<i>Cornus alba</i> 'Regnzam'	Red Gnome Dogwood	5 gal.	Pot	119
	DI	<i>Diervilla lonicera</i>	Dwarf Bush Honeysuckle	3 gal.	Pot	44
	Jf	<i>Juniperus chinensis</i> 'Sea Green'	Sea Green Juniper	5 gal.	Pot	120
	Sm3	<i>Spiraea x bumalda</i> 'Goldmound'	Gold Mound Spiraea	5 gal.	Pot	48
	Tt2	<i>Thuja occidentalis</i> 'Techny Globe'	Techny Globe Arborvitae	5 gal. (Min. 18" Height)	Pot	44
ANNUALS/PERENNIALS	CODE	BOTANICAL NAME	COMMON NAME	SIZE	CONTAINER	QTY
	Hr	<i>Hemerocallis x</i> 'Ruby Stella'	Ruby Stella Daylily	1 gal.	Pot	223
	Ho	<i>Hemerocallis x</i> 'Stella de Oro'	Stella de Oro Daylily	1 gal.	Pot	377
	Nr	<i>Nepeta racemosa</i> 'Walker's Low'	Catmint	1 gal.	Pot	92
GRASSES	CODE	BOTANICAL NAME	COMMON NAME	SIZE	CONTAINER	QTY
	Ck	<i>Calamagrostis x acutiflora</i> 'Karl Foerster'	Feather Reed Grass	1 gal.	Pot	385

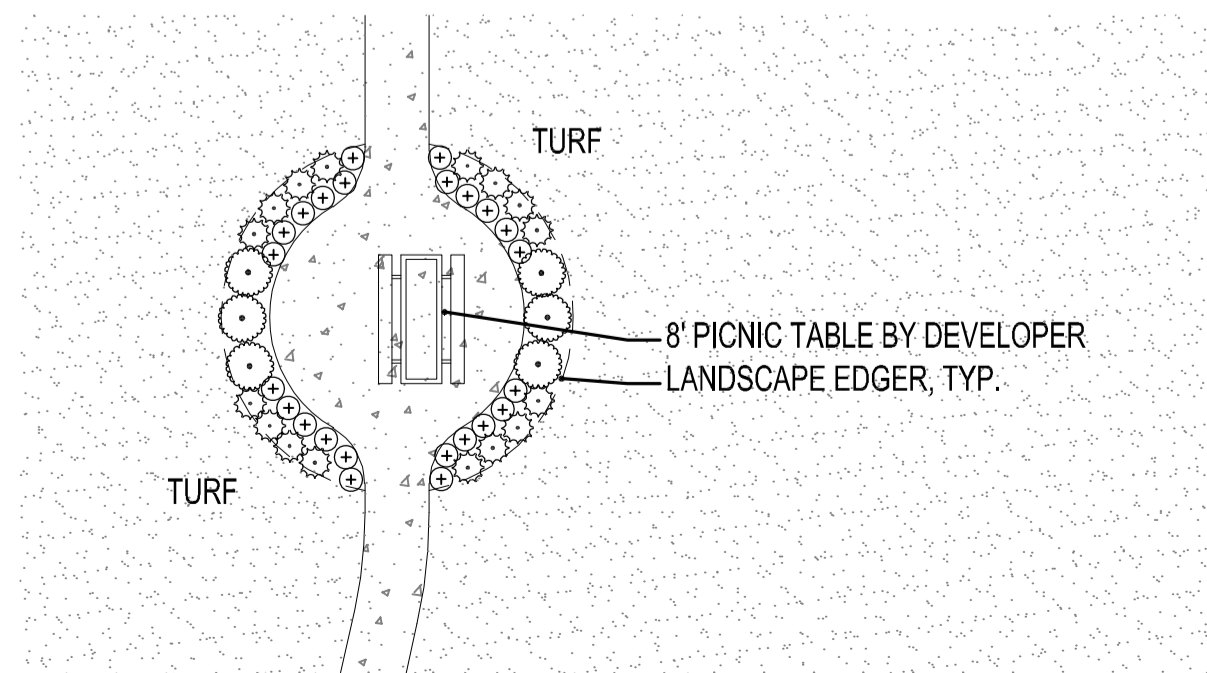

REFER TO LAYOUT PLAN SHEETS FOR TREE LOCATIONS

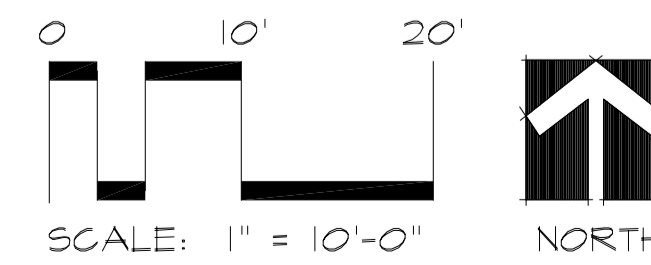

PICNIC AREA ENLARGEMENT:

CALYX DESIGN GROUP
 Landscape Architecture - Planning
 475 Cleveland Ave. N | Suite 101A | Saint Paul, MN 55104
 telephone: 651.788.9018
 internet: www.calyxdesigngroup.com

PRELIMINARY

PARKSIDE TOWNHOMES
 RAMSEY, MINNESOTA
 LANDSCAPE DETAILS
 FOR
COR AT RAMSEY LLC
 3313 LAKESHORE COURT, CHASKA, MN 55318

DRAWN BY BH
DATE 01/17/2023
REVISIONS
PROJECT NO. 22-164
L1.2

1 - Topsoil Requirement

Created by: Chris Anderson
On: 01/19/2023 08:28 AM

City Code requires a minimum of four (4) inches of topsoil applied to all disturbed areas not otherwise improved with impervious surfacing. Topsoil shall consist of not more than 35% sand content.

----- 0 Replies -----

2 - Shrub Size

Created by: Chris Anderson
On: 01/19/2023 08:34 AM

Modify Planting Schedule to specify that minimum size of shrubs at installation is 24 inches in height.

----- 0 Replies -----

LANDSCAPE NOTES + REQUIREMENTS:

- Landscape contractor to provide nursery pull list (bill of lading) including plant species and sizes shipped to the site. Additionally, the landscape contractor shall provide nursery stock traceability, proving none of the materials provided contain or are genetic strains of the neonicotinoid family including acetamiprid, clothianidin, imidacloprid, nitenpyram, nithiazine, thiacloprid and thiamethoxam.
- Refer to civil plan sheets for grading, drainage, site dimensions, survey, tree removal, proposed utilities & erosion control.
- All plant material shall comply with the latest edition of the American Standard for Nursery Stock, American Association of Nurserymen. Unless noted otherwise, deciduous shrubs shall have at least 5 canes at the specified shrub height. Plant material shall be delivered as specified. All deciduous trees are measured at 48" from finished grade to determine tree diameter (DBH). All coniferous trees are measured from finished grade to the top of the central leader. If no central leader is present on coniferous trees, that plant is rejected and must be replaced immediately.
- Plan takes precedence over plant schedule if discrepancies in quantities exist.
- All proposed plants shall be placed as close to the location(s) indicated on the plan as possible. Contact the landscape architect if discrepancies arise during plant installation that require deviating location(s) from those shown on the plans.
- Adjustment in location of proposed plant material may be needed in field. Should an adjustment be required, the client will provide field approval. Significant changes may require city review and approval.
- The project landscape contractor shall be held responsible for watering and properly handling all plant materials brought on the site both before and after installation. Schedule plant deliveries to coincide with expected installation time within 36 hours.
- All plant materials shall be fertilized upon installation as specified.
- The landscape contractor shall provide the owner with a watering schedule appropriate to the project site conditions and to plant material growth requirements.
- If the landscape contractor is concerned or perceives any deficiencies in the plant selections, soil conditions, drainage or any other site condition that might negatively affect plant establishment, survival or guarantee, they must bring these deficiencies to the attention of the landscape architect & client prior to bid submission. Plant bed drainage concerns during plant installation shall be brought to the attention of the Owner and General Contractor immediately.
- Contractor shall establish to his/ her satisfaction that soil and compaction conditions are adequate to allow for proper drainage at and around the building site.
- Contractor is responsible for ongoing maintenance of all newly installed material for the duration of the plant warranty, with the exception of turf sod, which shall be maintained for 30 days after installation or until the first mowing, whichever comes first. Contractor must bag clippings from initial mowing and remove from the job site. Any acts of vandalism or damage which may occur prior to warranty start shall be the responsibility of the contractor. Contractor shall provide the owner with O&M information, including (but not limited to), written instructions on proper lawn mowing height, yearly lawn maintenance recommendations, proper plant pruning information, plant & lawn fertilization schedule, and disease/pest control.
- The contractor shall guarantee newly planted material through one calendar year from the date punch list review. Plants that exhibit more than 20% die-back damage shall be replaced at no additional cost to the owner. The contractor shall also provide adequate tree wrap and deer/rodent protection measures for the plantings during the warranty period.
- This layout plan constitutes our understanding of the landscape requirements listed in the ordinance. Changes and modifications may be requested by the city based on applicant information, public input, council decisions, etc.
- The landscape contractor shall be responsible for obtaining any permits and coordinating inspections required throughout the work process.
- Plant size & species substitutions must be approved in writing prior to acceptance in the field.
- Irrigation: The landscape contractor shall furnish a complete irrigation layout plan for review. Design for head-to-head coverage of all landscaped areas. Include underground sleeve locations, irrigation connection location within the building, and locations of all heads, lateral lines, main lines, valves, & controls. Include a wired rain sensor per state plumbing code.
- Landscape Contractor is responsible for coordination with the General Contractor, to protect the new improvements on and off-site during landscape work activities. Report any damage to the General Contractor immediately.
- All plant beds and trees located outside of plant bed limits to receive Western Red Cedar wood mulch to a depth of 4-inches. Wood mulch tree rings per details. Submit mulch sample for Owner approval. Top dress wood mulch areas with Preen pre-emergent granule to prevent emergent weeds.
- Edger to be 16 GA Plated Finish Perforated Edger, Coyote or Equal. Stake every 18" minimum. Submit sample for approval.
- All planting areas shall be prepared prior to installation activities with clean, imported loam topsoil. Provide a firm planting bed free of stones, sticks, construction debris, etc.
- The Landscape Contractor shall furnish samples of all landscape materials for approval prior to installation.
- The Landscape Contractor shall clear and grub the underbrush from within the work limits to remove dead branches, leaves, trash, weeds and foreign materials.
- The landscape contractor shall contact Gopher State One Call no less than 48 hours before digging for field utility locations.
- The landscape contractor shall be responsible for the removal of erosion control measures once vegetation has been established to the satisfaction of the municipal staff. This includes silt curtain fencing and sediment logs placed in the landscape.
- The landscape contractor shall be responsible for visiting the site to become familiar with the conditions prior to bidding and installation. Coordinate with the general contractors on matters such as fine grading, landscaped area conditions, staging areas, irrigation connection to building, etc.
- Construction materials, stockpiles, equipment, and vehicles shall not be stored or operated on city boulevards without written permission from the city. Restore disturbed areas off-site to original condition.
- All sub-cut areas of the site that are designated on the site plan as open space for landscape shall be graded with imported, pulverized topsoil. Slope away from building. See note 29 below.
- Landscape contractor must prove the open sub-grade of all planting areas after their excavation is capable of infiltrating a minimum requirement of 1/4-inch of water per hour prior to installation of plant materials, topsoil, irrigation, weed mat, and mulch. Planting areas not capable of meeting this requirement shall have 4" diameter X 48" depth holes augured every 36" on-center and filled with MnDOT Free-Draining Coarse Filter Aggregate. Re-test sub-grade percolation for compliance to infiltration minimum requirement.
- Fencing (if noted) per Architect's Plans and Specifications.
- Grind or excavate existing stumps (if present) to 30" below grade & backfill with imported topsoil.
- Rock Mulch: Where noted on the plans, rock mulch shall be 3" depth of .75" dia. crushed buff limestone rock over 5oz. needle-punch free-draining landscape mat. Bryan Rock or equal. Overlap seams 6" and staple every 16" on-center.
- Landscape Contractor and Excavator shall be responsible for providing 6" depth topsoil under turf areas, 18" depth topsoil in plant beds and 24" in tree pits. See civil engineer's plans for grading, erosion control, and final grade elevations.

IRRIGATION NOTES + REQUIREMENTS:

- LAYOUT WORK AS ACCURATELY AS POSSIBLE TO THE CONTRACTOR PROVIDED AND OWNER-APPROVED IRRIGATION LAYOUT PLANS. THE CONTRACTOR MAY MAKE MINOR ADJUSTMENTS TO THE LOCATION AND SPACING AS NECESSARY TO ACCOMMODATE ACTUAL CONDITIONS. HEAD LOCATIONS SHALL BE FLAGGED AND REVIEWED BY THE OWNER'S REP. PRIOR TO INSTALLATION.
- COORDINATE SLEEVING AND IRRIGATION PIPE / HEAD / INTERNAL PLUMBING INSTALLATION WITH THE WORK OF OTHERS.
- ALL MATERIALS SHALL BE INSTALLED AS DETAILED ON DRAWINGS. (HOWEVER, IF THE CONTRACT DRAWINGS AND/OR SPECIFICATIONS DO NOT THOROUGHLY DESCRIBE THE METHOD OR TECHNIQUES TO BE USED, THE CONTRACTOR SHALL FOLLOW THE INSTALLATION METHODS ISSUED BY THE MANUFACTURER. ALL SUCH LITERATURE MUST BE SUBMITTED 2 WEEKS PRIOR TO INSTALLATION FOR REVIEW AND APPROVAL BY THE LANDSCAPE ARCHITECT.)
- CHECK AND VERIFY ALL EXISTING AND PROPOSED SITE CONDITIONS, UTILITIES AND SERVICES PRIOR TO TRENCHING.
- LATERAL PIPING TO BE A MINIMUM OF 12 INCHES DEEP AND MAINLINES A MINIMUM OF 18 INCHES DEEP.
- ALL MAIN LINE PIPING AND LATERAL PIPE OF 1-1/2" AND LARGER SHALL BE PVC (SDR 26 / CLASS 160). ALL OTHER LATERAL PIPE OF 1-1/4" AND SMALLER MAY BE POLYETHYLENE, UNLESS OTHERWISE NOTED ON THE PLANS. BUILDING CONNECTIONS ARE TO BE COPPER. TRACER WIRE IS REQUIRED ON ALL MAIN AND LATERAL LINES. SLEEVE LOCATIONS ARE TO BE MARKED ON THE SIDEWALK OR CURB, SO THEY CAN BE FOUND AFTER FINE GRADING.
- ALL TEES AND ELBOWS ON MAIN LINES SHALL BE PVC (160 PSI).
- IRRIGATION EQUIPMENT SHALL HUNTER, RAINBIRD, OR TORO BRAND HEADS, VALVES, AND ROTORS.
- ADJUST HEADS FOR GRADE, AS NECESSARY, AFTER TURF GRASS HAS BEEN ESTABLISHED AND ALL SETTLEMENT AT HEADS HAS OCCURRED.
- SUBMIT IRRIGATION PRODUCT DATA TO OWNER FOR REVIEW AND APPROVAL.
- USE TEFLON TAPE ON ALL THREADED JOINTS.
- CONDUCT PERFORMANCE TEST IN THE PRESENCE OF OWNER FOLLOWING COMPLETION OF SYSTEM INSTALLATION.
- CONDUCT AND DEMONSTRATE WINTERIZATION AND SPRING START-UP PROCESS TO OWNER IN THE FALL OF COMPLETION.
- IRRIGATION LINE LOCATIONS SUBJECT TO CHANGE IN THE FIELD, AS CONTRACTOR DEEMS NECESSARY.
- OVER-SPRAY OF THE IRRIGATION SYSTEM ON TO ADJACENT WALKS AND ASPHALT PAVING IS NOT ACCEPTABLE. DO NOT INSTALL ANY IRRIGATION EQUIPMENT OUTSIDE OF THIS PROPERTY LIMITS, UNLESS APPROVED BY THE CITY.
- LANDSCAPE CONTRACTOR SHALL BE RESPONSIBLE FOR SUBMITTING A COMPLETE IRRIGATION LAYOUT PLAN SET AND SUBMITTING TO THE LANDSCAPE ARCHITECT FOR REVIEW AND APPROVAL PRIOR TO COMMENCEMENT OF FIELD INSTALLATION.
- SUBMIT LAYOUT PLAN AND PRODUCT DATA TO THE OWNER FOR REVIEW AND APPROVAL PRIOR TO INSTALLATION.
- IRRIGATION BID SHALL INCLUDE (1) FALL SHUT-DOWN AND (1) SPRING START-UP.
- PROVIDE THE OWNER WITH AN AS-BUILT PLAN, INCLUDING THE EXISTING SYSTEM AS WELL AS NEWLY INSTALLED MATERIALS.
- IRRIGATION CONTRACTOR TO VERIFY WATER PRESSURE FOLLOWING CONSTRUCTION OF THE BUILDING UTILITIES. ADJUSTMENT OF PIPE AND VALVE SIZES MAY BE REQUIRED, BASED ON ACTUAL GPM AND PSI AVAILABLE.
- PROVIDE A PRINTED 8.5X11 MAP OF ALL ZONES AFTER NEW CONTROLLER IS WIRED AND TESTED.
- IRRIGATION MECHANICALS TO INCLUDE DOMESTIC WATER BRASS OR BRONZE GATE (BALL) VALVE, DEDUCT WATER METER, IRRIGATION BACKFLOW DEVICE, AND BOTH A QUICK COUPLE VALVE IMMEDIATELY OUTSIDE THE FOUNDATION ON THE MAIN AND A BOILER DRAIN WITH RUBBER HOSE ROUTED TO FLOOR DRAIN, FOR WINTERIZATION.
- ALL IRRIGATION EQUIPMENT REQUIRED FOR OPERATION IS TO BE FURNISHED AND INSTALLED BY THE IRRIGATION CONTRACTOR AND THEIR LICENSED PLUMBING SUB-CONTRACTOR. THIS INCLUDES SLEEVING THROUGH FOUNDATION WITH WATERSTOPS, FOR IRRIGATION MAIN ROUTING TO THE LANDSCAPE.

GENERAL NOTES:

- Landscape contractor to provide a new irrigation layout plan for the property. See landscape note #17.
- See Civil Engineer's plans for grading layout and requirements
- Contractor to coordinate any work in the right-of-way with City of Ramsey Public Works Department.
- Sod all disturbed areas except plant beds and areas noted to receive mulch.
- Place a minimum of 6" topsoil or slope dressing on all areas disturbed by construction, including right-of-way boulevards, unless specified otherwise.
- Refer to builder's specifications for additional requirements.
- See Sheet L1.1 for development landscape layout plan.
- Landscape contractor is responsible for verification of soils and graded condition prior to mobilization and shall notify the General Contractor if earthwork is not acceptable. Landscape contractor is responsible for fine grading, or grade to within 1" of final set elevation.

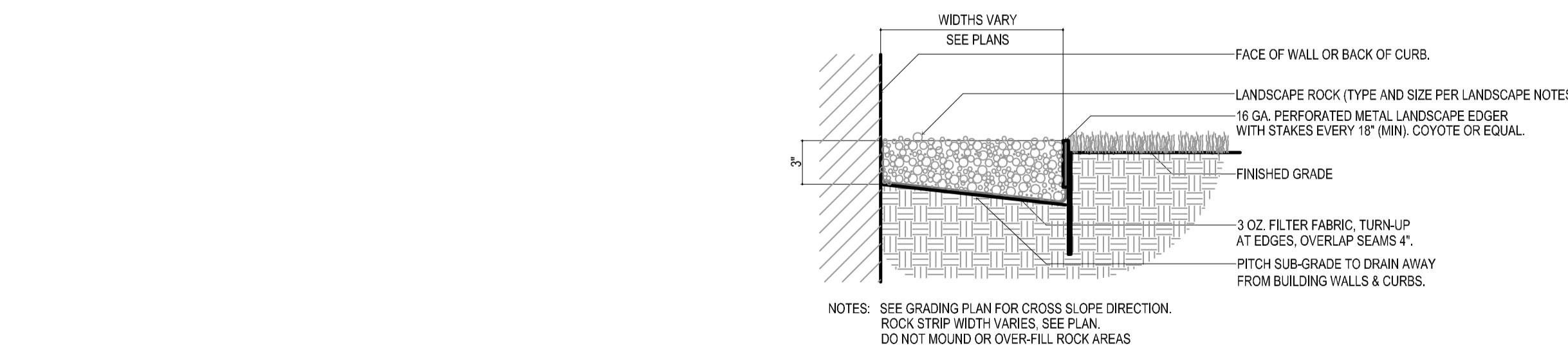

4 ROCK MAINTENANCE STRIP DETAIL
L1.3 NOT TO SCALE

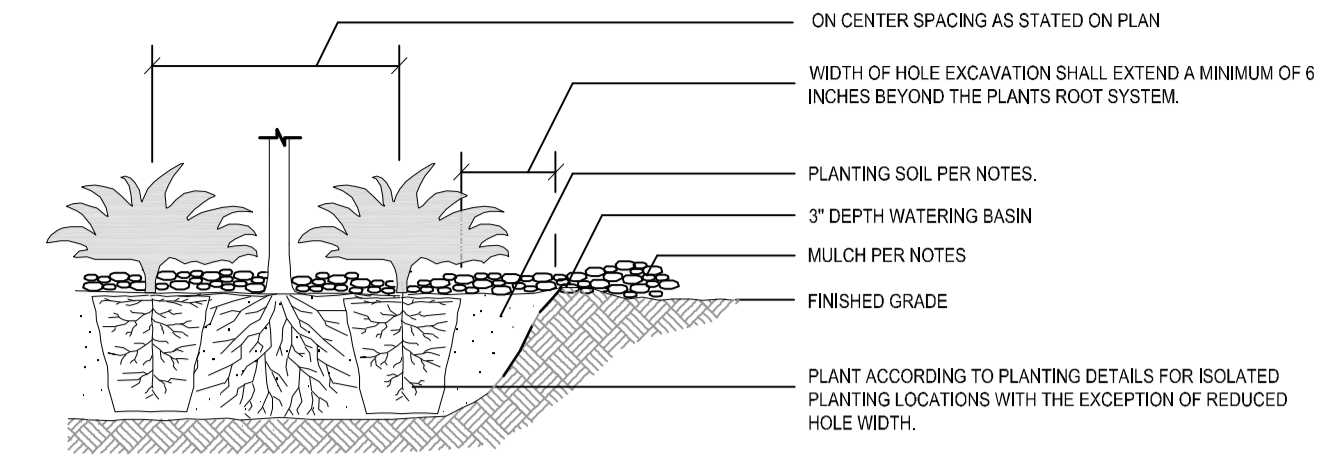

1 TYP. SHRUB PLANTING - SECTION
L1.3 NOT TO SCALE

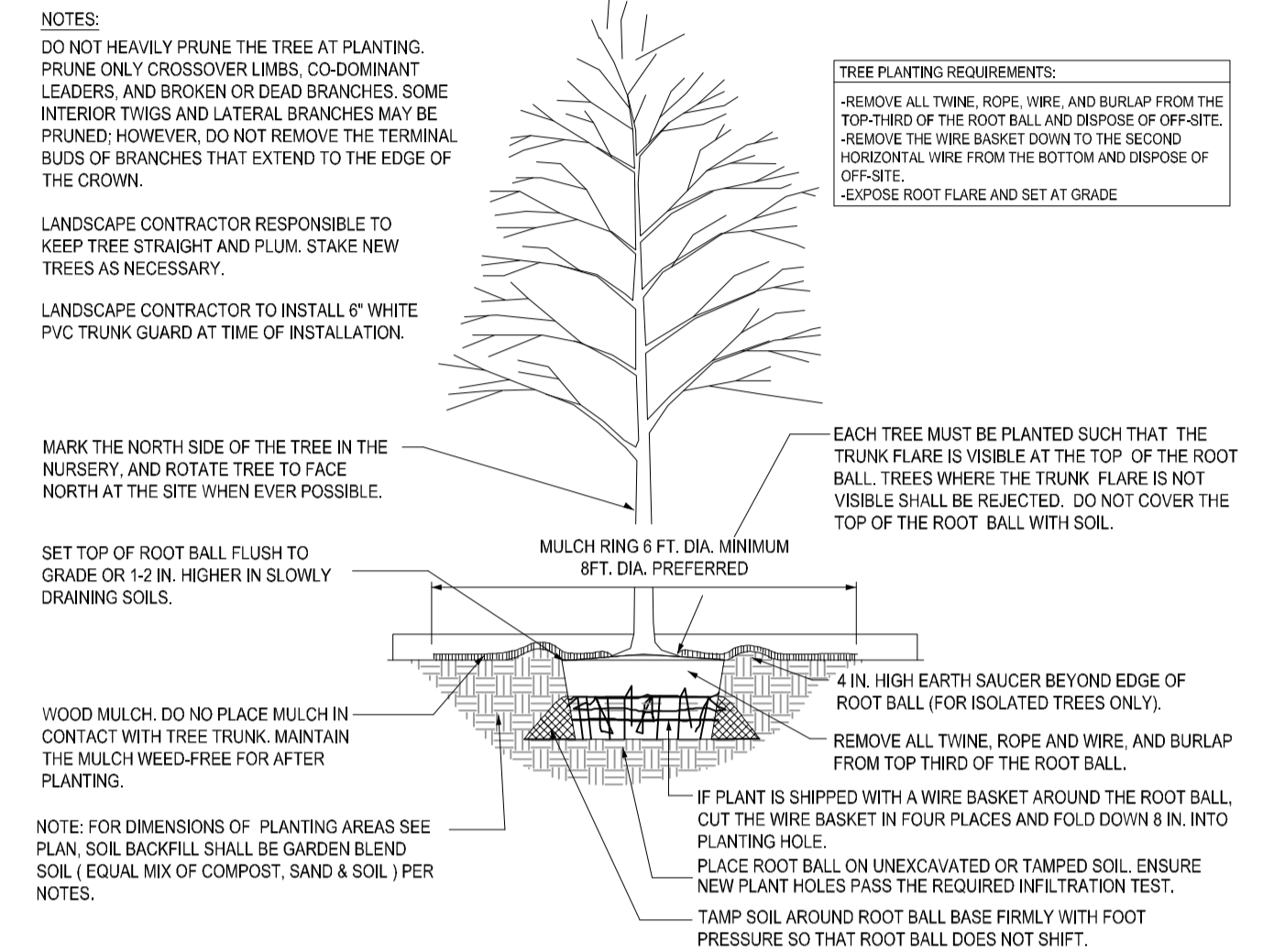

2 DECIDUOUS TREE PLANTING - SECTION
L1.3 NOT TO SCALE

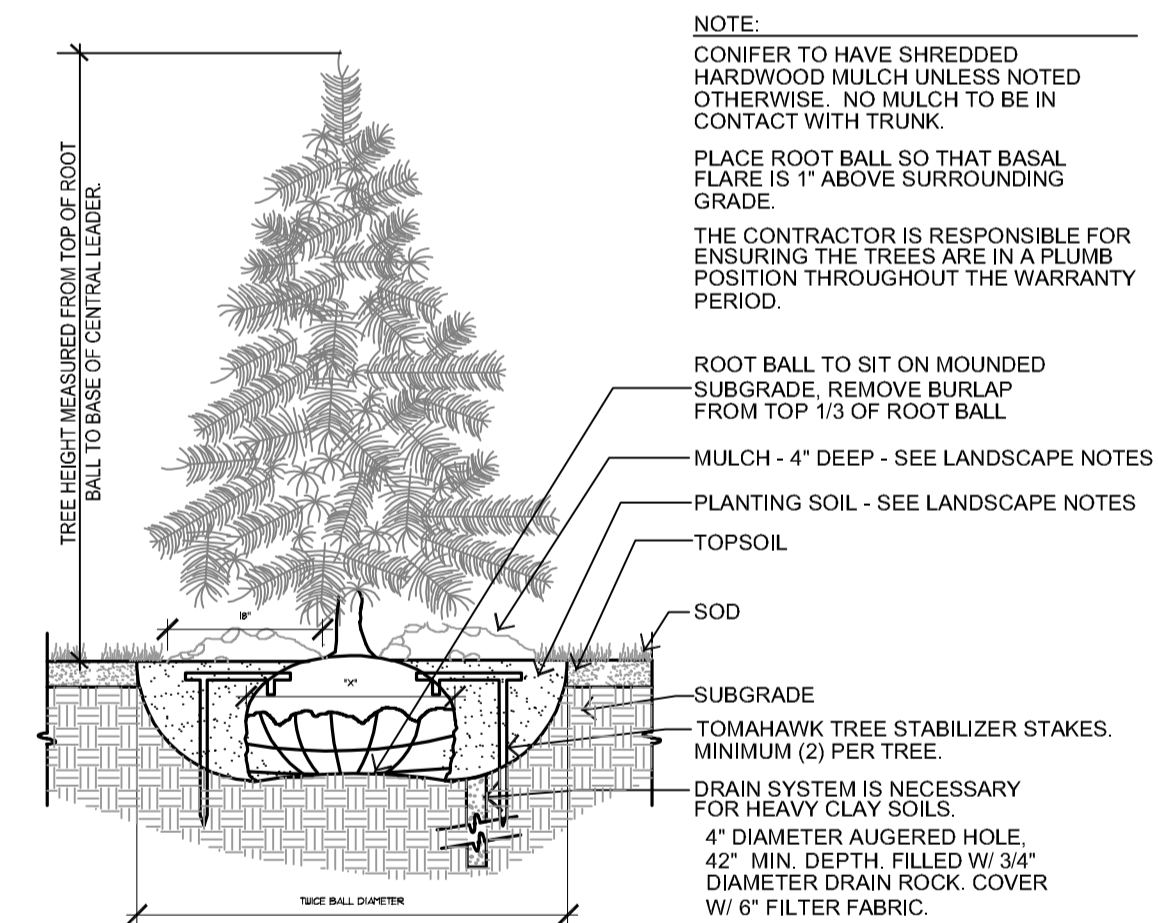

3 CONIFEROUS TREE PLANTING - SECTION
L1.3 NOT TO SCALE

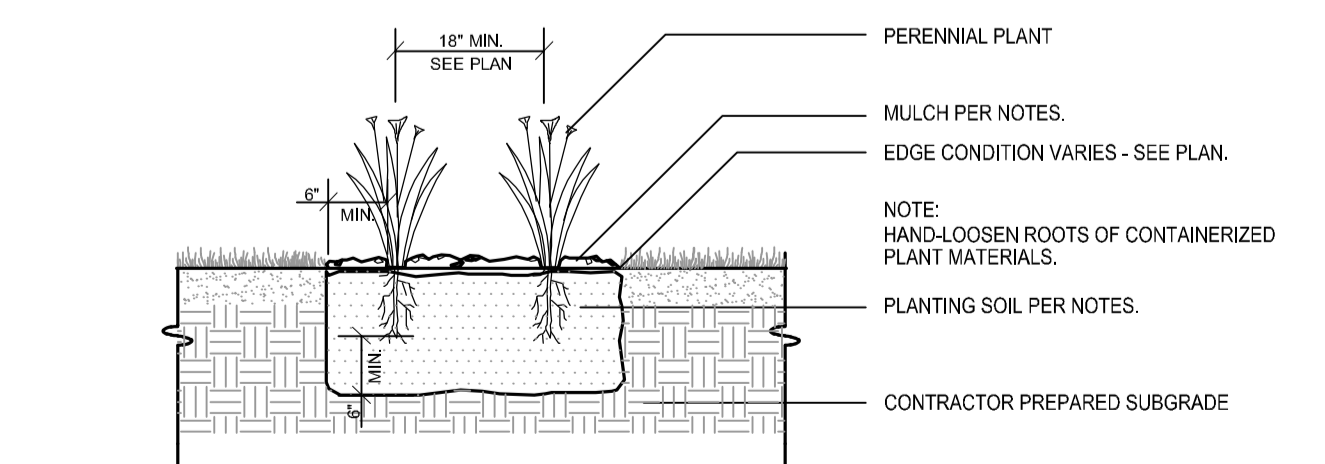

5 TYP. PERENNIAL PLANTING DETAIL
L1.3 NOT TO SCALE

DETAILS, NOTES, AND SCHEDULES:

CALYX DESIGN GROUP
Landscape Architecture - Planning
475 Cleveland Ave. N | Suite 101A | Saint Paul, MN 55104
telephone: 651.788.9018
internet: www.calyxdesigngroup.com

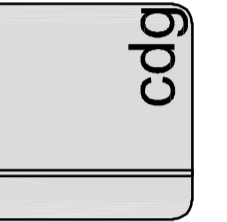

PRELIMINARY

PARKSIDE TOWNHOMES
RAMSEY, MINNESOTA
LANDSCAPE DETAILS
FOR
COR AT RAMSEY LLC
3313 LAKESHORE COURT, CHASKA, MN 55318

DRAWN BY

BH

DATE
01/17/2023

REVISIONS

PROJECT NO.

22-164

L1.3



1 - Warranty Information

Created by: Chris Anderson
On: 01/19/2023 08:38 AM

The required Development Agreement will specify that all plantings are subject to a two (2) year Maintenance Guarantee.

----- 0 Replies -----

2 - Substitutions

Created by: Chris Anderson
On: 01/19/2023 08:40 AM

Any substitutions to either species or size must receive approval from the City prior to installation. Modify Note #16 to include this language.

----- 0 Replies -----

3 - Irrigation Requirement

Created by: Chris Anderson
On: 01/19/2023 08:44 AM

Add an Irrigation Note that specifies that the irrigation system must include a rain sensor AND water efficient technology, such as a smart controller.

----- 0 Replies -----