

PLANT SCHEDULE					
TREES	QTY	COMMON / BOTANICAL NAME	CONT	NATIVE PLANTS	POLLINATOR FRIENDLY
AB2	4	Autumn Blaze Maple / Acer x freemanii 'Jeffred' TM	2.5' Cal. B&B	NATIVE CULTIVAR	
RB	8	River Birch / Betula nigra	2.5' Cal. B&B	NATIVE	N
SH	4	Skyline Thornless Honey Locust / Gleditsia triacanthos inermis 'Skycole' TM	2.5' Cal. B&B	NATIVE CULTIVAR	N
EK	3	Espresso Kentucky Coffeetree / Gymnocladus dioica 'Espresso'	2.5' Cal. B&B	NATIVE CULTIVAR	N
QB	7	Swamp White Oak / Quercus bicolor	2.5' Cal. B&B	NATIVE	Y
BL	6	Boulevard Linden / Tilia americana 'Boulevard'	2.5' Cal. B&B	NATIVE CULTIVAR	Y
SHRUBS	QTY	COMMON / BOTANICAL NAME	SIZE	NATIVE PLANTS	POLLINATOR FRIENDLY
CA3	22	New Jersey Tea / Cleome americanus	#1 CONT	NATIVE	Y
CA2	18	Arctic Fire Dogwood / Cornus sericea 'Arctic Fire'	#5 CONT	NATIVE CULTIVAR	Y
DL	10	Dwarf Bush Honeysuckle / Diervilla lonicera	#5 CONT	NATIVE	Y
HA	29	Annabelle Hydrangea / Hydrangea arborescens 'Annabelle'	#5 CONT	NOT NATIVE	Y
HL2	14	Little Quick Fire Hydrangea / Hydrangea paniculata 'Little Quick Fire'	#5 CONT	NOT NATIVE	Y
HJ2	45	Kalm St. Johnswort / Hypericum kalmianum	#2 CONT	NATIVE	Y
JM2	11	Medora Juniper / Juniperus scopulorum 'Medora'	#5 CONT	NOT NATIVE	N
LDN	55	Little Devil Ninebark / Physocarpus opulifolius 'Donna May' TM	#5 CONT	NATIVE CULTIVAR	Y
ST	9	Birchleaf Spirea / Spirea betulifolia 'Tor'	#5 CONT	NOT NATIVE	Y
SM	7	Dwarf Korean Lilac / Syringa meyeri 'Palbin'	#5 CONT	NOT NATIVE	Y
SM2	2	Miss Kim Lilac / Syringa patula 'Miss Kim'	#5 CONT	NOT NATIVE	Y
TT	27	Taunton's Yew / Taxus x media 'Tauntonii'	#5 CONT	NOT NATIVE	N
TB	9	Mr. Bowling Ball® Arborvitae / Thuja occidentalis 'Bobozam'	#5 CONT		
GRASSES	QTY	COMMON / BOTANICAL NAME	SIZE	NATIVE PLANTS	POLLINATOR FRIENDLY
AB3	70	Blackhawks Big Bluestem / Andropogon gerardii 'Blackhawks'	#1 CONT	NATIVE CULTIVAR	Y
CK	53	Feather Reed Grass / Calamagrostis x acutiflora 'Karl Foerster'	#1 CONT	NOT NATIVE	N
PH	60	Heavy Metal Switch Grass / Panicum virgatum 'Heavy Metal'	#1 CONT	NATIVE CULTIVAR	Y
PERENNIALS	QTY	COMMON / BOTANICAL NAME	SIZE	NATIVE PLANTS	POLLINATOR FRIENDLY
AT2	54	Summer Beauty Globe Lily / Allium tanguticum 'Summer Beauty'	#1 CONT	NOT NATIVE	Y
GC	6	Biokovo Cranesbill / Geranium x cantabrigiense 'Biokovo'	#1 CONT	NOT NATIVE	Y
HA2	62	Daylily / Hemerocallis x 'Chicago Apache'	#1 CONT	NOT NATIVE	Y
HO	15	Olive Bailey Langdon Hosta / Hosta x 'Olive Bailey Langdon'	#1 CONT	NOT NATIVE	Y
NW2	30	Walkers Low Catmint / Nepeta x faassenii 'Walkers Low'	#1 CONT	NOT NATIVE	Y
PL	32	Little Spire Russian Sage / Perovskia atriplicifolia 'Little Spire'	#1 CONT	NOT NATIVE	Y
SC2	34	Cardonna Salvia / Salvia x superba 'Caradonna'	#1 CONT	NOT NATIVE	Y
SA2	49	Showy Stonecrop / Sedum spectabile 'Autumn Fire'	#1 CONT	NOT NATIVE	Y
SD	13	Dazzleberry Stonecrop / Sedum x 'Dazzleberry'	#1 CONT	NOT NATIVE	Y

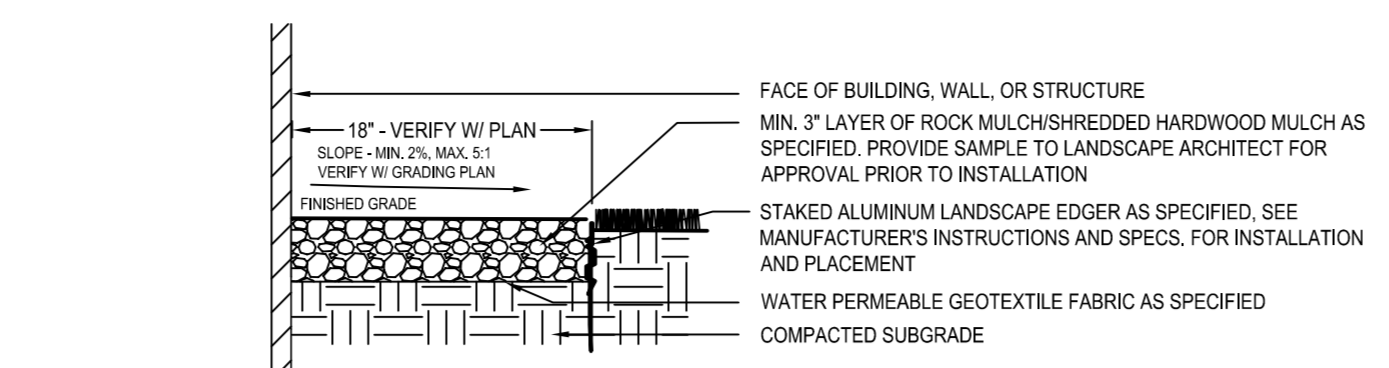

1 AGGREGATE MAINTENANCE STRIP
N T S

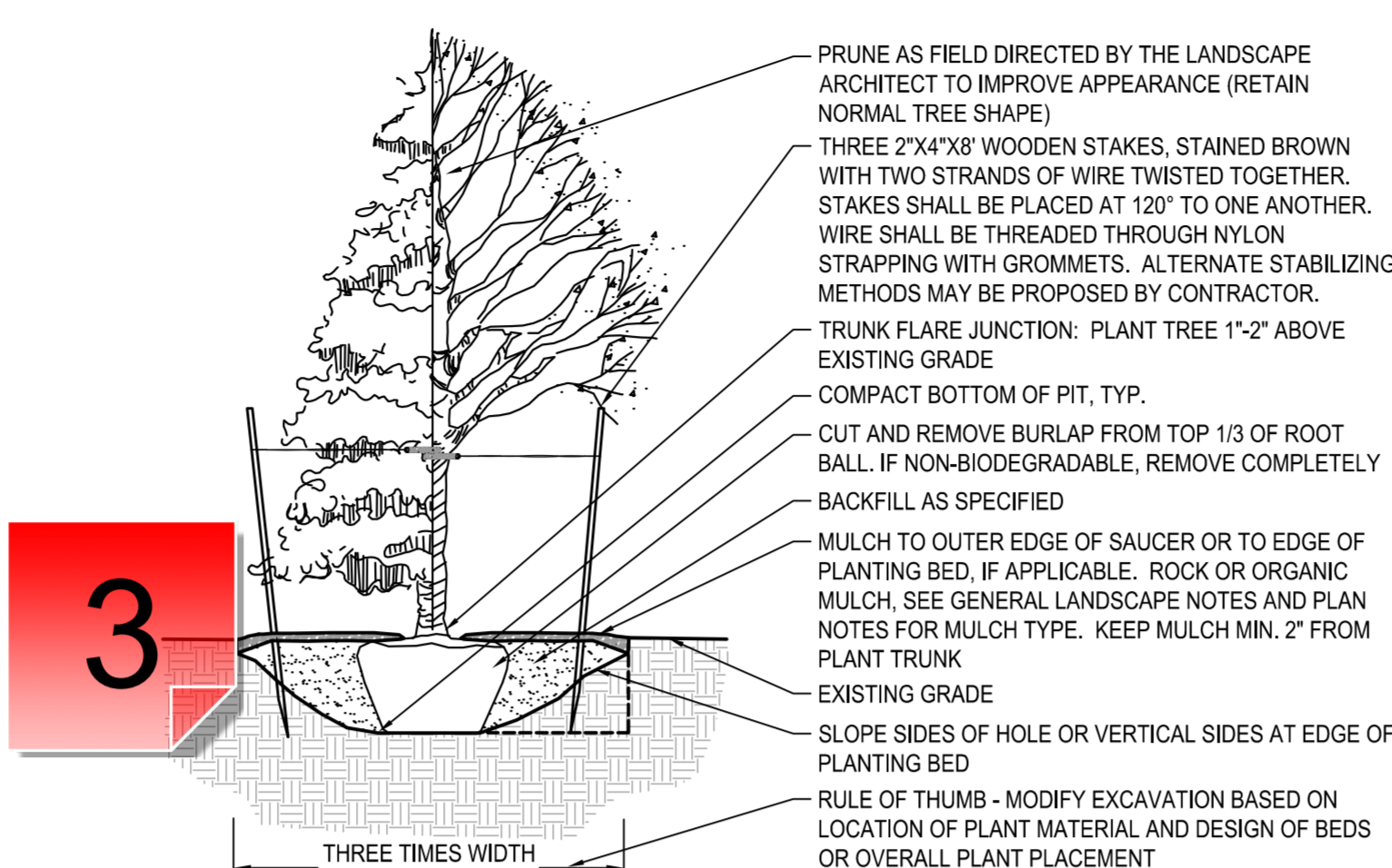

2 DECIDUOUS & CONIFEROUS TREE PLANTING
N T S

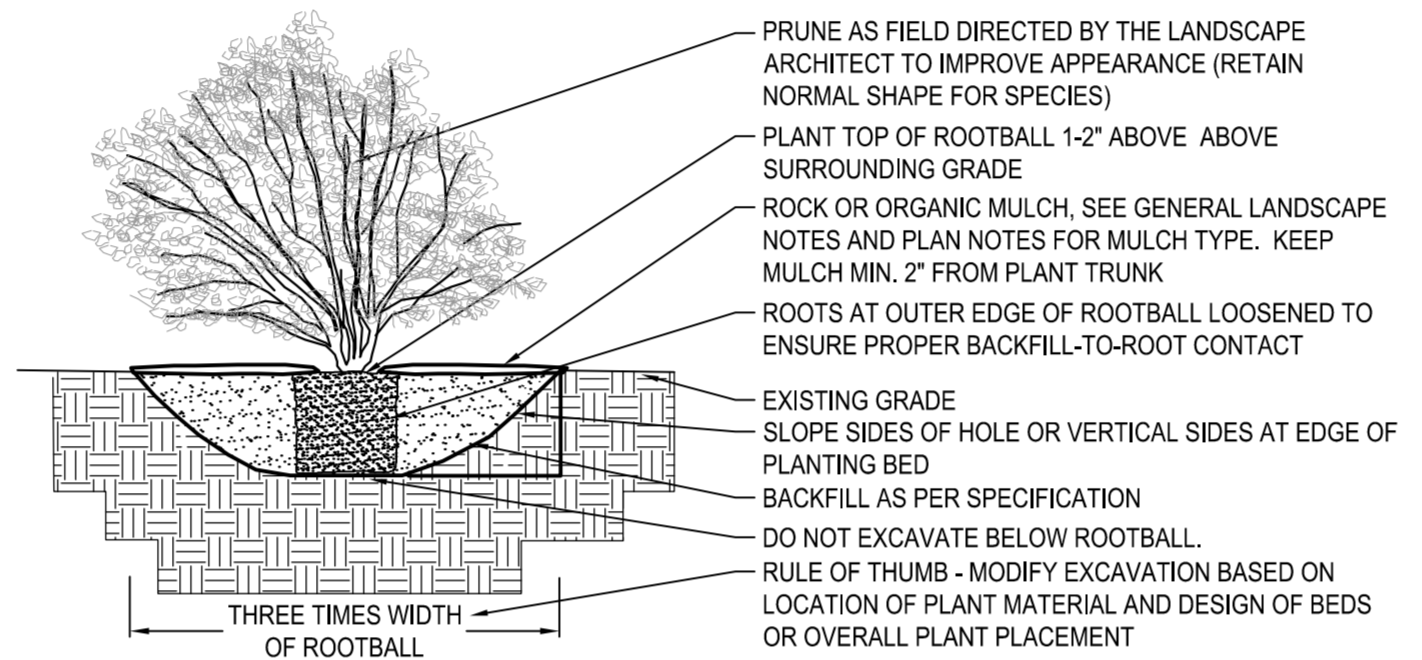

3 DECIDUOUS & CONIFEROUS SHRUB PLANTING
N T S

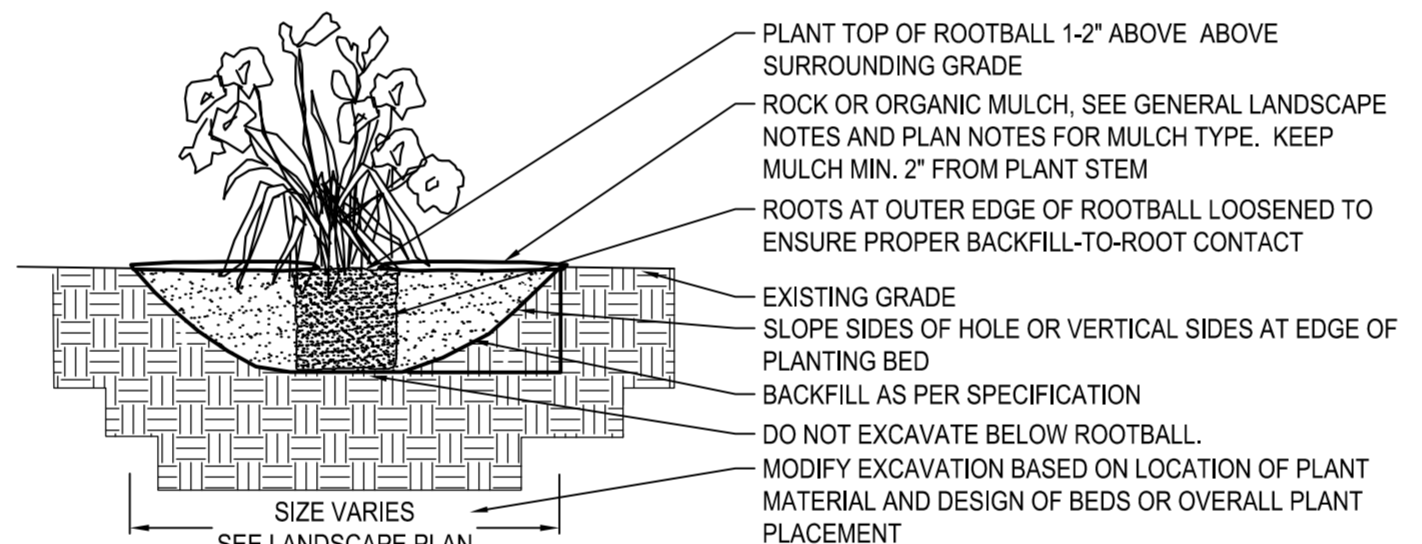

4 PERENNIAL BED PLANTING
N T S

GROUND COVERS	CODE	COMMON / BOTANICAL NAME	SIZE
	PT	Japanese Pachysandra / Pachysandra terminalis	6-Pak 2" Plugs
	RM	1.5\"/>	

IRRIGATION NOTES:

- ENTIRE SITE SHALL BE FULLY IRRIGATED. THE CONTRACTOR SHALL SUBMIT IRRIGATION SHOP DRAWINGS FOR REVIEW AND APPROVAL BY THE LANDSCAPE ARCHITECT PRIOR TO INSTALLATION.
- SEE MECHANICAL AND ELECTRICAL PLANS AND SPECIFICATIONS FOR IRRIGATION WATER, METER, AND POWER CONNECTIONS.
- CONTRACTOR TO VERIFY LOCATION OF ALL UNDERGROUND/ABOVE GROUND FACILITIES PRIOR TO ANY EXCAVATION/INSTALLATION. ANY DAMAGE TO UNDERGROUND/ABOVE GROUND FACILITIES SHALL BE THE RESPONSIBILITY OF THE CONTRACTOR AND COSTS ASSOCIATED WITH CORRECTING DAMAGES SHALL BE BORNE ENTIRELY BY THE CONTRACTOR.
- SERVICE EQUIPMENT AND INSTALLATION SHALL BE PER LOCAL UTILITY COMPANY STANDARDS AND SHALL BE PER NATIONAL AND LOCAL CODES. EXACT LOCATION OF SERVICE EQUIPMENT SHALL BE COORDINATED WITH THE LANDSCAPE ARCHITECT OR EQUIVALENT AT THE JOB SITE.
- CONTRACTOR SHALL COORDINATE WITH LOCAL UTILITY COMPANY FOR THE PROPOSED ELECTRICAL SERVICE AND METERING FACILITIES.
- IRRIGATION WATER LINE CONNECTION SIZE IS 1-1/2\"/>



PRELIMINARY:
NOT FOR
CONSTRUCTION

PROJECT
HOME2 SUITES BY HILTON
SUNWOOD DRIVE NW AND ZEOLITE ST NW, RAMSEY, MN 55303
RAMSEY PROPERTIES, LLC
8445 BUNKER LAKE BLVD NW, RAMSEY, MN 55303

I HEREBY CERTIFY THAT THIS PLAN, SPECIFICATION, OR REPORT WAS PREPARED BY ME OR UNDER MY DIRECT SUPERVISION AND THAT I AM A DULY LICENSED LANDSCAPE ARCHITECT UNDER THE LAWS OF THE STATE OF MINNESOTA.

J. Lockman
JORDAN M. LOCKMAN
DATE 03-10-23 LICENSE NO. 48523

ISSUE/SUBMITTAL SUMMARY
DATE DESCRIPTION
3-10-2023 CITY SUBMITTAL

DRAWN BY: AMJL/FJ REVIEWED BY: DK
PROJECT NUMBER: 23034

REVISION SUMMARY
DATE DESCRIPTION

LANDSCAPE PLAN
NOTES & DETAILS

L1.1



1 - Irrigation Note

Created by: Chris Anderson
On: 03/20/2023 01:56 PM

Add note stating that irrigation system must have a rain sensor and utilize some form of water efficient technology, such as a weather compensating smart controller.

----- 0 Replies -----

2 - Shrub Size

Created by: Chris Anderson
On: 03/20/2023 01:58 PM

Modify table to specify minimum shrub size at planting is 24 inches in height.

----- 0 Replies -----

3 - Tree Planting Detail

Created by: Chris Anderson
On: 03/20/2023 02:01 PM

There are two separate tree planting details, this one, and one included on Sheet L1.0. Only use 1, so there is no conflicting detail. Must specify that root floor to be at finished grade and to cut and remove burlap, twine, and wire basket (if applicable) from top 1/3 of rootball.

----- 0 Replies -----