

DECIDUOUS TREE PLANTING
NTS

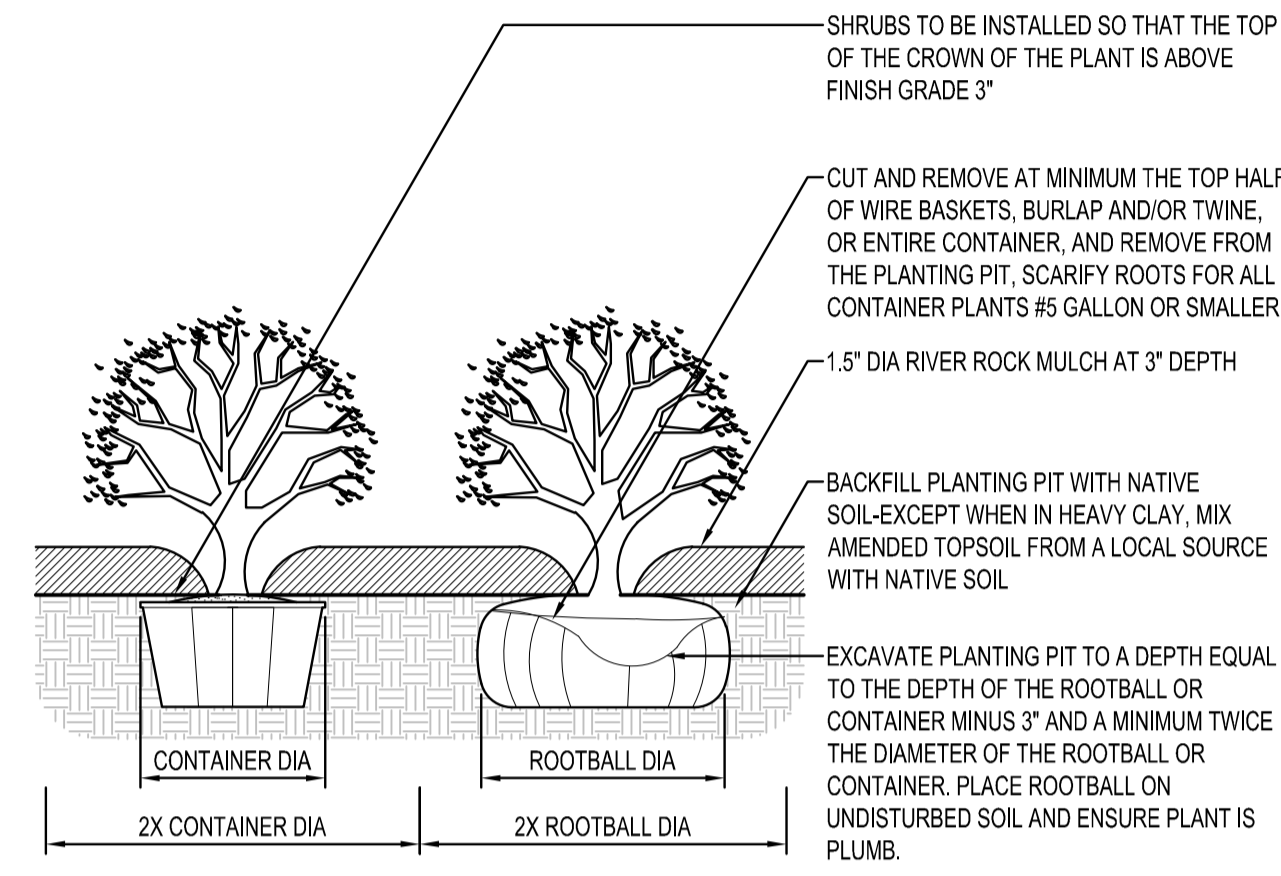

SHRUB PLANTING
NTS

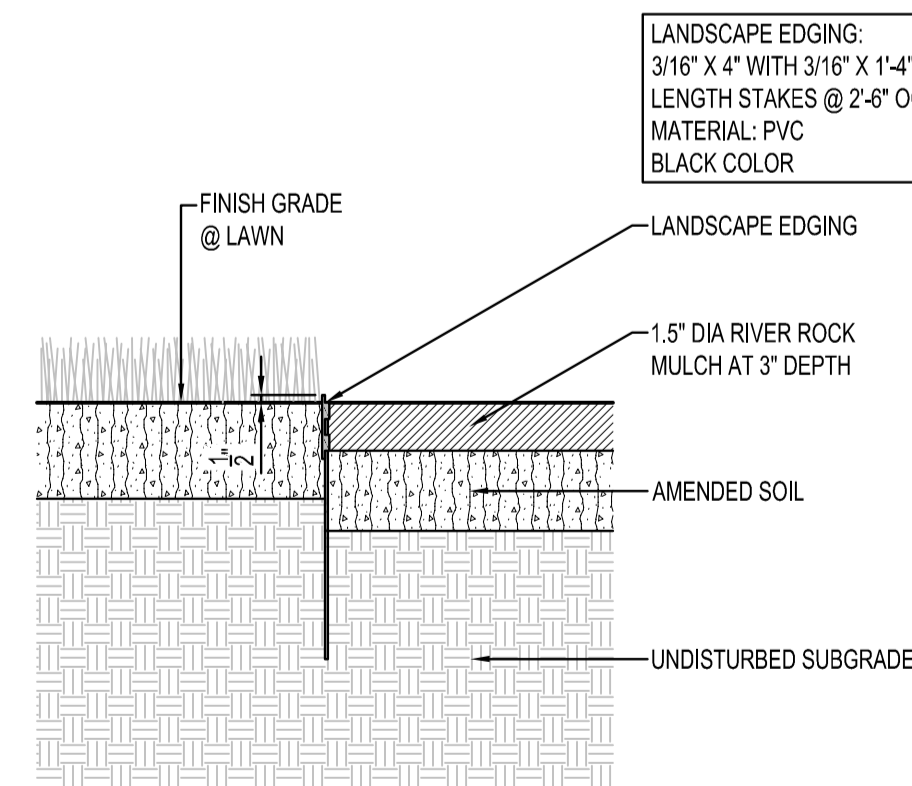

LANDSCAPE EDGING
NTS

PLANTING NOTES

- COORDINATE LOCATION OF ALL UTILITIES (LINES, DUCTS, CONDUITS, SLEEVES, FOOTINGS, ETC.) WITH LOCATIONS OF PROPOSED LANDSCAPE ELEMENTS (FENCE, FOOTINGS, TREE ROOTBALLS, ETC.). CONTRACTOR SHALL REPORT ANY DISCREPANCIES TO OWNER'S REPRESENTATIVE PRIOR TO CONTINUING WORK.
- SAVE AND PROTECT ALL EXISTING TREES NOT NOTED TO BE REMOVED.
- REMOVE ALL CONSTRUCTION DEBRIS AND MATERIALS INJURIOUS TO PLANT GROWTH FROM PLANTING PITS AND BEDS PRIOR TO BACKFILLING WITH PLANTING MIX.
- REFER TO PLANTING DETAILS FOR AMENDED SOIL DEPTH IN PLANTING BEDS AND SURROUNDING TREES.
- FIELD STAKE PLANTINGS ACCORDING TO PLAN. OWNER'S REPRESENTATIVE SHALL APPROVE ALL PLANT LOCATIONS PRIOR TO INSTALLATION. OWNER'S REPRESENTATIVE RESERVES THE RIGHT TO REVISE PLANTING LAYOUT AT TIME OF INSTALLATION.
- ALL PLANT MATERIALS SHALL BE TRUE TO THEIR SCIENTIFIC NAME AND SIZE AS INDICATED IN THE PLANT SCHEDULE.
- IF DISCREPANCIES EXIST BETWEEN THE NUMBER OF PLANTS DRAWN ON THE PLANTING PLAN AND THE NUMBER OF PLANTS IN THE SCHEDULE, THE PLANTING PLAN SHALL GOVERN.
- ANY PROPOSED SUBSTITUTIONS OF PLANT SPECIES SHALL BE MADE WITH PLANTS OF EQUIVALENT OVERALL FORM, HEIGHT, BRANCHING HABIT, FLOWER, LEAF, COLOR, FRUIT AND CULTURE, AND ONLY AFTER WRITTEN APPROVAL OF THE OWNER'S REPRESENTATIVE.
- ALL PLANT MATERIALS MUST CONFORM TO AMERICAN STANDARDS FOR NURSERY STOCK (ANSI Z60.1), LATEST EDITION PUBLISHED BY THE AMERICAN ASSOCIATION OF NURSERYMEN, WASHINGTON D.C. LARGER SIZED PLANT MATERIALS OF THE SPECIES LISTED MAY BE USED IF THE STOCK CONFORMS TO ANSI Z60.1.
- ALL PLANT MATERIAL SHALL BE GUARANTEED BY THE CONTRACTOR TO BE IN A LIVE AND HEALTHY GROWING CONDITION FOR ONE FULL GROWING SEASON (ONE YEAR) AFTER FINAL PROJECT ACCEPTANCE OR SHALL BE REPLACED BY THE CONTRACTOR FREE OF CHARGE WITH THE SAME GRADE AND SPECIES.
- ALL TREES SHALL HAVE A STRONG CENTRAL LEADER. ANY TREES DEEMED NOT TO HAVE A STRONG CENTRAL LEADER SHALL BE REJECTED.
- CONTRACTOR IS RESPONSIBLE FOR ALL DAMAGE DUE TO CONSTRUCTION OPERATIONS. ANY AREAS THAT ARE DISTURBED SHALL BE RESTORED TO ITS ORIGINAL CONDITION AT NO ADDITIONAL COST TO THE OWNER.
- PROVIDE DOUBLE SHREDDED HARDWOOD MULCH (NATURAL COLOR) SURROUNDING ALL PROPOSED TREES (5' Ø) AND WITHIN PLANTING BEDS TO A 3" MINIMUM DEPTH AS SHOWN IN TREE PLANTING DETAIL. DO NOT USE AN UNDERLAYMENT SUCH AS PLASTIC SHEET OR LANDSCAPE FABRIC. APPLY PRE-EMERGENT TO ALL PLANTING BEDS PRIOR TO MULCHING. REFER TO PLANS FOR ADDITIONAL DETAILS. REFER TO STORMWATER DETAILS FOR BASIN CONSTRUCTION AND MULCH APPLICATION.
- MULCHING MATERIAL SHALL BE 1.5" DIA RIVER ROCK MULCH AT 3" DEPTH, WITH NO INDIVIDUAL PIECES LARGER THAN 3". FREE OF GROWTH OR GERMINATION INHIBITING INGREDIENTS, 3" MINIMUM DEPTH. MINIMUM DEPTHS AT LOCATIONS INDICATED ON DRAWINGS.
- CONTRACTOR SHALL PROVIDE SAMPLE OF MULCH TO BE APPROVED BY THE LANDSCAPE ARCHITECT.
- INDICATED QUANTITIES ARE ESTIMATES AND SHALL BE CONFIRMED BY THE CONTRACTOR.
- ADJUST SPACING OF PLANT MATERIALS AROUND ADJACENT UTILITY STRUCTURES.

Issued:	Date:
A CITY SUBMITAL #1	05/12/23
B	
C	
D	
E	
Revisions:	Date:
1	
2	
3	
4	
5	
6	
7	
8	
9	

I HEREBY CERTIFY THAT THIS PLAN, SPECIFICATION OR REPORT WAS PREPARED BY ME OR UNDER MY DIRECT SUPERVISION AND THAT I AM A DULY LICENSED PROFESSIONAL ENGINEER UNDER THE LAWS OF THE STATE OF MINNESOTA.

RYAN J. ANDERSON

Ryan Anderson

DATE 05/12/2023 LIC. NO. 55938

NOTE:
THE CLARITY OF THESE PLANS DEPEND UPON COLOR COPIES. IF THIS TEXT DOES NOT APPEAR IN COLOR, THIS IS NOT AN ORIGINAL PLAN SET AND MAY RESULT IN MISINTERPRETATION.



MANAGING LOCATION:
BLOOMINGTON OFFICE
7900 INTERNATIONAL DRIVE
SUITE 550
MINNEAPOLIS, MN 55425
PHONE: 952.426.0699

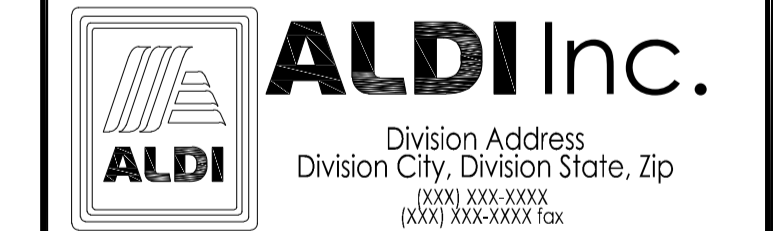

ALDI Inc. Store #: 143
RAMSEY, MN
7992 SUNWOOD DR NW
RAMSEY, MN 55303
ANOKA

Project Name & Location:
LANDSCAPE DETAILS

Drawing Name:	ISG Project No.
Type: V7.0 ER	23-21339
Drawn By: AE	
Designed By: AE	C-520
Reviewed By: MRW	Drawing No.

PRELIMINARY NOT FOR CONSTRUCTION

1 - Pruning Cuts

Created by: Chris Anderson
On: 05/26/2023 09:04 AM

Do not make flush cuts. The branch bark collar and ridge shall remain in tact.

----- 0 Replies -----

2 - Root Flare

Created by: Chris Anderson
On: 05/26/2023 09:06 AM

Root flare shall be flush with finished grade or no more than 2" above finished grade.

----- 0 Replies -----

3 - City Approval Required

Created by: Chris Anderson
On: 05/26/2023 09:08 AM

Any deviations from the approved landscape plan require prior approval of the City.

----- 0 Replies -----

4 - Warranty

Created by: Chris Anderson
On: 05/26/2023 09:09 AM

The Development Agreement will require a 2-year warranty period.

----- 0 Replies -----

5 - Parking Lot Islands

Created by: Chris Anderson
On: 05/26/2023 09:10 AM

Do not use riverrock in the parking lot islands. This must be an organic material such as hardwood mulch.

----- 0 Replies -----

6 - Topsoil

Created by: Chris Anderson
On: 05/26/2023 09:11 AM

Add note to either this sheet or the Landscape Plan stating that 4 inches of topsoil, with no more than 35% sand content is required over all disturbed areas not otherwise improved with impervious surfacing. A topsoil inspection is required prior to installation of landscaping.

----- 0 Replies -----

7 - Irrigation

Created by: Chris Anderson
On: 05/26/2023 09:13 AM

Will an irrigation system be installed? If so, please provide details. Any irrigation system installed shall include a rain sensor and some form of water efficient technology, such as a weather compensating smart controller.

----- 0 Replies -----