

PT	TYPE	DIA	CONDITION	STATUS	REASON FOR REMOVAL
702	WHITE SPRUCE	8"	GOOD	REMAIN	-
703	SIBERIAN ELM	9"	POOR	REMOVE	INVASIVE
704	SIBERIAN ELM	8"	GOOD	REMOVE	INVASIVE
705	SIBERIAN ELM	11"	FAIR	REMOVE	INVASIVE
706	SIBERIAN ELM	15"	GOOD	REMOVE	INVASIVE
707	BOXELDER	16"	GOOD	REMAIN	-
708	SIBERIAN ELM	12"	FAIR	REMOVE	INVASIVE
709	SIBERIAN ELM	9"	GOOD	REMOVE	INVASIVE
710	SIBERIAN ELM	13"	FAIR	REMOVE	INVASIVE
711	SIBERIAN ELM	11"	FAIR	REMOVE	INVASIVE
712	SIBERIAN ELM	8"	FAIR	REMOVE	INVASIVE
713	SIBERIAN ELM	9"	FAIR	REMOVE	INVASIVE
714	SIBERIAN ELM	22"	GOOD	REMOVE	INVASIVE
715	SIBERIAN ELM	26"	GOOD	REMOVE	INVASIVE
716	SIBERIAN ELM	10"	FAIR	REMOVE	INVASIVE
717	EASTERN RED CEDAR	9"	GOOD	REMOVE	EARTHWORK
718	EASTERN RED CEDAR	7"	GOOD	REMOVE	EARTHWORK
719	EASTERN RED CEDAR	7"	GOOD	REMOVE	EARTHWORK
720	SIBERIAN ELM	10"	FAIR	REMOVE	INVASIVE
721	SIBERIAN ELM	13"	FAIR	REMOVE	INVASIVE
722	SIBERIAN ELM	8"	FAIR	REMOVE	INVASIVE
723	EASTERN RED CEDAR	4"	GOOD	REMOVE	EARTHWORK
724	SIBERIAN ELM	8"	FAIR	REMOVE	INVASIVE
725	SIBERIAN ELM	10"	FAIR	REMOVE	INVASIVE
726	SIBERIAN ELM	11"	FAIR	REMOVE	INVASIVE
727	EASTERN RED CEDAR	7"	GOOD	REMOVE	EARTHWORK
728	EASTERN RED CEDAR	11"	GOOD	REMOVE	EARTHWORK
729	SIBERIAN ELM	9"	FAIR	REMOVE	INVASIVE
730	SIBERIAN ELM	15"	POOR	REMOVE	INVASIVE
731	SIBERIAN ELM	10"	FAIR	REMOVE	INVASIVE
732	SIBERIAN ELM	10"	FAIR	REMOVE	INVASIVE
733	SIBERIAN ELM	12"	FAIR	REMOVE	INVASIVE
734	SIBERIAN ELM	10"	FAIR	REMOVE	INVASIVE
735	SIBERIAN ELM	10"	FAIR	REMOVE	INVASIVE
736	SIBERIAN ELM	9"	FAIR	REMOVE	INVASIVE
737	SIBERIAN ELM	12"	FAIR	REMOVE	INVASIVE
738	EASTERN RED CEDAR	12"	GOOD	REMAIN	-
739	SIBERIAN ELM	10"	FAIR	REMOVE	INVASIVE
740	EASTERN RED CEDAR	12"	GOOD	REMAIN	-
741	EASTERN RED CEDAR	4"	GOOD	REMAIN	-
742	EASTERN RED CEDAR	6"	POOR	REMOVE	EARTHWORK
743	SIBERIAN ELM	8"	GOOD	REMOVE	INVASIVE
744	SIBERIAN ELM	14"	GOOD	REMOVE	INVASIVE
745	SIBERIAN ELM	15"	FAIR	REMOVE	INVASIVE
746	SIBERIAN ELM	8"	GOOD	REMOVE	INVASIVE
747	SIBERIAN ELM	8"	FAIR	REMOVE	INVASIVE
748	SIBERIAN ELM	10"	GOOD	REMOVE	INVASIVE
749	SIBERIAN ELM	11"	FAIR	REMOVE	INVASIVE
750	SIBERIAN ELM	10"	FAIR	REMOVE	INVASIVE
751	EASTERN RED CEDAR	15"	GOOD	REMOVE	EARTHWORK
752	EASTERN RED CEDAR	4"	FAIR	REMOVE	EARTHWORK
753	SIBERIAN ELM	11"	GOOD	REMOVE	INVASIVE
754	EASTERN RED CEDAR	5"	GOOD	REMAIN	-
755	EASTERN RED CEDAR	8"	GOOD	REMOVE	EARTHWORK
756	SIBERIAN ELM	11"	FAIR	REMOVE	INVASIVE
757	WHITE ASH	17"	GOOD	REMOVE	EARTHWORK
758	CHERRY BLACK	9"	GOOD	REMOVE	EARTHWORK
759	CHERRY BLACK	10"	GOOD	REMOVE	EARTHWORK
760	ASH WHITE	14"	GOOD	REMOVE	EARTHWORK
761	SILVER MAPLE	12"	GOOD	REMOVE	EARTHWORK
762	WHITE ASH	12"	GOOD	REMOVE	EARTHWORK
763	SIBERIAN ELM	11"	FAIR	REMOVE	INVASIVE
764	SIBERIAN ELM	9"	FAIR	REMOVE	INVASIVE
765	WHITE ASH	13"	GOOD	REMOVE	EARTHWORK
766	AMUR MAPLE	12"	FAIR	REMOVE	INVASIVE
767	AMUR MAPLE	10"	FAIR	REMOVE	INVASIVE
768	AMUR MAPLE	10"	FAIR	REMOVE	INVASIVE
769	AMUR MAPLE	10"	FAIR	REMOVE	INVASIVE
770	AMUR MAPLE	10"	FAIR	REMOVE	INVASIVE
771	EASTERN COTTONWOOD	8"	FAIR	REMOVE	EARTHWORK
772	EASTERN COTTONWOOD	20"	EXCELLENT	REMOVE	EARTHWORK
773	SIBERIAN ELM	8"	POOR	REMOVE	INVASIVE
774	NORTHERN RED OAK	12"	GOOD	REMOVE	EARTHWORK
775	NORTHERN RED OAK	13"	GOOD	REMOVE	EARTHWORK
776	PAPER BIRCH	12"	GOOD	REMOVE	EARTHWORK
777	PAPER BIRCH	10"	GOOD	REMOVE	EARTHWORK
778	PAPER BIRCH	8"	GOOD	REMOVE	EARTHWORK
779	PAPER BIRCH	8"	POOR	REMOVE	EARTHWORK
780	SIBERIAN ELM	8"	FAIR	REMOVE	INVASIVE
781	SIBERIAN ELM	12"	FAIR	REMOVE	INVASIVE
782	SIBERIAN ELM	8"	FAIR	REMOVE	INVASIVE
783	SIBERIAN ELM	8"	FAIR	REMOVE	INVASIVE

TREE REMOVAL INVENTORY:

- TOTAL INCHES EXISTING = 865"
- TOTAL INCHES REMOVED = 808"
- TOTAL INCHES OF INVASIVE SPECIES BEING REMOVED = 500"

REMOVAL LEGEND	
SYMBOL	DESCRIPTION
	REMOVE DECIDUOUS TREE (CLEAR AND GRUB)
	REMOVE CONIFEROUS TREE (CLEAR AND GRUB)

CONTRACTOR SHALL VERIFY EXISTING PAVEMENT SECTION AND NOTIFY ENGINEER OF ANY DISCREPANCIES. PAVEMENT REMOVALS SHALL INCLUDE FULL DEPTH SAWCUT AND SECTION REMOVAL.



NOTE:
THE CLARITY OF THESE PLANS DEPEND UPON COLOR COPIES. IF THIS TEXT DOES NOT APPEAR IN COLOR, THIS IS NOT AN ORIGINAL PLAN SET AND MAY RESULT IN MISINTERPRETATION.

I HEREBY CERTIFY THAT THIS PLAN, SPECIFICATION OR REPORT WAS PREPARED BY ME OR UNDER MY DIRECT SUPERVISION AND THAT I AM A DULY LICENSED PROFESSIONAL ENGINEER UNDER THE LAWS OF THE STATE OF MINNESOTA.
REESE A. SUDELGTE

DATE: 12/15/2022 LIC. NO. 54243

I HEREBY CERTIFY THAT THIS PLAN, SPECIFICATION OR REPORT WAS PREPARED BY ME OR UNDER MY DIRECT SUPERVISION AND THAT I AM A DULY LICENSED ARCHITECT UNDER THE LAWS OF THE STATE OF MINNESOTA.
MITCHELL R. WORKMON

DATE: 12/15/2022 LIC. NO. 53748

THIS DOCUMENT IS THE PROPERTY OF I & S GROUP, INC. AND MAY NOT BE USED, COPIED OR DUPLICATED WITHOUT PRIOR WRITTEN CONSENT.

PROJECT
ANOKA RAMSEY ATHLETIC ASSOCIATION NEW DOME

RAMSEY MINNESOTA

REVISION SCHEDULE		
DATE	DESCRIPTION	BY

PROJECT NO. 22-26051
FILE NAME 26051 C2-EXIST
DRAWN BY AJR
DESIGNED BY AJR
REVIEWED BY RAS
ORIGINAL ISSUE DATE 12/16/2022
CLIENT PROJECT NO. -

TITLE
TREE INVENTORY AND PRESERVATION PLAN

SHEET
C2-11

PRELIMINARY NOT FOR CONSTRUCTION

CITY LANDSCAPE REQUIREMENTS

E-3 EMPLOYMENT DISTRICT LANDSCAPE REQUIREMENTS:

MINIMUM TREE CROWN COVER REQUIREMENTS:
 IMPERVIOUS AREA: 258,688 SF
 PERVIOUS AREA: 302,667 SF
 RATIO OF IMPERVIOUS AREA: 46.08% / 0.4608
 TOTAL AREA: 561,355 SF

MULTIPLY THE IMPERVIOUS AREA/SITE AREA RATIO BY THE SQUARE FOOTAGE OF PERVIOUS AREA: 0.4608 X 302,667 = 139,468 REQUIRED / 139,468 PROPOSED
 NOTE: SEE SHEET C5-20 FOR DETAILS

THE FOLLOWING FORMULA SHALL BE UTILIZED TO DETERMINE THE AVERAGE CANOPY COVER FOR ACCEPTABLE SPECIES:
 $[(\text{MINIMUM} + \text{MAXIMUM SPREAD}) \times 4] \times \pi \times (0.65 \text{ FOR PREFERRED SPECIES}) = 114,806$

ROAD FRONTAGE REQUIREMENTS:
 FOR EVERY 35 FEET OF PUBLIC ROAD FRONTAGE, ONE OVERSTORY TREE SHALL BE PLANTED ADJACENT TO THE ROAD RIGHT-OF-WAY ON PRIVATE PROPERTY. THESE PLANTING ARE CREDITED TOWARD THE MINIMUM PLANTING REQUIREMENTS.
 • 522 LF OF ROAD FRONTAGE / 35 LF = 15 TREES REQUIRED / 15 TREES PROPOSED

PARKING LOT REQUIREMENTS:
 1 TREE PER EVERY TEN PARKING SPACES.
 • 153 PARKING SPACES / 10 = 15 TREES REQUIRED / 15 TREES PROVIDED

EVERY OVERSTORY TREE PLANTED SHALL BE PROVIDED WITH A PLANTING AREA PF AT LEAST 162 SF.

BUFFERYARD REQUIREMENTS:
 E-3 BUFFERYARD WIDTH: 35 FEET
 % INCREASE IN PLANTINGS: 20%

ACCEPTABLE GROUND COVER MATERIAL INCLUDES SOD, MULCH AND OTHER NATURAL GROUND COVER. USE OF LANDSCAPE ROCK AND PLASTIC UNDERLAYMENT IS PROHIBITED.

ALL AREAS DISTURBED DURING CONSTRUCTION AND NOT OTHERWISE IMPROVED WITH IMPERVIOUS SURFACING SHALL RECEIVE A MINIMUM OF 4" OF TOPSOIL WITH NO MORE THAN 3% SAND CONTENT. TOPSOIL INSPECTION IS REQUIRED PRIOR TO INSTALLATION OF SOD/GROUND COVER.

PLANT SCHEDULE

EVERGREEN TREES	QTY	BOTANICAL / COMMON NAME	SIZE	ROOT
LL	3	LARIX LARICINA TAMARACK	6' HT MIN	B & B
PB	2	PICEA GLAUCA DENSATA BLACK HILLS SPRUCE	6' HT MIN	B & B
PS	14	PINUS STROBUS WHITE PINE	6' HT MIN	B & B
OVERSTORY TREES	QTY	BOTANICAL / COMMON NAME	SIZE	ROOT
BA	6	BETULA ALLEGHANIENSIS YELLOW BIRCH	2.5' CAL	B & B
CO	14	CELTIS OCCIDENTALIS COMMON HACKBERRY	2.5' CAL	B & B
JC	9	JUGLANS CINEREA BUTTERNUT	2.5' CAL	B & B
QA	10	QUERCUS ALBA WHITE OAK	2.5' CAL	CONT
QM	3	QUERCUS MACROCARPA BURR OAK	2.5' CAL	B & B
SD	5	SORBUS DECORA SHOWY MOUNTAIN ASH	2.5' CAL	B & B
DECIDUOUS SHRUBS	QTY	BOTANICAL / COMMON NAME	SIZE	ROOT
AR	25	AMELANCHIER ALNIFOLIA 'REGENT' REGENT SERVICEBERRY	2' HT MIN	CONT
AS	16	AMELANCHIER SANGUINEA ROUNDLEAF SERVICEBERRY	2' HT MIN	CONT
AF	109	AMORPHA FRUTICOSA FALSE INDIGO	2' HT MIN	CONT
AM	7	ARONIA MELANOCARPA BLACK CHOKEBERRY	2' HT MIN	CONT
SA	7	SHEPHERDIA ARGENTEA SILVER BUFFALO BERRY	2' HT MIN	CONT
SC	12	SHEPHERDIA CANADENSIS RUSSETT BUFFALO BERRY	2' HT MIN	CONT
VR	11	VIBURNUM RAPINESOLIANUM DOWNY ARROWWOOD	2' HT MIN	CONT
VA	13	VIBURNUM TRILOBUM AMERICAN CRANBERRYBUSH	2' HT MIN	CONT

MULCH	QTY	BOTANICAL / COMMON NAME
	9,595 SF	DOUBLE SHREDDED WOOD MULCH (NATURAL COLOR)
SEED MIX	QTY	DESCRIPTION
	25,498 SF	EAST INFILTRATION BASIN SEED MIX
	21,393 SF	WEST INFILTRATION BASIN SEED MIX
SOD	QTY	DESCRIPTION
	185,113 SF	MNDOT SOD 25-131 (TURF)
EDGER	QTY	DESCRIPTION
	40 LF	POLYVINYL EDGER (BLACK COLOR)

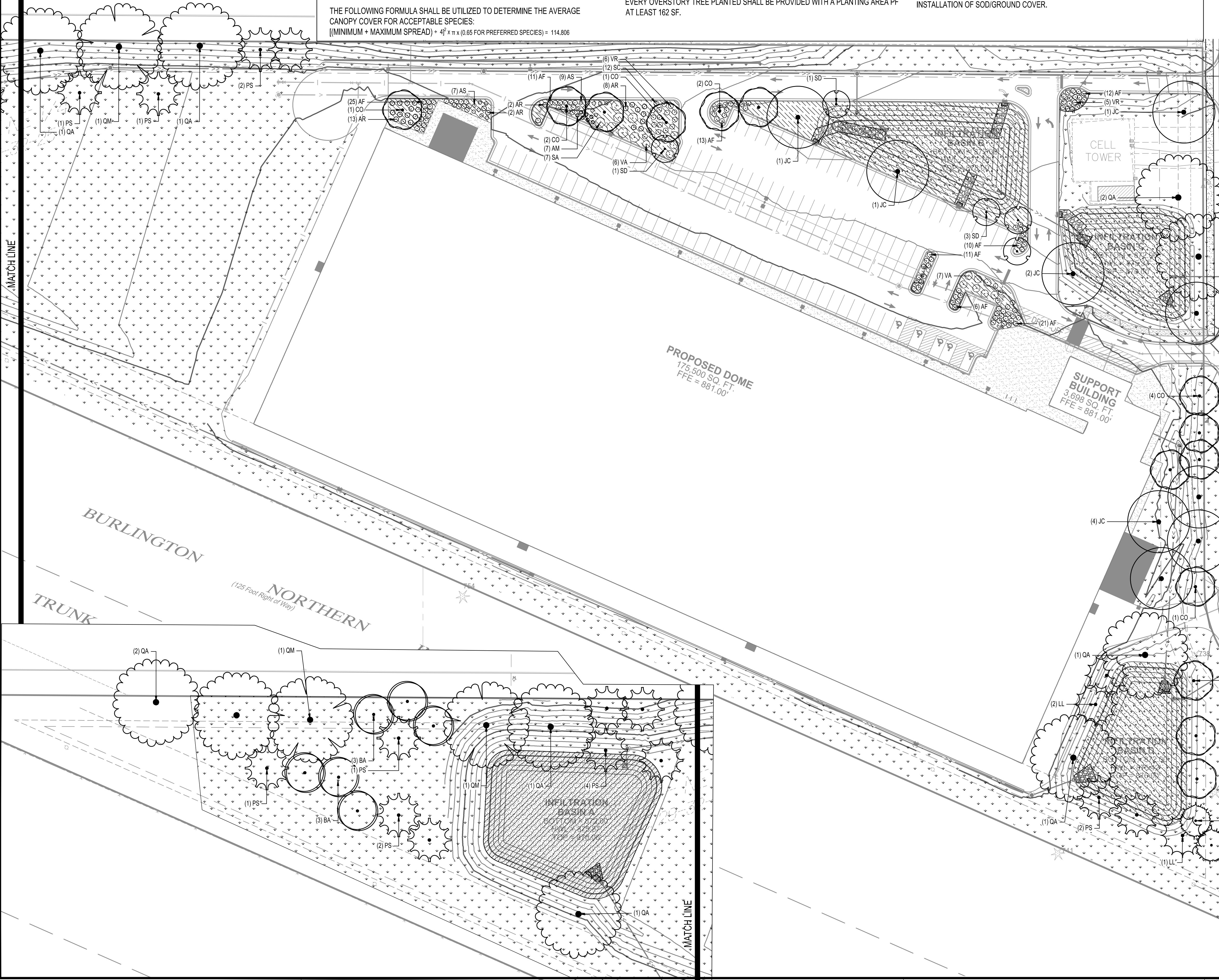

NOTE:
 THE CLARITY OF THESE PLANS DEPEND UPON COLOR COPIES. IF THIS TEXT DOES NOT APPEAR IN COLOR, THIS IS NOT AN ORIGINAL PLAN SET AND MAY RESULT IN MISINTERPRETATION.

I HEREBY CERTIFY THAT THIS PLAN, SPECIFICATION OR REPORT WAS PREPARED BY ME OR UNDER MY DIRECT SUPERVISION AND THAT I AM A DULY LICENSED PROFESSIONAL ENGINEER UNDER THE LAWS OF THE STATE OF MINNESOTA.
 REESE A. SUDTELGTE

DATE: 12/15/2022 LIC. NO. 54243

I HEREBY CERTIFY THAT THIS PLAN, SPECIFICATION OR REPORT WAS PREPARED BY ME OR UNDER MY DIRECT SUPERVISION AND THAT I AM A DULY LICENSED ARCHITECT UNDER THE LAWS OF THE STATE OF MINNESOTA.
 MITCHELL R. WORKMON

DATE: 12/15/2022 LIC. NO. 53748

THIS DOCUMENT IS THE PROPERTY OF I & S GROUP, INC. AND MAY NOT BE USED, COPIED OR DUPLICATED WITHOUT PRIOR WRITTEN CONSENT.

PROJECT
ANOKA RAMSEY ATHLETIC ASSOCIATION NEW DOME

RAMSEY MINNESOTA

REVISION SCHEDULE		
DATE	DESCRIPTION	BY

PROJECT NO.	22-26051
FILE NAME	26051 CS-LAND
DRAWN BY	AJR
DESIGNED BY	AJR
REVIEWED BY	RAS
ORIGINAL ISSUE DATE	12/16/2022
CLIENT PROJECT NO.	-

TITLE
PLANTING AND RESTORATION PLAN

SHEET
C5-10

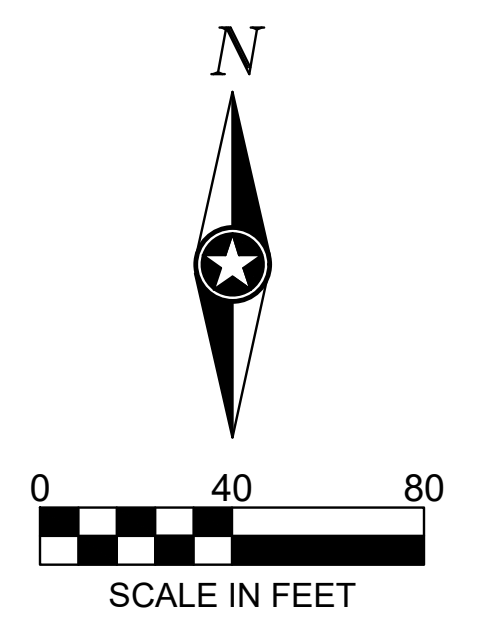

DATE: 11/16/2023 7:04 PM

PRELIMINARY NOT FOR CONSTRUCTION

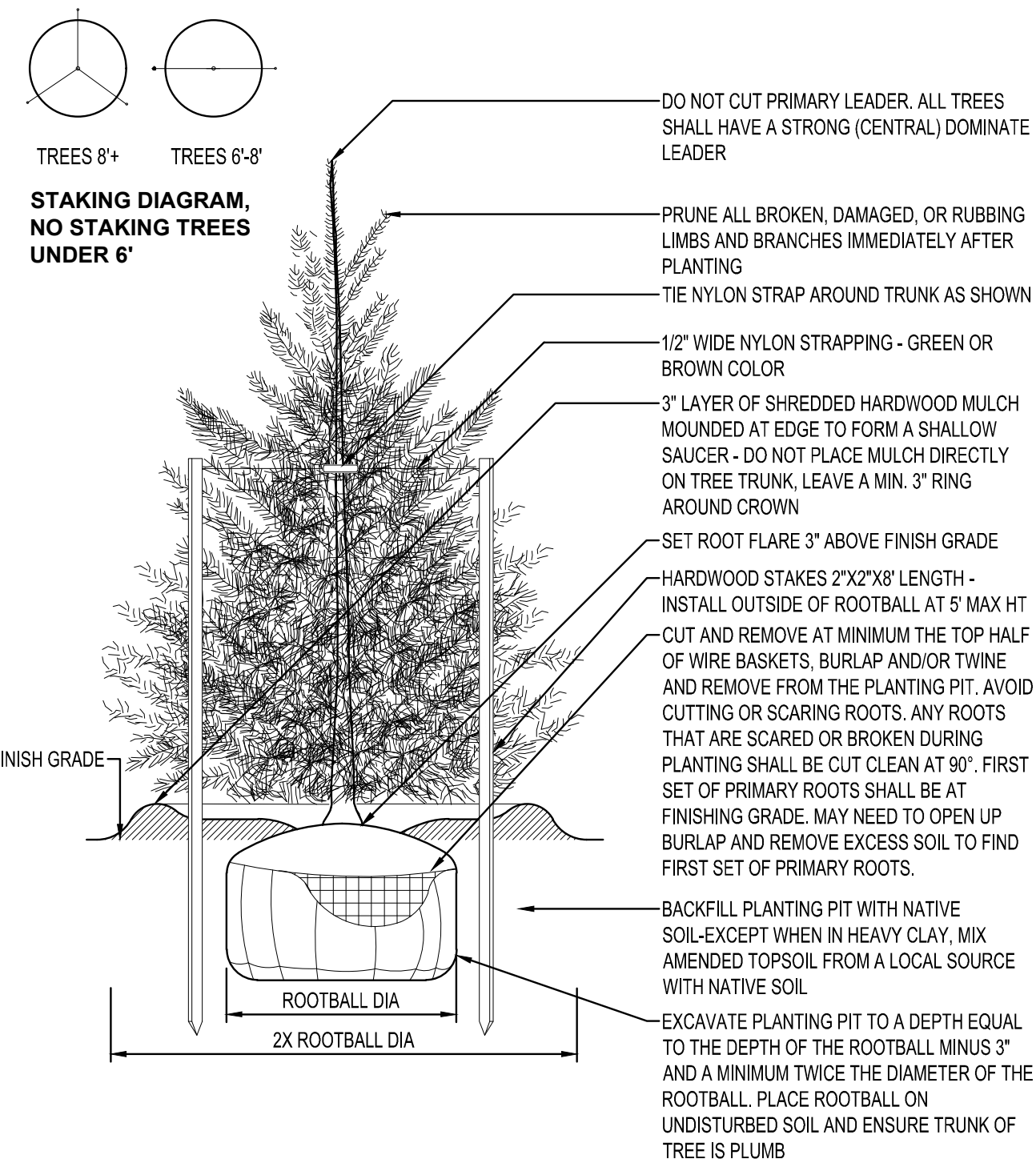

EVERGREEN TREE PLANTING
NTS

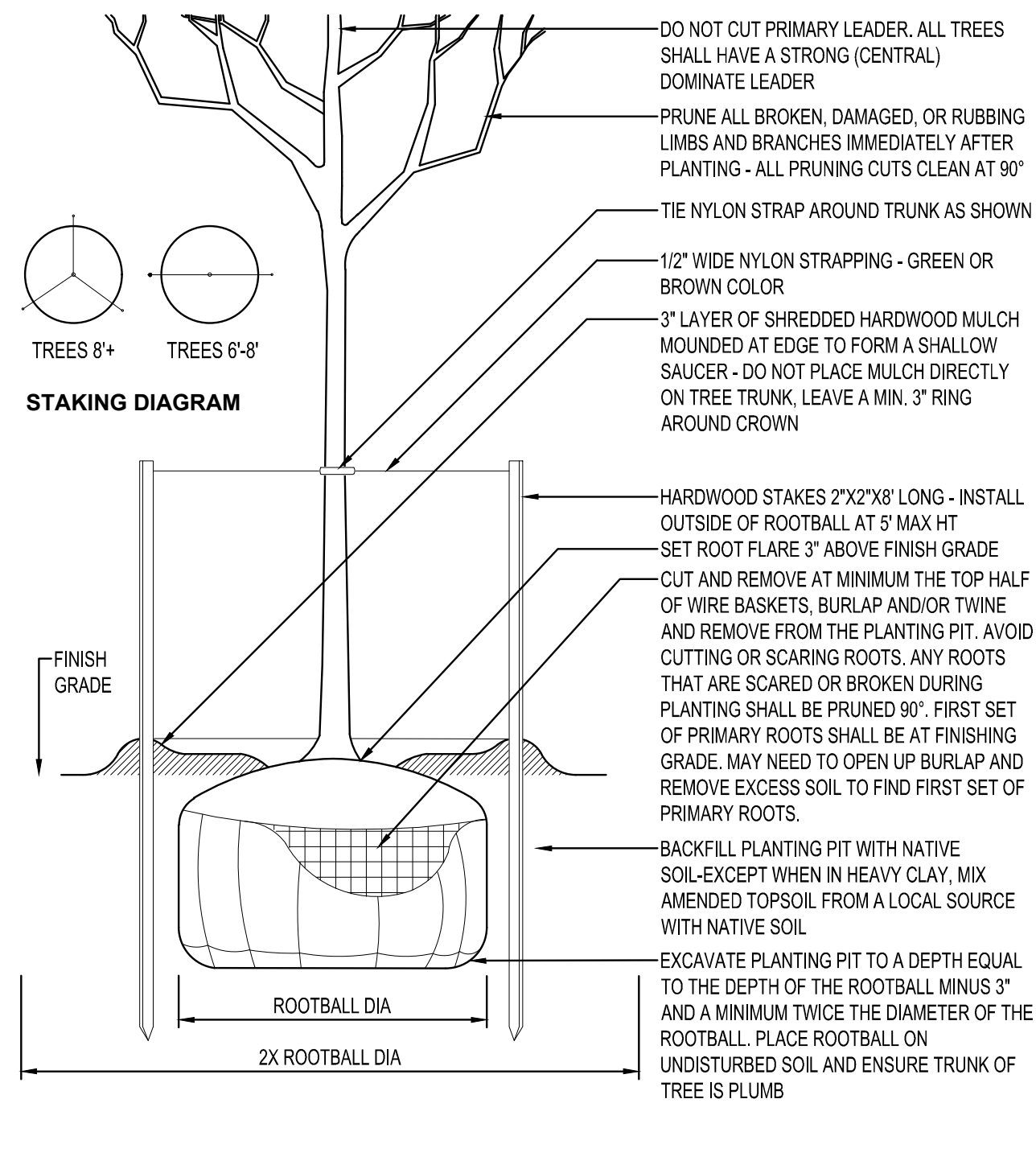

DECIDUOUS TREE PLANTING
NTS

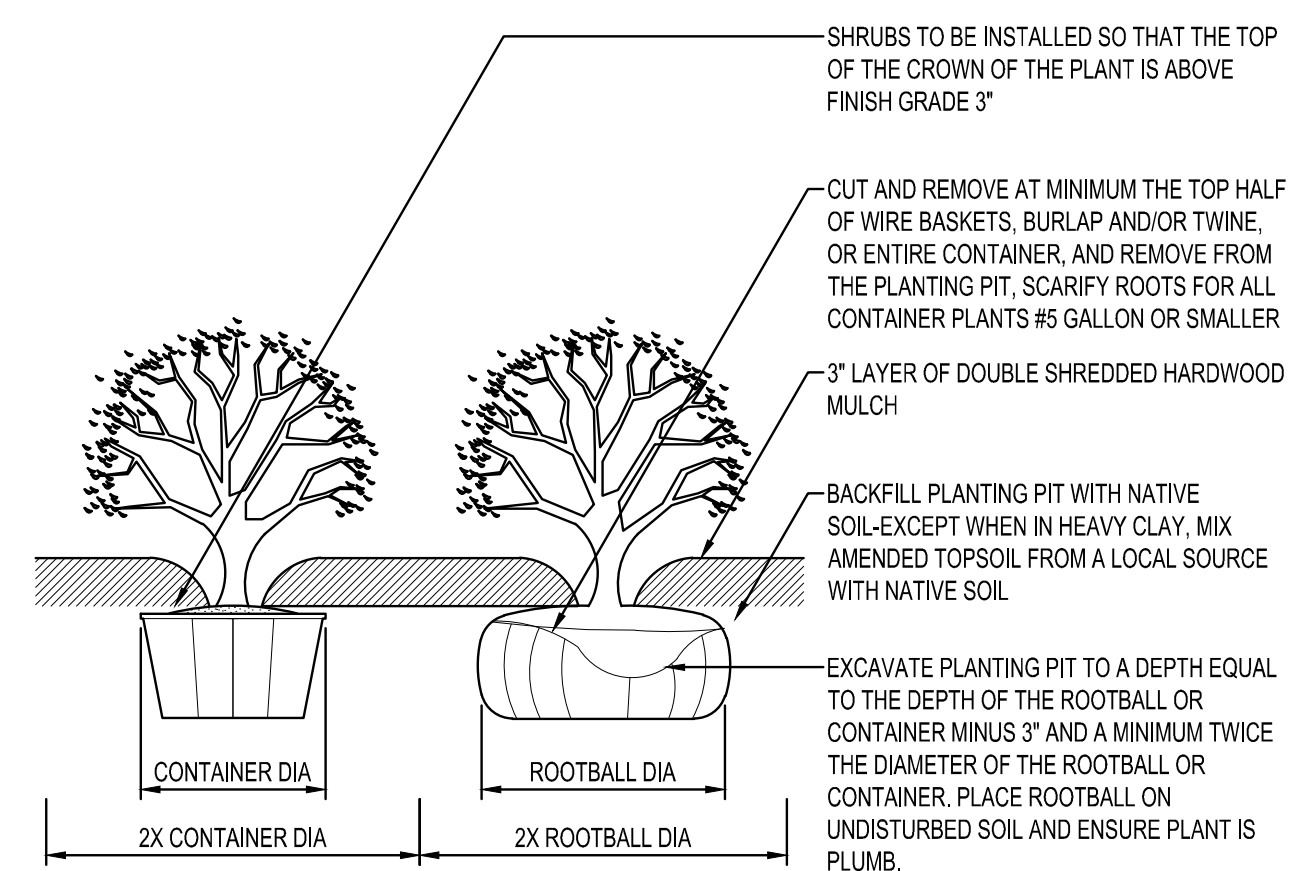

SHRUB PLANTING
NTS

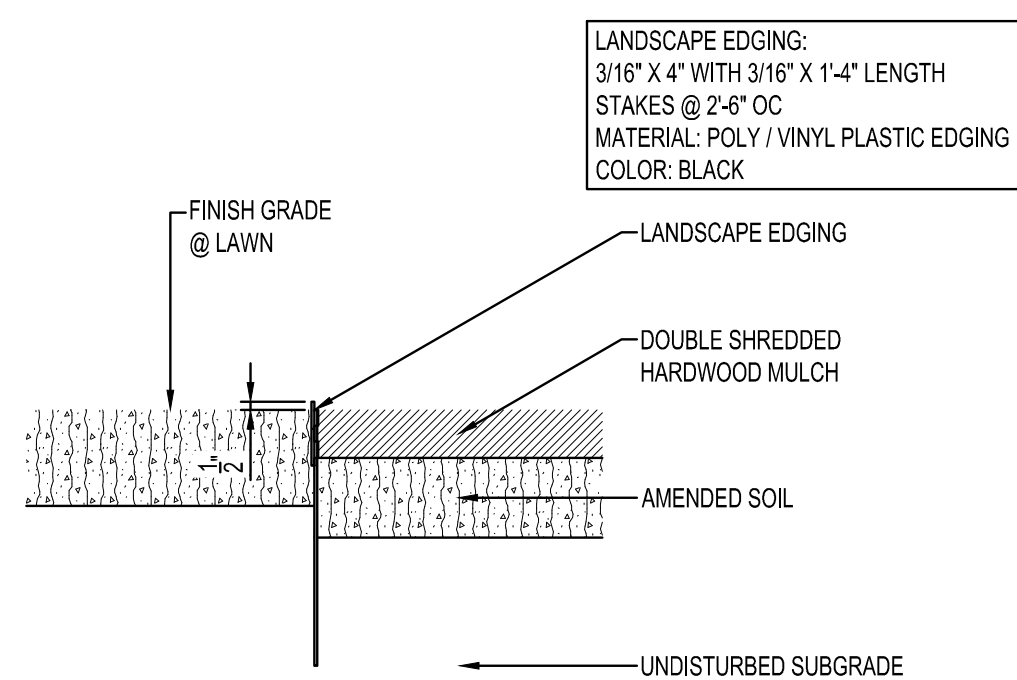

LANDSCAPE EDGING
NTS

PLANTING NOTES

- COORDINATE LOCATION OF ALL UTILITIES (LINES, DUCTS, CONDUITS, SLEEVES, FOOTINGS, ETC.) WITH LOCATIONS OF PROPOSED LANDSCAPE ELEMENTS (FENCE, FOOTINGS, TREE ROOTBALLS, ETC.). CONTRACTOR SHALL REPORT ANY DISCREPANCIES TO OWNER'S REPRESENTATIVE PRIOR TO CONTINUING WORK.
- SAVE AND PROTECT ALL EXISTING TREES NOT NOTED TO BE REMOVED.
- REMOVE ALL CONSTRUCTION DEBRIS AND MATERIALS INJURIOUS TO PLANT GROWTH FROM PLANTING PITS AND BEDS PRIOR TO BACKFILLING WITH PLANTING MIX.
- REFER TO PLANTING DETAILS FOR AMENDED SOIL DEPTH IN PLANTING BEDS AND SURROUNDING TREES.
- FIELD STAKE PLANTINGS ACCORDING TO PLAN. OWNER'S REPRESENTATIVE SHALL APPROVE ALL PLANT LOCATIONS PRIOR TO INSTALLATION. OWNER'S REPRESENTATIVE RESERVES THE RIGHT TO REVISE PLANTING LAYOUT AT TIME OF INSTALLATION.
- ALL PLANT MATERIALS SHALL BE TRUE TO THEIR SCIENTIFIC NAME AND SIZE AS INDICATED IN THE PLANT SCHEDULE.
- IF DISCREPANCIES EXIST BETWEEN THE NUMBER OF PLANTS DRAWN ON THE PLANTING PLAN AND THE NUMBER OF PLANTS IN THE SCHEDULE, THE PLANTING PLAN SHALL GOVERN.
- ANY PLANT SUBSTITUTIONS REQUIRE PRIOR APPROVAL BY THE CITY. ANY PROPOSED SUBSTITUTIONS OF PLANT SPECIES SHALL BE MADE WITH PLANTS OF EQUIVALENT OVERALL FORM, HEIGHT, BRANCHING HABIT, FLOWER, LEAF, COLOR, FRUIT AND CULTURE, AND ONLY AFTER WRITTEN APPROVAL OF THE OWNER'S REPRESENTATIVE.
- ALL PLANT MATERIALS MUST CONFORM TO AMERICAN STANDARDS FOR NURSERY STOCK (ANSI Z60.1). LATEST EDITION PUBLISHED BY THE AMERICAN ASSOCIATION OF NURSERYMEN, WASHINGTON D.C. LARGER SIZED PLANT MATERIALS OF THE SPECIES LISTED MAY BE USED IF THE STOCK CONFORMS TO ANSI Z60.1.
- ALL PLANT MATERIAL SHALL BE GUARANTEED BY THE CONTRACTOR TO BE IN A LIVE AND HEALTHY GROWING CONDITION FOR ONE FULL GROWING SEASON (ONE YEAR) AFTER FINAL PROJECT ACCEPTANCE OR SHALL BE REPLACED BY THE CONTRACTOR FREE OF CHARGE WITH THE SAME GRADE AND SPECIES.
- ALL TREES SHALL HAVE A STRONG CENTRAL LEADER. ANY TREES DEEMED NOT TO HAVE A STRONG CENTRAL LEADER SHALL BE REJECTED.
- CONTRACTOR IS RESPONSIBLE FOR ALL DAMAGE DUE TO CONSTRUCTION OPERATIONS. ANY AREAS THAT ARE DISTURBED SHALL BE RESTORED TO ITS ORIGINAL CONDITION AT NO ADDITIONAL COST TO THE OWNER.
- PROVIDE DOUBLE SHREDDED HARDWOOD MULCH SURROUNDING ALL PROPOSED TREES (5' Ø) AND WITHIN PLANTING BEDS TO A 3" MINIMUM DEPTH AS SHOWN IN TREE PLANTING DETAIL. DO NOT USE AN UNDERLAYMENT SUCH AS PLASTIC SHEET OR LANDSCAPE FABRIC. APPLY PRE-EMERGENT TO ALL PLANTING BEDS PRIOR TO MULCHING. REFER TO PLANS FOR ADDITIONAL DETAILS. REFER TO STORMWATER DETAILS FOR BASIN CONSTRUCTION AND MULCH APPLICATION.
- MULCHING MATERIAL SHALL BE DOUBLE SHREDDED HARDWOOD MULCH, WITH NO INDIVIDUAL PIECES LARGER THAN 3". FREE OF GROWTH OR GERMINATION INHIBITING INGREDIENTS. 3" MINIMUM DEPTH. MINIMUM DEPTHS AT LOCATIONS INDICATED ON DRAWINGS.
- CONTRACTOR SHALL PROVIDE SAMPLE OF MULCH TO BE APPROVED BY THE LANDSCAPE ARCHITECT.
- INDICATED QUANTITIES ARE ESTIMATES AND SHALL BE CONFIRMED BY THE CONTRACTOR.
- ADJUST SPACING OF PLANT MATERIALS AROUND ADJACENT UTILITY STRUCTURES.
- ANY CLEARING OF OAK STANDS SHALL BE PERFORMED PRIOR TO APRIL 15TH OR AFTER JULY 15TH EACH SEASON.
- ALL PLANT MATERIAL SHALL HAVE A 2-YEAR MAINTENANCE WARRANTY FROM DATE OF CITY APPROVAL OF INSTALLED LANDSCAPING.
- ALL AREAS DISTURBED DURING CONSTRUCTION AND NOT OTHERWISE IMPROVED WITH IMPERVIOUS SURFACING SHALL RECEIVE A MINIMUM OF 4" OF TOPSOIL WITH NO MORE THAN 35% SAND CONTENT. TOPSOIL INSPECTION IS REQUIRED PRIOR TO INSTALLATION OF SODD/GROUND COVER.

PROPOSED PLANT MATERIAL CROWN COVER PER RAMSEY TREE BOOK

- EVERGREEN TREE CROWN COVER:**
- AMERICAN LARCH 718 SF (3 TREES) = 2,154 SF OF CROWN COVER
 - BLACK HILLS SPRUCE 386 (2 TREES) = 772 SF OF CROWN COVER
 - WHITE PINE 1,995 (14 TREES) = 27,930 SF
- DECIDUOUS TREE CROWN COVER:**
- YELLOW BIRCH 992 SF (6 TREES) = 5,952 SF
 - COMMON HACKBERRY 992 SF (14 TREES) = 13,888 SF
 - BUTTERNUT 1,995 (9 TREES) = 17,955 SF
 - WHITE OAK 3,910 (10 TREES) = 39,100 SF
 - BURR OAK 3,910 (3 TREES) = 11,730 SF
 - SHOWY MOUNTAIN ASH 386 (5 TREES) = 1,930 SF

- SHRUB CROWN COVER:**
- REGENT SERVICEBERRY 18 (25 SHRUBS) = 450 SF
 - ROUNDLEAF SERVICEBERRY 10 (16 SHRUBS) = 160 SF
 - FALSE INDIGO 131 (109 SHRUBS) = 14,279 SF
 - BLACK CHOKECHERRY 10 SF (7 SHRUBS) = 70 SF
 - SILVER BUFFALOBERRY 93 SF (7 SHRUBS) = 651 SF
 - RUSSET BUFFALOBERRY 41 SF (12 SHRUBS) = 492 SF
 - DOWNY ARROWWOOD 41 SF (11 SHRUBS) = 451 SF
 - AMERICAN CRANBERRYBUSH 51 SF (13 SHRUBS) = 663 SF

- EXISTING EVERGREEN TREE CROWN COVER:**
- WHITE SPRUCE 460 SF (1 TREE) = 460 SF
 - EASTERN RED CEDAR 77 SF (2 TREES) = 514 SF

TOTAL CROWN COVER = 139,601 SF

WEST INFILTRATION BASIN CUSTOM SEED MIX				
SCIENTIFIC NAME	COMMON NAME	RATE (PLS OZ / ACRE)	RATE (SEEDS / SQ.FT)	% MIX BY WEIGHT
<i>Desmodium canadense</i>	Showy Tick Trefol	2	0.3	0.41
<i>Echinacea purpurea</i>	Purple Coneflower	8	1.2	1.65
<i>Helenium autumnale</i>	Sneezeweed	2	6.0	0.41
<i>Monarda fistulosa</i>	Wild Bergamot	2	3.2	0.41
<i>Oenothera biennis</i>	Common Evening Primrose	1	0.2	0.21
<i>Pycnanthemum virginianum</i>	Mountain Mint	0.5	2.5	0.10
<i>Symphoricarum laeve</i>	Smooth Blue Aster	2	2.5	0.41
<i>Symphoricarum lanceolatum</i>	Panicled Aster	1	3.6	0.21
<i>Rudbeckia hirta</i>	Black-eyed Susan	10	21.1	2.06
<i>Chamaecrista fasciculata</i>	Partridge Pea	16	1.0	3.29
<i>Verbena hastata</i>	Blue Vervain	4	8.5	0.82
<i>Asclepias incarnata</i>	Rose Milkweed	6	0.7	1.23
<i>Symphoricarum novae-angliae</i>	New England Aster	1	1.5	0.21
<i>Bidens polyplepis</i>	Bearded Beggarticks	1	0.2	0.21
<i>Rudbeckia laciniata</i>	Wild Golden Glow	1	0.2	0.21
<i>Helianthus maximiliani</i>	Maximilian's Sunflower	1	0.3	0.21
<i>Amoglossum atriplicifolium</i>	Pale Indian Plantain	1	0.1	0.21
TOTAL FORBS		59.5	53.2	12.24
<i>Andropogon gerardii</i>	Big Bluestem	32	7.3	6.58
<i>Beckmannia syzigachne</i>	American Slough Grass	16	18.4	3.29
<i>Calamagrostis canadensis</i>	Blue Joint Grass	0.5	3.2	0.10
<i>Bromus ciliatus</i>	Fringed Brome	8	1.8	1.65
<i>Spartina pectinata</i>	Cord Grass	10	1.5	2.06
<i>Sorghastrum nutans</i>	Indian Grass	32	8.8	6.58
<i>Panicum virgatum</i>	Switch Grass	4	1.3	0.82
<i>Elymus canadensis</i>	Canada Wild Rye	16	1.9	3.29
<i>Elymus virginicus</i>	Virginia Wild Rye	32	3.1	6.58
<i>Bromus kalmii</i>	Prairie Brome	16	2.9	3.29
<i>Poa palustris</i>	Fowl Bluegrass	16	47.8	3.29
<i>Carex vulpinoidea</i>	Brown Fox Sedge	4	9.2	0.82
TOTAL GRASSES & SEDGES		186.5	107.2	38.37
<i>Avena sativa</i>	Oats - Cover Crop	240	4.4	49.38
TOTAL COVER CROPS		240	4.4	49.38
TOTALS		486	164.8	100

EAST INFILTRATION BASINS CUSTOM SEED MIX				
SCIENTIFIC NAME	COMMON NAME	RATE (PLS OZ / ACRE)	RATE (SEEDS / SQ.FT)	% MIX BY WEIGHT
<i>Bouteloua curtipendula</i>	Side-oats Grama	16	2.2	4.09
<i>Calamagrostis canadensis</i>	Blue Joint Grass	1	6.4	0.26
<i>Elymus canadensis</i>	Canada Wild Rye	24	2.9	6.13
<i>Elymus hystrix</i>	Bottlebrush Grass	6	1.0	1.53
<i>Elymus riparius</i>	Riverbank Wild Rye	16	1.1	4.09
<i>Elymus villosus</i>	Silky Wild Rye	4	0.5	1.02
<i>Elymus virginicus</i>	Virginia Wild Rye	16	1.5	4.09
<i>Glyceria striata</i>	Fowl Manna Grass	6	12.4	1.53
<i>Panicum virgatum</i>	Switch Grass	2	0.6	0.51
<i>Poa palustris</i>	Fowl Bluegrass	16	47.8	4.09
<i>Schizachyrium scoparium</i>	Little Bluestem	16	5.5	4.09
<i>Spartina pectinata</i>	Cord Grass	8	1.2	2.04
TOTAL GRASSES		131	83.2	33.46
<i>Carex blanda</i>	Common Wood Sedge	2	0.6	0.51
<i>Carex brevior</i>	Plains Oval Sedge	4	2.7	1.02
<i>Carex crinita</i>	Fringed Sedge	1	0.5	0.26
<i>Carex molesta</i>	Field Oval Sedge	1	0.6	0.26
<i>Carex muskingumensis</i>	Palm Sedge	1	0.2	0.26
<i>Carex stipata</i>	Awl-fruited Sedge	3	2.3	0.77
<i>Carex vulpinoidea</i>	Brown Fox Sedge	6	13.8	1.53
<i>Juncus dudleyi</i>	Dudley's Rush	0.5	36.7	0.13
<i>Juncus tenuis</i>	Path Rush	1	23.0	0.26
<i>Scirpus pendulus</i>	Rufous Bulrush	1	7.1	0.26
TOTAL SEDGES & RUSHES		20.5	87.4	5.24
<i>Avena sativa</i>	Oats - Cover Crop	240	4.4	61.30
TOTAL COVER CROPS		240	4.4	61.30
TOTALS		391.5	175.0	100.00



NOTE: THE CLARITY OF THESE PLANS DEPEND UPON COLOR COPIES. IF THIS TEXT DOES NOT APPEAR IN COLOR, THIS IS NOT AN ORIGINAL PLAN SET AND MAY RESULT IN MISINTERPRETATION.

I HEREBY CERTIFY THAT THIS PLAN, SPECIFICATION OR REPORT WAS PREPARED BY ME OR UNDER MY DIRECT SUPERVISION AND THAT I AM A DULY LICENSED PROFESSIONAL ENGINEER UNDER THE LAWS OF THE STATE OF MINNESOTA.

REESE A. SUDELGTE

DATE: 12/15/2022 LIC. NO. 54243

I HEREBY CERTIFY THAT THIS PLAN, SPECIFICATION OR REPORT WAS PREPARED BY ME OR UNDER MY DIRECT SUPERVISION AND THAT I AM A DULY LICENSED ARCHITECT UNDER THE LAWS OF THE STATE OF MINNESOTA.

MITCHELL R. WORKMON

DATE: 12/15/2022 LIC. NO. 53748

THIS DOCUMENT IS THE PROPERTY OF I & S GROUP, INC. AND MAY NOT BE USED, COPIED OR DUPLICATED WITHOUT PRIOR WRITTEN CONSENT.

PROJECT

ANOKA RAMSEY ATHLETIC ASSOCIATION NEW DOME

RAMSEY MINNESOTA

REVISION SCHEDULE		
DATE	DESCRIPTION	BY

PROJECT NO. 22-26051
 FILE NAME 26051 C5-LAND
 DRAWN BY AJR
 DESIGNED BY AJR
 REVIEWED BY RAS
 ORIGINAL ISSUE DATE 12/16/2022
 CLIENT PROJECT NO. -

PLANTING NOTES AND DETAILS

PRELIMINARY NOT FOR CONSTRUCTION