

CITY OF RAMSEY

SUNWOOD DRIVE - CSAH 5 TO ERKIUM STREET RECONSTRUCTION

CITY IMPROVEMENT PROJECT NO. 25-02

S.A.P. 199-104-015 LOCATED ON SUNWOOD DRIVE BETWEEN NOWTHEN BOULEVARD (CSAH 5) AND ERKIUM STREET
 FROM NW 1/4 OF THE NW 1/4 OF S25, T32, R25 TO NW 1/4 OF THE NW 1/4 OF S25, T32, R25

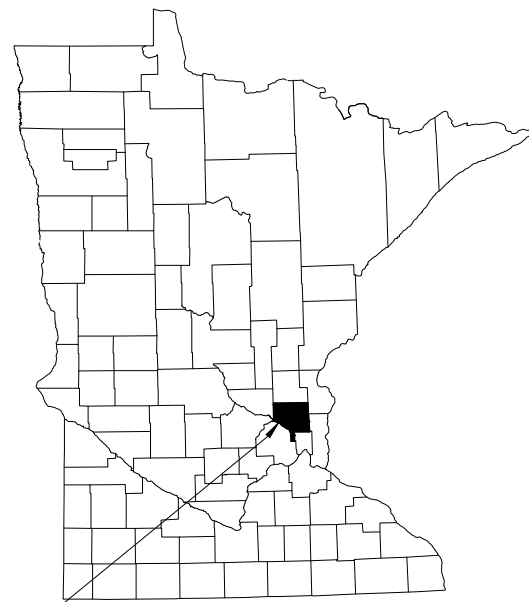
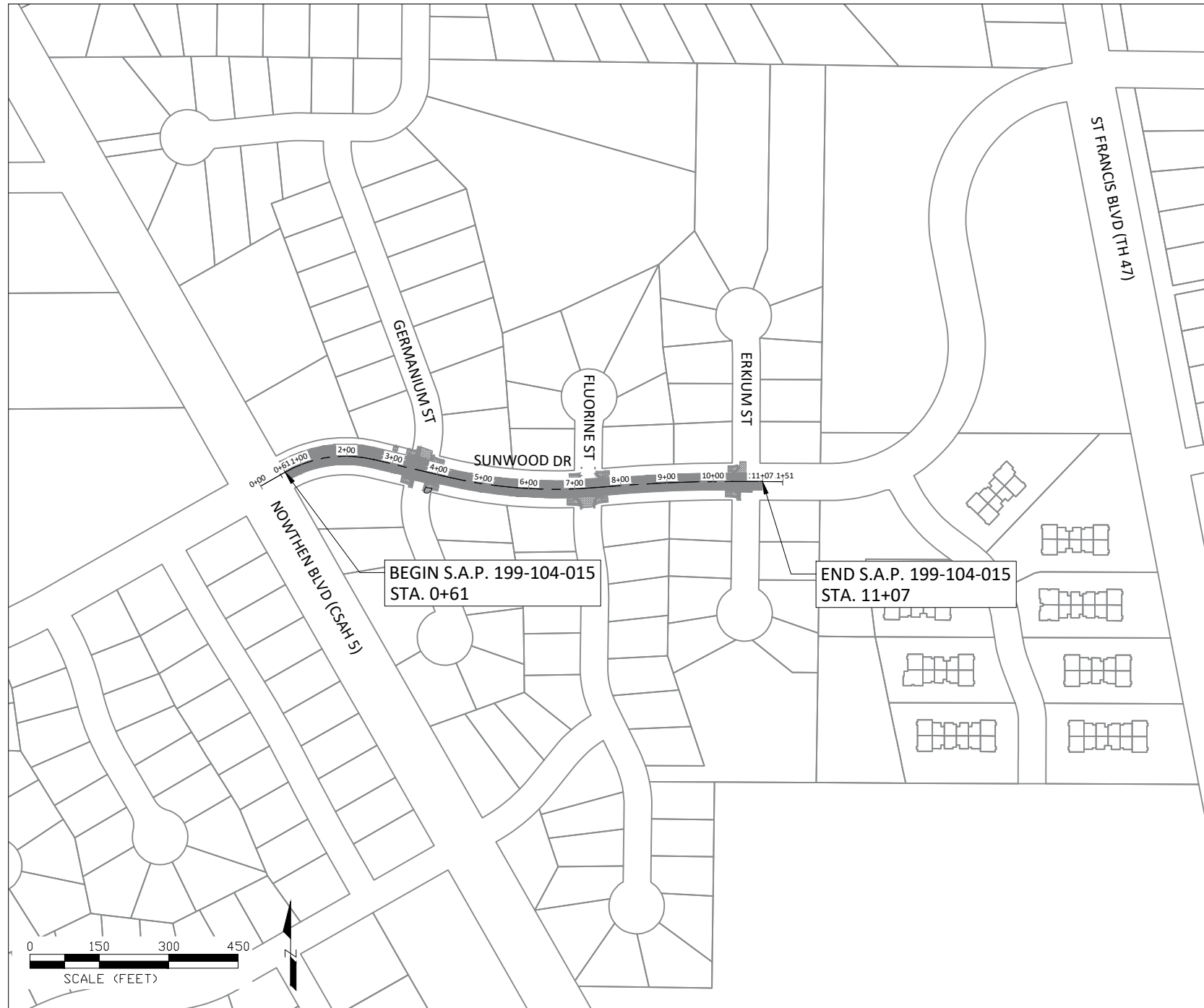

CITY OF RAMSEY
 ANOKA COUNTY, MINNESOTA
 DISTRICT: METRO

THE SUBSURFACE UTILITY INFORMATION IN THIS PLAN IS UTILITY QUALITY LEVEL D. THIS QUALITY LEVEL WAS DETERMINED ACCORDING TO THE GUIDELINES OF CI/ASCE 38-02, ENTITLED "STANDARD GUIDELINES FOR THE COLLECTION AND DEPICTION OF EXISTING SUBSURFACE UTILITY DATA."

NOTE: EXISTING UTILITY INFORMATION SHOWN ON THIS PLAN HAS BEEN PROVIDED BY THE UTILITY OWNER. THE CONTRACTOR SHALL FIELD VERIFY EXACT LOCATIONS PRIOR TO COMMENCING CONSTRUCTION AS REQUIRED BY STATE LAW. NOTIFY GOPHER STATE ONE CALL 1-800-252-1166 OR 651-454-0002



GOVERNING SPECIFICATIONS

THE 2020 EDITION OF THE MINNESOTA DEPARTMENT OF TRANSPORTATION "STANDARD SPECIFICATIONS FOR CONSTRUCTION" SHALL GOVERN.

ALL FEDERAL, STATE AND LOCAL LAWS, REGULATIONS AND ORDINANCES SHALL BE COMPLIED WITH IN THE CONSTRUCTION OF THIS PROJECT.

ALL TRAFFIC CONTROL DEVICES AND SIGNING SHALL CONFORM TO THE MINNESOTA MANUAL ON UNIFORM TRAFFIC CONTROL DEVICES, INCLUDING THE FIELD MANUAL FOR TEMPORARY TRAFFIC CONTROL ZONE LAYOUTS.

SHEET INDEX

THIS PLAN CONTAINS 23 SHEETS

SHEET No.	DESCRIPTION
01	TITLE SHEET
02	STATEMENT OF ESTIMATED QUANTITIES
03	TABULATIONS
04	ALIGNMENT LAYOUT
05	TYPICAL SECTION
06-07	CITY DETAILS
08-13	MNDOT PEDESTRIAN RAMP DETAILS
14	INTERSECTION DETAILS - SUNWOOD DR & GERMANIUM ST
15	INTERSECTION DETAILS - SUNWOOD DR & FLUORINE ST
16	INTERSECTION DETAILS - SUNWOOD DR & ERKIUM ST
17	EROSION CONTROL
18	REMOVALS
19-20	STREET IMPROVEMENTS
21	PAVEMENT MARKING PLAN
22-23	CROSS SECTIONS

LEGEND

	SANITARY MANHOLE		Easement - Drainage & Utility
	CATCH BASIN		Easement - Northern Natural Gas
	FLARED END SECTION		Easement - Roadway
	CULVERT END SECTION		LOT LINE
	HYDRANT		ELECTRIC LINE
	VALVE		ELECTRIC LINE - BURIED
	TREE - CONIFEROUS		ELECTRIC LINE - OVERHEAD
	TREE - DECIDUOUS		GAS LINE
	SHRUB		TELECOMMUNICATION LINE
	LIGHT POLE		TELECOMM - OVERHEAD
	SIGN		FIBER OPTIC LINE
	MAILBOX		TREE LINE
	PEDESTAL - TELECOM		LANDSCAPE
	PEDESTAL - ELECTRIC		RETAINING WALL
	HAND HOLE		FENCE
	REMOVE BIT PAVE		SILT FENCE
	REMOVE CONCRETE PAVE		FLOTATION SILT CURTAIN
	REMOVE GRAVEL SURFACE		WATERMAIN
	MILL BIT PAVEMENT		SANITARY SEWER
	RECLAIM BIT PAVEMENT		STORM SEWER
	CONSTRUCTION EXIT		DRAIN TILE
	RIPRAP CLASS III		LANDSCAPE - ROCK
	CURB & GUTTER		LANDSCAPE - MULCH
	VALLEY GUTTER		LANDSCAPE - RIP RAP
			BIT PAVEMENT
			PR. CONCRETE WALK
			PR. SEEDING AREA

I hereby certify that this plan, specification, or report was prepared by me or under my direct supervision and that I am a duly Licensed Professional Engineer under the laws of the State of Minnesota.

Joe Feriancek 57095 DATE 11/22/24
 JOE FERIANCEK, P.E. LIC. NO.

APPROVED: _____ DATE 11/22/24
 CITY ENGINEER, CITY OF RAMSEY

PROJECT	STA. TO STA.	GROSS LENGTH	BRIDGE LENGTH	NET LENGTH	NET LENGTH (MILES)	ADT (2025)	ADT (2045)	DESIGN ESAL	R VALUE	TON DESIGN	DESIGN SPEED	NUMBER OF LANES	WIDTH OF LANES	FUNCTIONAL CLASSIFICATION
S.A.P. 199-104-015 SUNWOOD DR	0+61 TO 11+07	1,046 FT	0 FT	1,046 FT	0.20 MI	1,050	1,155	351,000	70	10	30 MPH	2	12'	COLLECTOR

CITY OF RAMSEY
 7550 SUNWOOD DRIVE
 RAMSEY, MN 55303
 (763) 427-1410 FAX (763) 433-9898

STOPPING SIGHT DISTANCE BASED ON:
 3.5 FT - HEIGHT OF EYE
 2.0 FT - HEIGHT OF OBJECT

DATUM:
 VERTICAL: NAVD 88
 HORIZONTAL: ANOKA COUNTY COORDINATES (1996 ADJUSTMENT)

DATE	REVISION

DATE	REVISION

DISTRICT STATE AID ENGINEER: REVIEWED FOR COMPLIANCE WITH STATE AID RULES/POLICY

STATE AID ENGINEER: APPROVED FOR STATE AID FUNDING

DATE _____
SHEET 01 OF 23 SHEETS

Nov 22, 2024 - 1:46pm
 G:\Engineering\AutoCad Dwg\Projects N-Z\Sunwood Drive - CSAH 5 to Erkium St 25-02\Plan Drawings\Title Sheet.dwg