

S:\Users\caj\24proj\02134 Complete Auto Bldg Additior (Ramsey)\02134_CDD\02134_BASE_7.dwg 2/27/2024

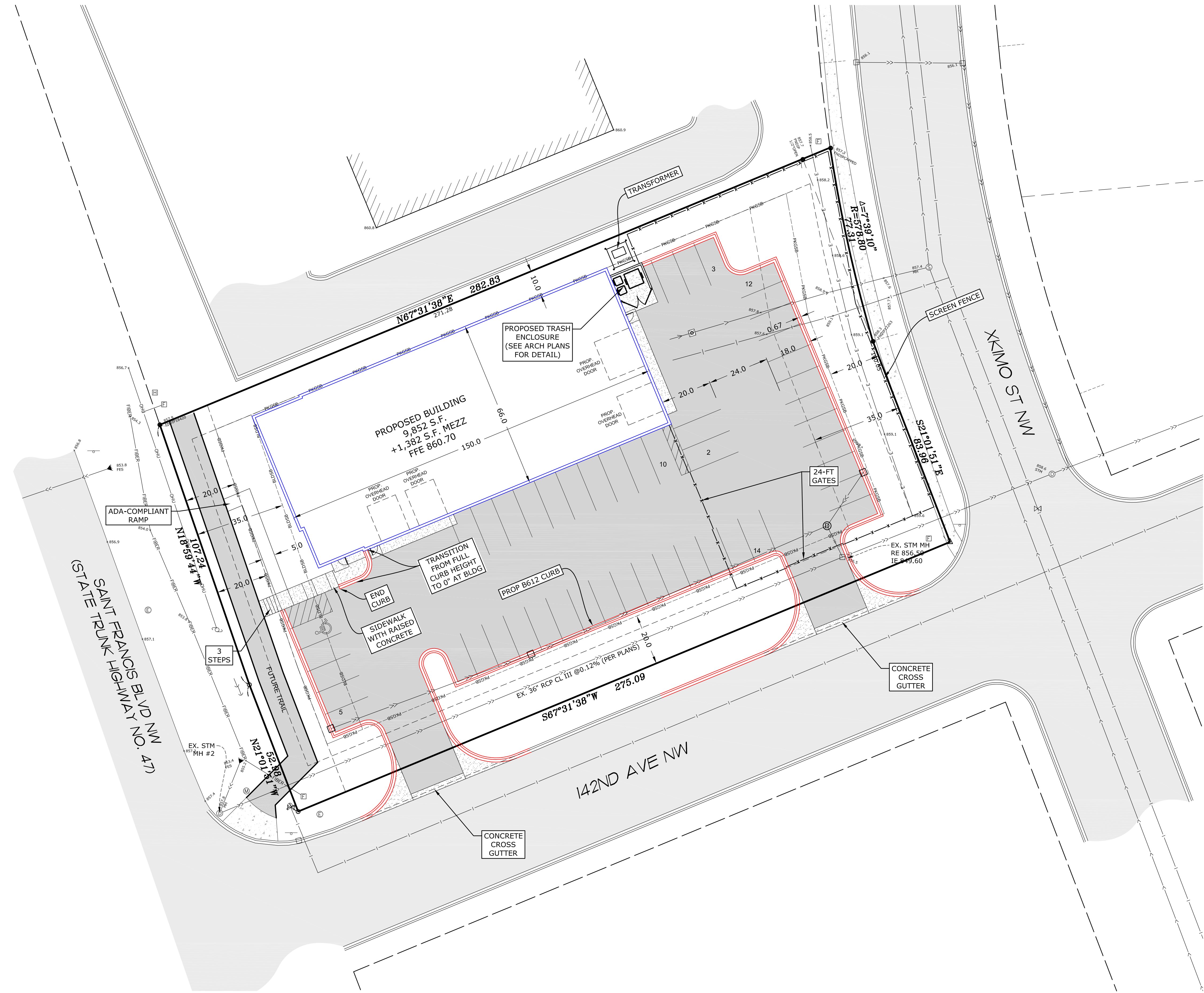

CURB & BITUMINOUS NOTES

REMOVAL AND DISPOSAL OF EXISTING STREET MATERIALS AS REQUIRED FOR CONSTRUCTION IS CONSIDERED INCIDENTAL.
 SAW-CUT EXISTING BITUMINOUS AND CONCRETE CURB TO PROVIDE BUTT-JOINT.
 RESTORE DISTURBED STREET TO EXISTING OR BETTER SECTION.
 BACKFILLING OF CURB IS INCIDENTAL TO CURB INSTALLATION.
 FOUR INCHES OF CLASS 5 UNDER CURB IS INCIDENTAL TO CURB INSTALLATION.

LEGEND

- OHW — EXISTING OVERHEAD ELECTRIC
- TEL — EXISTING UNDERGROUND TELEPHONE
- CBL — EXISTING UNDERGROUND CABLE
- EXISTING ELECTRICAL PEDESTAL
- EXISTING CABLE PEDESTAL
- EXISTING UTILITY POLE
- EXISTING LIGHT POLE
- S — EXISTING STORM SEWER
- W — EXISTING WATER MAIN
- SS — EXISTING SANITARY SEWER
- FM — EXISTING FORCEMAIN
- ⊙ EXISTING STORM MANHOLE
- ⊙ EXISTING CATCH BASIN
- ▲ EXISTING FLARED-END SECTION
- ⊗ EXISTING GATE VALVE
- ⊗ EXISTING HYDRANT
- ⊙ EXISTING WELL
- ⊙ EXISTING SANITARY SEWER MANHOLE
- EXISTING BITUMINOUS
- P — PROPOSED WATER PIPE
- S — PROPOSED SANITARY SEWER PIPE
- S — PROPOSED STORM SEWER PIPE
- EXISTING CONCRETE SURFACE
- PROPOSED CONCRETE SURFACE
- PROPOSED TIP-OUT CURB
- ⊙ PROPOSED LIGHT POLE

DRAWN BY:	DESIGN BY:
M.Q.A.	Q.M.A.
CHKD BY:	PROJ. NO.
M.Q.A.	24-2134
ORIGINAL DATE:	
JANUARY 25, 2024	

DATE	REVISION DESCRIPTION

I hereby certify that this plan was prepared by me or under my direct supervision and that I am a duly Licensed Professional Engineer under the laws of the State of Minnesota.

CASEM M. ABUGHAZLEH
 LICENSE NO. 56299
 DATE: 02.09.2024

COMPLETE AUTO SERVICE
 RAMSEY, MINNESOTA
 CIVIL SITE PLAN

PREPARED FOR:
CLASSIC CONSTRUCTION

PLOWE ENGINEERING, INC.
 SITE PLANNING & ENGINEERING
 6776 LAKE DRIVE
 SUITE 110
 LINO LAKES, MN 55014
 PHONE: (651) 361-8210
 FAX: (651) 361-8701



Know what's below.
 Call before you dig.

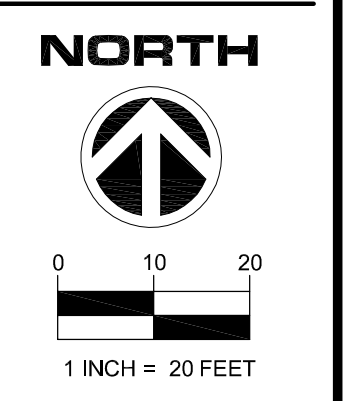

**CIVIL SITE PLAN
 COMPLETE AUTO SERVICE**

C1