



THE WATERFRONT

CITY OF RAMSEY

RAMSEY, MN 55303

100% EARTHWORK, UTILITIES & TRAIL PAVING PLAN CONSTRUCTION DRAWINGS

DF/
DAMON FARBER
LANDSCAPE ARCHITECTS

310 South 4th Avenue, Suite 7050
Minneapolis, MN 55415
p: 612.332.7522

REHDER & ASSOCIATES, INC.
Civil Engineers & Land Surveyors
3440 Federal Drive, Suite 110
Eagan, MN 55122
Telephone: 651-452-5051
www.rehder.com
Project No: 231-3242.012
PROJECT NO.: 231-3242.012
DRAWING FILE: 3242016.DWG

PROJECT # 23-176

CONTEXT MAP

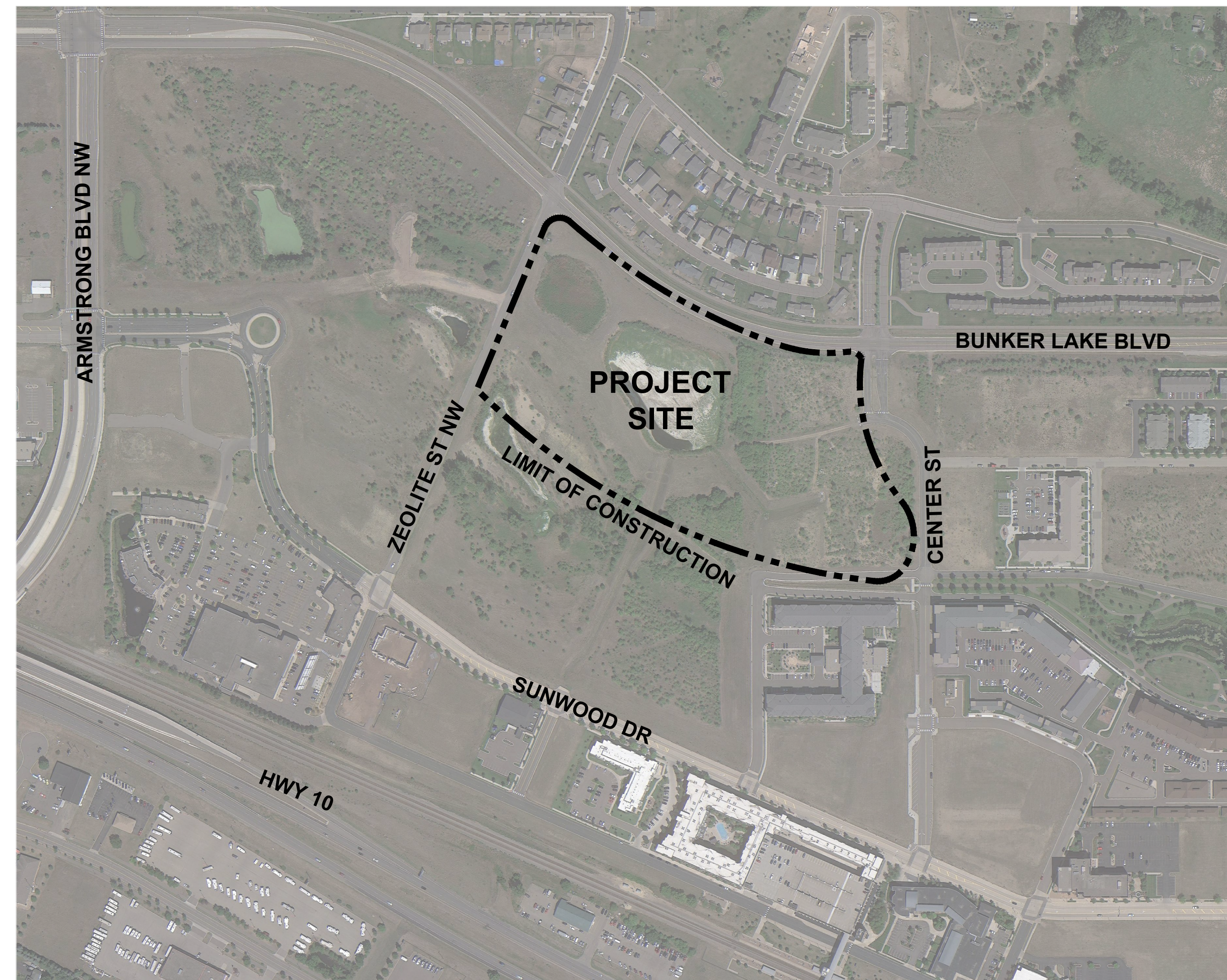

PROJECT DIRECTORY

OWNER

CITY OF RAMSEY
MARK RIVERBLOOD | PARKS & ASSISTANT PUBLIC WORKS DIRECTOR
7550 SUNWOOD DRIVE NW
RAMSEY, MINNESOTA 55303
MRIVERBLOOD@CITYOFRAMSEY.COM
P. 763.433.9853

LANDSCAPE ARCHITECT

DAMON FARBER LANDSCAPE ARCHITECTS
310 S 4TH AVE
MINNEAPOLIS, MN 55415
CONTACT: CHUCK EVENS, PLA
CEVENS@DAMONFARBER.COM
651.216.6115
ABBY GLASTETTER, PLA
AGLASTETTER@DAMONFARBER.COM
314.413.7180

CIVIL ENGINEER

REHDER & ASSOCIATES
CONTACT: NICK ADAM, P.E.
NADAM@REHDER.COM
651.337.6729

Sheet List Table	
Sheet Number	Sheet Title
G000	COVER SHEET
G001	EXISTING CONDITIONS
G002	NOTES, ABBREVIATIONS & SYMBOLS
C101	GRADING & EROSION CONTROL PLAN
C102	GRADING & EROSION CONTROL PLAN
L110	SITE MATERIALS PLAN
L500	SITE DETAILS



01 SITE ORIENTATION PLAN
1" = 50'-0"

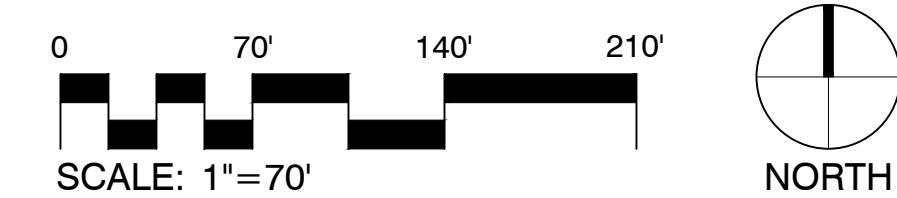

100% BID PACKAGE

EARTHWORK, UTILITIES & TRAIL PAVING

THE WATERFRONT

RAMSEY, MINNESOTA

I hereby certify that this document was prepared by me or under my direct supervision and that I am a duly licensed Landscape Architect under the laws of the State of Minnesota.

Name: Charles Evens
Registration#: 50575
Signature: *Charles Evens*
Date: 03/08/2024

Date: 03/08/2024
DF/ Project #: 23-176
Scale: AS SHOWN
Drawn/Checked: AG/CE

REVISION: --

COVER SHEET

G000

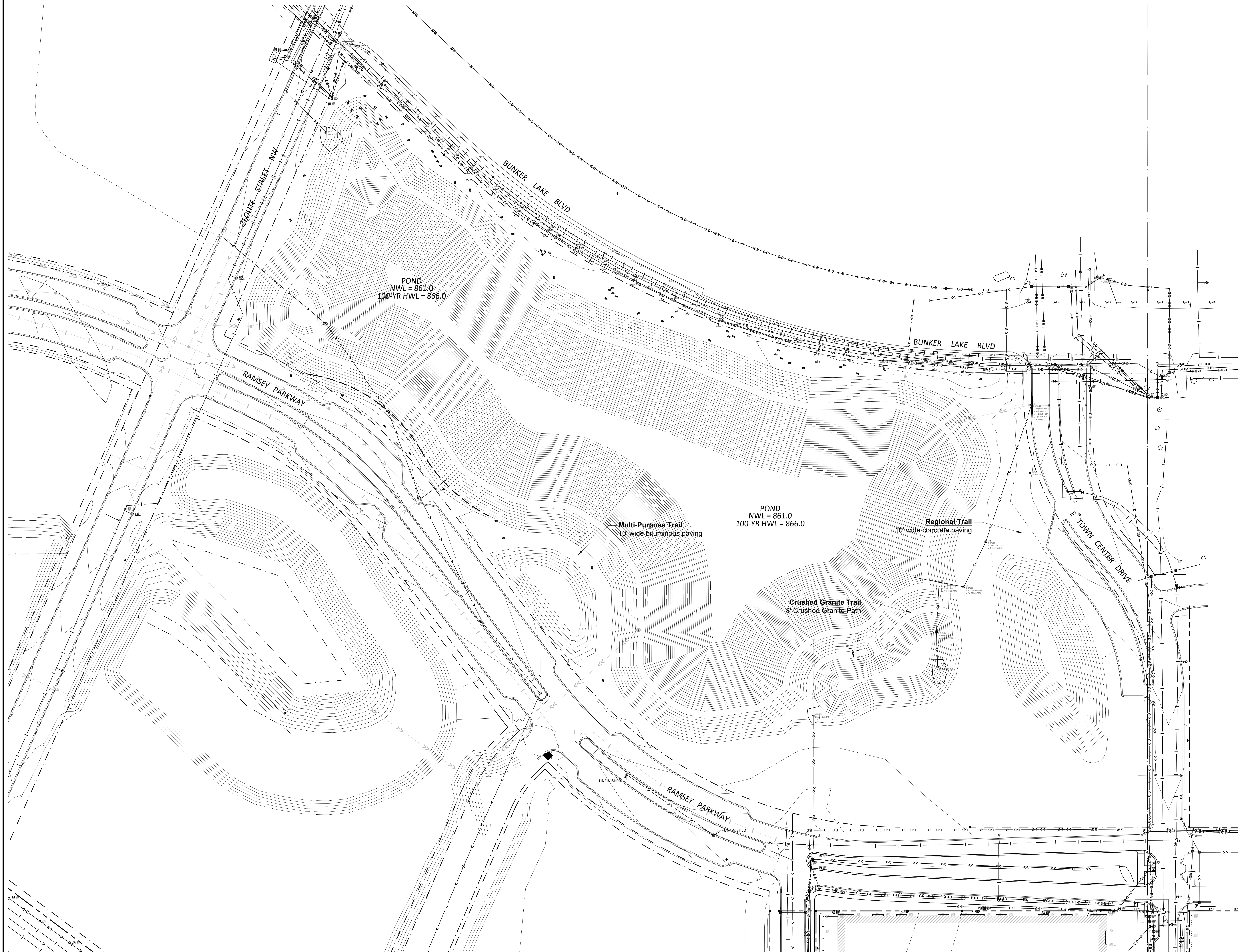

100% BID PACKAGE

EARTHWORK, UTILITIES & TRAIL
PAVING

THE WATERFRONT

RAMSEY, MINNESOTA

I hereby certify that this document was prepared by me or under my direct supervision and that I am a duly licensed Landscape Architect under the laws of the State of Minnesota.

Name: Charles Evens
Registration#: 50575

Signature: *Charles Evens* Date: 03/08/2024

Date: 03/08/2024

DF/ Project #: 23-176

Scale: AS SHOWN

Drawn/Checked: AG/CE

REVISION

EXISTING
CONDITIONS

G001

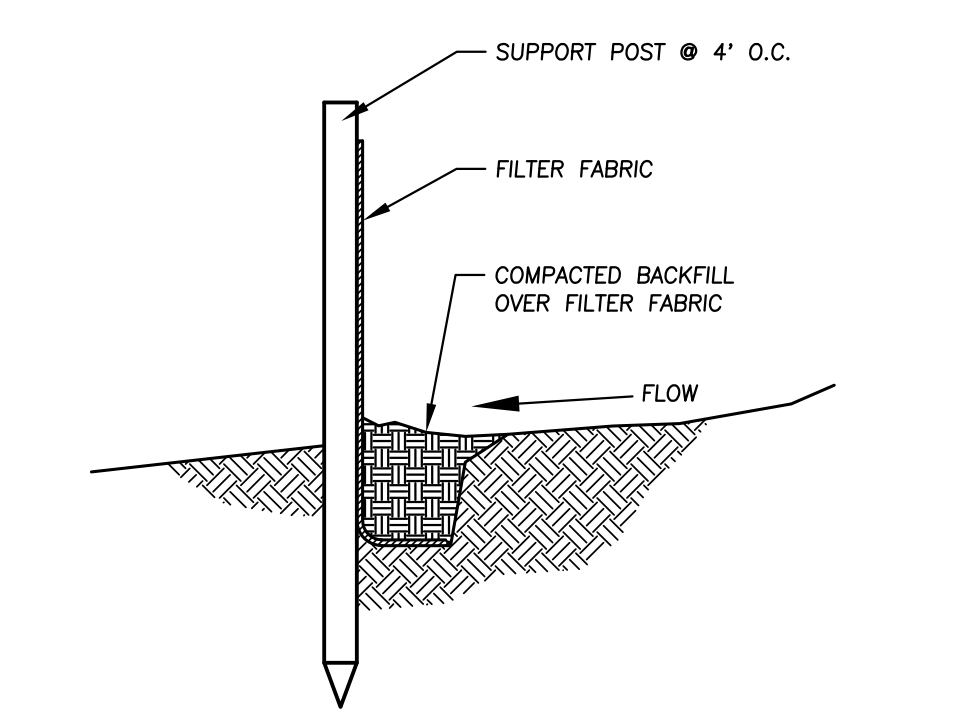

1
C1
SILT FENCE
NO SCALE

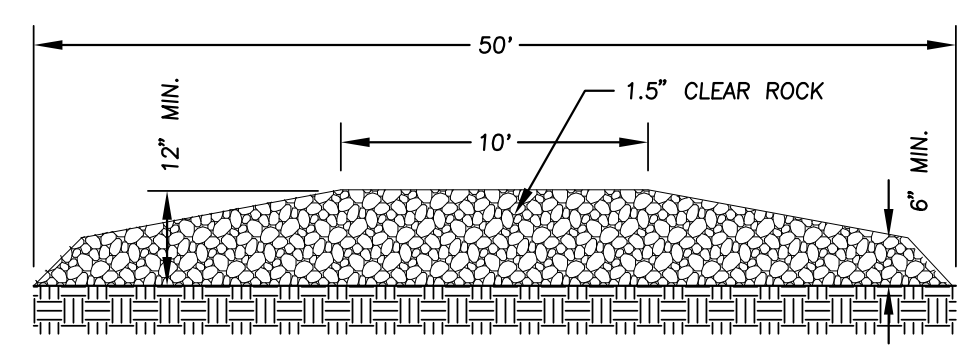
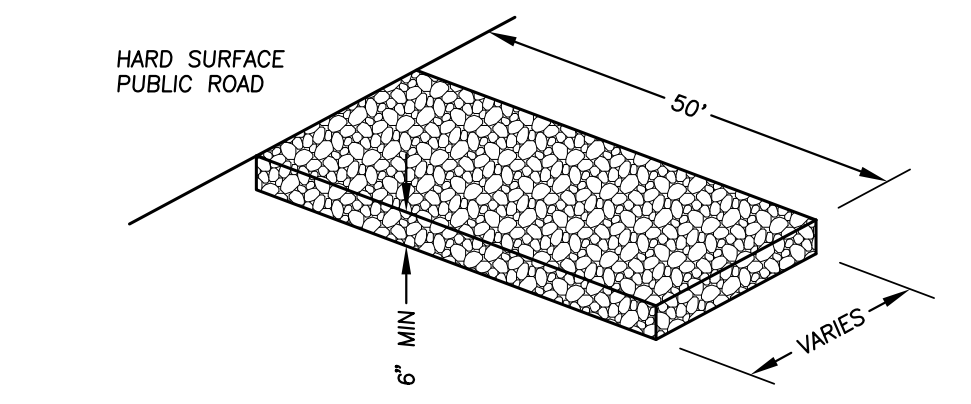

2
C1
ROCK CONSTRUCTION ENTRANCE
NO SCALE

- GRADING NOTES**
- All elevations shown are to final surfaces.
 - Contractor is responsible for obtaining a National Pollutant Discharge Elimination System (NPDES) General Storm Water Permit for Construction Activity before construction begins.
- EROSION CONTROL NOTES**
- Contractor is responsible for all notifications and inspections required by General Storm Water Permit.
 - All erosion control measures shown shall be installed prior to grading operations and maintained until all areas disturbed have been restored.
 - Sweep paved public streets as necessary where construction sediment has been deposited.
 - Each area disturbed by construction shall be restored per the specifications within 14 days after the construction activity in that portion of the site has temporarily or permanently ceased.
 - Temporary soil stockpiles must have silt fence around them and cannot be placed in surface waters, including storm water conveyances such as curb and gutter systems, or conduits and ditches.
 - Excess concrete/water from concrete trucks shall be disposed of in portable washout concrete basin or disposed of in a contained area.
 - Trail contractor is responsible for removing all silt fence from the site at the completion of the project.

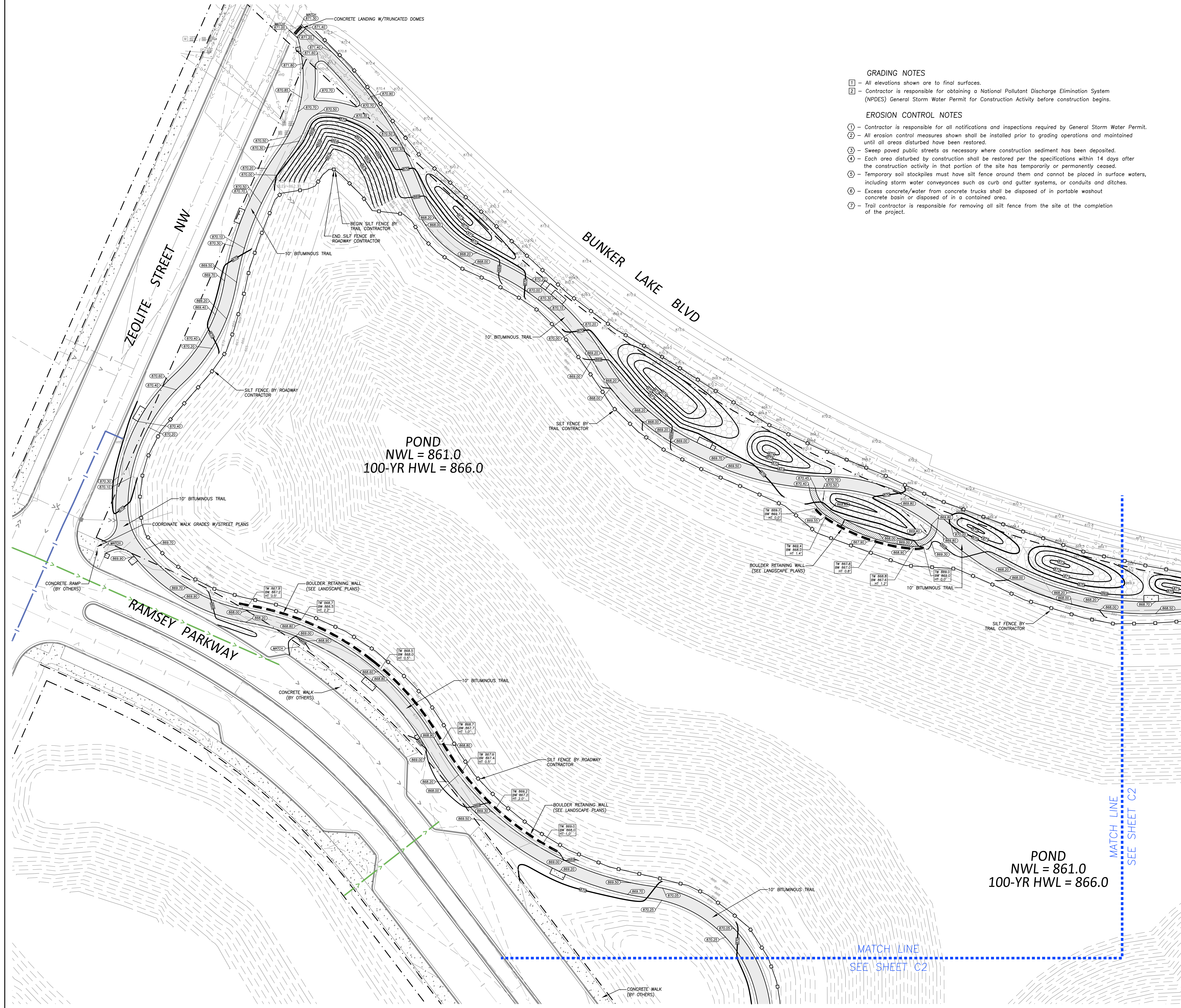

LEGEND

- PROPOSED CONCRETE
- PROPOSED BITUMINOUS
- PROPOSED CRUSHED GRANITE
- PROPOSED CONTOUR
- PROPOSED ELEVATION
- SILT FENCE
- PROPOSED EC BLANKET
- BOUNDARY/ROW/BLOCK LINE
- BUILDING/PARKING SETBACK LINE
- DRAINAGE ARROW
- EXISTING CONTOUR
- EXISTING ELEVATION

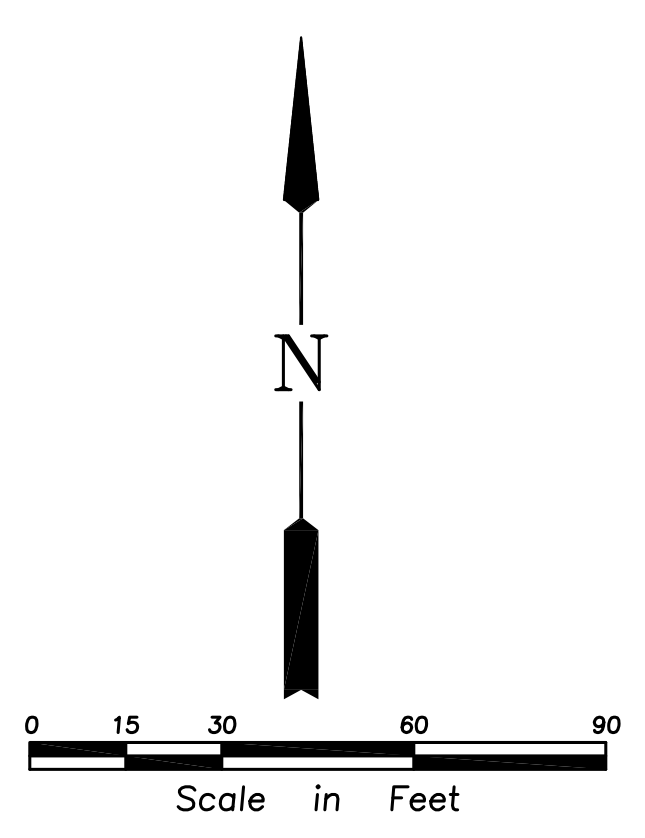

100% BID PACKAGE

EARTHWORK, UTILITIES & TRAIL PAVING

THE WATERFRONT

RAMSEY, MN

I hereby certify that this document was prepared by me or under my direct supervision and that I am a duly licensed Professional Engineer under the laws of the State of Minnesota.

Name: Nicholas P. Adam
Registration#: 43856
Signature: *Nicholas P. Adam* 03/08/2024
Date

Date: 03/08/2024
DF/ Project #: 23-176
Scale: 1 INCH = 30 FEET
Drawn/Checked: BJO/NPA

REVISION	

GRADING & EROSION CONTROL PLAN

C101

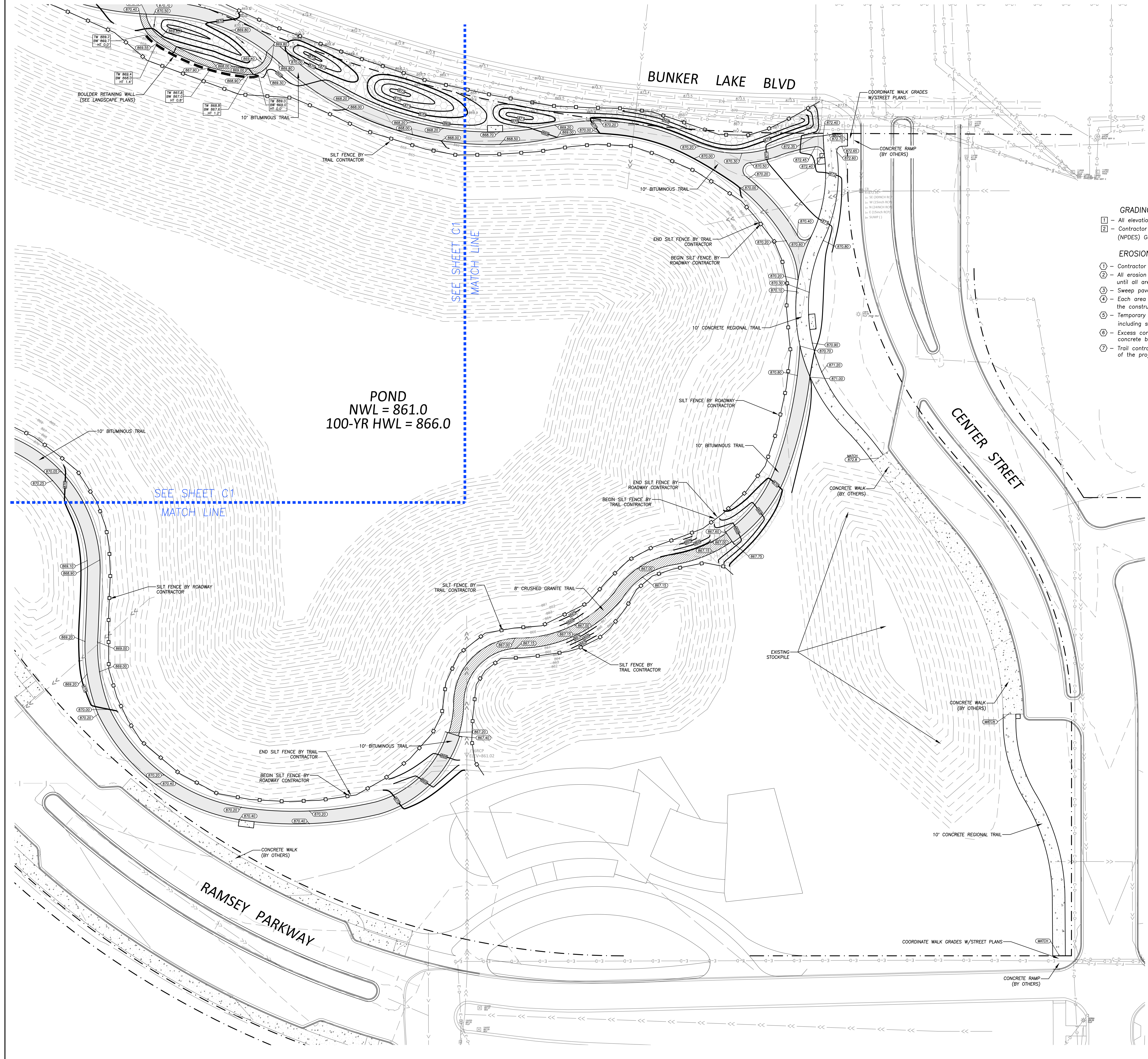

GRADING NOTES

- 1 - All elevations shown are to final surfaces.
- 2 - Contractor is responsible for obtaining a National Pollutant Discharge Elimination System (NPDES) General Storm Water Permit for Construction Activity before construction begins.

EROSION CONTROL NOTES

- 1 - Contractor is responsible for all notifications and inspections required by General Storm Water Permit.
- 2 - All erosion control measures shown shall be installed prior to grading operations and maintained until all areas disturbed have been restored.
- 3 - Sweep paved public streets as necessary where construction sediment has been deposited.
- 4 - Each area disturbed by construction shall be restored per the specifications within 14 days after the construction activity in that portion of the site has temporarily or permanently ceased.
- 5 - Temporary soil stockpiles must have silt fence around them and cannot be placed in surface waters, including storm water conveyances such as curb and gutter systems, or conduits and ditches.
- 6 - Excess concrete/water from concrete trucks shall be disposed of in portable washout concrete basin or disposed of in a contained area.
- 7 - Trail contractor is responsible for removing all silt fence from the site at the completion of the project.

SPECIFICATIONS

GENERAL

- I. GENERAL
 - A. Before construction begins, the Contractor shall contact all utility companies, both public and private and have them locate all utilities within the construction limits.
 - B. The Contractor shall be responsible for arranging all required inspections with the governing authority that has jurisdiction over the work that is to be performed.
 - C. The Contractor shall stay within the construction limits unless approved otherwise by the Owner and/or Engineer. Construction limits are defined by the property boundary unless shown different on the plan.
 - D. The Contractor shall be responsible for protecting all existing structures, utilities, trees, etc. from damage during construction.
 - E. The Contractor shall be responsible for correcting any damage (at Contractor's expense).
 - F. Any discrepancies found on the site that affect the proposed work shall be reported to the Owner and/or Engineer before the completion of any additional work.
 - G. No soils report provided. Subgrade soils assumed adequate for the proposed construction.
 - H. Existing Topography and Boundary Survey provided by Bolton & Menz.

SITE CLEARING

- I. GENERAL
 - A. Remove trees, shrubs, grass, and other vegetation or obstructions, as required, to permit installation of improvements shown on the Plans.
- II. EXECUTION
 - A. Trees and stumps shall be hauled from the site. Burial on-site or burning of trees and stumps will not be allowed.
 - B. Where existing trees are indicated to remain, leave existing topsoil in place within drip lines to prevent damage to root system.
 - C. Topsoil shall be stripped from disturbed areas and stockpiled in piles not exceeding 3-feet in depth.
 - D. Remove all back dirt and unsuitable material from under drives and roadways within 3-feet of final pavement subgrade.
 - E. Remove all waste materials and unsuitable or excess topsoil from Owner's property.

GRADING, EROSION CONTROL, AND TURF ESTABLISHMENT

- I. GENERAL
 - A. All grading, erosion control and turf establishment shall be according to the materials, workmanship, and other applicable requirements of the Minnesota Department of Transportation "Standard Specifications for Construction", latest edition, unless otherwise specified.
 - B. All erosion control measures shown on the plans must be installed prior to commencement of grading operations and maintained until all areas altered on the site have been restored.
 - C. All areas disturbed by construction shall be restored with seed and disked mulch, sod, wood fiber blanket, or be hard surfaced within two weeks of substantial completion of construction.
 - D. Provide approved borrow soil materials from off-site when sufficient approved soil materials are not available from excavations. Remove all excess and unsatisfactory material from the site.
 - E. Protect structures, utilities, sidewalks, pavements, and other facilities from damage caused by settlement, lateral movement, undermining, wearout, and other hazards created by earthwork operations.
 - F. Compaction shall not be less than the following percentages of maximum dry density according to ASTM D 698:
 - i. Under structures, building slabs, steps, and pavements, compact the top 12 inches below subgrade and each layer of backfill or fill material at 100 percent maximum dry density.
 - ii. Under walkways, compact the top 6 inches below subgrade and each layer of backfill or fill material at 100 percent maximum dry density.
 - iii. Under lawn or ungrazed areas, compact the top 6 inches below subgrade and each layer of backfill or fill material at 95 percent maximum dry density.
 - G. Grades as shown on the plan are to finished grade.
 - H. Backfill trenches involving utilities under building slabs to be designed by Others (per their requirements).
- II. PRODUCTS
 - A. Satisfactory soils include ASTM D 2487 soil classification groups GW, GP, GM, SW, SP, and SM; free of rock or gravel larger than 2-inches in any dimension, debris waste, frozen material, vegetation and other deleterious matter.
 - B. Unsatisfactory soils include ASTM D 2487 soil classification groups GC, SC, ML, MH, CL, CH, OL, OH, and PT.
 - C. All backfill and fill materials must be satisfactory soil materials.
 - D. Topsoil shall be per ASTM D 5268, free of stones 1" or larger.
 - E. Subbase and base material must be a naturally or artificially graded mixture of natural or crushed gravel, crushed stone, and natural or meeting MNDOT Specifications for Class 6 gravel.
 - F. Spring/Summer temporary turf establishment: seed shall be MNDOT Mixture 110 @ 100 lbs/acre and mulch shall be MNDOT Type 1.
 - G. Winter temporary turf establishment: seed shall be MNDOT Mixture 100 @ 100 lbs/acre and mulch shall be MNDOT Type 1.
- III. EXECUTION
 - A. Place 4-inches of topsoil over all areas to be re-established with turf or as specified in the landscape plans.
 - B. Provide erosion control measures to prevent erosion or displacement of soils and discharge of soil-bearing water runoff or airborne dust to adjacent properties and walkways.
 - C. Place inlet protection devices in catch basins and maintain until all areas disturbed have been restored.
 - D. Whenever construction vehicle access routes intersect paved public roads, provisions must be made to minimize the transport of sediment (mud) by runoff or vehicles tracking onto the paved road surface. Where sediment is transported onto a public road surface, the roads shall be cleaned thoroughly at the end of each day. Sediment shall be removed by shoveling or sweeping and be transported to a sediment controlled disposal area. Street washing shall be allowed only after sediment is removed in this manner.

LEGEND

- PROPOSED CONCRETE
- PROPOSED BITUMINOUS
- PROPOSED CRUSHED GRANITE
- PROPOSED CONTOUR
- PROPOSED ELEVATION
- SILT FENCE
- PROPOSED EC BLANKET CATEGORY 20 (MNDOT 3885)
- BOUNDARY/ROW/BLOCK LINE
- BUILDING/PARKING SETBACK LINE
- DRAINAGE ARROW
- EXISTING CONTOUR
- EXISTING ELEVATION

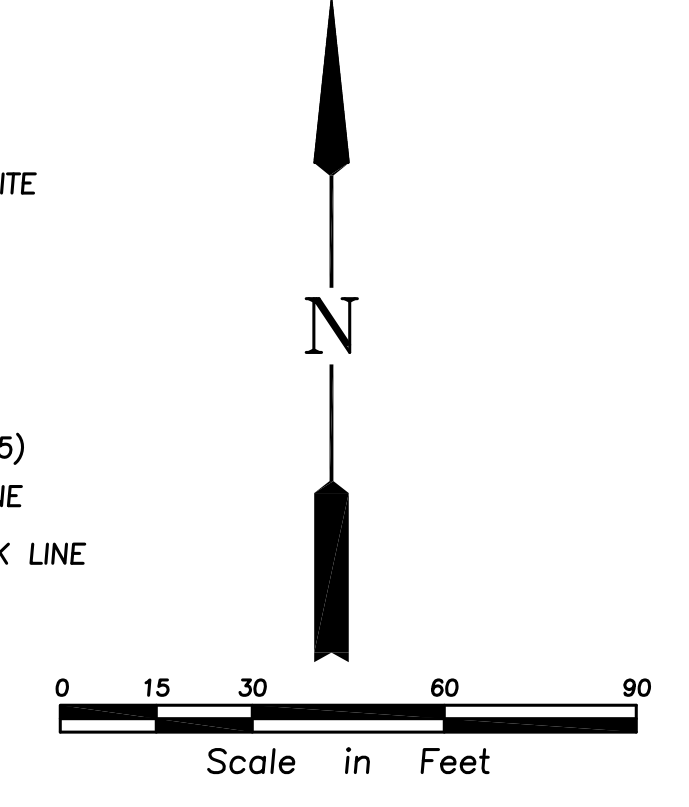

REFERENCE NOTES SCHEDULE					
PAVING					
SYMBOL	DESCRIPTION	QTY	DETAIL	MATERIAL PROFILE/ASSEMBLY	COLOR/FINISH
P-01	PAVING TYPE 01 - BITUMINOUS PATH	225.26 CY	3/L500	2.5" WEARING COURSE, OVER 4" CLASS 5 BASE, OVER COMPACTED SUBGRADE	
P-02	PAVING TYPE 02 - CLASS 3 CRUSHED GRANITE TRAIL	36.57 CY	4/L500	4" DEPTH CLASS 3 CRUSHED GRANITE	
WALL					
SYMBOL	DESCRIPTION	QTY	DETAIL	MATERIAL PROFILE/ASSEMBLY	PRODUCT/MODEL
WL-01	WALL TYPE 01 - GLACIAL BOULDER WALL	342 LF	5/L500	GLACIAL BOULDER RETAINING WALL OVER COMPACTED AGGREGATE BASE WITH DRAINAGE PIPE	GLACIAL BOULDER 12"-36"

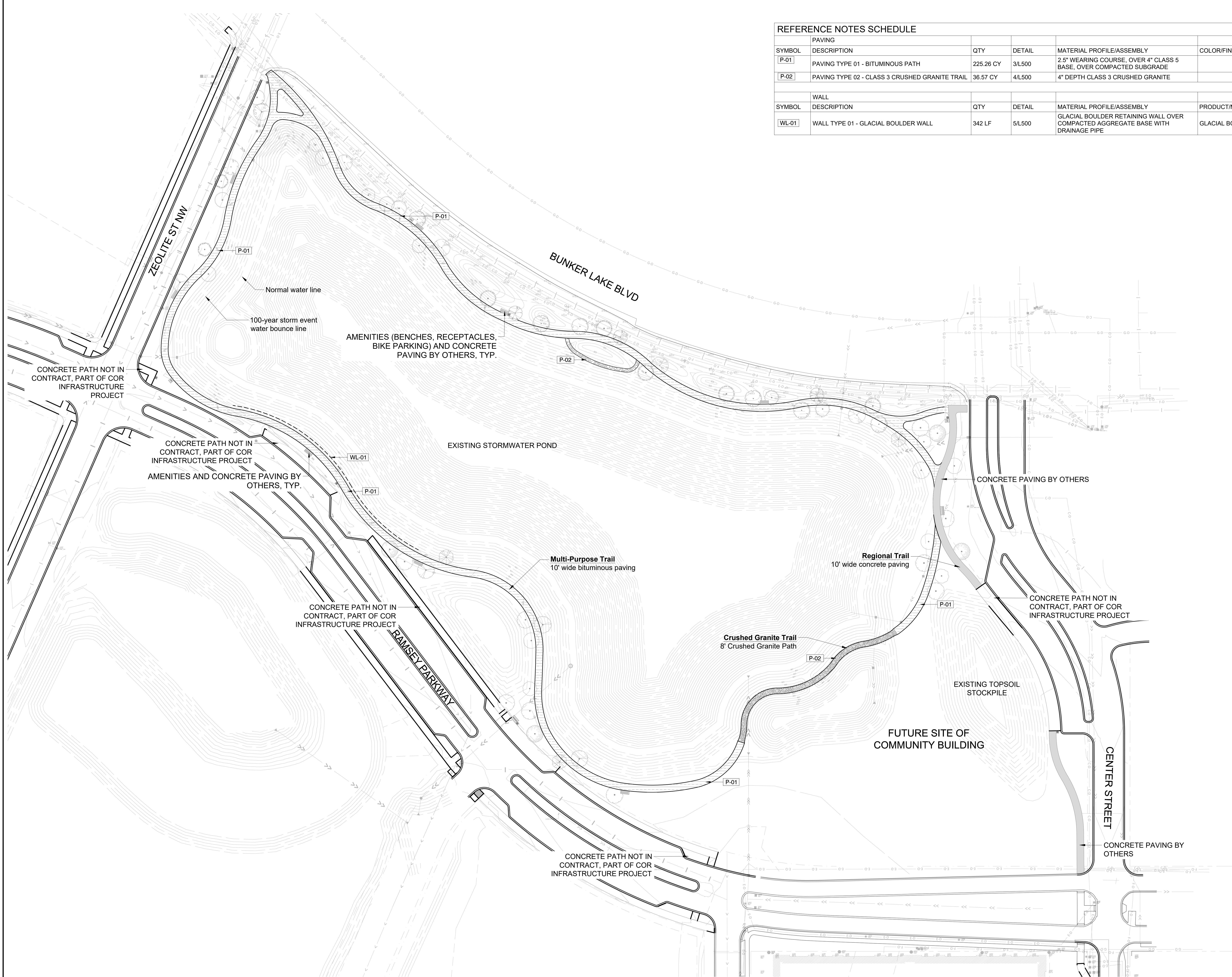

100% BID PACKAGE

EARTHWORK, UTILITIES & TRAIL PAVING

THE WATERFRONT

RAMSEY, MINNESOTA

I hereby certify that this document was prepared by me or under my direct supervision and that I am a duly licensed Landscape Architect under the laws of the State of Minnesota.

Name: Charles Evens
Registration#: 50575
Signature: *Charles Evens*
Date: 03/08/2024

Date: 03/08/2024
DF/ Project #: 23-176
Scale: AS SHOWN
Drawn/Checked: AG/CE

REVISION: --

SITE MATERIALS PLAN

L110

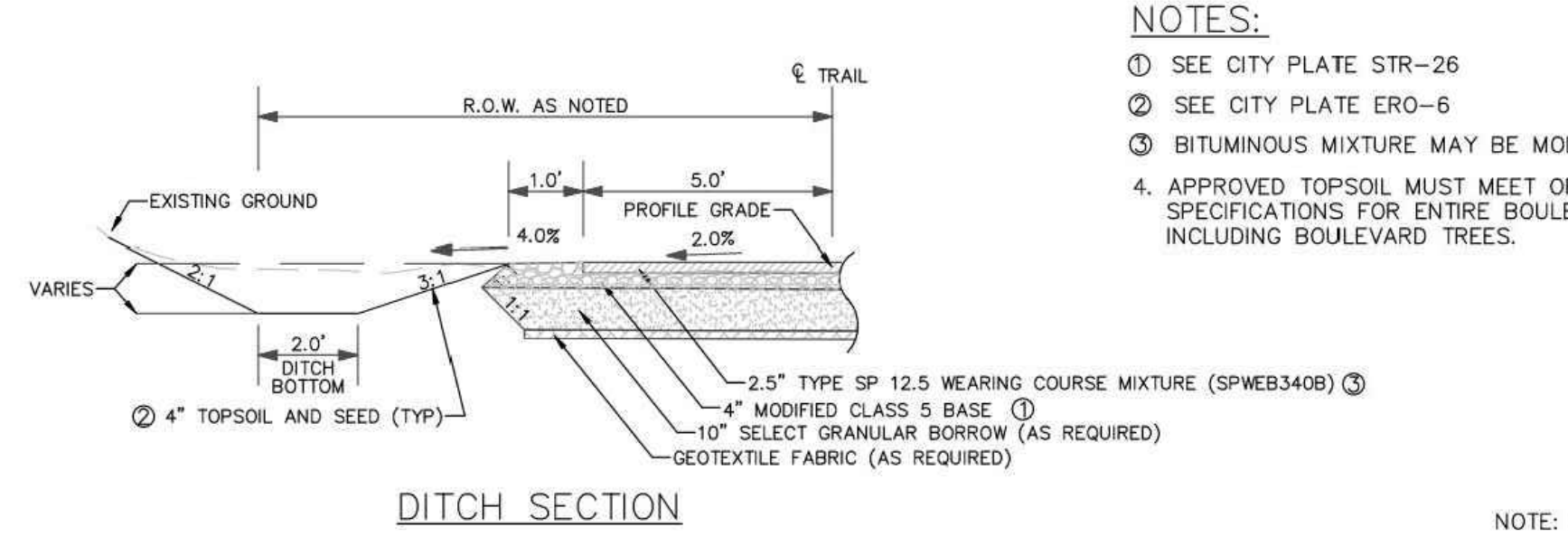
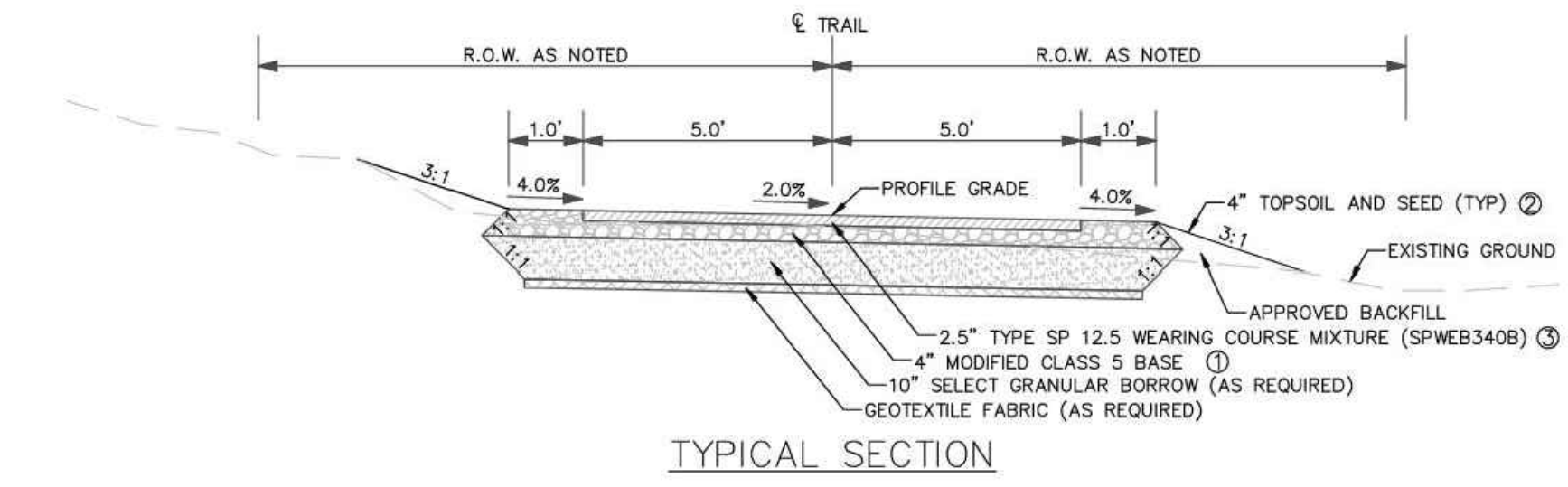

- NOTES:**
- ① SEE CITY PLATE STR-26
 - ② SEE CITY PLATE ERO-6
 - ③ BITUMINOUS MIXTURE MAY BE MODIFIED PER PLAN.
 - 4. APPROVED TOPSOIL MUST MEET ORGANIC CONTENT SPECIFICATIONS FOR ENTIRE BOULEVARD IN AREAS INCLUDING BOULEVARD TREES.

3 DETAIL-BITUMINOUS TRAIL SECTION - STANDARD
NTS

P-23 176-92

- NOTES:**
- REFER TO CIVIL PLAN FOR LOCATION, TOP OF WALL AND BOTTOM OF WALL ELEVATIONS.
 - BOULDERS SHALL BE STABLE AND FREE FROM MOVEMENT.
 - SELECT BOULDERS FOR APPROPRIATE SCALE AND FIT WITH ADJACENT BOULDERS
 - INSTALL LARGEST BOULDERS ON THE BOTTOM COURSE
 - PROPERLY SELECTED BOULDERS WILL LIMIT SIZE OF VOIDS AND PROVIDE SECURE WALL
 - ENSURE GOOD CONTACT BETWEEN ADJACENT BOULDERS
 - PROVIDE SOLID INSTALLATION WITHOUT MOVEMENT OF INDIVIDUAL BOULDERS
 - SELECT BOULDERS FOR APPROPRIATE SCALE AND FIT WITH ADJACENT BOULDERS
 - INSTALL LARGEST BOULDERS ON THE BOTTOM COURSE
 - PROPERLY SELECTED BOULDERS WILL LIMIT SIZE OF VOIDS AND PROVIDE SECURE WALL
 - ENSURE GOOD CONTACT BETWEEN ADJACENT BOULDERS
 - PROVIDE SOLID INSTALLATION WITHOUT MOVEMENT OF INDIVIDUAL BOULDERS

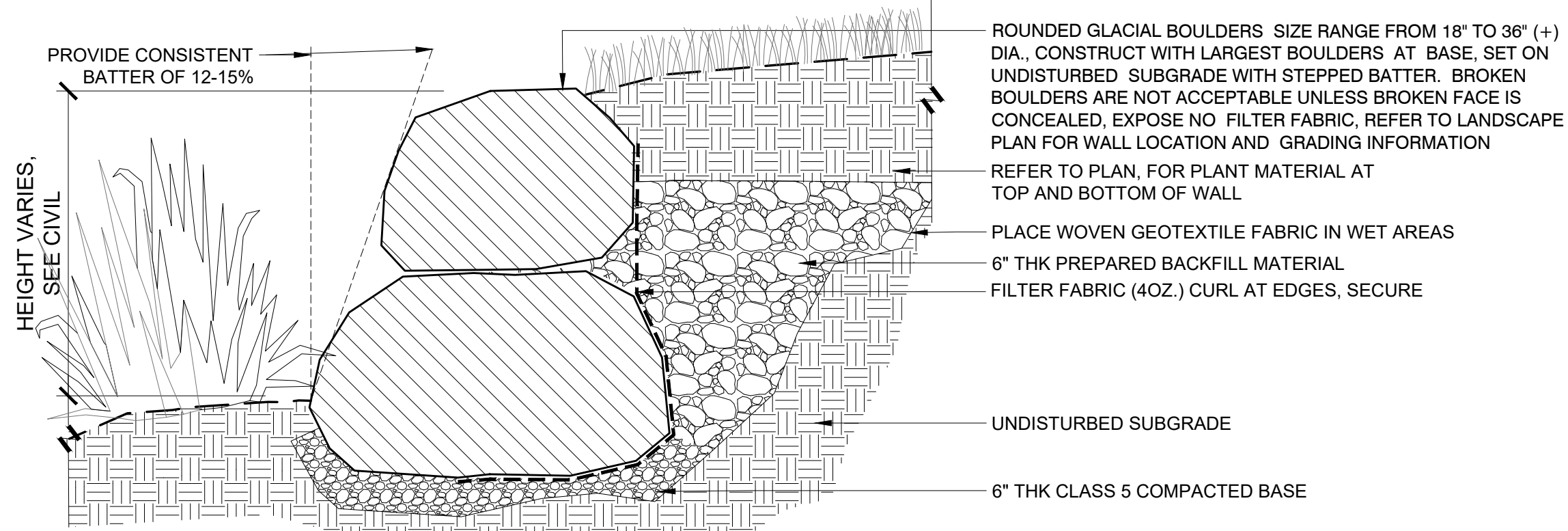

2 WALL TYPE 01 - BOULDER RETAINING WALL
1" = 1'-0"

P-23 176-14

100% BID PACKAGE

EARTHWORK, UTILITIES & TRAIL PAVING

THE WATERFRONT

RAMSEY, MINNESOTA

I hereby certify that this document was prepared by me or under my direct supervision and that I am a duly licensed Landscape Architect under the laws of the State of Minnesota.

Name: Charles Evens
Registration#: 50575
Signature: *Charles Evens*
Date: 03/08/2024

Date: 03/08/2024
DF/ Project #: 23-176
Scale: AS SHOWN
Drawn/Checked: AG/CE

REVISION	

SITE DETAILS

L500

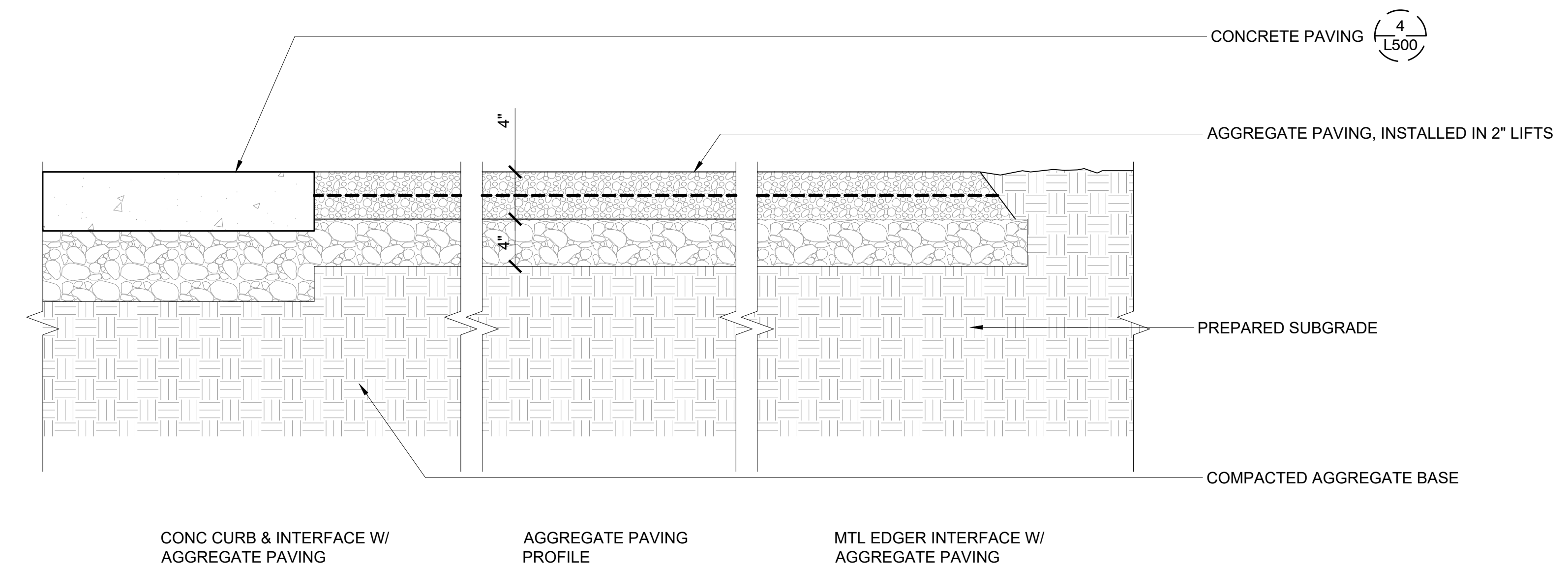

4 DETAIL - AGGREGATE PAVING
1 1/2" = 1'-0"

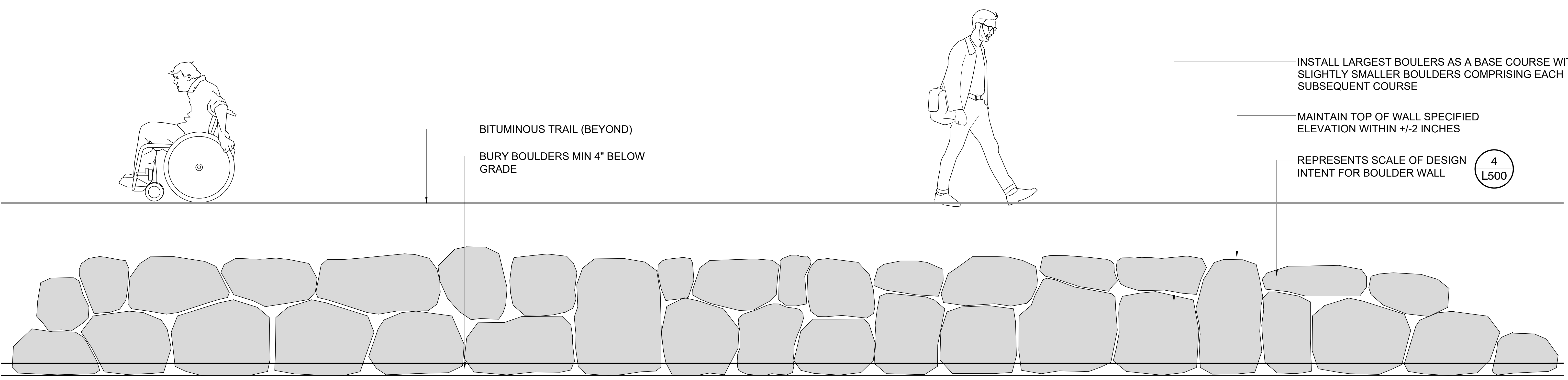

1 WALL TYPE 01 - BOULDER RETAINING WALL ELEVATION
3/4" = 1'-0"

P-23 176-94