



Identify ♦ Inform ♦ Impact

Submitted To: Thao
Company: King Baguette
Job Location: Northstar Marketplace Job Description: Channel letters on Raceway, 2 Sets
City/State: Ramsey, MN
Phone: 763-232-4418

Quality Sign Solutions is pleased to submit the following specifications and estimates to fabricate and install:

Quantity two (2) sets of raceway mounted channel letters "KING BAGUETTE", 12" tall; Front elevation to have one (1) logo 22" tall and subcopy bar "BANH MI – PHO – BOBA TEA", and the rear elevation to have "DRIVE THRU"; LED illuminated, with black trim & returns - per drawing, installed.....\$10,975.00

Install only quantity one (1) drive thru menu board, footing/conduit/rebar cage by others....\$975.00

Total: \$11,950.00, plus extras listed below

Extra:

MN Sales Tax

City Permit(s) fee – to be determined and added to final invoice.

Electrical hook up by others (or can be subbed out for additional cost)

****Please Note**** Not responsible for buried obstacles not marked by Gopher One, e.g. irrigation lines, invisible dog fencing, underground speaker wire, communication lines, etc. Additionally, Quality Sign Solutions is not responsible for any accidental damage or loss.

Payment to be made as follows: Eleven Thousand Nine Hundred Fifty Dollars: (\$11,950.00)

75% Down payment required (\$8,963.00) Balance due upon completion.

This proposal may be withdrawn if not accepted within 30 days.

This agreement, with all conditions noted is accepted by both parties, QSS and Submitted To.

Purchaser _____

Title _____

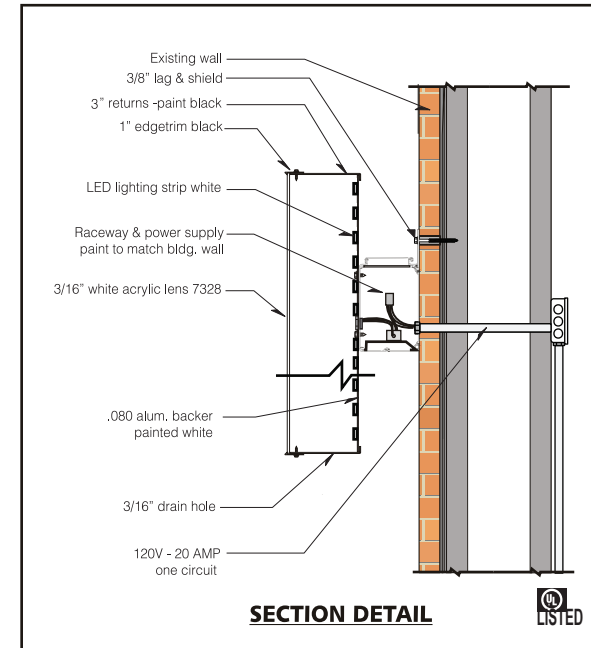

SPECIFICATIONS

12" channel LED letter raceway mounted
 White faces / White LEDs
 Black 1' edge trim / Black 4" returns

11' x 80 3/5" channel LED capsule
 Face with black opaque vinyl
 with copy reversed out and
 red translucent arrow applied.z



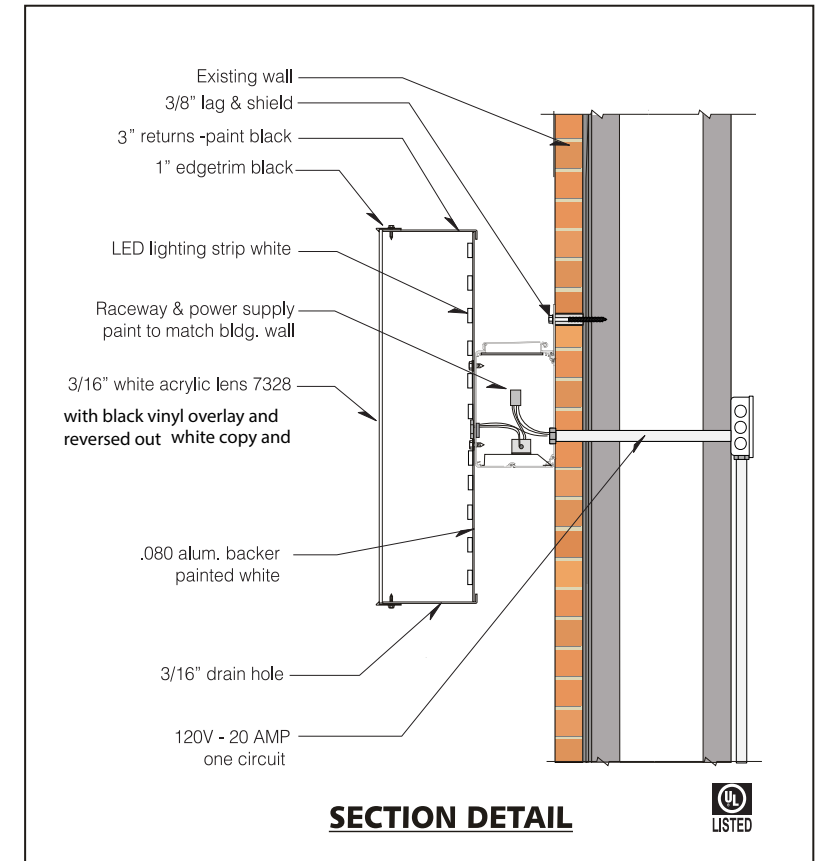

Channel LED letters on a raceway
 Scale 1/4" = 1'-0"
 qtal sq ft of sign 24.6

