

TYPICAL SECTION

NOT TO SCALE
RIVLYN AVENUE NW
STA: 0+82.94 TO STA: 9+64.66

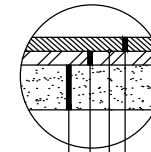
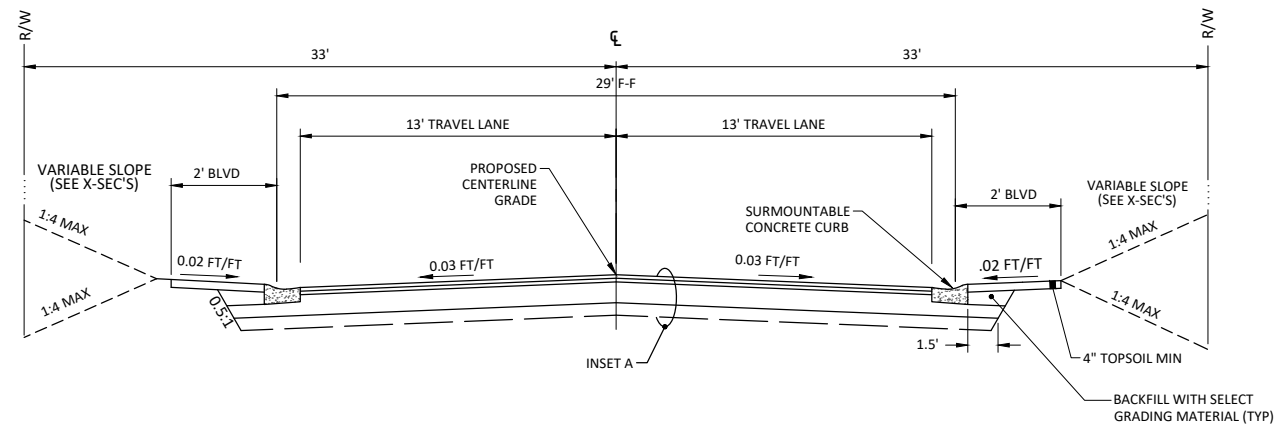

1.5" TYPE SP 9.5 WEARING COURSE (SPWEA340C) (2360)
BITUMINOUS TACK COAT (2357) (INCIDENTAL)
2" TYPE SP 12.5 NON WEARING COURSE (SPNWB330C) (2360)
6" AGGREGATE BASE CL 5, MOD (2211) (SEE STR-26)
SUBGRADE PREPARATION (2112) (INCIDENTAL)

INSET A - BITUMINOUS ROADWAY

NOT TO SCALE

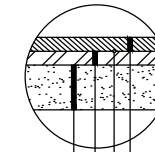

2" TYPE SP 9.5 WEARING COURSE (SPWEA340C) (2360)
BITUMINOUS TACK COAT (2357) (INCIDENTAL)
2" TYPE SP 12.5 NON WEARING COURSE (SPNWB330C) (2360)
6" AGGREGATE BASE CL 5, MOD (2211) (SEE STR-26)
SUBGRADE PREPARATION (2112) (INCIDENTAL)

INSET C - COMMERCIAL BITUMINOUS DRIVEWAY

NOT TO SCALE

TYPICAL SECTION

NOT TO SCALE
TUNGSTEN STREET NW
STA: 12+51.45 TO STA: 13+50

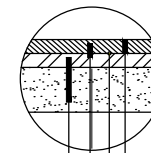
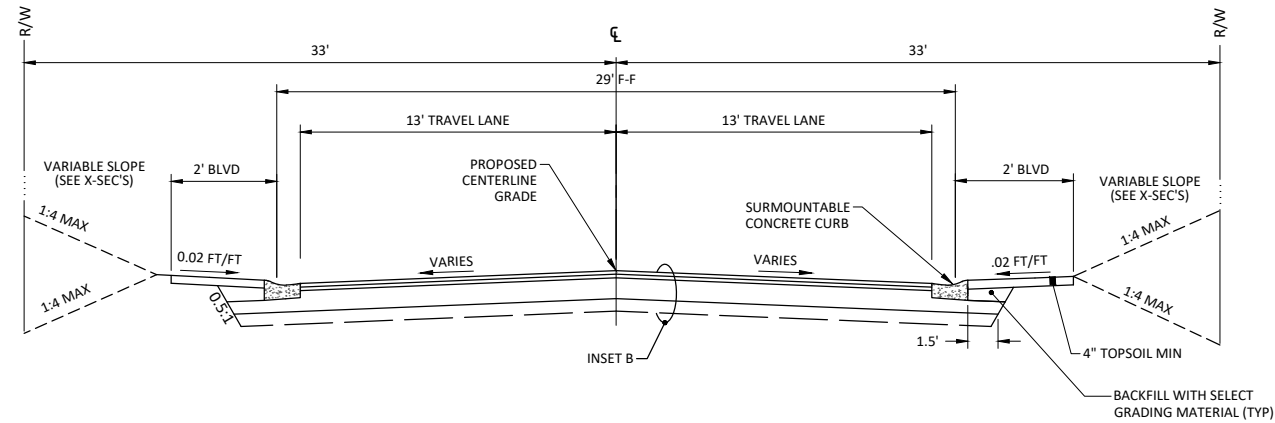

2" TYPE SP 9.5 WEARING COURSE (SPWEA340C) (2360)
BITUMINOUS TACK COAT (2357) (INCIDENTAL)
2" TYPE SP 12.5 NON WEARING COURSE (SPNWB330C) (2360)
6" AGGREGATE BASE CL 5, MOD (2211) (SEE STR-26)
SUBGRADE PREPARATION (2112) (INCIDENTAL)

INSET B - BITUMINOUS ROADWAY

NOT TO SCALE

TYPICAL SECTION

NOT TO SCALE
TUNGSTEN STREET NW
STA: 13+50 TO STA: 14+90

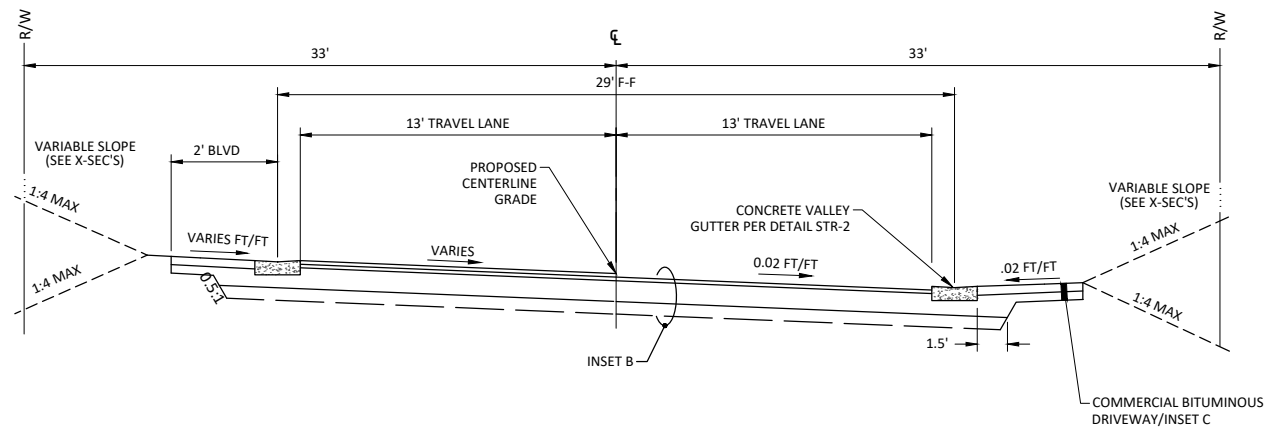

NOTES:

- CONTRACTOR SHALL VERIFY EXISTING PAVEMENT SECTION PRIOR TO RECLAMATION. RECLAMATION PROCEDURES SHALL NOT START WITHOUT PRIOR APPROVAL FROM ENGINEER.
- TYPICAL SECTION DOES NOT REPRESENT DIMENSIONS AT INTERSECTIONS. SEE PLAN SHEETS FOR INTERSECTION LAYOUT.

© Bolton & Menk, Inc. 2025. All Rights Reserved. 11/16/2024 10:55:00 AM CAD/CS/135503/01.dwg 2/27/2025 9:22:03 AM

I HEREBY CERTIFY THAT THIS PLAN, SPECIFICATION, OR REPORT WAS PREPARED BY ME OR UNDER MY DIRECT SUPERVISION AND THAT I AM A DULY LICENSED PROFESSIONAL ENGINEER UNDER THE LAWS OF THE STATE OF MINNESOTA.
ZACHARY F. LINGL, P.E.
LIC. NO. 56344 DATE MM/DD/YYYY



7533 SUNWOOD DR NW, SUITE 206
RAMSEY, MN 55303
Phone: (763) 433-2851
Email: Ramsey@bolton-menk.com
www.bolton-menk.com

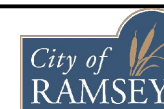

DESIGNED	NO.	ISSUED FOR	DATE
TJP			
DRAWN	ZDB		
CHECKED	ZFL		
CLIENT PROJ. NO.	25-04		

CITY OF RAMSEY, MINNESOTA
DICKENSON'S MISSISSIPPI ESTATES STREET RECONSTRUCTION

TYPICAL SECTIONS