

CITY OF RAMSEY

FLINTWOOD HILLS 2ND & 3RD STREET RECONSTRUCTIONS

CITY IMPROVEMENT PROJECT NO. 26-05

GOVERNING SPECIFICATIONS

THE 2025 EDITION OF THE MINNESOTA DEPARTMENT OF TRANSPORTATION "STANDARD SPECIFICATIONS FOR CONSTRUCTION" SHALL GOVERN.

THE 2023 EDITION OF THE CITY ENGINEERS ASSOCIATION OF MINNESOTA "STANDARD SPECIFICATIONS" SHALL GOVERN FOR UTILITY INSTALLATIONS.

ALL FEDERAL, STATE AND LOCAL LAWS, REGULATIONS AND ORDINANCES SHALL BE COMPLIED WITH IN THE CONSTRUCTION OF THIS PROJECT.

ALL TRAFFIC CONTROL DEVICES AND SIGNING SHALL CONFORM TO THE MINNESOTA MANUAL ON UNIFORM TRAFFIC CONTROL DEVICES, INCLUDING THE FIELD MANUAL FOR TEMPORARY TRAFFIC CONTROL ZONE LAYOUTS.

SHEET INDEX

THIS PLAN CONTAINS 56 SHEETS

| SHEET No. | DESCRIPTION |
|-----------|-------------|
|-----------|-------------|

| | |
|-------|-----------------------------------|
| 01 | TITLE SHEET |
| 02 | STATEMENT OF ESTIMATED QUANTITIES |
| 03 | ALIGNMENT LAYOUT |
| 04 | TYPICAL SECTION |
| 05-06 | CITY DETAILS |
| 07-12 | MNDOT PEDESTRIAN RAMP DETAILS |
| 13-14 | SWPPP |
| 15-21 | GRADING & EROSION CONTROL |
| 22-28 | EXISTING CONDITIONS & REMOVALS |
| 29-38 | STREET CONSTRUCTION |
| 39-40 | CROSS SECTIONS 142ND AVENUE |
| 41 | CROSS SECTIONS 142ND CIRCLE |
| 42-43 | CROSS SECTIONS 141ST AVENUE |
| 44 | CROSS SECTIONS COBALT CIRCLE |
| 45-47 | CROSS SECTIONS BARIUM STREET |
| 48-52 | CROSS SECTIONS ARGON STREET |
| 53-54 | CROSS SECTIONS 143RD AVENUE |
| 55-56 | CROSS SECTIONS 142ND LANE |

LOCATION MAP

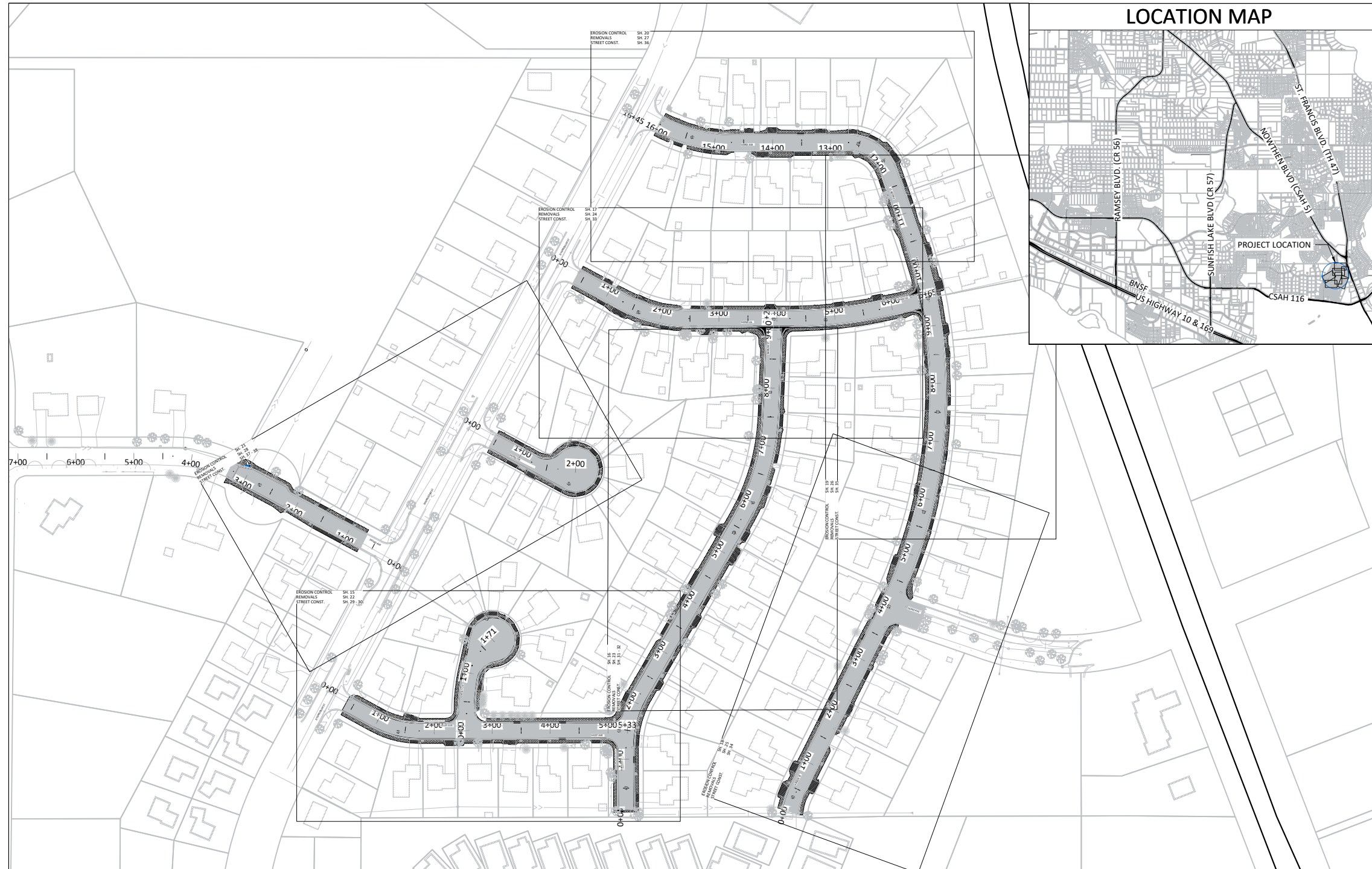
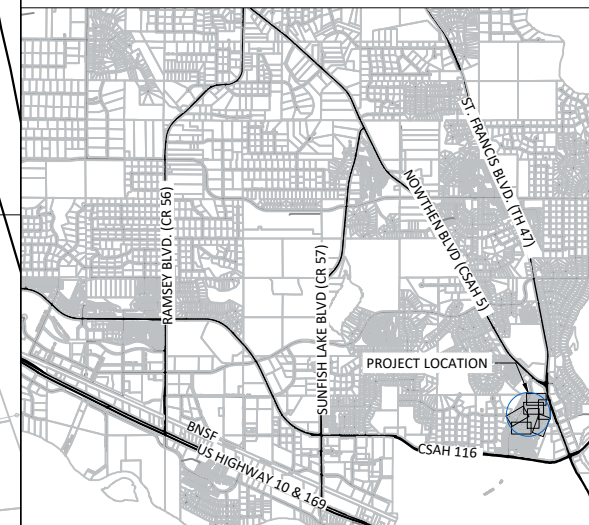

| LEGEND | | | |
|--------|-----------------------|--|-------------------------------|
| | SANITARY MANHOLE | | Easement - Drainage & Utility |
| | STORM SEWER MANHOLE | | Easement - Roadway |
| | CATCH BASIN MANHOLE | | LOT LINE |
| | CATCH BASIN | | ELECTRIC LINE |
| | CATCH BASIN - GROUT | | ELECTRIC LINE - BURIED |
| | CATCH BASIN - RESET | | ELECTRIC LINE - OVERHEAD |
| | FLARED END SECTION | | GAS LINE |
| | CULVERT END SECTION | | TELECOMMUNICATION LINE |
| | HYDRANT | | TELECOMM - OVERHEAD |
| | VALVE | | FIBER OPTIC LINE |
| | TREE - CONIFEROUS | | TREE LINE |
| | TREE - DECIDUOUS | | LANDSCAPE |
| | SHRUB | | RETAINING WALL |
| | LIGHT POLE | | FENCE |
| | SIGN | | SILT FENCE |
| | MAILBOX | | WATERMAIN |
| | PEDESTAL - TELECOM | | SANITARY SEWER |
| | PEDESTAL - ELECTRIC | | STORM SEWER |
| | HAND HOLE | | DRAIN TILE |
| | DRIVE - BITUMINOUS | | LANDSCAPE - ROCK |
| | DRIVE - CONCRETE | | LANDSCAPE - MULCH |
| | DRIVE - GRAVEL | | LANDSCAPE - RIP RAP |
| | CONCRETE WALK | | PR. DRIVE - BITUMINOUS |
| | BITUMINOUS TRAIL | | PR. DRIVE - CONCRETE |
| | REMOVE BIT PAVE | | PR. DRIVE - GRAVEL |
| | REMOVE CONCRETE PAVE | | PR. CONCRETE WALK |
| | REMOVE GRAVEL SURFACE | | PR. CONCRETE |
| | MILL BIT PAVEMENT | | PR. SEEDING AREA |
| | RECLAIM BIT PAVEMENT | | PR. SODDING AREA |

I hereby certify that this plan, specification, or report was prepared by me or under my direct supervision and that I am a duly Licensed Professional Engineer under the laws of the State of Minnesota.

JOE FERIANCEK, P.E.
ASSISTANT CITY ENGINEER

57095 DATE --/--/--
LIC. NO.

| DATE | REVISION |
|------|----------|
| | |
| | |
| | |
| | |

SHEET 01 OF 56 SHEETS



CITY OF RAMSEY
7550 SUNWOOD DRIVE
RAMSEY, MN 55303
(763) 427-1410 FAX (763) 433-9898

THE SUBSURFACE UTILITY INFORMATION IN THIS PLAN IS UTILITY QUALITY LEVEL D. THIS QUALITY LEVEL WAS DETERMINED ACCORDING TO THE GUIDELINES OF CI/ASCE 38-02, ENTITLED "STANDARD GUIDELINES FOR THE COLLECTION AND DEPICTION OF EXISTING SUBSURFACE UTILITY DATA."

NOTE: EXISTING UTILITY INFORMATION SHOWN ON THIS PLAN HAS BEEN PROVIDED BY THE UTILITY OWNER. THE CONTRACTOR SHALL FIELD VERIFY EXACT LOCATIONS PRIOR TO COMMENCING CONSTRUCTION AS REQUIRED BY STATE LAW. NOTIFY GOPHER STATE ONE CALL 1-800-252-1166 OR 651-454-0002



Call before you dig
811
651 454-0002 Metro
800 252-1166 Outstate
www.gopherstateonecall.org