

CITY OF RAMSEY

STREET RECONSTRUCTION PLANS FOR AGGREGATE BASE, BITUMINOUS SURFACING, CURB & GUTTER, GRADING, STORM SEWER

S.A.P. 199-126-002, S.A.P. 199-125-002

S.A.P. 199-125-002 LOCATED 164TH LANE BETWEEN JARVIS STREET NW AND ANDRIE STREET NW
 S.A.P. 199-126-002 LOCATED ANDRIE STREET BETWEEN 164TH LANE NW AND ALPINE DRIVE NW
 FROM NW 1/4 OF THE NW 1/4 OF S18, T32, R25 TO SE 1/4 OF THE NW 1/4 OF S19, T32, R25

GOVERNING SPECIFICATIONS

THE 2016 EDITION OF THE MINNESOTA DEPARTMENT OF TRANSPORTATION "STANDARD SPECIFICATIONS FOR CONSTRUCTION" SHALL GOVERN.

ALL FEDERAL, STATE AND LOCAL LAWS, REGULATIONS AND ORDINANCES SHALL BE COMPLIED WITH IN THE CONSTRUCTION OF THIS PROJECT.

ALL TRAFFIC CONTROL DEVICES AND SIGNING SHALL CONFORM TO THE MINNESOTA MANUAL ON UNIFORM TRAFFIC CONTROL DEVICES, INCLUDING THE FIELD MANUAL FOR TEMPORARY TRAFFIC CONTROL ZONE LAYOUTS.

SHEET INDEX

THIS PLAN CONTAINS 67 SHEETS

SHEET NO.	DESCRIPTION
1	TITLE SHEET
2	SHEET INDEX
3	STATEMENT OF ESTIMATED QUANTITIES
4	STORM SEWER SUMMARY
5	EARTHWORK SUMMARY
6	TYPICAL SECTIONS
7	PROJECT NOTES AND LEGEND
8	EROSION CONTROL DETAILS
9	STORM SEWER DETAILS
10	STREET DETAILS
11-15	PEDESTRIAN RAMP DETAILS
16-17	PEDESTRIAN RAMP LAYOUT
18-23	REMOVALS
24-29	EROSION CONTROL PLAN
30	ALIGNMENT LAYOUT
31-36	STREET AND STORM SEWER
37-39	STORM SEWER
40	STRIPING PLAN
41-42	SWPPP
43-67	CROSS SECTIONS

LEGEND

	MAILBOX		EASEMENT
	LIGHT POLE		RIGHT OF WAY
	TREE		ELECTRIC
	SHRUB		GAS
	SIGN		TELECOMMUNICATIONS
	POLE		STORM SEWER
	FLOOD LIGHT		TREE LINE
	VALVE		SPLIT RAIL FENCE
	UTILITY PEDESTAL		LANDSCAPING
	HAND HOLE		RETAINING WALL
	EXISTING CATCH BASIN		5' CONTOUR LINE
	EXISTING MANHOLE		1' CONTOUR LINE
	EXISTING FLARED END		SILT FENCE
	REMOVE TREE		
	3'x2' CATCH BASIN		
	CATCH BASIN MANHOLE		
	INLET PROTECTION		
	RECLAIM BITUMINOUS PAVEMENT		
	EDGE MILL		
	REMOVE BITUMINOUS PAVEMENT		
	REMOVE BITUMINOUS DRIVE		
	REMOVE CONCRETE DRIVE		
	REMOVE GRAVEL DRIVE		
	CONCRETE DRIVE		
	BITUMINOUS DRIVE		
	GRAVEL DRIVE		
	RIP RAP		
	SOD		
	EROSION CONTROL BLANKET		
	CLEARING AND GRUBBING		

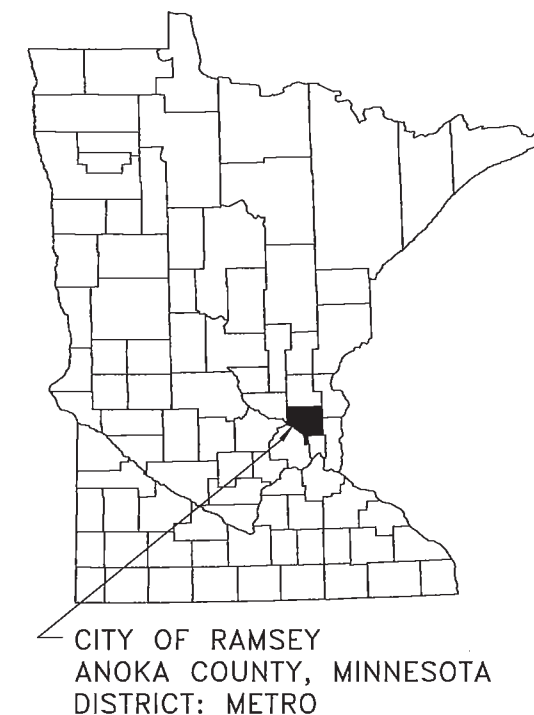
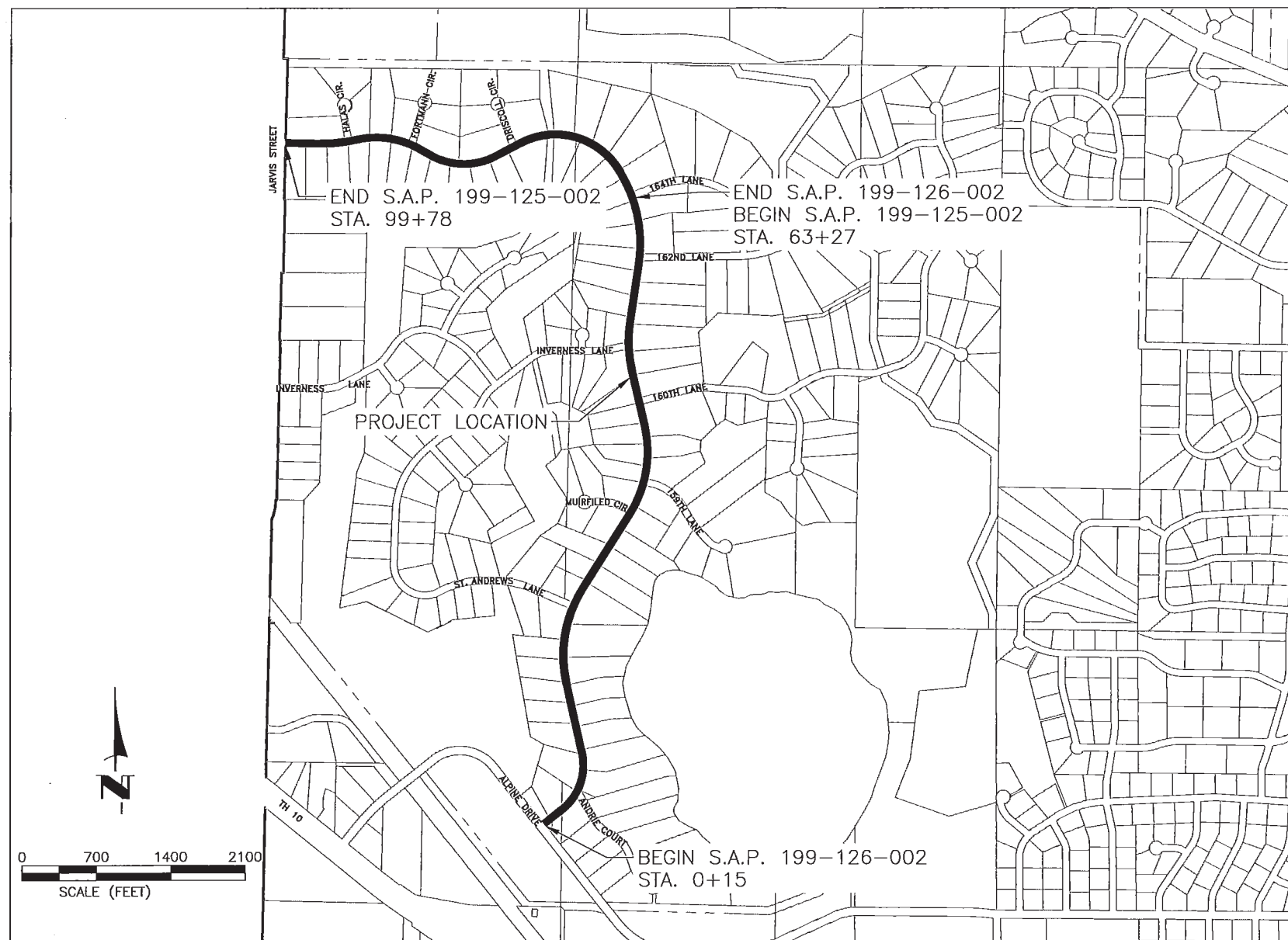

THE SUBSURFACE UTILITY INFORMATION IN THIS PLAN IS UTILITY QUALITY LEVEL D. THIS QUALITY LEVEL WAS DETERMINED ACCORDING TO THE GUIDELINES OF CI/ASCE 38-02, ENTITLED "STANDARD GUIDELINES FOR THE COLLECTION AND DEPICTION OF EXISTING SUBSURFACE UTILITY DATA."

NOTE: EXISTING UTILITY INFORMATION SHOWN ON THIS PLAN HAS BEEN PROVIDED BY THE UTILITY OWNER. THE CONTRACTOR SHALL FIELD VERIFY EXACT LOCATIONS PRIOR TO COMMENCING CONSTRUCTION AS REQUIRED BY STATE LAW. NOTIFY GOPHER STATE ONE CALL 1-800-252-1166 OR 651-454-0002



NO.	PROJECT	STA. TO STA.	GROSS LENGTH	BRIDGE LENGTH	NET LENGTH	NET LENGTH (MILES)	ADT (2015)	ADT (2036)	DESIGN ESAL	R VALUE	TON DESIGN	DESIGN SPEED	NUMBER OF LANES	WIDTH OF LANES	NUMBER OF PARKING LANES	WIDTH OF LANES	FUNCTIONAL CLASSIFICATION
①	S.A.P. 199-126-002 ANDRIE STREET	0+15 TO 63+27	6312 FT	0 FT	6312 FT	1.20 MI.	1360	1790	361,000	40	10	30	2	NB - 11' SB - 11'	1	8'	COLLECTOR
②	S.A.P. 199-125-002 164TH LANE	63+27 TO 99+78	3651 FT	0 FT	3651 FT	0.69 MI.	440	470	361,000	40	10	30	2	WB - 11' EB - 11'	1	8'	COLLECTOR

CITY OF RAMSEY
 7550 SUNWOOD DRIVE
 RAMSEY, MN 55303
 (763) 427-1410 FAX (763) 433-9898

STOPPING SIGHT DISTANCE BASED ON:
 3.5 FT - HEIGHT OF EYE
 2.0 FT - HEIGHT OF OBJECT

DATUM:
 VERTICAL: NAVD 88
 HORIZONTAL: ANOKA COUNTY COORDINATES (1996 ADJUSTMENT)

DATE	REVISION

I hereby certify that this plan, specification, or report was prepared by me or under my direct supervision and that I am a duly Licensed Professional Engineer under the laws of the State of Minnesota.

Bruce R Westby 40116 DATE 4/1/16
 BRUCE R WESTBY, P.E. LIC. NO.
 RAMSEY CITY ENGINEER

John Diesel DATE 4/6/16
 DISTRICT STATE AID ENGINEER: REVIEWED FOR COMPLIANCE WITH STATE AID RULES/POLICY

John Diesel DATE 4/6/16
 STATE AID ENGINEER: APPROVED FOR STATE AID FUNDING

SHEET 1 OF 67 SHEETS

Mar 30, 2016 - 2:26pm C:\Engineering\AutoCad Drawings\Projects A-W\Andrie Street and 164th Avenue\Plan Drawings\Cover Sheet.dwg