

Hello, I am seeking a CUP for my property to allow for automotive uses, specifically the auto repair use.

I am fine with there being stipulations, such as how many vehicles can be parked outside, limiting the vehicles parked outside to being un-damaged if there is not screening / coverage to hide them, requiring the businesses operating in the spaces to be either contractors working on their own vehicles or repair shops that pick up clients vehicles / have them dropped off due to there not being a waiting room within the spaces.

I would like to keep the appearance of the exterior of the property no different from if there were any other use taking place within the property.

In addition, in my lease that tenants sign it does actually detail parking limitations as well to avoid excess vehicles being at the property. I would also be willing to add additional limitations to the lease detailing the stipulations listed above.

Sincerely,

Josh Clark

# Parking

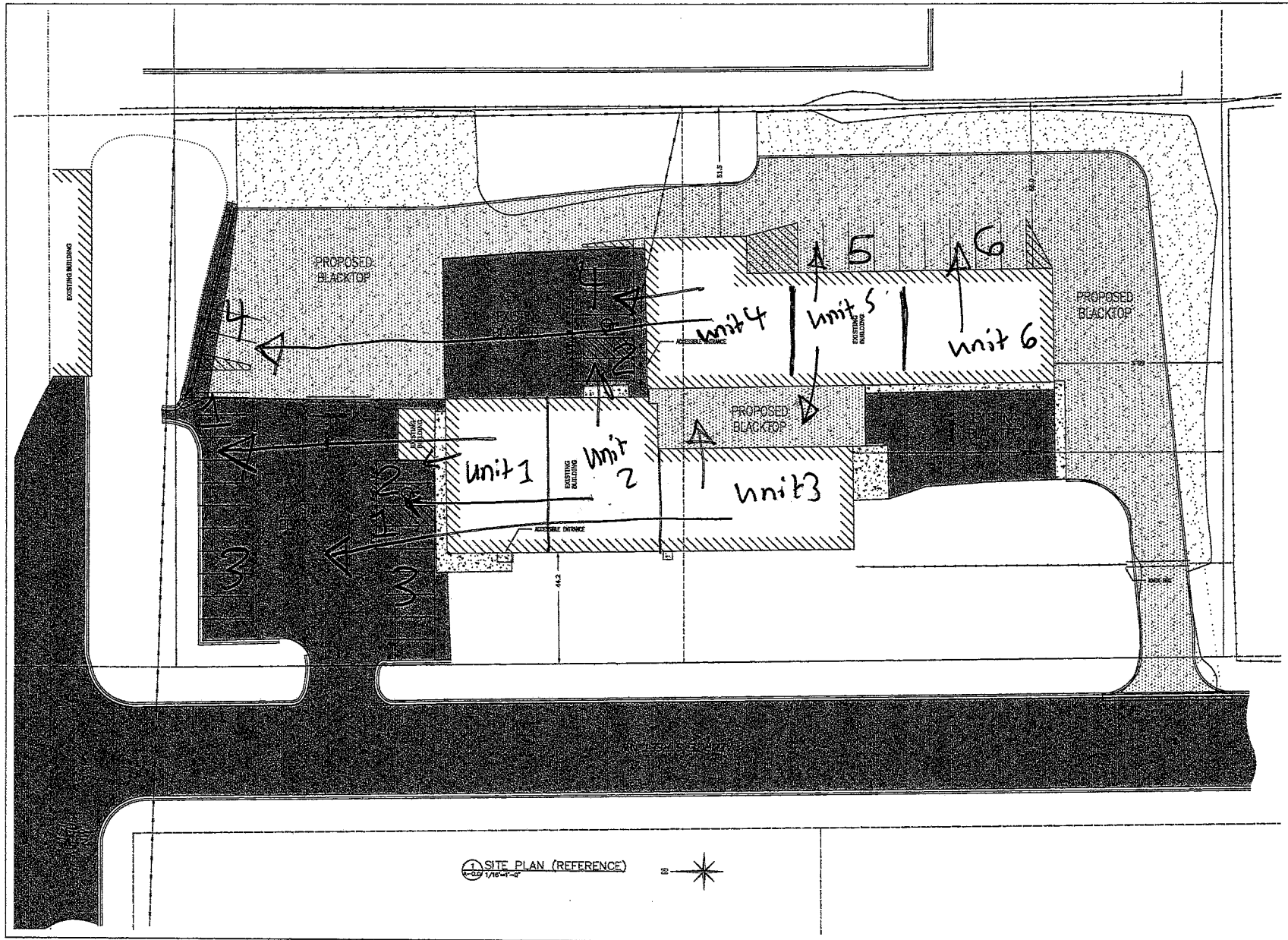

1 SITE PLAN (REFERENCE)  
1/16"=1'-0"



El-Nagdy  
Architects

100% TAKING OF SE.  
RENDERINGS, NOT SCALE  
PROVIDED FOR REVIEW

consultants

DATE: 2/21/2025  
BY: A. EL-NAGDY  
CHECKED BY: A. EL-NAGDY  
SCALE: AS SHOWN

I HEREBY CERTIFY THAT THIS PLAN  
APPROVED AS SHOWN AND PRINTED IS  
A TRUE AND CORRECT REPRESENTATION AND  
SCALE OF THE PROJECT AS APPROVED AND  
RECORDED BY THE CITY OF RAMSEY.

certification

REVISION 1 6/13/2025  
REVISION 2 7/15/2025  
REVISION 3 11/14/2025

revisions

project title

Title  
14047  
AZURITE ST. NW  
RAMSEY  
MN, 55303

SITE PLAN  
REFERENCE

A-0.0