



Arizona Department of Liquor Licenses and Control
 800 W Washington 5th Floor
 Phoenix, AZ 85007-2934
 www.azliquor.gov
 (602) 542-5141

AFFIDAVIT OF POSTING

Date of Posting: April 4, 2016 Date of Posting Removal: May 3, 2016

Applicant's Name: Menett Lauren Kay
Last First Middle

Business Address: 1645 Juan Sanchez Blvd. San Luis 85349
Street City Zip

License #: 10143179

I hereby certify that pursuant to A.R.S. 4-201, I posted notice in a conspicuous place on the premises proposed to be licensed by the above applicant and said notice was posted for at least twenty (20) days.

Sonia Cornelio City clerk 928.341.8520
Print Name of City/County Official Title Phone Number

[Signature] May 3, 2016
Signature Date Signed

Return this affidavit with your recommendations (i.e., Minutes of Meeting, Verbatim, etc.) or any other related documents. If you have any questions please call (602) 542-5141 and ask for the Licensing Division.

NOTICE

APPLICATION TO SELL ALCOHOLIC BEVERAGES

DATE POSTED: April 4, 2016

A HEARING ON A LIQUOR LICENSE APPLICATION SHALL BE HELD BEFORE THE

City of San Luis City Council

PLACE 1090 E. Union St, San Luis, AZ DATE/TIME May 11, 2016 @ 7:00 pm

HEARING DATES SUBJECT TO CHANGE, TO VERIFY CALL: 928-341-8520

THE LOCAL GOVERNING BODY WILL RECOMMEND TO THE STATE LIQUOR BOARD WHETHER THE BOARD SHOULD GRANT OR DENY THE LICENSE. THE STATE LIQUOR BOARD MAY HOLD A HEARING TO CONSIDER THE RECOMMENDATION OF THE LOCAL GOVERNING BODY. ANY PERSON RESIDING OR OWNING OR LEASING PROPERTY WITHIN A ONE-MILE RADIUS MAY CONTACT THE STATE LIQUOR BOARD IN WRITING TO REGISTER AS A PROTESTER. TO REQUEST INFORMATION REGARDING PROCEDURES BEFORE THE BOARD AND NOTICE OF ANY BOARD HEARINGS REGARDING THIS APPLICATION, CONTACT THE **STATE LIQUOR BOARD:** 800 W. WASHINGTON, 5TH FLOOR, PHOENIX, AZ. 85007 (602) 542-9789

INDIVIDUALS REQUIRING ADA ACCOMMODATIONS CALL - LOCAL GOVERNING BODY: 928-341-8520 STATE LIQUOR DEPT: (602) 542-9789

POST ONE COPY OF THE APPLICATION FORM BELOW THIS NOTICE.



Arizona Department of Liquor Licenses and Control
 800 W Washington 5th Floor
 Phoenix, AZ 85007
 www.azliquor.gov
 (602) 542-5141

MAR 24 11:49 AM 101034

Application for Liquor License
 Type or Print with Black Ink

SECTION 1 This application is for a:

- Interim Permit (Complete Section 5)
- New License (Complete Sections 2, 3, 4, 13, 14, 15, 16)
- Person Transfer (Complete Section 2, 3, 4, 12, 13, 14, 16)
- Location Transfer (Bars and Liquor Stores Only)
(Complete Section 2, 3, 4, 11, 13, 14, 16)
- Probate/ Will Assignment/ Divorce Decree
(Complete Sections 2, 3, 4, 9, 13, 14, 16)
(Fee not required)
- Government (Complete Sections 2, 3, 4, 10, 13, 16)
- Seasonal

SECTION 2 Type of Ownership:

- J.T.W.R.O.S. (Complete Section 6)
- Individual (Complete Section 6)
- Partnership (Complete Section 6)
- Corporation (Complete Section 7)
- Limited Liability Co (Complete Section 7)
- Club (Complete Section 8)
- Government (Complete Section 10)
- Trust (Complete Section 6)
- Tribe (Complete Section 6)
- Other (Explain) _____

SECTION 3 Type of license

LICENSE # 10143179

1. Type of License: Series 10

APPLICATION FEE AND INTERIM PERMIT FEES (IF APPLICABLE) ARE NOT REFUNDABLE
 A service fee of \$25 will be charged for all dishonored checks (A.R.S. § 44-6852)

SECTION 4 Applicants

1. Individual Owner/Agent's Name: Merrett Lauren Kay P1036740
Last First Middle

2. Owner Name: Super C Fuel, LLC B1056395
(Ownership name for type of ownership checked on section 2)

3. Business Name: Super C
(Exactly as it appears on the exterior of premises)

4. Business Location Address: 1645 Juan Sanchez Blvd San Luis AZ 85349 Yuma B1023443
(Do not use PO Box) Street City State Zip Code County

5. Mailing Address: 736 S Longmore St Chandler AZ 85224
(All correspondence will be mailed to this address) Street City State Zip Code

6. Business Phone: 928-627-5725 Daytime Contact Phone: 602-738-1421

7. Email Address: N/A

8. Is the Business located within the incorporated limits of the above city or town? Yes No

9. Does the Business location address have a street address for a City or Town but is actually in the boundaries of another City, Town or Tribal Reservation? Yes No

If Yes, what City, Town or Tribal Reservation is this Business located in: _____

10. Total Price paid for Series 6 Bar, Series 7 Beer & Wine Bar or Series 9 Liquor Store (license only) \$ _____

Fees: <u>\$100.00</u>	<u>\$100.00</u>	Department Use Only	<u>\$22.00</u>	<u>\$22.00</u>
<small>Application</small>	<small>Interim Permit</small>	<small>Site Inspection</small>	<small>Finger Prints</small>	<small>Total of All Fees</small>
Is Arizona Statement of Citizenship & Alien Status for State Benefits complete? <input checked="" type="checkbox"/> Yes <input type="checkbox"/> No				
Accepted by: <u>[Signature]</u>		Date: <u>3/24/16</u> License # <u>10143179</u>		

SECTION 5 Interim Permit

- If you intend to operate business when your application is pending you will need an interim permit pursuant to ARS § 4-203.01
- There **MUST** be a valid license of the same type you are applying for currently issued to the location or for the replacement of a Hotel/Motel license with a Restaurant license pursuant to A.R.S. § 4-203.01.

1. Enter license number currently at the location: 10143048

2. Is the license currently in use? Yes No If no, how long has it been out of use? _____

Attach a copy of the license currently issued at this location to this application.

I, Laura Bertha Fernandez declare that I am the CURRENT OWNER, AGENT, OR CONTROLLING PERSON on the stated license and location.

(Print Full Name)
Laura Bertha Fernandez
(Signature)

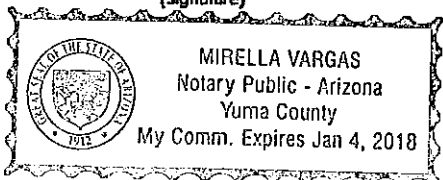

My Commission Expires on: 01/04/2018
Date

State AZ County of Yuma
The foregoing instrument was acknowledged before me this
10th day of March, 2016
Day Month Year
Mirella Vargas
(Signature of Notary Public)

SECTION 6 Individual, Partnership, J.T.W.R.O.S, Trust, Tribe Ownerships

EACH PERSON LISTED MUST SUBMIT A COMPLETED QUESTIONNAIRE, AN "APPLICANT" TYPE FINGERPRINT CARD AND \$22 PROCESSING FEE FOR EACH CARD.

Individual

Last	First	Middle	%Owned	Mailing Address	City	State	Zip Code

Is any person other than above, going to share in profit/losses of the business? Yes No

If Yes, give name, current address, and telephone number of person(s). Use additional sheets if necessary.

Last	First	Middle	Mailing Address	City	State	Zip Code	Phone #

Partnership

Name of Partnership: _____

General-Limited	Last	First	Middle	%Owned	Mailing Address	City	State	Zip Code
<input type="checkbox"/>								
<input type="checkbox"/>								
<input type="checkbox"/>								
<input type="checkbox"/>								

J.T.W.R.O.S (Joint Tenant with Rights of Survivorship)

Name of J.T.W.R.O.S: _____

Last	First	Middle	Mailing Address	City	State	Zip Code

STATE OF ARIZONA
DEPARTMENT OF LIQUOR LICENSES
AND CONTROL
ALCOHOLIC BEVERAGE LICENSE
License 10143048

Issue Date: 2/17/2000

Expiration Date: 7/31/2016

Issued To:

LAURA BERTHA FERNANDEZ, Agent
SERVICIO EL NORTENO INC, Owner

Mailing Address:

LAURA BERTHA FERNANDEZ
SERVICIO EL NORTENO INC
SUPER C
2954 N CAMPBELL AVE PMB #347
TUCSON, AZ 85719

Location:

SUPER C
1645 JUAN SANCHEZ BLVD
SAN LUIS, AZ 85349



POST THIS LICENSE IN A CONSPICUOUS PLACE

SECTION 6 - continued

16 MAR 24 11:47:11 AM 10084

TRUST

Name of Trust: _____

Last	First	Middle	Mailing Address	City	State	Zip Code

TRIBE

Name of Tribal Ownership: _____

Last	First	Middle	Mailing Address	City	State	Zip Code

SECTION 7 Corporations/ Limited Liability Co

EACH PERSON LISTED MUST SUBMIT A COMPLETED QUESTIONNAIRE AN "APPLICANT" TYPE FINGERPRINT CARD AND \$22 PROCESSING FEE FOR EACH CARD.

Corporation Complete Questions 1, 2, 3, 4, 5, 6, and 7

L.L.C. Complete Questions 1, 2, 3, 4, 5, 6, and 7

- Name of Corporation/LLC: Super C Fuel, LLC
- Date Incorporated/Organized: 11/11/2015 State where Incorporated/Organized: AZ
- AZ Corporation or AZ L.L.C File No: L-20466440 Date authorized to do Business in AZ: 11/13/2015
- Is Corp/LLC Non Profit? Yes No
- List Directors, Officers, Members in Corporation/LLC:

Last	First	Middle	Title	Mailing Address	City	State	Zip Code
Somani	Saleema		Member	1042 N 51st Ave	Phoenix	AZ	85043

(Attach additional sheet if necessary)

6. List all Stockholders / percentage owners who own 10% or more:

Last	First	Middle	%Owned	Mailing Address	City	State	Zip Code
Somani	Saleema		100%	1042 N 51st Ave	Phoenix	AZ	85043

(Attach additional sheet if necessary)

7. If the corporation/ L.L.C are owned by another entity, attach an Organizational **FLOWCHART** showing the structure of the ownership. Attach additional sheets as needed in order to disclose the Officers, Directors, Members, Managers, Partners, Stockholders and percentage owners of those entities.

SECTION 12 Person to Person Transfer

16 MAR 24 10:17 AM 10184

Questions to be completed by Current Licensee (Bar and Liquor Stores Only- Series, 06, 07, and 09)

1. Individual Owner / Agent Name: _____ Entity: _____
Last First Middle (Individual, Agent, Etc)

2. Ownership Name: _____
(Exactly as it appears on license)

3. Business Name: _____
(Exactly as it appears on license)

4. Business Location Address: _____
Street City State Zip

5. License Type: _____ License Number: _____

6. Current Mailing Address: _____
Street City State Zip

7. Have all creditors, lien holders, interest holders, etc. been notified? Yes No

8. Does the applicant intend to operate the business while this application is pending? Yes No

If yes, complete Section 5 (Interim Permit) of this application; attach fee, and current license to this application.

9. I, (Print Full Name) _____ hereby authorize the department to process this Application to transfer the privilege of the license to the applicant provided that all terms and conditions of sale are met. Based on the fulfillment of these conditions, I certify that the applicant now owns or will own the property rights of the license by the date of issue.

I, (Print Full Name) _____, declare that I am the **CURRENT OWNER, MEMBER, PARTNER STOCKHOLDER or LICENSEE** of the stated license. I have read the above Section 12 and confirm that all statements are true, correct, and complete.

NOTARY

X (Signature) _____

State of _____ County of _____
The foregoing instrument was acknowledged before me this

_____ of _____
Day Month Year

My commission expires on: _____

Signature of NOTARY PUBLIC

SECTION 13 Proximity to Church or School

Questions to be completed by all in-state applicants EXCLUDING those applying for a Series 5 Government, Series 11 Hotel/Motel, and Series 12 Restaurant licenses.

A.R.S. § 4-207 (A) and (B) state that no retailer's license shall be issued for any premises which are at the time the license application is received by the director, within three hundred (300) horizontal feet of a church, within three hundred (300) horizontal feet of a public or private school building with kindergarten programs or grades one (1) through (12) or within three hundred (300) horizontal feet of a fenced recreational area adjacent to such school building. The above paragraph DOES NOT apply to:

- a) Restaurant license (§ 4-205.02)
- b) Hotel/motel license (§ 4-205.01)
- c) Government license (§ 4-205.03)
- d) Fenced playing area of a golf course (§ 4-207(B)(5))

1. Distance to nearest School: 524 ft Name of School: Southwest Middle School
(if less than one (1) mile note footage)
 Address: 963 N 8th Ave, San Luis, AZ 85349

2. Distance to nearest Church: 980 ft Name of Church: Apostolic Assembly Church
(if less than one (1) mile note footage)
 Address: 1330 Kennedy Ln, San Luis, AZ 85349

SECTION 14 Business Financials

1. I am the: Lessee Sub-lessee Owner Purchaser Management Company

2. If the premise is leased give lessors: Name: _____
 Address: _____
Street City State Zip

3. Monthly Rent/ Lease Rate: \$ _____

4. What is the remaining length of the lease? _____ Years _____ Months

5. What is the penalty if the lease is not fulfilled? \$ _____ or other: _____
(Give details-attach additional sheet if necessary)

6. Total money borrowed for the Business not including lease? \$ 0 purchased with profits from other stores owned in Phx
 Please List Lenders/People you owe money to for business.

Last	First	Middle	Amount Owed	Mailing Address	City	State	Zip

(Attach additional sheet if necessary)

7. What type of business will this license be used for (be specific)?

8. Has a license or a transfer license for the premises on this application been denied by the state with in the past (1) year? Yes No if yes, attach explanation.

9. Does any spirituous liquor manufacture, wholesaler, or employee have an interest in your business? Yes No

10. Is the premises currently license with a liquor license? Yes No

If yes, give license number and licensee's name:

License #: 10143048 Individual Owner /Agent Name: Laura Bertha Fernandez
(Exactly as it appears on license)

AMENDMENT

RECEIVED
 2016 APR 19 AM 10:50
 CITY OF SAN LUIS
 OFFICE OF THE CITY CLERK

15 APR 19 11:41 AM EST

SECTION 13 Proximity to Church or School

716 MAR 24 LIQ. LIC. AM1034

Questions to be completed by all in-state applicants **EXCLUDING** those applying for a Series 5 Government, Series 11 Hotel/Motel, and Series 12 Restaurant licenses.

A.R.S. § 4-207 (A) and (B) state that no retailer's license shall be issued for any premises which are at the time the license application is received by the director, within three hundred (300) horizontal feet of a church, within three hundred (300) horizontal feet of a public or private school building with kindergarten programs or grades one (1) through (12) or within three hundred (300) horizontal feet of a fenced recreational area adjacent to such school building. The above paragraph DOES NOT apply to:

- a) Restaurant license (§ 4-205.02)
- b) Hotel/motel license (§ 4-205.01)
- c) Government license (§ 4-205.03)
- d) Fenced playing area of a golf course (§ 4-207(B)(5))

1. Distance to nearest School: 5000 ft Name of School: Rio Colorado Elem School
 (if less than one (1) mile note footage) Address: 2288 S. Hwy 95 San Luis AZ 85349

2. Distance to nearest Church: 6000 ft Name of Church: St. Jude Thord deus
 (if less than one (1) mile note footage) Address: 2279 S Hwy 95 San Luis 85349

SECTION 14 Business Financials

1. I am the: Lessee Sub-lessee Owner Purchaser Management Company

2. If the premise is leased give lessors: Name: _____
 Address: _____
 Street City State Zip

3. Monthly Rent/ Lease Rate: \$ _____

4. What is the remaining length of the lease? _____ Years _____ Months

5. What is the penalty if the lease is not fulfilled? \$ _____ or other: _____
 (Give details-attach additional sheet if necessary)

6. Total money borrowed for the Business not including lease? \$ 0 purchased with profits from other
 Please List Lenders/People you owe money to for business. stores owned in Phx

Last	First	Middle	Amount Owed	Mailing Address	City	State	Zip

(Attach additional sheet if necessary)

7. What type of business will this license be used for (be specific)?

CONVENIENCE STORE

8. Has a license or a transfer license for the premises on this application been denied by the state within the past (1) year? Yes No If yes, attach explanation.

9. Does any spirituous liquor manufacture, wholesaler, or employee have an interest in your business? Yes No

10. Is the premises currently license with a liquor license? Yes No

If yes, give license number and licensee's name:

License #: 10143048 Individual Owner /Agent Name: Laura Bertha Fernandez
 (Exactly as it appears on license)

SECTION 15 Restaurant or hotel/motel license applicants

16 MAR 24 11:11 AM 10:34

- 1. Is there an existing Restaurant or Hotel/Motel Liquor License at the proposed location? Yes No
- 2. If the answer to Question 1 is YES, you may qualify for an Interim Permit to operate while your application is pending; consult A.R.S. § 4-203.01; and complete SECTION 5 of this application.
- 3. All Restaurant and Hotel/Motel applicants must complete a Restaurant Operation Plan form provided by the Department of Liquor Licenses and Control.
- 4. As stated in A.R.S. § 4-205.02. (H)(2), a Restaurant is an establishment which derives at least forty (40) percent of its gross revenue from the sale of food. Gross revenue is the revenue derived from sales of food and spirituous liquor on the licensed premises. By applying for this Restaurant Hotel/Motel, I certify that I understand that I must maintain a minimum of forty (40) percent food sales based on these definitions and have included the Restaurant Hotel/Motel Records Required for Audit form with this application.

(Applicant's Signature)

5. I understand it is my responsibility to contact the Department of Liquor Licenses and Control to schedule an inspection when all tables and chairs are on site, kitchen equipment, and, if applicable, patio barriers are in place on the licensed premises. With the exception of the patio barriers, these items are not required to be properly installed for this inspection. Failure to schedule an inspection will delay issuance of the license. If you are not ready for your inspection 90 days after filing your application, please request an extension in writing; specify why the extension is necessary; and the new inspection date you are requesting.

(Applicant's Initials)

SECTION 16 Diagram of Premises

Check ALL boxes that apply to your business:

- Entrances/Exits Liquor storage areas **Patio:** Contiguous
- Walk-up windows Drive-through windows Non Contiguous

1. Is your licensed premises currently closed due to construction, renovation or redesign? Yes No
If yes, what is your estimated completion date? _____

Month/Day/Year

- 2. **Restaurants and Hotel/Motel** applicants are required to draw a detailed floor plan of the kitchen and dining areas including the locations of all kitchen equipment and dining furniture. Place for diagram is on section 16 number 6.
- 3. The diagram (a detailed floor plan) you provide is required to disclose only the area(s) where spirituous liquor is to be sold, served, consumed, dispensed, possessed or stored on the premises unless it is a restaurant (see # 3 above).
- 4. Provide the square footage or outside dimensions of the licensed premises. Please do not include non-licensed premises such as parking lots, living quarters, etc.

As stated in A.R.S. § 4-207.01 (B), I understand it is my responsibility to notify the Department of Liquor Licenses and Control when there are changes to the boundaries, entrances, exits, added or deleted doors, windows, service windows or increase or decrease to the square footage after submitting this initial diagram.

(Applicant's Initials)

SECTION 16 Diagram of Premises – continued

6. On the diagram please show only the areas where spirituous liquor is to be sold, served, consumed, dispensed, possessed or stored. It must show all entrances, exits, interior walls, bars, hi-top tables, dining tables, dining chairs, dance floor, stage, game room, and the kitchen. DO NOT include parking lots, living quarters, etc. When completing diagram, North is up ↑.

If a legible copy of a rendering or drawing of your diagram of the premises is attached to this application, please write the words "DIAGRAM ATTACHED" in the box provided for the diagram on the application.

DIAGRAM OF PREMISES

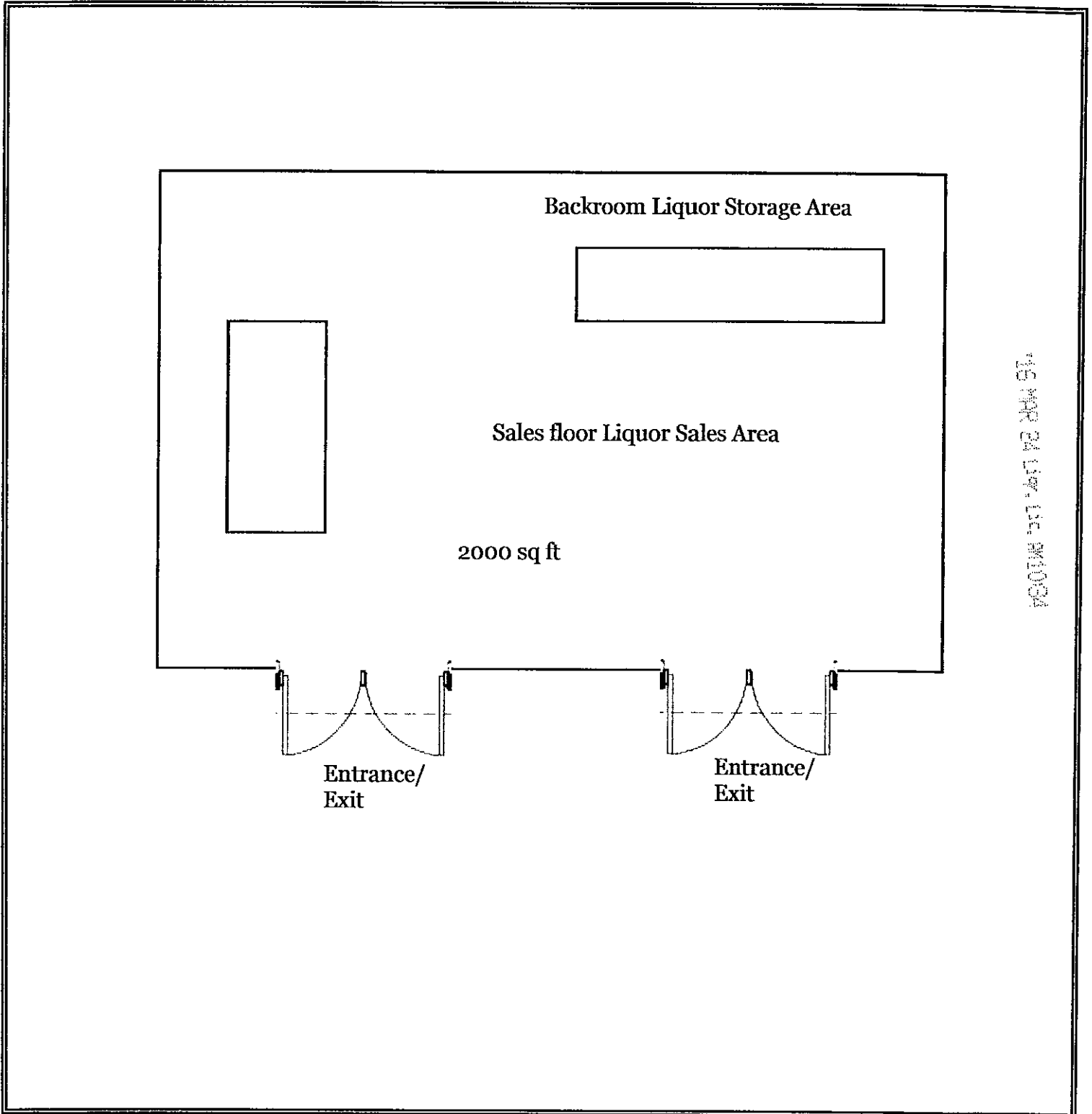

SECTION 17 SIGNATURE BLOCK

NOTARY

I, (Print Full Name) Laural Kay Merrett, hereby declare that I am the Owner/Agent filing this application as stated in Section 4 # 1. I have read this application and verify all statements to be true, correct and complete.

X (Signature) Laural Kay Merrett

State of AZ County of MARICOPA

The foregoing instrument was acknowledged before me this

24 of MARCH, 2016

Day

Month

Year

Debbie Wunderly
Signature of NOTARY PUBLIC

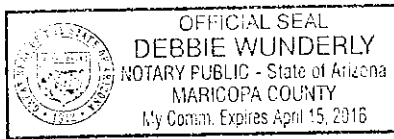

My commission expires on: _____

A.R.S. § 41-1030. Invalidity of rules not made according to this chapter; prohibited agency action; prohibited acts by state employees; enforcement; notice

B. An agency shall not base a licensing decision in whole or in part on a licensing requirement or condition that is not specifically authorized by statute, rule or state tribal gaming compact. A general grant of authority in statute does not constitute a basis for imposing a licensing requirement or condition unless a rule is made pursuant to that general grant of authority that specifically authorizes the requirement or condition.

D. THIS SECTION MAY BE ENFORCED IN A PRIVATE CIVIL ACTION AND RELIEF MAY BE AWARDED AGAINST THE STATE. THE COURT MAY AWARD REASONABLE ATTORNEY FEES, DAMAGES AND ALL FEES ASSOCIATED WITH THE LICENSE APPLICATION TO A PARTY THAT PREVAILS IN AN ACTION AGAINST THE STATE FOR A VIOLATION OF THIS SECTION.

E. A STATE EMPLOYEE MAY NOT INTENTIONALLY OR KNOWINGLY VIOLATE THIS SECTION. A VIOLATION OF THIS SECTION IS CAUSE FOR DISCIPLINARY ACTION OR DISMISSAL PURSUANT TO THE AGENCY'S ADOPTED PERSONNEL POLICY.

F. THIS SECTION DOES NOT ABROGATE THE IMMUNITY PROVIDED BY SECTION 12-820.01 OR 12-820.02.

11 APR 24 10:11 AM '16