

Friendship Park

Proposed Master Plan 2016/2017

Proposed Master Plan Layout

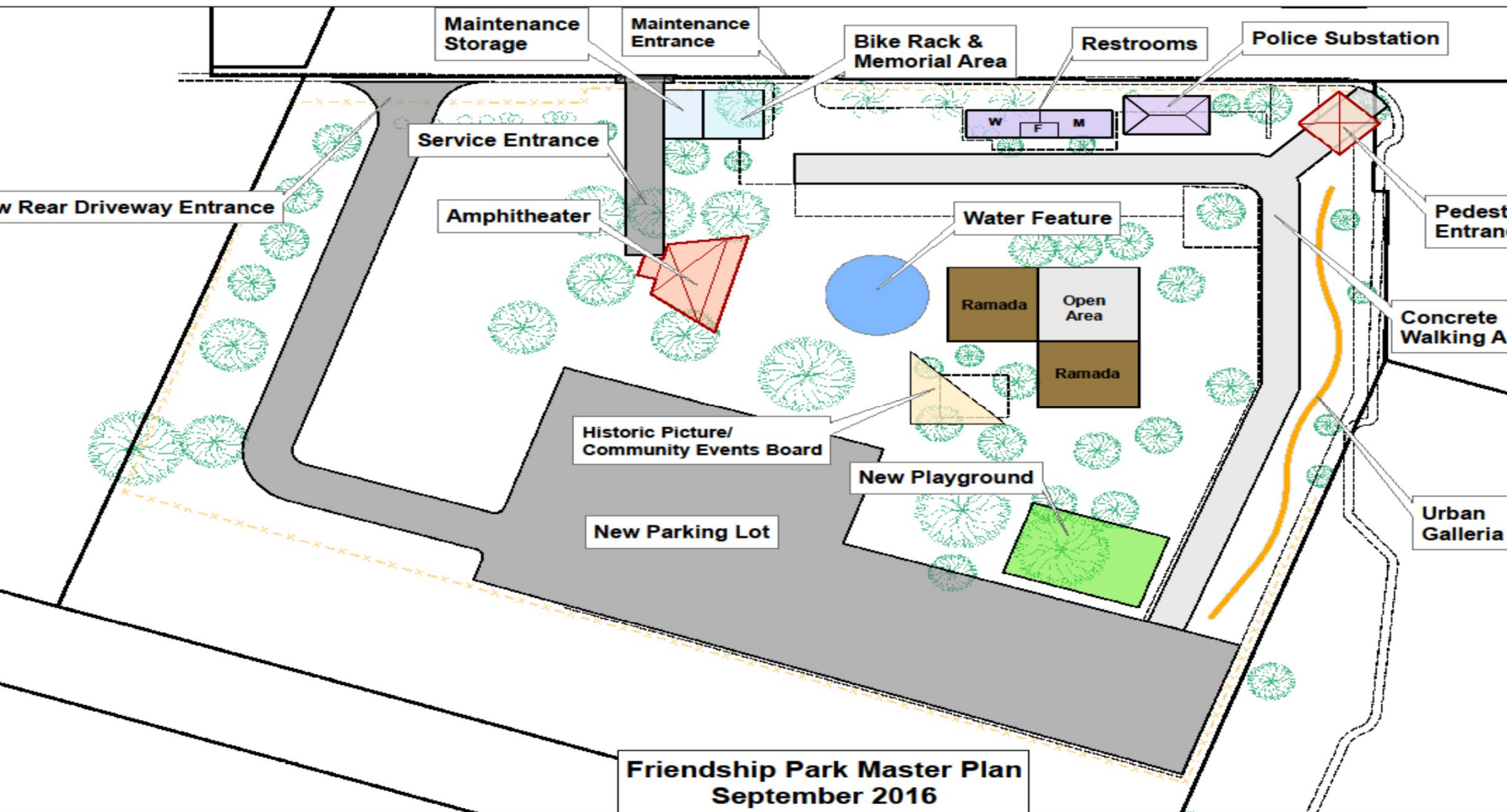

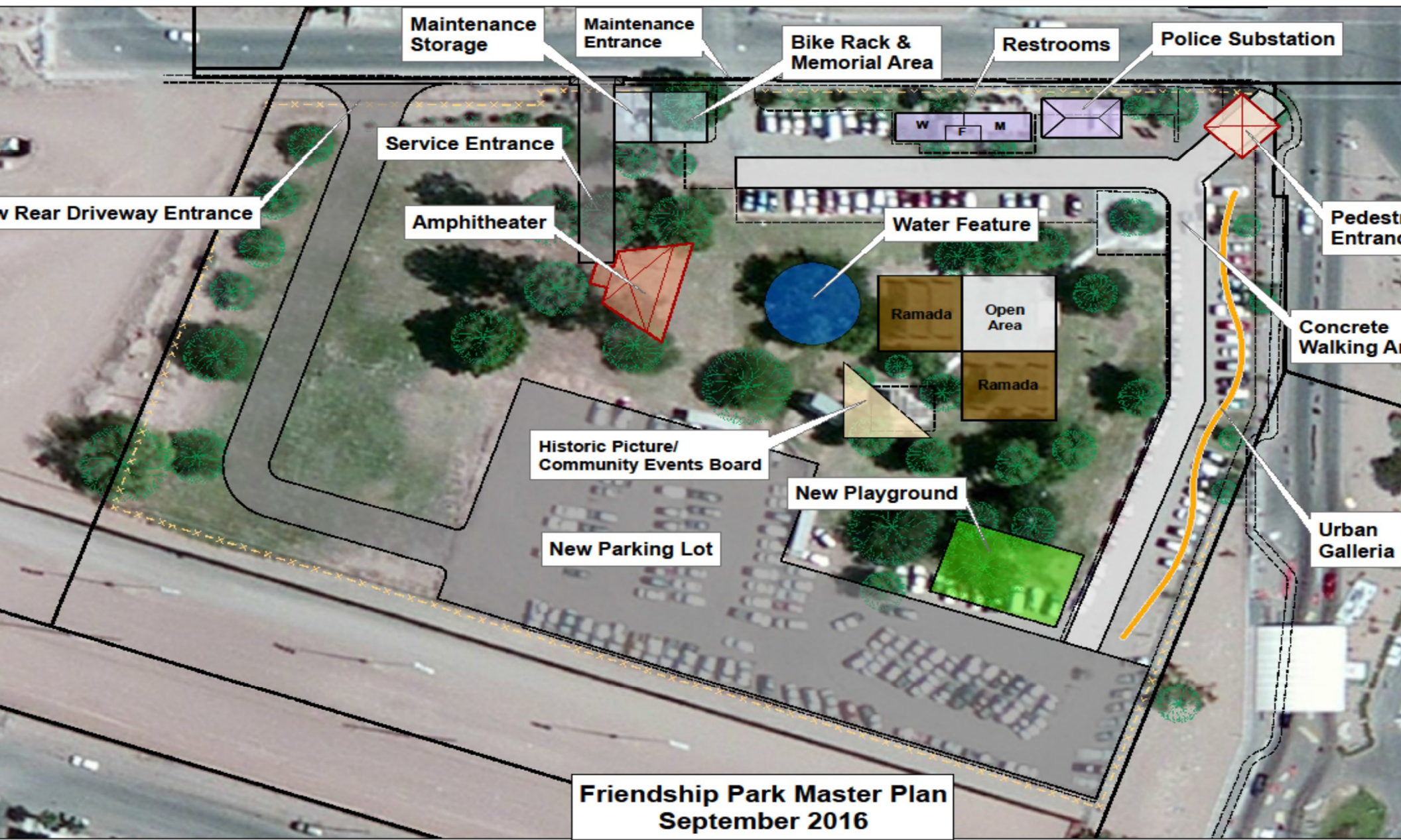

pedestrian Entrance \$7K to \$20K



Playground Area

\$60k to \$150k

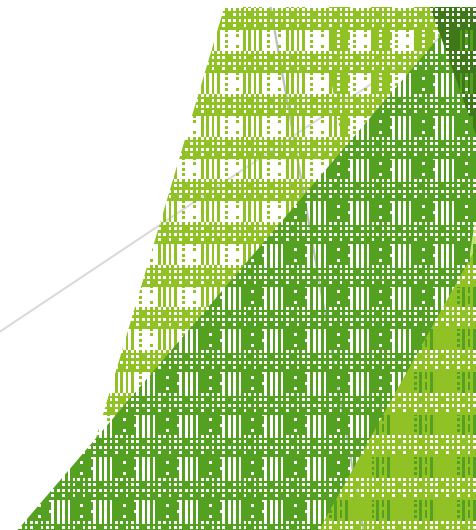

Memorial Bike Rack Area to \$6K

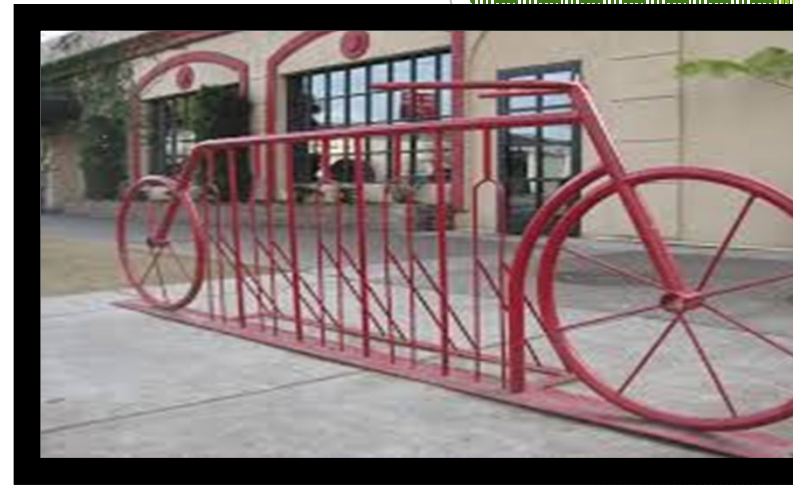

Water Feature Plaza

20K to \$50k



Amphitheater Area

\$30k to \$60K

Modern



Traditional



Kiosk

(Mobile or Permanent)



ade Structures



Gallery Area \$5k to \$20K

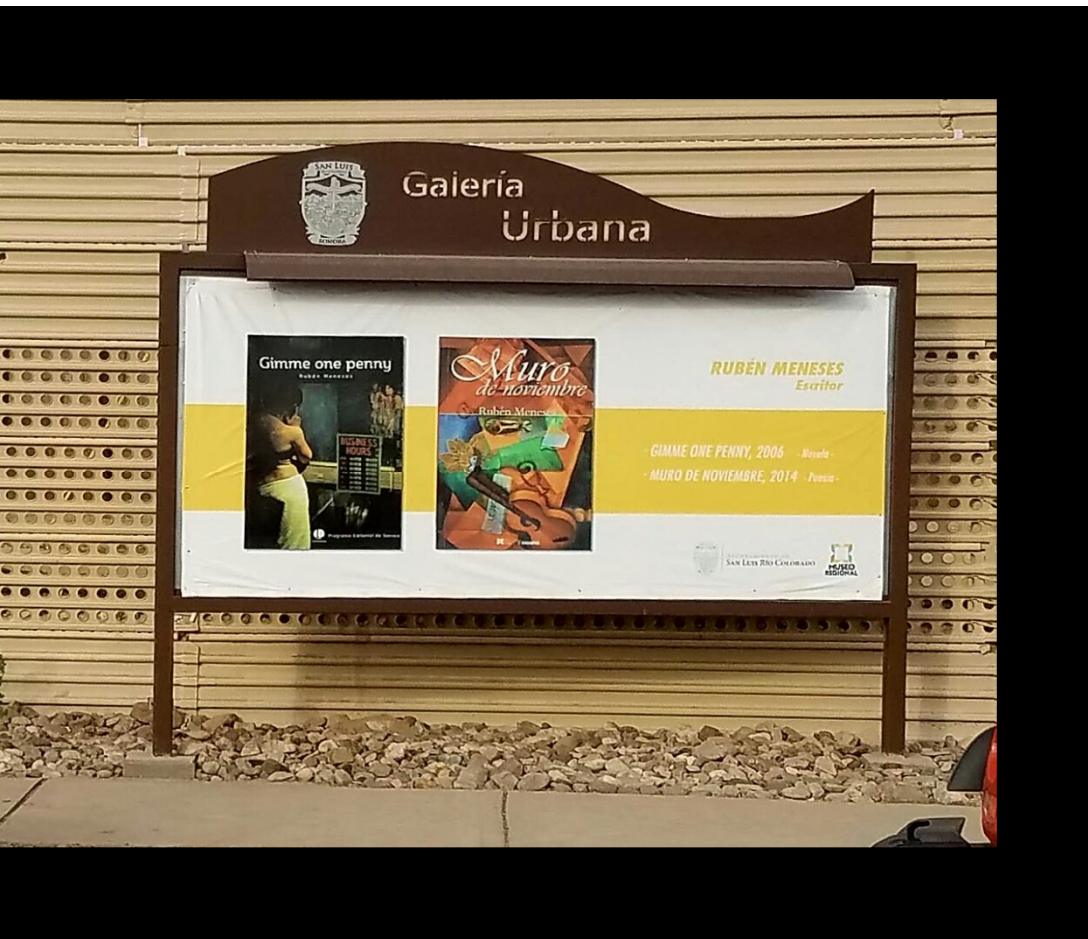

Historic/Visitors Center



Info Calendar/Event Board /Historic Art Work



Police Sub-Station



Parking Lot (Existing)



Area (Proposed)
e Source: (\$3 per day) (100 spaces)
s per year (\$72K per year)





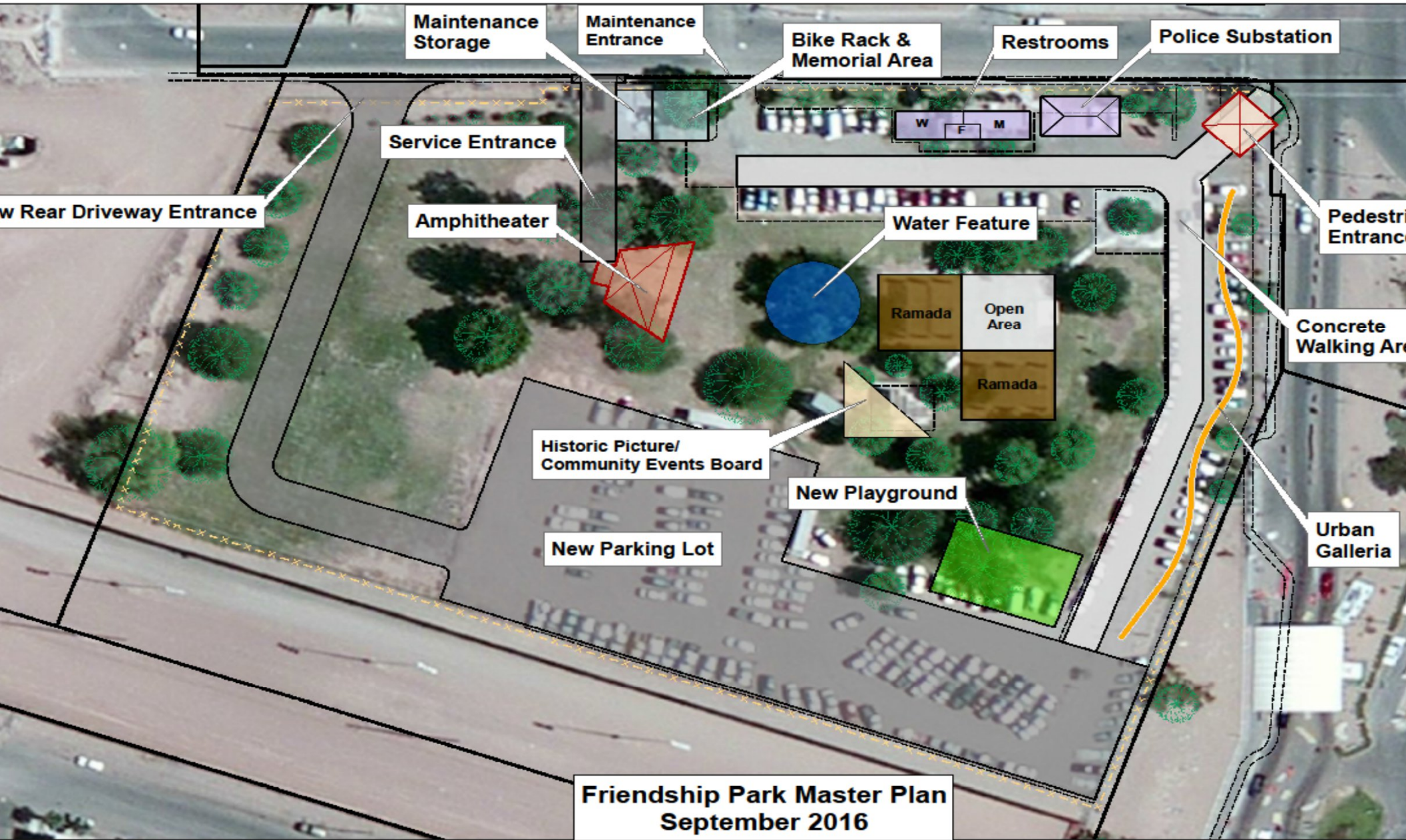

**Friendship Park Master Plan
September 2016**

Proposed Master Plan Layout

