

113'

22.

RECEIVED
R.P.
2015 JUL 13 AM 9:38
DEPT OF DEVEL SERVICES
CITY OF SAN LUIS, AZ

RECEIVED
2015 JUN 14 PM 2:55
DEPT OF DEVEL SERVICES
CITY OF SAN LUIS, AZ

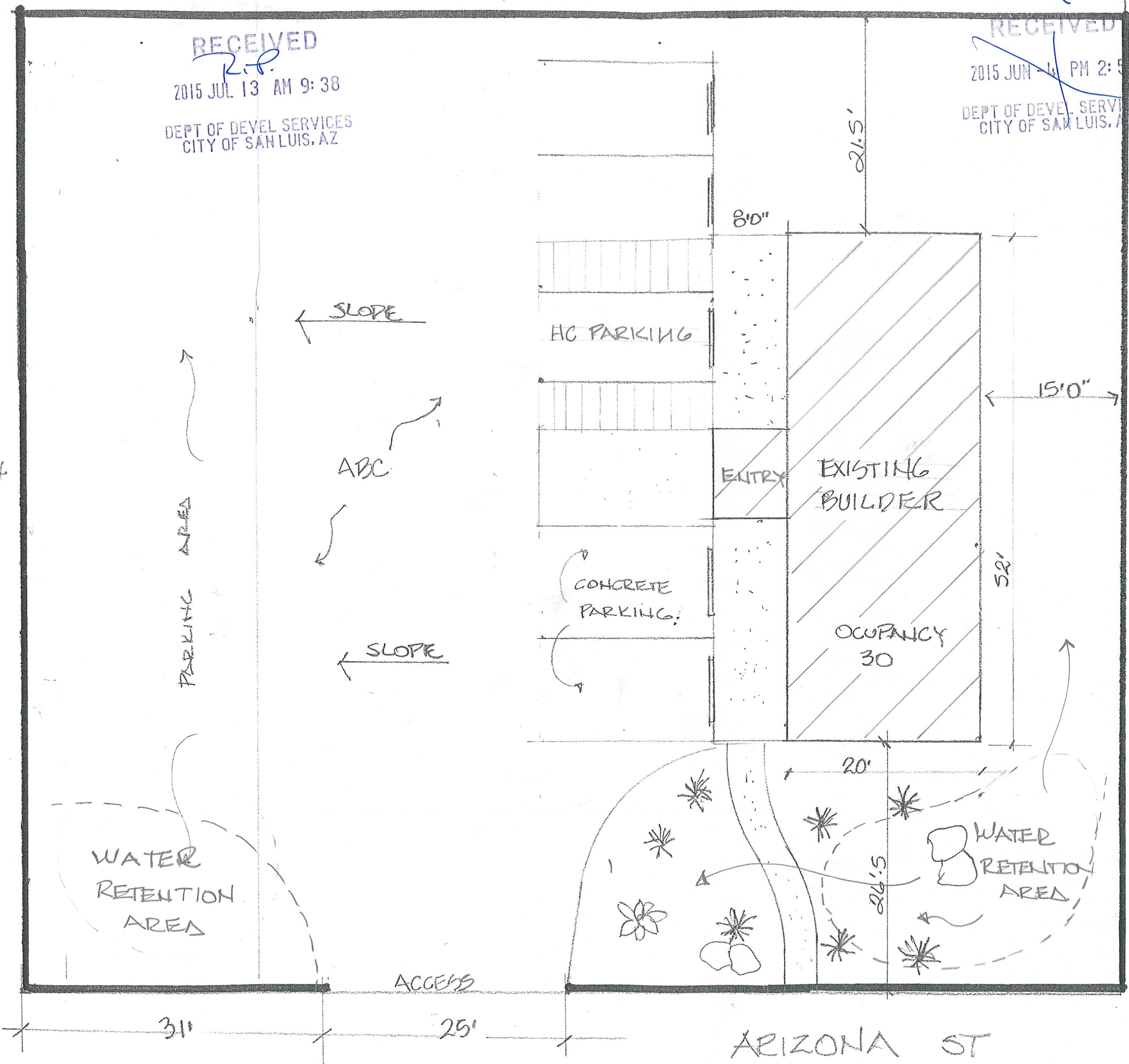

CHURCH OFFICE
LOCATION: 1050 W ARIZONA ST BIENESTAR EAST 4 TRACT B SAN LUIS AZ.
SITE PLAN

WATER RETENTION AREA

PARKING AREA

SLOPE

ABC

SLOPE

HC PARKING

CONCRETE PARKING

ENTRY

EXISTING BUILDER

OCCUPANCY 30

WATER RETENTION AREA

WATER RETENTION AREA

ACCESS

ARIZONA ST

RECEIVED

2015 AUG 27 PM 1:18

DEPT OF DEVEL SERVICES
CITY OF SAN LUIS, AZ

52'0"

14'6"

17'0"

4'6"

EXIT SIGN W/LIGHT

EXIT SIGN W/LIGHT

CLASSROOM-1

CLASSROOM-2

OFFICE 3

RESTROOM

9'6"

4'11/2" X 0

4'11/2" X 0

3' X 6' 8"

FIRE E.

FIRE E.

FIRE E.
6' X 6' 8"

PORCH

STOCK ROOM

34 seats

PULPIT

4'4" X 0

4'4" X 0

4'4" X 0

20'0"

8'0"

10'0"

EXISTING FLOOR PLAN

1/4" = 1'0"

CHURCH
OFFICE

LOCATION:

1050 W ARIZONA ST
BIENESTAR EAST 4. TRACT B
SAN LUIS AZ