



Arizona Department of Liquor Licenses and Control
 800 W Washington 5th Floor
 Phoenix, AZ 85007-2934
 www.azliquor.gov
 (602) 542-5141

FOR DLLC USE ONLY

Event Date(s):
Event time start/end:
CSR:
License:

SEP 14 2017

APPLICATION FOR SPECIAL EVENT LICENSE
 Fee= \$25.00 per day for 1-10 days (consecutive)
 Cash Checks or Money Orders Only

Office of the City Clerk
 City of San Luis, Arizona

A service fee of \$25.00 will be charged for all dishonored checks (A.R.S. § 44-6852)

IMPORTANT INFORMATION: This document must be fully completed or it will be returned.

The Department of Liquor Licenses and Control must receive this application ten (10) business days prior to the event. If the special event will be held at a location without a permanent liquor license or if the event will be on any portion of a location that is not covered by the existing liquor license, this application must be approved by the local government before submission to the Department of Liquor Licenses and Control (see Section 15).

SECTION 1 Name of Organization: San Luis Frontera Rotary Club

SECTION 2 Non-Profit/IRS Tax Exempt Number: 86-0734186

SECTION 3 The organization is a: (check one box only)

- Charitable Fraternal (must have regular membership and have been in existence for over five (5) years)
- Religious Civic (Rotary, College Scholarship) Political Party, Ballot Measure or Campaign Committee

SECTION 4 Will this event be held on a currently licensed premise and within the already approved premises? Yes No

 Name of Business License Number Phone (include Area Code)

SECTION 5 How is this special event going to conduct all dispensing, serving, and selling of spirituous liquors? Please read R-19-318 for explanation (look in special event planning guide) and check one of the following boxes.

- Place license in non-use
- Dispense and serve all spirituous liquors under retailer's license
- Dispense and serve all spirituous liquors under special event
- Split premise between special event and retail location

(IF NOT USING RETAIL LICENSE, SUBMIT A LETTER OF AGREEMENT FROM THE AGENT/OWNER OF THE LICENSED PREMISE TO SUSPEND THE LICENSE DURING THE EVENT. IF THE SPECIAL EVENT IS ONLY USING A PORTION OF PREMISE, AGENT/OWNER WILL NEED TO SUSPEND THAT PORTION OF THE PREMISE.)

SECTION 6 What is the purpose of this event? On-site consumption Off-site (auction) Both

SECTION 7 Location of the Event: Joe Orduño Park

Address of Location: 965 N Park Avenue San Luis Yuma AZ 85349
Street City COUNTY State Zip

SECTION 8 Will this be stacked with a wine festival/craft distiller festival? Yes No

SECTION 9 Applicant must be a member of the qualifying organization and authorized by an Officer, Director or Chairperson of the Organization named in Section 1. (Authorizing signature is required in Section 13.)

1. Applicant: Ramirez Marcos 10/25/1988
Last First Middle Date of Birth

2. Applicant's mailing address: PO BOX 13926 San Luis Arizona 85349
Street City State Zip

3. Applicant's home/cell phone: (928) 627-3873 Applicant's business phone: (928) 285-3532

4. Applicant's email address: marcosramirez5550@gmail.com

SECTION 10

- Has the applicant been convicted of a felony, or had a liquor license revoked within the last five (5) years?
 Yes No (If yes, attach explanation.)
- How many special event licenses have been issued to this location this year? 5
 (The number cannot exceed 12 events per year; exceptions under A.R.S. §4-203.02(D).)
- Is the organization using the services of a promoter or other person to manage the event? Yes No
 (If yes, attach a copy of the agreement.)
- List all people and organizations who will receive the proceeds. Account for 100% of the proceeds. The organization applying must receive 25% of the gross revenues of the special event liquor sales. Attach an additional page if necessary.
 Name San Luis Frontera Rotary Club Percentage: 50%
 Address PO BOX 13926 San Luis Arizona 85349
Street City State Zip
 Name Pueblo Housing & Community Development Percentage: 50%
 Address PO BOX 3763 San Luis Arizona 85349
Street City State Zip
- Please read A.R.S. § 4-203.02 Special event license; rules and R19-1-205 Requirements for a Special Event License.

Note: ALL ALCOHOLIC BEVERAGE SALES MUST BE FOR CONSUMPTION AT THE EVENT SITE ONLY.
"NO ALCOHOLIC BEVERAGES SHALL LEAVE SPECIAL EVENT UNLESS THEY ARE IN AUCTION SEALED CONTAINERS OR THE SPECIAL EVENT LICENSE IS STACKED WITH WINE /CRAFT DISTILLERY FESTIVAL LICENSE"

- What type of security and control measures will you take to prevent violations of liquor laws at this event?
 (List type and number of police/security personnel and type of fencing or control barriers, if applicable.)
2 Number of Police 2 Number of Security Personnel Fencing Barriers
 Explanation: Fencing will be placed around both beer areas. One entrance and One exit will be posted.
Security will be place at both ends to ensure proper flow of people. Signs will be posted
on each site, indicating entrance and exit.

SECTION 11 Dates and Hours of Event. Days must be consecutive but may not exceed 10 consecutive days.
 See A.R.S. § 4-244(15) and (17) for legal hours of service.

PLEASE FILL OUT A SEPARATE APPLICATION FOR EACH "NON-CONSECUTIVE" DAY

	Date	Day of Week	Event Start Time AM/PM	License End Time AM/PM
DAY 1:	<u>10/21/2017</u>	<u>Saturday</u>	<u>3:00 PM</u>	<u>12:00 AM</u>
DAY 2:	_____	_____	_____	_____
DAY 3:	_____	_____	_____	_____
DAY 4:	_____	_____	_____	_____
DAY 5:	_____	_____	_____	_____
DAY 6:	_____	_____	_____	_____
DAY 7:	_____	_____	_____	_____
DAY 8:	_____	_____	_____	_____
DAY 9:	_____	_____	_____	_____
DAY 10:	_____	_____	_____	_____

SECTION 12 License premises diagram. The licensed premises for your special event is the area in which you are authorized to sell, dispense or serve alcoholic beverages under the provisions of your license. The following space is to be used to prepare a diagram of your special event licensed premises. Please show dimensions, serving areas, fencing, barricades, or other control measures and security position.

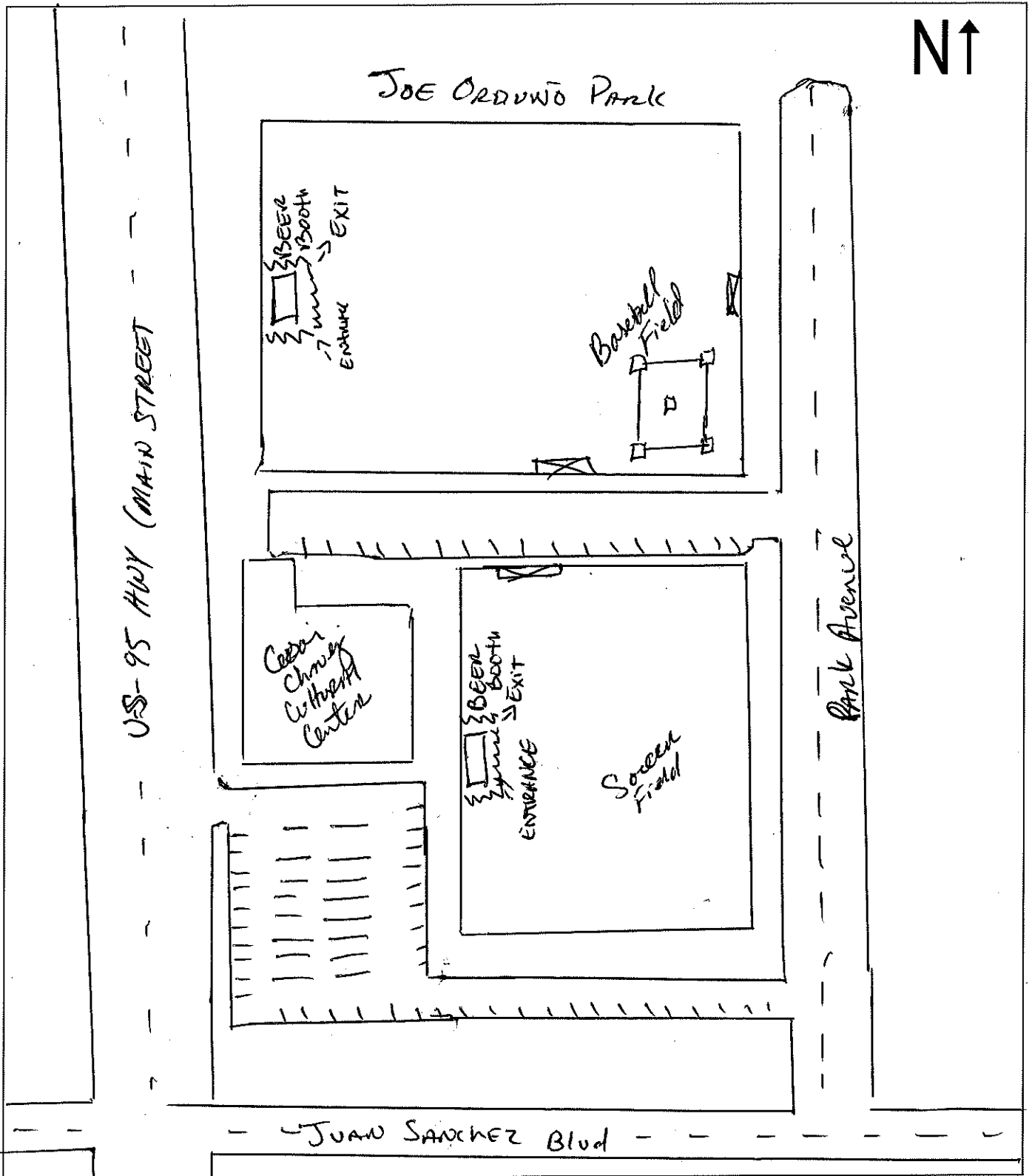

SECTION 13 To be completed only by an Officer, Director or Chairperson of the organization named in Section 1.

I, (Print Full Name) Marcos Ramirez declare that I am an Officer, Director or Chairperson of the organization filing this application as listed in Section 9. I have read the application and the contents and all statements are true, correct and complete.

X Marcos Ramirez Sgt at Arms 9/12/2017 928-285-3532
 Signature Title/ Position Date Phone Number

The foregoing instrument was acknowledged before me this 12 September 2017
 Day Month Year

State AZ County of Yuma

My Commission Expires on: Feb 14 2019 Date [Signature] Signature of Notary Public

SECTION 14 This section is to be completed only by the applicant named in Section 9.

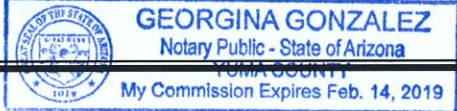

I, (Print Full Name) Marcos Ramirez declare that I am the APPLICANT filing this application as listed in Section 9. I have read the application and the contents and all statements are true, correct and complete.

X Marcos Ramirez Sgt at Arms 9/12/2017 928-285-3532
 Signature Title/ Position Date Phone Number

The foregoing instrument was acknowledged before me this 12 September 2017
 Day Month Year

State AZ County of Yuma

My Commission Expires on: Feb 14 2019 Date [Signature] Signature of Notary Public

Please contact the local governing board for additional application requirements and submission deadlines. Additional licensing fees may also be required before approval may be granted. For more information, please contact your local jurisdiction: http://www.azliquor.gov/assets/documents/homepage_docs/spec_event_links.pdf



SECTION 15 Local Governing Body Approval Section.

I, _____ recommend APPROVAL DISAPPROVAL
 (Government Official) (Title)

On behalf of _____, _____, _____, _____
 (City, Town, County) Signature Date Phone

SECTION 16 For Department of Liquor Licenses and Control use only.

APPROVAL DISAPPROVAL BY: _____ DATE: ____/____/____

A.R.S. § 41-1030. Invalidity of rules not made according to this chapter; prohibited agency action; prohibited acts by state employees; enforcement; notice

B. An agency shall not base a licensing decision in whole or in part on a licensing requirement or condition that is not specifically authorized by statute, rule or state tribal gaming compact. A general grant of authority in statute does not constitute a basis for imposing a licensing requirement or condition unless a rule is made pursuant to that general grant of authority that specifically authorizes the requirement or condition.

D. THIS SECTION MAY BE ENFORCED IN A PRIVATE CIVIL ACTION AND RELIEF MAY BE AWARDED AGAINST THE STATE. THE COURT MAY AWARD REASONABLE ATTORNEY FEES, DAMAGES AND ALL FEES ASSOCIATED WITH THE LICENSE APPLICATION TO A PARTY THAT PREVAILS IN AN ACTION AGAINST THE STATE FOR A VIOLATION OF THIS SECTION.

E. A STATE EMPLOYEE MAY NOT INTENTIONALLY OR KNOWINGLY VIOLATE THIS SECTION. A VIOLATION OF THIS SECTION IS CAUSE FOR DISCIPLINARY ACTION OR DISMISSAL PURSUANT TO THE AGENCY'S ADOPTED PERSONNEL POLICY.

F. THIS SECTION DOES NOT ABROGATE THE IMMUNITY PROVIDED BY SECTION 12-820.01 OR 12-820.02.



CERTIFICATE OF LIABILITY INSURANCE

7/1/2017

DATE (MM/DD/YYYY)
9/12/2017

THIS CERTIFICATE IS ISSUED AS A MATTER OF INFORMATION ONLY AND CONFERS NO RIGHTS UPON THE CERTIFICATE HOLDER. THIS CERTIFICATE DOES NOT AFFIRMATIVELY OR NEGATIVELY AMEND, EXTEND OR ALTER THE COVERAGE AFFORDED BY THE POLICIES BELOW. THIS CERTIFICATE OF INSURANCE DOES NOT CONSTITUTE A CONTRACT BETWEEN THE ISSUING INSURER(S), AUTHORIZED REPRESENTATIVE OR PRODUCER, AND THE CERTIFICATE HOLDER.

IMPORTANT: If the certificate holder is an ADDITIONAL INSURED, the policy(ies) must be endorsed. If SUBROGATION IS WAIVED, subject to the terms and conditions of the policy, certain policies may require an endorsement. A statement on this certificate does not confer rights to the certificate holder in lieu of such endorsement(s).

PRODUCER LOCKTON COMPANIES 500 West Monroe, Suite 3400 CHICAGO IL 60661 (312) 669-6900	CONTACT NAME: Lockton Companies	FAX (A/C. No.): 1-312-681-6769
	PHONE (A/C. No. Ext): 1-800-921-3172	E-MAIL ADDRESS: rotary@lockton.com
INSURER(S) AFFORDING COVERAGE INSURER A: Lexington Insurance Company		NAIC # 19437
INSURED 1393456 All Active US Rotary Clubs & Districts San Luis Frontera Rotary, Disitrc 5500 Attn: Risk Management Department 1560 Sherman Ave. Evanston, IL 60201-3698		
INSURER B:		
INSURER C:		
INSURER D:		
INSURER E:		
INSURER F:		

COVERAGES ROTJN01 CERTIFICATE NUMBER: REVISION NUMBER:

THIS IS TO CERTIFY THAT THE POLICIES OF INSURANCE LISTED BELOW HAVE BEEN ISSUED TO THE INSURED NAMED ABOVE FOR THE POLICY PERIOD INDICATED. NOTWITHSTANDING ANY REQUIREMENT, TERM OR CONDITION OF ANY CONTRACT OR OTHER DOCUMENT WITH RESPECT TO WHICH THIS CERTIFICATE MAY BE ISSUED OR MAY PERTAIN, THE INSURANCE AFFORDED BY THE POLICIES DESCRIBED HEREIN IS SUBJECT TO ALL THE TERMS, EXCLUSIONS AND CONDITIONS OF SUCH POLICIES. LIMITS SHOWN MAY HAVE BEEN REDUCED BY PAID CLAIMS.

INSR LTR	TYPE OF INSURANCE	ADDL INSD	SUBR WVD	POLICY NUMBER	POLICY EFF (MM/DD/YYYY)	POLICY EXP (MM/DD/YYYY)	LIMITS	
A	<input checked="" type="checkbox"/> COMMERCIAL GENERAL LIABILITY <input type="checkbox"/> CLAIMS-MADE <input checked="" type="checkbox"/> OCCUR <input checked="" type="checkbox"/> Liquor Liability <input type="checkbox"/> Included GEN'L AGGREGATE LIMIT APPLIES PER: <input checked="" type="checkbox"/> POLICY <input type="checkbox"/> PRO-JECT <input type="checkbox"/> LOC OTHER:			015375594	7/1/2017	7/1/2018	EACH OCCURRENCE	\$ 2,000,000
							DAMAGE TO RENTED PREMISES (Ea occurrence)	\$ 500,000
							MED EXP (Any one person)	\$ XXXXXXXX
							PERSONAL & ADV INJURY	\$ 2,000,000
							GENERAL AGGREGATE	\$ 4,000,000
							PRODUCTS - COMP/OP AGG	\$ 4,000,000
								\$
A	<input type="checkbox"/> AUTOMOBILE LIABILITY <input type="checkbox"/> ANY AUTO <input type="checkbox"/> ALL OWNED AUTOS <input checked="" type="checkbox"/> HIRED AUTOS <input type="checkbox"/> SCHEDULED AUTOS <input checked="" type="checkbox"/> NON-OWNED AUTOS			015375594	7/1/2017	7/1/2018	COMBINED SINGLE LIMIT (Ea accident)	\$ 2,000,000
							BODILY INJURY (Per person)	\$ XXXXXXXX
							BODILY INJURY (Per accident)	\$ XXXXXXXX
							PROPERTY DAMAGE (Per accident)	\$ XXXXXXXX
								\$ XXXXXXXX
	<input type="checkbox"/> UMBRELLA LIAB <input type="checkbox"/> EXCESS LIAB <input type="checkbox"/> DED <input type="checkbox"/> RETENTION \$			NOT APPLICABLE			EACH OCCURRENCE	\$ XXXXXXXX
							AGGREGATE	\$ XXXXXXXX
								\$ XXXXXXXX
	WORKERS COMPENSATION AND EMPLOYERS' LIABILITY ANY PROPRIETOR/PARTNER/EXECUTIVE OFFICER/MEMBER EXCLUDED? (Mandatory in NH) if yes, describe under DESCRIPTION OF OPERATIONS below			NOT APPLICABLE			PER STATUTE	OTH-ER
							E.L. EACH ACCIDENT	\$ XXXXXXXX
							E.L. DISEASE - EA EMPLOYEE	\$ XXXXXXXX
							E.L. DISEASE - POLICY LIMIT	\$ XXXXXXXX

DESCRIPTION OF OPERATIONS / LOCATIONS / VEHICLES (ACORD 101, Additional Remarks Schedule, may be attached if more space is required)

The Certificate Holder is included as Additional Insured where required by written contract or permit subject to the terms and conditions of the General Liability policy, but only to the extent bodily injury or property damage is caused in whole or in part by the acts or omissions of the insured.

CERTIFICATE HOLDER CANCELLATION

Off Road Expo 2017 Car Show City of San Luis 965 N Park Avenue San Luis, Arizona 85349	SHOULD ANY OF THE ABOVE DESCRIBED POLICIES BE CANCELLED BEFORE THE EXPIRATION DATE THEREOF, NOTICE WILL BE DELIVERED IN ACCORDANCE WITH THE POLICY PROVISIONS.
San Luis Frontera Rotary, Disitrc 5500 Event on 10/21/2017 in San Luis, Arizona 85349	AUTHORIZED REPRESENTATIVE