

NOTICE

APPLICATION TO SELL ALCOHOLIC BEVERAGES

DATE POSTED: November 7, 2017

A HEARING ON A LIQUOR LICENSE APPLICATION SHALL BE HELD BEFORE THE

City of San Luis Council

PLACE 1090 E. Union St. SAZ DATE/TIME 7:00 pm December 13, 2017

HEARING DATES SUBJECT TO CHANGE, TO VERIFY CALL: 928.341.8520

THE LOCAL GOVERNING BODY WILL RECOMMEND TO THE STATE LIQUOR BOARD WHETHER THE BOARD SHOULD GRANT OR DENY THE LICENSE. THE

STATE LIQUOR BOARD MAY HOLD A HEARING TO CONSIDER THE RECOMMENDATION OF THE LOCAL GOVERNING BODY. ANY PERSON RESIDING OR OWNING OR LEASING PROPERTY WITHIN A ONE-MILE RADIUS MAY CONTACT THE STATE LIQUOR BOARD IN WRITING TO REGISTER AS A PROTESTER. TO REQUEST INFORMATION REGARDING PROCEDURES BEFORE THE BOARD AND

NOTICE OF ANY BOARD HEARINGS REGARDING THIS APPLICATION, CONTACT THE

STATE LIQUOR BOARD: 800 W. WASHINGTON, 5TH FLOOR, PHOENIX, AZ. 85007 (602) 542-9789

INDIVIDUALS REQUIRING ADA ACCOMMODATIONS CALL - LOCAL GOVERNING BODY: 928.341.8520 STATE LIQUOR DEPT: (602) 542-9789

POST ONE COPY OF THE APPLICATION FORM BELOW THIS NOTICE.

17 SEP 28 11:47 AM 3:16



Arizona Department of Liquor Licenses and Control
800 W Washington 5th Floor
Phoenix, AZ 85007-2934
www.azliquor.gov
(602) 542-5141

DLLC USE ONLY

License #	12143232
Date Accepted:	11-2-17
CSR:	AP

Application for Liquor License
Type or Print with Black Ink

APPLICATION FEE AND INTERIM PERMIT FEES (IF APPLICABLE) ARE NOT REFUNDABLE
A service fee of \$25 will be charged for all dishonored checks (A.R.S. § 44-6852)

SECTION 1 Type of License

- Interim Permit
- New License
- Person Transfer
- Location Transfer (series 6, 7 and 9)
- Probate/ Will Assignment/ Divorce Decree (No Fees)
- Seasonal

SECTION 2 Type of Ownership

- J.T.W.R.O.S.
- Individual
- Partnership
- Corporation
- Limited Liability Co
- Club
- Government
- Trust
- Tribe
- Other (Explain) _____

17 NOV 2 11:47 AM 2:03

SECTION 3 Type of license

- Add Sampling Privilege for Series 9 and 10 only (Complete Sampling Privilege application) A.R.S.§4-206.01 (G), (H), (I) & (L)
- Add Growler privileges (restaurant, series 12, license only. 300-foot restriction applies) A.R.S.§4-207(A) & (B)

1.Type of License (restaurant, bar etc.): Series 12 2. LICENSE # (if issued): 12143232

SECTION 4 Applicants

1. Agent's Name: Walshe Ruben Alberto
Last First Middle P1075095
2. Applicant/Licensee Name: La Concha LLC 81059915
(Ownership name for type of ownership checked on section 1)
3. Business Name (Doing Business As-DBA): La Concha Marisqueria 81049551
4. Business Location Address: 1914 E Juan Sanchez Blvd Ste 700 San Luis Az 85349 Yuma
(Do not use PO Box) Street City State Zip Code County
5. Mailing Address: P.O. Box 1523 San Luis Az 85349
(All correspondence will be mailed to this address) Street City State Zip Code
6. Business Phone: (928) 261-0032 Daytime Contact Phone: (928) 261-0032
7. Email Address: rubenwalshe80@gmail.com
8. Is the Business located within the incorporated limits of the above city or town? Yes No
If you checked no, in what City, Town, County or Tribal/Indian Community is this business located? _____

V.A.W.

Fees: <u>100</u>	<u>—</u>	Department Use Only <u>50</u>	<u>150.00</u>
Application	Interim Permit	Site Inspection	Total of All Fees
Is Arizona Statement of Citizenship & Alien Status for State Benefits complete?			<input checked="" type="checkbox"/> Yes <input type="checkbox"/> No

K.A.W.

SECTION 5 Background Check

EACH PERSON LISTED MUST SUBMIT A QUESTIONNAIRE, FINGERPRINT CARD ALONG WITH \$22. PROCESSING FEE PER CARD.
1. If the applicant is an entity, not an individual, answer questions 1a-b.

a) Date Incorporated/Organized: 04-28-2017 State where Incorporated/Organized: AZ

b) AZ Corporation or AZ L.L.C. File No: L21820512 Date authorized to do business in AZ 04-28-17
05-1-17 P.W.

2. List any individual or entity that own a beneficial interest of 10 % or more and/or controls the license. If the applicant is owned by another entity, attach an organizational chart showing the ownership structure. Attach additional sheets as needed to disclose any controlling person, member, shareholder or general partner who owns a beneficial interest of 10 % or more of the license.

Last	First	Middle	Title	%Owned	Mailing Address	City	State	Zip
Walsh	Ruben	Albark	Owner	100	P.O. Box 1523	San Luis	AZ	85349
La Concha LLC			Member					
			P.W.					

(Attach additional sheet if necessary)

M.A.W.

SECTION 6 Interim Permit

If you intend to operate business while your application is pending you will need an interim permit pursuant to A.R.S.§4-203.01 For approval of an interim permit:

- There **must** be a valid license of the same series issued to the current location you are applying for **OR**
- A Hotel/Motel license is being replaced with a restaurant license pursuant to A.R.S.§4-203.01 (A)

1. Enter license number currently at the location: _____

2. Is the license currently in use? Yes No If no, how long has it been out of use? _____

I, (Signature) _____ declare that I am the CURRENT OWNER, AGENT, OR CONTROLLING PERSON on the stated license and location.

Attach a copy of the license currently issued at this location to this application.

NOTARY

State of Arizona)
County of _____)

On this ____ Day of _____, 20____ before me personally appeared N/A
(Print Name of Document Signer)

Whose identity was proven to me on the basis of satisfactory evidence to be the person who he or she claims to be and acknowledged that he or she signed the above/attached document.

Signature of NOTARY PUBLIC

(Affix Seal Above)

SECTION 7 Probate, Receiver, Bankruptcy Trustee, Assignment, or Divorce Decree of an existing liquor license ARS § 4-204

EACH PERSON LISTED MUST SUBMIT A QUESTIONNAIRE, FINGERPRINT CARD ALONG WITH \$22. PROCESSING FEE PER CARD.

1. Current Licensee's Name: _____
(Exactly as it appears on the license) Last First Middle

2. Assignee's Name: _____
Last First Middle

License Number: _____

ATTACH A COPY OF THE DOCUMENT THAT SPECIFICALLY ASSIGNS THE LIQUOR LICENSE TO THE ASSIGNEE.

SECTION 8 Government (for Cities, Towns or Counties only)

1. Government Entity: N/A
2. Person/Designee: N/A
Last First Middle Daytime Contact Phone #

A SEPARATE LICENSE MUST BE OBTAINED FOR EACH PREMISES FROM WHICH SPIRITIOUS LIQUOR IS SERVED.

SECTION 9 Person to Person – Current Licensee Information ARS§4-203(C), (D), (G)
(Bar and Liquor Stores only – Series 06, 07 and 09)

1. License #: N/A
2. Current Agent Name: _____
Last First Middle
3. Current Licensee Name: _____
(Exactly as it appears on the license)
4. Current Business Name: _____
(Exactly as it appears on the license)
5. Current Daytime Phone: _____ Primary Email Address: _____
6. Does current licensee intend to operate the business while this application is pending? Yes No
7. I authorize the transfer of this license to the applicant: _____
Signature or Agent or Individual controlling person

NOTARY

State of Arizona)
County of _____)
On this _____ Day of _____, 20____ before me personally appeared _____
Day Month Year (Print Name of Document Signer)
Whose identity was proven to me on the basis of satisfactory evidence to be the person who he or she claims to be and
acknowledged that he or she signed the above/attached document.

Signature of NOTARY PUBLIC
(Affix Seal Above)

SECTION 10 Proximity to Church or School - Questions to be completed by 6, 7, 9, 10 and 12G applicants.

A.R.S. §4-207. (A) and (B) state that no retailer's license shall be issued for any premises which are at the time the license application is received by the director, within three hundred (300) horizontal feet of a church, within three hundred (300) horizontal feet of a public or private school building with kindergarten programs or grades one (1) through (12) or within three hundred (300) horizontal feet of a fenced recreational area adjacent to such school building.

The above paragraph DOES NOT apply to:

- a) Restaurants that do not sell growlers (A.R.S. §4-205.02) Series 12
- b) Hotel/motel license (A.R.S. §4-205.01) Series 11
- c) Microbrewery (A.R.S. §4-205.08) Series 3
- d) Craft Distillery (A.R.S. §4-205.10) Series 18
- e) Government license (A.R.S. §4-205.03) Series 5
- f) Playing area of a golf course (A.R.S. §4-207 (B)(5))
- g) Wholesaler/Distributor Series 4
- h) Farm Winery Series 13
- i) Producer Series 1

-Section 10 continued -

1. Distance to nearest School: N/A Name of School: N/A
 (If less than one (1) mile note footage) Address: _____

2. Distance to nearest Church: N/A Name of Church: N/A
 (If less than one (1) mile note footage) Address: _____

SECTION 11 Business Financials A.R.S. §4-202(F)

1. I am the:

- Tenant: a person who holds the lease of a property; a lessee.
- Sub-tenant: a person who holds a lease which was given to another person (tenant) for all or part of a property.
- Owner
- Purchaser
- Management Company

2. If the premises is leased give lessors: Name: DHG Management
 Address: 1950 Juan Sanchez Blvd San Luis Az 85349
Street City State Zip

3. What is the penalty if the lease is not fulfilled? \$ None or Other: _____

4. Total money borrowed for the Business not including lease? \$ None \$0.00

Please List Lenders/People you owe money to for business.

Last	First	Middle	Amount Owed	Mailing Address	City	State	Zip

(Attach additional sheet if necessary)

5. Has a license or a transfer license for the premises on this application been denied by the state within the past year?

Yes No If yes, attach explanation.

6. Does any spirituous liquor manufacture, wholesaler, or employee have an interest in your business?

Yes No If yes, attach explanation.

SECTION 12 Diagram of Premises

Check ALL boxes that apply to your business:

Walk-up or drive-through windows

Patio: Contiguous Non-Contiguous within 30 feet

1. Is your licensed premises now closed due to construction, renovation or redesign or rebuild?

Yes No If yes, what is your estimated completion date? 07/20/17
Rev. 12/01/17

Please attach a diagram of the premises which clearly show only the areas where spirituous liquor will be sold, served, consumed, dispensed, possessed or stored. Include all entrances, exits, interior walls, bar areas, dining areas, dance floor, stage, game room and the kitchen. **DO NOT INCLUDE** parking lots, living quarters or areas where business is not conducted under this liquor license. When completing your premises diagram, please identify which orientation is North.

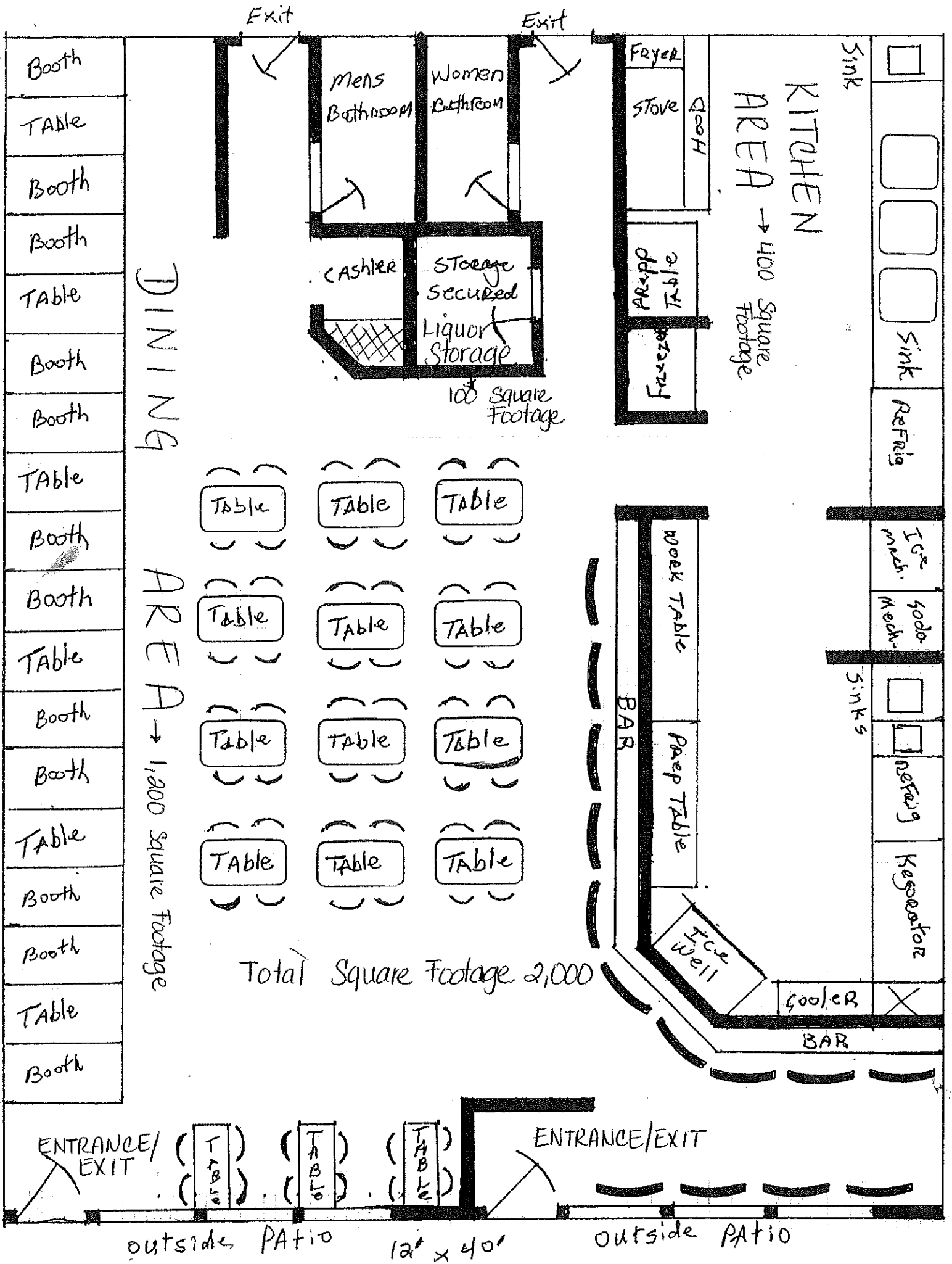

2. Provide the square footage or outside dimensions of the licensed premises. Please do not include non-licensed areas such as parking lots, living quarters, etc.

3. As stated in A.R.S. §4-207.01 (B), I understand it is my responsibility to notify the Department of Liquor Licenses and Control when there are changes to the service areas or the square footage of the licensed premises, either by increase or decrease.

R.W.
Applicants Initials

RESTAURANTS AND HOTELS/MOTELS ONLY

(IMPORTANT NOTE: A site inspection must be conducted prior to activation of the license. The fee of \$50.00 will be due and payable upon submitting this application.)

4a. Provide a detailed drawing of the kitchen and dining areas, including the locations of all kitchen equipment and dining furniture, these are required as part of the diagram. A.R.S. §4-205.02(C)

4b. Provide a restaurant operation plan.

SECTION 13 SIGNATURE BLOCK

I, (Signature) Ruben Alberto Walsh, hereby declare that I am the Owner/Agent filing this application, I have read this document and verify the content and all statements are true, correct and complete, to the best of my knowledge.

NOTARY

State of Arizona)
County of Yuma)
On this 20th Day of September 20 17 before me personally appeared Ruben Alberto Walsh
Day Month Year (Print Name of Document Signer)

Whose identity was proven to me on the basis of satisfactory evidence to be the person who he or she claims to be and acknowledged that he or she signed the above/attached document.

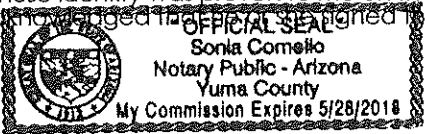

Sonia Comello
Signature of NOTARY PUBLIC

(Affix Seal Above)

A.R.S. §41-1030. Invalidity of rules not made according to this chapter; prohibited agency action; prohibited acts by state employees; enforcement; notice

B. An agency shall not base a licensing decision in whole or in part on a licensing requirement or condition that is not specifically authorized by statute, rule or state tribal gaming compact. A general grant of authority in statute does not constitute a basis for imposing a licensing requirement or condition unless a rule is made pursuant to that general grant of authority that specifically authorizes the requirement or condition.

D. THIS SECTION MAY BE ENFORCED IN A PRIVATE CIVIL ACTION AND RELIEF MAY BE AWARDED AGAINST THE STATE. THE COURT MAY AWARD REASONABLE ATTORNEY FEES, DAMAGES AND ALL FEES ASSOCIATED WITH THE LICENSE APPLICATION TO A PARTY THAT PREVAILS IN AN ACTION AGAINST THE STATE FOR A VIOLATION OF THIS SECTION.

E. A STATE EMPLOYEE MAY NOT INTENTIONALLY OR KNOWINGLY VIOLATE THIS SECTION. A VIOLATION OF THIS SECTION IS CAUSE FOR DISCIPLINARY ACTION OR DISMISSAL PURSUANT TO THE AGENCY'S ADOPTED PERSONNEL POLICY.

F. THIS SECTION DOES NOT ABROGATE THE IMMUNITY PROVIDED BY SECTION 12-820.01 OR 12-820.02.