

February 3rd, 2021

Gabriela Guevara
Communications Coordinator
San Luis Police Department
1030 East Union Street
San Luis, AZ 85349

SLPD PSAP Console Furniture Additions & Reconfigurations or Replacement – Budgetary Pricing

Gabby,

I enjoyed speaking with you late last week. Please find the below pricing for the items discussed last year, to repair and enhance the current positions. If you plan to proceed, let's get together in San Luis to dial in the details.

RB-10306 Rev D Op 1 Replacement Components & Added Console (Originally installed in 2008)			
<u>Qty.</u>	<u>Item</u>	<u>Unit Price</u>	<u>Extended Price</u>
1	New Desience Sit-Stand Dispatch Console to Match Existing - Worksurfaces will be high pressure laminate with molded urethane front edges	\$ 19,500	\$ 19,500
1	New Injection Molded Urethane Front Edge Worksurfaces - Replaces all existing worksurfaces	\$ 5,250	\$ 5,250
4	Personal Comfort System including: - Intuitive back lit controls at the worksurface edge - Dual-output forced air heater beneath worksurface with directional adjustment - Desktop cooling fans with directional diffusers, motion sensor for time out - Replaces existing (3) and covers the new position	\$ 1,600	\$ 6,400
4	Articulating Dimmable LED Task Light - Slatwall mounted, high, medium, low and off settings	\$ 255	\$ 1,020
1	Rotating Resource Center: - 36" Diameter rotating storage center for books and binders - Replaces existing unit	\$ 2,750	\$ 2,750
		Material Subtotal	\$ 34,920
		10.71% Sales Tax	\$ 3,740
		Freight Services	\$ 3,250
		Installation Services including reconfiguration of existing	\$ 7,750
		Project Total	\$ 49,660

A drawing of the reconfigured space is also included. If we were to look at a complete replacement, we would rethink and rework the entire design. See the next page for more information and budgetary pricing on a complete replacement.

Lead times are estimated at (12) weeks after receipt of order.

Please don't hesitate to contact me with any questions or concerns at (602) 380-6322 or mgawin@russbassett.com.

Respectfully,



Matt Gawin

San Luis PD Replacement Consoles - Preliminary Budget, Base Consoles

Qty.	Item	Unit Price	Extended Price
4	PSAP Consoles including: - Flex Corner and/or Linear Sit-Stand Consoles, 22.6" to 48.7" height range, heavy duty lifting columns, anti-collision technology - Single continuous worksurface, molded urethane edge - Continuous 42"H x 7" structural technology wall surround with removable vented interior/exterior lower access panels and acoustic fabric clad or powder coat painted steel upper panels behind sit-stand - Upper Slatwall section with integrated wire management troughs - Slatwall Monitor Array to support the monitor configurations shown in drawings - All technology is fully integrated and enclosed in under sit-stand cabinets, Micro PCs mounted at the Slatwall Array - Includes USB Keystone Couplers with 15' Extension Cables to couple with mice and keyboards with enclosed computers - Includes 14-Port Data Termination Bracket Kit, 2U Vertical Rack Mount Kit and R56 Bonding/Grounding Kit Accessories at all positions - Includes fixed height bridge shared storage as shown in drawings (Personal Storage & General room support) - Finished end panels (Painted Steel or Laminate)	\$ 12,750	\$ 51,000
4	Dimmable LED Task Lights - Gooseneck Light with rotating dimmer switch at dashboard and/or Fully Articulating Light mounted to Slatwall Monitor Array with hi, medium, low and off settings	\$ 255	\$ 1,020
4	Personal Device Convenience Outlets: - (1) 3-prong outlet and (2) USB power-only outlets located at dashboard	\$ 165	\$ 660

Material Subtotal	\$ 52,680
10.71% Sales Tax	\$ 5,642
Freight Services - Single Delivery	\$ 4,750
Installation Services - Single Phase Installation	\$ 8,950
Project Total - Base Consoles	\$ 72,022

Base Consoles + Optional Features, 2-Phase Installation

4	PSAP Consoles - Same as above - but assumes larger console, less cost-effective layout)	\$ 13,995	\$ 55,980
8	Dimmable LED Task Lights (same as above)	\$ 255	\$ 2,040
4	Personal Device Convenience Outlets (same as above)	\$ 165	\$ 660
4	Sanitation Station 1 - Slatwall Mounted Tissue / Hand Sanitizer Holder	\$ 160	\$ 638
4	Sanitation Station 2 - Slatwall Mounted Disinfectant Wipe Bottle Holder	\$ 110	\$ 440
4	Personal Comfort System including: - Dual-output forced air heater beneath worksurface with directional adjustment - Desktop cooling fans with directional diffusers - Intuitive back lit controls at the dashboard - Occupancy sensor for time out after 15 minutes of inactivity	\$ 1,195	\$ 4,780
4	Ambient Lighting - Blue light, under and over counter only, rotating dimmer at dashboard	\$ 625	\$ 2,500

Material Subtotal	\$ 67,038
10.71% Sales Tax	\$ 7,180
Freight Services - Single Delivery	\$ 4,250
Installation Services - 2 Phase Installation	\$ 13,500
Project Total - Base Consoles + Optional Features	\$ 91,968

This is a budget. If we can spend some time either in person or virtually discussing the project and learning about your operations, as well as sharing more about Russ Bassett, we can develop design drawings and an actual line item detail quotation.

The figures shown in the following pricing charts include all associated design, project management, console materials, sales tax, freight services and installation services. This quotation also includes Sales Taxes. We have estimated the Freight and Installation Services based on the understanding that we would complete the

project over the course of one (1) phase in the "base" console estimate and two (2) phases in the second pricing chart, with all material/product delivering in at the start of the 1st phase, to be stored at your facility until the time of the 2nd phase to save the cost of a second shipment.

The pricing excludes source electrical and communications cabling, floor coring, grounding, seismic anchoring (if applicable), new monitors, monitor mounting, monitor cables, cable labeling and cable routing. Russ Bassett can estimate and provide any of these excluded or other additional items and/or services upon request.

Russ Bassett is an industry leading designer and manufacturer of the highest quality consoles for mission critical environments. We are a financially stable company that has consistently delivered positive results for our clients for now 60 years. Russ Bassett has a state of the art 110,000 square foot manufacturing facility and showroom in Whittier, CA. We have proven expertise and experience in the layout, design, manufacture, shipment, delivery, installation and service of mission critical console systems. Based on our successful similar work for other Public Safety Communications Agencies, Transportation Network Operations Control Centers, Power Utilities and Military/Government Agencies you can trust us to do a great job for the San Luis Police Department.

Our goal is that every Russ Bassett client has an excellent experience working with us from project inception through successful project installation, and in the long run as we provide ongoing service and support. We strive to not only meet your expectations but exceed them. We will bring drive, integrity, attention to detail, and excellent service to your Team during every stage of the project. We will work in concert with SLPD, City Facilities and IT Staff, your Radio and 9-1-1 Equipment providers, electrician, low voltage communications subcontractor, and any other project stakeholders to deliver a best-in-class solution on-time and on-budget. We are team players!

Procurement

Russ Bassett Consoles are available to the City of San Luis via HGACBuy Contract EC07-20 for 9-1-1 Equipment & Services and have been priced accordingly. According to the HGACBuy website, there is already an IGA in place and you are a Member/User of this pre-competitively bid cooperative purchasing vehicle.

Russ Bassett Console Salient Characteristics

Our consoles are designed with the comfort, safety and productivity of the Telecommunicators as the primary focus. The proposed console design also effectively integrates technology creating a 'no-fail' work environment and allowing technicians to quickly access and trouble shoot equipment when necessary.

Russ Bassett has proposed a solution built upon our Flex Console system. The Flex Console product platform – as installed most recently in AZ at the Mesa PD and Peoria PD dispatch centers – is highly reliable, extraordinarily durable and ergonomically designed.

Here are a few key features that differentiate Russ Bassett Consoles from other options you may be considering:

- **Individually Adjustable Monitor Arms or Slatwall Monitor Arrays**

When it comes to monitor mounts, we strive to be the most flexible provider available. As our standard, Russ Bassett consoles utilize individually adjustable monitor arms that are fully articulating and designed to universally accommodate differing monitor sizes and weights. Individually adjustable monitor arms allow each user to adjust monitors to their focal depth and angle preferences so that they can be super comfortable as they work. We also offer a Slatwall Monitor Array that moves all monitors together as one with electric height and manual focal depth user adjustments. The array is a curved two-sided slatwall design and incorporates adjustable mounts that provide for peripheral and tilt angles to be preset, both optimizing the ergonomic interface and properly aligning all monitor seams. In either case robust power distribution and cable management features are integrated.

We have proposed the use of our Slatwall Monitor Array solution. If you were to head over to YCSO Dispatch to see their operations, you'd see fully articulating monitor arms.

- **Welded Steel Framework**

Russ Bassett consoles are welded steel rather than bolted extrusions and/or wood panels, offering superior rigidity (particularly beneficial for reconfiguring) and superior heat dispersion. While we do offer exhaust fan kits for technology storage areas, they are almost never required because the welded steel consoles are very well ventilated and disperse heat rather than insulating it.

The integrated 42" high structural/technology wall surround has a 7" profile and provides a rigid physical structure to the system, multiple cable management raceways, serve as the zone for accommodating and fully enclosing electrical J-box and network cabling demarcations, allows for computer and peripheral equipment placement, vertical rack mounting, and serves as the connection between the sit-stand cable management infrastructure and the fixed height extension cabinets, including accommodating all cable routing and coiling of excess computer cabling service loops. When supporting fixed height extensions and bridges, the walls include an upper slatwall section with flipper door access panels opening into the integrated wire management troughs. The walls have interior and exterior, lower and upper access panels as well as removable top caps that are also of perforated steel construction. Top caps can be specialized for integration of status indicator lights and large screen display mounts. This is an extraordinarily well thought out and durable solution! It is designed, engineered and manufactured as console furniture from the ground up and does not incorporate office furniture like elements.

- **Large, Uninterrupted Worksurface**

Russ Bassett consoles are designed to allow a full single-lift surface to achieve the BIFMA ergonomic standards for input device platforms, meaning a separate keyboard surface is not required. Your writing surface, work area, telephones and other peripheral devices are all at the same comfortable height as your keyboards. Height adjustment range is from 22.6" to 48.7" from the floor to the top of the work surface, which exceeds the HFES 100-2007, ANSI/BIMFA G1-2002 and all European standards for input device platforms.

- **Durable - Molded Front Edge**

Russ Bassett work surfaces utilize an injection molded urethane edge that provides a comfortable, durable, liquid tight edge. There is no exposed hardware on our consoles making them aesthetically appealing, comfortable and extremely tough.

- **Safety – Anti-Collision Technology**

Russ Bassett Flex consoles utilize in-house fabricated anti-collision switch covering the area of the user where the surface could lower onto a chair or operator. The lifting legs also can sense pressure. If the surface is lowered onto an object (such as a chair) the anti-collision technology is activated and the worksurface rises slightly avoiding any contact.

- **Cable Management**

We obsess over orderly cable management! You cannot put your foot up and disconnect a mouse, keyboard or anything else! All PCs and peripheral equipment monitor video and power cables, source electrical and communications cabling, etc. all occur within the console. From the monitor arms or slatwall monitor array, into the slatwall wire management trough, down the cable chains, into the structural wall and out into the PC enclosure spaces we properly manage all audio, video, power and network cables to keep all mission critical systems easily accessible and the console easily retrofittable.

- **Lockers, Tables and Accessories**

A wide range of locker, storage and table solutions, as well as many other accessorial features are available to accompany Russ Bassett Consoles. Accessories in addition to those shown in the pricing chart above include edge etched glazing with agency logos integrated, slatwall mounted organizational tools and speaker mounts, sanitation stations, cup holders, various technology integration options such as PC Towers vs. under counter cabinets, rack mount kits, monitor cables and many other options are available. Some of these items can be viewed here <https://russbassett.com/control-room-resources/literature/> and we look forward to discussing them further with your Team!

Product videos can be viewed at this link <https://russbassett.com/control-room-resources/video/>.

We are proud to be "**Made in the USA**". Russ Bassett Consoles are made at our factory in Whittier, California. We are vigilant in ensuring that our manufacturing processes and products are environmentally sound and will have favorable impact in our customer's facilities.

Russ Bassett offers several standard high-quality powder coat paint options for the Steel Framework including PC enclosures and storage components, as well as many standard top grade, high pressure laminate options for the worksurface. Flex Consoles can have no fabric if that is preferred, as we discussed in Payson. Finishes can be viewed on our website here: <https://russbassett.com/control-room-resources/finishes/>. Physical samples will be provided prior to selection.

Project Management and Schedule

As stated, Russ Bassett will work closely with your Team to ensure a seamless process and successful result. We take customer project timelines very seriously and will ensure that insofar as it depends on our Team, your project is completed on time and on budget. Manufacturing lead times for the products proposed here are currently in the ten (10) week range after receipt of order, plus shipping and installation time. Orders can be placed as far in advance as makes sense for the project.

If selected as your partner for the project, we will collaborate with the Team to define the desired start date, define all necessary action items and create and maintain a Gantt Chart Schedule to keep the Team

apprised of any extra project time, critical timelines and key action items. We are focused on successfully managing projects so that all parties involved have a great experience in working with us.

Delivery and Installation Services

Russ Bassett Project Managers and Factory Trained Local Installers deliver the highest caliber on-site delivery and installation experience. We coordinate up front, show up on time, install our console furniture with the highest safety and quality standards, and act as a team player to assist our clients in successfully implementing their projects. Key delivery and installation services include:

- o Project Planning Guide
- o Specialized packaging and transportation carriers
- o Onsite Project Manager
- o Russ Bassett Certified Local (Phoenix Area) Installers
- o Onsite Training of GC Subs and Equipment Vendors
- o Onsite Training of User Groups
- o Installation Survey

All Russ Bassett Installation Services will be coordinated from our corporate headquarters in Whittier, CA. Your Russ Bassett Project Manager will assign and lead our local Team (Phoenix based) of certified technicians to successfully complete the project.

All Russ Bassett project installations include onsite training for the electrical and communications cabling subcontractors while we're in the process of installation, as well as training for the technology integration Team and user group. A User Guide will be provided and reviewed with you at the completion of your installation.

Warranty

Russ Bassett consoles are built for 24/7 mission critical environments. Russ Bassett is your single point of contact for all questions regarding operation, warranty and service items. We have a simple, all inclusive ten (10) year warranty. Russ Bassett consoles do not require any kind of regularly scheduled service or preventative maintenance. We stand behind our product and are committed to maintaining long term positive relationships with our customers!

References

Provided in the following pages is a partial set of referral letters for you to check out. More can be viewed here: <https://russbassett.com/control-room-resources/endorsements/>. We would be happy to provide a list with contact information upon request.

Conclusion

If ultimately selected as your partner for the project Gabby, we will deliver both a best-in-class console furniture solution and customer experience.

Again, please don't hesitate to contact me with any questions or concerns as you review.

My cell phone is (602) 380-6322 and email is mgawin@russbassett.com.

Thank you!

Matt

February 12th, 2021

Michelle Boucher
Administrative Coordinator
San Luis Police Department
1030 E Union Street
San Luis, AZ 85349

SLPD PSAP Console Furniture Additions & Reconfigurations

Michelle,

As discussed by phone earlier this week, Russ Bassett Console Products are only available to the City of San Luis by way of a direct purchase from Russ Bassett.

As the Desience product platform installed in 2008 is no longer in regular product, there is no state contract or other contract available for the part/expansion purchase.

A purchase directly to Russ Bassett Corporation, not making reference to any contract vehicle, will be required to purchase the add on / reconfiguration option.

If you wanted to complete a full scale replacement of the existing consoles, we could do that and the proposed contract would be HGACBuy EC07-20 for 9-1-1 Equipment and Services.

Please don't hesitate to contact me with any questions or concerns at (602) 380-6322 or mgawin@russbassett.com.

Respectfully,



Matt Gawin

Request for Taxpayer Identification Number and Certification

**Give Form to the
 requester. Do not
 send to the IRS.**

▶ Go to www.irs.gov/FormW9 for instructions and the latest information.

1 Name (as shown on your income tax return). Name is required on this line; do not leave this line blank. RUSS BASSETT CORP.	
2 Business name/disregarded entity name, if different from above	
3 Check appropriate box for federal tax classification of the person whose name is entered on line 1. Check only one of the following seven boxes. <input type="checkbox"/> Individual/sole proprietor or single-member LLC <input type="checkbox"/> C Corporation <input checked="" type="checkbox"/> S Corporation <input type="checkbox"/> Partnership <input type="checkbox"/> Trust/estate <input type="checkbox"/> Limited liability company. Enter the tax classification (C=C corporation, S=S corporation, P=Partnership) ▶ _____ <small>Note: Check the appropriate box in the line above for the tax classification of the single-member owner. Do not check LLC if the LLC is classified as a single-member LLC that is disregarded from the owner unless the owner of the LLC is another LLC that is not disregarded from the owner for U.S. federal tax purposes. Otherwise, a single-member LLC that is disregarded from the owner should check the appropriate box for the tax classification of its owner.</small> <input type="checkbox"/> Other (see instructions) ▶ _____	4 Exemptions (codes apply only to certain entities, not individuals; see instructions on page 3): Exempt payee code (if any) _____ Exemption from FATCA reporting code (if any) _____ <small>(Applies to accounts maintained outside the U.S.)</small>
5 Address (number, street, and apt. or suite no.) See instructions. 8189 BYRON ROAD	Requester's name and address (optional)
6 City, state, and ZIP code WHITTIER, CA 90606	
7 List account number(s) here (optional)	

Print or type. See Specific Instructions on page 3.

Part I Taxpayer Identification Number (TIN)

Enter your TIN in the appropriate box. The TIN provided must match the name given on line 1 to avoid backup withholding. For individuals, this is generally your social security number (SSN). However, for a resident alien, sole proprietor, or disregarded entity, see the instructions for Part I, later. For other entities, it is your employer identification number (EIN). If you do not have a number, see *How to get a TIN*, later.

Note: If the account is in more than one name, see the instructions for line 1. Also see *What Name and Number To Give the Requester* for guidelines on whose number to enter.

Social security number													
<table border="1" style="width: 100%; height: 20px;"> <tr> <td style="width: 25%;"></td> <td style="width: 25%;"></td> <td style="width: 25%;"></td> <td style="width: 25%;"></td> </tr> </table>					<table border="1" style="width: 100%; height: 20px;"> <tr> <td style="width: 25%;"></td> <td style="width: 25%;"></td> <td style="width: 25%;"></td> <td style="width: 25%;"></td> </tr> </table>								
or													
Employer identification number													
<table border="1" style="width: 100%; height: 20px;"> <tr> <td style="width: 25%;">9</td> <td style="width: 25%;">5</td> <td style="width: 25%;">-</td> <td style="width: 25%;">4</td> </tr> <tr> <td style="width: 25%;">1</td> <td style="width: 25%;">1</td> <td style="width: 25%;">3</td> <td style="width: 25%;">4</td> </tr> <tr> <td style="width: 25%;">3</td> <td style="width: 25%;">4</td> <td style="width: 25%;">3</td> <td style="width: 25%;">0</td> </tr> </table>	9	5	-	4	1	1	3	4	3	4	3	0	
9	5	-	4										
1	1	3	4										
3	4	3	0										

Part II Certification

Under penalties of perjury, I certify that:

- The number shown on this form is my correct taxpayer identification number (or I am waiting for a number to be issued to me); and
- I am not subject to backup withholding because: (a) I am exempt from backup withholding, or (b) I have not been notified by the Internal Revenue Service (IRS) that I am subject to backup withholding as a result of a failure to report all interest or dividends, or (c) the IRS has notified me that I am no longer subject to backup withholding; and
- I am a U.S. citizen or other U.S. person (defined below); and
- The FATCA code(s) entered on this form (if any) indicating that I am exempt from FATCA reporting is correct.

Certification instructions. You must cross out item 2 above if you have been notified by the IRS that you are currently subject to backup withholding because you have failed to report all interest and dividends on your tax return. For real estate transactions, item 2 does not apply. For mortgage interest paid, acquisition or abandonment of secured property, cancellation of debt, contributions to an individual retirement arrangement (IRA), and generally, payments other than interest and dividends, you are not required to sign the certification, but you must provide your correct TIN. See the instructions for Part II, later.

Sign Here	Signature of U.S. person ▶	Date ▶ <u>01/03/2020</u>
------------------	----------------------------	--------------------------

General Instructions

Section references are to the Internal Revenue Code unless otherwise noted.

Future developments. For the latest information about developments related to Form W-9 and its instructions, such as legislation enacted after they were published, go to www.irs.gov/FormW9.

Purpose of Form

An individual or entity (Form W-9 requester) who is required to file an information return with the IRS must obtain your correct taxpayer identification number (TIN) which may be your social security number (SSN), individual taxpayer identification number (ITIN), adoption taxpayer identification number (ATIN), or employer identification number (EIN), to report on an information return the amount paid to you, or other amount reportable on an information return. Examples of information returns include, but are not limited to, the following.

- Form 1099-INT (interest earned or paid)

- Form 1099-DIV (dividends, including those from stocks or mutual funds)
- Form 1099-MISC (various types of income, prizes, awards, or gross proceeds)
- Form 1099-B (stock or mutual fund sales and certain other transactions by brokers)
- Form 1099-S (proceeds from real estate transactions)
- Form 1099-K (merchant card and third party network transactions)
- Form 1098 (home mortgage interest), 1098-E (student loan interest), 1098-T (tuition)
- Form 1099-C (canceled debt)
- Form 1099-A (acquisition or abandonment of secured property)

Use Form W-9 only if you are a U.S. person (including a resident alien), to provide your correct TIN.

If you do not return Form W-9 to the requester with a TIN, you might be subject to backup withholding. See What is backup withholding, later.

FOR PERSPECTIVE VIEW, SEE SHEET 1 OF 2
 FOR PLAN VIEW, SEE SHEET 2 OF 2

desience
 modular consoles



USER APPROVAL: _____

DATE: _____

COMPANY/CUSTOMER/AGENCY:
 SAN LUIS POLICE DEPARTMENT

FLOOR/AREA:
 DISPATCH

DRAWING NUMBER:
 HS-321

REVISION: A opt 1

MODULES: 11

SAE: AVA RABAGO

DEALER: CONCERT

DATE: 8/16/2010

DRAWN BY: CC

SCALE: NTS

SHEET NO.: 1 OF 2

REVISIONS:

DATE	BY	DESCRIPTION
▲		
▲		
▲		
▲		

russebassett

8189 Byron Road
 Whittier, CA 90606
 Tel. (800) 350-2445
 Fax. (562) 447-2229
www.desiencedispatch.com

RUSSEBASSETT CORPORATION hereby expressly reserves its common law copyright and other proprietary rights in these plans. These plans are not to be copied, reproduced or changed in any form or manner, whichsoever, nor are they to be assigned to any third party, without first obtaining the express written permission and consent of RUSSEBASSETT CORPORATION.

PERSPECTIVE VIEW

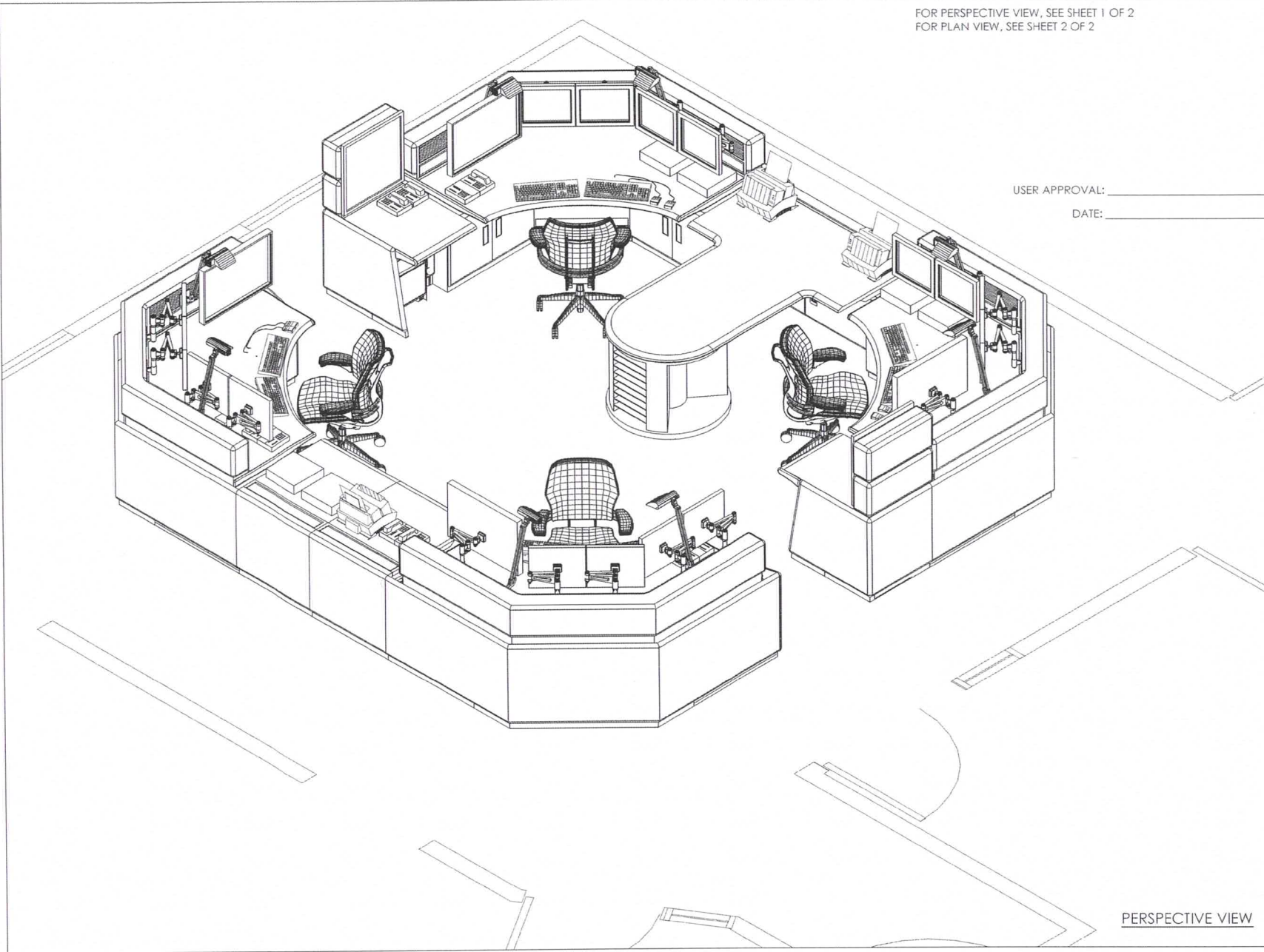

24'-8 1/2"

FOR PERSPECTIVE VIEW 1, SEE SHEET 1 OF 2
FOR PLAN VIEW, SEE SHEET 2 OF 2

desience
modular consoles



USER APPROVAL: _____

DATE: _____

COMPANY/CUSTOMER/AGENCY:
SAN LUIS POLICE DEPARTMENT

FLOOR/AREA:
DISPATCH

DRAWING NUMBER:
HS-321

REVISION: A opt 1

MODULES: 11

SAE: AVA RABAGO

DEALER: CONCERT

DATE: 8/16/2010

DRAWN BY: CC

SCALE: 3/4"=1'-0"

SHEET NO.: 2 OF 2

REVISIONS:

DATE	BY	DESCRIPTION
▲		
▲		
▲		
▲		
▲		

rusbassett

8189 Byron Road
Whittier, CA 90606
Tel. (800) 350-2445
Fax. (562) 447-2229

www.desiencedispatch.com

RUS BASSETT CORPORATION hereby expressly
renewes its common law copyright and other property
rights in these plans. These plans are not to be copied,
reproduced or changed in any form or manner whatsoever
nor are they to be dispated to any third party, without first
obtaining the explicit written permission and consent
of RUS BASSETT CORPORATION.

PLAN VIEW

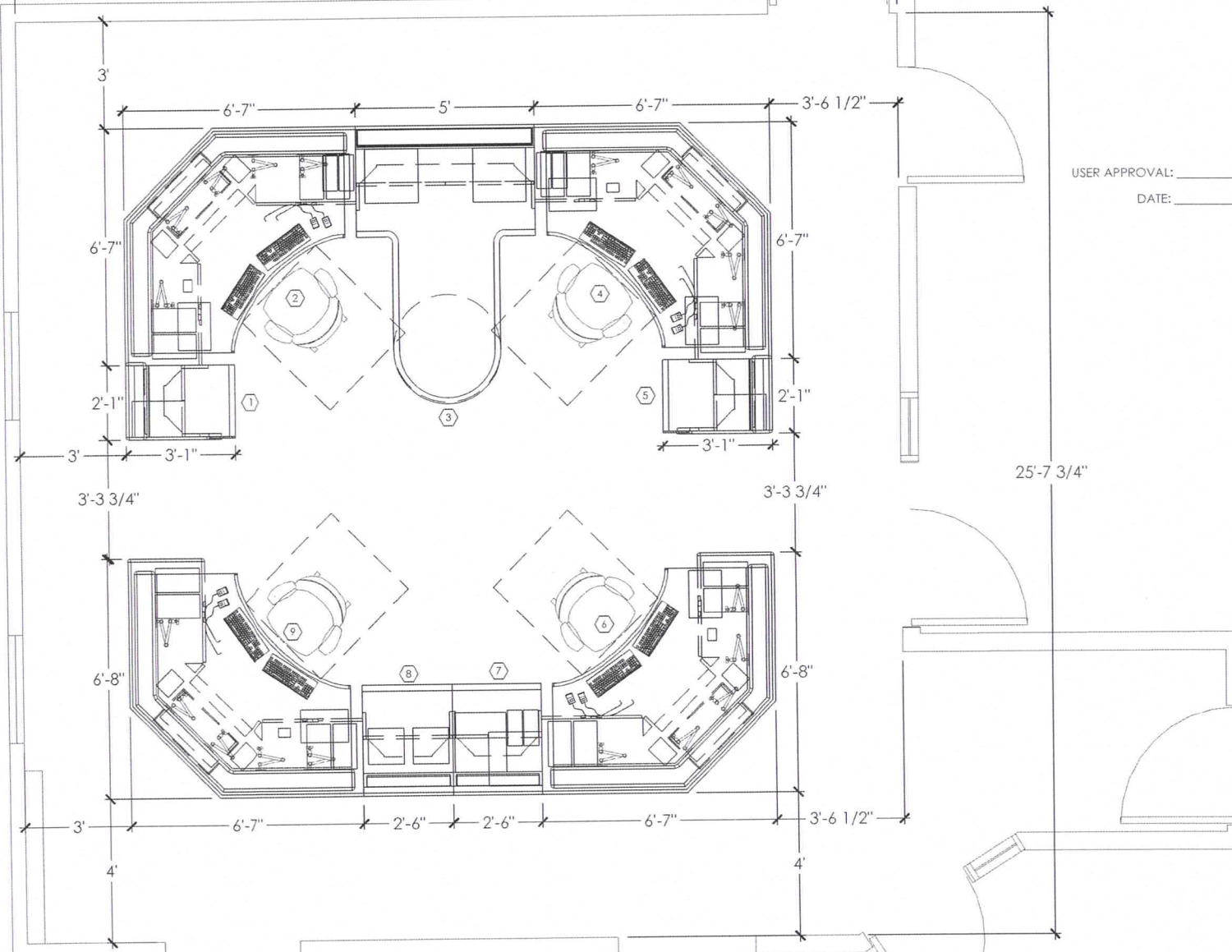

25'-7 3/4"