



# Planning and Zoning Commission

July 13, 2021

# Rezoning Case No. 2021-0243

**Request:** To rezone of a parcel 19.95 acres from Light Industrial (LI) to Medium Density Residential (R1-6). Assessor's Parcel 227-15-003, north half, located east of 20<sup>th</sup> Avenue and south of Belleza Del Desierto Phase 2 subdivision.

The applicant is requesting the rezoning of the north half to R1-6 for the construction and development of a residential subdivision.

# Rezoning Case No. 2021-0243

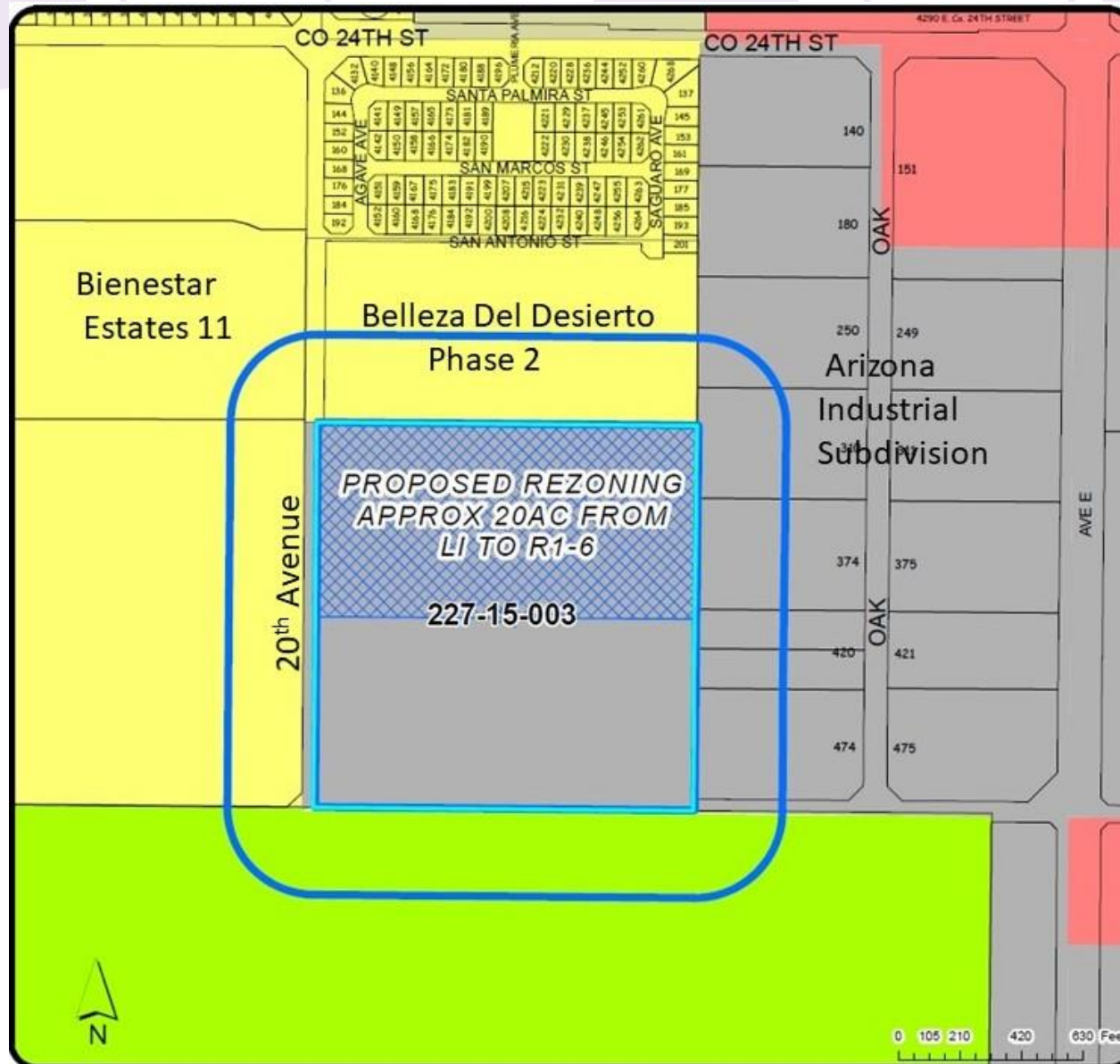

# Rezoning Case 2021-0243

Santa Cecilia  
1 & 2

Santa Cecilia  
3 & 4

Avenue E

County 24<sup>th</sup> St.

Bienestar  
Estates 11

Belleza del  
Desierto 1 & 2

Arizona  
Industrial  
Subdivision

20<sup>th</sup> Avenue

Rezoning Case 2021-0243

# Rezoning Case No. 2021-0243

## **Staff Recommendation:**

Staff recommends approval of Rezoning Case No. 2021-0243 with the following conditions of approval:

## **Recommended Motion:**

- ⦿ I MOVE TO FORWARD REZONING CASE NO. 2021-0243 TO CITY COUNCIL WITH RECOMMENDATION OF APPROVAL WITH THE FOLLOWING CONDITIONS OF APPROVAL:

# Rezoning Case No. 2021-0243

## **CONDITIONS OF APPROVAL:**

1. The owner/applicant shall submit a preliminary plat for approval in compliance with the City of San Luis subdivision regulations.
2. Development of the property, or portion thereof, and/or the approval of any subdivision plat, be conditioned upon payment to the city the sum of \$260.00 per acre, or any portion of an acre, as a proportionate contribution for a traffic signal at the intersection of County 24<sup>th</sup> Street and Avenue E.
3. The owner/applicant shall dedicate appropriate right-of-way to the City along 20<sup>th</sup> Avenue (Avenue E ½) alignment in accordance with the standards for right-of-way as provided by the City General Plan. Dedication of said right-of-way shall occur at such time and in such manner as required by the City of San Luis subdivision regulations.